

SHORT ITINERARY

ABOUT 1 ½ - 2 HOURS. ONLY THE 2ND FLOOR (Exit down the Lanzi Staircase). To see the greatest masterpieces of the Renaissance, which make the Gallery world-renowned. If you leave through this exit, you will miss the Cloakroom, the Audioguide Return Desk and the Main Museum Shop.

CLASSIC ITINERARY

MORE THAN 2 HOURS. (Descent from 2nd to 1st floor through the Lanzi Staircase) For those who wish to visit all the rooms of the gallery dedicated to Italian and European art from the 13th to the 17th centuries.

COMPLETE ITINERARY

MORE THAN 3 HOURS. (Descent from 2nd to 1st floor through the Lanzi Staircase) For those who wish to visit all the rooms, including the world-renowned Self-Portrait Collection.

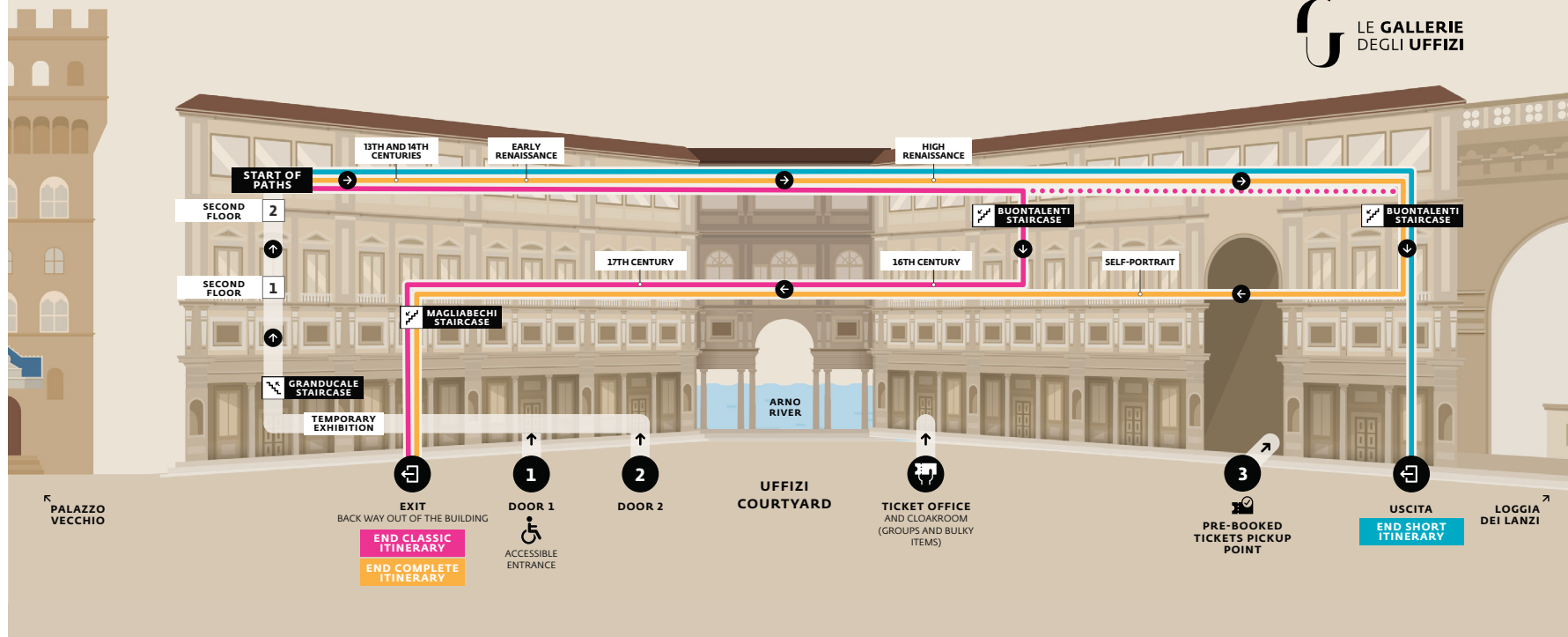

- Entrance
- Exit
- Accessible entrance
- Ticket office
- Stairs down
- Stairs up
- Lift
- Cloakroom
- Accessible toilets
- Toilet
- Baby Pit Stop
- Audioguides
- Giftshop
- Cafeteria
- Info desk
- Bookshop
- Outdoor space
- Post office

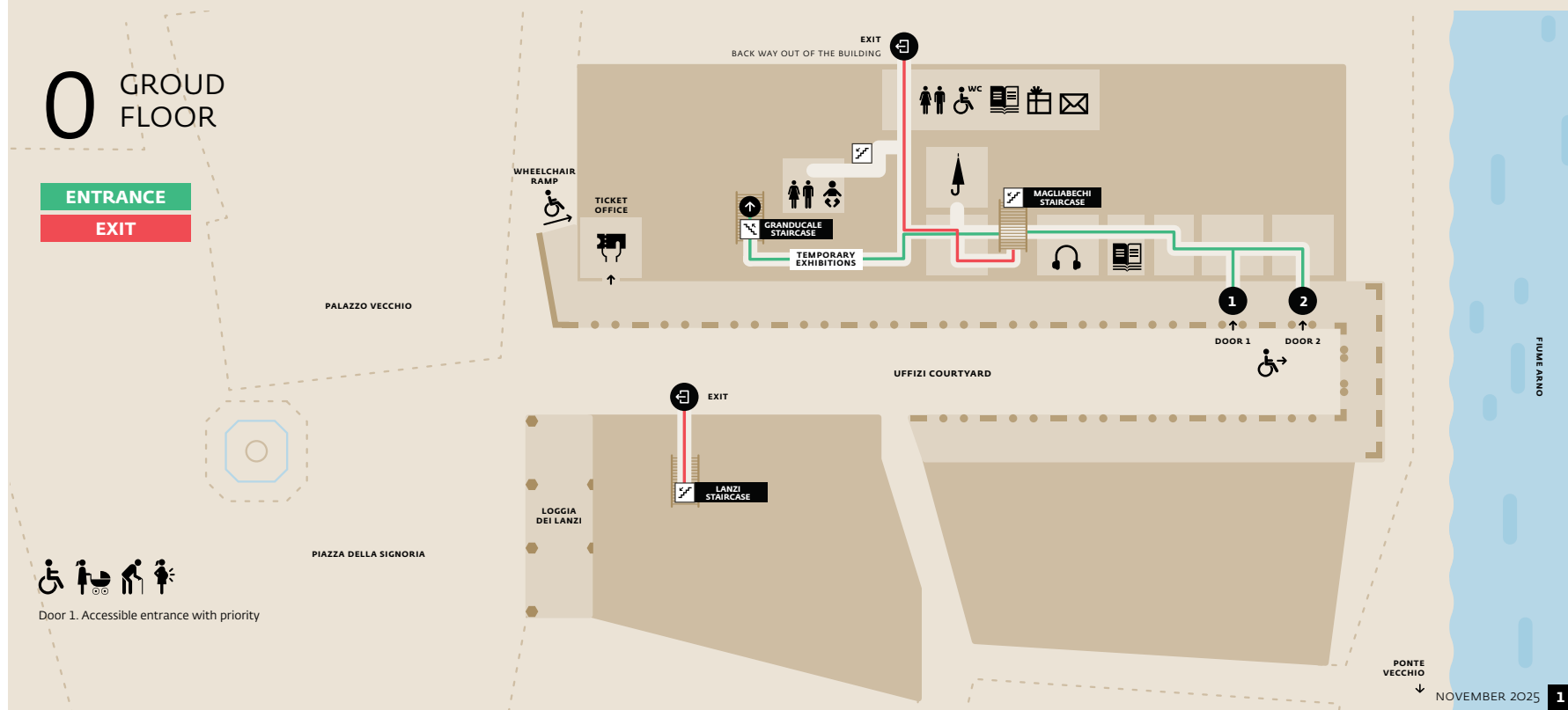

2 SECOND FLOOR

ITINERARY GROUP OF ROOMS

SHORT	A
CLASSIC	A + D + E
COMPLETE	A + B + C + D + E

XIII - XIV CENTURY

- A1 Lorenese Vestibule
- A2 Eastern Corridor
- A3 Medieval painting
- A4 Giotto, Cimabue
- A5 Lorenzetti, Simone Martini
- A6 14th Century
- A7 Lorenzo Monaco, Gentile da Fabriano

EARLY RENAISSANCE

- A8 Masaccio, Beato Angelico, P. Uccello
- A9 Filippo Lippi
- A10 I Pollaiuolo
- A11 Botticelli The Spring
- A12 Botticelli Venus
- A13 Hugo van der Goes
- A14 Room of the Maps
- A15 Room of Mathematics
- A16 Tribuna

RENAISSANCE BEYOND THE ALPS

- A17 - A20 Renaissance beyond the Alps
- A21 15th Century in Siena
- A22 Bouvoir of Miniatures

HIGH RENAISSANCE

- A24 Western Corridor
- A25 D. Veneziano - Piero della Francesca
- A26 Cosimo Rosselli
- A27 Pietro Perugino
- A28 Filippino Lippi, Piero di Cosimo
- A29 Lorenzo di Credi
- A30 Piero di Cosimo
- A31 Luca Signorelli
- A32 Luca Signorelli
- A33 Work in progress
- A34 Botticelli, Perugino
- A35 Leonardo Da Vinci
- A36 Hall of Ancient Inscriptions
- A37 The Cabinet of Marbles
- A38 Raphael and Michelangelo
- A39 Niobe Room
- A40 Fra Bartolomeo and School
- A41 Andrea del Sarto
- A42 Franciabigio, Granacci, Berruguete, Beccafumi

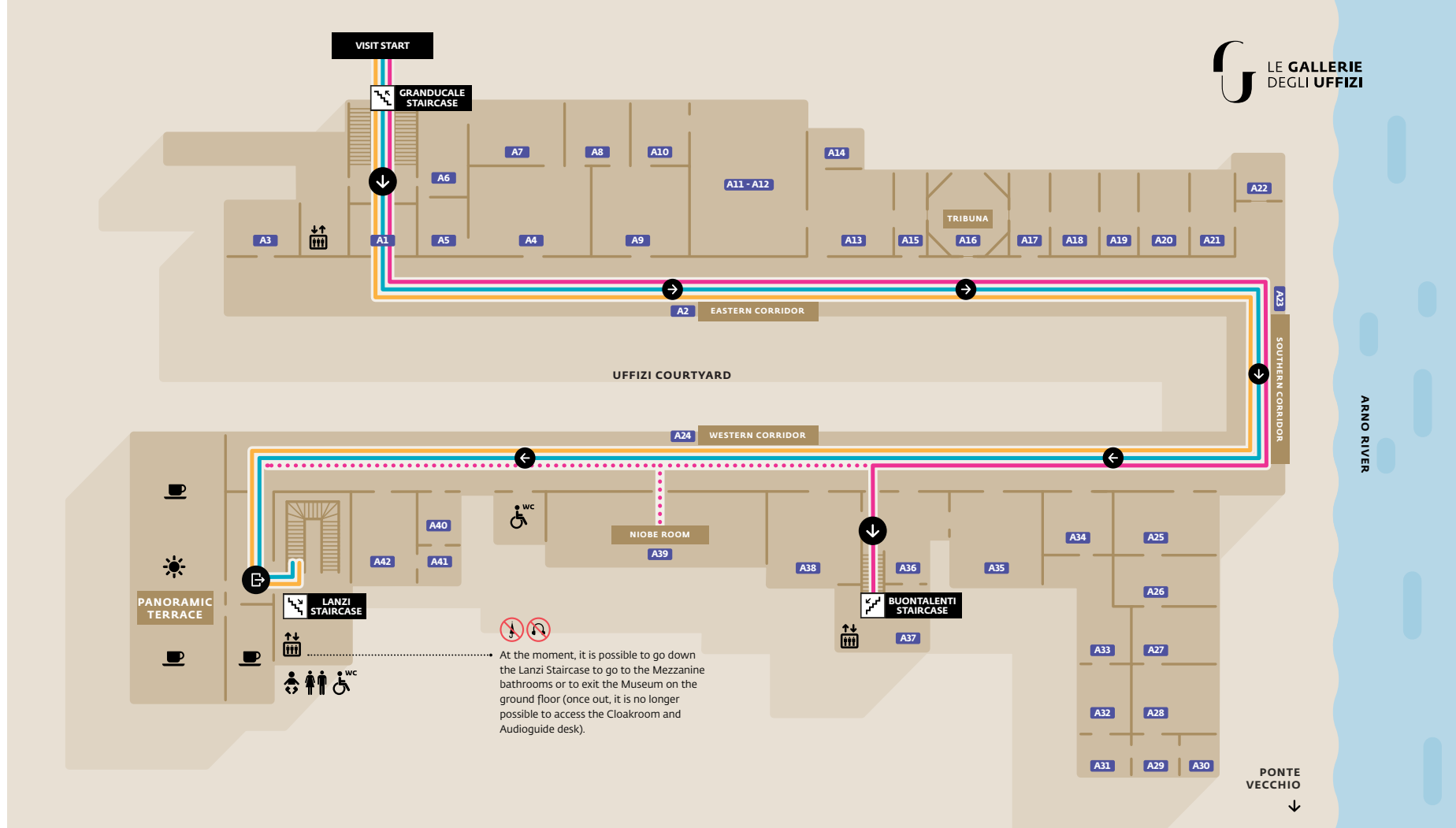

At the moment, it is possible to go down the Lanzi Staircase to go to the Mezzanine bathrooms or to exit the Museum on the ground floor (once out, it is no longer possible to access the Cloakroom and Audioguide desk).

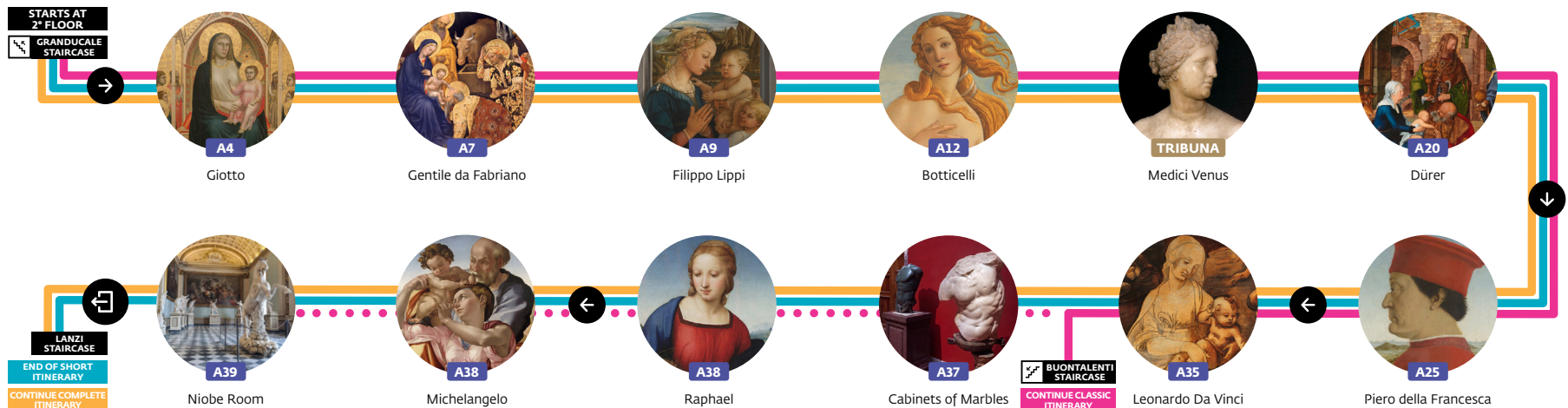

1 FIRST FLOOR

CONTINI BONACOSSÌ COLLECTION

- B1** Corridor
- B2** Sassetta, Andrea del Castagno
- B3** Gold ground paintings
- B4** Giovanni Bellini
- B5** Bramantino
- B6** Furniture
- B7** Majolica
- B8** Bernini

SELF-PORTRAITS COLLECTION

- C1** From the origins to the 17th century
- C2** Water and Light
- C3** 17th century
- C4** Showing the Artwork
- C5** Early 18th century
- C6** Late 18th century
- C7** Works on paper
- C8** Works on paper
- C9** 19th century
- C10** Early 20th century
- C11** Work in progress
- C12** Work in progress

16TH CENTURY

- D1** The 16th century in Lombardia
- D2** Dosso Dossi and his circle
- D3** Work in progress
- D4** Correggio and Parmigianino
- D5** Painters from Ferrara
- D6** The 16th century in Bologna
- D7** Sebastiano del Piombo and the influence of Michelangelo in Rome
- D8** Daniele da Volterra, Francesco Salviati
- D9** Plautilla Nelli Corridor
- D10** Work in progress
- D11** Work in progress
- D12** Pontormo, Rosso Fiorentino
- D13** Bachiaccia, The Florentine Portraits
- D14** Bronzino
- D15** Room of the Dynasties
- D16** Room of the Pillar
- D17** Classic tradition
- D18** Room of the Counter-Reformation Art
- D19** Giorgione
- D20** Venetian Small Chapel
- D21** El Greco
- D22** Antechamber of Venus
- D23** Tiziano, Venus of Urbino
- D24** Venetian Naturalism

- D25** Tintoretto
- D26** Veronese
- D27** Veronese Corridor
- D28** Verone

SEICENTO

- E4** Caravaggio (The Medusa), Artemisia
- E5** Caravaggio and the Caravaggeschi
- E6** Painting by Candlelight
- E7** Rembrandt, Rubens, Van Dyck

