

MARCH 2021

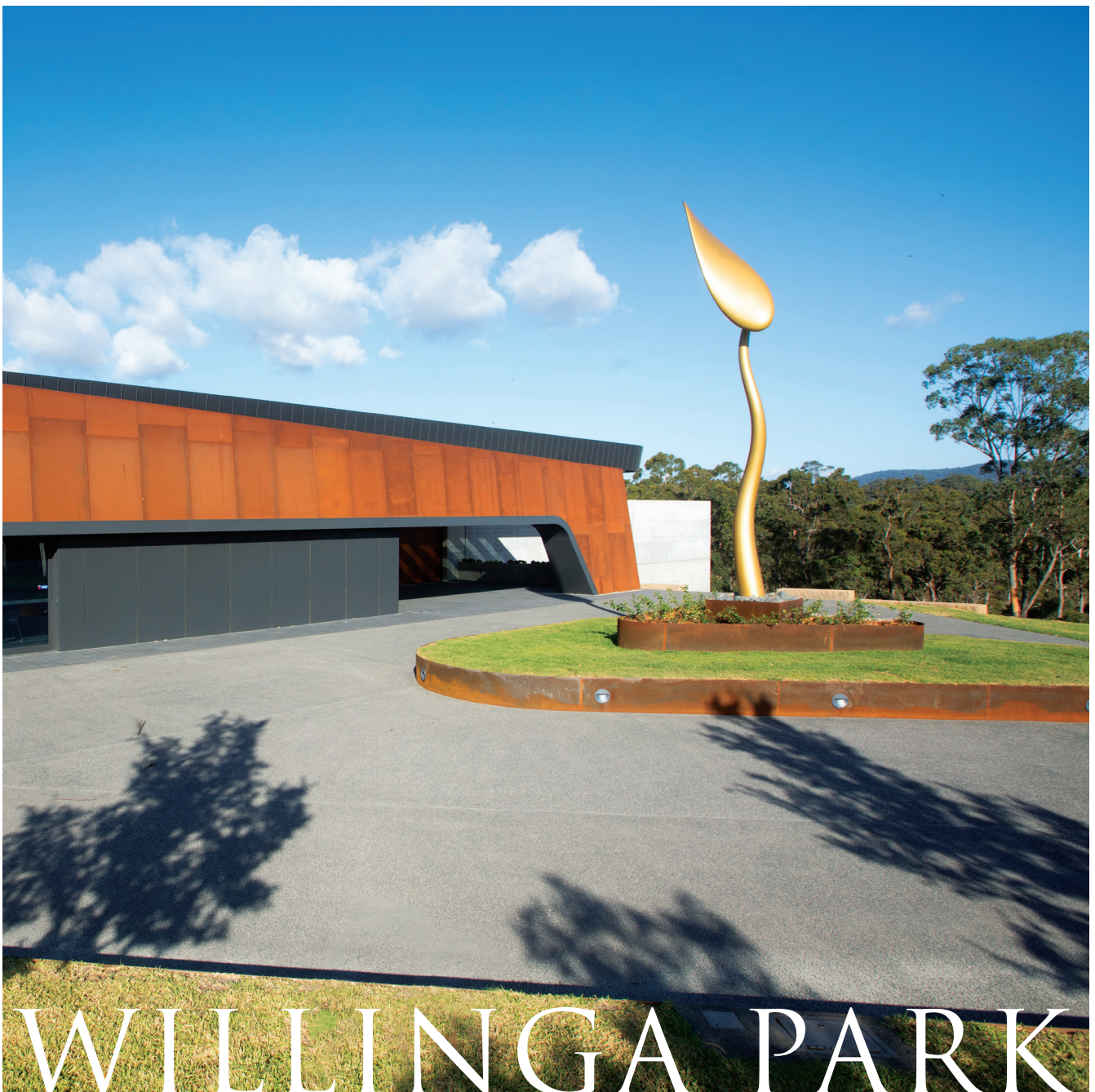

WILLINGA PARK

MEETINGS, CONFERENCES,  
EVENTS & ACCOMMODATION





Located on the picturesque South Coast of NSW, Willinga Park is one of Australia's leading equestrian centres, and an events destination renowned for exceptional quality and unique beauty.

Our conference centre, The Equine Education Centre, stands alongside our world-class equestrian facilities. This is a multi-purpose venue complimented by strikingly modern architecture, state-of-the-art audiovisual equipment, luxury accommodation and refined catering, all surrounded by unspoilt, natural landscapes. Proudly, the entire centre is powered by an award-winning solar system.

We hope to have the opportunity to welcome you to Willinga Park soon.

Renowned for  
exceptional quality  
and unique beauty,  
Willinga Park is  
set to inspire you.



## The Conference Hall.

The main feature of the Conference Centre is a breathtaking, architecturally-designed, 350sqm event hall. Featuring flexible layouts and fully-adaptable conferencing equipment, as well as options for staging and lighting, this exceptional space can host a range of events, from small to medium scale conferences, corporate retreats, meetings, functions and expos.

With floor-to-ceiling windows, opening to a 230sqm balcony and vast mountain views, this space will elevate your event and impress your delegates.

A private functions bar and restaurant is connected to the main hall with tailored catering and drinks packages available.

### FEATURES:

- Wifi
- 10m x 3.5m LED screen, plus two 3.6m x 1.4m secondary screens, all with wireless presentation capability
- Lectern
- Touch-control lighting
- Adamson IS7 sound system





## The Boardroom.



The Boardroom provides a sophisticated space to meet, collaborate and share ideas. It has the capacity for 20 people and the convenience of proximity to both the Conference Hall and our luxury, onsite accommodation.

With a 100-inch LED TV, HD video camera, superior audio reproduction utilising the latest audio tracking equipment, and all the requirements to 'plug and play' with your own laptop, the Boardroom is equipped for a very simple and seamless set up.

Our freestanding pavilions provide a luxurious retreat for delegates to enjoy privacy and comfort during their stay. There are 16 two-bedroom pavilions and two four-bedroom pavilions. All are self-contained, with spacious, elegant interiors and uninterrupted north-facing views of the surrounding natural landscape.

Each bedroom has an en-suite and pin code entry, providing flexibility to accommodate your numbers. Each pavilion has free Wi-Fi, a well-equipped kitchen, laundry facilities, and two parking spaces. Your delegates will re-energise between events with exclusive use of our on-site facilities.

A heated swimming pool, alfresco dining area, and barbecues are surrounded by meticulously landscaped gardens within close proximity to the pavilions. In conjunction to our onsite accommodation, we offer carefully-curated dining packages that celebrate local ingredients.

Further event accommodation options are offered next door at Interludes by Willinga Park. Set amongst peaceful surrounds, and beautifully decorated in designer coastal style, the modern villas will give your delegates the luxury of space whilst still fully immersed in your event.

## Sophisticated accommodation.





## Two bedroom pavilion.

Each pavilion offers a spacious 97 sqm of sophisticated luxury including a central open plan kitchen, dining and living space which flows seamlessly onto a northern sundeck. Two oversized bedrooms exude indulgence and comfort with a king bed and private ensuite.

### FEATURES:

- Inside: 97sqm
- Kitchen and laundry facilities
- Individual ensuite
- King bed and king single options
- 2 car parking spaces
- Complementary Wi-Fi



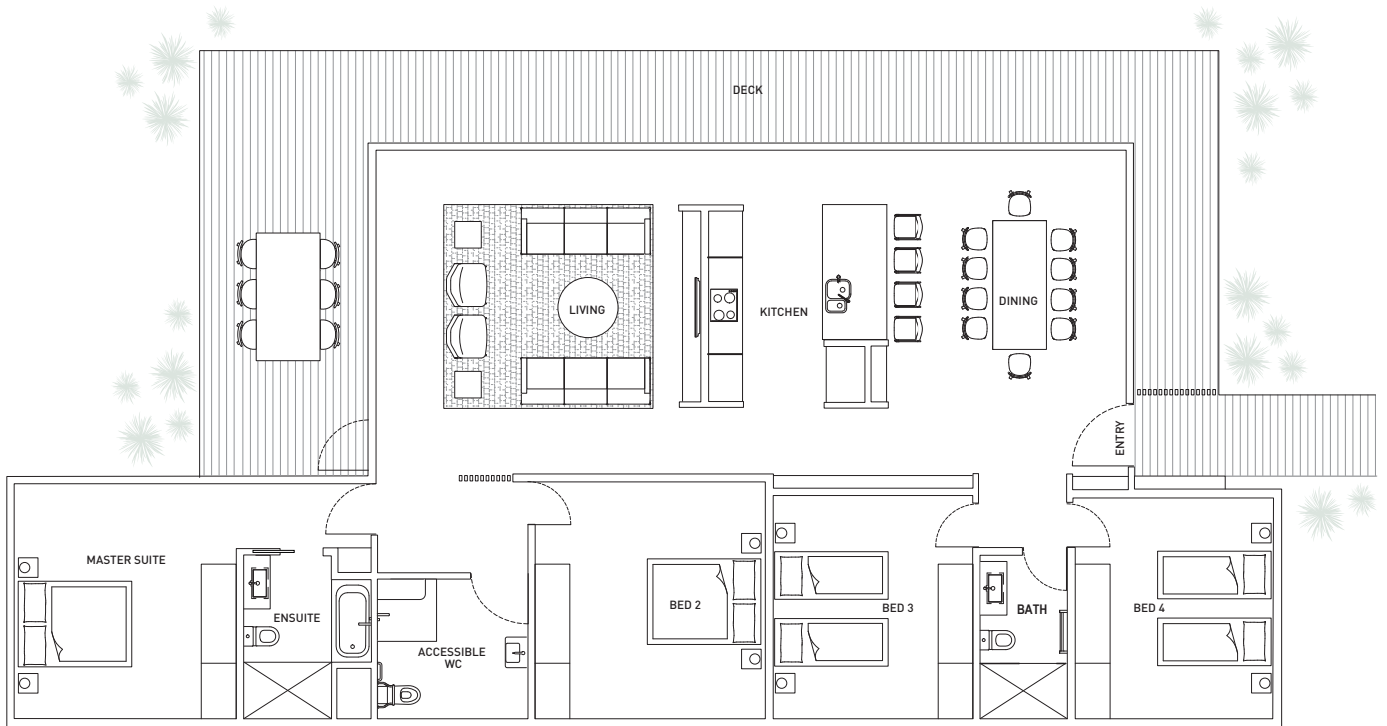

## Four bedroom pavilion.

The four bed pavilions are perfect for a larger delegate group, offering 200 sqm of refined luxury. An open plan kitchen, dining and living space is surrounded by an expansive outdoor deck with breathtaking northerly views. The oversized bedrooms provide flexibility with the option of a king bed or king single beds and are serviced by an ensuite and two additional bathrooms.

### FEATURES:

- Inside: 200sqm
- Outdoor Deck: 65sqm
- Kitchen and laundry facilities
- King bed and king single options
- 2 car parking spaces
- Complementary Wi-Fi



## Gardens and sculptures.

Adding to the already impressive conference facilities and accommodation are the Willinga Park botanical gardens, 10 acres of degraded grazing country that has been transformed into a vibrant natural wonderland. Featuring mostly native Australian plants, with water features throughout, it's a great space to disconnect and enjoy down time during your event.

Our permanent sculpture collection is also distributed throughout the gardens. With a variety of intriguing works by national and international sculptors, the collection will help inspire creativity and grand thinking.

### | Book a tour

One popular addition to our conference packages is a private tour of the grounds and sculptures. As well as the gardens, you will discover Willinga Park's sustainability features, such as our award-winning 500KW solar system and intricate dam and water-storage facilities.

The garden and sculpture tours provide a great space to disconnect and enjoy some down time during your event.





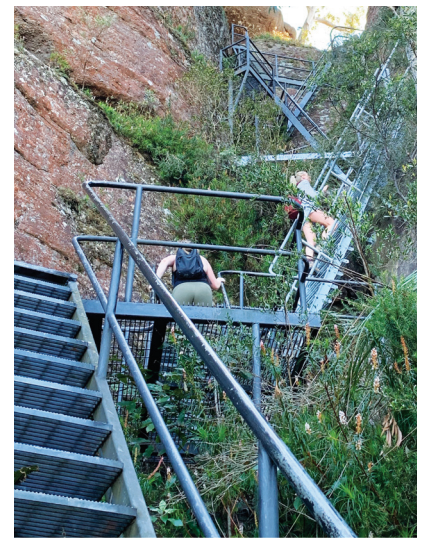

## At our doorstep.

Just 2.5 hours northeast of Canberra and 3.5 hours south of Sydney, Bawley Point is a jewel on the Shoalhaven coast and a playground for nature lovers. Sweeping sandy beaches, wild coastlines and unspoilt national parks are all within easy reach of Willinga Park.

Our remarkable locality provides an opportunity for your delegates to disconnect from the office, immerse themselves in nature and connect with purpose.

Through strong relationships with local providers, we can help create truly memorable, authentic experiences for your delegates. Wake up with morning yoga on the beach, hike mountain summits with knowledgeable local guides, learn about the area's rich indigenous history or marvel as our equestrian team demonstrate their horsemanship skills in the arena.

Whatever the purpose, we will tailor a bespoke package that sets your event up for success and makes the most of your time in our beautiful part of the world.

### | See & Do

#### Horse Demonstrations

From Dressage to Campdraft, watch world-class riders perform various disciplines of equine sport at a world-renowned equine facility.

#### Campfire Experience

Sit back and relax around a campfire, the perfect way to unwind after your days activities.

#### Yoga

Unwind and relax with a private yoga session set amongst the gorgeous Australian bush.

#### Murramarang National Park

Bushwalk some of the pristine 44km coastline and discover the ultimate spot to soak up some sun and explore the cliffs, headlands and pristine beaches of the NSW south coast.



## Contact us.

For more information, to arrange a site visit,  
or for a tailored quote, contact us at:

[conferences@willinga.com.au](mailto:conferences@willinga.com.au) | +61 2 4405 5660

