



Air purifier,
Humidifier

A&S 200 MEDIUM

User Manual



AIR ET SANTÉ
www.air-et-sante.fr

Dear customer,

AIR ET SANTÉ would like to thank you for the trust you place in its air purifiers. As all our attention is focused on your complete satisfaction, here are a few tips for use:

- Your purifier can be used continuously; in this case we recommend that you keep it in automatic mode, its smell detector will then control its autonomous functioning.
- Your purifier can be used in manual mode, so you can set it to strong airflow to quickly purify the air in your room, and then set it back to automatic mode.
- It also has a very powerful humidifier; do not forget to fill its water tank.

Your A&S 200 is optimal to purify an area of around 55 m². It has 6 stages of filtration:



- ❶ **Pre filter** : captures the smallest particles and protects the HEPA filter.
- ❷ **Medical grade HEPA filter**: 99.95% efficient on particles larger than or equal to 0.1 μm (PM2.5).
- ❸ **Activated carbon filter**: fixes and retains gaseous pollutants (volatile organic compounds).
- ❹ **Catalysis & photocatalysis**: transforms pollutants into carbon dioxide and water steam.
- ❺ **Photocatalysis and UV**: UV lamps activate titanium dioxide and degrade pollutants into carbon dioxide and water steams.
- ❻ **Negative ions**: charged (-) they aggregate with pollutants (+) and cause them to fall to the ground.



Tables of contents

Safety advice.....	1	UV lamps replacement	6
Precautions before first use.....	2	Water tank filling	6
Quick start	2	Water tank draining process.....	6
Regular maintenance.....	2	Smell detector update.....	6
Explanations of controls.....	3	Malfunctions	7
Remote control.....	4	Recycling.....	7
Filter's replacement.....	4	Maintenance.....	8

Safety Advice

- This model of air purifier is designed for domestic use. It is therefore not designed for industrial environments.
- Make sure to install the air purifier on a flat and stable surface. Leave at least 20 centimeters of space around it so that the air can circulate properly.
- Do not use your air purifier in humid, dusty environments, near heat sources or near flammable products or materials.
- Do not touch your air purifier with wet hands and do not allow any liquids to get into it.
- Never cover your air purifier. Never block any part of the air inlet and outlet vents.
- If you plan to stop the appliance for a long period of time, turn it off and unplug it.
- Before maintenance, cleaning or performing any other work on your air purifier, disconnect the power supply.
- If you are unsure whether your air purifier is working properly, unplug it before carrying out any other work.

- The warranty will be invalidated if it is used improperly or if safety rules are not followed.

Precautions before first use

- Place your air purifier on a flat and stable surface so that the air can circulate easily (minimum 20 cm all around).
- Do not place your air purifier behind curtains, under a window, under furniture, on a shelf, or near any other obstacle that may affect its proper functioning.
- Check the condition of the power outlet to which you wish to connect your air purifier.
- Your air purifier is not suitable for humid rooms such as bathrooms.
- Your air purifier does not replace a kitchen hood.

Quick Start

- Place the purifier on a dry and level surface, make sure the unit is stable.
- Plug in the electrical outlet. The unit goes into standby mode. The 5 air quality indicator LEDs flash red.
- Press ON/OFF, the control panel lights up and the display shows 00.
- Set the unit to automatic mode by pressing "SPEED" once.
- Thanks to its smell sensor, the purifier will adapt its functioning automatically.

Regular maintenance

To extend the lifecycle of your filters and to ensure optimal functioning of your air purifier, it is advised to periodically vacuum the pre-filter (blue). It is recommended to clean the interior and the grilles of the unit regularly.

Explanation of controls

Each time a button is activated, the corresponding icon appears on the control screen.



ON/OFF: power on/off of the device.



Speed: allows you to adjust the fan's running power by pressing the button successively. Three speeds are available: high, middle and low. By default, when the unit is turned on, the fan power is automatically adjusted according to the room air quality. The selected speed is indicated on the left side of the control panel.



Timer: the time button, activates the times and smell detector. The device automatically adjusts its functioning to the room air quality. The times can be set from 1 to 12h in one-hour intervals. The power turns off when the time is up.



Humidifier : enables to turn on or off the machine's vaporizer. In very dry environments, the water misting makes breathing easier. The power setting is adjusted by pressing the « Spray volume » button. The working power of the sprayer is visible at the bottom of the control panel.



Spray volume: allows to adjust the power of the water mister by successive presses.



Silent: in silent mode, the device automatically switches to low speed and deactivates the smell detector. Pressing the button again, all previous settings will restore.



Anion: switches on or off the ion generator.



Sterilize: activates the UV lamps (for germicides) .

- **Air quality indicator:** the 5 LED colors at the bottom of the control panel indicate the ambient air quality:

- Green: good air quality.
- Orange: medium air quality.
- Red: bad air quality.



Numerical display: indicates the scheduled times for the timer.

Remote control

The remote control allows to operate the air purifier remotely with the same commands as on the dashboard. For the first use, remove the film that covers the batteries.

Filter's replacement

When should I replace my filters?

The air quality indicator LEDs stay on, after 1900 hours of operation the time meter indicates that the filters may need to be replaced. This will depend on your environment and usage duration. The filters are designed to remain effective between 6 and 12 months.

The reduction in efficiency of your air purifier is, in any way, a sign that it is necessary to change the filters.

- **HEPA filter** (blue in front, white behind):
to change when its color has turned yellow, black, or rusty.
- **Activated carbon filter** (black in front, silver behind):
to change when its surface is dirty or has a dull color.

How to change the filters?

- Before any maintenance or cleaning of your air purifier, make sure to turn off the unit and unplug the outlet. Make sure you are in a ventilated room and that your hands are not wet.
- In order to ensure optimal performance of your air purifier, we encourage you to use only original filters. You can order them on www.air-et-sante.fr.
- Before replacing the filter pack, make sure you have the correct sized filters for your unit.

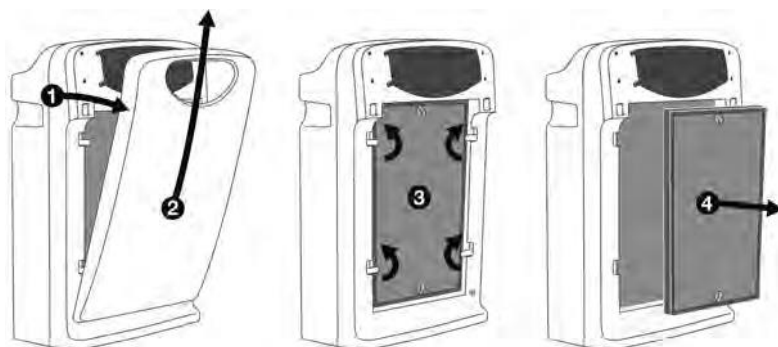

- 1- Remove the front cover of the device.
- 2- Open the four locks to release the used filters.
- 3- Remove, without shaking, the used filters. Place them in a bag, close it well before putting it in the trash (read p.7).
- 4- Place the new filters in place of the ones you removed, making sure to respect the order.
- 5- Close the four locks.
- 6- Put the front cover in place.

Reset the time counter

After replacing your filters, it is necessary to reset the time counter of your air purifier at 0, follow these steps:

- 1- Unplug the air purifier.
- 2- Press the power button for 3 to 5 seconds and then plug in (while still pressing the power button).
- 3- Release the on button after the fan has started.
- 4- Unplug the air purifier once again.
- 5- Wait 3 to 5 seconds and plug the purifier back into its power outlet. The time counter is reset to zero.

UV lamps replacement

This operation should only be performed by a qualified technician. For more information, visit www.air-et-sante.fr.

Filling the water tank

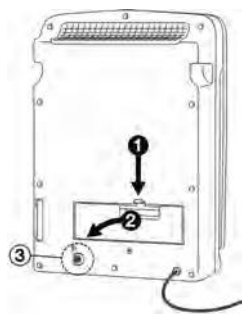

- 1- Remove the reservoir at the back of the machine by tilting it 45 degrees.
- 2- Unscrew the cap and fill it with clear water (any water is suitable).
- 3- Tighten the cap and replace the tank in its place.

Water tank draining process

It is possible to drain the water tank of the mister by pressing the drain at the back of the device (③ in the above illustration).

Smell detector update

If the air quality indicator remains red while the engine is off, it may be necessary to reset the smell detector memory:

- 1- After unplugging the unit for 20 seconds, plug it back in, turn it on, and press the "ANION" button.
- 2- Let the purifier run for 15 seconds then start again the operation.

Malfunctions

For any questions that are not covered in this manual, a dedicated service is available via our website at: www.air-et-sante.fr

The appliance does not start:

Verify the power supply.

The volume of air produced seems low:

Verify the cleanliness of the filters.

Make sure that the plastic protection films of the filters have been removed.

An alarm rings:

The water tank is empty.

Despite a long running time, the air quality does not improve:

Replace the filters.

Recycling

What to do with used filters?

When the filters are no longer in use, they do not present any danger to the inhabitants of the household or to the environment. However, when replacing them, it is preferable to put them in a garbage bag and tie it up tightly before throwing it with the regular garbage.

Recycling program AIR ET SANTÉ

Concerned about the environment, AIR ET SANTÉ ensures the recycling of the machines when they reach their life cycle. You will find on our website all the useful information to guarantee the optimal recycling of your machine.

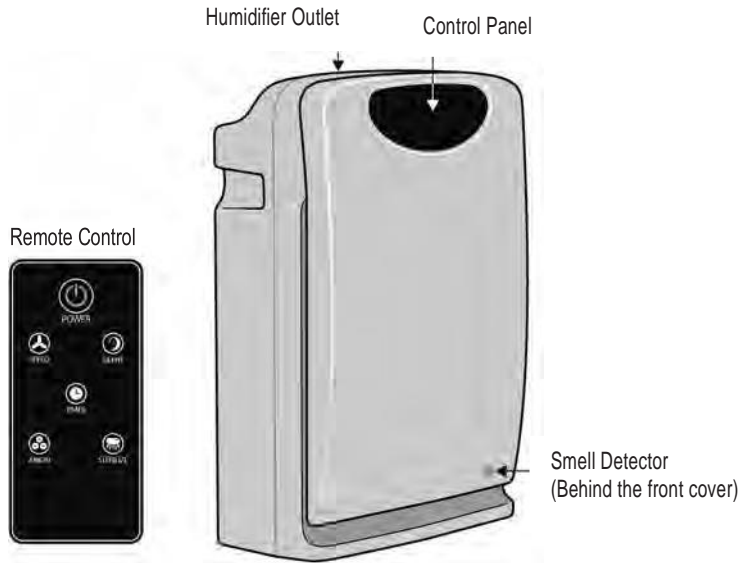

Health

Poor air quality affects your health.

We spend 80% of our time indoors (at home, at work...) where the air is up to 9 times more polluted than outside.

Poor air quality can cause symptoms such as headaches, fatigue, nose, throat and skin irritation, dizziness as well as allergic reactions and asthma.

In 30 years, the number of allergies has tripled, and the number of asthmatics has quadrupled reaching 20 to 25% of the population.

There are about 28,000 new cases of illnesses (asthma, rhinitis) per year linked to poor indoor air quality.

Contacts AIR ET SANTÉ:

Phone number: + 33 (0)9 72 64 67 16 from 9h00 to 18h00.

www.air-et-sante.fr by Email or chat and www.air-and-health.com

or

12



AIR ET SANTÉ - Manuel A&S 200

Technical specifications

Air purifier / Humidifier A&S-200

Dimensions:

Width..... 390 mm
Depth..... 206 mm
Height..... 580 mm
Weight..... 7 kg

Power supply V~240 V
50/60 Hz

Power consumptionPurifier 60 W
.....Humidifier 30 W

Noise level (dB):

High..... 42 dB
Medium..... 30 dB
Low..... 18 dB

Ventilation power:

High.....de 5,8 à 6,8 m/s
Mediumde 3,5 à 4,5 m/s
Low de 3,5 à 4,5 m/s
Maximum surface covered.....55 sqm
CADR..... 234 m³/h (for PM2.5)

Humidifier option:

Water tank..... 1200 ml
Sprayed volume
High..... 300 ml/h
Medium..... 200 ml/h
Low..... 130 ml/h



AIR ET SANTÉ
www.air-et-sante.fr



10-32-2667 / Certifié PEFC / pefc-france.org