



Rotisserie Grill

Instruction Manual



Item No. 34020

SAFETY INSTRUCTIONS



IMPORTANT: Read these instructions carefully before using this appliance and keep them for future reference.



Warning! Read all safety warnings and instructions. Failure to follow these may result in electric shock, fire and/or injury.

- If the supply cord is damaged it must only be repaired or replaced by a suitably qualified person.
- Do NOT position appliance where it can be reached by children.
- Extra caution is necessary when used near children or when left unattended.
- The appliance can be used by children aged 8 years and above and persons with reduced physical, sensory or mental capabilities or lack of knowledge and experience if they have been given supervision or instruction concerning the use of the appliance in a safe way and understand the hazards involved.
- Children must not play with the appliance.
- Cleaning and user maintenance by children must not be carried out without supervision.
- Children of less than 3 years should be kept away unless continually supervised.
- Children aged from 3 years and less than 8 years shall only switch the appliance on/off provided it has been installed in its intended normal operational position and they have been given supervision or instruction concerning the use of the appliance in a safe way and understand the hazards involved.
- Children from 3 years and less than 8 years shall not plug in, regulate or clean the appliance or carry out user maintenance of the appliance.
- This appliance is for household use only and not commercial or industrial use.
- Use this appliance only as described in this manual. Any other use is not recommended by the manufacturer and may cause fire, electric shock or injury.

- If the product or its supply cord is damaged do not use and consult a qualified person for repair or dispose of responsibly.
- Always unplug the appliance after use.
- Store the appliance out of reach of children when not in use.
- Store in a clean dry storage area when not in use.
- Always ensure any vents or outlets are clear from blockages which may impact on the products function or safe use.
- Always unplug this product from the mains by pulling on the plug not the power cable.
- Always unplug before cleaning.
- Only use a soft cloth with mild soapy water to clean this product. Do not submerge this product in water or any other liquid.
- Do not use the appliance for other than its intended use.
- The exterior of the grill will become very hot during use. Do not touch hot surfaces. Use the dials to adjust the time.
- Do not store or place any other items on top of the grill.
- To protect against electric shock, do not immerse cord, plug, or any parts of the grill in water or other liquids.
- The use of accessory attachments not recommended by the appliance manufacturer may cause hazard or injury.
- Do not use outdoors.
- Do not place on or near a hot gas or electric burner.
- Do not let the cord hang over the edge of table or counter, or touch hot surfaces, including the stove.
- When operating the grill keep at least four inches of space on all sides of the grill to allow for adequate air circulation.
- Unplug from outlet when not in use and before cleaning. Allow to cool before putting on or taking off parts, and before cleaning.
- To disconnect, turn the TIMER control to "Off", then remove the plug. Always hold the plug, never pull the cord.
- Extreme caution must be used when moving an appliance containing hot oil or other hot liquids.

COMPONENTS

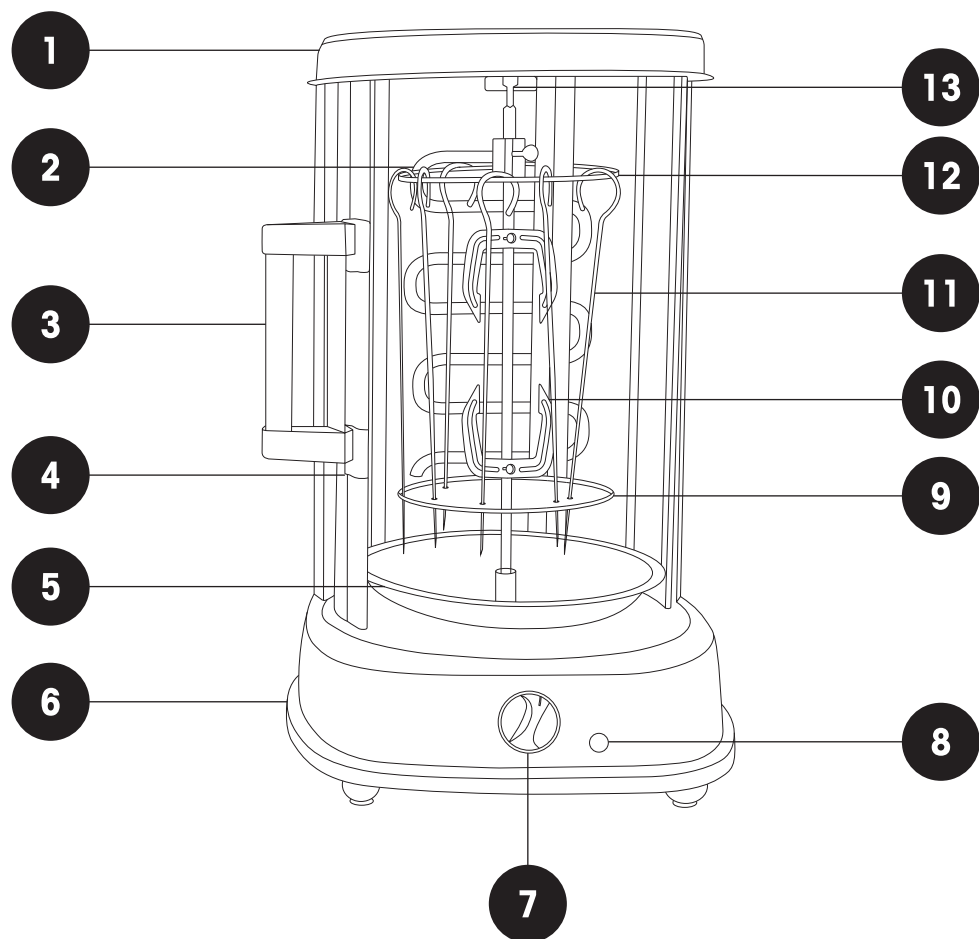

1. Lid
2. Heating Element
3. Handle
4. Glass Door
5. Drip tray
6. Base Unit
7. Timer Dial

8. Indicator Light
9. Bottom Support
10. Fork
11. Kebab Skewers
12. Upper Support
13. Rotisserie Spit

BEFORE FIRST USE

Place your grill on a level surface such as a counter top or table. Be sure the sides, back and top of the grill are at least four inches away from any walls, cabinets or objects on the counter or table. Remove all stickers from the grill. Remove Drip Tray, Rotisserie Spit, Forks, Kebab Set and wash them in warm, soapy water or in the dishwasher. Dry thoroughly before placing them into the grill.

Please Note: The door handle is removable, in order to let you take it out and clean the inside before using the grill, please follow the instruction picture to assemble the handle by yourself.

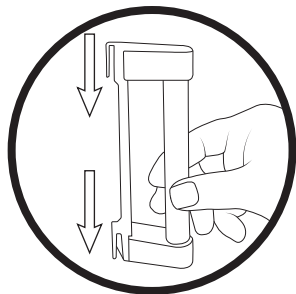

When you are ready to use the grill, be sure that the TIMER Control is in the "Off" position and unplugged. We recommend a trial run to familiarize yourself with your grill and to eliminate any protective substance or oil that may have been used for packing and shipping. Plug the cord into a 220-240 volt AC outlet (according to your country standard). Set the TIMER Control to "20" minutes. A small amount of smoke and odour may be detected, it is normal. To avoid scratching, marring, discolouration or fire hazard, do not store anything on the top of the grill, especially during operation.

USING THE APPLIANCE FOR ROTISSERIE

Caution: Appliance surfaces are hot during and after use! Do not place anything on the top of this appliance. Always wear protective, insulated oven mitts when handling, inserting or removing items from the hot grill. Never attempt to use your Rotisserie without the drip tray in place.

NOTE: The grill will never start before you close the door well and the inner light is off.

1. Place one rotisserie fork on the end of the rotisserie spit opposite the point with the tines facing the centre and tighten the screw slightly.
2. Slide the pointed end of the rotisserie spit through the centre of the food to be cooked.
3. Place the other rotisserie fork on the other end of the rotisserie spit with the tines facing the roast.
4. Adjust the roast so that it is centred on the rotisserie spit. Make sure the forks are secure on the roast and on the spit and tighten the screws.
5. When cooking poultry, it may be necessary to secure legs and wings to the body with butchers twine to make the roast as compact as possible for smooth movement of the rotisserie spit.
6. Season or baste the roast as desired.
7. **IMPORTANT!** Place the round drip tray into the receptacle at the bottom of the grill to catch the drippings.
8. Put the solid end of the rotisserie spit in the drive socket on located in the centre of the drip tray.

9. Place the grooved end on the spit support on located on the top interior of the grill.

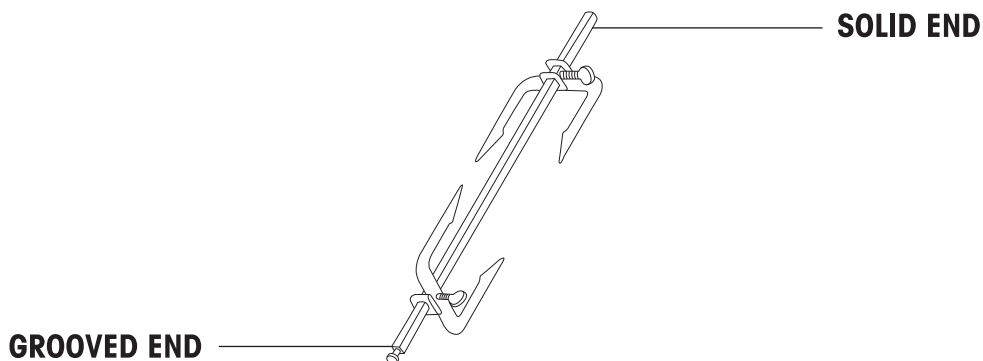

10. Close the glass door and the inner light will go off automatically.
11. Set the TIMER Control to the time according to recipe.
12. When the roast is done, turn the TIMER Control to "Off" and unplug the grill.
- Caution: The grill sides and top are hot, use oven mitts or temperature resistant gloves when removing the chicken. You can also use a carving fork and set of tongs to remove the roast**

13. Remove the rotisserie from the top by lifting up and out towards you. Pull the bottom part of the spit out of the drip tray receptacle and place onto a carving station.
14. Place the roast on a cutting board or platter and allow standing for 10-15 minutes, this allows the juices to redistribute throughout the roast making for a moister, flavourful roast.
15. Using a pot holder, loosen the screws on the rotisserie forks and remove the rotisserie spit from the roast. Carefully remove the rotisserie forks and carve the roast.

USING THE APPLIANCE FOR KEBAB

Caution: Appliance surfaces are hot during and after use! Do not place anything on the top of this appliance. Always wear protective, insulated oven mitts when handling, inserting or removing items from the hot grill. Never attempt to use your Rotisserie without the drip tray in place.

NOTE: The grill will never start before you close the door well and the inner light is off.

1.

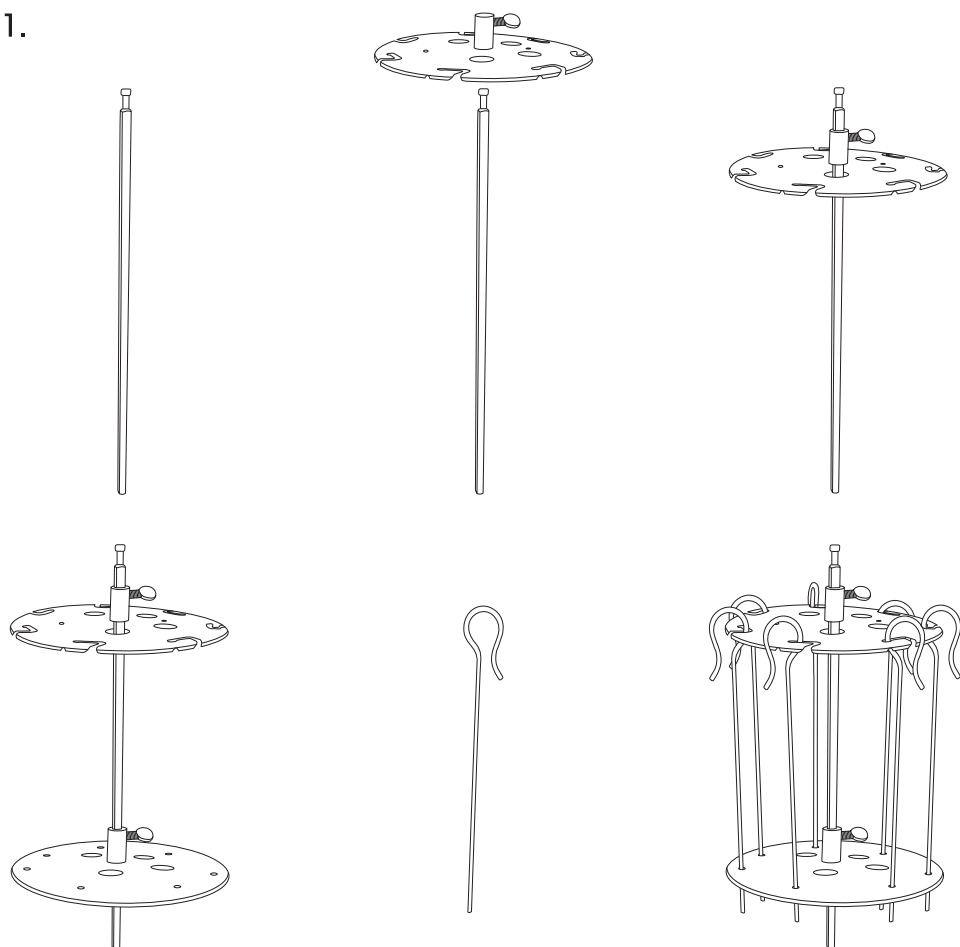

2. Place the round drip tray into the receptacle at the bottom of the grill to catch the drippings.
3. Put the solid end of the rotisserie spit in the drive socket on located in the centre of the drip tray.
4. Place the grooved end on the spit support on located on the top interior of the grill.
5. Close the glass door well and the inner light will be off automatically.
6. Set the TIMER Control to the time according to recommended Recipe.
7. When the roast is done, turn the TIMER Control to "Off" and unplug the grill.

CAUTION: The grill sides and top are hot, use oven mitts or temperature resistant gloves when removing the kebabs.

Recipe references (Approximate only – depends on size of food and your preference).

1. Chicken/Duck: 30~45 minutes approx.
2. Steak: 45~60 minutes approx.
3. Kebab: 20~30 minutes approx.
4. Fish: 20~32 minutes approx.
5. Vegetable: 15~20 minutes approx.

CLEANING

- Turn the TIMER Control to “Off” and unplug before cleaning.
- Allow the grill and all accessories to cool completely before cleaning.
- Clean the outside of the grill with a damp cloth and dry thoroughly. Clean stubborn stains with a non-abrasive liquid cleaner. Do not use metal scouring pads or abrasive cleaners that will scratch the surface.
- Clean the glass door with a cloth or sponge dampened with warm, soapy water and dry thoroughly.
- Wash the drip tray in hot, sudsy water or in the dishwasher. Clean stubborn stains with a nylon or polyester mesh pad and a mild, non-abrasive cleaner. Rinse and dry thoroughly.
- If crumbs and spills have accumulated on the bottom of the grill wipe with a damp cloth and dry thoroughly.
- The walls on the inside of the grill allow food particles or spatters during use to be easily wiped clean. Remove heavy spatter after use with a nylon or polyester mesh pad, sponge or cloth dampened with warm water. Blot dry with a paper towel or soft, dry cloth.
- The Rotisserie spit and forks (without screws attached) and kebab set can be placed in the dishwasher or washed in warm soapy water. Hand wash the screws in warm soapy water and dry thoroughly.

PLUG

- This appliance has been fitted with a BS UK compliant plug which should not be replaced or removed.
- The plug is fitted with UK compliant fuse link which is suitable for this type of appliance and should only be replaced by a fuse link of the same rating.
- If access to the fuse link is only possible by removing the plug cover this must only be done by a suitably qualified person.
- If the plug or the mains cable of this appliance is damaged do not use and dispose of the appliance responsibly.
- This appliance is earthed.



Information on Waste Disposal for Consumers of Electrical & Electronic Equipment



This symbol indicates that this product should not be treated as normal household waste and it should be recycled. Please take it to your nearest collection facility or for further details contact your local council or visit www.recycle-more.co.uk.



Importer UK: Benross Marketing Ltd, Liverpool L24,9HJ
Importer EU: Benross Marketing Ltd, Italeiei 1-2000 Antwerp Belgium.
Consumer Services: E: afterservice@benross.com. T: +441518327600.
Made in P.R.C.