

Views and ground plan - Ansichten und Grundriss - Fasader och grundplan  
 - Vues et plan au sol

Back wall-Hintere Wand-Vägg baksida-Paroi arrière

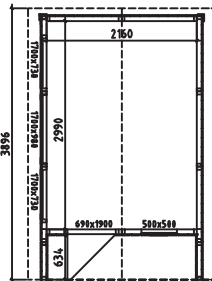

Left SideWall-Linke Seitenwand  
Vänster Vägg-Paroi latérale gauche

Right sideWall - Rechte Seitenwand  
Höger vägg - Paroi latérale droite

Front wall - Vordere Wand - Vägg Framsida - Paroi avant

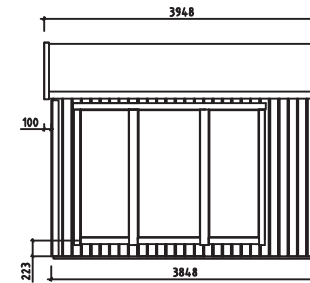

View from inside - Ansicht von Innen - Från insidan - Vue depuis l'intérieur

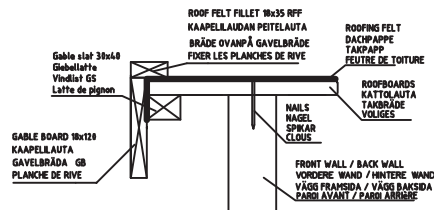
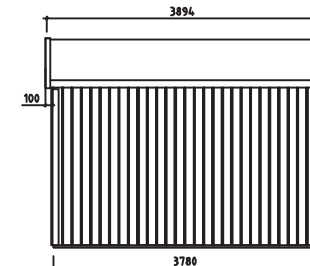
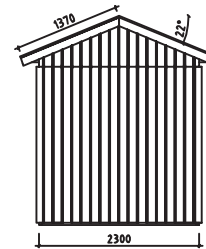
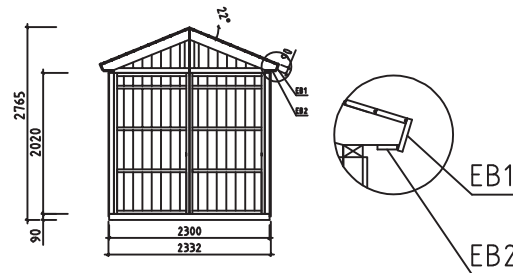

V 1.0



House	S3523-16-MARKKO	Sheet	1
Drawing		Scale	1:100
Material		Date	15.04.2024
Drawer	K.K.	File	S3523-16-MARKKO.dwg

Overview description of the manual - Übersichtsbeschreibung des Handbuchs - Översikts beskrivning för montering - Description générale du manuel

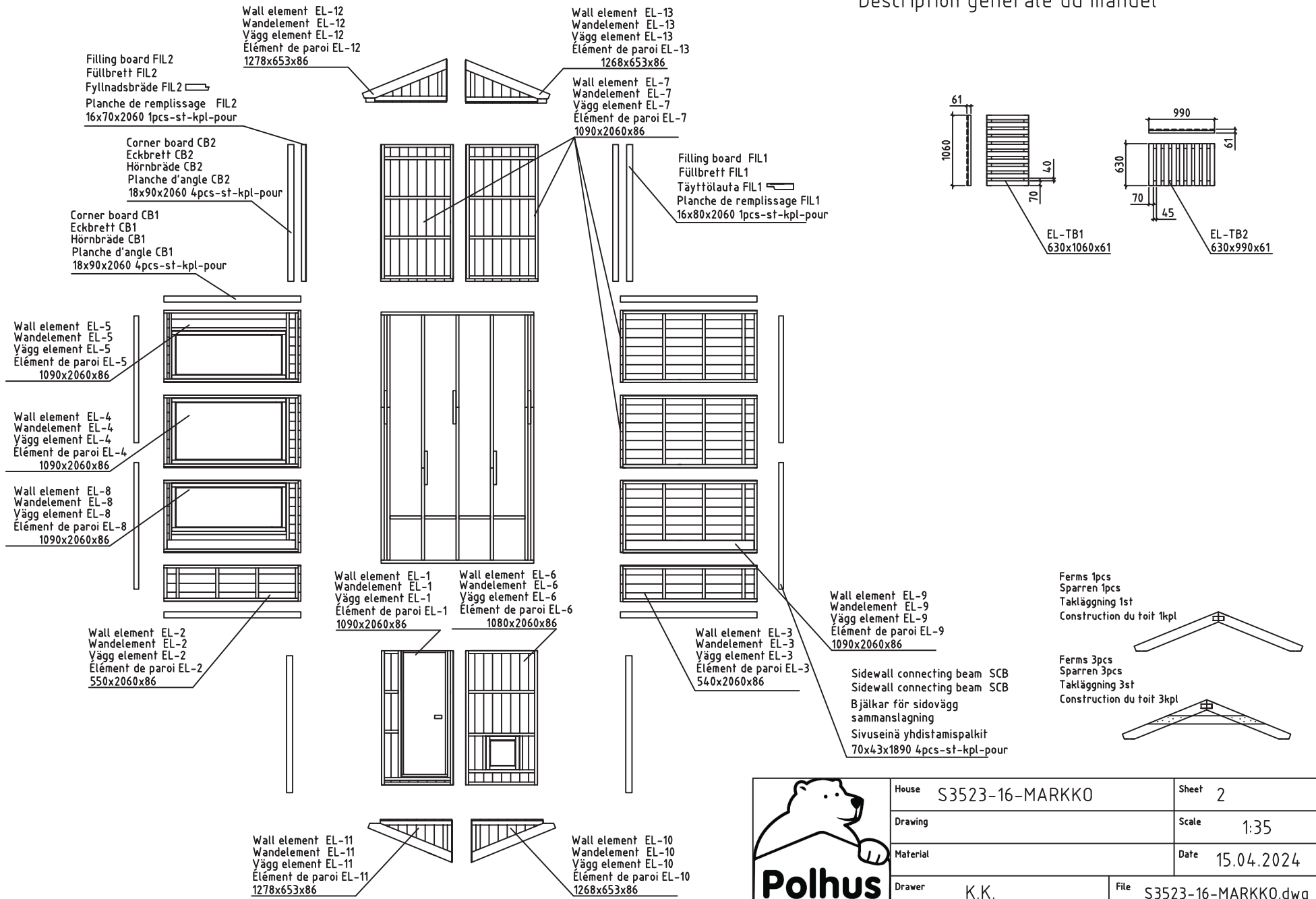

	House	S3523-16-MARKKO	Sheet	2
	Drawing		Scale	1:35
	Material		Date	15.04.2024
	Drawer	K.K.	File	S3523-16-MARKKO.dwg

Installation of floorbeams and floorboards - Installation von Bodenbalken und Bodenbrettern  
 Montering av golvbjälkar samt golv brädor - Installation des poutres de plancher et des planches de sol

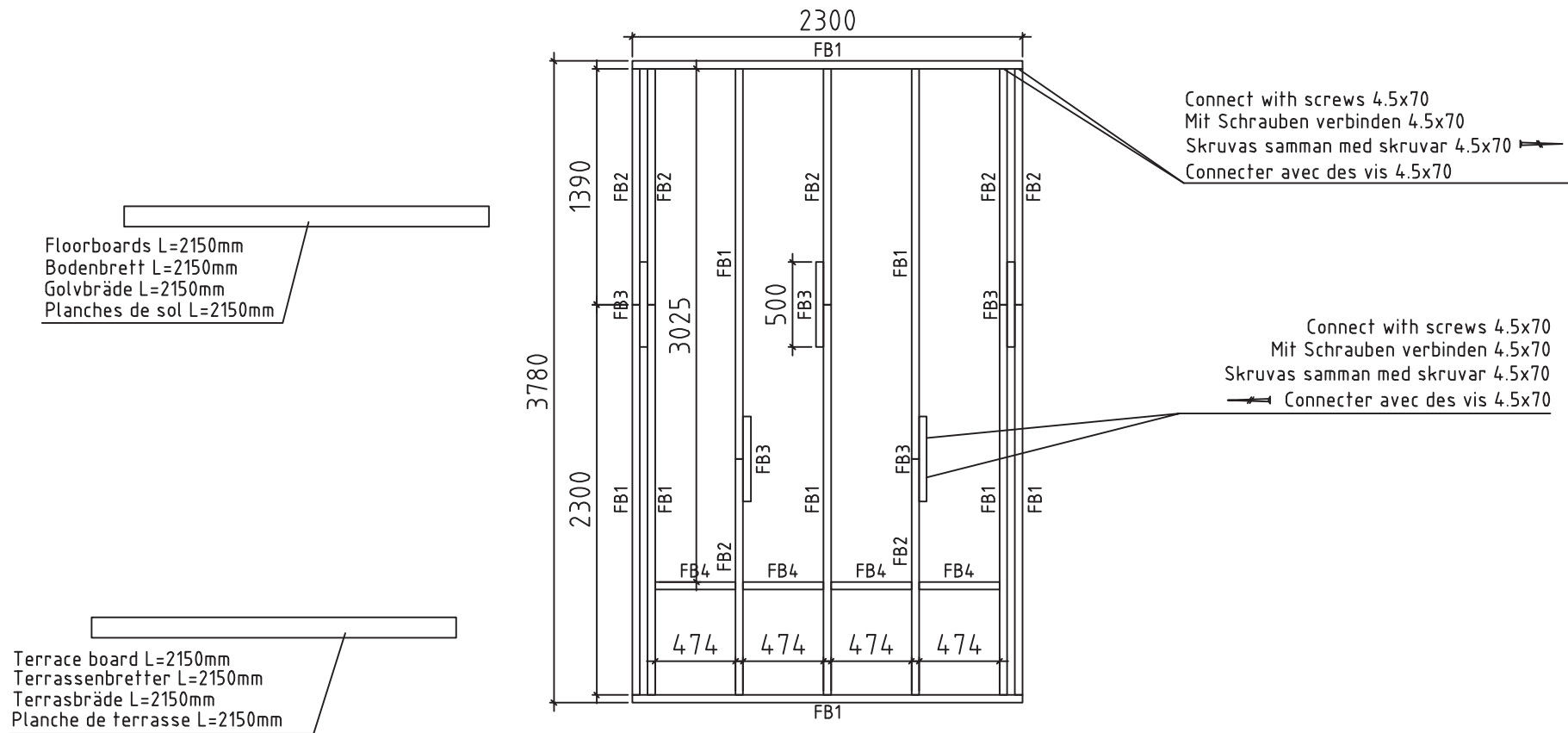

NB!!! Change the floorboard positions after every row  
 NB!!! Ändern Sie die Positionen der Bodenbretter nach jeder Reihe  
 NB!!! Skarva golv brädorna olika efter varje rad  
 NB!!! Changer les positions des planches de sol après chaque rangée



House	S3523-16-MARKKO	Sheet	3
Drawing	Floorbeams-lattiapalkit-golvbjälkar	Scale	1:35
Material	45x90	Date	15.04.2024
Drawer	K.K.	File	S3523-16-MARKKO.dwg

Installation of wall element EL-7 - Installation des Wandelemente EL-7 - Montering av vägg element EL-7 - Installation de l'élément de paroi EL-7  
 (Front wall - Vordere Wand - Vägg framsida - Paroi avant)

View from inside - Blick von innen - Från insidan - Vue de l'intérieur

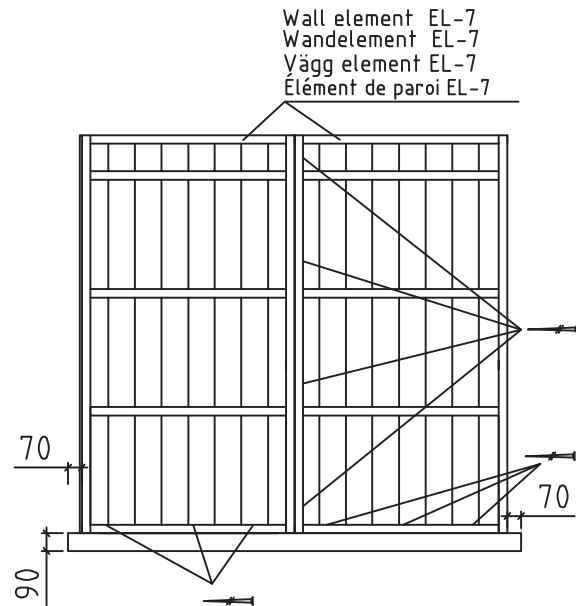

Wall element EL-7  
 Wandelement EL-7  
 Vägg element EL-7  
 Élément de paroi EL-7

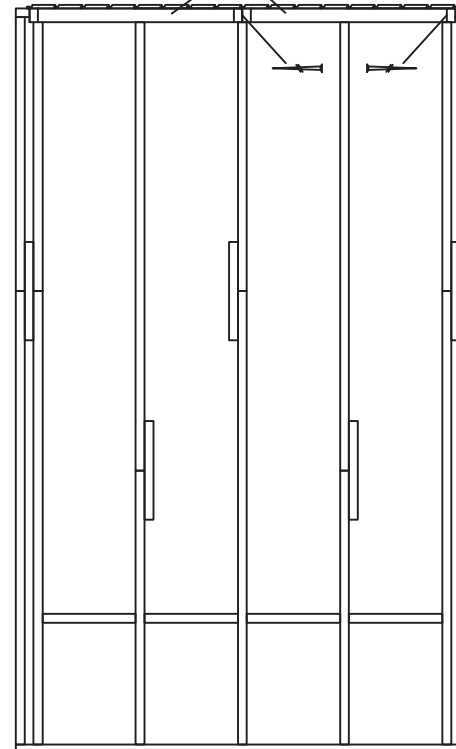

Fix wall element EL-7 with screws 4.5x70 into floorbeam  
 Befestigen Sie das Wandelement EL-7 mit Schrauben 4.5x70 am Bodenbalken  
 Fixera vägg element EL-7 med skruvar 4.5x70 i golvbjälke  
 Fixer l'élément de paroi EL-7 avec des vis 4.5x70 la poutre de plancher

Fix wall elements EL-7 and EL-7 with screws 4.5x70 together  
 Befestigen Sie das Wandelement EL-7 und EL-7 mit Schrauben 4.5x70 zusammen  
 Fixera vägg element EL-7 och EL-7 med skruvar 4.5x70 tillsammans  
 Fixer l'élément de paroi EL-7 et EL-7 avec des vis 4.5x70 ensemble



House	S3523-16-MARKKO	Sheet	4
Drawing		Scale	1:35
Material		Date	15.04.2024
Drawer	K.K.	File	S3523-16-MARKKO.dwg

Installation of wall element EL-7, EL-9 and EL-3 - Installation des Wandelements montering EL-7, EL-9 und EL-3

av vägg element EL-7, EL-9 och EL-3 - Installation de l'élément de paroi EL-7, EL-9 et EL-3

(Right sidewall - Rechte Seitenwand - Vägg framsida - Paroi latérale droite)

View from inside - Blick von innen - Från insidan - Vue de l'intérieur

Wall element EL-7  
Wandelement EL-7  
Vägg element EL-7  
Élément de paroi EL-7

Wall element EL-9  
Wandelement EL-9  
Vägg element EL-9  
Élément de paroi EL-9

Wall element EL-3  
Wandelement EL-3  
Vägg element EL-3  
Élément de paroi EL-3

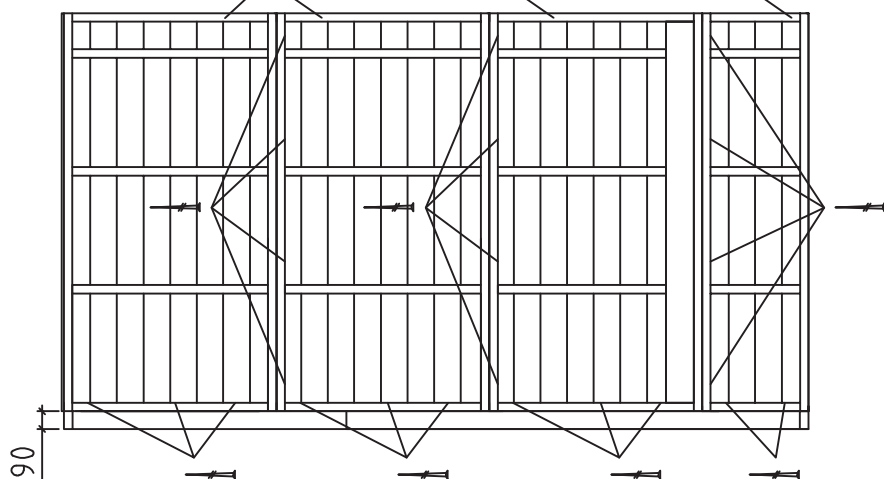

Wall element EL-7  
Wandelement EL-7  
Vägg element EL-7  
Élément de paroi EL-7

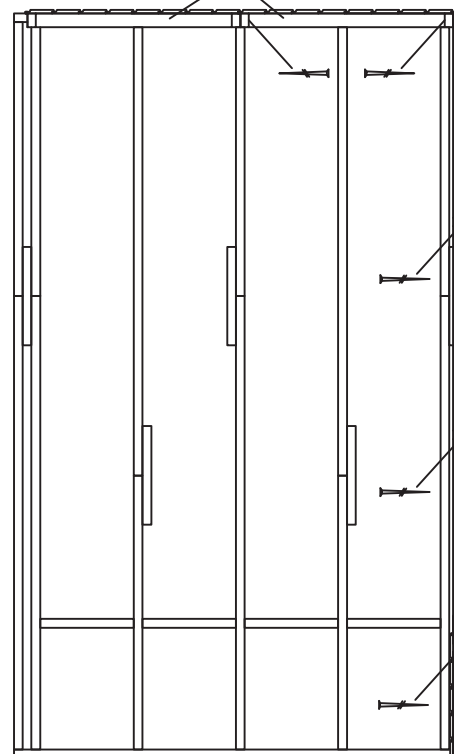

Wall element EL-7  
Wandelement EL-7  
Vägg element EL-7  
Élément de paroi EL-7

Wall element EL-9  
Wandelement EL-9  
Vägg element EL-9  
Élément de paroi EL-9

Wall element EL-3  
Wandelement EL-3  
Vägg element EL-3  
Élément de paroi EL-3

Fix wall element EL-7, EL-9 and EL-3 with screws 4.5x70 into floorbeam  
Befestigen Sie das Wandelement EL-7, EL-9 und EL-3 mit Schrauben 4.5x70 am Bodenbalken  
Fixera vägg element EL-7, EL-9 och EL-3 med skruvar 4.5x70 i golvbjälke  
Fixer l'élément de paroi EL-7, EL-9 et EL-3 avec des vis 4.5x70 la poutre de plancher

Fix wall elements EL-7, EL-9 and EL-3 with screws 4.5x70 together  
Befestigen Sie das Wandelement EL-7, EL-9 und EL-3 mit Schrauben 4.5x70 zusammen  
Fixera vägg element EL-7, EL-9 och EL-3 med skruvar 4.5x70 tillsammans  
Fixer l'élément de paroi EL-7, EL-9 et EL-3 avec des vis 4.5x70 ensemble



House	S3523-16-MARKKO	Sheet	5
Drawing		Scale	1:35
Material		Date	15.04.2024
Drawer	K.K.	File	S3523-16-MARKKO.dwg

Installation of wall element EL-1 and EL-6 - Installation des Wandelemente montage EL-1 und EL-6  
 av vägg element EL-1 och EL-6 - Installation de l'élément de paroi EL-1 et EL-6

(Front wall - Vordere Wand - V ägg framsida - Paroi avant)

View from inside - Blick von innen - Från insidan - Vue de l'intérieur

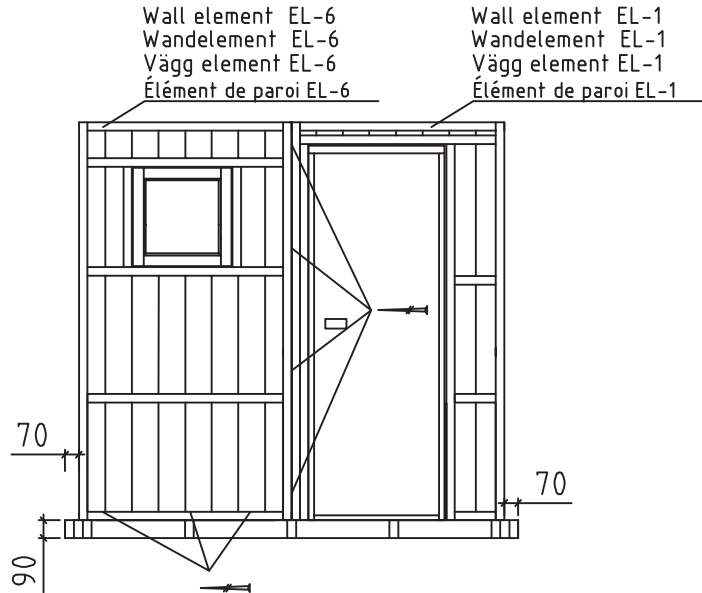

Fix wall element EL-1 and EL-6 with screws 4.5x70 into floorbeam  
 Befestigen Sie das Wandelement EL-1 und EL-6 mit Schrauben 4.5x70 am Bodenbalken  
 Fixera vägg element EL-1 och EL-6 med skruvar 4.5x70 i golvbjälke  
 Fixer l'élément de paroi EL-1 et EL-6 avec des vis 4.5x70 la poutre de plancher

Fix wall elements EL-1, EL-6 and EL-9 with screws 4.5x70 together  
 Befestigen Sie das Wandelement EL-1, EL-6 und EL-9 mit Schrauben 4.5x70 zusammen  
 Fixera vägg element EL-1, EL-6 och EL-9 med skruvar 4.5x70 tillsammans  
 Fixer l'élément de paroi EL-1, EL-6 et EL-9 avec des vis 4.5x70 ensemble

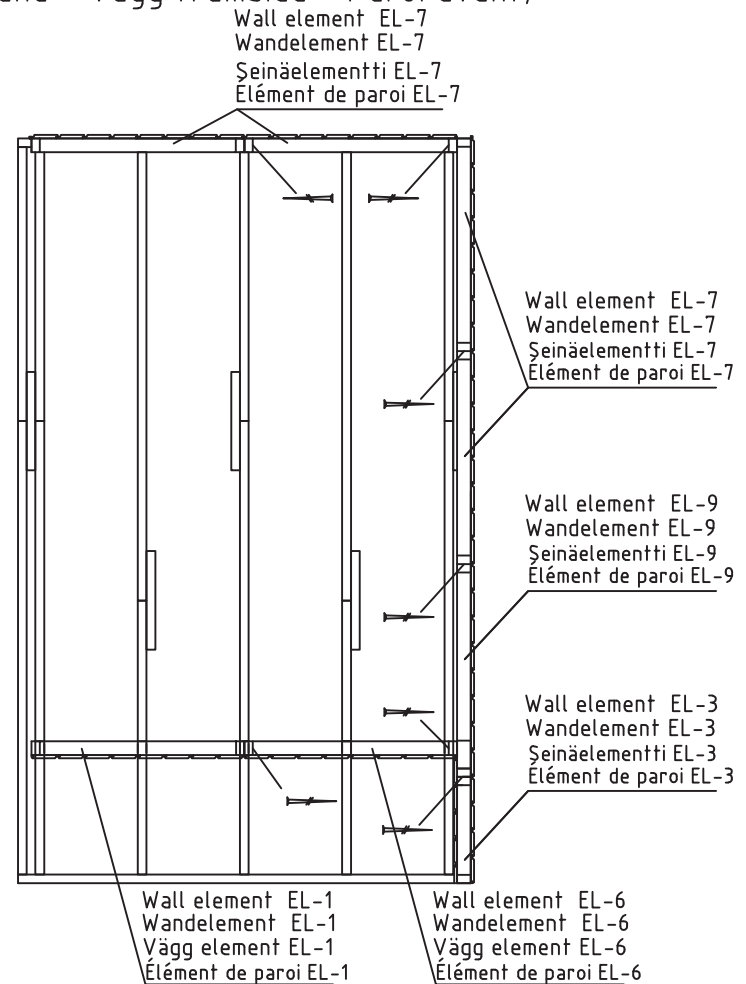

House	S3523-16-MARKKO	Sheet	6
Drawing		Scale	1:35
Material		Date	15.04.2024
Drawer	K.K.	File	S3523-16-MARKKO.dwg

Installation of wall element EL-2, EL-4, EL-5, EL-8 - Installation des Wandelemente montage EL-2, EL-4, EL-5, EL-8  
 av vägg element EL-2, EL-4, EL-5, EL-8 - Installation de l'élément de paroi EL-2, EL-4, EL-5, EL-8

(Left Sidewall-Linke Seitenwand - Vänster Vägg-Paroi latérale gauche)

View from inside - Blick von innen-Från insidan - Vue de l'intérieur

Wall element EL-2  
Wandelement EL-2  
Vägg element EL-2  
Élément de paroi EL-2

Wall element EL-8  
Wandelement EL-8  
Vägg element EL-8  
Élément de paroi EL-8

Wall element EL-4  
Wandelement EL-4  
Vägg element EL-4  
Élément de paroi EL-4

Wall element EL-5  
Wandelement EL-5  
Vägg element EL-5  
Élément de paroi EL-5

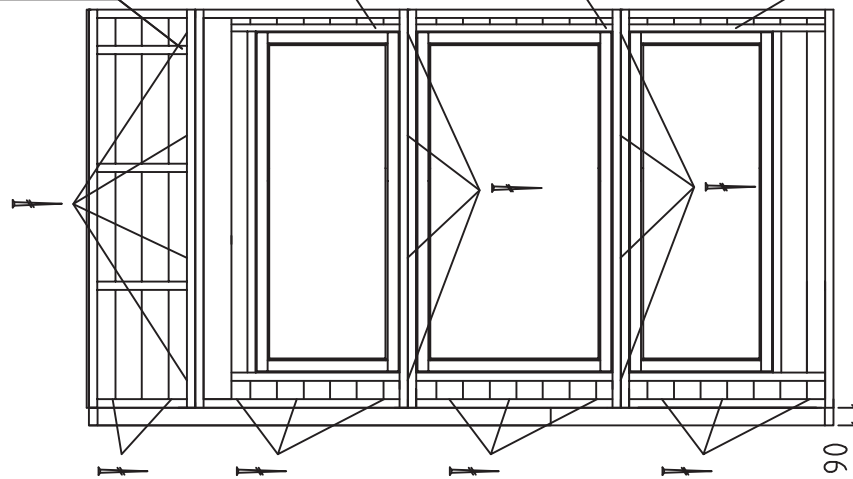

Wall element EL-5  
Wandelement EL-5  
Seinäelementti EL-5  
Élément de paroi EL-5

Wall element EL-4  
Wandelement EL-4  
Seinäelementti EL-4  
Élément de paroi EL-4

Wall element EL-8  
Wandelement EL-8  
Seinäelementti EL-8  
Élément de paroi EL-8

Wall element EL-2  
Wandelement EL-2  
Seinäelementti EL-2  
Élément de paroi EL-2

Wall element EL-7  
Wandelement EL-7  
Seinäelementti EL-7  
Élément de paroi EL-7

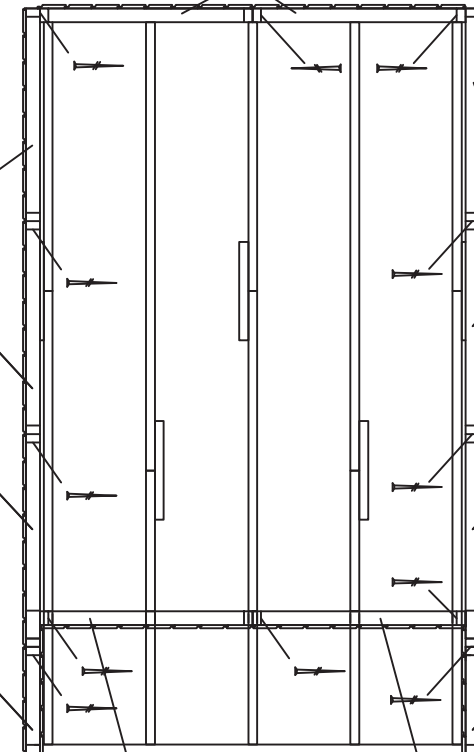

Wall element EL-7  
Wandelement EL-7  
Seinäelementti EL-7  
Élément de paroi EL-7

Wall element EL-9  
Wandelement EL-9  
Seinäelementti EL-9  
Élément de paroi EL-9

Wall element EL-3  
Wandelement EL-3  
Seinäelementti EL-3  
Élément de paroi EL-3

Wall element EL-1  
Wandelement EL-1  
Vägg element EL-1  
Élément de paroi EL-1

Wall element EL-6  
Wandelement EL-6  
Vägg element EL-6  
Élément de paroi EL-6

Fix wall element EL-2, EL-4, EL-5, EL-8 with screws 4.5x70 into floorbeam  
 Befestigen Sie das Wandelement EL-2, EL-4, EL-5, EL-8 mit Schrauben 4.5x70 am Bodenbalken  
 Fixera vägg element EL-2, EL-4, EL-5, EL-8 med skruvar 4.5x70 i golvbjälke  
 Fixer l'élément de paroi EL-2, EL-4, EL-5, EL-8 avec des vis 4.5x70 la poutre de plancher

Fix wall elements EL-1, EL-2, EL-4, EL-5, EL-8 with screws 4.5x70 together  
 Befestigen Sie das Wandelement EL-1, EL-2, EL-4, EL-5, EL-8 mit Schrauben 4.5x70 zusammen  
 Fixera vägg element EL-1, EL-2, EL-4, EL-5, EL-8 med skruvar 4.5x70 tillsammans  
 Fixer l'élément de paroi EL-1, EL-2, EL-4, EL-5, EL-8 avec des vis 4.5x70 ensemble



House	S3523-16-MARKKO	Sheet	7
Drawing		Scale	1:35
Material		Date	15.04.2024
Drawer	K.K.	File	S3523-16-MARKKO.dwg

Installation of sidewall connecting beams - Installation der Seitenwandverbindungsbalke  
 Montering av bjälkar för sidovägg sammanslagning - Installation des poutres de liaison de paroi latérale

Screws 4.5x70 4pcs  
 Schrauben 4.5x70 4st  
 Skruvar 4.5x70 4st  
 Vis 4.5x70 4pour

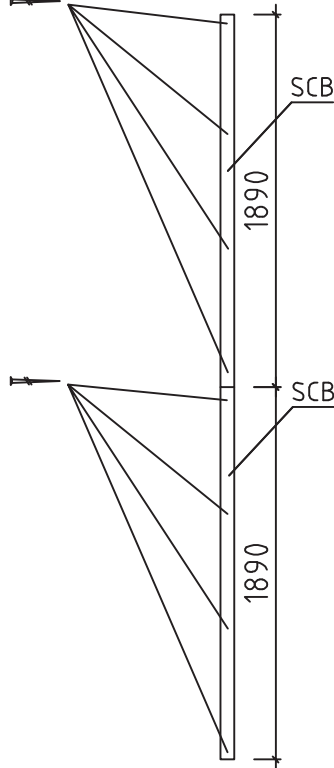

Screws 4.5x70 4pcs  
 Schrauben 4.5x70 4st  
 Skruvar 4.5x70 4st  
 Vis 4.5x70 4pour

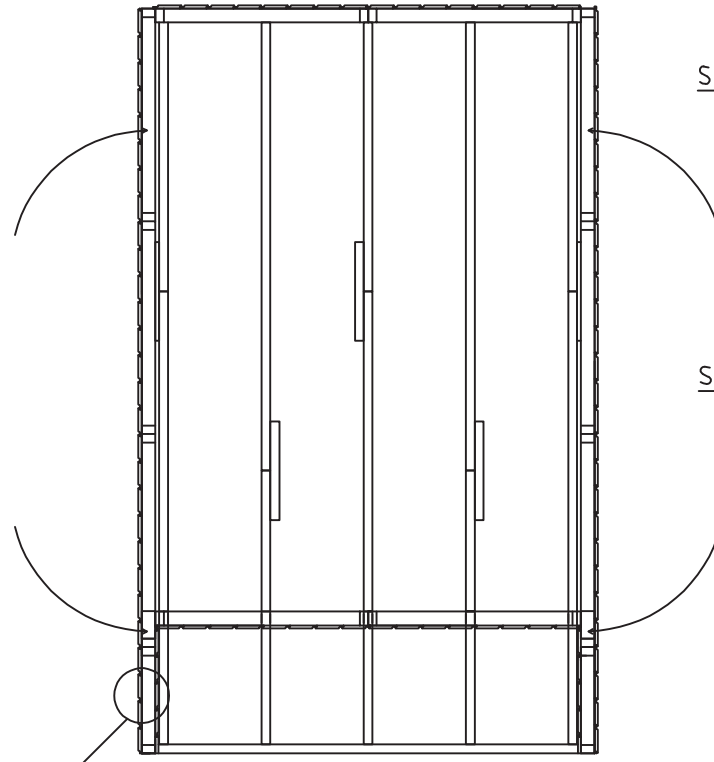
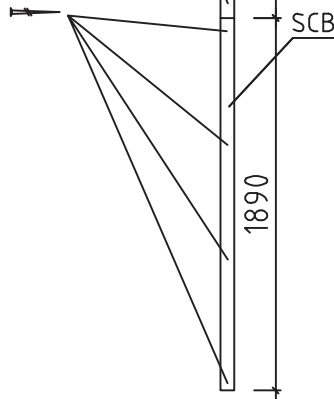

Screws 4.5x70 4pcs  
 Schrauben 4.5x70 4st  
 Skruvar 4.5x70 4st  
 Vis 4.5x70 4pour

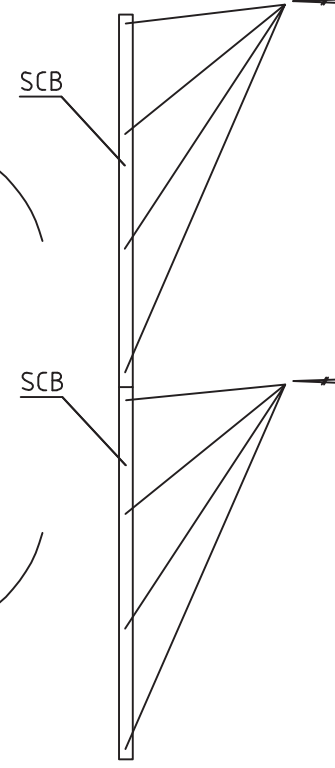

Screws 4.5x70 4pcs  
 Schrauben 4.5x70 4st  
 Skruvar 4.5x70 4st  
 Vis 4.5x70 4pour

Screws 4.5x70  
 Schrauben 4.5x70  
 Skruvar 4.5x70  
 Vis 4.5x70

Detail A

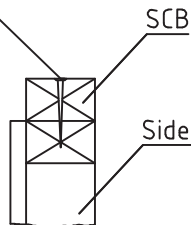

Sidewall-Seitenwand-Sidovägg-Paroi latérale



House	S3523-16-MARKKO	Sheet	8
Drawing		Scale	1:35
Material		Date	15.04.2024
Drawer	K.K.	File	S3523-16-MARKKO.dwg



Installation of wall element EL-10, EL-11 - Installation des Wandelements EL-10, EL-11  
 Montering av vägg element EL-10, EL-11 - Installation de l'élément de paroi EL-10, EL-11

(Front wall - Vordere Wand - Vägg framsida - Paroi avant)

View from inside - Blick von innen - Från insidan - Vue de l'intérieur

Connect with metal plate 60x160 + screws 5.0x40  
 Mit Metallplatte verbinden 60x160 + schrauben 5.0x40  
 Skarvas med metall platta 60x160 + skruvar 5.0x40  
 Connecter avec une plaque métallique 60x160 + vis 5.0x40

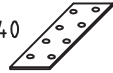

Wall element EL-10  
 Wandelement EL-10  
 Vägg element EL-10  
 Élément de paroi EL-10

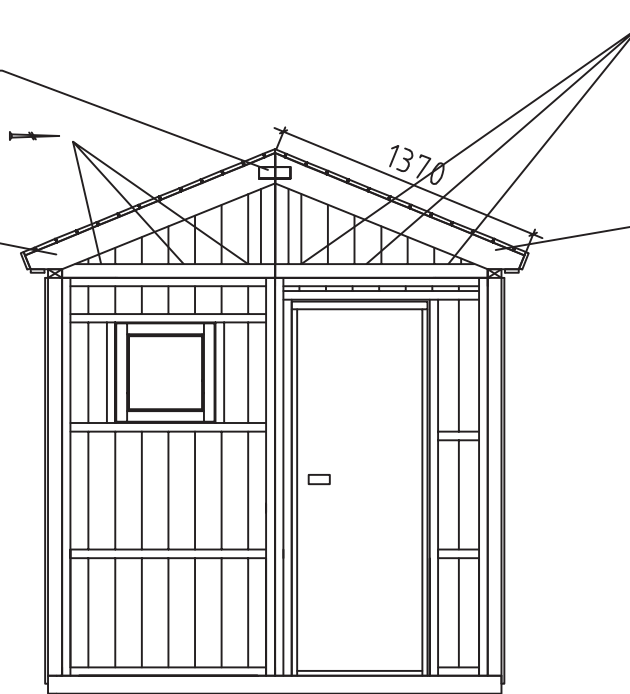

Wall element EL-11  
 Wandelement EL-11  
 Vägg element EL-11  
 Élément de paroi EL-11

Fix wall element EL-10, EL-11 with back wall elements with screws 5.0x120 together  
 Befestigen Sie die Wandelemente EL-10, EL-11 mit Hintere Wand mit schrauben 5.0x120 zusammen  
 Fixera vägg element EL-10, EL-11 med elementat vägg baksida med skruvar 5.0x120 tillsammans  
 Fixer les éléments de paroi EL-10, EL-11 des Paroi arrière des vis 5.0x120



House	S3523-16-MARKKO	Sheet	9
Drawing		Scale	1:35
Material		Date	15.04.2024
Drawer	K.K.	File	S3523-16-MARKKO.dwg

Installation of wall element EL-12, EL-13 - Installation des Wandelemente EL-12, EL-13  
 Montering av vägg element EL-12, EL-13 - Installation de l'élément de paroi EL-12, EL-13  
 (Back wall-Hintere Wand-Vägg baksida-Paroi arrière)

View from inside - Blick von innen-Från insidan - Vue de l'intérieur

Connect with metal plate 60x160 +screws 5.0x40  
 Mit Metallplatte verbinden 60x160+schrauben 5.0x40  
 Skarvas med metall platta 60x160+skruvar 5.0x40  
 Connecter avec une plaque métallique 60x160+vis 5.0x40

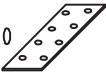

Wall element EL-12  
 Wandelement EL-12  
 Vägg element EL-12  
 Élément de paroi EL-12

Wall element EL-13  
 Wandelement EL-13  
 Vägg element EL-13  
 Élément de paroi EL-13

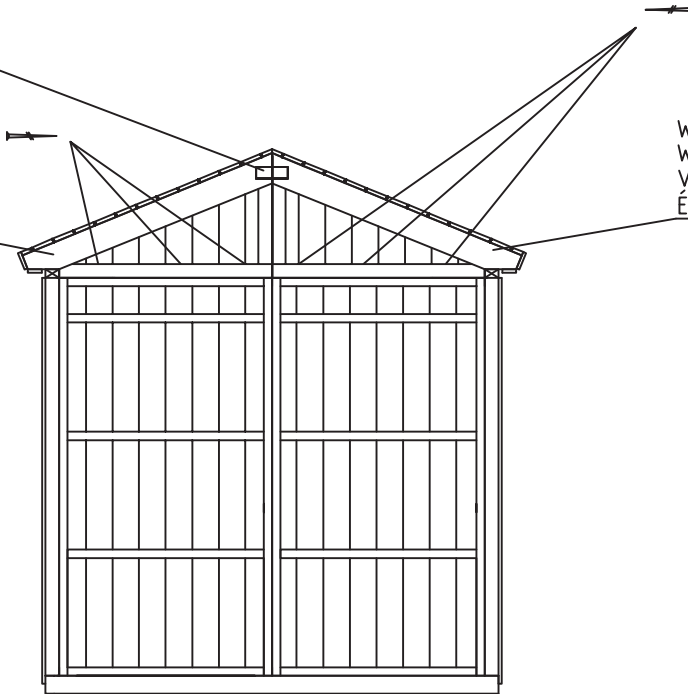

Fix wall element EL-12, EL-13 with back wall elements with screws 5.0x120 together  
 Befestigen Sie die Wandelemente EL-12, EL-13 mit Hintere Wand mit schrauben 5.0x120 zusammen  
 Fixera vägg element EL-12, EL-13 med elementat vägg baksida med skruvar 5.0x120 tillsammans  
 Fixer les éléments de paroi EL-12, EL-13 des Paroi arrière des vis 5.0x120



House	S3523-16-MARKKO	Sheet	10
Drawing		Scale	1:35
Material		Date	15.04.2024
Drawer	K.K.	File	S3523-16-MARKKO.dwg

# Ferms - Sparren-Takläggning - Construction du toit

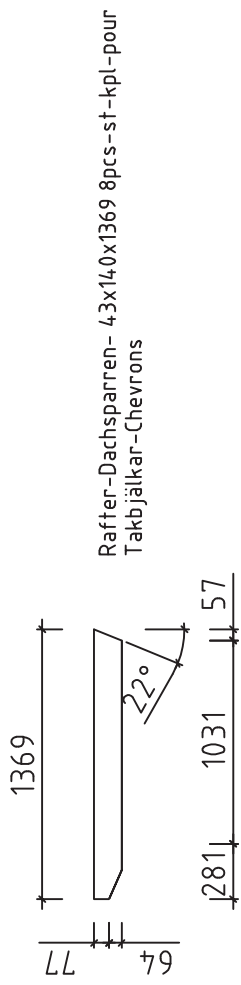

Connect with metal plate 60x160  
+ screws 5.0x40 6pcs  
on both sides of the ferm  
Mit Metallplatte verbinden 60x160+schrauben 5.0x40  
auf beiden Seiten des Sparrens  
Skarvas med metall platta 60x160+skruvar 5.0x40  
båda sidor takläggning  
Connecter avec une plaque métallique 60x160+  
vis 5.0x40 des deux côtés de toit

Ferms 3pcs  
Sparren 3st  
Takläggning 3st  
Construction du toit 3pour

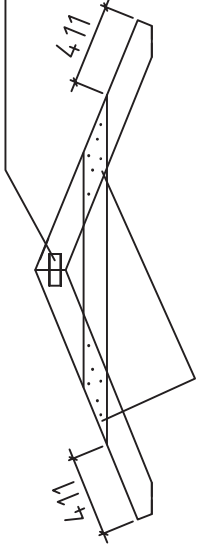

Connect with nails 4x100 (6+6)  
on both sides of the ferm  
Mit Nagel verbinden 4x100 (6+6)  
auf beiden Seiten des Sparrens  
Skarvas med spikar 4x100 (6+6)  
båda sidor takläggning  
Connecter avec clous 4x100 (6+6)  
des deux côtés de toit

Ferms 1pcs  
Sparren 1st  
Takläggning 1st  
Construction du toit 1pour

Connect with metal plate 60x160  
+ screws 5.0x40 2pcs  
on both sides of the ferm  
Mit Metallplatte verbinden 60x160+schrauben 5.0x40  
auf beiden Seiten des Sparrens  
Skarvas med metall platta 60x160+skruvar 5.0x40  
båda sidor takläggning  
Connecter avec une plaque métallique 60x160+  
vis 5.0x40 des deux côtés de toit

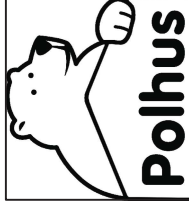
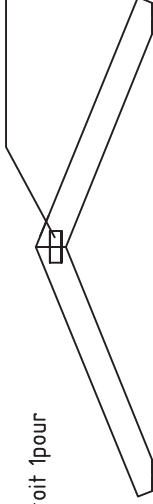

House	S3523-16-MARKKO	Sheet	11
Drawing		Scale	1:35
Material		Date	15.04.2024
Drawer	K.K.	File	S3523-16-MARKKO.dwg

# Ferm install-Ferm installieren-Installera takläggning-Installation ferm

Roofboard L=2460mm  
Dachbrett L=2460mm  
Takbräde L=2460mm R1  
Planche de toit L=2460mm

Roofboard L=1680mm  
Dachbrett L=1680mm  
Takbräde L=1680mm R3  
Planche de toit L=1680mm

Wall element EL-12  
Wandelement EL-12  
Vägg element EL-12  
Élément de paroi EL-12  
1268x653x86

Wall element EL-13  
Wandelement EL-13  
Vägg element EL-13  
Élément de paroi EL-13  
1278x653x86

Connect with steel corner 90x90x65+screws 4.5x45 12pcs  
Mit Stahlwinkel verbinden 90x90x65+schrauben 4.5x45 12st  
Skarvas med metallvinkel 90x90x65+skruvar 4.5x45 12st  
Connecter avec un coin en acier 90x90x65+vis 4.5x45 12pcs

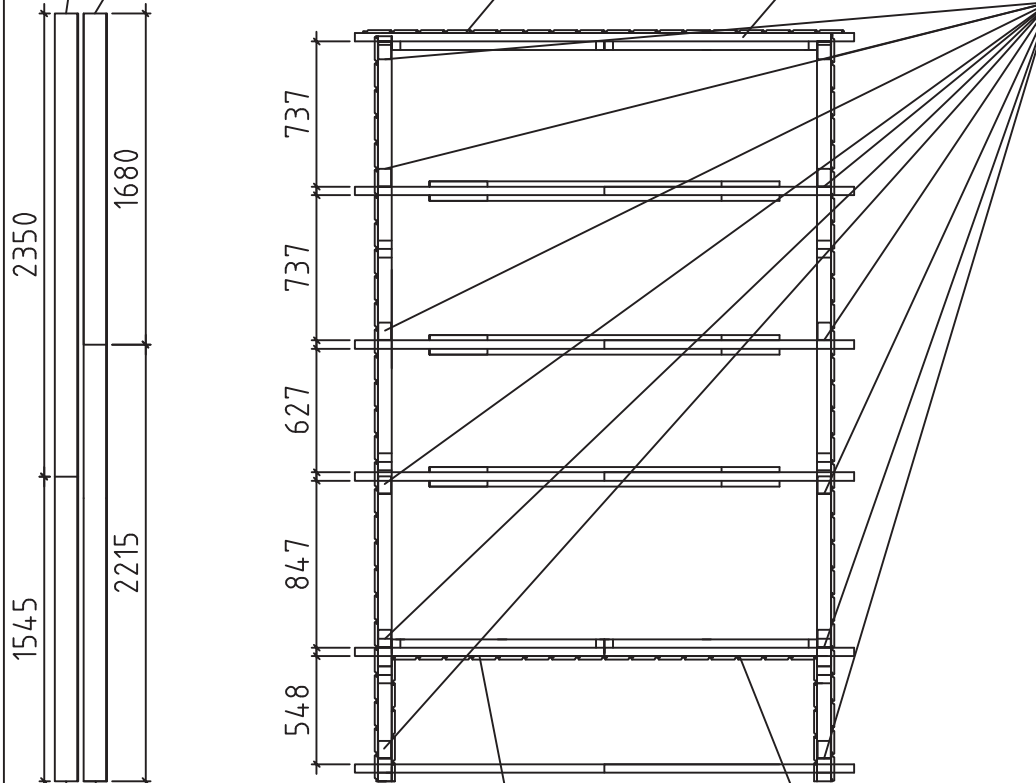

Roofboard L=2215mm  
Dachbrett L=2215mm  
Takbräde L=2215mm R2  
Planche de toit L=2215mm

Roofboard L=1435mm  
Dachbrett L=1435mm  
Takbräde L=1435mm R4  
Planche de toit L=1435mm

Wall element EL-11  
Wandelement EL-11  
Vägg element EL-11  
Élément de paroi EL-11  
1268x653x86

Wall element EL-10  
Wandelement EL-10  
Vägg element EL-10  
Élément de paroi EL-10  
1278x653x86

← Back ferm  
Hintere ferm  
Bakre takläggning  
Ferm arrière

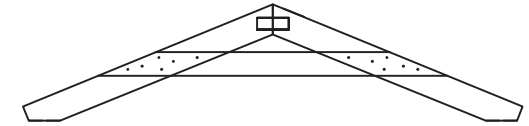

← Middle ferm  
Mittelferm  
Medelvärde takläggning  
Ferm du milieu

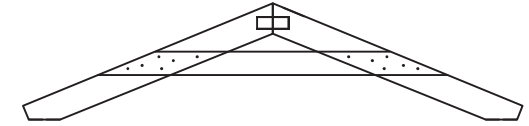

← Middle ferm  
Mittelferm  
Medelvärde takläggning  
Ferm du milieu

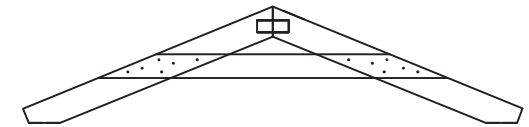

← Front ferm  
Vordere ferm  
Först takläggning  
Ferm avant

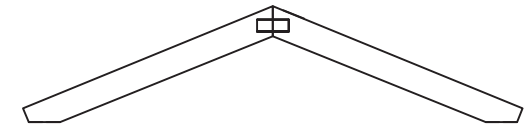

NB!!! Change the roofboard positions after every row  
NB!!! Ändern Sie die Positionen der Dachbretter nach jeder Reihe  
NB!!! Skarva tak brädorna olika efter varje rad  
NB!!! Changer les positions des planches de toit après chaque rangée



House	S3523-16-MARKKO	Sheet	12
Drawing		Scale	1:35
Material		Date	15.04.2024
Drawer	K.K.	File	S3523-16-MARKKO.dwg

# 2 PAKKI L<2.35m

## S3523-16-MARKKO

Nr. Profile L  
Pcs. (mm) (mm)

Wall element EL-10 1pcs  
Wandelement EL-10 1pcs  
Vägg element EL-10 1st  
Élément de paroi EL-10 1kpl  
1268x653x86

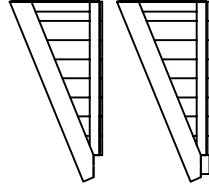

Wall element EL-12 1pcs  
Wandelement EL-12 1pcs  
Vägg element EL-12 1st  
Élément de paroi EL-12 1kpl  
1278x653x86



Wall element EL-11 1pcs  
Wandelement EL-11 1pcs  
Vägg element EL-11 1st  
Élément de paroi EL-11 1kpl  
1278x653x86

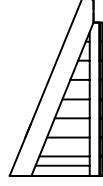

Wall element EL-13 1pcs  
Wandelement EL-13 1pcs  
Vägg element EL-13 1st  
Élément de paroi EL-13 1kpl  
1268x653x86



Wall element EL-8 1pc  
Wandelement EL-8 1pc  
Vägg element EL-8 1st  
Élément de paroi EL-8 1kpl  
1090x2060x86



Wall element EL-1 1pc  
Wandelement EL-1 1pc  
Vägg element EL-1 1st  
Élément de paroi EL-1 1kpl  
1090x2020x86

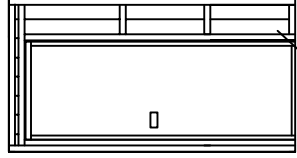

Wall element EL-6 1pc  
Wandelement EL-6 1pc  
Vägg element EL-6 1st  
Élément de paroi EL-6 1kpl  
1080x2020x86

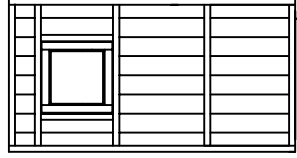

Wall element EL-5 1pc  
Wandelement EL-5 1pc  
Vägg element EL-5 1st  
Élément de paroi EL-5 1kpl  
1090x2060x86

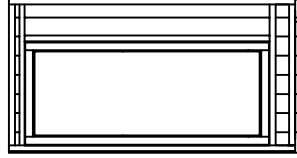

Wall element EL-4 1pc  
Wandelement EL-4 1pc  
Vägg element EL-4 1st  
Élément de paroi EL-4 1kpl  
1090x2060x86



Wall element EL-3 1pcs  
Wandelement EL-3 1pcs  
Vägg element EL-3 1st  
Élément de paroi EL-3 1kpl  
550x2060x86

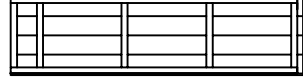

Wall element EL-7 4pcs  
Wandelement EL-7 4pcs  
Vägg element EL-7 4st  
Élément de paroi EL-7 4kpl  
1090x2060x86

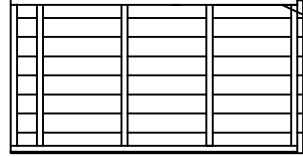

Wall element EL-9 1pcs  
Wandelement EL-9 1pcs  
Vägg element EL-9 1st  
Élément de paroi EL-9 1kpl  
1090x2060x86

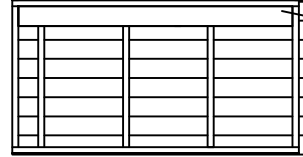

Wall element EL-2 1pcs  
Wandelement EL-2 1pcs  
Vägg element EL-2 1st  
Élément de paroi EL-2 1kpl  
540x2060x86

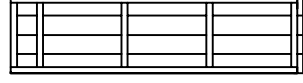

RA	RAFTER – DACHSPARREN – TAKBJÄLKAR – CHEVRONS	8	43x140	1369
TB	TIE BEAM – BINDUNGSBALKEN – TAKBJÄLKAR – POUTRE DE LIAISON	6	28x120	1775
FB1	FLOORBEAM – BODENBRETTEN – GOLVBÄLKAR – PLANCHES DE SOL	9	45x90	2300
FB2	FLOORBEAM – BODENBRETTEN – GOLVBÄLKAR – PLANCHES DE SOL	7	45x90	1390
FB3	FLOORBEAM – BODENBRETTEN – GOLVBÄLKAR – PLANCHES DE SOL	5	45x90	500
FB4	FLOORBEAM – BODENBRETTEN – GOLVBÄLKAR – PLANCHES DE SOL	4	45x90	474
SCB	SIDEWALL CONNECTING BEAM – SEITENWANDVERBINDUNGSBALKEN – BJÄLKAR FÖR SIDOVÄGG SAMMANSLAGNING – POUTRE DE LIAISON DE PAROI LATÉRALE	4	43x70	1890
F1	FLOORBOARD – BODENBRETT – GOLVBRÄDE – PLANCHES DE SOL	25+1	28x120	2150

Kood S3523-16-MARKKO

Materiaal

File S3523-16-MARKKO.dwg

Leht 13







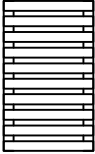
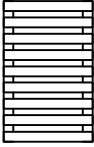

**Polhus**

# 2 PAKKI L<2.35m

Pos	S3523-16-MARKKO	Nr. Pcs.	Profile (mm)	L (mm)
T	TERRACE BOARD-TERRASSENBRETT- TERRASBRÄDE-PLANCHE DE TERRASSE	7	19x90	2150
FF	FLOOR FILLET - FUSSBODENLEISTE - GOLVLIST - BBAGUETTE DE FINITION DE PLANCHER	5	18x35	2100
R1	ROOFBOARD - DACHBRETT - TAKBRÄDE - PLANCHE DE TOIT	13+1 17+1	18x114 18x88	2350
R2	ROOFBOARD - DACHBRETT - TAKBRÄDE - PLANCHE DE TOIT	13+1 17+1	18x114 18x88	2215
R3	ROOFBOARD - DACHBRETT - TAKBRÄDE - PLANCHE DE TOIT	13 17	18x114 18x88	1680
R4	ROOFBOARD - DACHBRETT - TAKBRÄDE - PLANCHE DE TOIT	13 17	18x114 18x88	1545
GB	GABLE BOARD - GIEBELBLENDE - GEVELPLANK - PLANCHE DE RIVE	4	18x120	1395
GS1	GABLE SLAT - GIEBELLEISTE - GEVELLIJST - PLANCHE DE RIVE	4	30x40	1370
EB1	EAVE BOARD - TRAUFBRETT - TAKFOTSRÄDE - LATTES SOUS VOLIGES	2 2	18x90	2215 1680
EB2	EAVE BOARD - TRAUFBRETT - TAKFOTSRÄDE - LATTES SOUS VOLIGES	2 2	18x70	2215 1680
RFF	ROOF FELT FILLET - GIEBELLEISTE - BRÄDE OVANPÅ GAVELBRÄDE - BAGUETTE DE FIXATION DU FEUTRE BITUMEUX	4	18x35	1400
CB1 CB2	CORNER BOARD - ECKBRETT - HÖRNBRÄDE - PLANCHE D'ANGLE	4 4	18x90 18x90	2060 2040
FIL1	FILLING BOARD- FÜLLBRETT- FYLLNADSBRÄDE - PLANCHE DE REMPLISSAGE	1	16x80	2060
FIL2	FILLING BOARD- FÜLLBRETT- FYLLNADSBRÄDE - PLANCHE DE REMPLISSAGE	1	16x70	2060
T1	TERRACE BOARD-TERRASSENBRETT- TERRASBRÄDE - PLANCHE DE TERRASSE	10+1	16x135	2045
T2	TERRACE BOARD-TERRASSENBRETT- TERRASBRÄDE - PLANCHE DE TERRASSE	10	16x135	1160
T3	EAVE SLAT- TRAUFENLEISTE - TAKFOTSLIST - BAGUETTES POUR FIXER LES LATTES SOUS VOLIGES	4	43x43	634
EL-TB1		1	61x630	1060
EL-TB2		1	61x630	990
	STEEL CORNER - STAHLWINKEL - VINKELJÄRN - COIN D'ACIER	12	90x90	65
	STEEL PLATE - STAHLPLATTE - METALLPLATTA - PLAQUE D'ACIER	11	2,5x60	160
	NAIL-NAGEL-SPIKAR-CLOUS FOR-FÜR-FÖR-POUR	48	4,0	100
	NAIL-NAGEL-SPIKAR-CLOUS FOR-FÜR-FÖR-POUR	715 32	2,5 2,0	60 40
Kood	S3523-16-MARKKO	Materjal	File	S3523-16-MARKKO.dwg
			Leht	14

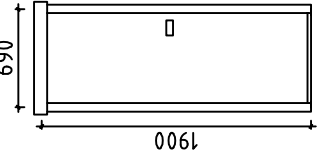
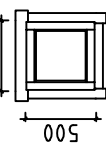
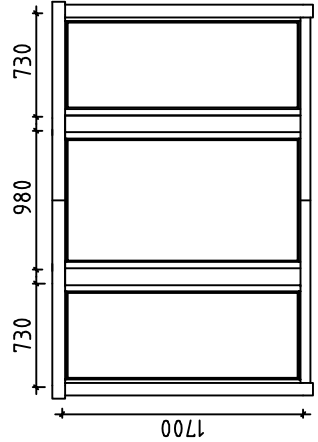
# 2 PAKKI L<2.35m

Pos	S3523-16-MARKKO	Nr. Pcs.	Profile (mm)	L (mm)
SCREW - SCHRAUBEN - SKRUVAR - VIS	 ELEMENT - ELEMENT - ELEMENT ÉLÉMENT DE PAROI NR.5 & NR.6	12	5,0	120
SCREW - SCHRAUBEN - SKRUVAR - VIS	 FLOORBEAM - BODENBRETTE - GOLVBJÄLKAR - PLANCHES DE SOL ELEMENT CONNECTING - ELEMENT VERBINDEN - ÉLÉMENT SAMMANSLAGNING - CONNEXION DES ÉLÉMENTS STEEL PLATE - STAHLPLATTE - METALLPLATTA - PLAQUE D'ACIER	220	4,5	70
SCREW - SCHRAUBEN - SKRUVAR - VIS	 STEEL CORNER - STAHLWINKEL - VINKELJÄRN - CORN D'ACIER CORNER BOARD - ECKBRETT - HÖRNBÄDE - LÄTTES SOUS VOLIGES GABLE BOARD - GIEBELLENDE - GEVELPLANK - PLANCHE DE RIVE ROOF FELT FILLET - GIEBELLESTE - BRÅDE OVANFÅ GAVELBRÅDE - BAGUETTE DE FIXATION DU FEUTRE BITUMEUX	80	5,0	40
SCREW - SCHRAUBEN - SKRUVAR - VIS	 FAVE BOARD - TRAUERBRETT - TAKFOTSRÅDE - LÄTTES SOUS VOLIGES GABLE SLAT - GIEBELLESTE - GEVELLUST - PLANCHE DE RIVE	120	4,5	45
	Door-Tür-dörr - Porte 690x1900 (left) 1pc-st-st-pour Ast_ISO__VA 	1	690	1900
	Window-Fenster-Fönster - Fenêtre 500x500 1pc-st-st-pour Ast_ISO_VU 	1	500	500
	Window-Fenster-Fönster-Fenêtre 1pc-st-st-pour Ast ISO KIN	1	1700	980
	Window-Fenster-Fönster-Fenêtre 2pc-st-st-pour 	2	1700	730
		1		

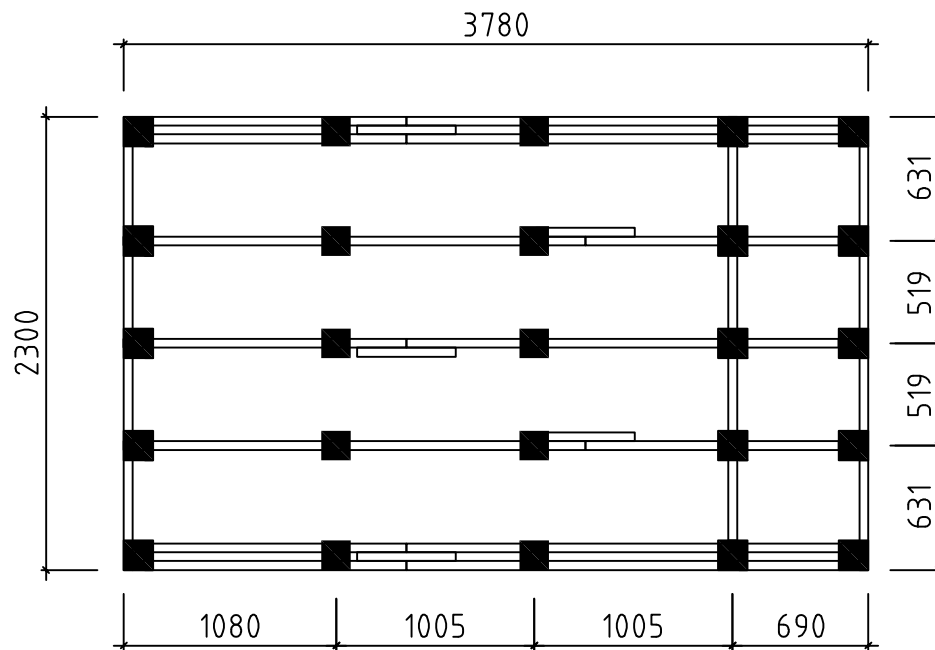

Detta är ett förslag för hur man kan placera plintarna (100- 200 mm i diameter) för golvbjälklaget. Golvbjälkarna är med i byggsatsen, men inte plintarna. Använder man exempelvis 500-600mm långa murblock så kan man halvera antalet punkter. Lägg fuktskyddande papp mellan betong och trä

Vorschlag für eine alternative Pfostenanordnung mit Tragbalken und Pfosten. Tragbalken 45x95 oder 45x120 und Pfosten mit einem Durchmesser von ca. 100-200 mm. (Tragbalken und Pfosten sind nicht im Lieferumfang enthalten). Wenn beispielsweise Betonblöcke (die nicht im Lieferumfang enthalten sind) anstelle von Pfosten verwendet werden, können die Tragbalken flach gegen diese gelegt werden, um die Höhe der Konstruktion zu reduzieren. In dieser Konstruktion können Sie außerdem eine "Platte" zwischen den Tragbalken und den Bodenbalken platzieren, um die Deckenisolierung zu tragen. Legen Sie eine feuchtigkeitsabweisende Pappe zwischen Beton und Holz

A proposal for placing plinths (100-200 mm in diameter) for floor beams. Floor beams are provided in the kit but plinths are not included. For example, by using 500-600 mm long masonry units, one can reduce the number of points 50%. Place cardboard between the concrete and wood to protect from moisture

Proposition d'un plan alternatif avec des barres et des plots. Utilisez des barres de type 4Sx 95 ou 4Sx 120 et des plots d'environ 100 à 200 mm de diamètre (les barres et les plots ne sont pas inclus dans la livraison). Si l'on utilise des parpaings (non inclus dans la livraison) au lieu des plots, on peut positionner les barres à plat contre eux, réduisant ainsi la hauteur de la construction. Dans cette structure, on peut également placer une "plaque de plancher" entre les barres et les poutres du plancher pour monter facilement l'isolation du plancher. Placez une feuille pare-vapeur entre le béton et le bois.



House	S3523-16-MARKKO	Sheet	
Drawing	Plan	Scale	1:35
Material		Date	15.04.2024
Drawer	K.K.	File	S3523-16-MARKKO.dwg