

# 2 bedroom apartment

## Garter House

### Type C

Apartment No. 10, 19



WEAVERS  
YARD



### Floor areas

Kitchen/Dining/Living Room	4.25m x 5.81m	13' 11" x 19' 1"
Bedroom 1	3.03m x 3.27m	9' 11" x 10' 9"
En Suite	2.15m x 1.60m	7' 1" x 5' 3"
Bedroom 2	4.57m x 2.67m	15' 0" x 8' 9"
Bathroom	2.02m x 2.15m	6' 8" x 7' 1"
<b>Total Area</b>	<b>73.0 sq m</b>	<b>785.8 sq ft</b>

### Site plan

Floor 1, 2

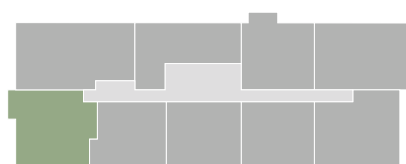

These plans are to be used as a guide only and are for illustrative purposes to the apartment types and sizes available. \* Handed apartment

*Rent well. Live well.*

grainger