

IKON™

Technical Information Pack



Vortex™
Spas

Available exclusively at *Spa* WORLD

IKON™



JETS

18



WATER CAPACITY

1,159 litres



SEATING

6 seats



DIMENSIONS

3.64 x 2.25 x 0.90m

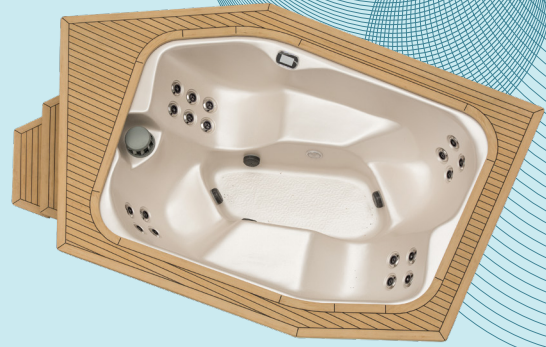

*Shown with Left Step option

FEATURES

Build

- Superior USA made Aristech™ acrylic
- Thermobond™ 4 layer shell construction
- Duraflex™ 'no kink' PVC plumbing
- EnduraLuxe™ AL Composite Panels

Water care

- Purezone™ pleated filtration
- Purezone™ Ozone water clarifier

Lighting

- Hydroglow™ underwater LED floodlight

Control

- SpaNet™ premium control systems

Hydrotherapy

- Ergonomic Hydrotherapy Loungers
- Individual jet pressure control
- Exclusive Vortex Hydroflow™ bearing-less jets

Optional Upgrades Included in Avanté

- Galvanised steel frame construction
- Purezone™ UV-C sanitiser
- ThermoLock™ Dual layer insulation
- Hydroglow™ jet lighting
- Hydroglow™ programmable lighting

Optional Extras

- SmartLINK™ Wifi connectivity
- SpaNet™ Hybrid heat pump compatible

WARRANTIES

Frame	Lifetime
Shell structure.....	10 yrs
Acrylic surface	5 yrs
Jets, plumbing & heater	5 yrs
Pumps & equipment	2 yrs
Deck	2 yrs

* Conditions apply. Specifications may change without notice. Pictures may show options not available on all models.

IKON™

Heights

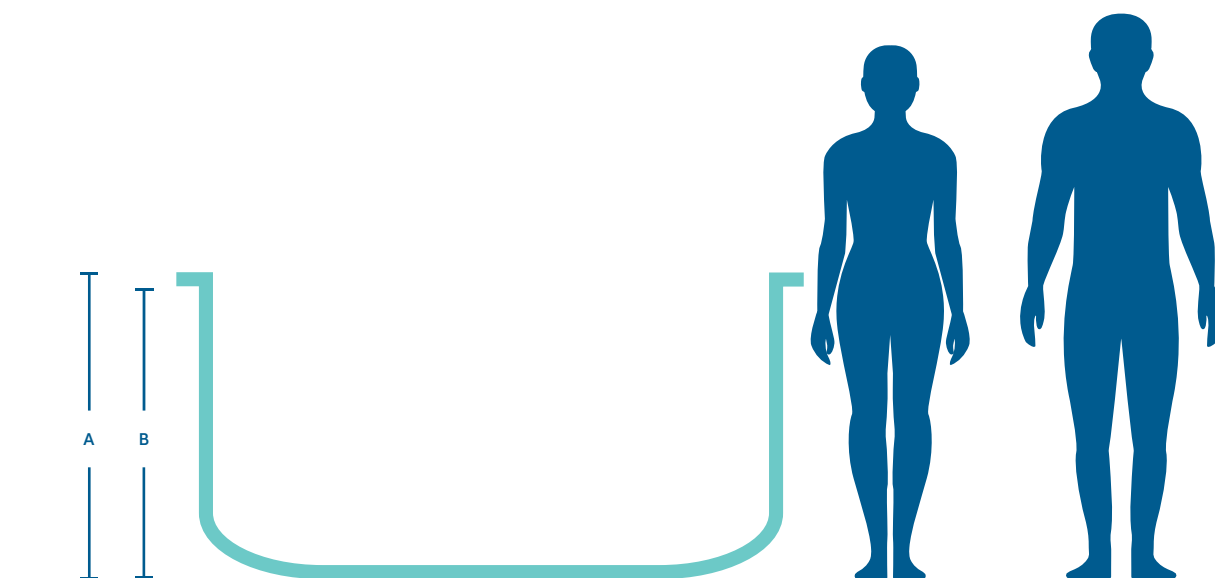

Illustration shows IKON™ spa model

		IKON™
Model dimensions		3.64(L) x 2.25(W)m
A	Total height +/-20mm	0.90m
B	Product height to bottom of deck +/-20mm	870mm

* Conditions apply. Specifications may change without notice. Pictures may show options not available on all models.

IKON™

Jet specifications

Dimensions: 3.64 x 2.25 x 0.90m

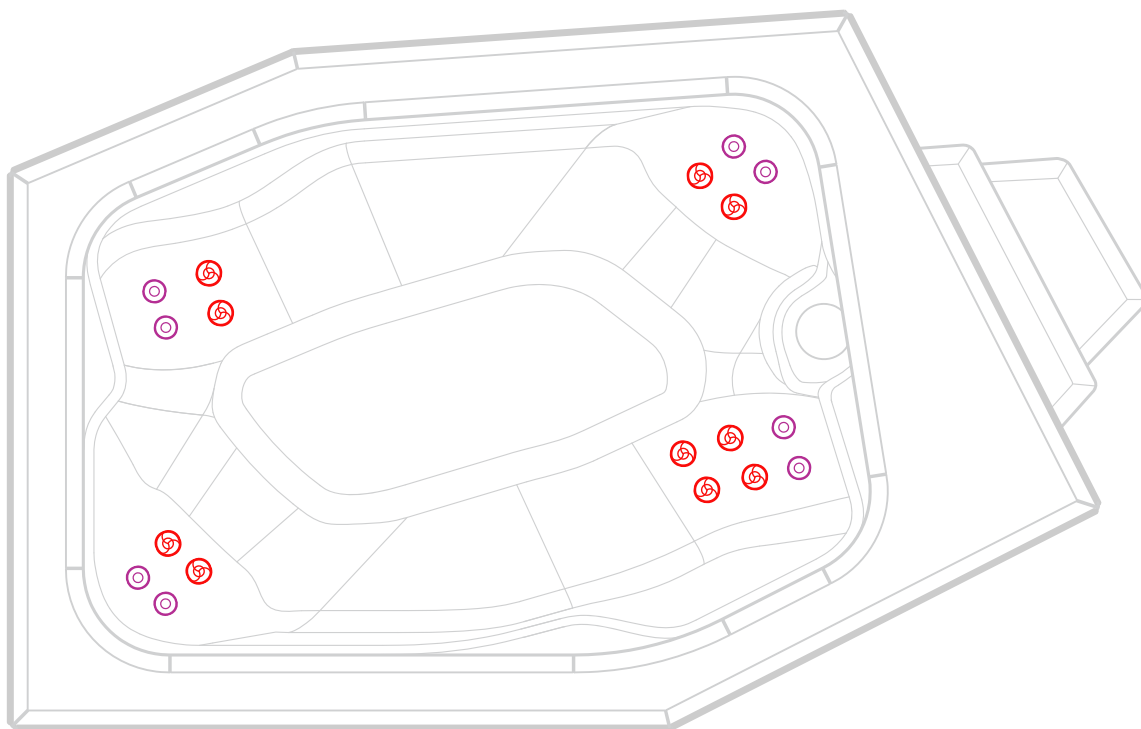

 10 x 100mm Single Jets

 8 x 100mm Directional Jets

* Conditions apply. Specifications may change without notice. Pictures may show options not available on all models.

IKON™

Specifications table

	IKON™
Water capacity	1159L
Dry weight	460kg
Filled weight (incl cover)	1634kg
Lift weight	550kg**
Intuitive spa controller	SV2
Programmable circulation pump	1
Jet pumps	1
Variable output heater	3kW max
Recommended electrical supply	15 amps

** The specified Lift weights in the table above include the spa's dry weight, packaging, and hard cover. These are approximate weights and are intended as a guide only. All weights must be checked by the crane operator prior to the lift. (Cranes have the ability to check the weight)

* Conditions apply. Specifications may change without notice. Pictures may show options not available on all models.

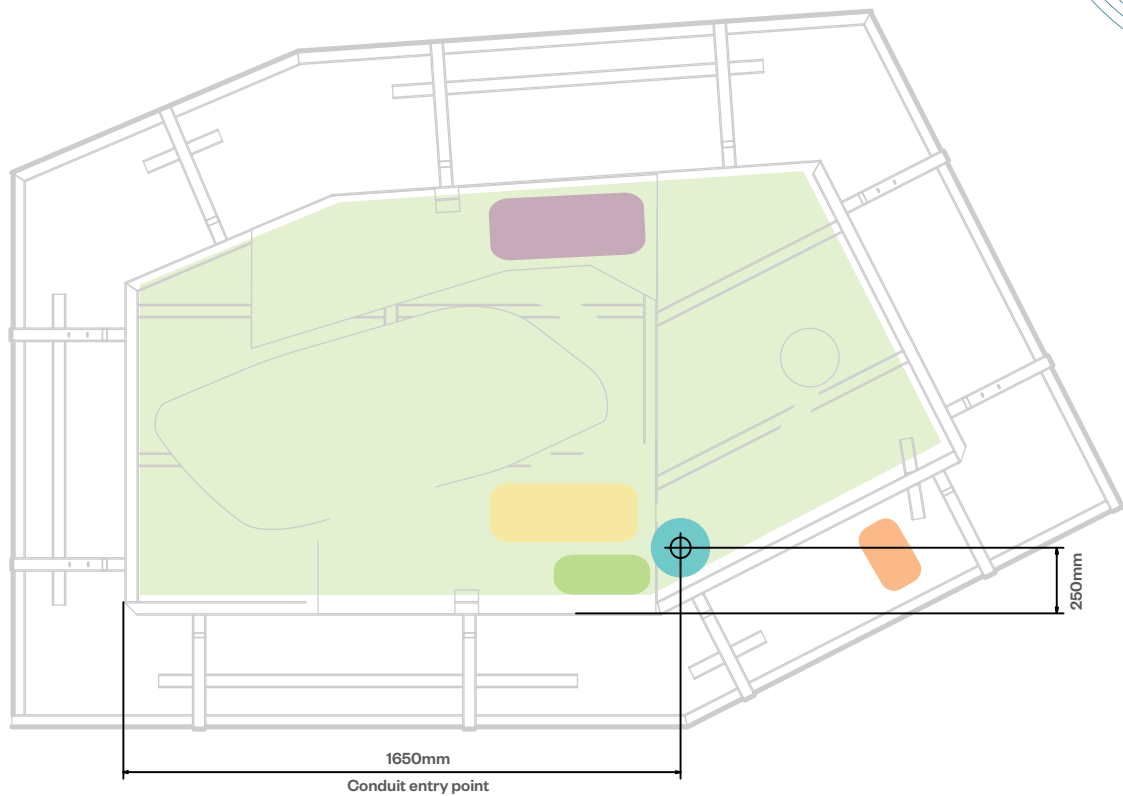
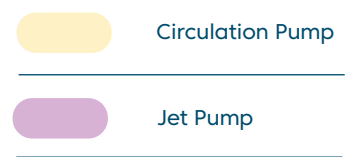
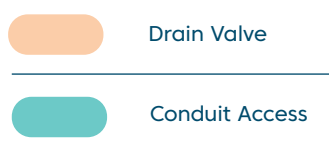
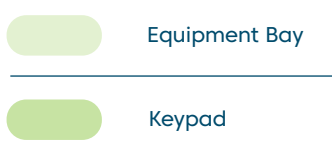

Illustration shows IKON™ spa pool model



* Conduit access should be no more than 100mm high above the concrete slab.

Note: This model has a rigid base, and if you choose to bring the piping conduit in from the bottom through the base, you will need to cut a hole into the base on-site before installation. The factory does not provide this hole. Please see the diagram above to find the location where you can drill the hole.

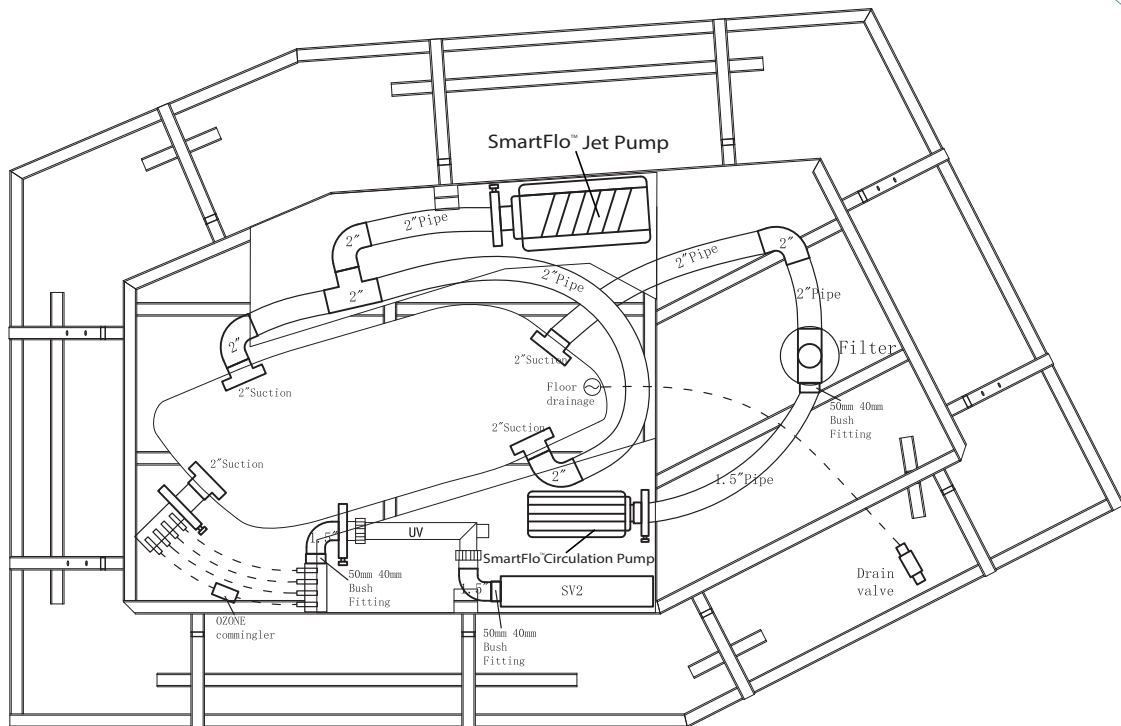

Illustration shows IKON™ spa pool model

* Conduit access should be no more than 100mm high above the concrete slab.

Note: This model has a rigid base, and if you choose to bring the piping conduit in from the bottom through the base, you will need to cut a hole into the base on-site before installation. The factory does not provide this hole. Please see the diagram above to find the location where you can drill the hole.

IKON™

Moving Specifications

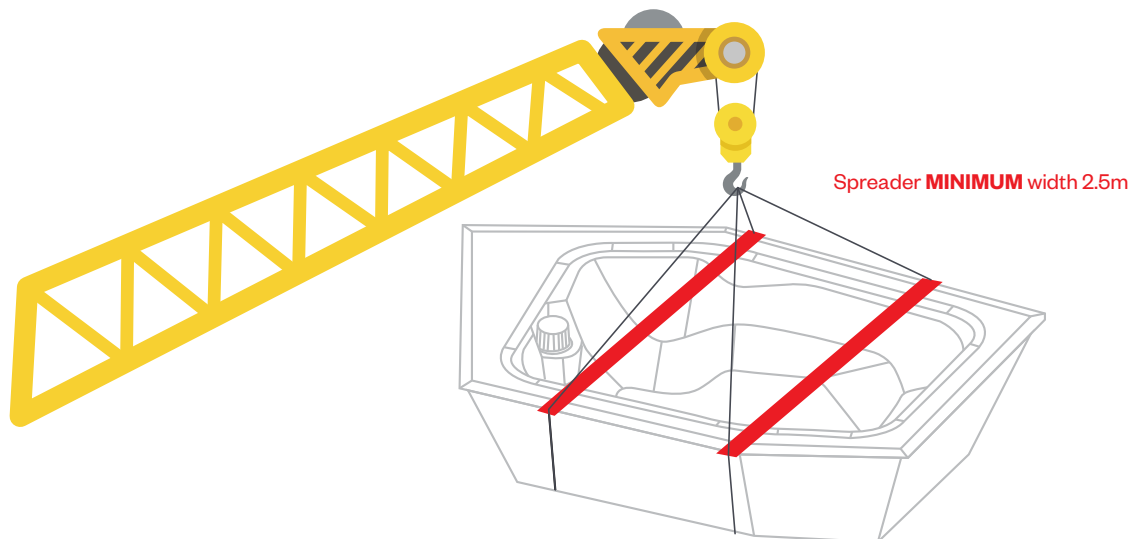

NEVER lift deck

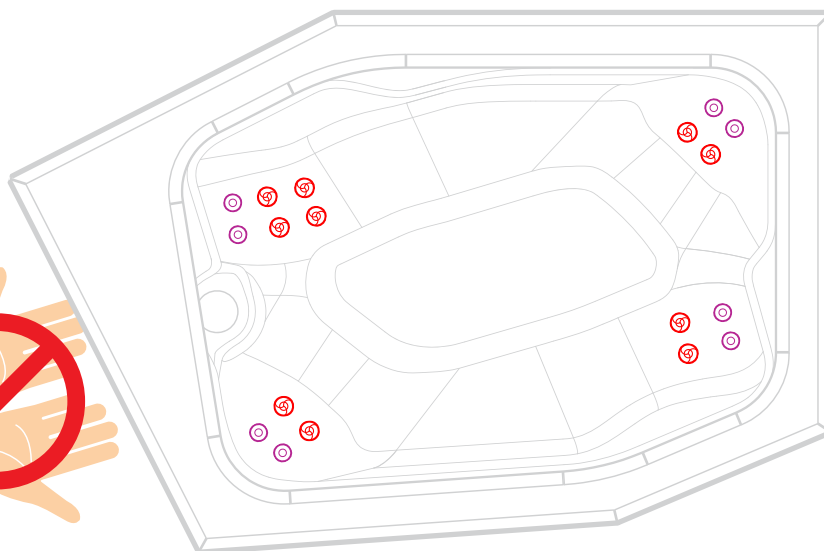

ALWAYS remove the cabinet panels and lift with the internal steel frame

IKON™

Steps Specifications and Installation



No Steps



Optional Left Steps



Optional Right Steps

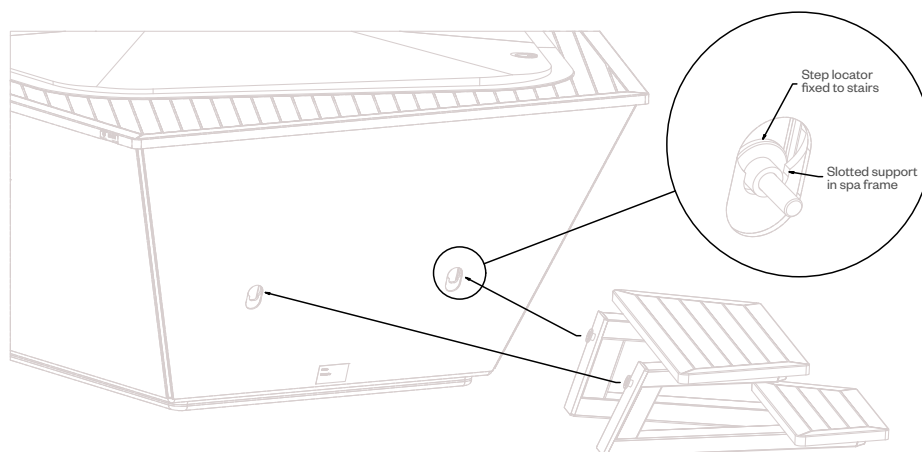

Step Installation:

1. Align the step locator with the slotted supports in the spa.
2. Push downward to secure in place.

Reverse sequence for removal.

* No step option will not include the two step locators

IKON™

Cover specifications

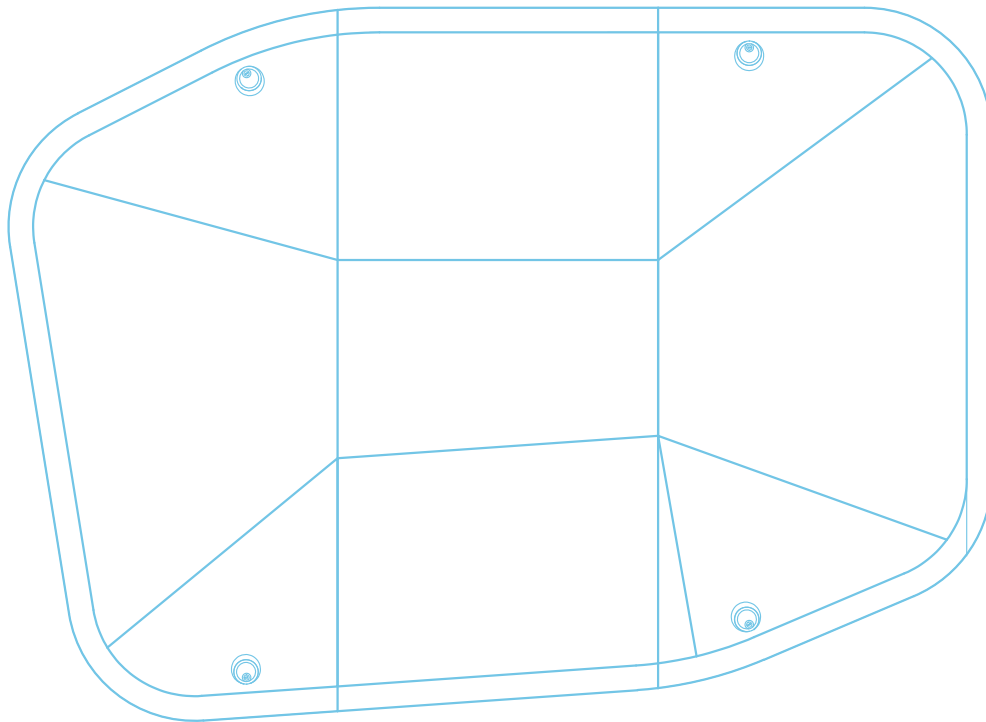

Foam cover assembly



Cover side view

IKON™

Cover specifications

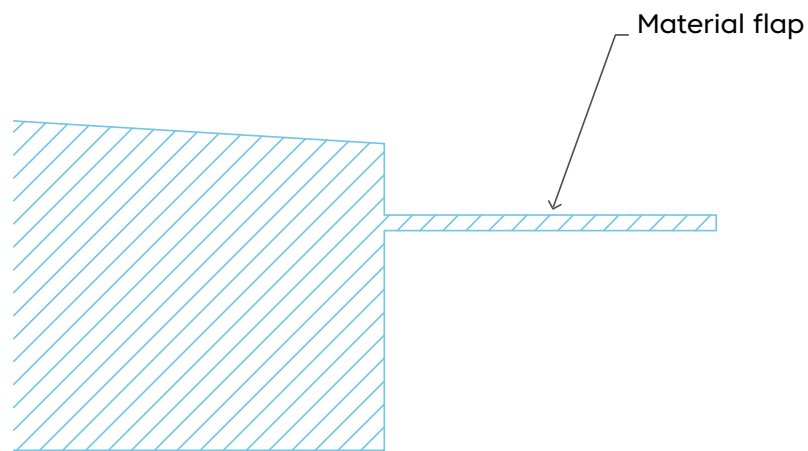

Cover side section

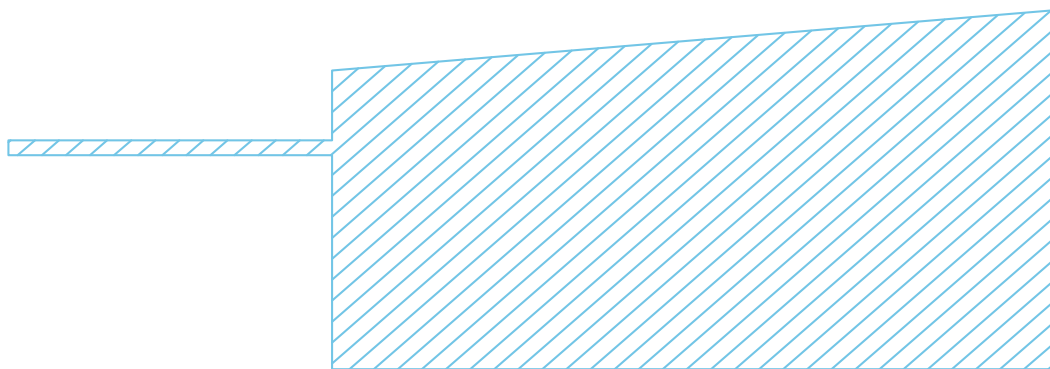

Cover side section

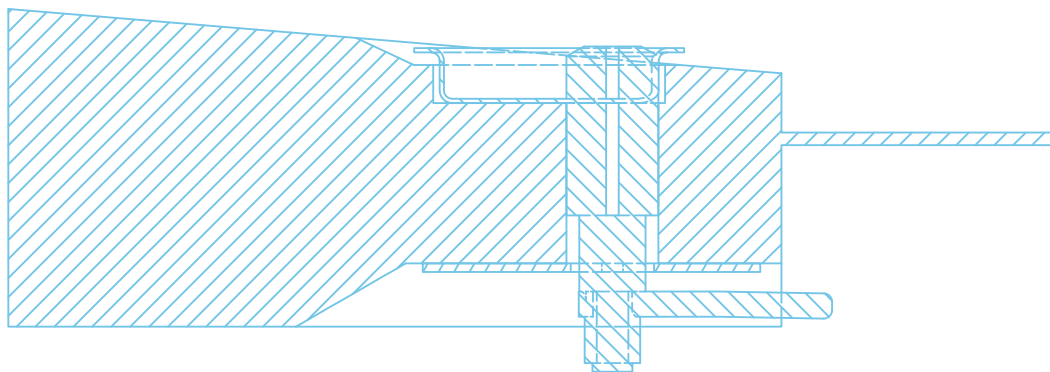

Lock side section

Planning details

Please visit the Spa World website for planning information including:

Property access

Electrical Information

Service access

Foundations, including generic slab

Pit and deck installation

Optional heat pump installation

Use your Smartphone to scan the QR code for your country:

Australia
spaworld.com.au



[Click here to find out more](#)

New Zealand
spaworld.co.nz



[Click here to find out more](#)

Vortex Spas™ Limited Warranty

Vortex Leisure Pty Ltd owns the Vortex Spas™ brand

Lifetime Warranty on Permaframe™ Frames

Vortex Leisure Pty Ltd warrants the structural integrity of the spa frame against defects in workmanship and materials for the lifetime of the spa subject to the limitations, conditions and exclusions expressed in this warranty.

10-year non pro rata structural warranty

Vortex Leisure Pty Ltd warrants the structure of the spa shell against defects in workmanship and materials leading to water loss from the spa for a period of 10 years from date of manufacture subject to the limitations and conditions expressed in this warranty.

5-year acrylic warranty

Vortex Leisure Pty Ltd warrants against the loss of water through the acrylic surface of the spa shell for a period of 5 years from date of manufacture, subject to limitations and conditions in this warranty.

5-year jet warranty

Vortex Leisure Pty Ltd warrants the removable spa jets to be free of manufacturing defects for a period of 5 years from date of manufacture. This warranty excludes damage by grit, sand and improper water chemistry causing corrosion of the part and is limited to supply of replacement parts after the faulty part has been returned to Vortex Leisure Pty Ltd for warranty inspection. Leaking from jets is covered by the plumbing warranty. Laminar jets have a 1 year parts only warranty.

5-year heater warranty

Vortex Leisure Pty Ltd warrants the heater element against defects in materials and workmanship for a period of 5 years from date of manufacture. After 1 year this warranty is limited to the supply of replacement parts and excludes labour and freight costs. This warranty does not cover damage to heaters caused by incorrect water balance resulting in the heater being subjected to abrasive/acid water.

5-year plumbing warranty

Vortex Leisure Pty Ltd warrants the plumbing piping and plumbing joints against defects in materials and workmanship causing leaking for a period of 5 years from date of manufacture. After 1 year this warranty is limited to the supply of replacement parts and excludes all labor and freight costs.

2-year pump warranty

Vortex Leisure Pty Ltd warrants the water pumps against defects in materials and workmanship for a period of 2 years from date of manufacture. After 1 year this warranty is limited to the supply of replacement parts and excludes all labour and freight costs. Damage to the pump motor caused by incorrect chemical balance will not be covered under this warranty. Vortex Leisure Pty Ltd reserves the right to request that the pump be returned for assessment before it is replaced under this warranty.

2-year electronic components warranty

Vortex Leisure Pty Ltd warrants electronic control systems against defects in materials and workmanship for a period of 2 years from date of manufacture. After 1 year the warranty is limited to the supply of replacement parts after the product has been assessed by either Vortex Leisure Pty Ltd or the relevant control system manufacturer.

1-year air blower warranty

Vortex Leisure Pty Ltd warrants the air blower against defects in materials and workmanship for a period of 1 year. This warranty will become void if the blower damage is caused by overfilling.

1-year thermoclad cabinet warranty

Vortex Leisure Pty Ltd warrants the thermoclad spa cabinet against defects in materials and workmanship for a period of 1 year from date of manufacture. This warranty specifically covers the structural integrity of the cabinet. The thermoclad cabinet finish is warranted to be free from defects in materials and workmanship at the time of initial delivery. Fading and weathering of the surface will occur naturally over time, and are not considered defects.

1-year Wifi, audio system, ozone, UV, LED light(s) warranty

Vortex Leisure Pty Ltd warrants the factory installed Wifi, audio system, UV sanitiser, Ozone sanitiser and LED Light(s) assemblies, to be free from defects in materials and workmanship for 1 year. The UV globe is a parts only warranty, if it fails within the 1 year period, a replacement globe will be sent out free of charge to be installed by the customer.

1-year external heat pump warranty

Vortex Leisure Pty Ltd warrants the External Heat Pump to be free from defects in materials and workmanship for 1 year. Installation is to be carried out by a qualified contractor. Failure to do so will immediately VOID this warranty. Vortex Leisure Pty Ltd reserves the right to request the return of the heat pump for assessment before it is replaced or repaired.

1-year spa hardcover warranty

Your Spa Cover is warranted for a period of 1 Year from the date of delivery. This warranty applies only to the structural integrity of the cover and the vinyl. Damage caused to stitching, straps or locks due to improper use of the cover will not be covered under warranty. Disposal of any cover replaced under warranty will be the owners responsibility.

Warranty coverage

Warranty coverage begins at the delivery date. Vortex Leisure Pty Ltd only extends this warranty to the original purchaser and only if the spa has been purchased through an authorized Vortex Leisure Pty Ltd reseller. Written notice of the defect and proof of purchase must be provided to Vortex Leisure Pty Ltd or it's nominated representative within 14 days of the defect occurring. If the spa is required to be returned to Vortex Leisure Pty Ltd for rectification all freight costs shall be pre paid by the customer. Repair or replacement of any defective product is at the sole discretion of Vortex Leisure Pty Ltd. To action warranty service contact the authorized Vortex Leisure Pty Ltd reseller you purchased from. If you are unable to obtain satisfactory service from your reseller, written notification must be provided to Vortex Leisure Pty Ltd within 14 days of the defect occurring. Vortex Leisure Pty Ltd will pay the travel costs of the service agent for the first 50km from their base. Any further travel charges shall be the responsibility of the spa owner.

Electrical connection

All electrical connections must be carried out by a qualified electrical contractor. Failure to do so will immediately VOID this warranty. The spa must be connected to a dedicated MAINS electrical supply circuit protected by a compliant earth leakage circuit breaker safety switch. Vortex Leisure Pty Ltd reserves the right to ask for proof that the spa has been installed by a qualified electrician.

Warranty exclusions

1. Damage resulting from improper water maintenance.
2. Damage from operating the spa above 45°C.
3. Damage caused by clogged filters
4. Damage caused to the spa by improper use of spa cover and excessive exposure to sunlight.
5. Acts of God.
6. Damage caused by not installing spa on sufficient hard level surface.
7. Damage caused by incorrect electrical installation, brownouts, voltage spikes or operating spa out of +/- 10% of voltage range.
8. Warranty is not extended to filter cartridges, head rests, pump seals or drain hoses.
9. Commercial use reduces all warranties to maximum 6 months.
10. Damage caused by relocation of the spa from its original installed location.
11. Damage by termites, borer or other pests.
12. Damage caused by flooding
13. Damage caused by third party carriers.
14. Damage or corrosion to frame caused by un-repaired leaks or improper drainage.

Limitations

This warranty is the only warranty offered by Vortex Leisure Pty Ltd and excludes any other implied or oral undertakings. Except as described above, this warranty does not cover defects or damage due to normal wear and tear, improper installation, alteration without Vortex Leisure Pty Ltd's prior written consent, accident, acts of God, misuse, abuse, commercial or industrial use, use of an accessory not approved by Vortex Leisure Pty Ltd, failure to follow Vortex Spas™ Pre-Delivery Instructions or Owner's Manual, or repairs made or attempted by anyone other than an authorized representative of Vortex Leisure Pty Ltd. Vortex Leisure Pty Ltd or its agents will not be liable for any incidental or consequential loss or injury. Vortex Leisure Pty Ltd will not be liable for costs associated with but not limited to building alterations, removal costs, delivery costs or labour costs associated with the replacement of a spa.

You must check and tighten all barrel unions regularly. Failure to do so may affect your warranty.
See your user manual for further information.

VSW030821



Vortex IKON™

Plumbing Approval

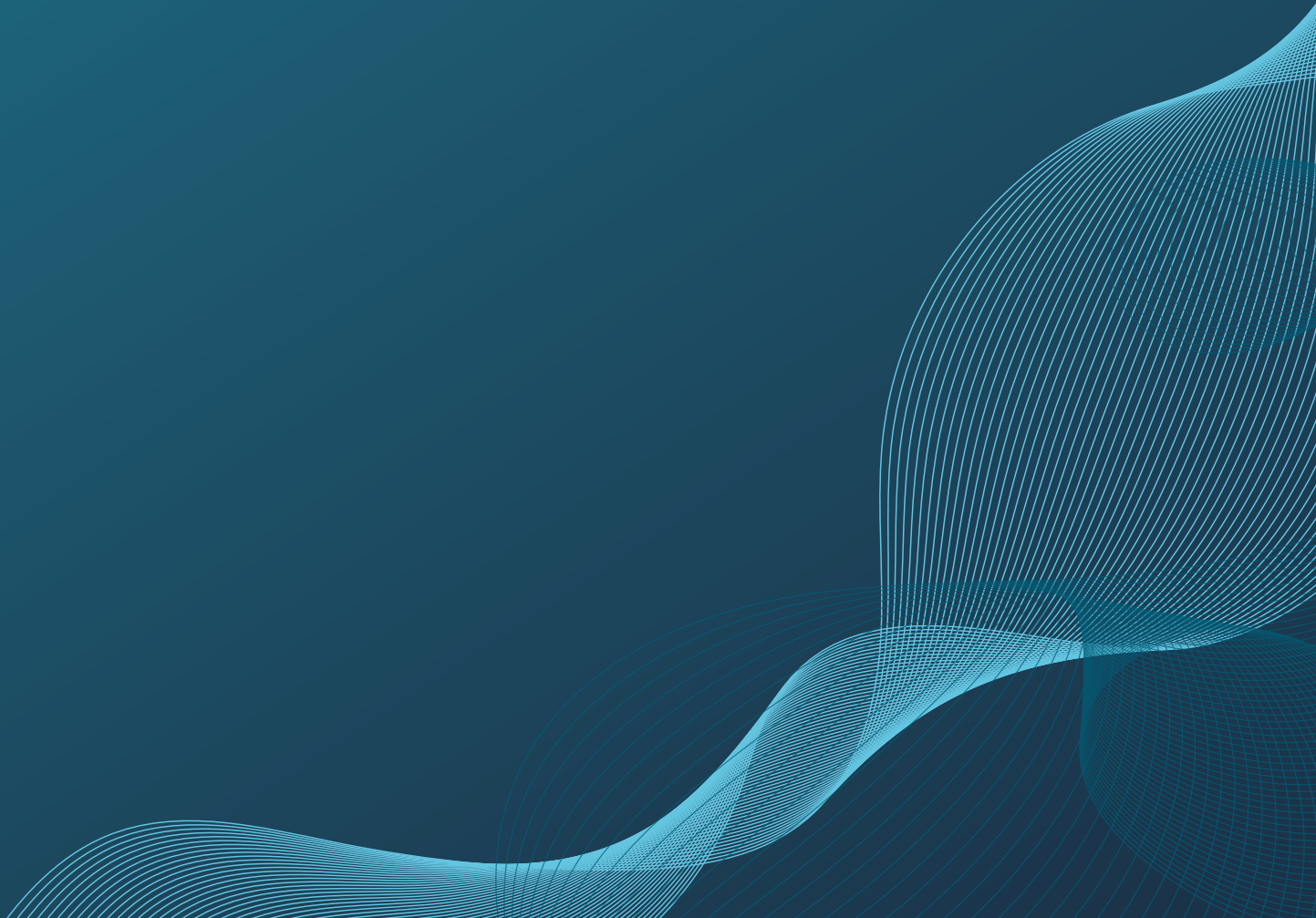

Building Act 1993
Section 238(1)(a)
Building Regulations 2018
Regulation 126

CERTIFICATE OF COMPLIANCE FOR PROPOSED BUILDING WORK

This certificate is issued to

Relevant building surveyor

This certificate is issued in relation to the proposed building work at:

TBA

Nature of proposed building work

Plumbing of Proposed Vortex IKON Swim Spa

Building classification

N/A

Prescribed class of building work for which this certificate is issued:

Design or part of the design of building work relating to water recirculation matter

Documents setting out the design that is certified by this certificate

Document no.	Document date	Type of document (e.g. drawings, computations, specifications, calculations etc.)	Prepared by
2308211	22/08/2023	Plumbing Drawings – Rev. A <i>As Nominated on the Sheet Index, Drawing Sheet S000</i>	Barrason's Engineers

The design certified by this certificate complies with the following provisions of Building Act 1993, Building Regulations 2018 or National Construction Code

Act, Regulation or NCC	Section, Regulation, Part, Performance Requirement or other provision
NCC 2022	NCC 2022 Volume 2 AS 1926.3-2010 Swimming Pool Safety Part 3: Water recirculation systems

I prepared the design, or part of the design, set out in the documents listed above.

I certify that the design set out in the documents listed above complies with the provisions set out above.

I believe that I hold the required skills, experience and knowledge to issue this certificate and can demonstrate this if requested to do so.



Engineer:

Full Name: Andrew Barraclough

Registrations: FIEAUST, CPEng, NER, RBP

Qualifications: BEng MEng PhD

Address: Lvl 2, 2 Pacific Promenade, Pakenham, VIC 3810

Email: admin@barrasons.com.au

Endorsed building engineer area of engineering: Structural

Endorsed building engineer registration no.: PE0000600, RPEQ 22822

Building practitioner registration category and class: C

Signed:

Andrew Barraclough

Date of issue of certificate: 22/08/2023

SPA WORLD

SPA PLUMBING DRAWINGS

VORTEX SPAS - VORTEX IKON

Sheet Index

Layout ID	Layout Name
S000	Title Sheet
S001	General Notes
S101	Spa Plumbing Plan

REV	STATUS	DRAWN	CHECKED	DATE
A	FOR CONSTRUCTION	F.N.	B.E.	22.08.23



TITLE:
TITLE SHEET

PROJECT ADDRESS:
SPA PLUMBING DRAWINGS
VORTEX SPAS

JOB No: 2308211
DATE: 22.08.2023
CLIENT: TONY JONES
DRAWN: F.N.
SCALE: NTS (A3)
CHECKED: B.E.

DWG No: S000
REVISION: REV A

**FOR
CONSTRUCTION**

GENERAL:

- G1. ALL CONSTRUCTION WORK AND MATERIALS TO CONFORM WITH THE ENGINEER SPECIFICATION, AND CURRENT BUILDING CODE OF AUSTRALIA AND AUSTRALIAN STANDARDS.
- G2. THESE DRAWINGS SHALL BE READ IN CONJUNCTION WITH ALL MANUFACTURER'S SPECIFICATIONS AND INSTRUCTIONS.
- G3. ALL DIMENSIONS SHOWN ARE IN MILLIMETERS, AND LEVELS SHOWN ARE A.H.D.(AUSTRALIAN HT. DATUM)
- G4. DRAWINGS ARE NOT TO BE SCALED.RELEVANT DIMENSIONS TO BE CONFIRMED ON SITE BY BUILDER BEFORE COMMENCEMENT OF WORKS.
- G5. ANY DISCREPANCIES OR QUERIES SHOULD BE REFERRED TO THE BARRASONS ENGINEERS FOR CLARIFICATIONS PRIOR TO COMMENCEMENT OF WORKS.
- G6. THE CONTRACTOR SHALL LIAISE WITH ANY BUILDING/PROPERTY OWNERS AS REQUIRED TO ENSURE MINIMAL DISRUPTIONS TO SERVICES.AND THAT SPECIAL REQUIREMENTS OF THE OWNERS ARE ADHERED TO.

SPA MANUFACTURE :

CONSTRUCTION SEQUENCE :

- STEP 1. VACUUM FORM USING 4.75, ARISTECH ACRYLIC SHEET
- STEP 2. FIRST COATING 1.5MM - 2MM USING APPROX. 40:60 RATIO (GLASS TO RESIN)
FIBERGLASS PRAY UP ROVING : 110P VINYL ESTER RESIN
CATALYST M50 (1.8% - 2%)
- STEP 3. OVER CURE AT 35-40 DEGREES CELSIUS
- STEP 4. SECOND COATING 4MM - 8MM USING APPROX. 40:60 RATIO (GLASS TO RESIN)
FIBERGLASS PRAY UP ROVING : 290P POLYESTER RESIN
CATALYST 388 (1.8% - 2%)
CALCIUM CARBONATE FILLER ON SECOND LAYER

NOTES :

SWIMMING POOL AND SPA SAFETY TO FOLLOW THE GUIDELINES OF PN-05-2018 PUBLISHED BY VBA.

BARRIERS AND LOCATION OF BARRIERS TO BE DESIGNED TO REQUIREMENTS OF AS 1926.1-2012 AND AS 1926.2-2007, SWIMMING POOL SAFETY - SAFETY BARRIERS FOR SWIMMING POOLS.

DESIGN AND INSTALL POOLS AND SPAS MANUFACTURED FROM FIBRE-REINFORCED PLASTIC MATERIALS, WITH VOLUMES EXCEEDING 7500 AND DEPTHS GREATER THAN 750MM, TO REQUIREMENTS OF AS/NZS 1838:1994, SWIMMING POOLS - PREMOULDED FIBRE-REINFORCED DESIGN AND FABRICATION.

REV	STATUS	DRAWN	CHECKED	DATE
A	FOR CONSTRUCTION	F.N.	B.E.	22.08.23



TITLE:
GENERAL NOTES-1

PROJECT ADDRESS:
**SPA PLUMBING DRAWINGS
VORTEX SPAS**

JOB No: **2308211** DATE: **22.08.2023**
 CLIENT: **TONY JONES** DRAWN: **F.N.**
 SCALE: **NTS (A3)** CHECKED: **B.E.**

DWG No: **S001**
 REVISION: **REV A**

**FOR
CONSTRUCTION**

SAFETY NOTES :
 1- FILTER IS PART OF AN APPROVED ALTERNATIVE SKIMMING DEVICE.
 2- SUCTION OUTLET COVER TO BE CMP 25201 OR LBW RATED TO 640 L/M.

Vortex IKON™

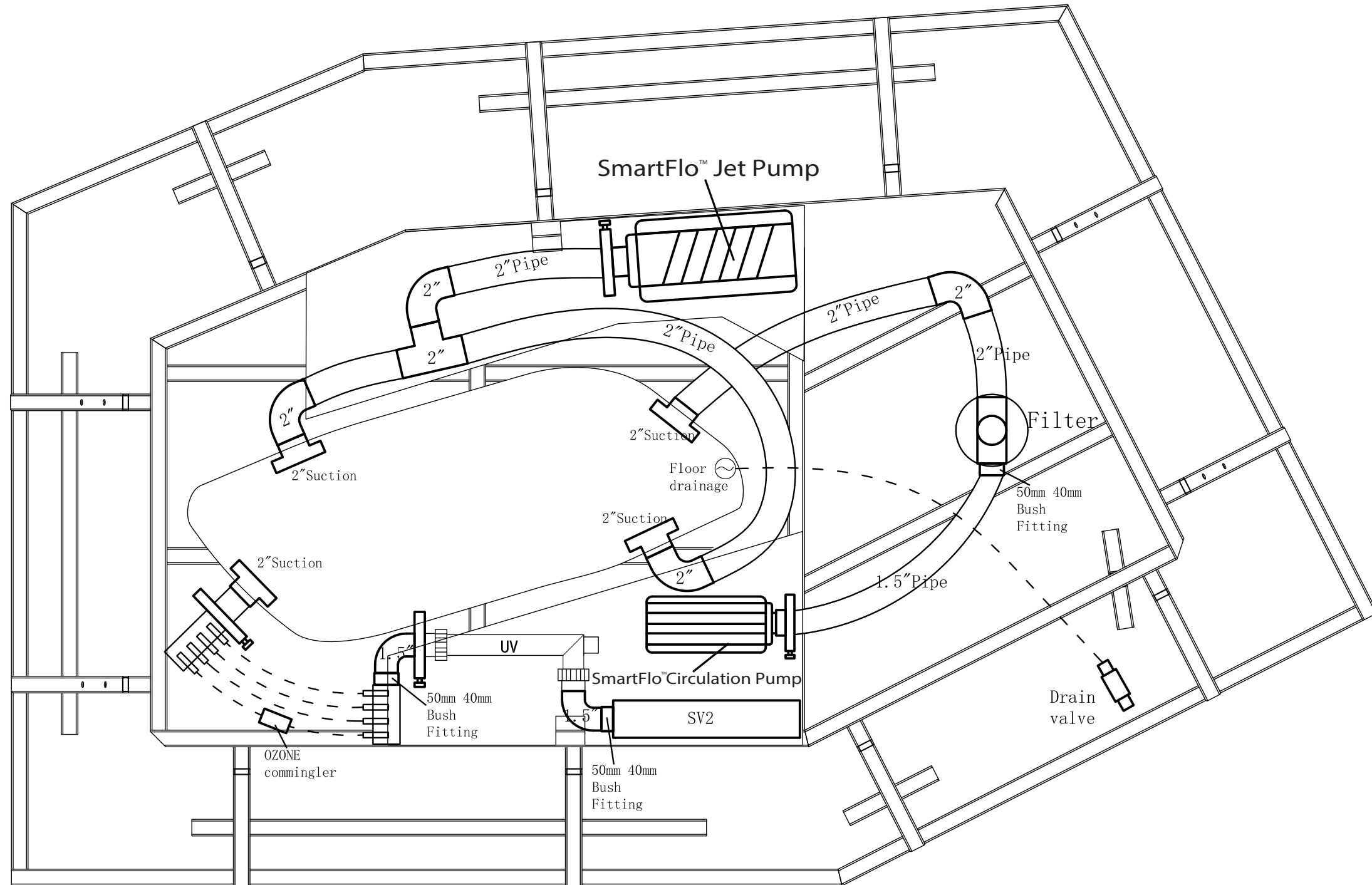

REV	STATUS	DRAWN	CHECKED	DATE
A	FOR CONSTRUCTION	F.N.	B.E.	22.08.23



TITLE:
SPA PLUMBING PLAN

PROJECT ADDRESS:
SPA PLUMBING DRAWINGS
VORTEX SPAS

JOB No: 2308211

DATE: 22.08.2023

CLIENT: TONY JONES

DRAWN: F.N.

SCALE: 1:100 (A3)

CHECKED: B.E.

DWG No: S101

REVISION: REV A

FOR CONSTRUCTION



Vortex IKON™

Structural Certificate

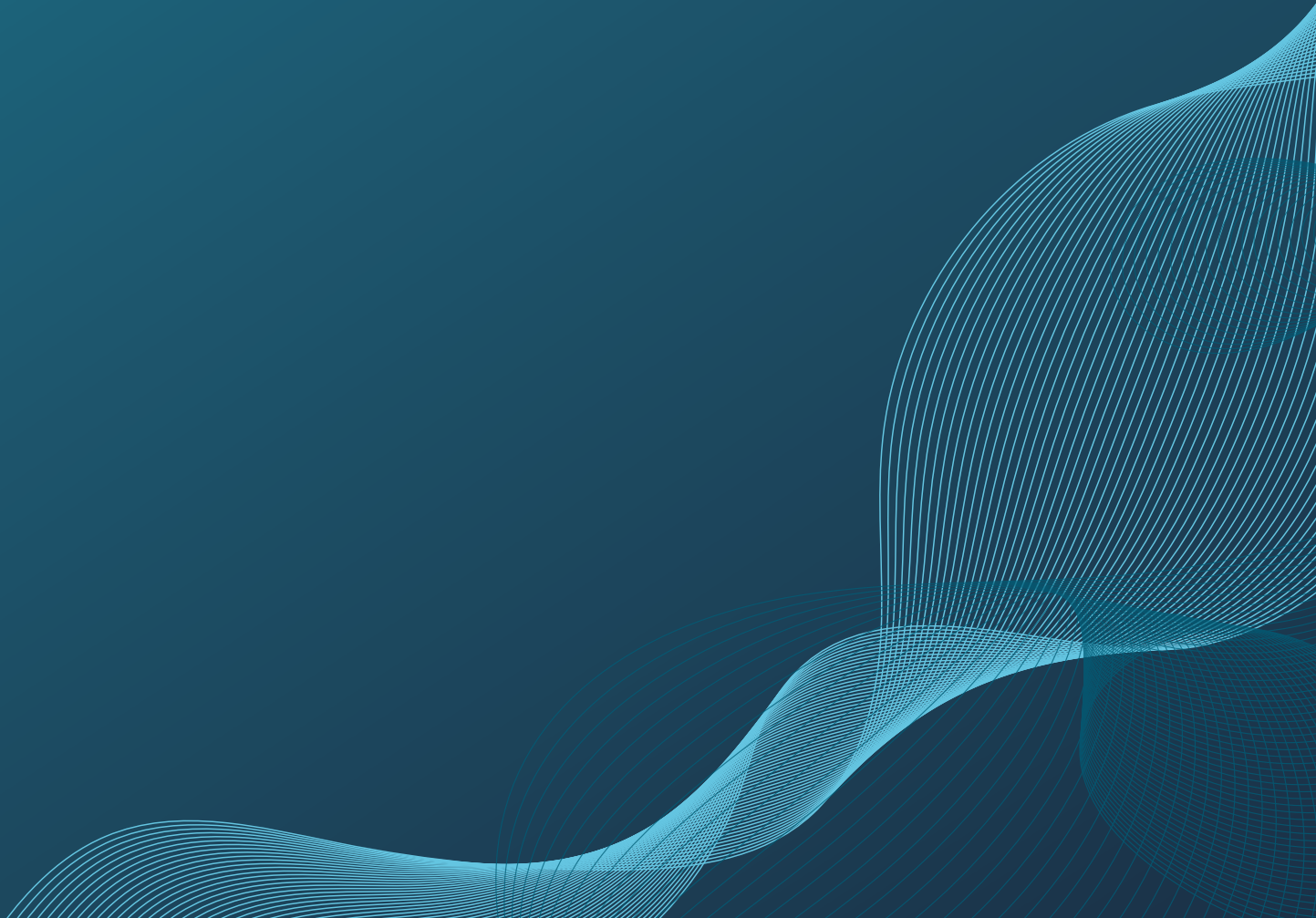

Building Act 1993
Section 238(1)(a)
Building Regulations 2018
Regulation 126

CERTIFICATE OF COMPLIANCE FOR PROPOSED BUILDING WORK

This certificate is issued to

Relevant building surveyor

This certificate is issued in relation to the proposed building work at:

TBC

Nature of proposed building work

Construction of Proposed Vortex IKON Spa

Building classification

Part of building: Spa

BCA Classification: 10b

Prescribed class of building work for which this certificate is issued:

Design or part of the design of building work relating to Structural matter

Documents relied on in preparation of the design that is certified by this certificate

Document no.	Document date	Type of document (e.g. drawings, computations, specifications, calculations etc.)	Prepared by
-	29/09/2017	Structural Drawings	Vortex Spas

The design certified by this certificate complies with the following provisions of Building Act 1993, Building Regulations 2018 or National Construction Code

Act, Regulation or NCC	Section, Regulation, Part, Performance Requirement or other provision
NCC 2022	Part 2.1, 3.0, 3.2, 3.4 of the NCC Vol. 2-2022 amendment 1 including relevant Australian Standards: AS1170.0, AS/NZ1170.1-2002, AS/NZ1170.2-2011, AS1684.2 AS1684.4, AS1720.1, AS2870, AS3959, AS3600, AS3700, AS3850, AS4100, AS4055, AS4671, AS4773.1

I prepared the design, or part of the design, set out in the documents listed above.

I certify that the design set out in the documents listed above complies with the provisions set out above.

I believe that I hold the required skills, experience and knowledge to issue this certificate and can demonstrate this if requested to do so.



Engineer:

Full Name: Andrew Barraclough

Registrations: FIEAUST, CPEng, NER, RBP

Qualifications: BEng MEng PhD

Address: Lvl 2, 2 Pacific Promenade, Pakenham, VIC 3810

Email: admin@barrasons.com.au

Endorsed building engineer area of engineering: Structural

Endorsed building engineer registration no.: PE0000600, RPEQ 22822

Building practitioner registration category and class: C

Signed:

Andrew Barraclough

Date of issue of certificate: 18/08/2023

This form is the approved form that must be used in accordance with section 10 of the *Building Act 1975* and sections 73 and 77 of the *Building Regulation 2021* (Design-specification certificate) stating that an aspect of building work or specification will, if installed or carried out as stated in this form, comply with the building assessment provisions.

Additional explanatory information is included in the Appendix at the end of this form.

<p>1. Property description</p> <p>This section need only be completed if details of street address and property description are applicable.</p> <p>E.g. in the case of (standard/generic) pool design/shell manufacture and/or patio and carport systems this section may not be applicable.</p> <p>Where applicable, the description must identify all land the subject of the application.</p> <p>The lot and plan details (e.g. SP/RP) are shown on title documents or a rates notice.</p> <p>If the plan is not registered by title, provide previous lot and plan details.</p>	<p>Street address <i>(include number, street, suburb/locality and postcode)</i></p> <p>.....</p> <p>..... State Postcode</p> <p>Lot and plan details <i>(attach list if necessary)</i></p> <p>.....</p> <p>Local government area the land is situated in</p> <p>.....</p>
<p>2. Description of aspect/s certified</p> <p>Clearly describe the extent of work covered by this certificate, e.g. all structural aspects of the steel roof beams.</p>	
<p>3. Basis of certification</p> <p>Detail the basis for giving the certificate and the extent to which tests, specifications, rules, standards, codes of practice and other publications were relied upon.</p>	

<p>4. Reference documentation</p> <p>Clearly identify any relevant documentation, e.g. numbered structural engineering plans.</p>	
--	--

<p>5. Building certifier reference number and building development application number</p>	<p>Building certifier reference number</p> <p>.....</p> <p>Building development application number <i>(if available)</i></p> <p>.....</p>
--	---

<p>6. Appointed competent person details</p> <p>Under Part 6 of the Building Regulation 2021 a person must be assessed as a competent for the type of work (design-specification) by the relevant building certifier.</p>	<p>Name <i>(in full)</i></p> <p>.....</p> <p>Company name <i>(if applicable)</i> Contact person</p> <p>.....</p> <p>Business phone number Mobile number</p> <p>.....</p> <p>Email address</p> <p>.....</p> <p>Postal address</p> <p>.....</p> <p>..... State Postcode</p> <p>Licence class or registration type <i>(if applicable)</i></p> <p>.....</p> <p>Licence or registration number <i>(if applicable)</i></p> <p>.....</p>
--	---

<p>7. Signature of appointed competent person</p> <p>This certificate must be signed by the individual assessed and appointed by the building certifier as competent to give design-specification help.</p>	<p>Signature Date</p> <p style="text-align: center;"><i>Andrew Barraclough</i></p> <p>.....</p>
--	--

LOCAL GOVERNMENT USE ONLY

Date received		Reference number/s	
----------------------	--	---------------------------	--

Appendix – explanatory information

IMPORTANT NOTE: it is an offence for a competent person to give a building certifier a document, including this form, that the person knows or reasonably suspects, is false or misleading.

Who can complete this certificate? (section 10 of the *Building Act 1975* (Building Act) and sections 73 and 77 of Building Regulation 2021 (BR 2021))

A building certifier can accept from a competent person (design-specification) a certificate stating that the competent person has assessed the building design or specification for the aspect of building work, and it will, if installed or carried out under the certificate, comply with the building assessment provisions, including any relevant standards and codes.

Schedule 10 of the BR 2021 defines *building design or specification* as any material, system, method of building or other thing related to the design of or specifications for building work.

When completing the certificate, a competent person is required under section 77 of the BR 2021 to include the basis for giving the certificate and state the extent to which the competent person has relied on tests, specifications, rules, standards, codes of practice or other publications.

What is the purpose of this form? (section 10 of the Building Act and sections 73 and 77 of the BR 2021)

The information in this form informs the building certifier's decision making when they are assessing a building development application, issuing the building development approval for the building work the subject of the certificate (form) and when amending the building development approval due to the receipt of updated aspect information such as glazing or truss specifications or revised excavation drawings.

Can a manufacturer or supplier give this Form 15?

A building certifier can accept this form from a manufacturer or supplier who the certifier has decided is a competent person (design-specification).

A manufacturer or supplier of building materials can give this form if they have undertaken the design component for the product. For example a window manufacturer who designs, constructs and supplies the windows to industry could give this form.

Competent person (section 10 of the Building Act 1975 and Part 6 of the BR 2021)

A building certifier must assess and decide to appoint an individual as a competent person before they can accept design-specification help.

When deciding whether a person can be a competent person, the building certifier must assess the person having regard to their experience, qualifications and skills and ensure the person holds a licence or registration if required.

The building certifier is required to keep detailed records about what was considered when appointing a competent person.

For further information about assessment of someone as a competent person refer to the **Guideline for the assessment of competent persons**.

What is required if a manufacturer or supplier did not do the design work for the product?

A manufacturer or supplier who is not part of the design process may give the construction contractor, builder, competent person or the building certifier evidence of suitability such as a product technical statement under Part A5 of the Building Code of Australia (BCA), for an aspect or material stating that it is compliant with the relevant reference documents in the BCA i.e. the applicable Australian Standard/s.

What if there is not enough space for all the supporting material/documents?

Items 2, 3 and 4 requires the competent person to clearly identify the extent of the assessment that was undertaken for aspect/s of work identified in this form.

For instance, there is provision for material such as specifications, standards, codes or other relevant publications to be referenced in the form. However, if the space in the form is not sufficient to accommodate all of this material, you can create and refer to additional material in an addendum or attachment to the form.

The form is also available in a Microsoft Word version, that you can download and edit to include additional material in the relevant parts of the form. Note that editing the form in the Microsoft Word version may cause the relevant boxes to expand and increase the length of the document. This is acceptable and does not change the approved form, provided the section text (description on the left-hand side of the page) is not altered.

Appointed competent person (design or specification) – (sections 34 and 36 of the BR 2021)

A building certifier must assess and decide to appoint an individual as a competent person before they can, as a competent person, give design-specification help. The building certifier is required to keep detailed records about what was considered when appointing a competent person.

A building certifier must be satisfied that an individual is competent to give the type of help having regard to the individual's experience, qualifications and skills and if required by law to hold a licence or registration, that the individual is appropriately registered or licensed.

An individual is appointed as competent to give design-specification help on or from a particular day.

For further information about assessment of someone as a competent person refer to the **Guideline for the assessment of competent persons**.

PRIVACY NOTICE

The Department of Energy and Public Works is collecting personal information as required under the *Building Act 1975*. This information may be stored by the Department, and will be used for administration, compliance, statistical research and evaluation of building laws. Your personal information will be disclosed to other government agencies, local government authorities and third parties for purposes relating to administering and monitoring compliance with the *Building Act 1975*. Personal information will otherwise only be disclosed to third parties with your consent or unless authorised or required by law.

DRAWING No. BRIDESON 4 FRAME WELDMENT
 REFERENCE DRAWINGS

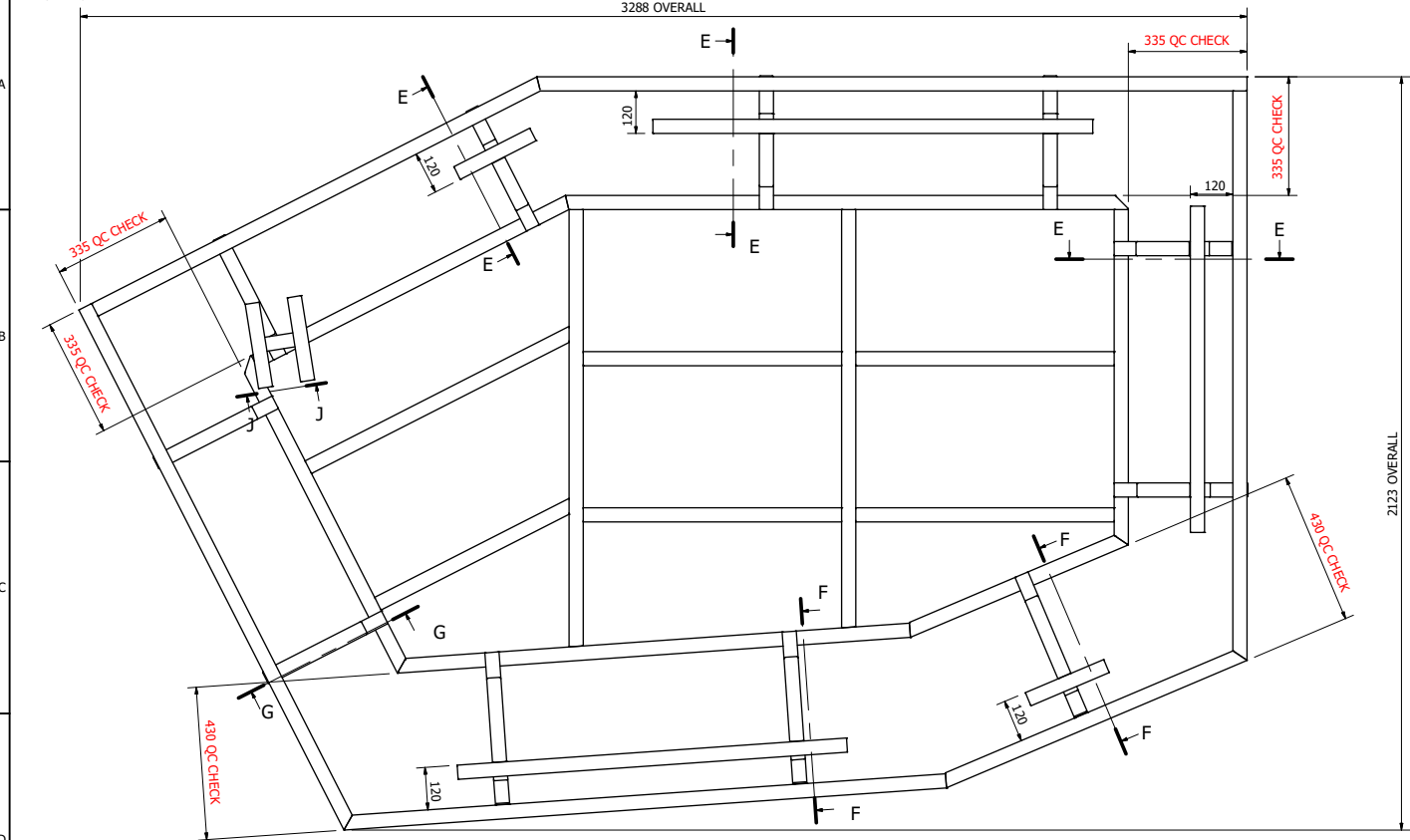

PARTS LIST					
ITEM	QTY	DESCRIPTION	LENGTH	ANGLE1	ANGLE2
1	1	1 - 40X3SHS	1586.4 mm	45.0 deg	76.5 deg
2	1	2 - 40X3SHS	944.7 mm	90.0 deg	56.5 deg
3	1	3 - 40X3SHS	667.3 mm	71.0 deg	56.5 deg
4	1	4 - 40X3SHS	1449.4 mm	90.0 deg	56.5 deg
5	1	5 - 40X3SHS	984.7 mm	45.0 deg	56.5 deg
6	1	6 - 40X3SHS	993.4 mm	90.0 deg	76.5 deg
7	1	7 - 40X3SHS	1178.5 mm	90.0 deg	86.0 deg
8	1	8 - 40X3SHS	1232.0 mm	90.0 deg	86.0 deg
9	4	9 - 40X3SHS	728.0 mm	90.0 deg	90.0 deg
10	1	10 - 40X3SHS	835.0 mm	90.0 deg	63.0 deg
11	1	11 - 40X3SHS	615.0 mm	90.0 deg	63.0 deg
12	5	12 - 40X3SHS	57.0 mm	90.0 deg	70.0 deg
13	7	13 - 40X3SHS	120.0 mm	90.0 deg	90.0 deg
14	1	14 - 40X3SHS	920.0 mm	90.0 deg	90.0 deg
15	1	15 - 40X3SHS	1100.0 mm	90.0 deg	90.0 deg
16	4	16 - 40X3SHS	240.0 mm	90.0 deg	90.0 deg
17	1	17 - 40X3SHS	728.0 mm	90.0 deg	90.0 deg
18	1	18 - 40X3SHS	1240.0 mm	90.0 deg	90.0 deg
19	3	19 - 40X3SHS	52.0 mm	90.0 deg	64.5 deg
20	3	20 - 40X3SHS	80.0 mm	90.0 deg	90.0 deg
21	8	21 - 40X3SHS	107.0 mm	90.0 deg	70.0 deg
22	3	22 - 40X3SHS	116.0 mm	90.0 deg	64.5 deg
23	1	23 - 40X3SHS	2001.7 mm	90.0 deg	76.5 deg
24	1	24 - 40X3SHS	1604.7 mm	90.0 deg	56.5 deg
25	1	25 - 40X3SHS	1644.8 mm	90.0 deg	56.5 deg
26	1	26 - 40X3SHS	920.5 mm	71.0 deg	56.5 deg
27	1	27 - 40X3SHS	1702.5 mm	90.0 deg	56.5 deg
28	1	28 - 40X3SHS	1408.7	90.0 deg	76.5 deg
29	4	29 - 40X3SHS	805.2 mm	70.0 deg	70.0 deg
30	3	30 - 40X3SHS	842.0 mm	64.5 deg	64.5 deg
31	4	31 - 40X3SHS	805.2 mm	70.0 deg	70.0 deg

NOTE:
 1. ALL GALVANISED STEEL 40 x 40 x 3mm SQUARE HOLLOW SECTION.
 2. PAINT ALL WELDS WITH ZINC PAINT

TOP VIEW
 SCALE (1 : 7.5)

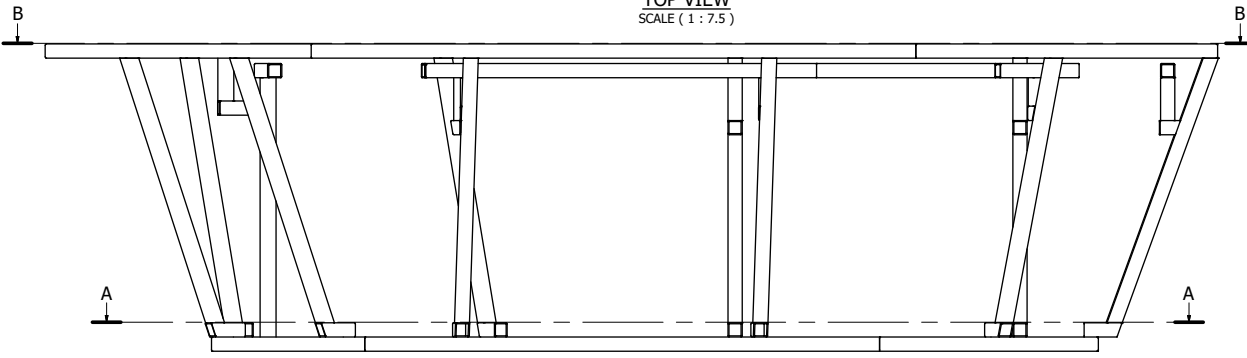

FRAME WELDMENT
 SIDE VIEW
 SCALE (1 : 7.5)

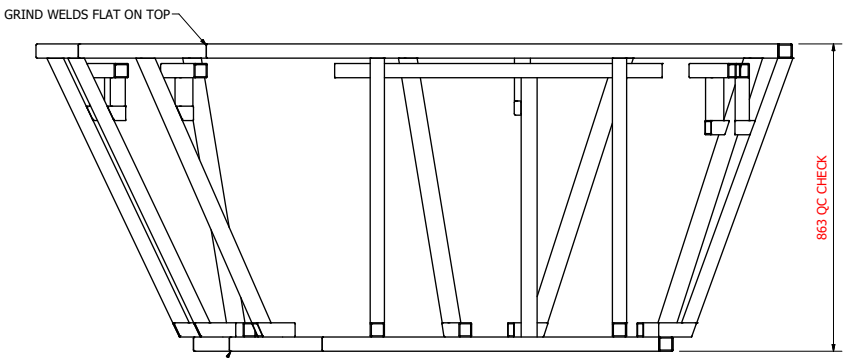

END VIEW
 SCALE (1 : 7.5)

ISSUE	DATE	DRAWN	COMMENTS
E	19/10/18	S.L.	DECK BRACE ADDED
D	25/05/18	S.L.	BASE 4MM SMALLER ALL ROUND
C	13/04/18	S.L.	LENGTH OF ITEMS 12 13 15 16 17 19 20
B	4/12/17	S.L.	ITEM 21 & 29 POSITION FOR STAIRS
A	29/09/17	S.L.	ISSUED TO A-TECH FOR PROTOTYPE

DO NOT SCALE
 WORK TO DIMENSIONS
 3RD ANGLE
 PROJECTION



DRAWN Stephen	DATE 7/06/2017
CHECKED	DATE
APPROVED	DATE
SCALE NTS	

PROJECT IKON	SHEET 1 of 1
TITLE SPA FRAME FABRICATION	
DRAWING No. BRIDESON 4 FRAME WELDMENT	

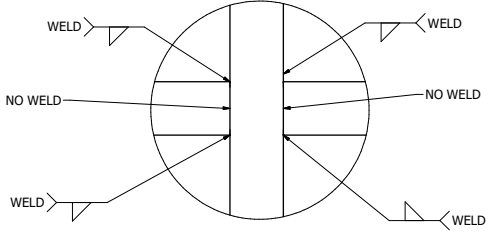

WELDING DETAIL L
 SCALE (1 : 2)

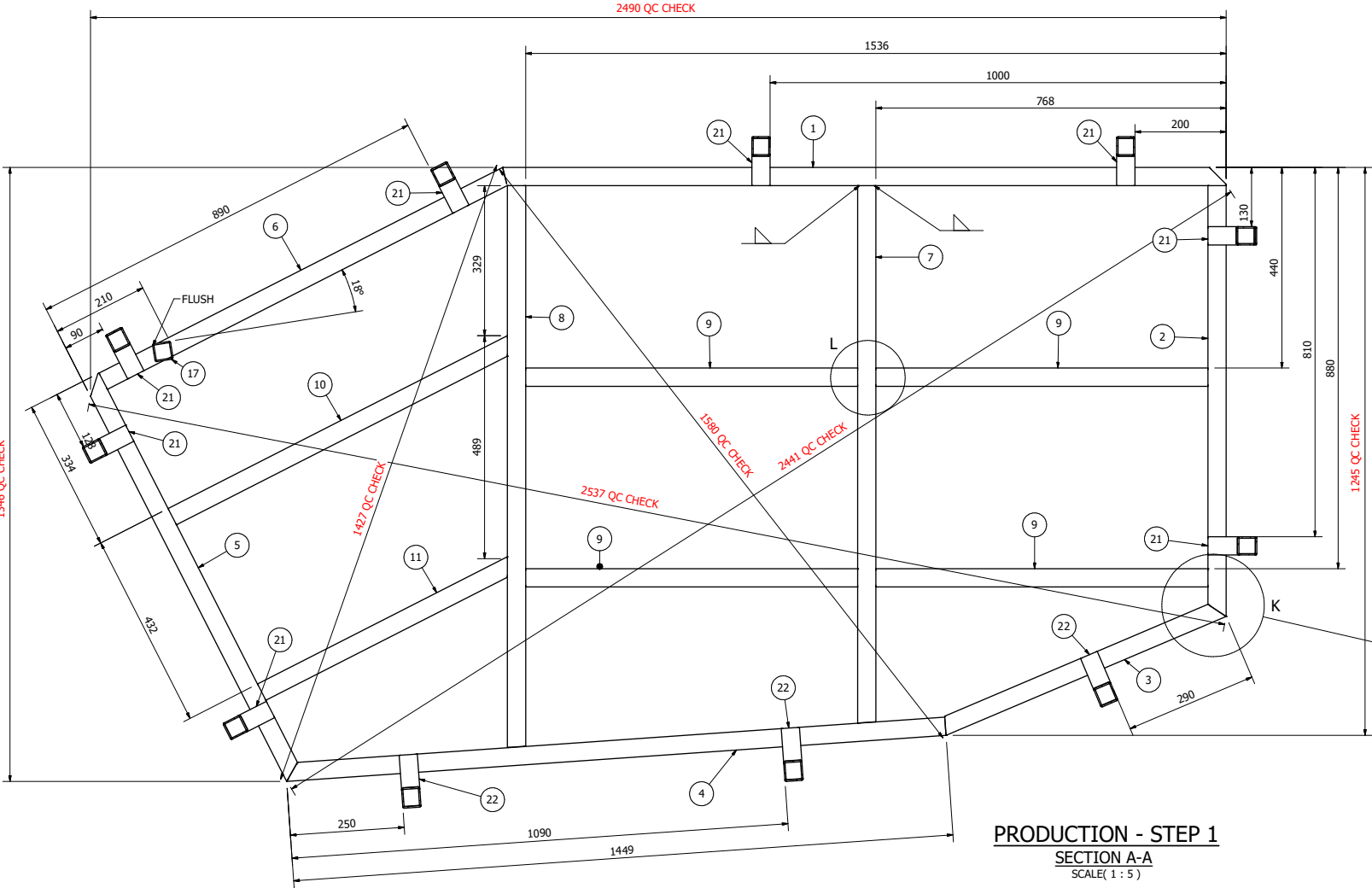

PRODUCTION - STEP 1
SECTION A-A
 SCALE(1 : 5)

PARTS LIST					
ITEM	QTY	DESCRIPTION	LENGTH	ANGLE1	ANGLE2
1	1	1 - 40X3SHS	1586.4 mm	45.0 deg	76.5 deg
2	1	2 - 40X3SHS	944.7 mm	90.0 deg	56.5 deg
3	1	3 - 40X3SHS	667.3 mm	71.0 deg	56.5 deg
4	1	4 - 40X3SHS	1449.4 mm	90.0 deg	56.5 deg
5	1	5 - 40X3SHS	984.7 mm	45.0 deg	56.5 deg
6	1	6 - 40X3SHS	993.4 mm	90.0 deg	76.5 deg
7	1	7 - 40X3SHS	1178.5 mm	90.0 deg	86.0 deg
8	1	8 - 40X3SHS	1232.0 mm	90.0 deg	86.0 deg
9	4	9 - 40X3SHS	728.0 mm	90.0 deg	90.0 deg
10	1	10 - 40X3SHS	835.0 mm	90.0 deg	63.0 deg
11	1	11 - 40X3SHS	615.0 mm	90.0 deg	63.0 deg
12	5	12 - 40X3SHS	57.0 mm	90.0 deg	70.0 deg
13	7	13 - 40X3SHS	120.0 mm	90.0 deg	90.0 deg
14	1	14 - 40X3SHS	920.0 mm	90.0 deg	90.0 deg
15	1	15 - 40X3SHS	1100.0 mm	90.0 deg	90.0 deg
16	4	16 - 40X3SHS	240.0 mm	90.0 deg	90.0 deg
17	1	17 - 40X3SHS	728.0 mm	90.0 deg	90.0 deg
18	1	18 - 40X3SHS	1240.0 mm	90.0 deg	90.0 deg
19	3	19 - 40X3SHS	52.0 mm	90.0 deg	64.5 deg
20	3	20 - 40X3SHS	80.0 mm	90.0 deg	90.0 deg
21	8	21 - 40X3SHS	107.0 mm	90.0 deg	70.0 deg
22	3	22 - 40X3SHS	116.0 mm	90.0 deg	64.5 deg
23	1	23 - 40X3SHS	2001.7 mm	90.0 deg	76.5 deg
24	1	24 - 40X3SHS	1604.7 mm	90.0 deg	56.5 deg
25	1	25 - 40X3SHS	1644.8 mm	90.0 deg	56.5 deg
26	1	26 - 40X3SHS	920.5 mm	71.0 deg	56.5 deg
27	1	27 - 40X3SHS	1702.5 mm	90.0 deg	56.5 deg
28	1	28 - 40X3SHS	1408.7	90.0 deg	76.5 deg
29	4	29 - 40X3SHS	805.2 mm	70.0 deg	70.0 deg
30	3	30 - 40X3SHS	842.0 mm	64.5 deg	64.5 deg
31	4	31 - 40X3SHS	805.2 mm	70.0 deg	70.0 deg

NOTE:
 1. ALL HOT DIP GALVANISED STEEL 40 x 40 x 3mm SQUARE HOLLOW SECTION.
 2. PAINT ALL WELDS WITH ZINC PAINT

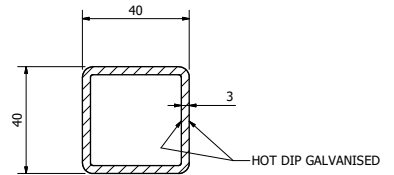

SECTION N-N
 SCALE(1 : 1)

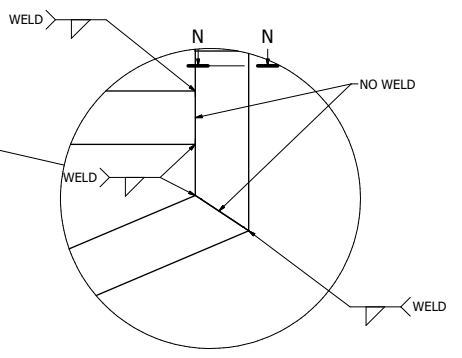

WELDING DETAIL K
 SCALE (1 : 2)

ISSUE	DATE	DRAWN	COMMENTS
E	19/10/18	S.L.	DECK BRACE ADDED
D	25/05/18	S.L.	BASE 4MM SMALLER ALL ROUND
C	13/04/18	S.L.	LENGTH OF ITEMS 12 13 15 16 17 19 20
B	4/12/17	S.L.	ITEM 21 & 29 POSITION FOR STAIRS
A	29/09/17	S.L.	ISSUED TO A-TECH FOR PROTOTYPE

DO NOT SCALE
 WORK TO DIMENSIONS
 3RD ANGLE
 PROJECTION



DRAWN Stephen	DATE 7/06/2017
CHECKED	DATE
APPROVED	DATE
SCALE NTS	

PROJECT IKON	SHEET 2 of 10
TITLE SPA FRAME FABRICATION	
DRAWING No: BRIDESON 4 FRAME WELDMENT	

PARTS LIST					
ITEM	QTY	DESCRIPTION	LENGTH	ANGLE1	ANGLE2
1	1	1 - 40X3SHS	1586.4 mm	45.0 deg	76.5 deg
2	1	2 - 40X3SHS	944.7 mm	90.0 deg	56.5 deg
3	1	3 - 40X3SHS	667.3 mm	71.0 deg	56.5 deg
4	1	4 - 40X3SHS	1449.4 mm	90.0 deg	56.5 deg
5	1	5 - 40X3SHS	984.7 mm	45.0 deg	56.5 deg
6	1	6 - 40X3SHS	993.4 mm	90.0 deg	76.5 deg
7	1	7 - 40X3SHS	1178.5 mm	90.0 deg	86.0 deg
8	1	8 - 40X3SHS	1232.0 mm	90.0 deg	86.0 deg
9	4	9 - 40X3SHS	728.0 mm	90.0 deg	90.0 deg
10	1	10 - 40X3SHS	835.0 mm	90.0 deg	63.0 deg
11	1	11 - 40X3SHS	615.0 mm	90.0 deg	63.0 deg
12	5	12 - 40X3SHS	57.0 mm	90.0 deg	70.0 deg
13	7	13 - 40X3SHS	120.0 mm	90.0 deg	90.0 deg
14	1	14 - 40X3SHS	920.0 mm	90.0 deg	90.0 deg
15	1	15 - 40X3SHS	1100.0 mm	90.0 deg	90.0 deg
16	4	16 - 40X3SHS	240.0 mm	90.0 deg	90.0 deg
17	1	17 - 40X3SHS	728.0 mm	90.0 deg	90.0 deg
18	1	18 - 40X3SHS	1240.0 mm	90.0 deg	90.0 deg
19	3	19 - 40X3SHS	52.0 mm	90.0 deg	64.5 deg
20	3	20 - 40X3SHS	80.0 mm	90.0 deg	90.0 deg
21	8	21 - 40X3SHS	107.0 mm	90.0 deg	70.0 deg
22	3	22 - 40X3SHS	116.0 mm	90.0 deg	64.5 deg
23	1	23 - 40X3SHS	2001.7 mm	90.0 deg	76.5 deg
24	1	24 - 40X3SHS	1604.7 mm	90.0 deg	56.5 deg
25	1	25 - 40X3SHS	1644.8 mm	90.0 deg	56.5 deg
26	1	26 - 40X3SHS	920.5 mm	71.0 deg	56.5 deg
27	1	27 - 40X3SHS	1702.5 mm	90.0 deg	56.5 deg
28	1	28 - 40X3SHS	1408.7 mm	90.0 deg	76.5 deg
29	4	29 - 40X3SHS	805.2 mm	70.0 deg	70.0 deg
30	3	30 - 40X3SHS	842.0 mm	64.5 deg	64.5 deg
31	4	31 - 40X3SHS	805.2 mm	70.0 deg	70.0 deg

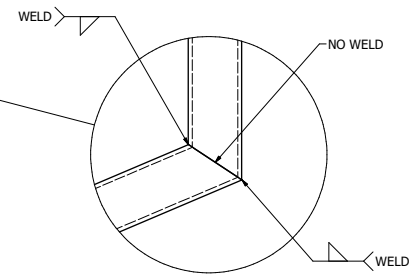
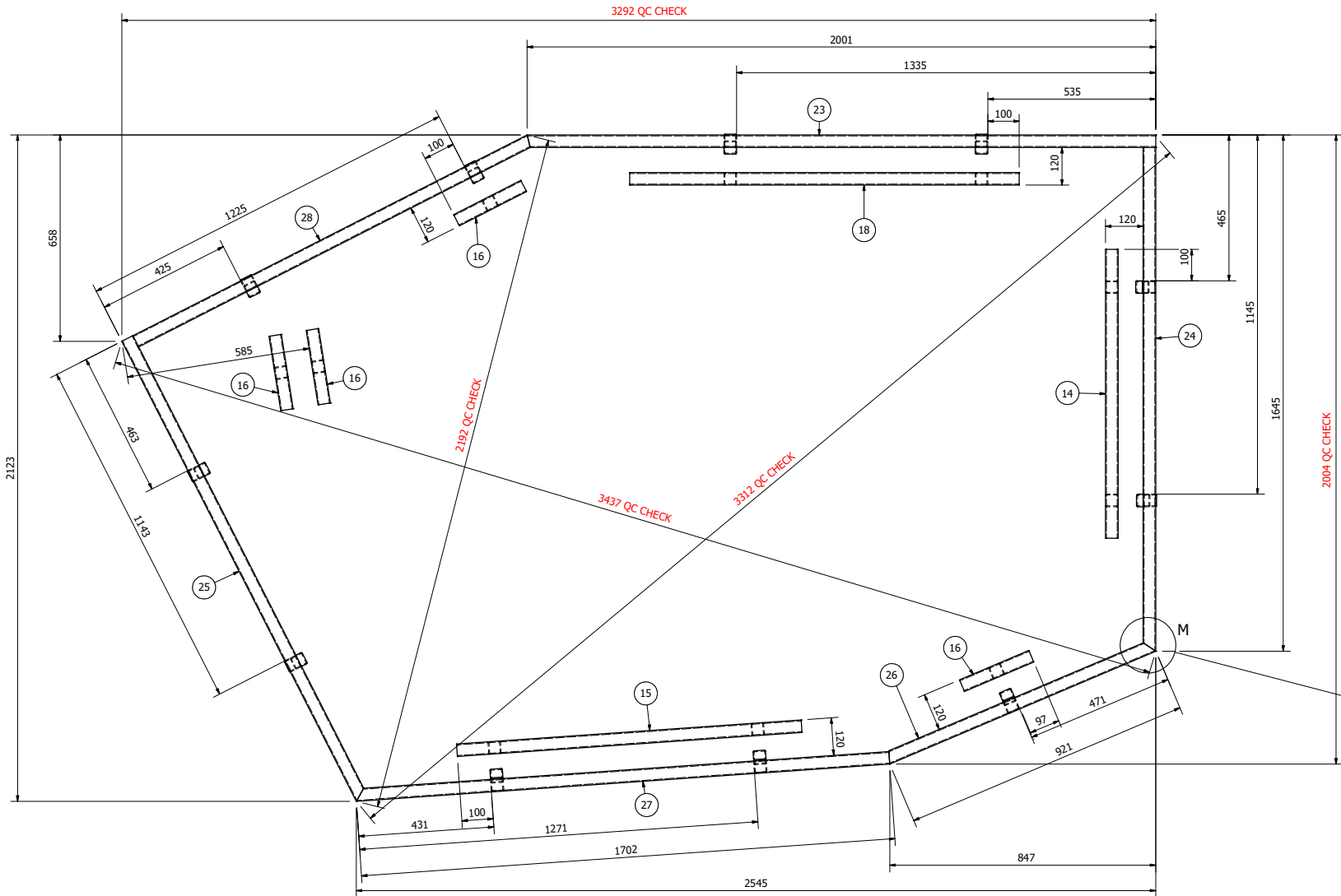

PRODUCTION - STEP 2
SECTION B
 SCALE (1 : 7)

WELDING DETAIL M
 SCALE (1 : 2)

ISSUE	DATE	DRAWN	COMMENTS
E	19/10/18	S.L.	DECK BRACE ADDED
D	25/05/18	S.L.	BASE 4MM SMALLER ALL ROUND
C	13/04/18	S.L.	LENGTH OF ITEMS 12 13 15 16 17 19 20
B	4/12/17	S.L.	ITEM 21 & 29 POSITION FOR STAIRS
A	29/09/17	S.L.	ISSUED TO A-TECH FOR PROTOTYPE

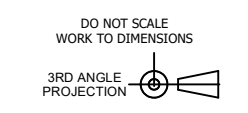

DRAWN Stephen	DATE 7/06/2017
CHECKED	DATE
APPROVED	DATE
SCALE NTS	

PROJECT IKON	SHEET 3 of 10
TITLE SPA FRAME FABRICATION	
DRAWING No: BRIDESON 4 FRAME WELDMENT	A1

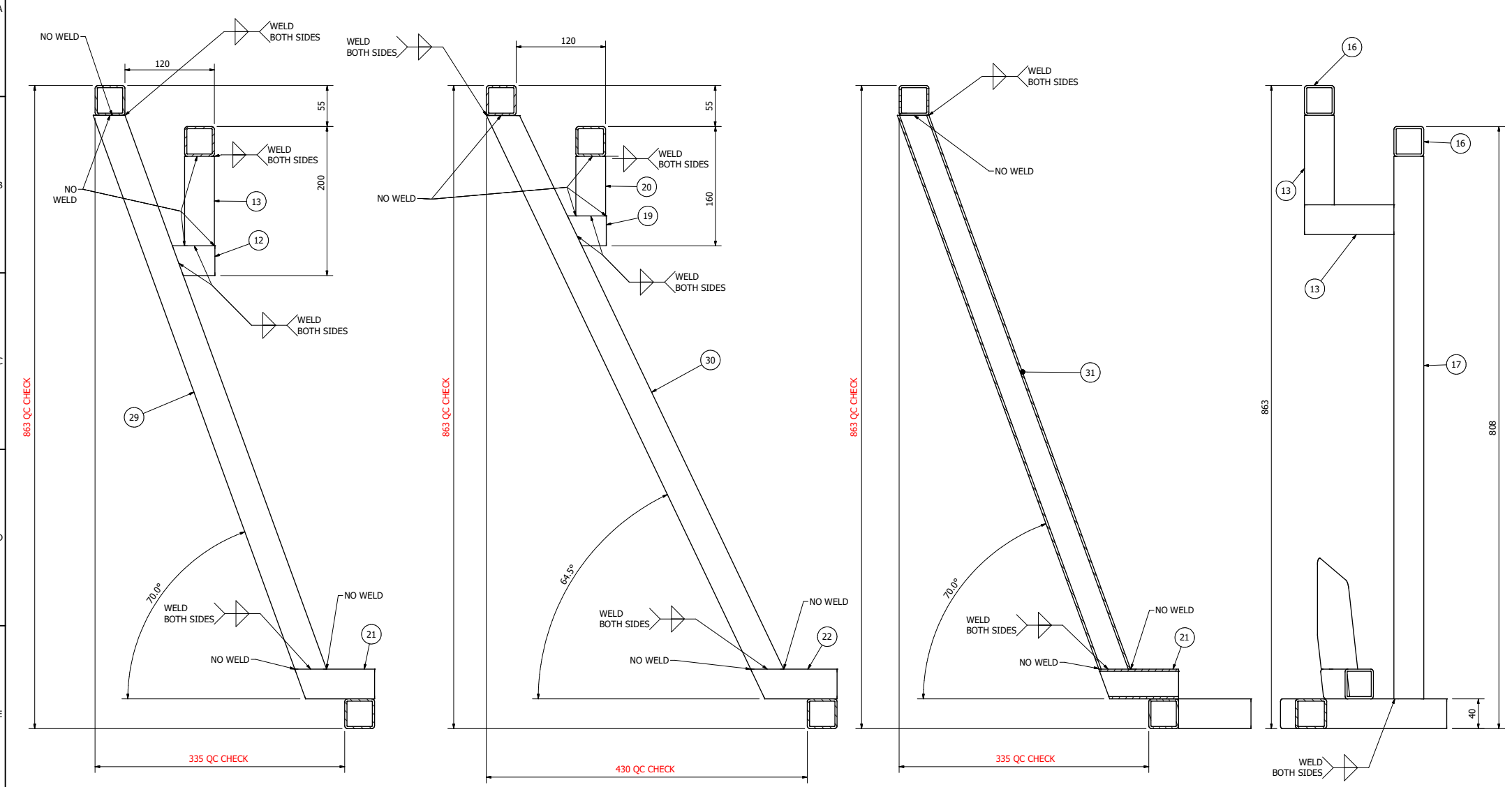

SECTION E-E
SCALE(1 : 2.5)

SECTION F-F
SCALE(1 : 2.5)

SECTION G-G
SCALE(1 : 2.5)

SECTION J-J
SCALE(1 : 2.5)

ISSUE	DATE	DRAWN	COMMENTS
E	19/10/18	S.L.	DECK BRACE ADDED
D	25/05/18	S.L.	BASE 4MM SMALLER ALL ROUND
C	13/04/18	S.L.	LENGTH OF ITEMS 12 13 15 16 17 19 20
B	4/12/17	S.L.	ITEM 21 & 29 POSITION FOR STAIRS
A	29/09/17	S.L.	ISSUED TO A-TECH FOR PROTOTYPE

DO NOT SCALE
WORK TO DIMENSIONS

3RD ANGLE
PROJECTION



DRAWN Stephen	DATE 7/06/2017
CHECKED	DATE
APPROVED	DATE
SCALE NTS	

PROJECT IKON	SHEET 4 of 10
TITLE SPA FRAME FABRICATION	
DRAWING No. BRIDESON 4 FRAME WELDMENT	

DRAWING No:
BRIDESON 4 FRAME WELDMENT

REFERENCE DRAWINGS:

PARTS LIST

ITEM	QTY	DESCRIPTION	LENGTH	ANGLE1	ANGLE2
1	1	1 - 40X3SHS	1586.4 mm	45.0 deg	76.5 deg
2	1	2 - 40X3SHS	944.7 mm	90.0 deg	56.5 deg
3	1	3 - 40X3SHS	667.3 mm	71.0 deg	56.5 deg
4	1	4 - 40X3SHS	1449.4 mm	90.0 deg	56.5 deg
5	1	5 - 40X3SHS	984.7 mm	45.0 deg	56.5 deg
6	1	6 - 40X3SHS	993.4 mm	90.0 deg	76.5 deg
7	1	7 - 40X3SHS	1178.5 mm	90.0 deg	86.0 deg
8	1	8 - 40X3SHS	1232.0 mm	90.0 deg	86.0 deg
9	4	9 - 40X3SHS	728.0 mm	90.0 deg	90.0 deg
10	1	10 - 40X3SHS	835.0 mm	90.0 deg	63.0 deg
11	1	11 - 40X3SHS	615.0 mm	90.0 deg	63.0 deg
12	5	12 - 40X3SHS	57.0 mm	90.0 deg	70.0 deg
13	7	13 - 40X3SHS	120.0 mm	90.0 deg	90.0 deg
14	1	14 - 40X3SHS	920.0 mm	90.0 deg	90.0 deg
15	1	15 - 40X3SHS	1100.0 mm	90.0 deg	90.0 deg
16	4	16 - 40X3SHS	240.0 mm	90.0 deg	90.0 deg
17	1	17 - 40X3SHS	728.0 mm	90.0 deg	90.0 deg
18	1	18 - 40X3SHS	1240.0 mm	90.0 deg	90.0 deg
19	3	19 - 40X3SHS	52.0 mm	90.0 deg	64.5 deg
20	3	20 - 40X3SHS	80.0 mm	90.0 deg	90.0 deg
21	8	21 - 40X3SHS	107.0 mm	90.0 deg	70.0 deg
22	3	22 - 40X3SHS	116.0 mm	90.0 deg	64.5 deg
23	1	23 - 40X3SHS	2001.7 mm	90.0 deg	76.5 deg
24	1	24 - 40X3SHS	1604.7 mm	90.0 deg	56.5 deg
25	1	25 - 40X3SHS	1644.8 mm	90.0 deg	56.5 deg
26	1	26 - 40X3SHS	920.5 mm	71.0 deg	56.5 deg
27	1	27 - 40X3SHS	1702.5 mm	90.0 deg	56.5 deg
28	1	28 - 40X3SHS	1408.7 mm	90.0 deg	76.5 deg
29	4	29 - 40X3SHS	805.2 mm	70.0 deg	70.0 deg
30	3	30 - 40X3SHS	842.0 mm	64.5 deg	64.5 deg
31	4	31 - 40X3SHS	805.2 mm	70.0 deg	70.0 deg

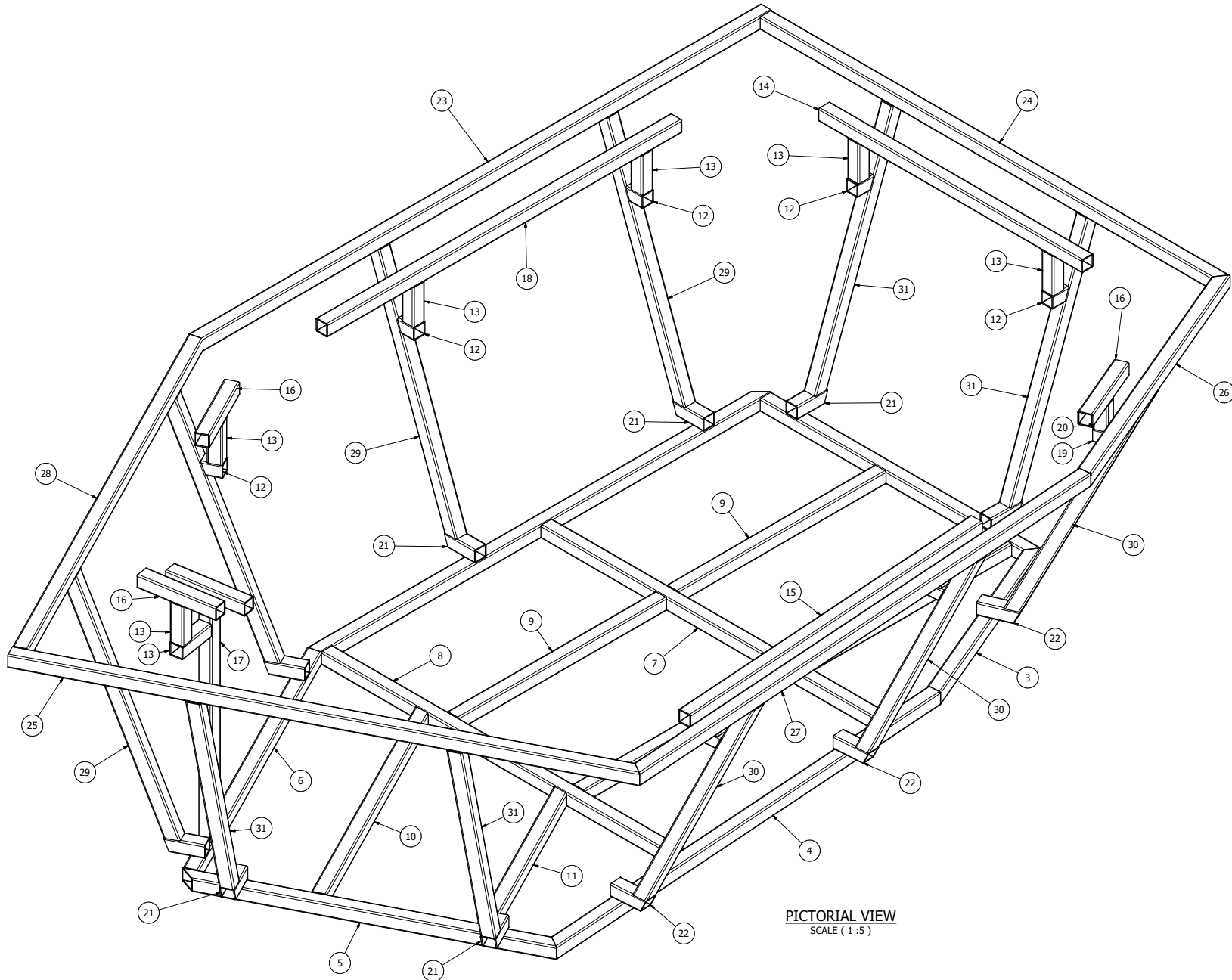

PICTORIAL VIEW
SCALE (1 : 5)

ISSUE	DATE	DRAWN	COMMENTS
E	19/10/18	S.L.	DECK BRACE ADDED
D	25/05/18	S.L.	BASE 4MM SMALLER ALL ROUND
C	13/04/18	S.L.	LENGTH OF ITEMS 12 13 15 16 17 19 20
B	4/12/17	S.L.	ITEM 21 & 29 POSITION FOR STAIRS
A	29/09/17	S.L.	ISSUED TO A-TECH FOR PROTOTYPE

DO NOT SCALE
WORK TO DIMENSIONS

3RD ANGLE
PROJECTION



DRAWN Stephen	DATE 7/06/2017	PROJECT IKON
CHECKED	DATE	TITLE SPA FRAME FABRICATION
APPROVED	DATE	
SCALE NTS		DRAWING No: BRIDESON 4 FRAME WELDMENT

DRAWING No:
BRIDESON 4 FRAME WELDMENT

REFERENCE DRAWINGS:

PARTS LIST

ITEM	QTY	DESCRIPTION	LENGTH	ANGLE1	ANGLE2
1	1	1 - 40X3SHS	1586.4 mm	45.0 deg	76.5 deg
2	1	2 - 40X3SHS	944.7 mm	90.0 deg	56.5 deg
3	1	3 - 40X3SHS	667.3 mm	71.0 deg	56.5 deg
4	1	4 - 40X3SHS	1449.4 mm	90.0 deg	56.5 deg
5	1	5 - 40X3SHS	984.7 mm	45.0 deg	56.5 deg
6	1	6 - 40X3SHS	993.4 mm	90.0 deg	76.5 deg
7	1	7 - 40X3SHS	1178.5 mm	90.0 deg	86.0 deg
8	1	8 - 40X3SHS	1232.0 mm	90.0 deg	86.0 deg
9	4	9 - 40X3SHS	728.0 mm	90.0 deg	90.0 deg
10	1	10 - 40X3SHS	835.0 mm	90.0 deg	63.0 deg
11	1	11 - 40X3SHS	615.0 mm	90.0 deg	63.0 deg
12	5	12 - 40X3SHS	57.0 mm	90.0 deg	70.0 deg
13	7	13 - 40X3SHS	120.0 mm	90.0 deg	90.0 deg
14	1	14 - 40X3SHS	920.0 mm	90.0 deg	90.0 deg
15	1	15 - 40X3SHS	1100.0 mm	90.0 deg	90.0 deg
16	4	16 - 40X3SHS	240.0 mm	90.0 deg	90.0 deg
17	1	17 - 40X3SHS	728.0 mm	90.0 deg	90.0 deg
18	1	18 - 40X3SHS	1240.0 mm	90.0 deg	90.0 deg
19	3	19 - 40X3SHS	52.0 mm	90.0 deg	64.5 deg
20	3	20 - 40X3SHS	80.0 mm	90.0 deg	90.0 deg
21	8	21 - 40X3SHS	107.0 mm	90.0 deg	70.0 deg
22	3	22 - 40X3SHS	116.0 mm	90.0 deg	64.5 deg
23	1	23 - 40X3SHS	2001.7 mm	90.0 deg	76.5 deg
24	1	24 - 40X3SHS	1604.7 mm	90.0 deg	56.5 deg
25	1	25 - 40X3SHS	1644.8 mm	90.0 deg	56.5 deg
26	1	26 - 40X3SHS	920.5 mm	71.0 deg	56.5 deg
27	1	27 - 40X3SHS	1702.5 mm	90.0 deg	56.5 deg
28	1	28 - 40X3SHS	1408.7	90.0 deg	76.5 deg
29	4	29 - 40X3SHS	805.2 mm	70.0 deg	70.0 deg
30	3	30 - 40X3SHS	842.0 mm	64.5 deg	64.5 deg
31	4	31 - 40X3SHS	805.2 mm	70.0 deg	70.0 deg

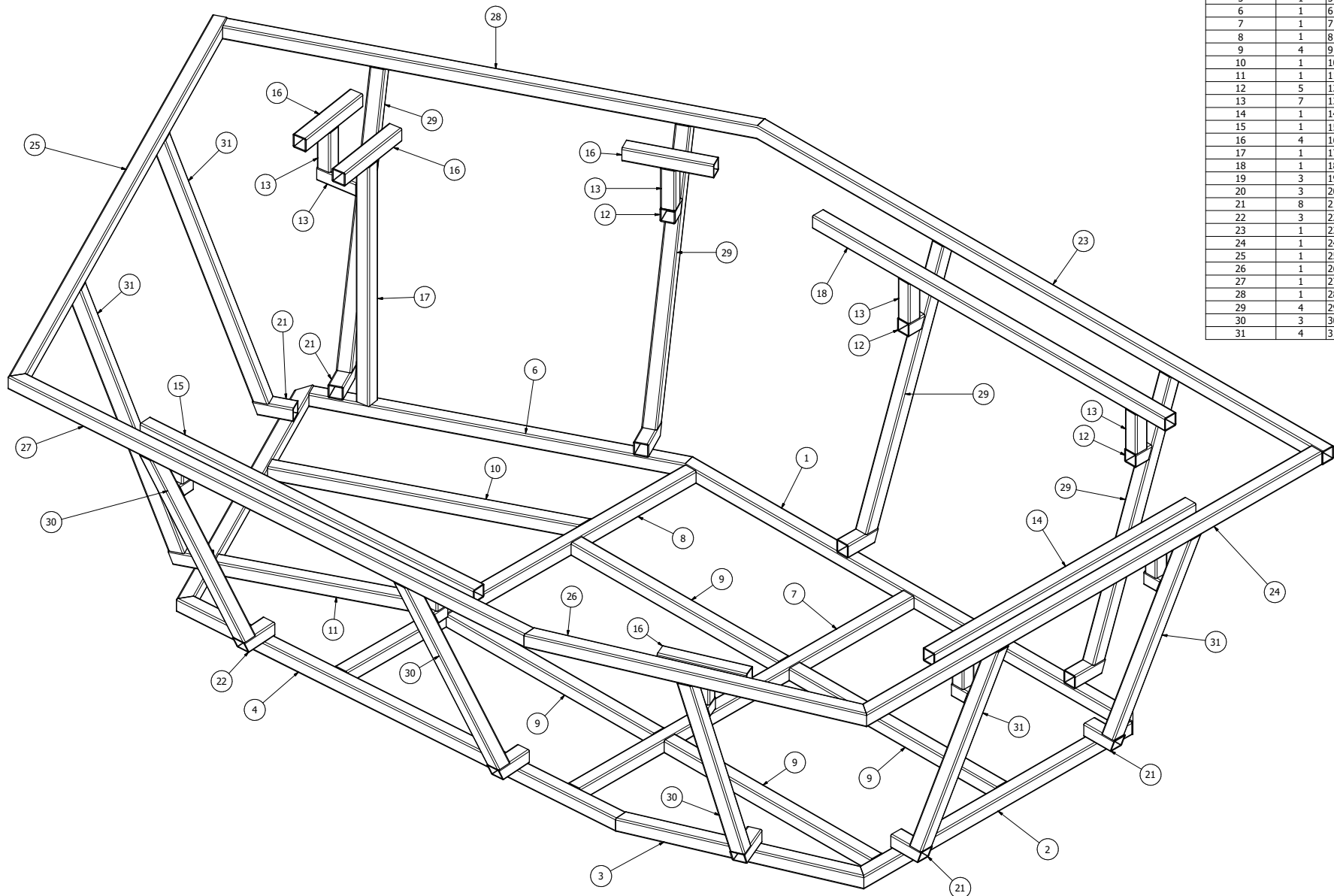

PICTORIAL VIEW
 SCALE (1 : 5)

ISSUE	DATE	DRAWN	COMMENTS
E	19/10/18	S.L.	DECK BRACE ADDED
D	25/05/18	S.L.	BASE 4MM SMALLER ALL ROUND
C	13/04/18	S.L.	LENGTH OF ITEMS 12 13 15 16 17 19 20
B	4/12/17	S.L.	ITEM 21 & 29 POSITION FOR STAIRS
A	29/09/17	S.L.	ISSUED TO A-TECH FOR PROTOTYPE

DO NOT SCALE
 WORK TO DIMENSIONS

3RD ANGLE
 PROJECTION

Vortex Spas

DRAWN Stephen	DATE 7/06/2017
CHECKED	DATE
APPROVED	DATE
SCALE NTS	

PROJECT IKON	SHEET 6 of 10
TITLE SPA FRAME FABRICATION	
DRAWING No: BRIDESON 4 FRAME WELDMENT	

DRAWING No. BRIDESON 4 FRAME WELDMENT
 REFERENCE DRAWINGS

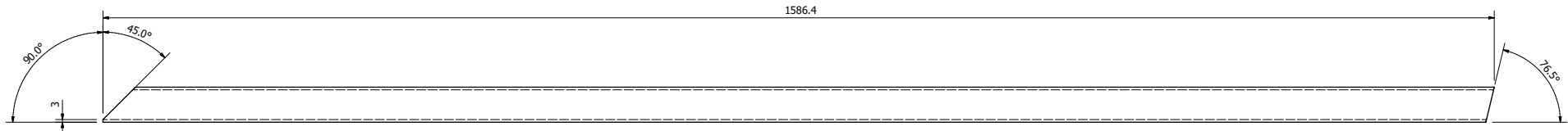

1 - 40X3SHS
 QUANTITY 1
 SCALE (1 : 2.5)

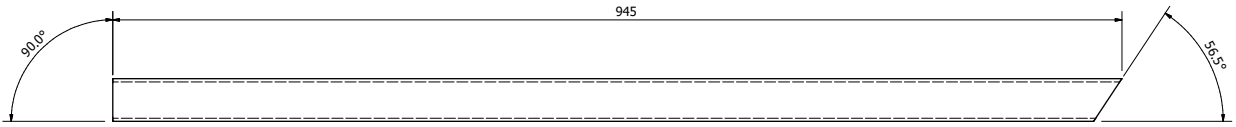

2 - 40X3SHS
 QUANTITY 1
 SCALE (1 : 2.5)

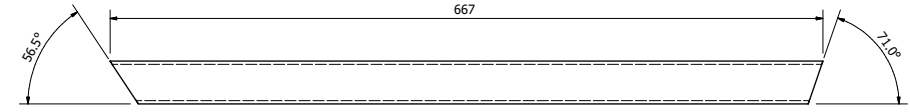

3 - 40X3SHS
 QUANTITY 1
 SCALE (1 : 2.5)

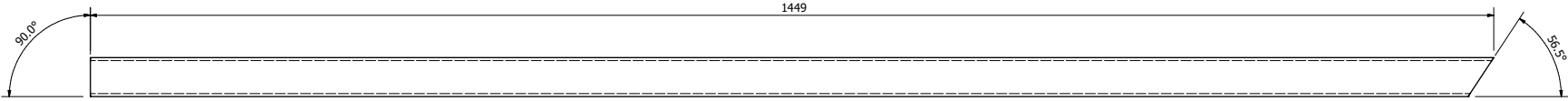

4 - 40X3SHS
 QUANTITY 1
 SCALE (1 : 2.5)

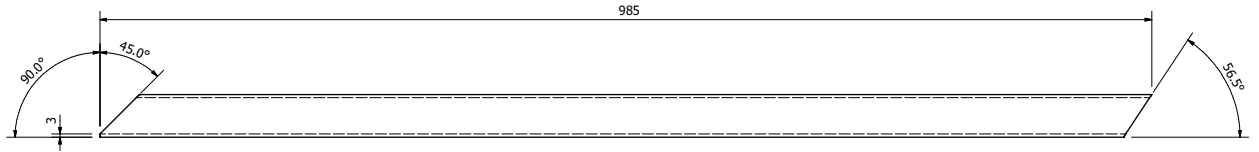

5 - 40X3SHS
 QUANTITY 1
 SCALE (1 : 2.5)

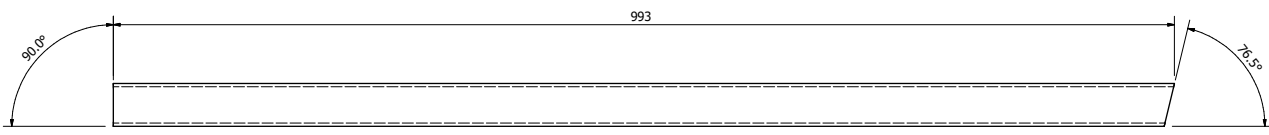

6 - 40X3SHS
 QUANTITY 1
 SCALE (1 : 2.5)

ISSUE	DATE	DRAWN	COMMENTS
E	19/10/18	S.L.	DECK BRACE ADDED
D	25/05/18	S.L.	BASE 4MM SMALLER ALL ROUND
C	13/04/18	S.L.	LENGTH OF ITEMS 12 13 15 16 17 19 20
B	4/12/17	S.L.	ITEM 21 & 29 POSITION FOR STAIRS
A	29/09/17	S.L.	ISSUED TO A-TECH FOR PROTOTYPE

DO NOT SCALE
 WORK TO DIMENSIONS
 3RD ANGLE
 PROJECTION



DRAWN Stephen	DATE 7/06/2017
CHECKED	DATE
APPROVED	DATE
SCALE NTS	

PROJECT IKON	TITLE SPA FRAME FABRICATION
DRAWING No. BRIDESON 4 FRAME WELDMENT	
SHEET 7 of 10	A1

DRAWING No. BRIDESON 4 FRAME WELDMENT
REFERENCE DRAWINGS

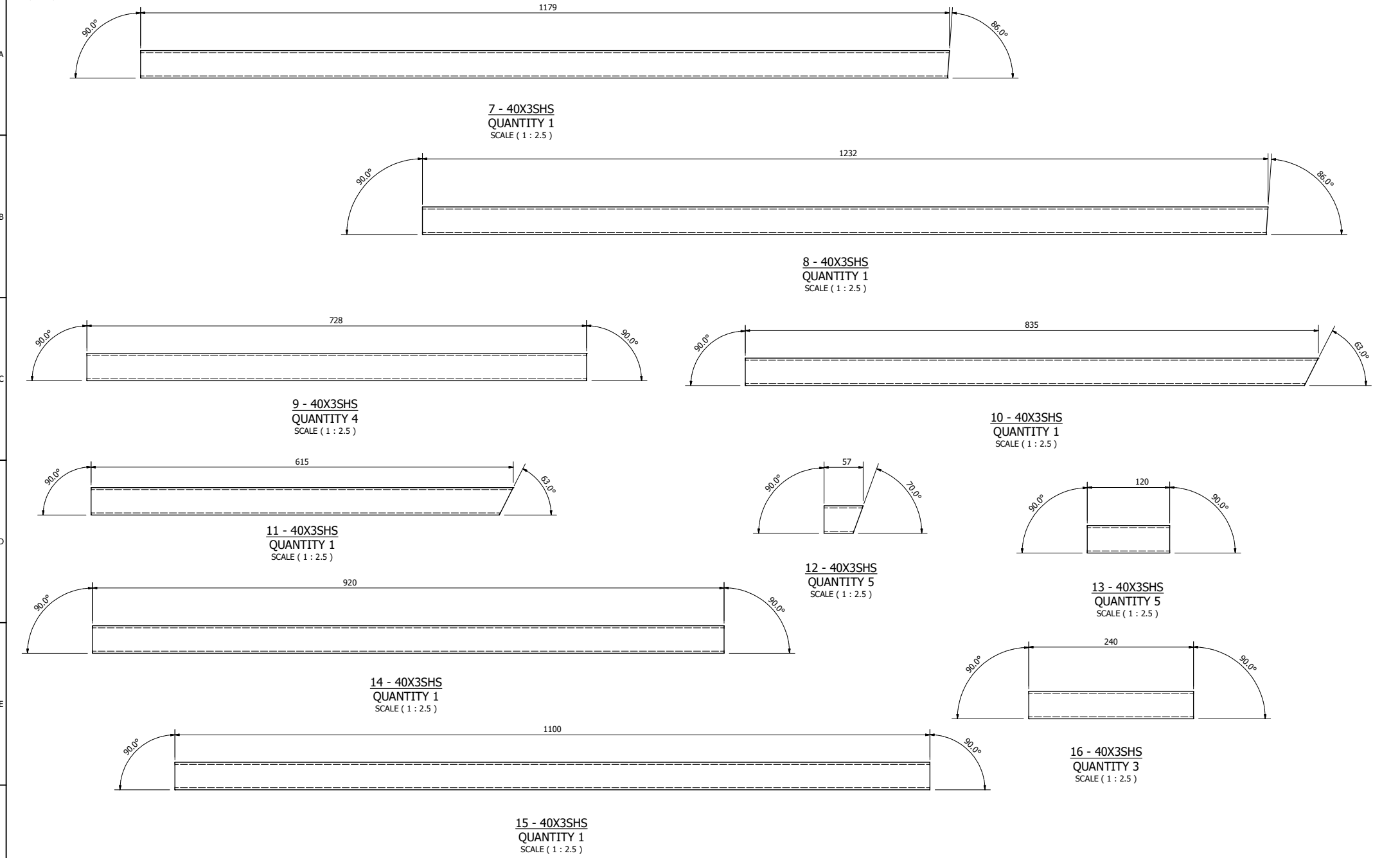

ISSUE	DATE	DRAWN	COMMENTS
E	19/10/18	S.L.	DECK BRACE ADDED
D	25/05/18	S.L.	BASE 4MM SMALLER ALL ROUND
C	13/04/18	S.L.	LENGTH OF ITEMS 12 13 15 16 17 19 20
B	4/12/17	S.L.	ITEM 21 & 29 POSITION FOR STAIRS
A	29/09/17	S.L.	ISSUED TO A-TECH FOR PROTOTYPE

DO NOT SCALE
WORK TO DIMENSIONS

3RD ANGLE
PROJECTION



DRAWN Stephen	DATE 7/06/2017
CHECKED	DATE
APPROVED	DATE
SCALE NTS	

PROJECT IKON	DRAWING No. BRIDESON 4 FRAME WELDMENT	SHEET 8 of 10	A1
TITLE SPA FRAME FABRICATION			

DRAWING No. BRIDESON 4 FRAME WELDMENT
REFERENCE DRAWINGS

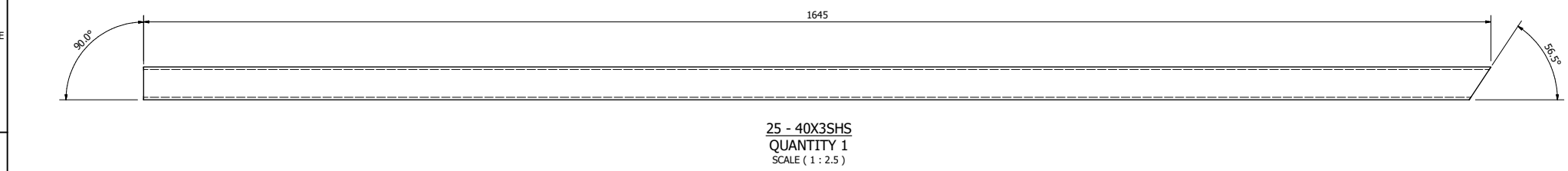
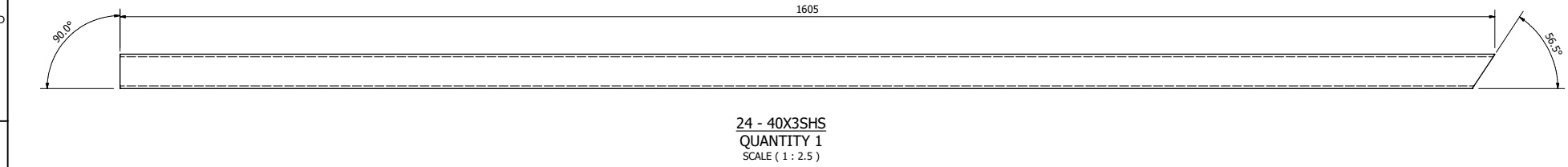
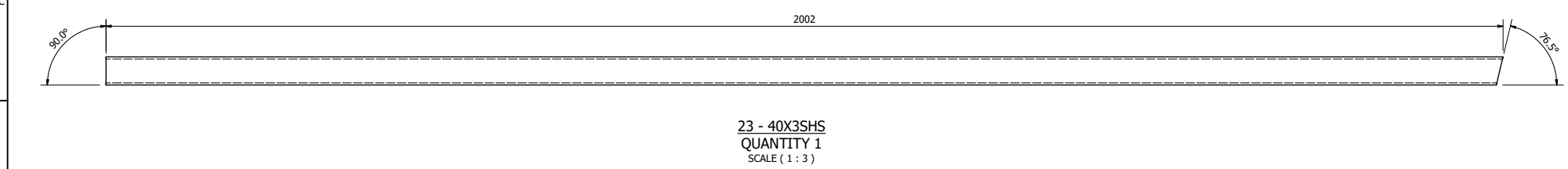
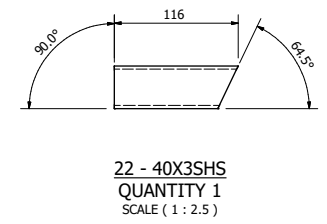
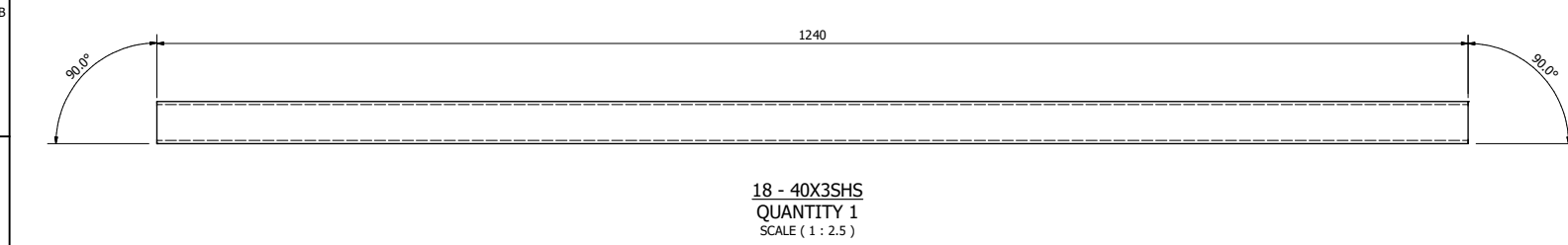
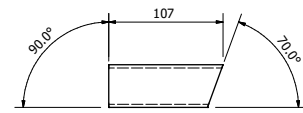
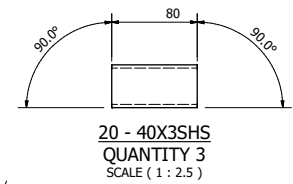
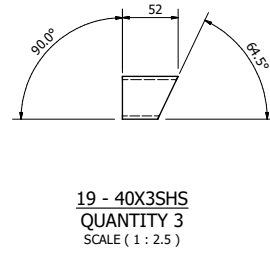
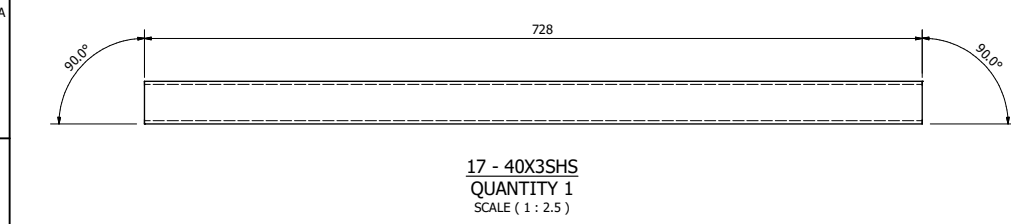

ISSUE	DATE	DRAWN	COMMENTS
E	19/10/18	S.L.	DECK BRACE ADDED
D	25/05/18	S.L.	BASE 4MM SMALLER ALL ROUND
C	13/04/18	S.L.	LENGTH OF ITEMS 12 13 15 16 17 19 20
B	4/12/17	S.L.	ITEM 21 & 29 POSITION FOR STAIRS
A	29/09/17	S.L.	ISSUED TO A-TECH FOR PROTOTYPE

DO NOT SCALE
WORK TO DIMENSIONS

3RD ANGLE
PROJECTION



DRAWN Stephen	DATE 7/06/2017
CHECKED	DATE
APPROVED	DATE
SCALE NTS	

PROJECT IKON	TITLE SPA FRAME FABRICATION
DRAWING No. BRIDESON 4 FRAME WELDMENT	
SHEET 9 of 10	A1

DRAWING No:
BRIDESON 4 FRAME WELDMENT

REFERENCE DRAWINGS:

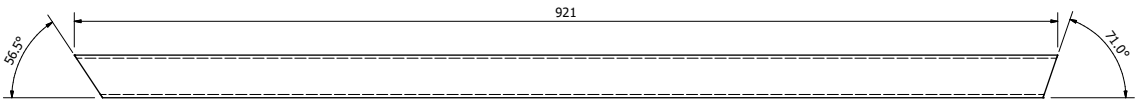

26 - 40X3SHS
QUANTITY 1
SCALE (1 : 2.5)

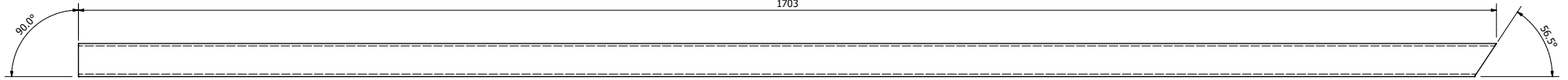

27 - 40X3SHS
QUANTITY 1
SCALE (1 : 2.5)

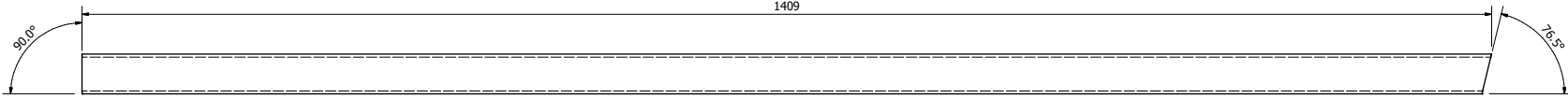

28 - 40X3SHS
QUANTITY 1
SCALE (1 : 2.5)

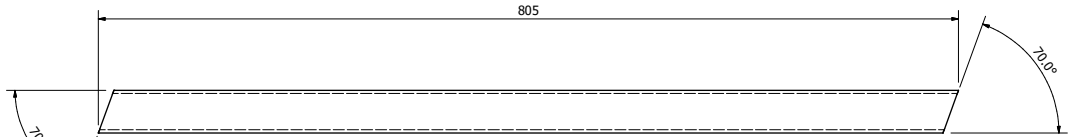

29 - 40X3SHS
QUANTITY 4
SCALE (1 : 2.5)

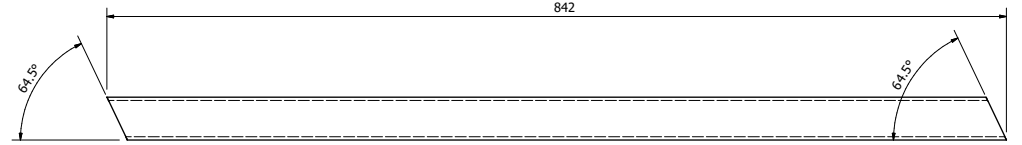

30 - 40X3SHS
QUANTITY 3
SCALE (1 : 2.5)

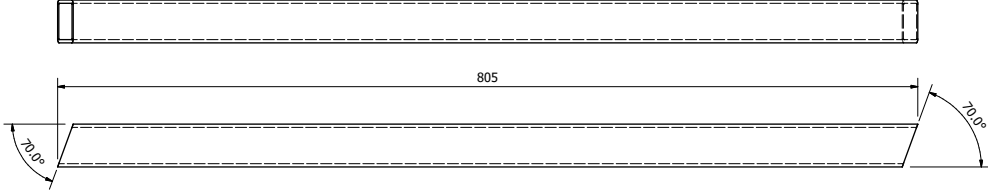

31 - 40X3SHS
QUANTITY 4
SCALE (1 : 2.5)

ISSUE	DATE	DRAWN	COMMENTS
E	19/10/18	S.L.	DECK BRACE ADDED
D	25/05/18	S.L.	BASE 4MM SMALLER ALL ROUND
C	13/04/18	S.L.	LENGTH OF ITEMS 12 13 15 16 17 19 20
B	4/12/17	S.L.	ITEM 21 & 29 POSITION FOR STAIRS
A	29/09/17	S.L.	ISSUED TO A-TECH FOR PROTOTYPE

DO NOT SCALE
WORK TO DIMENSIONS

3RD ANGLE
PROJECTION



DRAWN Stephen	DATE 7/06/2017	PROJECT IKON
CHECKED	DATE	TITLE SPA FRAME FABRICATION
APPROVED	DATE	DRAWING No: BRIDESON 4 FRAME WELDMENT
SCALE NTS		SHEET 10 of 10 A1

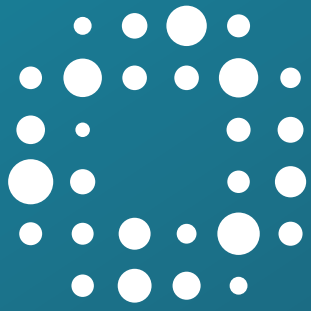

VortexTM Spas

Available exclusively at *Spa* WORLD