

Console Installation

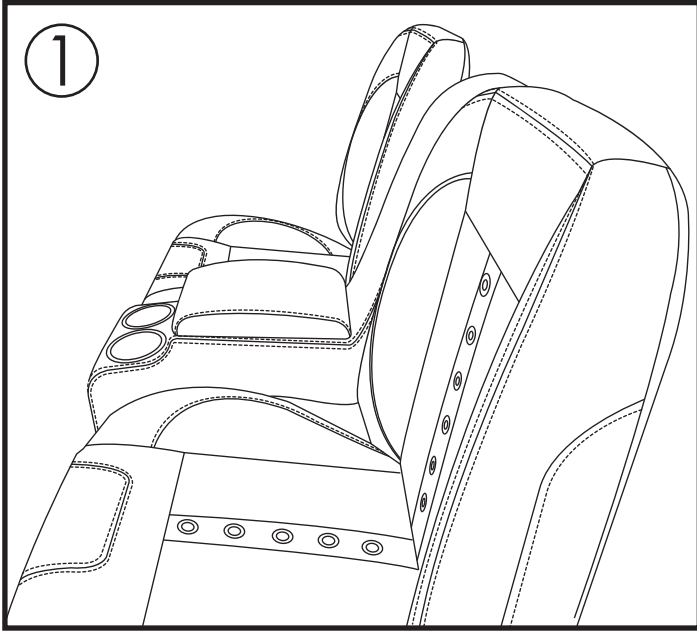

NOTE* SEATS MUST BE INSTALLED PRIOR TO CONSOLE INSTALLATION.



STEP 1: Place Console in between seats on top of Seat Bracket.

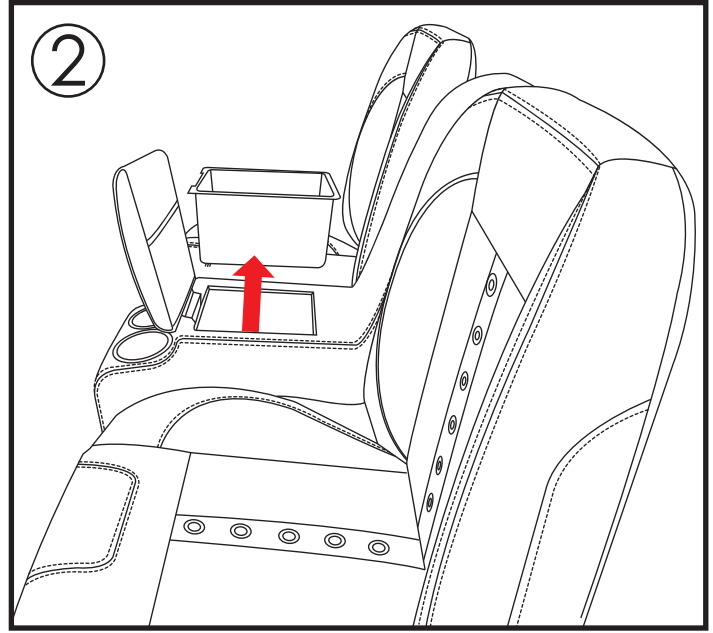

STEP 2: Remove the center console tray to screw in the L brackets to the seat frame.

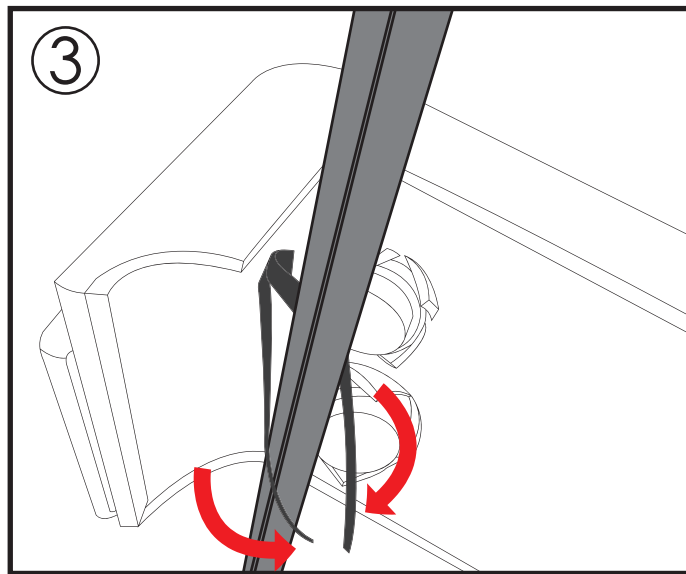

STEP 3: Use the Velcro strap to wrap around the rear bar multiple times to prevent movement of the center console.