

CHEVELLE DASH PAD INSTALLATION INSTRUCTIONS

PARTS:



TOOLS NEEDED FOR INSTALL:



SCREW GUN

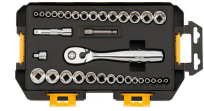

RACHET & SOCKET SET

NOTE: Extensive automotive skill and knowledge will be required to complete your new TMI Dash Pad Installation. THE USE OF AN EXPERT IS HIGHLY RECOMMENDED.

STEP 1. Steering wheel column will have to be lowered to remove the OEM dash pad. Begin by removing the 2 nuts holding the column bracket underneath the driver dash.

STEP 1B. Loosen the bolt almost all the way, but DO NOT remove it. The column will drop just enough to give you the clearance needed.

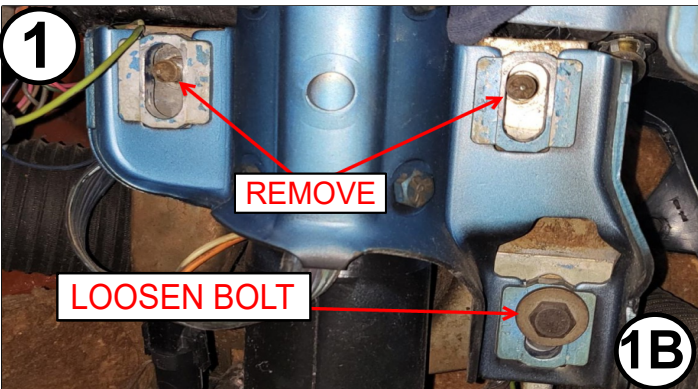

STEP 2. Place masking tape or a rag around the column to prevent scratches. Remove all screws around the instrument cluster trim. Loosen the bolts under the dash in each corner. This will allow the instrument cluster trim to lower just enough to give you access for hardware to be removed.



STEP 3. Reach in between the top dash and the instrument cluster dash trim. Locate the factory nuts holding the OEM dash pad. Remove them by using the corresponding socket and small ratchet. Once hardware has been removed, pull slowly on the dash pad to remove.

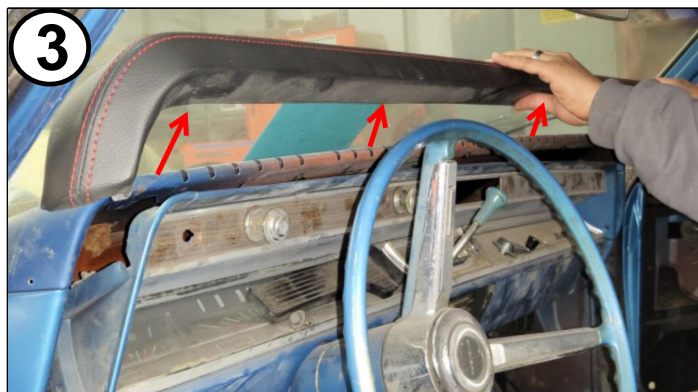

STEP 4. Install your new TMI dash pad by lining up the 4 studs into the factory dash holes. This step might take some finessing for the dash to snap into place. Once in place, replace the 4 nuts using 3/8 socket and ratchet. You may now replace and tighten all factory hardware on the instrument cluster trim and steering wheel column.

