

List of works

- | | |
|--|--|
| <p>1. <i>Small time</i>
Acrylic on cotton, 2022
30cm diameter</p> <p>2. <i>It escapes, irretrievable time</i>
Acrylic on cotton duck, 2022
60 x 80cm</p> <p>3. <i>Saffron</i>
Acrylic on cotton duck, 2022
150 x 200cm</p> <p>4. <i>Ceci n'est pas une orange, or the authority and failure of language</i>
Oil on cotton duck, 2022
42 x 51cm</p> <p>5. <i>Robin Red</i>
Acrylic on board, 2022
50 x 60cm</p> <p>6. <i>Time flies</i>
Acrylic on board, quartz clock mechanism
2022
60cm diameter</p> <p>7. <i>Disorder is more probable than order</i>
Plaster and acrylic paint, 2022
Dimensions variable</p> <p>8. <i>Yellow Red</i>
Acrylic on cotton duck, American red oak,
2022,
227 x 210 x 60cm
Tasmanian Oak frames</p> | <p>9. <i>a concrete poem (after Hansjörg Mayer)</i>
Acrylic on cotton duck, 2022
80 x 60cm</p> <p>10. <i>Atrophy Painting</i>
Acrylic on cotton duck, American red oak
2022
227 x 210 x 60cm</p> <p>11. <i>Anti-Entropy (LB Sainte Sébastienne)</i>
Acrylic on cotton duck, American red oak
2022
227 x 210 x 60cm</p> <p>12. <i>Useful order</i>
Plaster and acrylic paint, 2022
Dimensions variable</p> <p>13. <i>Time heals and divides</i>
Acrylic on cotton duck, 2022
80 x 60cm</p> <p>14. <i>Entropy Painting</i>
Acrylic on cotton duck, American red oak,
2022
227 x 210 x 60cm</p> |
|--|--|

Courtesy of the artist and ReadingRoom
(Naarm, Melbourne)

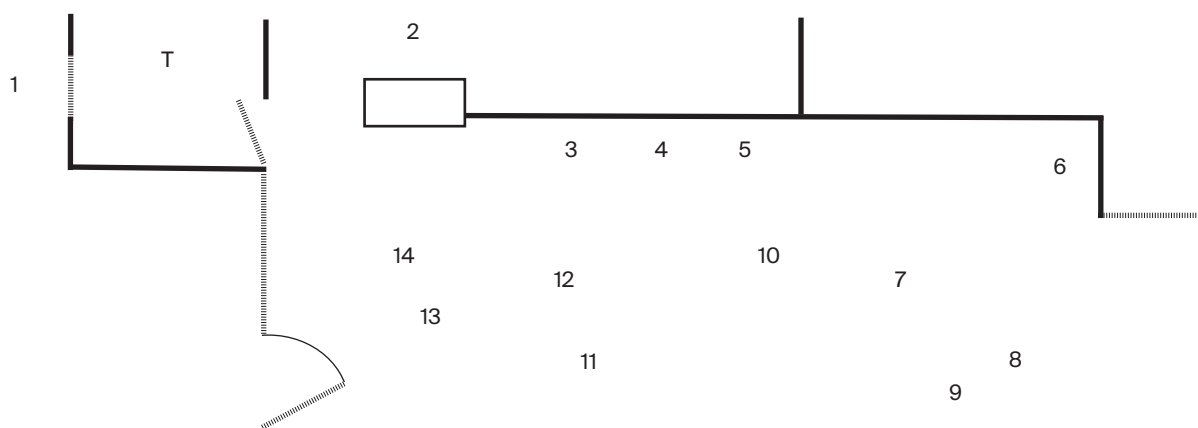

Darcey Bella Arnold

A Measure of Disorder

Gertrude Glasshouse

Thursday 11 March - Saturday 9 April 2022

Atrophy

/ˈatrəfi/

Noun: The process of atrophying or state of having atrophied.

Verb: (Of body tissue or an organ) to waste away, especially as a result of the degeneration of cells, or become vestigial during evolution. 'The calf muscles will atrophy'. Gradually decline in effectiveness or vigour due to underuse or neglect. 'The imagination can atrophy from lack of use.'

Entropy

/ˈɛntɹəpi/

Noun: entropy; plural noun: entropies; symbol: S

Physics: a thermodynamic quantity representing the unavailability of a system's thermal energy for conversion into mechanical work, often interpreted as the degree of disorder or randomness in the system. 'The second law of thermodynamics says that entropy always increases with time'. Lack of order or predictability; gradual decline into disorder. Information theory: a logarithmic measure of the rate of transfer of information in a particular message or language.

Living with aphasia – a condition that can impact the ability to communicate – the artist's mother Jennifer regularly uses the words *atrophy* and *entropy* as placeholder words in written and verbal conversation. Beginning in the studio with these two words, Darcey Bella Arnold tracks and drifts through family histories, artworks, and linguistics to form a body of research that arises from these terms. With touchpoints in Ferdinand de Saussure's Structural Linguistics of thought and sound, the oddity of René Magritte's image treachery, typography of Mutlu Çerkez, the orange arc of Elsworth Kelly, Louise Bourgeois's *Sainte Sebastienne*, pedagogical visual languages (the daughter of teachers) and the elasticity of language in concrete poetry, the practice of research informs Arnold's painting and sculptural works.

This research is a way of filling the body of the artist with the resonances that move through *atrophy* and entropy. The artist's practice provides a methodology for processing these embodiments through a painting and sculptural logic that enacts a measure of disorder.

Gertrude Glasshouse is generously supported by Michael Schwarz and David Clouston.

Gertrude Glasshouse is generously supported by the City of Yarra, through the 2022 Annual Grants Program.