

17/08/2021

Our Ref: GDL150442.5

Art Gallery of NSW
Attn: Ben Campbell
Art Gallery of NSW, Art Gallery Road
The Domain, Sydney NSW 2000

Art Gallery of NSW (AGNSW)
Art Gallery of NSW, Art Gallery Road, The Domain, Sydney NSW 2000
BCA DESIGN COMPLIANCE STATEMENT (CROWN CERTIFICATE)

Further to our engagement for the abovementioned project, please find attached the Building Code of Australia (BCA) Design Compliance Review completed in respect to the proposed AGNSW - Sydney Modern Projects (Initial Engagement Phase) RFT. ID - AGNSW 2015.47, as required by Section 6.28 of the Environmental Planning and Assessment Act.

In reviewing the content herein, we draw particular attention to both the design documentation listed and conditions of approval listed in this statement.

In terms of the conditions of approval, the content therein reflects BCA related matters that were not fully documented or need to be complied with during the construction to achieve compliance with the referenced BCA.

The builder and the applicant need to be aware of these conditions whilst undertaking the works, as they represent items that we shall either be focusing on in the inspection or be seeking installation certificates for on completion of the works, and it is the responsibility of the applicant and builder engaged for the works to ensure these are complied with as part of the works.

Should you have any further enquiries please do not hesitate to contact Shane Berry.

Yours faithfully



Justin Jones-Gardiner
Director

BCA DESIGN COMPLIANCE STATEMENT

PRELIMINARIES

STATEMENT NO.	GDL150442.5
Property Address	Art Gallery Road, The Domain, Sydney, NSW 2000 Lot 102 DP 854472, Lot 103 DP 1199151, Lot 34 DP 39586, Lots 107, 108 and 109 DP 1105308, Lot 4 DP 259027, Lot 51 DP 47732, Lot 35 DP 39586, Lot 9 DP 1007656 (Woolloomooloo Bay) , Lot 113 DP 1105308, Lot 1013 DP 1199151, and Lots 107, 108 and 115 DP 1105308 (Art Gallery Road), Mrs. Macquarie's Road, The Domain, and Lincoln Crescent and Cowper Wharf Road, Woolloomooloo
Client	Art Gallery of NSW (AGNSW)
Date	17/08/2021
Planning Approval	SSD 6471 dated 20 November 2018 S4.55 dated 17 September 2019
Proposal	Sydney Modern Expansion Project: <ul style="list-style-type: none"> • Demolition, earthworks and excavation works • Construction of new art gallery building • Remediation and conversion of former fuel bunker to gallery use • Construction of new entry plaza and associated canopy • New loading dock with access from Lincoln Crescent • Installation of seawater heat exchange system • Public domain and landscaping works, including new footpaths, public lifts and tree planting • Subdivision <p>THIS CROWN BUILDING WORKS CERTIFICATE IS LIMITED TO:</p> <ul style="list-style-type: none"> • Stage 2 Zone 1A: demolition, excavation, retaining structures and in-ground services only, as per Figure 1 below. <p>Note: This Certificate DOES NOT include the Art Garden design.</p>

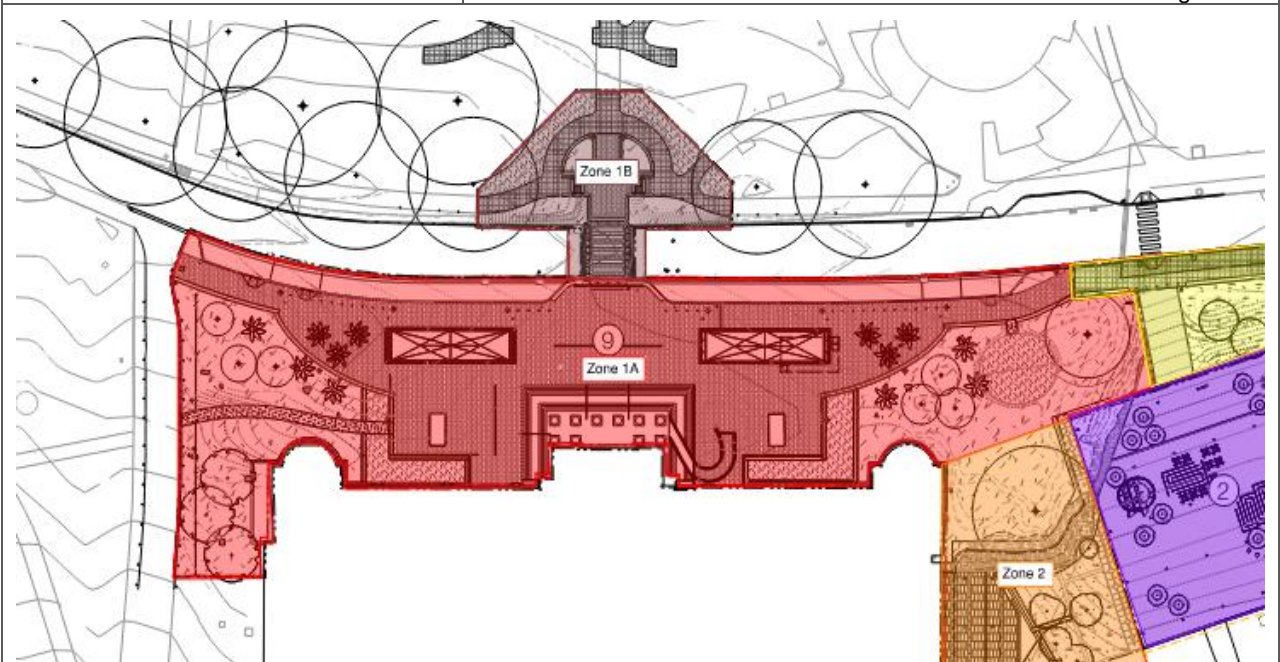

DEVELOPMENT DESCRIPTION

Proposed Works	Description
Classification(s):	Class 9b (Assembly Building), Class 7a (Loading Dock) Class 7b (Storage), Class 6 (Restaurant, Café)
Use of Building/Part:	Art Gallery
Subject Area (Area of Works):	Art Gallery of NSW, Art Gallery Road, The Domain, Sydney NSW 2000

BASIS OF STATEMENT:

This statement is based upon: -

- The National Construction Code, Volume 1, Building Code of Australia BCA Class 2-9 Buildings 2019 (BCA)
- The Design Documentation listed in this statement below

EXCLUSIONS

This statement relates only to the assessment and application of the Building Code of Australia to the proposed building works contained within the Design Documentation listed below and excludes: -

- Service providers requirements relating to electricity, gas, water and telecommunications
- The regulatory compliance of existing components/areas of the premises/site unaffected by the works.
- Any existing elements of the building, as this statement relates to BCA confirmation of new works only, and not an assessment of any existing elements or portions of the building
- Any elements the subject of the documentation relied upon, or the conditions are not the liability of Group DLA as reliance upon this documentation, certification and information in issuance of this statement.

STATEMENT OF COMPLIANCE

We hereby confirm that the proposed design shall accord with the relevant principles and provisions of the Building Code of Australia 2019 subject to: -

- Compliance with the conditions of approval nominated below; and
- Reliance upon the listed documentation relied upon, listed drawings/plans
- Certification of the installation of the relevant portions on completion of the works

CONDITION OF APPROVAL

The approval is subject to completion of the following conditions

- Provide endorsement of the CPTMP Rev F from TNSW
- Provide acceptance of the HMMP Rev 4 from SafeWork NSW EPA's

FIRE SAFETY SCHEDULE

Fire Safety Measure	Standard	BCA Clause(s)	Proposed Fire Safety Measures
Access panels, doors & hoppers to fire resisting shafts	AS 1530.4 – 2014 AS 1851 Amend 1 - 2012	C3.13	<input type="checkbox"/>
Automatic fail-safe devices	AS 1851-2012	C3.8, D2.21, Spec C3.4	<input type="checkbox"/>
Automatic fire detection & alarm systems Critical Fire Safety Measure – Inspection at AS 1851 intervals	AS 1670.1 – 2018 AS 1668.1 – 2015 AS 1851 Amend 1 - 2012 Fire Engineering Report No.247039 Rev I, issued by Arup Fire dated 16.07.2021	Spec E2.2b, EP2.1, EP2.2	<input type="checkbox"/>
Automatic fire suppression systems Critical Fire Safety Measure – Inspection at AS 1851 intervals	AS 2118.1 – 2017 AS 1851 Amend 1 - 2012 Fire Engineering Report No.247039 Rev I, issued by Arup Fire dated 16.07.2021	E1.5, Spec E1.5, NSW Table E2.2b, EP1.4	<input type="checkbox"/>
Emergency lighting	AS 2293.1 – 2018 AS1851-2012	E4.2, E4.4	<input type="checkbox"/>
Exit signs	AS 2293.1 – 2018 Fire Engineering Report No.247039 Rev I, issued by Arup Fire dated 16.07.2021	E4.5, NSW E4.6 & E4.8, EP4.2	<input type="checkbox"/>
Fire alarm monitoring system Critical Fire Safety Measure – Inspection at AS 1851 intervals	AS 1670.3 – 2018 AS 4428.6 – 1997 AS 1851 Amend 1 - 2012	Spec E2.2, Spec E1.5	<input type="checkbox"/>
Fire control centre facility	-	E1.8, Spec E1.8	<input type="checkbox"/>
Fire dampers Critical Fire Safety Measure – Inspection at AS 1851 intervals	AS 1668.1 – 2015 AS 1851 Amend 1 - 2012	Spec E2.2a	<input type="checkbox"/>
Fire doors Critical Fire Safety Measure – Inspection at AS 1851 intervals	AS 1905.1 – 2015 AS 1851 Amend 1 - 2012	Spec C3.4, C3.10	<input type="checkbox"/>
Fire doors (Concertina Won Door Gallery 8) Critical Fire Safety Measure – Inspection at 6-month intervals	AS 1905.1 – 2015 AS 1851 Amend 1 - 2012 Fire Engineering Report No.247039 Rev I, issued by Arup Fire dated 16.07.2021	D1.11, Spec C3.4, C3.6, C3.7, CP2, DP2	<input type="checkbox"/>
Fire hose reel systems Critical Fire Safety Measure – Inspection at AS 1851 intervals	AS 2441 – 2005 AS 1851 Amend 1 - 2012 Fire Engineering Report No.247039 Rev I, issued by Arup Fire dated 16.07.2021	E1.4, EP1.1	<input type="checkbox"/>
Fire hydrant systems Critical Fire Safety Measure – Inspection at AS 1851 intervals	AS 2419.1 – 2005 AS 1851 Amend 1 - 2012 Fire Engineering Report No.247039 Rev I, issued by Arup Fire dated 16.07.2021	E1.3, EP1.3, CP7	<input type="checkbox"/>

Fire Safety Measure	Standard	BCA Clause(s)	Proposed Fire Safety Measures
Fire seals (protecting openings in fire resisting components of the building) Critical Fire Safety Measure – Inspection at AS 1851 intervals	AS 4072.1 – 2005 AS 1530.4 – 2014 AS 1851 Amend 1 - 2012	C3.12, C3.13, C3.15	<input type="checkbox"/>
Fire curtain (Lift 3)	Fire Engineering Report No.247039 Rev I, issued by Arup Fire dated 16.07.2021 AS 1530.4 - 2005 AS 1851 Amend 1 - 2012 AS 1905.2 – 2005	Spec C3.4	<input type="checkbox"/>
Lightweight construction Critical Fire Safety Measure – Inspection at AS 1851 intervals	Fire Engineering Report No.247039 Rev I, issued by Arup Fire dated 16.07.2021 AS 1851 Amend 1 - 2012	C1.8, Spec C1.8, CP1, CP2	<input type="checkbox"/>
Mechanical air handling systems <ul style="list-style-type: none"> Auto shutdown Stair pressurisation Smoke exhaust Critical Fire Safety Measure – Inspection at AS 1851 intervals	AS 1668.1 – 2015 AS 1668.2 –2012 AS 1851 Amend 1 - 2012 Fire Engineering Report No.247039 Rev I, issued by Arup Fire dated 16.07.2021	E2.2, Spec E2.2a, Spec E2.2b, CP2, DP4, EP2.2	<input type="checkbox"/>
Portable fire extinguishers & fire blankets Critical Fire Safety Measure – Inspection at AS 1851 intervals	AS 2444 – 2001 AS 1851 Amend 1 - 2012	E1.6	<input type="checkbox"/>
Smoke dampers Critical Fire Safety Measure – Inspection at AS 1851 intervals	AS 1668.1 – 2015 AS 1851 Amend 1 - 2012	C3.15	<input type="checkbox"/>
Smoke doors (Gallery 1) Critical Fire Safety Measure – Inspection at 6-month intervals.	Fire Engineering Report No.247039 Rev I, issued by Arup Fire dated 16.07.2021	Spec C3.4	<input type="checkbox"/>
EWIS	Fire Engineering Report No.247039 Rev I, issued by Arup Fire dated 16.07.2021 AS 1670.4 – 2018 AS 4428.4 – 2004	E4.9, EP4.3	<input type="checkbox"/>
Wall wetting sprinklers & drencher systems (LL1 Café) Critical Fire Safety Measure – Inspection at AS 1851 intervals	AS 2118.1 – 2017 Tyco WS Fire Engineering Report No.247039 Rev I, issued by Arup Fire dated 16.07.2021	E1.5, EP1.4	<input type="checkbox"/>
Warning and operational signs	-	C3.6, E3.3, D2.23 & Spec E1.8	<input type="checkbox"/>
Paths of Travel	Fire Engineering Report No.247039 Rev I, issued by Arup Fire dated 16.07.2021	D1.6, D1.10, DP4, DP5, DP6, EP2.2	<input type="checkbox"/>
Fire Engineering Report No.247039 Rev I, issued by Arup Fire dated 16.07.2021: 7.1 Lift Reduction in FRL's and motor separation – CP2/CP6	Fire Engineering Report No.247039 Rev I, issued by Arup Fire dated 16.07.2021	CP1, CP2, CP6, CP7, CP8, DP2, DP4, DP5, EP1.1, EP1.2, EP1.3,	<input type="checkbox"/>

Fire Safety Measure	Standard	BCA Clause(s)	Proposed Fire Safety Measures
7.2 Reduced FRL's – Loadbearing – CP1		EP1.4, EP1.6, EP2.2, EP4.3	
7.3 Reduced FRL's – CP2			
7.4 Entry foyer FH more than 4 m from exit – EP1.3			
7.5 Rationalisation of fire hose reel coverage – EP1.1			
7.6 Rationalisation of smoke hazard management – CP2, DP4, EP2.2			
7.7 Rationalisation of folding fire door, Gallery 8 – CP2, DP2			
7.8 Fire hydrant booster not located within sight of the main entrance – EP1.3, EP1.6			
7.9 Exit discharge rationalisation, into covered loading dock – DP5			
7.10 Extended travel distances – DP4, EP2.2			
7.11 Justification of academic non-compliances as caused by the building straddling multiple Lots – CP1, CP2, CP8, DP4, EP1.1, EP1.2, EP1.3, EP1.4, EP1.6, EP.2, EP4.3			
7.12 Removed.			
7.13 Entry Pavilion exit discharge – DP4			
7.14 Oversized fire compartment – CP2			
7.15 Sprinklered compartment +10,000m ² with only 2 FH operational – EP1.3, EP1.6			
7.16 Omission of sprinkler protection to certain areas – EP1.4, CP2			
7.17 Omission of sprinkler protection to certain areas – EP1.4, CP2			
7.18 Omission of sprinkler protection to certain areas – EP1.4, CP2			
7.19 Digital readout display to Fire Pumps in lieu of pressure filled gauges - EP1.3			
7.20 LL3 plant stair discharge location rationalisation – DP4			
7.21 Omission of panic bars to certain doors – DP4			
7.22 Certain rooms opening directly into a fire-isolated exit – DP5, EP2.2			
7.23 Non-fire rated penetration between the Entry Foyer and the LL1 Mezz ventilation plenum – CP2, CP8			

Fire Safety Measure	Standard	BCA Clause(s)	Proposed Fire Safety Measures
7.24 Altered sprinkler pump set provisions – EP1.4			
7.25 No fire rated opening protection to the emergency generator room – CP2, CP7			
7.26 To permit Lift 8 to be within Gallery 8 fire stair – CP2, DP5, EP2.2			
7.27 Sliding doors concealing exit doors at Gallery 1, 2 & 3 – DP2, DP4			
7.28 No FRL insulation rating to the fire and smoke curtain providing separation between LL2 and the spiral stair from Gallery 8 – CP2			
7.29 Fire stair 6 discharges to adjacent unprotected louvre opening – DP5, EP2.2			
7.30 Internal doors in the path of travel do not release on fire alarm – DP4, EP2.2			
7.31 External exit sliding doors do not fail-safe open outside of office hours – DP4			
7.32 Sliding smoke door to form the smoke compartmentation between Gallery 1 and Entry Pavilion – DP2, DP4			
7.33 Rationalisation of SSISEP sounding – Gallery 8 – EP4.3			
7.34 To permit EWIS speaker testing variations – EP4.3			
7.35 Omission of fire protection to structural steel members within the Gallery 3/8 void space – CP1			
7.36 Omission of sprinkler protection within the Gallery 3/8 void space, which consists of the G3 slab supported by non-fire rated steel members the subject of – CP2, EP1.4			
7.37 Allow pre-action sprinkler system to be provided with pipework that is non-sloping- EP1.4			
7.38 Omission of sprinkler coverage and smoke exhaust in the Mingwei Gallery space – EP1.4, EP2.2			
7.39 Gallery 1 maintenance corridor at Entry Level to have a reduced egress – DP2, DP6			

Fire Safety Measure	Standard	BCA Clause(s)	Proposed Fire Safety Measures
7.40 Allow reduced insulation fire rating for the composite floor slabs at Entry Level, Lower Level 1 and Lower Level 2 – CP1, CP2			
7.41 Sprinklers in Galleries 1, 2 and 3 above and below ceiling not provided with same spacing – EP1.4, EP2.2			
7.42 Allow the use of two lengths of fire hydrant hose to achieve coverage – EP1.3			
7.43 Fire protection to Gallery 1 façade support – CP1			
7.44 Omission of fire safety system to Ausgrid substation – EP1.3, EP4.1, EP4.2, EP4.3			
7.45 Omission of sprinkler protection to portion LL1 Mezzanine void – CP2, EP1.4			
7.46 To permit fire rated steel connections to have unprotected secondary elements connected to a fire-rated primary structural member – CP1			

DESIGN DOCUMENTATION

The following architectural documentation was reviewed as part of this assessment;

Drawing No.	Title	Prepared By	Revision	Date
SMP-A-0000X32	Existing Site Plan	SANAA	A	16/12/2019
SMP-L-0000X04	Legend	SANAA	8	23/07/2021
SMP-L-0000X06	Site Plan	SANAA	9	23/07/2021
SMP-L-0000X08	Stage 2 Zone 1 Demolition Plan	SANAA	1	23/07/2021
SMP-L-0000X09	Tree Removal Plan	SANAA	1	23/07/2021
SMP-L-1000X10	Stage 2 Zone 1 Layout & Grading Plan	SANAA	1	23/07/2021
SMP-L-1001X10	Stage 1 Zone 1 Materials Plan	SANAA	1	23/07/2021
SMP-L-1002X10	Stage 2 Zone 1 Planting Plan	SANAA	1	23/07/2021

SUPPLEMENTARY DOCUMENTATION

The following additional documentation was reviewed as part of this assessment, and has been relied upon in confirming compliance for those elements listed / certified or confirmed as compliant;

- Application for Crown Certificate Form issued by Hakan Harman of Art Gallery NSW Trust, dated 06/08/2021
- Letter of Compliance of SSD Condition 64 – Air Quality and Odour Management Plan issued by Raghuram Muguli of Coffey, dated 13/08/2021
- Letter of Compliance of SSD Condition B69 – Hazardous Materials Management Plan issued by Raghuram Muguli of Coffey, dated 13/08/2021
- Confirmation no other Section 4.55 have been applied for other than MOD 5, Aconex from Katerina Plastiras from Richard Crookes Construction, issued 16/07/2021
- Confirmation of compliance with DA Condition A9 issued by Andrei Stevanovic of Infrastructure NSW dated 04/08/2021
- Geotechnical Monitoring for Sydney Modern Minor Works for CC5 Scope issued by Gena Gabbassova of Tetra Tech Coffey, dated 12/08/2021
- Geotechnical Excavation and Monitoring Plan, Revision 4 issued by Tetra Tech Coffey, dated 02/04/2020
- Letter of Compliance of SSD Condition 16B – Geotechnical Excavation and Monitoring Plan issued by Gena Gabbassova of Tetra Tech Coffey, dated 12/08/2021
- Letter of Compliance of SSD Condition B37 – Bicycle Parking issued by Siew Hwee Kong of Transport and Traffic Planning Associates, dated 27/07/2021
- Confirmation current Sydney Water Plans for CC1 remains valid for CC5 Aconex from Jimmy Pham of Richard Crookes Construction, dated 24/07/2021
- Confirmation no demolishing works applicable to CC5 Aconex from Katerina Plastiras of Richard Crookes Construction, dated 51/07/2021
- Construction Pedestrian and Traffic Management Plan, Reference No. 142/2019, Issue F issued by TTPA, dated August 2021
- Air Quality and Odour Management Plan Reference No. SYDGE234348-RCC AQOMP R02 Revision 02, issued by Coffey, dated 06/08/2021
- Hazardous Materials Management Plan Reference No. 754-SYDGE234348 – RCC HMMP R03 Revision R04 issued by Coffey, dated 06/08/2021
- Erosion and Sediment Control Plans issued by SANAA

- Long Service Levy Receipt of Payment No. 00496544, dated 26/07/2021
- BCA Design Compliance Statement issued by Paul McAtomney of McGregor Coxall, dated 26/04/2021
- Civil / Structural Design Certificate for CC5 and associated plans issued by Karen Seeto and Andrew Phillips of ARUP, dated 02/08/2021
- Confirmation that the Geotech Report submitted for CC1, CC2, CC3, and CC4, remains valid for CC5 Confirmation from Jimmy Pham, Richard Crookes Construction, dated 19/07/2021
- Dial Before You Dig Reference No. 30038672 issued by John Trimmer, dated 02/07/2021
- Design Certificate for Hydraulic Services and associated plans issued by Acor, dated 11/08/2021
- Fire Assessment Report No. FC12215-001 for fire resistance assessment of Stobich fire curtains issued by Branz, dated 30/03/2020
- Confirmation that fire stair 01 is fully fire rated and independently supported issued by John Jeffrey of Architectus dated 06/08/2021
- Test Report No. 14-000003 for Marmoleum 2.5mm sheet flooring TS2 Code 3244 Linoleum Sheeting issued by Michael A. Jackson of Australian Wool Testing Authority Ltd, dated 09/10/2014
- Electrical Services Plans issued by Steensen Varming
- Design Certificate for Water Feature – Hydraulic, Filtration, Treatment and Electrical Control Works Plans and associated plans issued by SDC Engineering, dated 16th August 2021
- Structural Design certificate and associated plans issued by ALJ Consulting Engineers, dated 16th August 2021
- Letter of Confirmation of no changes to CC5 Checklist items issued by Christo Derbyshire of Richard Crookes Constructions, dated 12/08/2021

Information previously relied upon in Crown Certificate GDL150442.4, dated 03/07/2020;

- Application for Crown Certificate Form issued by Hakan Harman of Art Gallery NSW Trust, dated 22/06/2021
- Confirmation of no additional Section 4.55 has been applied for other than Mod 5 issued by Bella Basagliia of Richard Crookes Constructions, dated 09/07/2021
- Confirmation of Compliance with DA Condition A9 issued by Andrej Stevanovic of Infrastructure NSW dated 06/07/2021
- Structural Design Statement for Stair GD.03 issued by Andrew Phillips of ARUP, dated 03/07/2021
- Email Confirmation of acceptable travel distance allowance issued by Claire Mouclier of Infrastructure NSW dated 09/02/2021
- Email Confirmation of no Performance Solutions issued by Bella Basagliia of Richard Crookes Constructions, dated 16/04/2021
- Test Report No. FCO-2960, Rev A for resistance of Firecore TVC doorsets incorporating various Kilargo Seals issued by Keith Nicholls of CSIRO, dated 26/09/2019
- Confirmation of No Card Readers in Fire Isolated Stairs issued by Bella Basagliia of Richard Crookes Constructions, dated 15/04/2021
- Confirmation that the Fire Stairs will not be used as Communication Stairs nor contain Card Readers inside issued by Claire Mouclier of Infrastructure NSW dated 09/04/2021
- OEH Condition B22 – External Materials Report issued by SANAA and Architectus, dated 06/04/2019
- Letter of Satisfaction for DA Condition B22 issued by Katrina Stankowski of Department of Environment and Heritage, dated 03/06/2019
- Letter referencing DA Condition B29 issued by AGNSW
- Letter of Satisfaction for DA Condition B29 – Wayfinding and Signage issued by Sarah Cope of Studio Ongarato, dated 15/03/2021
- Wayfinding and Signage Tender Documentation issued by Studio Ongarato, dated 15/10/2020

- Letter of Confirmation for DA Condition B29 (e) and (f) issued by Josh Milston of JMT Consulting, dated 25/03/2021
- SMP SSDA of Consent b29 - Wayfinding and Signage Consultation Summary of Meeting
- Memo referencing DA Condition B31, B32, B34, B35 and B36 issued by James von Dinklage of LCI Consultants, dated 30/06/2021
- Design Certificate for Hydraulic Services and associated Plans issued by Burt de Keyzer of ACOR Consultants Pty Ltd, dated 21/06/2021
- Operational Overlay Plans issued by SANAA and Architectus
- Structural Design Certificate and associated plans issued by Andrew Phillips of ARUP, dated 20/07/2021
- Confirmation of no Civil Stormwater Works are applicable to CC4 issued by Karen Seeto of ARUP, dated 16/06/2021
- Design Certificate for Mechanical Services and associated plans issued by Daniel Sullivan of D&E Air Conditioning Pty Ltd, dated 19/07/2021
- Design Certificate for Electrical Services and associated Plans issued by Nevin Zeng of Nilsen NSW Australia Pty Ltd, dated 16/07/2021
- Design Certificate for Fire Services and associated plans issued by Jason Tait of BSA, dated 19/07/2021
- Structural Design Certificate for Hydraulic Services and associated plans issued by Dale C. Carr of Dale C. Carr & Associates, dated 12/07/2021
- Letter of Confirmation of SSD items issued with previous Certificates remain valid issued by Christo Derbyshire of Richard Crookes Constructions Pty Ltd, dated 14/04/2021
- Compliance Statement for Accessibility issued by Elisa Moechtar of Group DLA, dated 23/07/2021
- Access Design Review Report for Crown Building Works Certificate 4 issued by Group DLA Access Consultancy dated 23/07/2020
- Fire Engineering Report No. 247039, Revision I issued by ARUP, dated 16/07/2021
- Fire Engineering Report Peer Review No. 112004-FEPR-r3 issued by BCA Logic, dated 28/06/2021
- Confirmation of all items in the BCA Logic Fire Engineering Report Peer Review dated 28/06/2021 re closed out, except for Items 11 and 12 which are captured in FER Revision J Aconex Correspondence issued by James Murch of SGA Fire, dated 21/07/2021 and Oliver Gibson of ARUP Fire, dated 20/07/2021
- Façade Proofing Performance Solution Report No. 19127, Revision 01 issued by Surface Design, dated 17/12/2020
- Aconex Confirmation of Façade and Reflectivity Deign Statement for CC3 has not been modified for CC4 issued by Anthony Khoury of Richard Crookes Constructions Pty Ltd, dated 23/07/2021 and Robert Moisy of Surface Design, dated 23/07/2021
- JV3 Verification Assessment Report for CC4, Revision 01, issued by James von Dinklage of LCI, dated 22/06/2021
- NCC 2019 Performance Solution Report Reference No. 19127, Revision 01, issued b Surface Design, dated 17/12/2021
- Architectural Design Certificate – Sydney Modern Crown Certificate No.4, issued by Rodd Perey of Architectus, dated 23 July 2021.
- Design Compliance Certificate for Weather-proofing Façade and waterproofing, issued by Beres Dowdle of Surface Design, dated 30 June 2021

Information previously relied upon in Crown Certificate GDL150442.3, dated 03/07/2020;

- Application for Crown Certificate Form issued by Hakan Harman of Art Gallery NSW Trust, dated 11/05/2020
- Fire Engineering Report No. 246370, Revision B, issued by ARUP, dated 07/12/2018
- Fire Engineering Peer Review Report No. 2018/180 R1.2, issued by Stephen Grubits & Associates, dated 19/12/2018
- OEH Condition B22 – External Materials Report issued by SANAA & Architectus, dated 06/04/2019
- Plan No. DA_6001 – External Materials, Rev A, issued by SANAA & Architectus, dated 21/09/2018

- Plan No. DA_6001 – External Materials, Rev B, issued by SANAA & Architectus, dated 16/05/2019
- Long Service Levy Receipt of Payment No. 00424755, dated 11/05/2020
- Reflectivity Compliance Certificate issued by Gavin McPherson of Surface Design, dated 03/06/2020
- Statement of Compliance for Ecologically Sustainable Development issued by James von Dinklage of LCI Consultants, dated 05/06/2020
- Certificate of Compliance for Mechanical Services and associated drawings issued by Daniel Sullivan of D&E Air Conditioning Pty Ltd, dated 09/06/2020
- Memo Referencing Energy Efficiency - Section J – Addendum to JV3 Fabric Report issued by James von Dinklage of LCI Consultants, dated 24/06/2020
- Design Certificate for Lifts 1, 2, 3, 4, 6, 7 and 8 issued by Mark Rollinson of Liftronic Pty Ltd, dated 18/06/2020
- Letter referencing SSD Items 10, 11, 12 and 13 issued by Michael Bradburn of Richard Crookes Constructions Pty Ltd, dated 29/05/2020
- Letter referencing SSD Items 7.15, 7.17, 7.18, 7.19, 7.22, 7.23 and 7.24 issued by Michael Bradburn of Richard Crookes Constructions Pty Ltd, dated 29/05/2020
- Confirmation of Review of Strategies, Plans & Programs in accordance with SSD condition A9, issued by Andrej Stevanovic of Infrastructure NSW dated 24/06/2020
- Design Statement for Fire Services – Hydrants, Hose Reels, Sprinklers, Extinguishers, Automatic Detection and Warning Systems) issued by Jason Tait of Triple M Fire Pty Ltd, dated 05/06/2020
- Design Certificate for Electrical Services and associated drawings issued by Nevin Zeng of Nilsen NSW Australia Pty Ltd, dated 09/06/2020
- Evidence of submission of documentation for SSD Condition B22 to the Department of Planning issued by Daniel Griffin dated 19/06/2019
- Letter referencing Condition B22 – Heritage Division issued by Katrina Stankowski of Heritage Council of NSW, dated 03/06/2020
- Design Certificate for Hydraulic Services and associated drawings issued by Burt de Keyzer of Acor Consulting Pty Ltd, dated 04/06/2020
- Design Certificate for Hydraulic Services and associated drawings issued by Burt de Keyzer of Acor Consulting Pty Ltd, dated 28/05/2020
- Letter referencing Item No. 7.4a of Condition B6 – Geotechnical Design is not applicable, issued by Michael Bradburn of Richard Crookes Constructions Pty Ltd, dated 27/05/2020
- Email Correspondence regarding CTMP issued by Benjamin Borger of TfNSW, dated 19/04/2020
- Water and Stormwater Management Plan Reference No. REP/247039, Issue 2 issued by ARUP, dated 15/05/2020
- Construction Pedestrian and Traffic Management Plan Reference No. 142/2019, Issue E, issued by TTPA, dated April 2020
- Architectural Design Certificate for CC No. 3 issued by Colin Odbert of Architectus Australia Pty Ltd, dated 12/06/2020
- Design Certificate for Art Hoist (Lift No. 5) issued by David Robert Head of Southwell Engineering Pty Ltd, dated 11/06/2020
- Confirmation of corrosion protection to steel members issued by Luke McClure of Richard Crookes Constructions dated 25/05/2020
- Accessibility Compliance Statement for Crown Building Works Certificate 3 issued by Group DLA Access Consultancy dated 03/07/2020
- Access Design Review Report for Crown Building Works Certificate 3 issued by Group DLA Access Consultancy dated 03/07/2020
- Group DLA Building Code of Australia 2019 Report Rev I dated 03/07/2020
- NCC 2019 Performance Solution Report FP1.4 & FP1.5 issued by Surface Design dated 30/06/2020
- Fire Engineering Report No.246370 Rev E, issued by Arup Fire dated 22/06/2020

Information Previously relied upon in Crown Certificate GDL 150442.2, dated 29/04/2020

- Application for Crown Certificate Form issued by Hakan Harman of Art Gallery NSW Trust, dated 20/02/2020
- TTPA Certification Sydney Modern Project SSDA Conditions B62 & C8 28102019 issued by Meg Kong of Transport and Traffic Planning Associates, dated 28/10/2019
- Construction Pedestrian and Traffic Management Plan Reference No. 142/2019, Issue D, issued by Transport and Traffic Planning Associates, dated November 2019
- Condition B16 – Geotechnical Certificate Reference No. 754-SYDGE234348-G-L02-Rev1, issued by James Searle of Coffey Services Australia Pty Ltd, dated 06/03/2020
- Structural Plans - Landbridge Substructure interface with Proposed Works issued by Art Gallery of NSW
- Structural Plans - Steel Framing issued by Art Gallery of NSW
- Structural Plans - Concrete General Arrangement Plans issued by Art Gallery of NSW
- Correspondence regarding Structural Model Confirmation issued by Andrew Phillips of ARUP, dated 14/11/2019
- SSD Instrument of Modification issued by Andrew Witherdin of Department of Planning, Industry and Environment
- SSD 6471 Sydney Modern Approved Plans issued by Art Gallery of NSW
- Construction Noise and Vibration Management Plan No. 2019078_161019_CNVMP_BW_R2, Revision 2 issued by White Noise Acoustics Pty Ltd, dated 08/11/2019
- Condition B16 - Geotechnical Excavation Monitoring Plan No. SYDGE234348-G1-GEMP, Revision 3 issued by Coffey, dated 29/01/2020
- Condition B22 - External Materials Heritage Division response issued by Katrina Stankowski of Office of Environment and Heritage, dated 03/06/2019
- CPTMP Consultation issued by Kaye Russell of TfNSW, dated 14/11/2019
- Confirmation that documentation pertaining to Condition B22 of the SSDA consent have been submitted to the Department of Planning issued by Daniel Griffin of AG NSW dated 19/06/2019
- CNVMP Consultation issued by Mark Hanemann of NSW Environmental Protection Authority, dated 23/10/2019
- CNVMP Council Consultation issued by David M. Zabell of City of Sydney Council, dated 04/11/2019
- Civil Plans issued by Art Gallery of NSW
- Letter referencing no changes to SSD Conditions documentation issued with CC1 issued by Michael Bradburn of Richard Crookes Constructions Pty Ltd, dated 09/03/2020
- Letter referencing Summary of Geotechnical Works for CC2 Application issued by James Searle of Coffey Services Australia Pty Ltd, dated 06/03/2020
- Structural Design Certificate issued by Andrew Phillips of ARUP, dated 09/03/2020
- Reflectivity Compliance Letter issued by Gavin McPherson of Surface Design, dated 05/03/2020
- External Materials Plan, Revision B, issued by Art Gallery of NSW
- Condition B22 -OEH Plans issued by Sanaa Jimusho Ltd & Architectus
- Stamped External Materials Plan, Revision A, issued by Art Gallery of NSW
- Construction Noise and Vibration Management Plan Letter issued by Ben White of White Noise Acoustics Pty Ltd, dated 08/11/2019
- Performance Solution Report for Stairs exceeding maximum number of risers, issued by Mark Dohrmann of Dohrmann Consulting dated 23/04/2020
- Structural Plans issued by Sanaa Jimusho Ltd & Architecture
- Long Service Levy Payment Receipt No. 00402329 dated 28/10/2019
- Design Certification for ESD & Confirmation of compliance with Condition B31, issued by James Von Dinklage of LCI Consultants dated 26/03/2020
- Design Certification for Civil Works issued by Karen Seeto of ARUP dated 27/04/2020
- Confirmation of Notification to DPoE regarding the Review of Strategies, Plans & Programs in accordance with Condition A9, issued by Andrej Stefanovic of Infrastructure NSW dated 08/04/2020
- Water & Stormwater Quality Management Plan Ref REP/247039 Issue 1 dated 25/03/2020 issued by ARUP

- Confirmation that reports cannot be endorsed by Council, issued by John Rooke of City of Sydney Council dated 21/04/2020
- Access Design Compliance Statement issued by Elisa Moechtar of Group DLA dated 29/04/2020
- Performance Solution Report – Access (Stair GS.06) issued by Elisa Moechtar of Group DLA dated 29/04/2020

Information Previously relied upon in Crown Certificate GDL 150442.1.2, dated 24/02/2020

- Application for Crown Certificate issued by Hakan Harman of Art Gallery NSW Trust, dated 07/02/2020
- Mindewi Art Space Pile Alignment Plan No. SK-A-00407 - Perspective - Mingwei Art Space Option 2 issued by Architectus & Sanaa Jimusho Ltd, dated 10/01/2020
- Geotechnical Investigation Report Letter issued by Michael Bradburn of Richard Crookes, dated 14/02/2020
- Structural Design Statement issued by Andrew Phillips of Arup dated 17/02/2020 and associated Structural Plans
- Civil Design Statement issued by Karen Seeto of Arup dated 18/02/2020

Information previously relied upon in Crown Certificate GDL-150442.2, dated 15/11/2019

- Application for Crown Certificate Application issued by Hakan Harman of Art Gallery NSW Trust, dated 01/11/2019
- Consultancy Agreement between Richard Crookes Construction and GML Heritage Pty Ltd
- Consolidated Geotechnical Report – Tender Stage Report Reference SYDGEN210394-AV, Revision 0, issued by Robert Turner of Coffey, dated 28/08/2019
- Review Of Environmental Factors, issued by Architectus, dated Dec 2018
- EFT Remittance for Bond for Substation Work issued by Art Gallery NSW, dated 15/11/2018
- Review of Environmental Factors Report issued by Architectus, dated Dec 2018
- Civil Works Report issued by Smartpole
- Sydney Streets Technical Specifications for Street Lighting, Version 1, issued by City of Sydney, dated 13/09/2016
- Structural Design Certificate – Review of Environmental Factors issued by Andrew Phillips of ARUP, dated 07/11/2019
- Design Statement for Lincoln Crescent Lighting for REF issued by Michael Harrold of Steensen Varming, dated 11/11/2019
- Pre-Construction Dilapidation Inspection Report Reference No. 819060.8 – Area 8 issued by GreenPlus Property Services, dated 23/10/2019
- Pre-Construction Dilapidation Inspection Report Reference No. 819060.9 – Area 9 issued by GreenPlus Property Services, dated 23/10/2019
- Civil Design Certificate for CC1 issued by Karen Seeto of ARUP, dated 07/11/2019
- Letter referencing approval to pay Levy by Instalments issued by Sherry Ryan of Long Service Corporation, dated 23/10/2019
- Certificate of Currency – General, Products and Environmental Liability for Infrastructure NSW
- Certificate of Currency – Contract Works Material Damage for Infrastructure NSW
- EFT Remittance for Long Service Levy issued by Richard Crookes Constructions, dated 24/10/2019
- Letter referencing REF Dec 2018 Condition 14.1 – Dilapidation Report issued by Steven Ju of GreenPlus Property Services, dated 08/11/2019
- Ausgrid Plans
- Electricity Network Connection Application for Lincoln Crescent issued by Lingasen Pather of Ausgrid, dated 19/12/2018
- Sediment and Erosion Control Plan issued by Sanaa Jimusho Ltd
- Construction Pedestrian and Traffic Management Plan, Reference No. 142/2019, Issue C issued by Transport and Traffic Planning Associates, dated 23/10/2019
- Construction Waste Management Plan Revision 2, issued by Richard Crookes Constructions, dated 10/10/2019

- Environmental Management Plan issued by Richard Crookes Constructions, dated 08/10/2019
- Plan – SMP-C-6400X20 – Light Pole Footing Detail Sheet 1 of 1, Revision 03 issued by Sanaa Jimusho Ltd, dated 25/10/2019
- Certificate of Currency - Workers Compensation for Richard Crookes Constructions Pty Ltd

Information previously relied upon in Crown Certificate GDL-150442, dated 15/11/2019

- Application for Crown Certificate Application issued by Hakan Harman of Art Gallery NSW Trust, dated 01/11/2019
- Consolidated Geotechnical Report – Tender Stage Report Reference SYDGEN210394-AV, Revision 0, issued by Robert Turner of Coffey, dated 28/08/2019
- Sydney Water Building Plan Approval Application Reference No. 560245 form and associated plans issued by Minh Tran of MetroWater Management, dated 20/11/2018
- Letter referencing Construction Noise and Vibration Management Plan issued by Ben White of White Noise Acoustics, dated 29/10/2019
- Memo referencing Condition B31 compliance issued by LCI Consultants, dated 06/11/2019
- Design Integrity Report Revision 1, issued by Infrastructure NSW
- Additional Information requested for DIR Plans
- Letter referencing Nominated Historical Archaeologist issued by Dan Griffin of Art Gallery NSW, dated 23/09/2019
- Letter referencing Archaeological Monitoring issued by Jennifer Jones-Travers of GML Heritage, dated 10/10/2019
- Conditions of Consent B21 – Works to Former Naval Fuel Bunker Report dated 17/10/2019
- Structural Design Certificate for Crown Certificate 1 issued by Andrew Phillips of ARUP, dated 23/10/2019
- Design Statement for Northern Stair Lighting for CC1 Certificate issued by Michael Harrold of Steensen Varming, dated 04/11/2019
- Pre-Construction Dilapidation Inspection Report Reference No. 819060.1 – Area 1 issued by GreenPlus Property Services, dated 08/11/2019
- Pre-Construction Dilapidation Inspection Report Reference No. 819060.2 – Area 2 issued by GreenPlus Property Services, dated 08/11/2019
- Pre-Construction Dilapidation Inspection Report Reference No. 819060.3 – Area 3 issued by GreenPlus Property Services, dated 08/11/2019
- Pre-Construction Dilapidation Inspection Report Reference No. 819060.4 – Area 4 issued by GreenPlus Property Services, dated 08/11/2019
- Pre-Construction Dilapidation Inspection Report Reference No. 819060.5 – Area 5 issued by GreenPlus Property Services, dated 08/11/2019
- Pre-Construction Dilapidation Inspection Report Reference No. 819060.6 – Area 6 issued by GreenPlus Property Services, dated 08/11/2019
- Pre-Construction Dilapidation Inspection Report Reference No. 819060.7 – Area 7 issued by GreenPlus Property Services, dated 08/11/2019
- Pre-Construction Dilapidation Inspection Report Reference No. 819060.8 – Area 8 issued by GreenPlus Property Services, dated 08/11/2019
- Pre-Construction Dilapidation Inspection Report Reference No. 819060.9 – Area 9 issued by GreenPlus Property Services, dated 08/11/2019
- Letter referencing CEMP and Heritage Induction Document review issued by Cheryl Brown of The Heritage Council of NSW, dated 14/11/2019
- Evidence of Compliance with SSD Condition B23 – Heritage Personnel Appointment issued by Jennifer Jones of GML Heritage Consultants, dated 10/10/2019
- Confirmation of Compliance with SSD Condition A10 and B61 issued by Amy Conway of Heritage NSW, dated 14/11/2019
- Confirmation of Compliance with SSD Condition B61 issued by Christine Tumney of NSW DPI, dated 07/11/2019
- Confirmation of Compliance with SSD Condition B61 issued by Mark Hanemann of NSW DPI, dated 24/10/2019

- Confirmation of Compliance with SSD Condition B61 issued by Steven Nguyen of NSW RMS, dated 30/10/2019
- Confirmation of Compliance with SSD Condition A10 and B61 issued by Kay Russell of Transport for NSW, dated 13/11/2019
- Confirmation of Compliance with SSD Condition B62 issued by Clement Lim of City of Sydney, dated 07/11/2019
- Confirmation of Compliance with SSD Condition B62 issued by Ben Borger of RMS, dated 07/11/2019
- Confirmation of Compliance with SSD Condition B63 issued by Mark Hanemann of NSW DPI, dated 23/10/2019
- Confirmation of Compliance with SSD Condition B69 issued by Mark Hanemann of NSW DPI, dated 23/10/2019
- Confirmation of Compliance with SSD Condition B72 issued by Mark Hanemann of NSW DPI, dated 23/10/2019
- Civil Design Certificate and associated Civil Plans for CC1 issued by Karen Seeto of ARUP, dated 07/11/2019
- Structural Plans issued by Arup
- Confirmation of Compliance with Conditions A10 and B61 issued by Steve Meredith of Heritage Council of NSW, dated 11/11/2019
- Confirmation of Compliance with Conditions A10 and B61 issued by Cheryl Brown of The Heritage Council of NSW, dated 14/11/2019
- Letter referencing Condition B22 Proposed Materials issued by Katrina Stankowski of Heritage Council of NSW, dated 03/06/2019
- Letter of Response regarding Works to the Former Naval Fuel Bunker - Condition B21 issued by Cheryl Brown of The Heritage Council of NSW, dated 25/10/2019
- Letter referencing approval to pay Levy by Instalments issued by Sherry Ryan of Long Service Corporation, dated 23/10/2019
- Letter referencing SSD Condition A20 issued by Marcus Ray of NSW Planning and Environment, dated 13/03/2019
- Letter referencing discharge of SSD Condition B2, B3 and B4 issued by Anthea Sargeant of NSW Planning and Environment, dated 25/10/2019
- Certificate of Currency – General, Products and Environmental Liability for Infrastructure NSW
- Certificate of Currency – Contract Works Material Damage for Infrastructure NSW
- EFT Remittance for Long Service Levy
- Letter referencing SSD Conditions B65 and C25 - Construction Waste Management Plan issued by Jesse Moss of Richard Crookes Constructions, dated 28/10/2019
- Letter referencing SSD Condition 16B – Geotechnical Excavation Monitoring Plan issued by James Searle of Coffey, dated 07/11/2019
- Air Quality and Odour Management Plan Report Reference No. SYDGE234348-RCC AQOMP R01, issued by Jesse Mosso f Richard Crookes Constructions, dated 22/10/2019
- Construction Noise and Vibration Management Plan Report, Revision 0, issued by Ben White of White Noise Acoustics, dated 18/10/2019
- Construction Pedestrian and traffic Management Plan report Reference No. 142/2019, Revision C issued by Transport and Traffic Planning Associates, dated 23/10/2019
- Letter referencing SSD Condition B52 and C1 – Demolition Control Plan issued by Brenton Watson of DECC, dated 28/10/2019
- Demolition Control Plan Report Version 2 issued by Brenton Watson of DECC, dated 22/10/2019
- Environmental Management Plan issued by Richard Crookes Constructions, dated 08/10/2019
- Geotechnical Excavation Monitoring Plan Report Reference No. SYDGE234348-G1-GEMP, Revision 2 issued by James Searle of Coffey, dated 05/11/2019
- Hazardous Material Management Plan Report Reference No. 754-SYDGE234348 – RCC HMMP R03, Revision R03, issued by Coffey, dated 04/11/2019
- Unexpected Finds Procedure Report Reference SYDGE234348-EB_UFP issued by Coffey, dated 15/10/2019
- Letter referencing Unexpected Finds Protocol issued by Michael Dunbavan of Coffey, dated 08/11/2019

- Plan – SMP-C-0100X01 – General Notes and Legend Sheet 1 of 2, Revision 04 issued by Sanaa Jimusho Ltd, dated 23/10/2019
- Plan – SMP-C-0100X02 – General Notes and Legend Sheet 2 of 2, Revision 04 issued by Sanaa Jimusho Ltd, dated 23/10/2019
- Plan – SMP-C-1200X01 – Sediment and Erosion Control Plan, Revision 04 issued by Sanaa Jimusho Ltd, dated 06/11/2019
- Plan – SMP-C-6200X01 – Sediment and Erosion Control Details, Revision 03 issued by Sanaa Jimusho Ltd, dated 06/11/2019
- Luminaire Data Sheet Reference XB1, dated Aug 2018
- Letter referencing SSD Condition B49 - Pre-Construction Dilapidation Report and Condition B60 – Heritage Dilapidation Study (HDS) issued by Steven Ju of GreenPlus Property Services, dated 08/11/2019
- Letter referencing SSD Condition B51- Requirements of Public Authorities issued by Michael Bradburn of Richard Crookes Constructions, dated 14/11/2019
- Email Correspondence regarding Principals Documentation for Crown Certificate, issued by Andrej Stevanovic of Art Gallery NSW Trust, dated 28/10/2019
- Email Correspondence regarding Condition B8 issued by Andrej Stevanovic of Art Gallery NSW Trust, dated 28/10/2019
- Plan – SMP-L-1000X00 – Northern Stair – Layout, Material & Finishes Plan, Revision 1, issued by Sanaa Jimusho Ltd, dated 29/10/2019
- Compliance Monitoring and Reporting Program (Condition B8), Revision 01, dated 10/10/2019
- Letter referencing Condition 5.1 – Construction Traffic Management Plan issued by Meg Kong of Transport and traffic Planning Associates, dated 28/10/2019
- Letter referencing Condition B62 and C8 – Construction Pedestrian and Traffic Management Plan issued by Meg Kong of Transport and traffic Planning Associates, dated 28/10/2019
- Fire Resistance Performance of Structural Steel Report Reference 409488 issued by Warringtonfire, dated 18/03/2019
- Certificate of Currency - Workers Compensation for Richard Crookes Constructions Pty Ltd
- GDL 190324 – Accessibility Statement issued by Group DLA 14 November 2019
- Evidence of approval of SSD Condition B61 issued by David M Zabell of City of Sydney dated 7/11/2019
- Evidence of approval of SSD Condition B63 issued by David M Zabell of City of Sydney dated 23/10/2019
- Evidence of approval of SSD Condition B69 issued by Raghuram Muguli of Coffey dated 8/11/2019
- Evidence of approval of SSD Condition B64 issued by Raghuram Muguli of Coffey dated 8/11/2019

This statement confirms compliance of the Design to BCA 2019 for the proposed works and is reliant upon the listed documentation, design certification and plans referenced, as well as compliance with the conditions of this document.



Justin Jones-Gardiner
Director
Building Professionals Board / BDC0204