

Fact Sheet

What happens after 7 years of age?



My child has turned 7, can they now move out of their booster seat?

The law states from seven, children must use either an approved child restraint or properly adjusted and securely fastened seat belt. However, the average seven-year-old cannot fit an adult seatbelt correctly. In fact, most children can't wear these seatbelts correctly until they're 145cm which might not be until 10 to 12 years of age.

Vehicle seats and seatbelts are designed for adult bodies so it's highly unlikely that your child will fit an adult seatbelt when they reach their seventh birthday. A booster seat needs to be used until they can.

Children that move into an adult seatbelt too early are twice as likely to suffer devastating injuries in a crash, including severe damage to the brain, liver, spleen, stomach and spinal cord.

Seatbelt fits will vary from vehicle to vehicle and even from position to position in the same car. There are several models of booster seats on the market that can accommodate children up to the height needed to wear the adult seatbelt correctly.

Fact Sheet

Shoulder height markers

RACT

How do I know when my child is ready to use an adult seatbelt?

We recommend you only consider moving your child out of their booster seat once they have passed the '5 step test'.

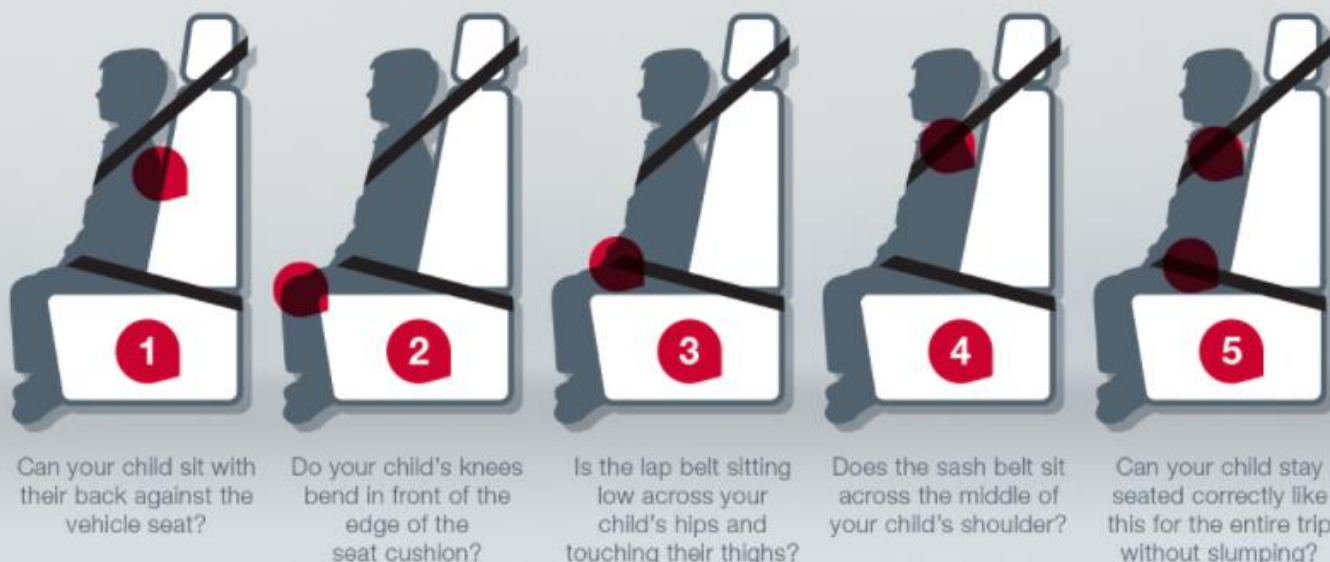

Here's what to look for:

1. Can your child sit with their back against the vehicle seat?
2. Do your child's knees bend in front of the edge of the seat cushion?
3. Is the lap belt sitting low across your child's hips and touching their thighs?
4. Does the sash belt sit across the middle of your child's shoulder?
5. Can your child stay seated correctly like this for the entire trip without slumping?

If you answered 'no' to any of these questions, your child needs to be in a booster seat to make both the sash and the lap part of the seatbelt fit right to ensure maximum crash protection.

For more information on child restraints please call 13 27 22, visit ract.com.au or email child.restraints@ract.com.au