

OPTIC-Line: Large Area Lights

3-CCT & 5-Power Selectable Rotatable and EZ-Swap Optics



5P150		5P300		5P450	
WATT	LUMENS	WATT	LUMENS	WATT	LUMENS
50	7,500	180	27,000	330	49,500
75	11,250	210	31,500	360	54,000
100	15,000	240	36,000	390	58,500
125	18,750	270	40,500	420	63,000
150	22,500	300	45,000	450	67,500

LUMENS BASED OFF 4000K. 30K & 50K +/- 5%

Detail Specifications:

- Finish: Bronze, Black, White (Quick Ship)
- Custom colors available
- IP Rating: Wet Location (IP65)
- Beam Angle: Type III Installed (Type II, IV, V included in box)
- Tool-free interchangeable in the field
- CCT: 30/40/50K Selectable
- Chip: SMD 2835, R9 >50, CRI >80
- Operating Temperature: -40° - 122° F
- Lens: PC Lens: Clear acrylic with optics
- Average life (L70) of 70,000 hours

Applications:

- Dock and Loading
- Walkways & Pathways
- Parking Lots
- Outdoor Corridors
- General Outdoor Lighting
- Commercial and Industrial

Product Information:

- Sturdy die-cast aluminum housing finished with corrosion free powder coat
- 2' STJW 18.3 AWG cable whip included
- EZ-Optic-Switch allows for:
- Field rotatable optics
- Field optic lens swap
- Select-n-Switch Technology
- Twist-C Control
- Instant-On to full brightness

Driver Options:

- UNV: 120-277V or HV: 277-480V 0-10V Dimmable
- Built in 6kV Surge Protector
- 20kV available
- THD: <20% (+/-5% tolerance), PF >0.9, 50/60Hz

Mounting & Installation:

- Optional tenon mount adaptors available
- Several standard bracket options available (see below)

Certifications:

- UL Listed for USA and CA
- DLC Listed
- ROHS Compliant
- Approved for CA T24
- 7 Year Limited Warranty
- FCC CFR 47, GCC Part 15, Subpart B:2017

Series	Power	3CCT	Finish ¹	Voltage ²	Photocell	EMB
LED-ARL3-OPT -		- TRI -				
5P150	150/125/100 75/50w	30/40 50K	BZ Bronze (Standard)	UNV 120-277V (6kV Surge Protector)	(Blank) No Photocell PC Photocell	(Blank) No Emergency
5P300	300/270/240 210/180w		BL Black	HV 277-480V (6kV Surge Protector)		EMB 40W Remote Emergency 6,000lm
5P450	450/420/390 360/330w		WH White GRY Gray CS Custom Color	UNV20KV 120-277V (20kV Surge Protector) HV20KV 277-480V (6kV Surge Protector)		

1. Standard quickship is bronze, black, and white. Other colors are custom finishes.
2. 6kV quick ship. 20kV models are made to order. 3P450 only available in UNV or UNV20KV

Required Accessories

Bronze Brackets	Black Brackets	White Brackets
ARL3-SF Slip Fitter	ARL3-SF-BL Slip Fitter	ARL3-SF-WH Slip Fitter
ARL3-SA Straight Arm	ARL3-SA-BL Straight Arm	ARL3-SA-WH Straight Arm
ARL3-SFA Adjustable	ARL3-SFA-BL Adjustable	ARL3-SFA-WH Adjustable
ARL3-SFA Slip Fitter	ARL3-SFA-BL Slip Fitter	ARL3-SFA-WH Slip Fitter
ARL3-TR Trunnion	ARL3-TR-BL Trunnion	ARL3-TR-WH Trunnion

Optional Accessories

Wall Mount	Control Sensors
ARL3-WM Must Purchase with SA or SFA	S-TWC-MW-1 S-Line: Twist-C Microwave Sensor
ARL3-WM-BL	S-TWC-PIR-1 S-Line: Twist-C PIR Sensor
ARL3-WM-WH	S-TWC-MW-BT S-Line: Twist-C Microwave Sensor w/ Bluetooth
	S-TWC-PIR-BT S-Line: Twist-C PIR Sensor w/ Bluetooth
	S-LINE-R Remote for S-Line Series Sensors (Required)
	ENVISION CONNECT App for Bluetooth sensors (Required)

Specs and model numbers are subject to change with or without notice.

FEATURES

Photocell Access
(Receptacle Not Included)

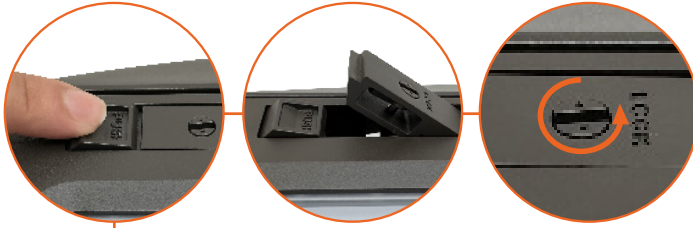

Die-Cast Aluminum



Toolless Access to Optic Lens

Wattage Selector
Inside J-Box



S-TWC-MW-1 S-TWC-PIR-1
S-TWC-MW-BT S-TWC-PIR-BT
TWC-DL



Toolless Access to Driver

3-CCT
Selectable

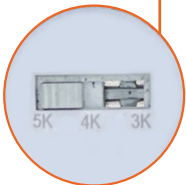

Twist-C Control
Receptacle

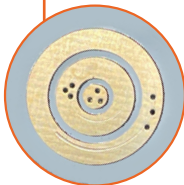

EPA & BUG

WATTAGE

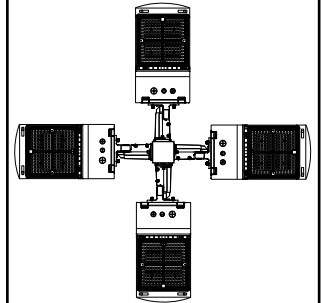
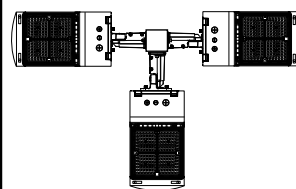
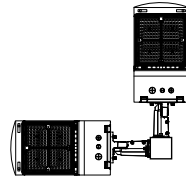
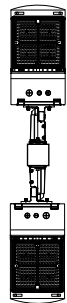
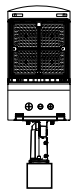

BUG

1PC FIXTURE

2PC 180°

2PC 90°

3PC 90°

4PC 90°

5P150

B3-U0-G3

0.384

0.776

0.599

0.914

0.914

5P300

B4-U0-G4

0.468

0.945

0.73

1.114

1.114

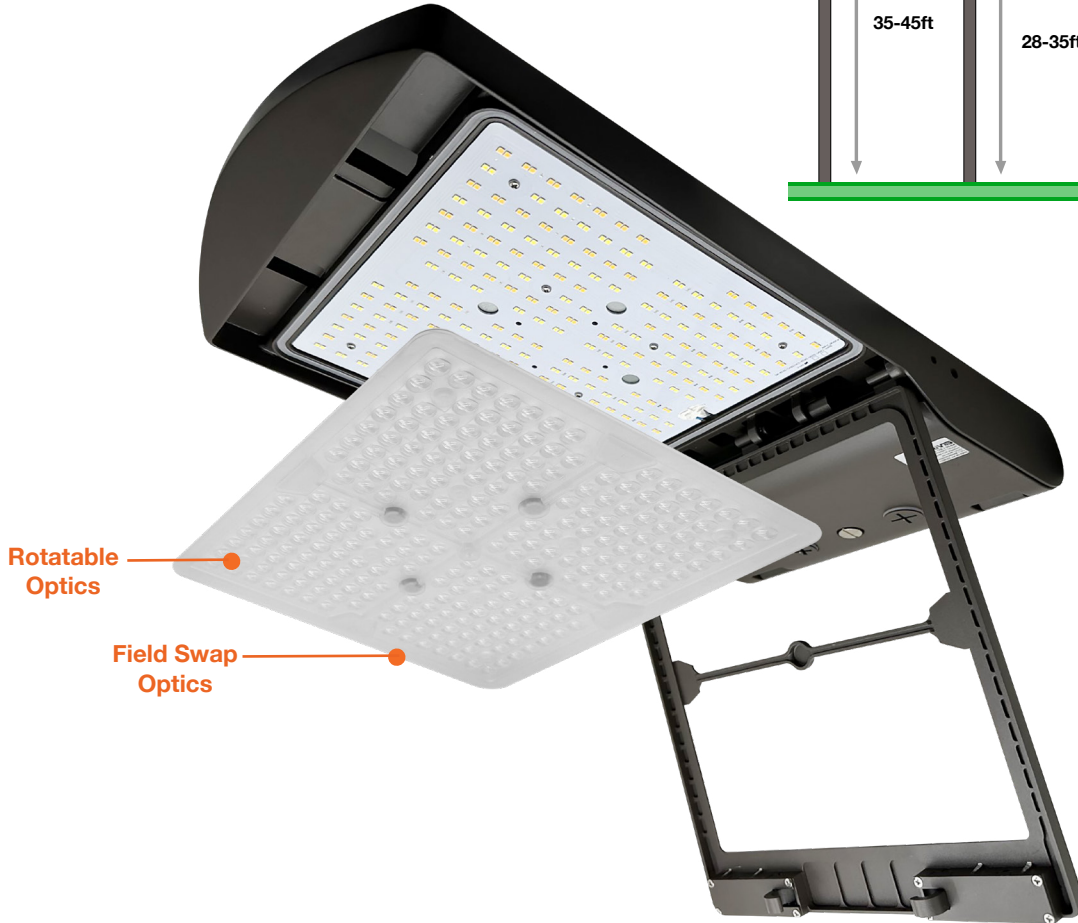
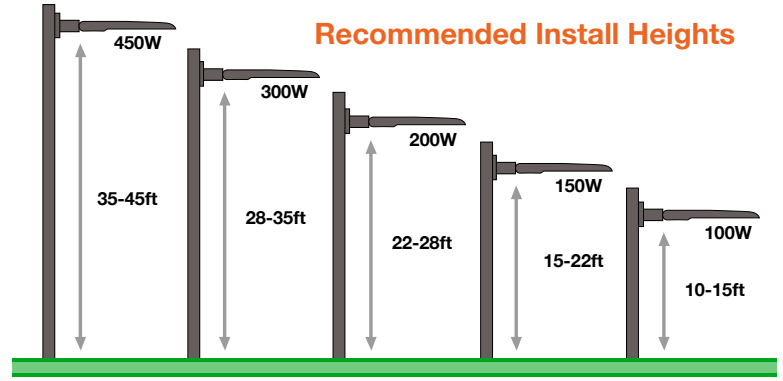

Rotatable Optic Lens

Field rotation eases lighting design implementation. Rotate lens and receive different light distribution in different directions. No change to fixture installation and EPA.

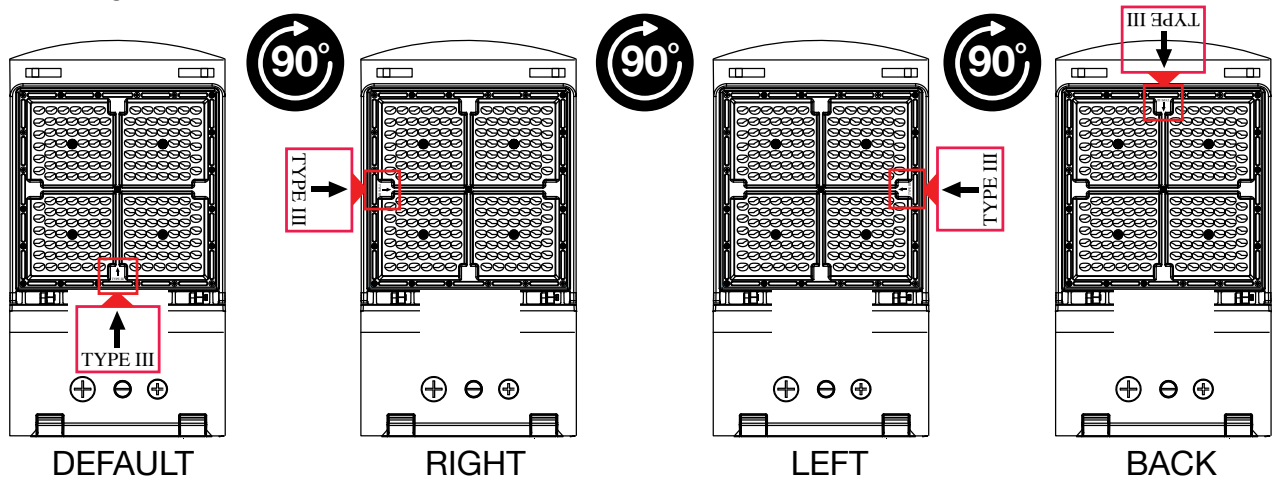

BRACKET DIMENSIONS

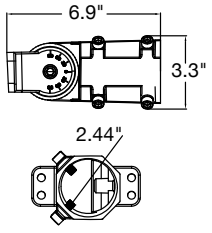

ARL3-SF

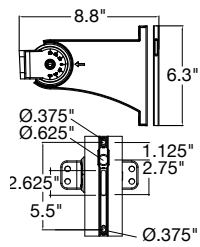

ARL3-SA

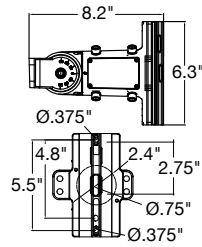

ARL3-SFA

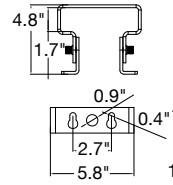

ARL3-TR

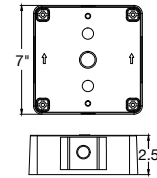

ARL3-WM

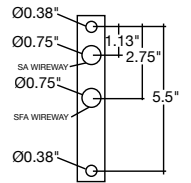

SA/SFA

5P150

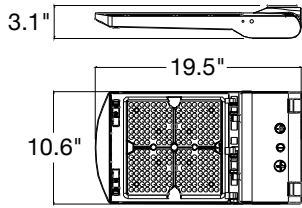

SF

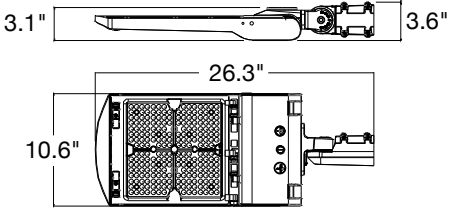

SA

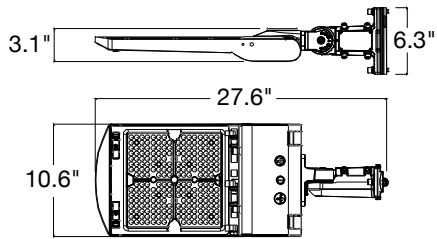

SFA

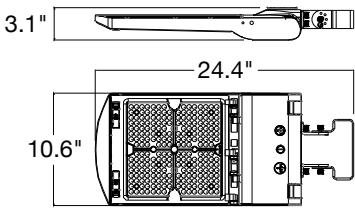

TR

5P300

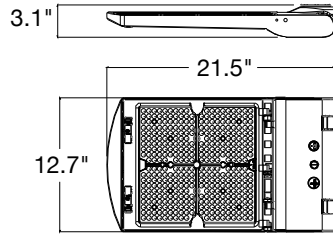

SF

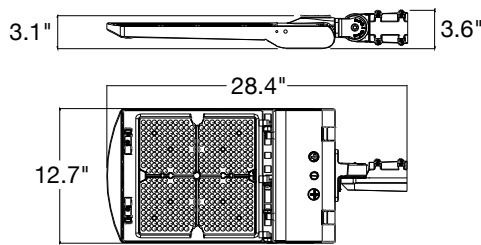

SA

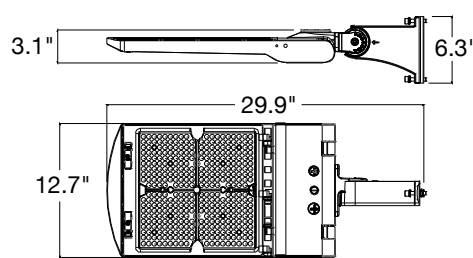

SFA

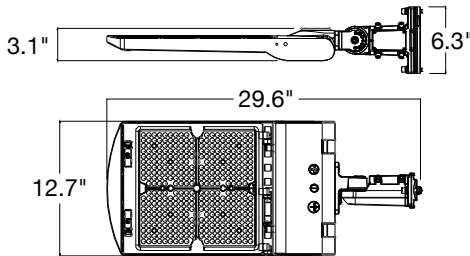

TR

5P450

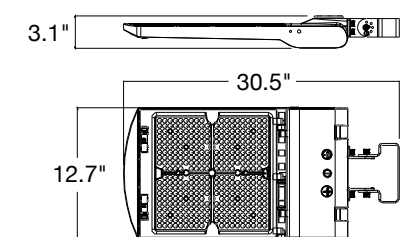
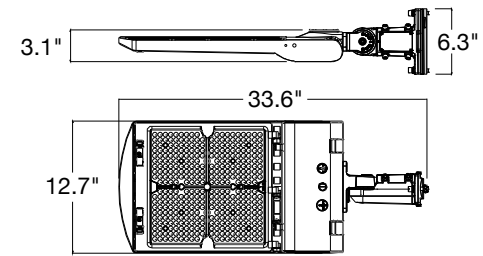
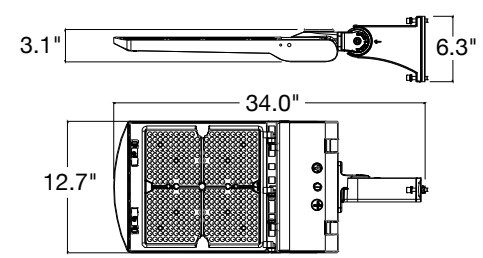
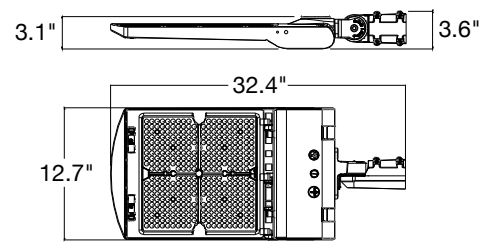
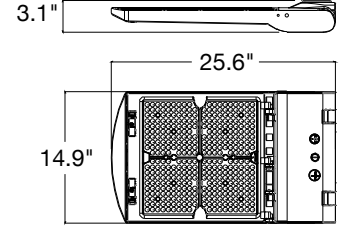

ACCESSORIES



ARL3-TR

Trunnion

- Flood light bracket
- Ideal use on a wall
- Can be used for shoebox
- Adjustable design to angle area light luminaire



ARL3-SA

Straight Arm Adjustable

- For use with round or square poles
- Adjustable design to angle area light luminaire



ARL3-SF

Slip Fitter

- For use with round or square poles
- Adjustable design to angle area light luminaire
- Fits 2 3/8" tenon



ARL3-SFA

Slip Fitter & Straight Arm

- Flood light bracket
- For use with round or square poles
- Can be used for shoebox
- Adjustable design to angle area light luminaire



ARL3-WM

Wall Mount Adapter

- Attach to SA or SFA arm
- Does not attach to the body of the fixture directly

Accessory Model	Description
ARL3-SF	ARL3: Slip Fitter
ARL3-SF-BL	ARL3: Slip Fitter (Black)
ARL3-SF-WH	ARL3: Slip Fitter (White)
ARL3-SA	ARL3: Straight Arm
ARL3-SA-BL	ARL3: Straight Arm (Black)
ARL3-SA-WH	ARL3: Straight Arm (White)
ARL3-SFA	ARL3: Slip Fitter/Straight Arm Combo
ARL3-SFA-BL	ARL3: Slip Fitter/Straight Arm Combo (Black)
ARL3-SFA-WH	ARL3: Slip Fitter/Straight Arm Combo (White)
ARL3-TR	ARL3: Trunnion
ARL3-TR-BL	ARL3: Trunnion (Black)
ARL3-TR-WH	ARL3: Trunnion (White)
ARL3-WM	ARL3: Wall Mount Adapter (Requires ARL3-SA or ARL3-SFA)
ARL3-WM-BL	ARL3: Wall Mount Adapter (Black) (Requires ARL3-SA or ARL3-SFA)
ARL3-WM-WH	ARL3: Wall Mount Adapter (White) (Requires ARL3-SA or ARL3-SFA)
ARL3-OPT-L-HSS-BZ	ARL3: OPTIC-Line: House Side Shield for 5P150
ARL3-OPT-L-HSS-BL	ARL3: OPTIC-Line: House Side Shield for 5P150
ARL3-OPT-L-HSS-WH	ARL3: OPTIC-Line: House Side Shield for 5P150
ARL3-OPT-XL-HSS-BZ	ARL3: OPTIC-Line: House Side Shield for 5P300
ARL3-OPT-XL-HSS-BL	ARL3: OPTIC-Line: House Side Shield for 5P300
ARL3-OPT-XL-HSS-WH	ARL3: OPTIC-Line: House Side Shield for 5P300
ARL3-OPT-XXL-HSS-BZ	ARL3: OPTIC-Line: House Side Shield for 5P450
ARL3-OPT-XXL-HSS-BL	ARL3: OPTIC-Line: House Side Shield for 5P450
ARL3-OPT-XXL-HSS-WH	ARL3: OPTIC-Line: House Side Shield for 5P450
ARL3-450W-HSS-BZ	ARL3: Front & House Side Shield for 450W
S-TWC-MW-1	S-Line: Twist-C Microwave Sensor
S-TWC-PIR-1-BT	S-Line: Twist-C PIR Sensor
S-TWC-MW-BT	S-Line: Twist-C Microwave Sensor w/ Bluetooth
TWC-DL	S-Line: Twist-C Daylight Sensor: Dusk to Dawn, works like a photocell
S-LINE-R	Remote for S-LINE Series Sensors
K121INT	3 Pin Receptacle
PC-SHORT-CAP	3 Pin Shorting Cap
K171H	7 Pin Receptacle

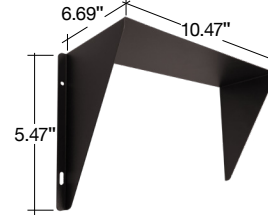
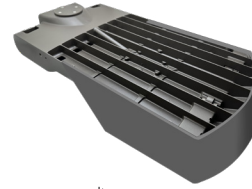

ARL3-OPT-L-HSS-BZ
ARL3-OPT-L-HSS-BL
ARL3-OPT-L-HSS-WH

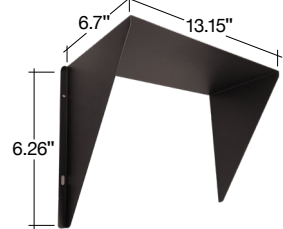

ARL3-OPT-XL-HSS-BZ
ARL3-OPT-XL-HSS-BL
ARL3-OPT-XL-HSS-WH

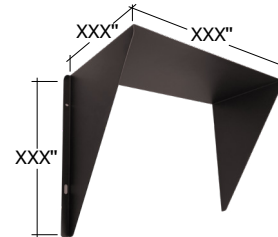

ARL3-OPT-XXL-HSS-BZ
ARL3-OPT-XXL-HSS-BL
ARL3-OPT-XXL-HSS-WH



S-TWC-PIR-1



S-TWC-MW-1
S-TWC-MW-BT
TWC-DL



S-LINE-R
Controller



Optic Lenses
Beam Angle: Type III Installed
(Type II, IV, V included in box)
Tool-free interchangeable in the field



3 Pin Photocell
120-277V
PC-TWL-UNV



3 Pin Photocell
347-480V
PC-TWL-HV



3 Pin
Receptacle
K121INT



PC
Short Cap
PC-SHORT-CAP



7 Pin
Receptacle
K171H