

INSTALLATION INSTRUCTIONS FOR IN GROUND 5-CCT LIGHTS

PLEASE READ AND UNDERSTAND THIS ENTIRE MANUAL BEFORE ATTEMPTING TO ASSEMBLE, OPERATE OR INSTALL THE PRODUCT.

Warning:

- ONLY use this fixture on 12-24V AC/DC circuits.
- The maximum load (combined total wattage of all fixtures) should NOT exceed 80% of the total power rating of the transformer.
- The wire is intended for shallow burial (less than 6 inches deep).
- Install ALL fixtures at least 10ft away from pools, spas, or fountains.
- Keep the fixtures away from flammable or combustible materials.
- DO NOT touch the lens, guard, or fixture housing while in use.
- DO NOT operate or install a fixture with missing or damaged parts.
- DO NOT submerge this fixture in water as this may damage it.
- Vertically mount the transformer at least 12 inches above the ground.
- Keep this fixture out of the reach of children under 3 years old.
- DO NOT connect this fixture to electrical systems that DO NOT have grounding

PACKAGE CONTENT

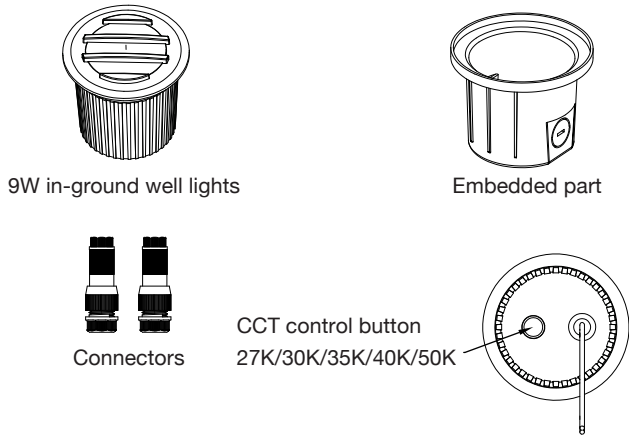

INSTALLATION

1. Dig a 4.25" wide and 3.25" deep hole (Fig. 1)

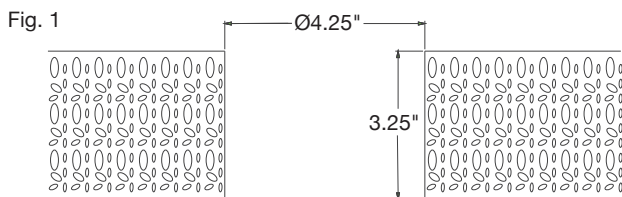

2. Dig a wire groove between the above install hole and the power supply cord.

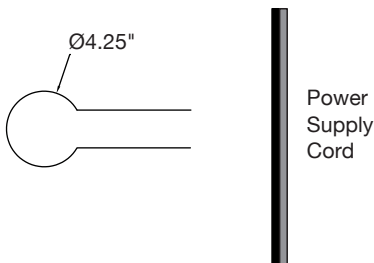

3. Install the lamp with the embedded part into the hole. Then, route the cable towards the groove and fill the hole with pea gravel or sand.
4. Using wire connectors, connect the leads from the fixture body to the main supply cable leads.

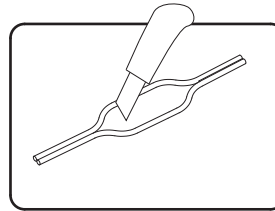

5: Separate the power cord

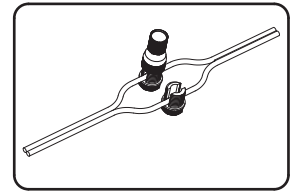

6: Put the wire into the large cap. Pierce the pin part into the wire

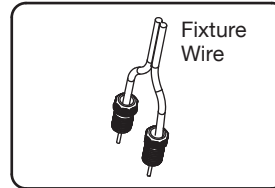

7: Pass the stripped light cord through the small cap

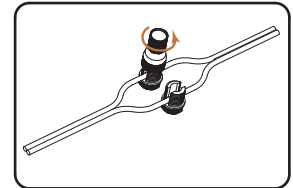

8: Tighten the large cap

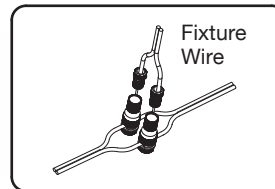

9: Screw the small cap into the joint and tighten the small cap

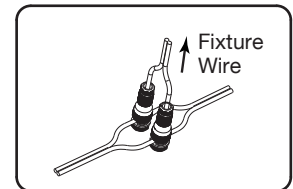

10: Pull the wires gently to test the connection

11. Continue to install the rest of the light fixtures by repeating steps 4 - 11

CARE AND MAINTENANCE

- Before attempting to clean the fixture, disconnect the power by turning off the breaker or by removing the fuse from the box.
- DO NOT USE ANY CLEANERS WITH CHEMICALS, SOLVENTS OR HARSH ABRASIVES

TROUBLESHOOTING

If all lights are not working properly:

- Check if the power is turned on
- Check to make sure the input voltage is 12-24V
- Check to make sure that the transformer is properly connected

IF SOME LIGHTS ARE NOT WORKING PROPERLY

- Check the wiring, make sure that all connections between the lights and the main power cord are tightened properly.
- Check the connectors, if any, make sure that connectors work correctly. If the lights still do not work after several adjustments, please contact our customer support.