

HP LINE

cmatic[®]
P N E U M A T I C F I T T I N G S

250 bar 润滑用自动接头
High Pressure Push-in Fittings, 250 bar



HP是新一代快插接头，可以确保高压下的密封性，迄今为止人们认为这是快插接头无法实现的。该接头为润滑领域的应用而开发，凭借着创新性的卡爪系统，HP系列最高可以承受250Bar的压力。



HP is a new generation of fittings studied to guarantee tightness with pressure ranges, considered so far "out of reach" with the push-in version. HP Fitting has been created and developed to be used in the Lubrication systems. Thanks to the innovative gripping system of the collet, our HP push-in fittings can stand up to a maximum of 250 bar pressure.

1	2	3	4	5
本体 Body	螺纹体 Threaded Screws	卡爪 Gripping collet	密封圈 Seals	卡簧 Seeger
镀镍黄铜 UNI EN 12164 CW614N - UNI EN 12165 CW617N Brass UNI EN 12164 CW614N - UNI EN 12165 CW617N Nickel Plated	UNI EN 12164 CW614N 镀镍黄铜 Brass UNI EN 12164 CW614N Nickel Plated	黄铜 UNI EN 12164 CW614N Brass UNI EN 12164 CW614N	NBR NBR	钢 C75 镀锌 C75 Steel zinc coated



	M6x0.75	M6x1	M8x1	M10x1	R1/8	R1/4
4	•	•	•	•	•	
6		•	•	•	•	•

技术规格

建议的连接管路：
Pa6-6 (4x1.5 - 6x3)，高压管路，带金属端管。
可接受的管路公差：
+/- 0.07 mm，最大直径 Ø 6 mm。

应用领域：
润滑系统。

最大工作压力取决于所用管路的类型和工作温度。这两个因素有可能导致接头爆破压力的降低。

DATA SHEET

Recommended tubings:
PA6-6 (4x1,5 - 6x3), High pressure tubing with metal stem.
Acceptable Tolerances on the tubings:
+/- 0,07 mm up to Ø 6 mm.

Application fields:
Lubrication installations.

The pressure rate achievable can vary depending on the tubing used and on the room temperature. These two factors may in fact lower the tube bursting pressure.

管路插入深度

Tubing insertion depth

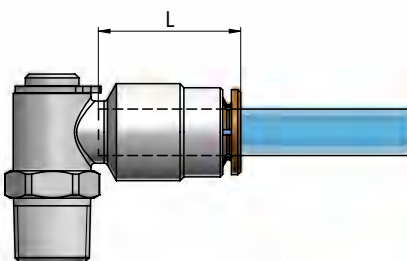

管径 \varnothing_e	L
4	16
6	18.5

- 1.沿管路垂直切割 (使用TCUT管路切刀),确认内外管壁没有毛刺,同时注意避免管路截面呈椭圆形。
- 2.将管路插入接头,到底为止。

拔出管路:

垂直按压释放环,同时拔出管路即可。

1. Cut the tube square (by means of a hose cutter i.e. our TCUT) making sure that no burrs are left and that the tube is not oval.
2. Insert the tube into the fitting until it bottoms.

Tube release

While pressing on the release ring, pull out the tube from the fitting.

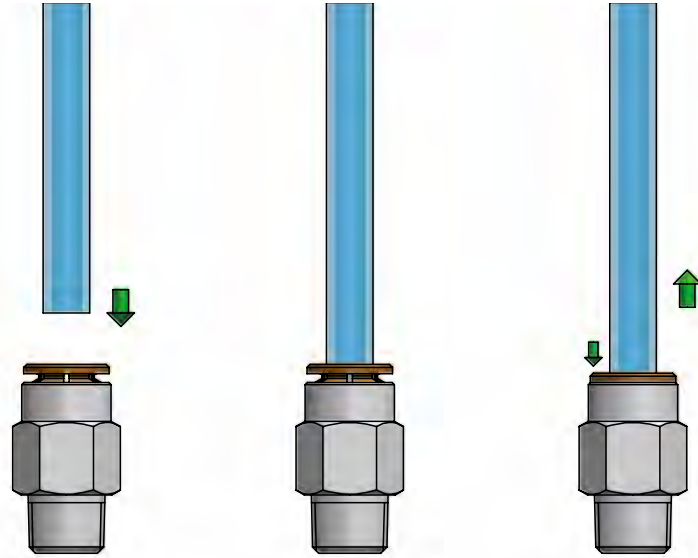

完成连接后,请确保管路上不承受外力;此外,请确保管路连接的最小弯曲半径符合本样册第335页之规定。
 为了避免管路意外松脱,任何物体均不要接触释放环。作用在释放环上任何外力,包括侧向力,均可能导致管路意外松脱。
 螺纹拧紧时,请参考第六页列出的建议扭矩。
 如果接头连接已经使用了金属管,拆装后,该接头不建议再使用塑料管连接。



Once the tubing is connected to the fitting, make sure that the tubing is not subject to any tensile strength and that the min. recommended bending radius stated in the tubing section of this catalogue is complied with (see page 335).
 To prevent any accidental tube release, no components have to come in touch with the release ring and exercise any unwanted pressure on the same. Indeed however lateral, any load on the release Ring may cause the tube disconnection.
 To tighten threads, please check out our tightening torque chart illustrated at page 6.
 Should the fitting be assembled with metal tubes, in case of disassembly, we do not recommend to reassemble the same fitting with plastic tubing.

如果使用金属尾管连接接头,则尾管需要按照以下图示进行加工,否则,接头的性能指标会受到一定影响,且有可能接头受到无法修复的损坏而不能保证功能。

If a metal stem is connected to the fitting the stem has to be manufactured according to the profile and sizes as set forth below. Should the fitting be connected to a metal stem not complying to the technical features recommended, the fitting may get irreversibly damaged and its function would no longer be guaranteed.

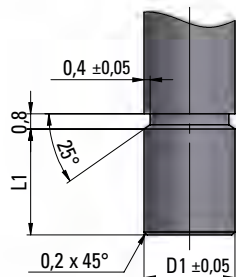

D1	L1
4	8
6	9.5

HP 11

锥螺纹直管接头

Taper Straight, male

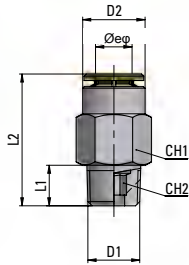

类型	管径 Øe	D1	D2	L1	L2	CH1	CH2	g Δ
11 04 18	4	R1/8	9.5	7.5	21	10	3	8.5
12 04 M6x0.75*	4	M6x0.75	9.5	6	23	10	2.5	8.8
11 04 M6x1	4	M6x1	9.5	8	25	10	2.5	8.4
11 04 M8x1	4	M8x1	9.5	8	22.5	10	3	7.8
11 04 M10x1	4	M10x1	9.5	8	21	11	3	9.5
11 06 18	6	R1/8	11.5	7.5	24	12	4	11.5
11 06 14	6	R1/4	11.5	11	26	14	4	19.1
11 06 M6x1	6	M6x1	11.5	8	28	12	2.5	12.8
11 06 M8x1	6	M8x1	11.5	8	28	12	4	13.2
11 06 M10x1	6	M10x1	11.5	8	24.5	12	4	12

* M6x0.75 圆柱形螺纹 - Parallel Thread

HP 14

锥外螺纹弯管接头

Taper Elbow Fitting, male

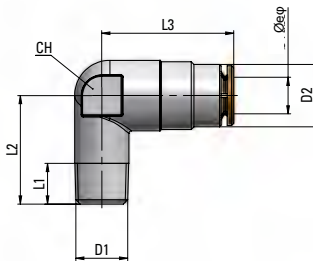

类型	管径 Øe	D1	D2	L1	L2	L3	CH	g Δ
14 04 18	4	R1/8	9.5	7.5	17	21.5	10	15.8
14 04 M6x1	4	M6x1	9.5	6	17	21.5	10	13.9
14 04 M8x1	4	M8x1	9.5	8	17	21.5	10	14.2
14 04 M10x1	4	M10x1	9.5	8	18	21.5	10	16.9
14 06 18	6	R1/8	11.5	7.5	20	24	14	25.1
14 06 M6x1	6	M6x1	11.5	6	20	24	14	24.2
14 06 M8x1	6	M8x1	11.5	8	20	24	14	23.5
14 06 M10x1	6	M10x1	11.5	8	21	24	14	27

HP 18

可调向直外螺纹弯管接头

Parallel Swivelling Elbow, male

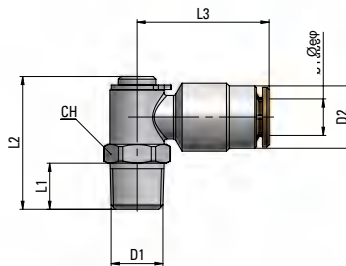

类型	管径 Øe	D1	D2	L1	L2	L3	CH	g Δ
18 04 18	4	R1/8	9.5	8.5	24.5	22	11	18.5
18 04 M6x0.75*	4	M6x0.75	9.5	6	22	22	11	16.8
18 04 M6x1	4	M6x1	9.5	8	24	22	11	16.9
18 04 M8x1	4	M8x1	9.5	8	24	22	11	17.4
18 04 M10x1	4	M10x1	9.5	8	25	22	11	18.9
18 06 18	6	R1/8	11.5	8.5	24.5	24	11	19.8
18 06 14	6	R1/4	11.5	11	28	24	14	25.5
18 06 M6x1	6	M6x1	11.5	8	24	24	11	18.6
18 06 M8x1	6	M8x1	11.5	8	24	24	11	19.4
18 06 M10x1	6	M10x1	11.5	8	25	24	11	20.6

* M6x0.75 圆柱形螺纹 - Parallel Thread.

HP 90

软管接头

Hose Connection, straight

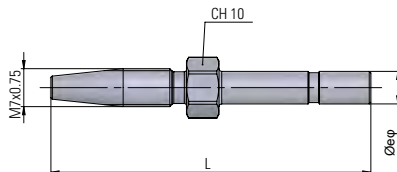

类型	管径 Øe	L	g Δ
90 04 00	4	53	10
90 06 00	6	59	13

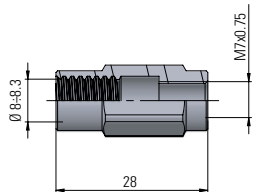

类型

g

99 04 00

13

HP 系列 150bar用止回阀

HP LINE CHECK VALVE for 150 bar

1	2	3	4
本体 Body	卡爪 Gripping Collet	弹簧 Spring	滚珠 Balls
UNI EN 12164 CW614N镀镍黄铜 Brass UNI EN 12164 CW614N Nickel Plated	黄铜UNI EN 12164 CW614N Brass UNI EN 12164 CW614N	AISI 302不锈钢 Stainless Steel AISI 302	AISI 420不锈钢 Stainless Steel AISI 420

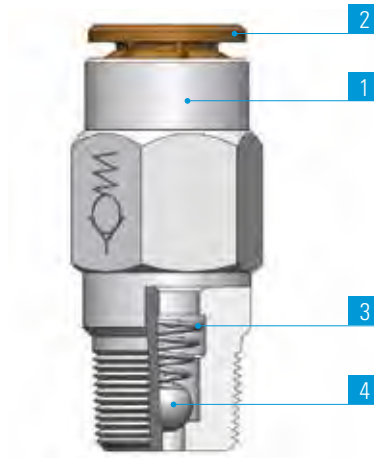
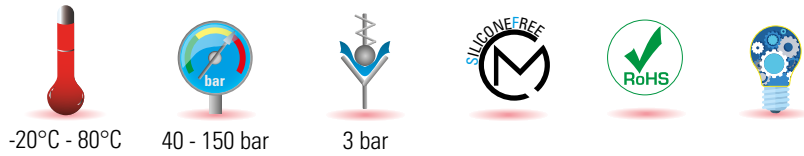

HP 11-NR

150 bar止回阀

Check Valve for 150 bar

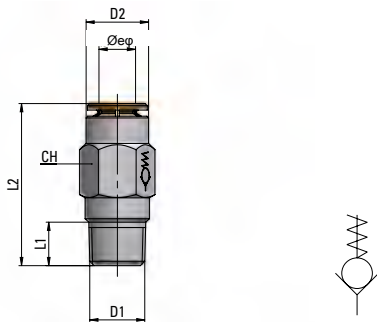

类型	管径Øe	D1	D2	L1	L2	CH	g ΔΔ
11 06 18 NR	6	R1/8	11.5	7.5	29.5	12	-
11 06 M10x1 NR	6	M10x1	11.5	8	29.5	12	15.9

技术规格

建议的连接管路：
Pa6-6 (4x1.5 - 6x3)，高压管路，带金属端管。
可接受的管路公差：
+/- 0.07 mm，最大直径Ø 6 mm。

应用领域：
润滑系统。

DATA SHEET

Recommended tubings:
PA6-6 (4x1,5 – 6x3), High pressure tubing with metal stem.
Acceptable Tolerances on the tubings:
+/- 0,07 mm up to Ø 6 mm.

Application fields:
Lubrication installations.



如果接头连接已经使用了金属管，拆装后，该接头不建议再使用塑料管连接



Should the fitting be assembled with metal tubes, in case of disassembly, we do not recommend to reassemble the same fitting with plastic tubing.