

MB LINE

cmatic[®]
PNEUMATIC FITTINGS

高级合成树脂快插接头
Technopolymer Push-in Fittings



MB



MB系列快插接头使用缩醛树脂(POM)类聚集体制成，具有尺寸稳定，坚固，耐疲劳，耐腐蚀等性能，可以填补传统金属接头和塑料接头之间的空缺。



The push-in Fittings of the MB line are made of a Technopolymer belonging to the Acetal Resins Family (POM) also well known for the dimensional stability offered, stiffness, fatigue and corrosion resistance. These features can bridge the gap between metal and the traditional plastic materials.

MB

1 - 2		3	4	5	6	7
本体与释放环 Body and Release Ring		卡爪 Gripping Collet	支撑环 Holding Ring	保护环 Protection Ring	螺纹体 Threaded Screws	密封圈 Seals
缩醛树脂 Acetal Resin	(POM) (POM)	AISI 301不锈钢 Stainless steel AISI 301	缩醛树脂 Acetal Resin	(POM) (POM)	缩醛树脂 Acetal Resin	(POM) (POM)
					黄铜UNI EN 12164 CW614N镀镍 Brass UNI EN 12164 CW614N Nickel Plated	NBR NBR

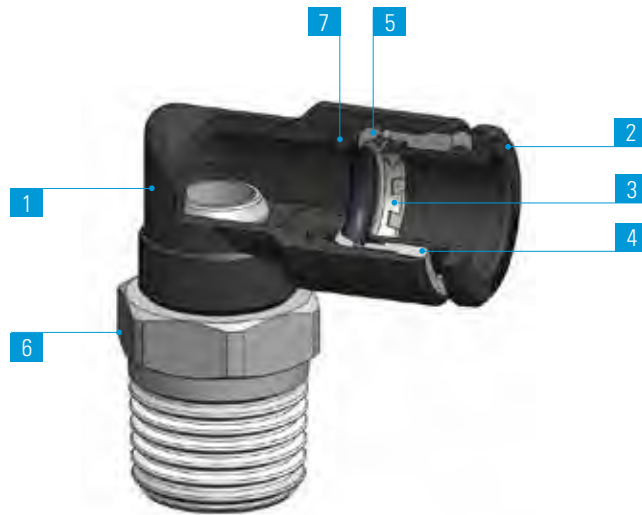
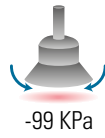

	M5x0.8	G1/8	G1/4	G3/8	G1/2	R1/8	R1/4	R3/8	R1/2
4	•	•	•			•	•		
6	•	•	•			•			
8		•	•	•		•	•	•	
10			•	•			•	•	
12				•	•			•	•
14				•	•			•	•

技术规格

建议的连接管路：
PA11、PA12、PA6、PE聚乙烯、PU聚氨酯 (98 Shore A) 。
可接受的管路公差：
+/- 0.07 mm，最大直径 10 mm
+/- 0.1 mm，最大直径Ø 14mm。

应用领域：
气动系统。

DATA SHEET

Recommended tubings:
PA11, PA12, PA6, Polyethylene PE, Polyurethane PU (98 Shore A).
Acceptable Tolerances on the tubings:
+/- 0,07 mm up to Ø 10 mm
+/- 0,1 mm up to Ø 14 mm.

Application fields:
Pneumatic circuits.

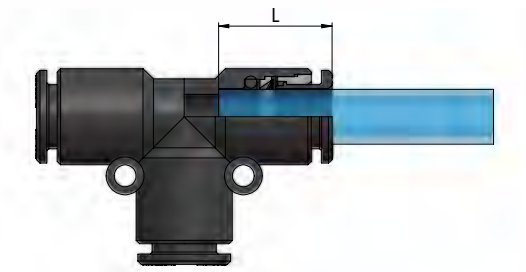

管径 \varnothing_e	L
4	13.4
6	16.3
8	16.5
10	18.5
12	20.3
14	23

安装说明

ASSEMBLY INSTRUCTIONS

- 1.沿管路垂直切割 (使用TCUT管路切刀),确认内外管壁没有毛刺,同时注意避免管路截面呈椭圆形。
- 2.将管路插入接头,到底为止。

1. Cut the tube square (by means of a hose cutter i.e. our TCUT) making sure that no burrs are left and that the tube is not oval.
2. Insert the tube into the fitting until it bottoms.

拔出管路:

垂直按压释放环,同时拔出管路即可。

Tube release

While pressing on the release ring, pull out the tube from the fitting.

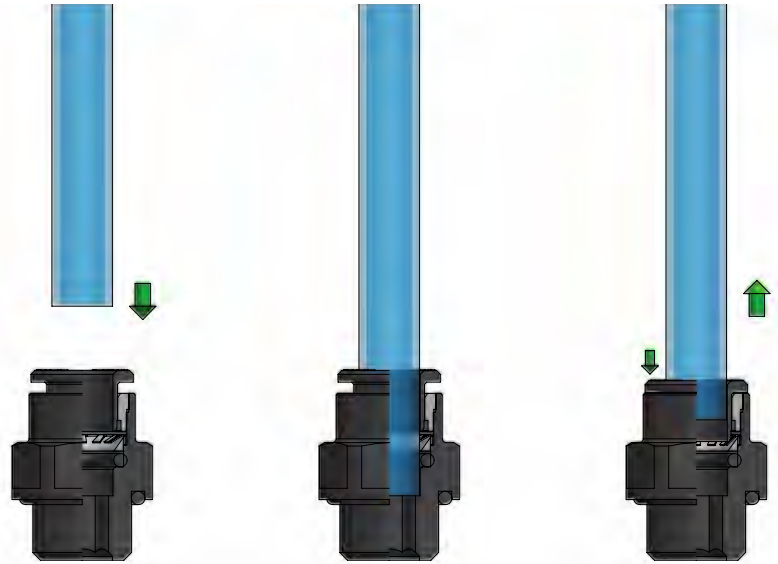

完成连接后,请确保管路上不承受外力;此外,请确保管路连接的最小弯曲半径符合本样册第335页之规定。

为了避免管路意外松脱,任何物体均不要接触释放环。作用在释放环上任何外力,包括侧向力,均可能导致管路意外松脱。螺纹拧紧时,请参考第六页列出的建议扭矩。



Once the tubing is connected to the fitting, make sure that the tubing is not subject to any tensile strength and that the min. recommended bending radius stated in the tubing section of this catalogue is complied with (see page 333).

To prevent any accidental tube release, no components have to come in touch with the release ring and exercise any unwanted pressure on the same. Indeed however lateral, any load on the release ring may cause the tube disconnection. To tighten threads, please check out our tightening torque chart illustrated at page 6.

AP 12

直螺纹直管接头

Parallel Straight, male

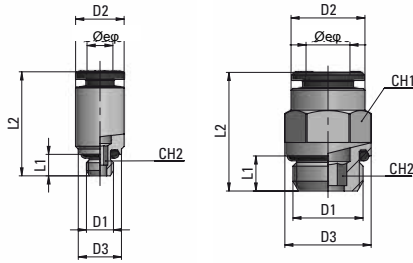

类型	管径 \varnothing_e	D1	D2	D3	L1	L2	CH1	CH2	g $\Delta\Delta$
12 04 M5	4	M5x0.8	9	8	4	19	-	2.5	4.6
12 06 M5	6	M5x0.8	12	8	4	22	-	2.5	8.6
12 04 18	4	G1/8	9	13	5	16.5	9	3	6.1
12 06 18	6	G1/8	12	13.5	5	19.5	12	4	9
12 06 14	6	G1/4	12	16	6.5	19.5	12	4	12.7
12 08 18	8	G1/8	14	13	5	23.5	13	6	11.4
12 08 14	8	G1/4	14	16	6.5	21.5	14	6	13.5
12 08 12	8	G1/2	14	25	8.5	23	14	6	32.6
12 10 14	10	G1/4	16	16	6.5	27.5	15	8	17.4
12 10 38	10	G3/8	16	20	7	25	16	8	22.6
12 12 38	12	G3/8	19	20	7	28.5	19	10	28.9
12 12 12	12	G1/2	19	25	8.5	26.5	19	10	36.1
12 14 38	14	G3/8	22	20	7	32.5	22	10	-
12 14 12	14	G1/2	22	25	8.5	32.5	22	12	-

AP 13

内螺纹直管接头

Female Straight

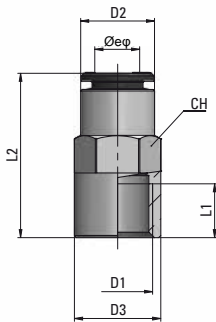

类型	管径 \varnothing_e	D1	D2	D3	L1	L2	CH	g $\Delta\Delta$
13 04 18	4	G1/8	9	13	7.5	23.5	9	10
13 06 18	6	G1/8	12	14	7.5	26	12	15.1
13 06 14	6	G1/4	12	16	11	30	12	18.5
13 08 18	8	G1/8	14	13	7.5	26	14	17.5
13 08 14	8	G1/4	14	16	11	30	14	20.2
13 10 14	10	G1/4	16	16	11	32	16	24.4
13 10 38	10	G3/8	16	20	12	33.5	16	30.3

MB 12

直螺纹直管接头

Parallel Straight, male

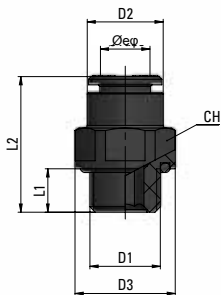

类型	管径 \varnothing_e	D1	D2	D3	L1	L2	CH	g $\Delta\Delta$
12 04 18	4	G1/8	9.7	15.5	6	20.5	14	2.32
12 06 18	6	G1/8	12	15.5	6	24	14	2.65
12 06 14	6	G1/4	12	18.5	8	26	17	4.08
12 08 18	8	G1/8	14	15.5	6	25.5	14	2.88
12 08 14	8	G1/4	14	18.5	8	25	17	3.80
12 08 38	8	G3/8	14	23.5	9	27	21	5.90
12 10 14	10	G1/4	16	18.5	8	27.5	17	3.96
12 10 38	10	G3/8	16	23.5	9	27.5	21	6.20

MB 13

螺纹型尾管接头

Stem Adaptor

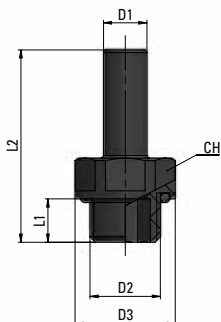

类型	D1	D2	D3	L1	L2	CH	g $\Delta\Delta$
13 04 18	4	G1/8	15.5	6	27	14	1.85
13 06 18	6	G1/8	15.5	6	30	14	2.02
13 06 14	6	G1/4	18.5	8	33.5	17	3.21
13 08 18	8	G1/8	15.5	6	32	14	2.12
13 08 14	8	G1/4	18.5	8	35.5	17	3.54
13 08 38	8	G3/8	23.5	9	37	21	5.42
13 10 14	10	G1/4	18.5	8	37.5	17	3.45
13 10 38	10	G3/8	23.5	9	39	21	5.47

MB 14

直角对接接头

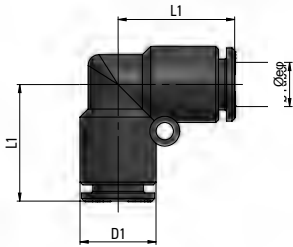

Union Elbow

类型	管径 \varnothing_e	D1	L2	g Δ
14 04 04	4	9.7	15.5	2.24
14 06 06	6	12	19.7	3.77
14 08 08	8	14	21.5	4.85
14 10 10	10	16	23.5	6.30
14 12 12	12	19	27	9.59
14 14 14	14	22.5	31	15.50

MB 15

正T型三通接头

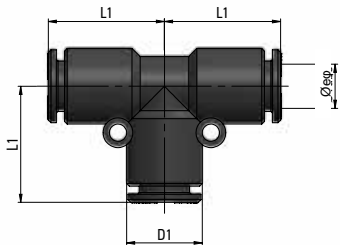

Union Tee

类型	管径 \varnothing_e	D1	L2	g Δ
15 04 04	4	9.7	15.2	3.34
15 06 06	6	12	19.7	5.41
15 08 08	8	14	21.5	7.08
15 10 10	10	16	23.5	8.83
15 12 12	12	19	27	13.83
15 14 14	14	22.5	31	21.70

MB 16

可调向锥外螺纹弯管接头

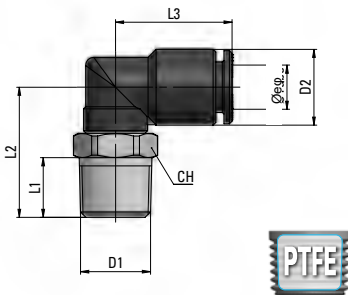

Taper Swivelling Elbow Fitting, male

类型	管径 \varnothing_e	D1	D2	L1	L2	L3	CH	g Δ
16 04 18	4	R1/8	9.7	7.5	17	15.5	10	6.41
16 04 14	4	R1/4	9.7	11	20.5	15.5	14	11.47
16 06 18	6	R1/8	12	7.5	18.8	20	12	8.42
16 06 14	6	R1/4	12	11	23.3	20	14	13.60
16 08 18	8	R1/8	14	7.5	19.5	21.5	12	8.97
16 08 14	8	R1/4	14	11	24	21.5	14	14.05
16 08 38	8	R3/8	14	11.5	24.5	21.5	17	18.97
16 10 14	10	R1/4	16	11	25.5	24	16	17.28
16 10 38	10	R3/8	16	11.5	26.5	24	17	21.66
16 12 38	12	R3/8	19	11.5	28.5	28.5	20	32.80
16 12 12	12	R1/2	19	14	31.5	28.5	22	41.40
16 14 38	14	R3/8	22.5	11.5	29.5	33	20	34.60
16 14 12	14	R1/2	22.5	14	32.5	33	22	43.20

MB 17

接头连接杆可调向锥外螺纹弯管接头

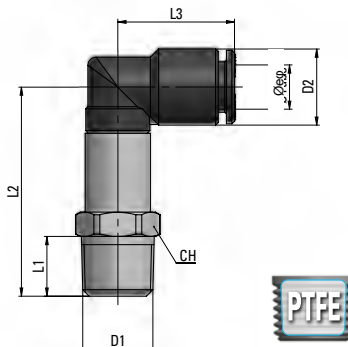

Extended Swivel Elbow, taper

类型	管径 \varnothing_e	D1	D2	L1	L2	L3	CH	g Δ
17 04 18	4	R1/8	9.7	7.5	26	15.5	10	10.02
17 04 14	4	R1/4	9.7	11	30	15.5	14	16.10
17 06 18	6	R1/8	12	7.5	33.3	20	12	17.62
17 06 14	6	R1/4	12	11	37.8	20	14	20.51
17 08 18	8	R1/8	14	7.5	34	21.5	12	18.00
17 08 14	8	R1/4	14	11	38.5	21.5	14	20.79
17 08 38	8	R3/8	14	11.5	39	21.5	17	27.40
17 10 14	10	R1/4	16	11	42	24	16	36.43
17 10 38	10	R3/8	16	11.5	43	24	17	35.05

MB 18

可调向直外螺纹弯管接头

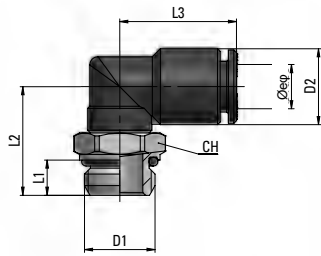

Parallel Swivelling Elbow, male

类型	管径 \varnothing_e	D1	D2	L1	L2	L3	CH	g Δ
18 04 M5	4	M5x0.8	9.7	4	15	15.5	9	4.60
18 04 18	4	G1/8	9.7	5	15	15.5	13	7.10
18 04 14	4	G1/4	9.7	6.5	17	15.5	16	11.11
18 06 M5	6	M5x0.8	12	4	15.3	20	12	7.85
18 06 18	6	G1/8	12	5	17.3	20	12	8.38
18 06 14	6	G1/4	12	6.5	19.3	20	15	12.47
18 08 18	8	G1/8	14	5	18	21.5	12	8.82
18 08 14	8	G1/4	14	6.5	20	21.5	15	12.96
18 08 38	8	G3/8	14	7	21.5	21.5	20	21.36
18 10 14	10	G1/4	16	6.5	21.5	24	16	15.59
18 10 38	10	G3/8	16	7	23.5	24	20	22.83
18 12 38	12	G3/8	19	7	24	28.5	20	27.21
18 12 12	12	G1/2	19	8.5	28.5	28.5	20	34.91
18 14 38	14	G3/8	22.5	7	25	33	20	28.80
18 14 12	14	G1/2	22.5	8.5	29.5	33	20	36.50

MB 19

可调向加长型直外螺纹弯头

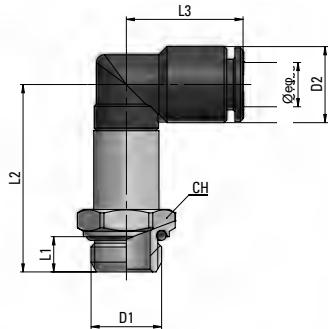

Swivelling Extended Elbow Fitting, male, parallel

类型	管径 \varnothing_e	D1	D2	L1	L2	L3	CH	g Δ
19 04 M5	4	M5x0.8	9.7	4	23.8	15.5	9	9.10
19 04 18	4	G1/8	9.7	5	24	15.5	13	12.20
19 04 14	4	G1/4	9.7	6.5	26	15.5	16	13.71
19 06 M5	6	M5x0.8	12	4	29.8	20	13	20.81
19 06 18	6	G1/8	12	5	31.8	20	13	19.56
19 06 14	6	G1/4	12	6.5	33.8	20	16	20.51
19 08 18	8	G1/8	14	5	32.5	21.5	13	20.00
19 08 14	8	G1/4	14	6.5	34.5	21.5	16	20.93
19 08 38	8	G3/8	14	7	38	21.5	20	29.40
19 10 14	10	G1/4	16	6.5	37	24	16	32.29
19 10 38	10	G3/8	16	7	39	24	20	36.76

MB 20

单铰接头

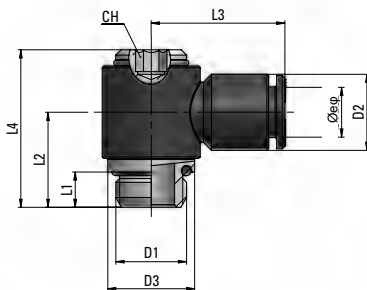

Swivelling Fitting with Banjo Ring

类型	管径 \varnothing_e	D1	D2	D3	L1	L2	L3	L4	CH	g Δ
20 04 M5	4	M5x0.8	9.7	9.7	4	11	19	17.6	4	5.44
20 04 18	4	G1/8	9.7	15	5	15	25.5	19.1	4	12.20
20 06 M5	6	M5x0.8	12	9.7	4	11	19	21.5	4	5.89
20 06 18	6	G1/8	12	15	5	15	25.5	22.7	4	12.79
20 06 14	6	G1/4	12	18	6.5	17.5	29	24.3	5	21.82
20 08 18	8	G1/8	14	15	5	15	25.5	23	4	12.98
20 08 14	8	G1/4	14	18	6.5	17.5	29	24.6	5	22.20
20 08 38	8	G3/8	14	23	7	19.5	32.5	26.5	6	34.86
20 10 14	10	G1/4	16	18	6.5	17.5	29	27	5	22.51
20 10 38	10	G3/8	16	23	7	19.5	32.5	28.5	6	35.50

MB 21

可调向锥螺纹正T型三通接头

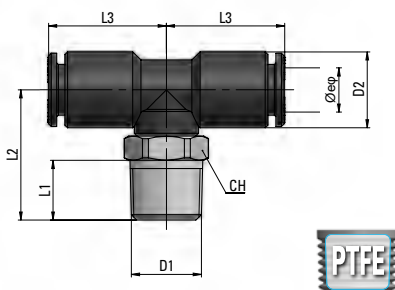

Swivelling Tee, taper

类型	管径 \varnothing_e	D1	D2	L1	L2	L3	CH	g Δ
21 04 18	4	R1/8	9.7	7.5	17	15.7	10	7.41
21 04 14	4	R1/4	9.7	11	20.5	15.7	14	13.80
21 06 18	6	R1/8	12	7.5	18.8	20.2	12	10.03
21 06 14	6	R1/4	12	11	23.3	20.2	14	15.16
21 08 18	8	R1/8	14	7.5	19.5	21.7	12	11.20
21 08 14	8	R1/4	14	11	24	21.7	14	16.34
21 08 38	8	R3/8	14	11.5	24.5	21.7	17	21.34
21 10 14	10	R1/4	16	11	25.5	24	16	19.90
21 10 38	10	R3/8	16	11.5	26.5	24	17	27.00
21 12 38	12	R3/8	19	11.5	28.5	28.5	20	36.30
21 12 12	12	R1/2	19	14	31.5	28.5	22	44.80

MB 22

可调向直螺纹正T型三通接头

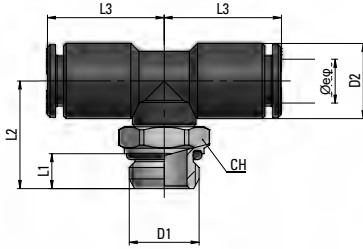

Swivelling Tee Fitting, parallel

类型	管径 \varnothing_e	D1	D2	L1	L2	L3	CH	g Δ
22 04 M5	4	M5x0.8	9.7	4	14.8	15.7	9	5.56
22 04 18	4	G1/8	9.7	5	15	15.7	13	8.11
22 04 14	4	G1/4	9.7	6.5	17	15.7	16	11.96
22 06 M5	6	M5x0.8	12	4	15.3	20.2	12	9.15
22 06 18	6	G1/8	12	5	17.3	20.2	12	9.79
22 06 14	6	G1/4	12	6.5	19.3	20.2	15	13.58
22 08 18	8	G1/8	14	5	18	21.7	12	11.05
22 08 14	8	G1/4	14	6.5	20	21.7	15	15.10
22 08 38	8	G3/8	14	7	21.5	21.7	20	23.70
22 10 14	10	G1/4	16	6.5	21.5	24	16	17.96
22 10 38	10	G3/8	16	7	23.5	24	20	25.18
22 12 38	12	G3/8	19	7	24	28.5	20	30.50
22 12 12	12	G1/2	19	8.5	28.5	28.5	20	38.10

MB 23

可调向锥螺纹直T型三通接头

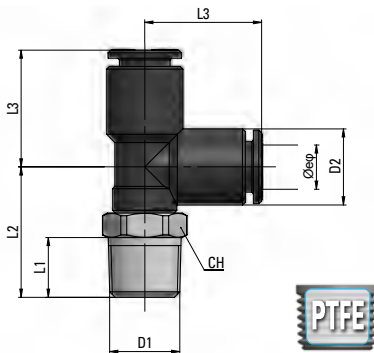

Lateral Swivelling Tee Fitting, taper

类型	管径 \varnothing_e	D1	D2	L1	L2	L3	CH	g Δ
23 04 18	4	R1/8	9.7	7.5	17	15.5	10	7.38
23 04 14	4	R1/4	9.7	11	20.5	15.5	14	12.60
23 06 18	6	R1/8	12	7.5	18.8	20	12	10.09
23 06 14	6	R1/4	12	11	23.3	20	14	15.23
23 08 18	8	R1/8	14	7.5	19.5	21.5	12	10.85
23 08 14	8	R1/4	14	11	24	21.5	14	16.21
23 08 38	8	R3/8	14	11.5	24.5	21.5	17	23.70
23 10 14	10	R1/4	16	11	25.5	24	16	22.50
23 10 38	10	R3/8	16	11.5	26.5	24	17	26.70

MB 24

可调向直螺纹直T型三通接头

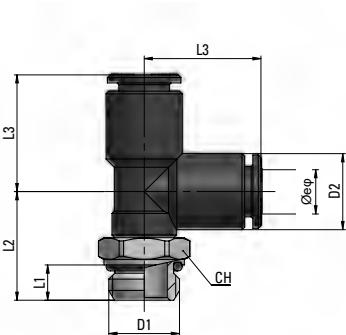

Lateral Swivelling Tee Fitting, parallel

类型	管径 \varnothing_e	D1	D2	L1	L2	L3	CH	g Δ
24 04 M5	4	M5x0.8	9.7	4	14.8	15.5	9	5.57
24 04 18	4	G1/8	9.7	5	15	15.5	13	8.14
24 04 14	4	G1/4	9.7	6.5	17	15.5	16	13.00
24 06 M5	6	M5x0.8	12	4	15.3	20	12	10.30
24 06 18	6	G1/8	12	5	17.3	20	12	9.87
24 06 14	6	G1/4	12	6.5	19.3	20	15	13.91
24 08 18	8	G1/8	14	5	18	21.5	12	10.74
24 08 14	8	G1/4	14	6.5	20	21.5	15	14.73
24 08 38	8	G3/8	14	7	21.5	21.5	20	27.40
24 10 14	10	G1/4	16.5	6.5	21.5	24	16	20
24 10 38	10	G3/8	16.5	7	23.5	24	20	25.09

MB 25

对接接头

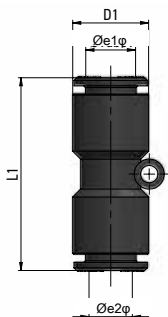

Union

类型	管径1 \varnothing_e	管径2 \varnothing_e	D1	L1	g Δ
25 04 04	4	4	9.7	26.5	2.19
25 06 06	6	6	12	34	3.38
25 08 08	8	8	14	35.5	4.29
25 10 10	10	10	16	37.5	5.45
25 12 12	12	12	19	42	7.55
25 06 04	6	4	12	31	2.82
25 08 06	8	6	14	35	4.01
25 10 08	10	8	16	36.5	7.00
25 12 08	12	8	19	42	9.50
25 12 10	12	10	19	42	8.60
25 14 14	14	14	22.5	49	21.70

MB 26

减径接头

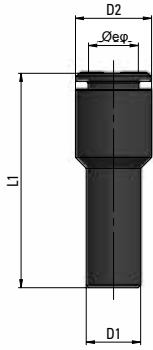

Reducer

类型	管径Øe	D1	D2	L1	g	ΔΔ
26 04 06	4	6	10	31.5	1.66	
26 04 08	4	8	10	32.5	1.97	
26 04 10	4	10	10	34.5	3.00	
26 06 08	6	8	12	37	2.63	
26 06 10	6	10	12	37	3.13	
26 06 12	6	12	12	39	3.89	
26 08 10	8	10	14	39.5	3.72	
26 08 12	8	12	14	41.5	4.38	
26 10 12	10	12	16	45	5.32	
26 10 14	10	14	22.5	45	6.20	
26 12 14	12	14	22.5	47	7.10	

MB 27

减径接头



Reducer

类型	管径Øe	D1	D2	L1	g	ΔΔ
27 06 04	6	4	12	34	2.12	
27 08 06	8	6	14	36.5	2.92	

MB 28

单通铰接接头本体

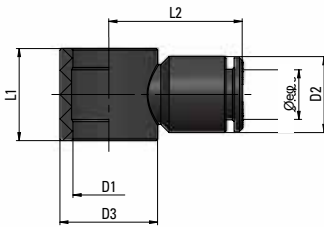

Single Banjo Ring

类型	管径Øe	D1	D2	D3	L1	L2	g	ΔΔ
28 04 M5	4	M5	9.7	9.7	10	17.6	1.89	
28 04 M5 /R	4	7	9.7	9.7	10	17.6	2.3	
28 04 18	4	1/8	9.7	15	15	19.1	2.92	
28 06 M5 /R	6	7	12	9.7	10	21.5	3.10	
28 06 18	6	1/8	12	15	15	22.7	3.47	
28 06 14	6	1/4	12	18	17	24.3	4.15	
28 08 18	8	1/8	14	15	15	23	3.74	
28 08 14	8	1/4	14	18	17	24.6	4.54	
28 08 38	8	3/8	14	23	20	26.5	6.41	
28 10 14	10	1/4	16	18	17	27	5.15	
28 10 38	10	3/8	16	23	20	28.5	8.40	

/R = 仅用于流量调节器 - For flow controls only.

MB 29

Y型接头

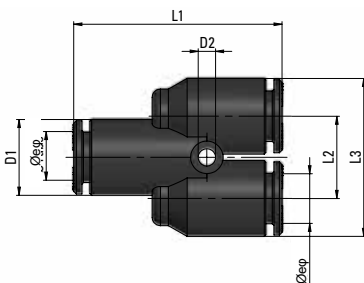

Y Fitting

类型	管径Øe	D1	D2	L1	L2	L3	g	ΔΔ
29 04 04	4	9.7	2.7	28.3	10.7	20.5	3.52	
29 06 06	6	12	3.2	36	13	25	5.71	
29 08 08	8	14	3.2	38.5	15	29	7.86	
29 10 10	10	16	3.2	40.6	18	34.5	9.67	
29 12 12	12	19	3.2	46	21.5	40.5	15.47	

MB 30

带尾管Y型接头

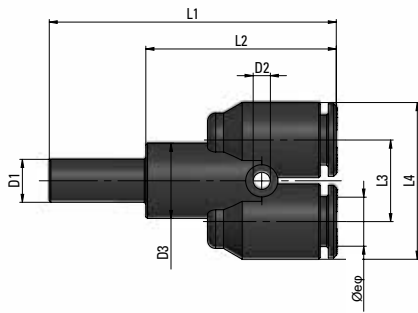

Tube Y Coupling

类型	管径 \varnothing_e	D1	D2	D3	L1	L2	L3	L4	g $\Delta\Delta$
30 04 04	4	4	2.7	9.7	40	25.8	10.7	20.5	3.78
30 04 06	4	6	2.7	9.7	43	25.8	10.7	20.5	4.22
30 04 08	4	8	2.7	9.7	45	25.8	10.7	20.5	4.50
30 06 06	6	6	3.2	12	50	32.9	13	25	6.32
30 08 08	8	8	3.2	14	54	35.5	15	29	8.73

MB 31

直螺纹Y型接头

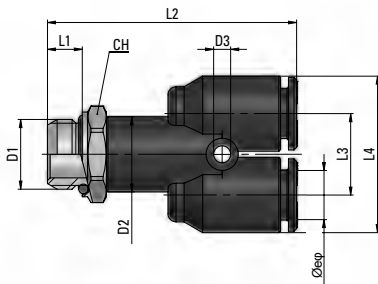

Threaded Y Fitting

类型	管径 \varnothing_e	D1	D2	D3	L1	L2	L3	L4	CH	g $\Delta\Delta$
31 04 M5	4	M5x0.8	9.7	2.7	4	34	10.7	20.5	9	6.47
31 04 18	4	G1/8	9.7	2.7	5	34	10.7	20.5	13	9.04
31 04 14	4	G1/4	9.7	2.7	6.5	36	10.7	20.5	16	13.37
31 06 18	6	G1/8	12	3.2	5	41	13	25	13	11.53
31 06 14	6	G1/4	12	3.2	6.5	43	13	25	16	16.15
31 08 18	8	G1/8	14	3.2	5	43	15	29	14	15.94
31 08 14	8	G1/4	14	3.2	6.5	45	15	29	16	18.77
31 08 38	8	G3/8	14	3.2	7	47	15	29	20	27.74

MB 32

接头连接杆

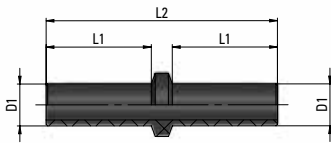

Extension Piece

类型	D1	L1	L2	g $\Delta\Delta$
32 04 00	4	15	33	0.56
32 06 00	6	18	40	1.27
32 08 00	8	20	45	1.79
32 10 00	10	22	48	3.09
32 12 00	12	25	54	4.24
32 14 00	14	25	54	4.80

MB 33

堵头

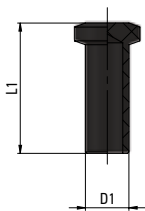

Plug

类型	D1	L1	g $\Delta\Delta$
33 04 00	4	18	0.34
33 06 00	6	22	0.90
33 08 00	8	25	1.26
33 10 00	10	26	1.99
33 12 00	12	40	3.30
33 14 00	14	40	4.20

MB 35

分流排

Manifold

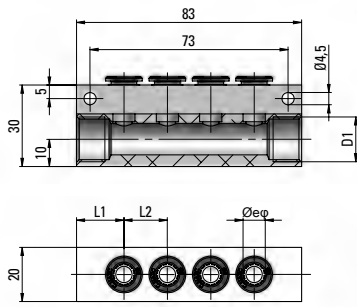

类型	管径 Øe	D1	L1	L2	输出数	g $\Delta\Delta$
35 04 06	4	G1/4	14	11	6	111.73
35 06 05	6	G1/4	15.5	13	5	104.05
35 08 04	8	G3/8	17.5	16	4	99.34

MB 36

分流接头

Manifold

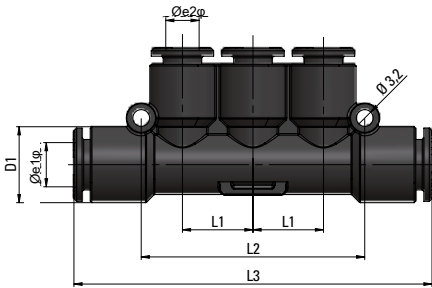

类型	管径1 Øe	管径2 Øe	D1	L1	L2	L3	g $\Delta\Delta$
36 06 04	6	4	12	11	35	59	79.5
36 08 06	8	6	14	13	41	66	111.6

MB 43

一对多Y型插管接头

Double Y-Coupling

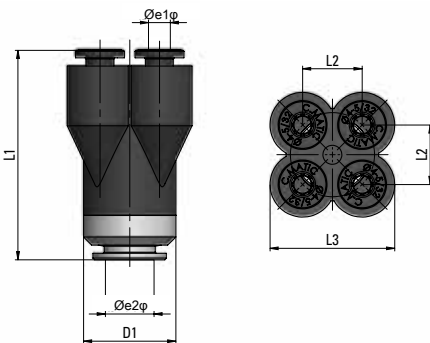

类型	管径1 Øe	管径2 Øe	D1	L1	L2	L3	g $\Delta\Delta$
43 04 06	4	6	17	38	11	24	27.80
43 04 08	4	8	17	38	11	24	25.00

MB 44

一对多Y型直螺纹接头

Double Y-Coupling with Threaded Joint Fitting

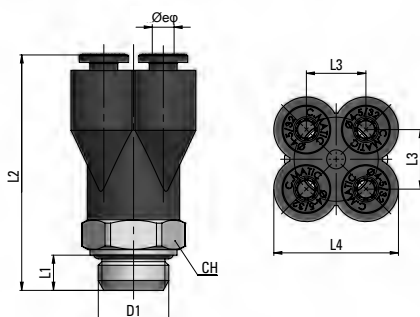

类型	管径 Øe	D1	L1	L2	L3	L4	CH	g $\Delta\Delta$
44 04 18	4	G1/8	5	41	11	24	17	32.80
44 04 14	4	G1/4	6.5	43	11	24	17	32.00

MB 46

可调向H型接头

Swivelling Cross Fitting

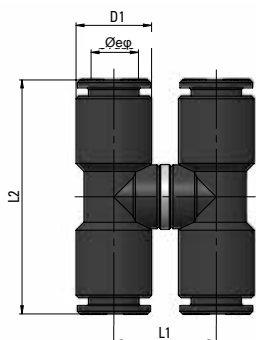

类型	管径Øe	D1	L1	L2	g Δ
46 04 04	4	9.7	14	31.4	9.20
46 06 06	6	12	17	40.4	11.85
46 08 08	8	14	19.5	43.4	14.12
46 10 10	10	16	23	48	25.80

MB 48

穿板直角接头

Elbow Bulkhead

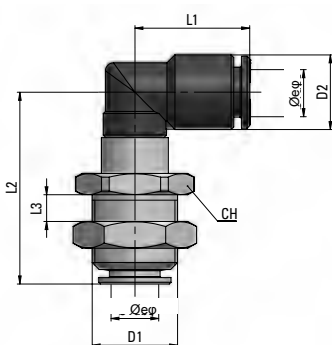

类型	管径Øe	D1	D2	L1	L2	L3 最大	CH	g Δ
48 04 04	4	M12x0.75	9.7	15.5	27.1	6	15	17.98
48 06 06	6	M14x1	12	20	33	6	18	32.79
48 08 08	8	M16x1	14	21.5	35.7	8	20	39.56
48 10 10	10	M18x1	16	24	40.3	9.5	22	52.84
48 12 12	12	M20x1	19	28.5	44.5	10	24	71.50

MB 49

带尾管直角接头

Plug-in Elbow

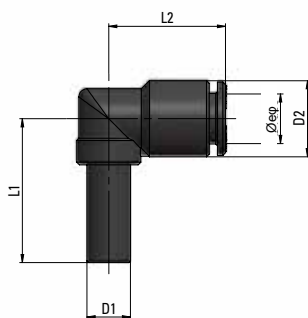

类型	管径Øe	D1	D2	L1	L2	g Δ
49 04 04	4	4	9.7	21.5	15.5	1.75
49 06 06	6	6	12	25.5	20	3.21
49 08 08	8	8	14	28.5	21.5	3.80
49 10 10	10	10	16	32.5	24	6.73
49 12 12	12	12	19	33	28.5	9.51
49 14 14	14	14	22.5	37	33	11.50

MB 10

埋入式接头

MB10埋入接头的优良结构设计，使得同一规格接头能够同时适用于塑料，铝和黄铜等不同基座材质。

Press-in Cartridge

The new construction features of the cartridge MB10 allow for one single cartridge version to be assembled in plastic, aluminium as well as brass bodies.

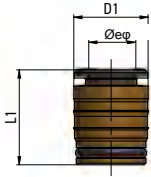

类型	管径 \varnothing_e	D1	L1	g
10 04 00	4	9	14.5	2.75
10 06 00	6	11.5	16.5	4.59
10 08 00	8	13.5	17	6.39
10 10 00	10	15.5	18.5	8.32

钻孔示意图

Cartridge Seat Drilling Plan

类型	D1	D2	D3	D4	L1	L2
4	9.5	9.2	3	8.6	12	3.2
6	11.7	11.4	5	10.8	14	4
8	13.9	13.6	7	13	14.5	4
10	16	15.7	9	15.1	16	4

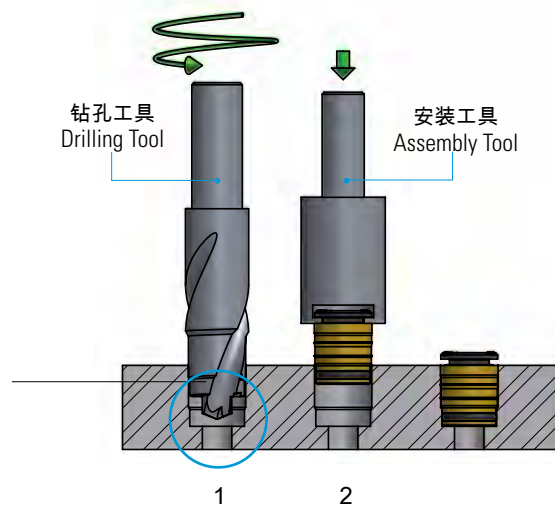
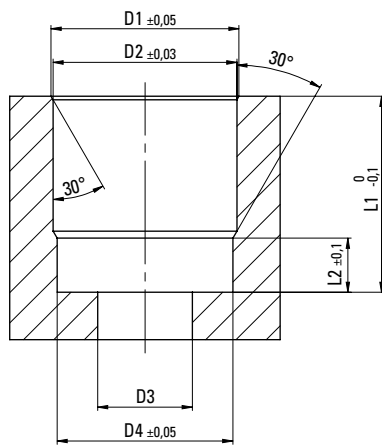

1. 按照提供的说明和钻孔方法来加工埋入孔

2. 手动将接头按压入埋入孔，再使用埋入工具进行压装，直至底部，这样就确保了正确安装

可根据要求提供“钻孔和安装工具”。

1. Drill the cartridge seat, following the instructions given

2. Manually press the cartridge into the seat and by means of the Assembly Tool push it all the way down until it bottoms; this will guarantee the proper cartridge assembly.

“Drilling and Assembly Tool” available upon request.