

QO LINE

cmatic[®]
PNEUMATIC FITTINGS

350 bar 液压用快插接头
Push-in Fittings for Hydraulics, 350 bar



快插接头，专为耐受高达350 bar的工作压强而开发和测试。紧凑创新的设计，安装快速、简单、安全，无需借助工具，尤其适合空间有限和操作困难的安装场合。
接头和联轴器之间的液压密封通过接头外部的密封圈实现，便于在发生损坏或磨损时进行维护。



Push-in Fittings designed and tested to guarantee a working pressure of 350 bar. The compact, innovative design allows for safe, quick and easy assemblies with no need for assembly tools on reduced manifold spaces as well as during difficult assembly operations. The hydraulic tightness between the Fitting and the plug is guaranteed by an o-ring outside of the fitting itself. This feature enables the fitting service-ability in case of o-ring damage or wear out.

00	1-2	3	4	5	6
本体和卡爪 Body and Gripping Collet	释放环 Release Ring	安全环 Safety Ring	密封圈 Seals	支撑环 Backup Ring	
镀锌钢 Zinc plated steel	镀锌钢 Zinc plated steel	PA66	NBR 90 Sh	PTFE	

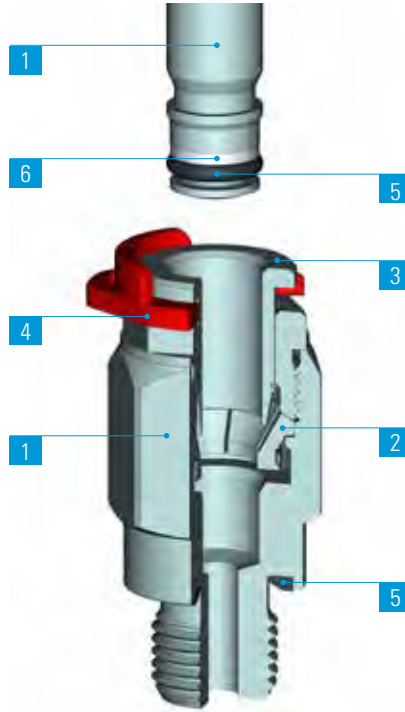

	G1/4	G3/8	G1/2	G3/4	7/16-20	9/16-18	3/4-16	11/16-12	M14x1.5	M16x1.5	M18x1.5	M20x1.5
4	•				•				•			
6		•				•				•		
8			•				•				•	
12				•				•				•

技术规格

建议的连接管路：
带强化编织层的耐油合成橡胶管路；用于固定端管的套箍取决于管路类型。

应用领域：
液压设备

DATA SHEET

Recommended tubings:
Synthetic oil-resistant rubber hose with braids reinforcement; the ferrule for the hose terminal will depend on the hose type.

Application fields:
Hydraulics.

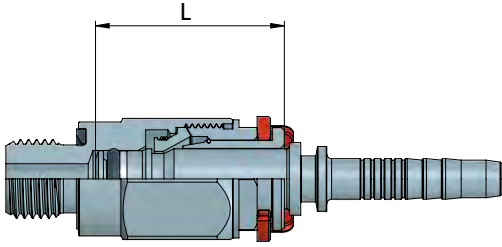

Plug-in DN Dash	L
4	31
6	33.5
8	37.5
12	42

安装说明

ASSEMBLY INSTRUCTIONS

1. 确认端管上正确装有支撑环和密封密封圈，并已正确润滑。
2. 将端管插入接头内，并推至底部，并确认安全环位于释放环下方。

1. Make sure that the back up ring and the tightness ring are assembled and duly greased on the straight hose connection.
2. Push the straight hose connection all the way into the fitting until it bottoms; the hose connection can be assembled also if the safety ring is in place under the release ring.

抽取管路

1. 取下释放环下方的的安全环；
2. 垂直按压释放环，同时将端管从接头中拔出。

Tube release

1. Remove the safety ring under the release ring
2. Press the release ring and pull the hose connection out of the fitting.

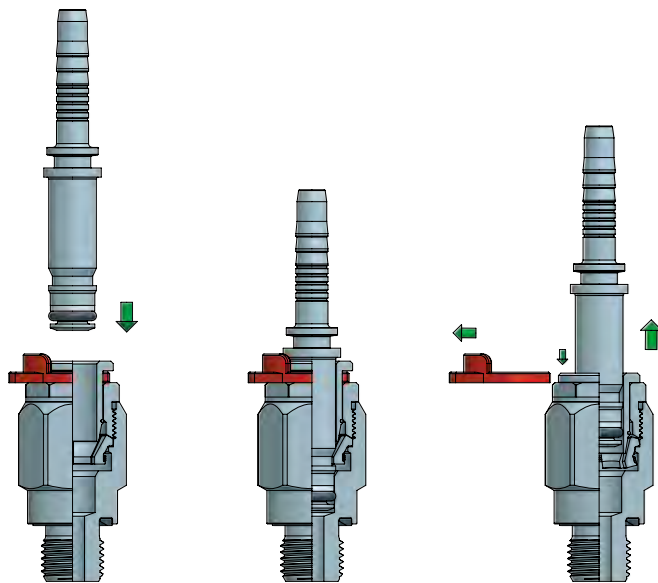

完成连接后，请确保管路上不承受外力；此外，请确保管路连接的最小弯曲半径符合本样册第335页之规定。
 为了避免管路接头因为释放环意外受力而断开，工作过程中必须确保安全环总是在正确的位置上。安全环连接有一条固定缆线。安全环套件可单独购买，其中包含固定缆线。
 螺纹拧紧时，请参考第六页列出的建议扭矩。



Once the tubing is connected to the fitting, make sure that the tubing is not subject to any tensile strength and that the min. recommended bending radius stated in the tubing section of this catalogue is complied with (see page 335).
 In order to prevent an involuntary hose disconnection due to an accidental pressure on the fitting release ring, make sure that the safety ring is always in place when the fitting is pressurized. The safety ring shape allows for a fixing wire to be connected. A KIT is also available and it contains the safety ring pre-assembled with the fixing wire. To tighten threads, please check out our tightening torque chart illustrated at page 6.

00 12

BSPP螺纹直管接头

Straight Push-in Fitting, BSPP Thread

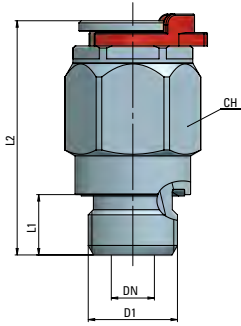

类型	Plug-in DN Dash	D1 Thread	L1	L2	CH	g Δ
12 04 G1/4	04	G1/4	12	46	20	60.8
12 06 G3/8	06	G3/8	12	48	24	85.5
12 08 G1/2	08	G1/2	14	54.5	28	128.8
12 12 G3/4	12	G3/4	16	61.5	38	228

BSPP (ISO 1179-2)

00 12

UNF螺纹直管接头

Straight Push-in Fitting, UNF Thread

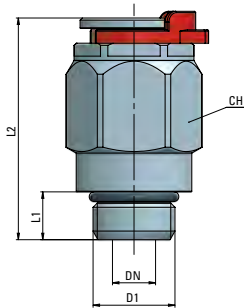

类型	Plug-in DN Dash	D1 Thread	L1	L2	CH	g Δ
12 04 7/16 UNF ORB	04	7/16-20	9	43	20	60.8
12 06 9/16 UNF ORB	06	9/16-18	10	46	24	85.5
12 08 3/4-16 UNF ORB	08	3/4-16	11	51.5	28	128.8
12 12 1-1/16 UNF ORB	12	1 1/16-12	15	60.5	38	228

SAE Oring Boss - UNF Stud (ISO 11926-3)

00 12

公制螺纹直管接头

Straight Push-in Fitting, metric

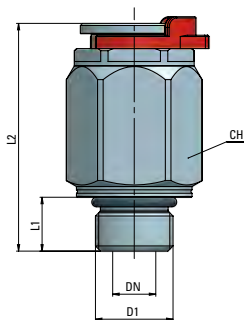

类型	Plug-in DN Dash	D1 Thread	L1	L2	CH	g Δ
12 04 M14x1.5	04	M14x1.5	11	45	20	60.8
12 06 M16x1.5	06	M16x1.5	11.5	47.5	24	85.5
12 08 M18x1.5	08	M18x1.5	12.5	53	28	128.8
12 12 M22x1.5	12	M22x1.5	13	58.5	38	228

Metric Stud (ISO 6149-3)

00 90

软管接头

Hose Connection, straight

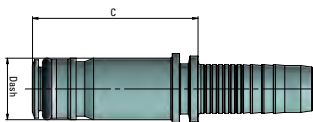

类型	Plug-in DN Dash	Hose ID (inch)	Hose ID (mm)	C CUT-OFF (mm)	g Δ
90 04 1/4	04	1/4	6.2	38.2	21.4
90 06 3/8	06	3/8	9.5	40.3	38
90 08 1/2	08	1/2	12.9	45.6	64.1
90 12 3/4	12	3/4	19	52.1	132.8

Q0 91

45°端管

45° Hose Connection

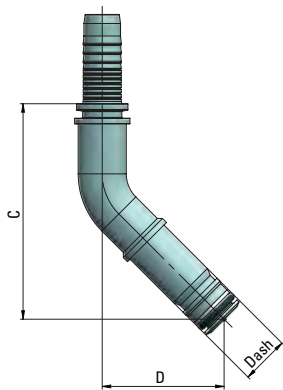

类型	Plug-in DN Dash	Hose ID (inch)	Hose ID (mm)	C CUT-OFF (mm)	D drop (mm)	g $\Delta\Delta$
91 04 1/4	04	1/4	6.2	62.2	37.6	41.9
91 06 3/8	06	3/8	9.5	67.6	40.3	71.8
91 08 1/2	08	1/2	12.9	76	43	121.4
91 12 3/4	12	3/4	19	97.5	56.4	273.2

Q0 92

90°端管

90° Hose Connection

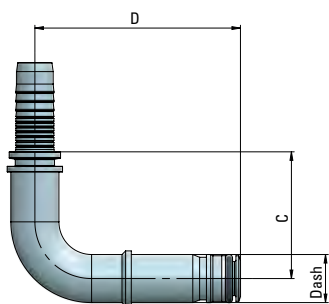

类型	Plug-in DN Dash	Hose ID (inch)	Hose ID (mm)	C CUT-OFF (mm)	D drop (mm)	g $\Delta\Delta$
92 04 1/4	04	1/4	6.2	33.3	62	47.6
92 06 3/8	06	3/8	9.5	37.9	67.5	81.9
92 08 1/2	08	1/2	12.9	44.7	72.5	140.7
92 12 3/4	12	3/4	19	59.8	98.5	325.6

SAFETY KIT



类型	g $\Delta\Delta$
SAFETY KIT DASH 04	-
SAFETY KIT DASH 06	-
SAFETY KIT DASH 08	-
SAFETY KIT DASH 12	-

QO 10

埋入接头

QO10埋入接头是解决空间狭窄的优异方案，紧凑的产品设计，使得它安装在阀组模板上几乎不占空间。

Push-in Cartridge Fitting

The QO10 cartridge is the right solution in case of lack of space; the compact design allows for the assembly of the cartridge in such a way that it almost completely disappears once assembled in its own body (manifolds/ valves etc)

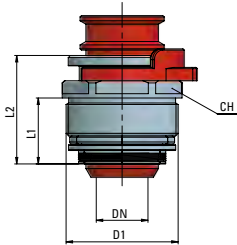

类型	Plug-in DN Dash	D1 Thread	L1	L2	CH	g Δ
10 04 00	04	M18x1	13.2	21.7	17	22.3
10 06 00	06	M22x1	13.9	23.1	21	33
10 08 00	08	M26x1	15.3	25.1	25	46.7
10 12 00	12	M34x1	18.2	28.2	32	80.3

钻孔示意图

Cartridge Seat Drilling Plan

DN (Dash)	D1	D2	D3	D4	L1	L2	L3	L4
04	M18x1	16.2	10.8	9.4	8	10.6	14.4	23.1
06	M22x1	20	14	12.25	8.5	11	15.3	24.3
08	M26x1	24	17.8	16.2	9	12.1	16.9	27.9
12	M34x1	32.2	25	23	12	15	20.6	32.6

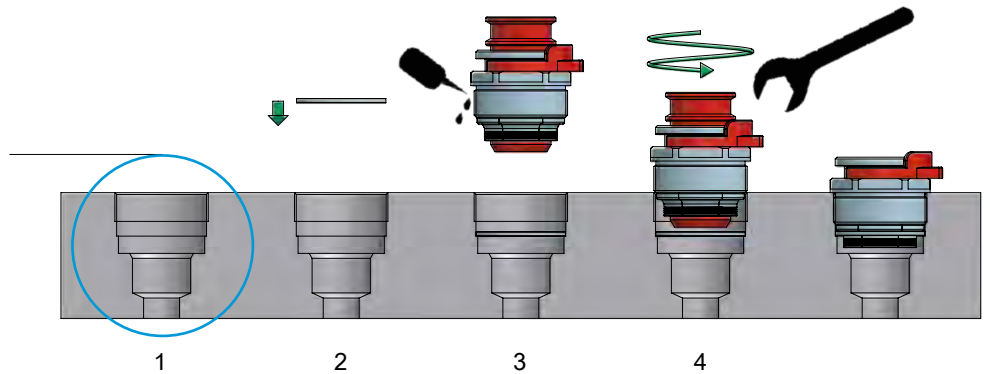
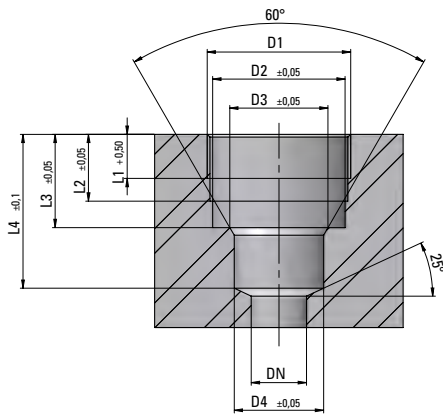

- 1 按照尺寸图加工埋入孔基座；
- 2 如图所示，将埋入接头垫片放置到基座底部；
- 3 在埋入接头螺纹上涂抹一层螺纹锁固剂；
- 4 将埋入接头拧入基座底部，确保到底。

1. Machine the cartridge Seating according to the drawing stated below;
2. Place at the bottom of the Seating the distance Ring provided with the cartridge , as shown in the picture;
3. Apply a light layer of threadlocking sealant on the cartridge thread;
4. Screw the cartridge all the way into its Seating until it bottoms.