

RX LINE

RX

cmatic[®]
PNEUMATIC FITTINGS

316L 不锈钢标准接头
316L Stainless Steel Standard Fittings



Certified to
NSF/ANSI 169



RX系列包括AISI 316L 不锈钢标准接头，是快插接头，卡套接头、不锈钢功能接头系列的补充。



RX are our standard fittings in stainless steel AISI 316L; the right complement to our AISI 316L Fitting program.

RX

1	2
本体 Body	密封圈 Seals
AISI 316L不锈钢(1.4404) Stainless Steel AISI 316L (1.4404)	FPM FPM



	M5x0.8	G1/8	G1/4	G3/8	G1/2	R1/8	R1/4	R3/8	R1/2
	•	•	•	•	•	•	•	•	•
	•								

应用领域：
气动、食品、化学、医疗制药行业。

Application fields:
Pneumatics, Food Industry, Chemical, Medical and Pharmaceutical Industry.

RX 12

锥螺纹转接头

Nipple, taper

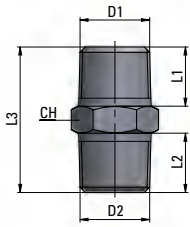

类型	D1	D2	L1	L2	L3	CH	g Δ
12 18 18	R1/8	R1/8	7.5	7.5	20	12	8.1
12 18 14	R1/8	R1/4	7.5	11	23.5	14	12.5
12 14 14	R1/4	R1/4	11	11	27	14	14.8
12 14 38	R1/4	R3/8	11	11.5	27.5	17	20.9
12 38 38	R3/8	R3/8	11.5	11.5	28	17	24.3
12 38 12	R3/8	R1/2	11.5	14	31.5	22	38.5
12 12 12	R1/2	R1/2	14	14	34	22	38.9

RX 13

转接头

Joint Piece

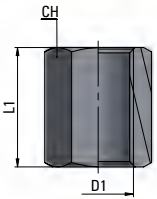

类型	D1	L1	CH	g Δ
13 00 18	G1/8	15	14	11.8
13 00 14	G1/4	22	17	21.6
13 00 38	G3/8	24	22	40.5
13 00 12	G1/2	30	27	73.5

RX 14

锥螺纹减径接头

Taper Female-Male reducing connector

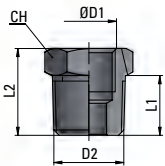

类型	D1	D2	L1	L2	CH	g Δ
14 18 14	G1/8	R1/4	11	16	14	8.8
14 18 38	G1/8	R3/8	11.5	16.5	17	18.6
14 18 12	G1/8	R1/2	14	19.5	22	32
14 14 38	G1/4	R3/8	11.5	16.5	17	11.9
14 14 12	G1/4	R1/2	14	19.5	22	34.6
14 38 12	G3/8	R1/2	14	19.5	22	22.7

RX 15

直螺纹减径接头

Parallel Female-Male reducing connector

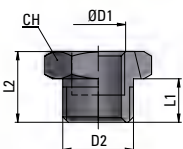

类型	D1	D2	L1	L2	CH	g Δ
15 M5 18	M5x0.8	G1/8	6	10.5	14	7.8
15 18 14	G1/8	G1/4	8	13	17	10.5
15 14 38	G1/4	G3/8	9	14	19	12.7

RX 21

内螺纹直角转接头

Female Elbow

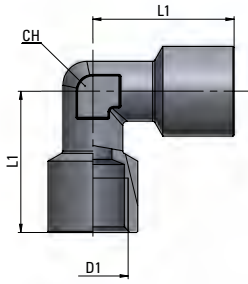

类型	D1	L1	CH	g $\Delta\Delta$
21 18 18	G1/8	22	10	19
21 14 14	G1/4	26	12	37.4
21 38 38	G3/8	28	17	44
21 12 12	G1/2	34	19	75.6

RX 22

内外螺纹直角转接头

Male-Female Elbow

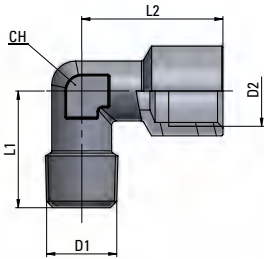

类型	D1	D2	L1	L2	CH	g $\Delta\Delta$
22 18 18	R1/8	G1/8	17	22	10	16.3
22 14 14	R1/4	G1/4	21.5	26	12	37.5
22 38 38	R3/8	G3/8	24.5	28	17	40.9
22 12 12	R1/2	G1/2	30.5	34	19	71.8

RX 23

内螺纹三通转接头

Female T

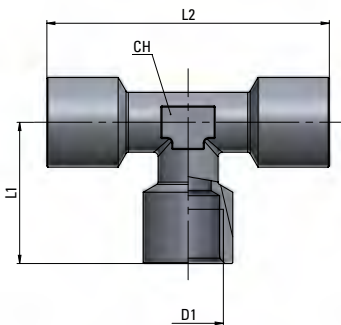

类型	D1	L1	L2	CH	g $\Delta\Delta$
23 18 18	G1/8	22	44	10	26.6
23 14 14	G1/4	26	52	12	48.8
23 38 38	G3/8	28	56	17	60
23 12 12	G1/2	34	68	19	108.5

RX 24

内外螺纹三通转接头

Male-Female Stud Tee

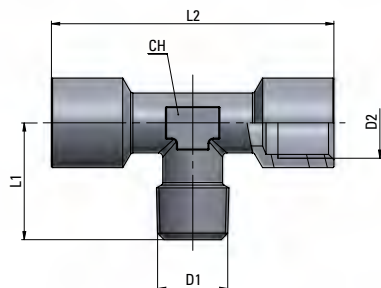

类型	D1	D2	L1	L2	CH	g $\Delta\Delta$
24 18 18	R1/8	G1/8	17	44	10	24.7
24 14 14	R1/4	G1/4	21.5	52	12	51.4
24 38 38	R3/8	G3/8	24.5	56	17	57.5
24 12 12	R1/2	G1/2	30.5	68	19	101.4

RX 35

外螺纹弯管接头

Male-Male Elbow

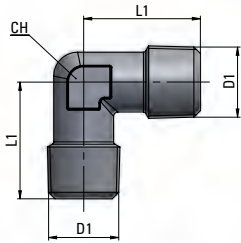

类型	D1	D2	L1	CH	g Δ
35 18 18	R1/8	R1/8	17	10	10.1
35 14 14	R1/4	R1/4	21.5	12	20.3
35 38 38	R3/8	R3/8	24.5	17	37.9
35 12 12	R1/2	R1/2	30.5	19	62

RX 42

单铰接头本体

Single Banjo Ring

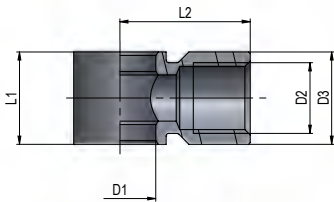

类型	D1	D2	D3	L1	L2	g Δ
42 00 18	10	G1/8	14	15	18.5	15.8
42 00 14	13.2	G1/4	17	17	24	24.3
42 00 38	17	G3/8	20	20	29	40
42 00 12	21	G1/2	26	24	34.5	63.8

RX 43

锥螺纹堵头

Taper Plug

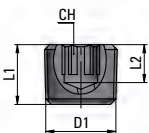

类型	D1	L1	L2	CH	g Δ
43 00 18	R1/8	7.5	6	5	2.6
43 00 14	R1/4	11	8	6	8.4
43 00 38	R3/8	11.5	8	10	13.3
43 00 12	R1/2	14	9.5	10	25.7



RX 46

带O型圈堵头

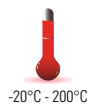
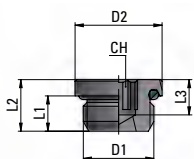
Male Plug with O-Ring

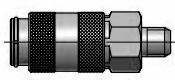
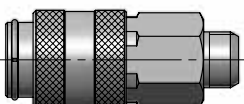
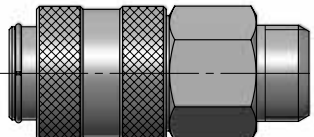
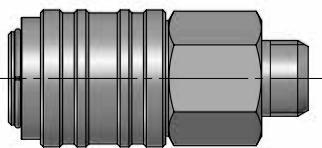
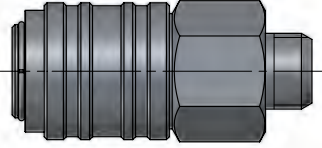
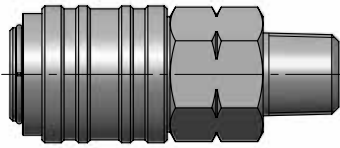
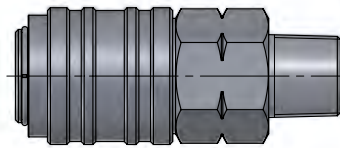

类型	D1	D2	L1	L2	L3	CH	g Δ
46 00 18	G1/8	13	5	7.5	4.5	5	4.1
46 00 14	G1/4	16	6.5	9.5	5.5	6	8.3
46 00 38	G3/8	20	7	10	6	8	14.2
46 00 12	G1/2	25	8.5	12	7	10	28.8

类型	Profiles			页码ref.
GU20	Mini	2.5		BSP 188
GU21	Midi	5.5		BSP 190
GU26	European	7.4		BSP 193
GU10	Multi	5.5 - 7.4		BSP 196
GX10 不锈钢	Multi	5.5 - 7.4		BSP 204
PU10	Multi	5.5 - 7.4		NPT 200
PUX10 不锈钢	Multi	5.5 - 7.4		NPT 208