

**AV LINE**



CN

### 食品行业用高性能黄铜快插接头

AV系列快插式管接头采用黄铜材质制造，并经过化学镀镍处理。该产品系列已通过NSF 169认证，因其在腐蚀性和高温环境中表现出良好的耐受性，成为食品和化学行业的理想选择产品。所有AV管接头均采用含磷化学镀镍工艺处理，并通过NSF 51标准认证。

EN

### Brass Push-in Fittings for Food and High Performance Applications

The push-in fittings of the AV line are made of brass, chemical nickel plated. This product family is NSF 169 certified and as such it is a good alternative product for food and chemical industry, given the good resistance in corrosive and high temperature rated environments. All AV fittings are subject to a phosphorous chemical nickel-plating treatment. certified NSF 51.

# AV Line

- 1** 本体  
Body

黄铜UNI EN 12164 CW614N - UNI EN 12165 CW617N化学镀镍  
Brass UNI EN 12164 CW614N - UNI EN 12165 CW617N, chemical nickel Plated
- 2** 释放环  
Release ring
- 3** 支撑环  
Holding ring

树脂  
Resin
- 4** 卡爪  
Gripping ring

(PEI)  
(PEI)

AISI 301 不锈钢  
Stainless steel AISI 301
- 5** 保护环  
Protection ring

树脂  
Resin
- 6** 密封圈  
Seals

(PEI)  
(PEI)

满足FDA规范的FPM  
FPM, FDA compliant

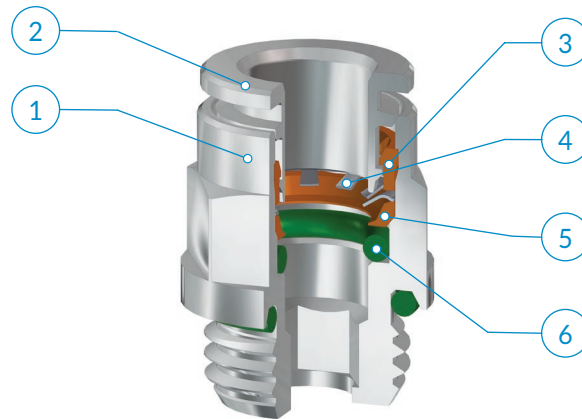

	M5x0,8	1/8	1/4	3/8	1/2
4	●	●	●		
6	●	●	●		
8		●	●	●	
10			●	●	●
12			●	●	●



涉及蒸汽应用, 请联络销售技术团队。  
For steam applications, please contact our sales engineering team.

### 建议的连接管路:

PA11、PA12、PA6、PE聚乙烯、  
PU聚氨酯 (98 Shore A)。

### 可接受的管路公差:

+/- 0.07 mm, 最大直径 10 mm  
+/- 0.1 mm, 直径从12到 14 mm。

### 应用领域:

气动系统。

### Recommended tubings:

PA11, PA12, PA6, Polyethylene PE,  
Polyurethane PU (98 Shore A)

### Acceptable Tolerances on the tubings:

+/- 0,07 mm up to Ø 10 mm  
+/- 0,1 mm from Ø 12 up to Ø 14 mm

### Application fields:

Pneumatic circuits

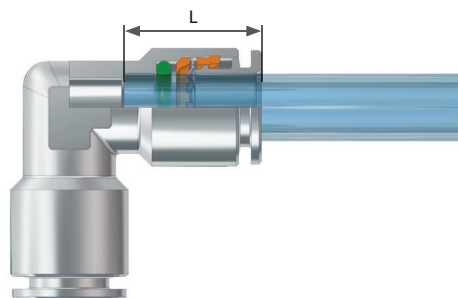

OD	L
4	13,2
6	16,1
8	16,2
10	18,3
12	19,5

安装说明

ASSEMBLY INSTRUCTIONS

1

沿管路垂直切割 (使用TCUT切管刀),确认内外管壁没有毛刺,同时注意避免管路截面呈椭圆形。使用金属管路连接时,需要通过专用设备 (TINC) 在管路上开槽。开槽尺寸需要考虑管路直径,以保证可靠的连接。

1

Cut the tube square (by means of a hose cutter i.e. our TCUT) making sure that no burrs are left and that the tube is not oval. In case of use with metal hoses, make a groove all around the tube diameter with a suitable tool (TINC).The groove must be made according to the tube diameter so that the fitting collect can better grip onto it.

2

将管路插入接头,到底为止。

2

Insert the tube into the fitting until it bottoms.

拔出管路:

垂直按压释放环,同时拔出管路即可。

Tube release

While pressing on the release ring, pull out the tube from the fitting

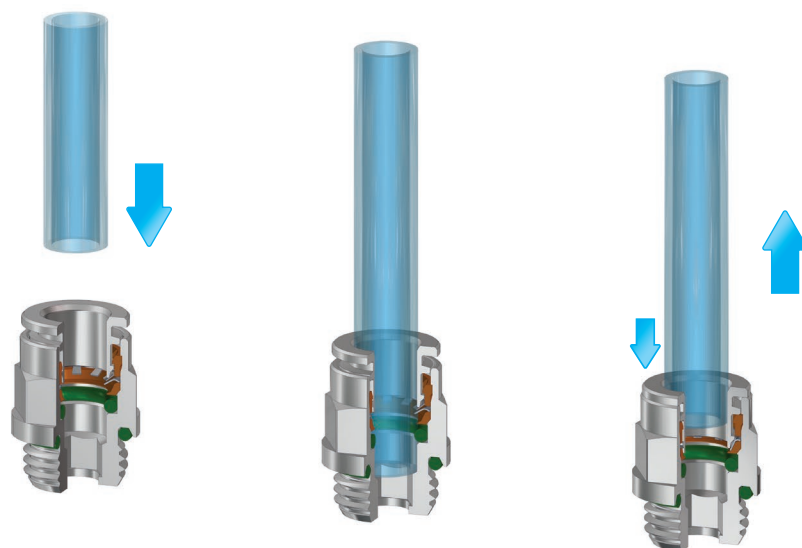

完成连接后,请确保管路上不承受外力;此外,请确保管路连接的最小弯曲半径符合本样册第376页之规定。为了避免管路意外松脱,任何物体均不要接触释放环。作用在释放环上任何外力,包括侧向力,均可能导致管路意外松脱。螺纹拧紧时,请参考第10页列出的建议扭矩。



Once the tubing is connected to the fitting, make sure that the tubing is not subject to any tensile strength and that the min. recommended bending radius stated in the tubing section of this catalogue is complied with (see page 376). To prevent any accidental tube release, no components have to come in touch with the release ring and exercise any unwanted pressure on the same. Indeed however lateral, any load on the release ring may cause the tube disconnection. To tighten threads, please check out our tightening torque chart illustrated at page 10.

## AV 12

### 外直螺纹直接头

Parallel straight, male

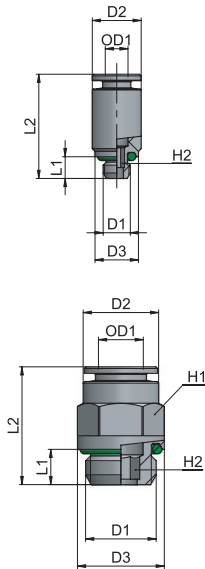

类型	OD1	D1	D2	D3	L1	L2	H2	g	Δ
12 04 M5	4	M5x0,8	9	8	4	19	2,5	4,0	
12 06 M5	6	M5x0,8	12	8	4	22,2	2,5	8,5	

类型	OD1	D1	D2	D3	L1	L2	H1	H2	g	Δ
12 04 18	4	G1/8	9	13	5	16,5	9	3	6,0	
12 04 14	4	G1/4	9	16	6,5	18,5	9	3	12,0	
12 06 18	6	G1/8	11,9	13,5	5	19,5	12	4	9,0	
12 06 14	6	G1/4	11,9	16	6,5	19,5	12	4	12,5	
12 08 18	8	G1/8	13,9	14,5	5	23,5	13	6	11,0	
12 08 14	8	G1/4	13,9	16	6,5	21,5	14	6	14,0	
12 08 38	8	G3/8	13,9	20	7	21	14	6	20,0	
12 10 14	10	G1/4	15,9	16	6,5	27,5	15	8	18,0	
12 10 38	10	G3/8	15,9	20	7	25	16	8	23,0	
12 10 12	10	G1/2	15,9	25	8,5	25,5	16	8	34,5	
12 12 14	12	G1/4	18,9	21	6,5	28,5	19	8	22,0	
12 12 38	12	G3/8	18,9	21	7	28,5	19	10	25,0	
12 12 12	12	G1/2	18,9	25	8,5	26,5	19	10	33,0	

## AV 13

### 内螺纹直接头

Female straight

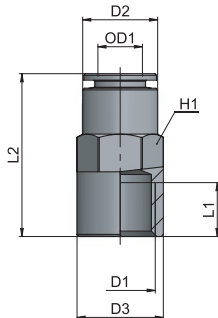

类型	OD1	D1	D2	D3	L1	L2	H1	g	Δ
13 04 18	4	G1/8	9	13	7	23,5	9	10,0	
13 06 18	6	G1/8	11,9	14	7	26	12	15,7	
13 06 14	6	G1/4	11,9	16	10	30	12	19,0	
13 08 18	8	G1/8	13,7	16,2	7	26	14	18,0	
13 08 14	8	G1/4	13,9	16	10	30	14	22,0	
13 10 14	10	G1/4	15,9	18,5	10	32	16	24,4	

## AV 16

### 可调向外直螺纹弯管接头

Parallel swivelling elbow fitting, male

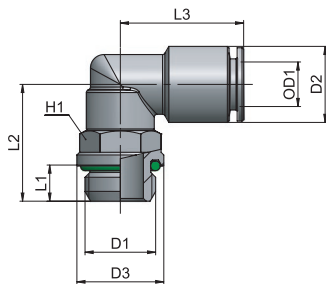

类型	OD1	D1	D2	D3	L1	L2	L3	H1	g	Δ
16 04 M5	4	M5x0,8	9,1	10	4	14	17,5	9	8,5	
16 04 18	4	G1/8	9,1	14,5	5	18,2	19,5	13	16,0	
16 04 14	4	G1/4	9,1	16	6,5	21,7	19,5	13	19,5	
16 06 M5	6	M5x0,8	12	10	4	14	20,5	9	12,0	
16 06 18	6	G1/8	12	14,5	5	18,2	22	13	19,0	
16 06 14	6	G1/4	12	16	6,5	21,7	22	13	22,0	
16 08 18	8	G1/8	14	14,5	5	18	22,5	13	22,0	
16 08 14	8	G1/4	14	16	6,5	21,5	22,5	13	24,0	
16 08 38	8	G3/8	14	20	7	25,5	23	16	36,5	
16 10 14	10	G1/4	16	18	6,5	22	26	16	33,0	
16 10 38	10	G3/8	16	20	7	25,5	26	16	38,0	
16 10 12	10	G1/2	16	25	8,5	27,5	26	16	43,2	
16 12 14	12	G1/4	19	22,5	6,5	25,5	28,5	20	56,5	
16 12 38	12	G3/8	19	22,5	7	26	28,5	20	55,5	
16 12 12	12	G1/2	19	25	8,5	30,5	28,5	20	63,0	

## AV 21

可调向直螺纹正T型三通接头

Swivelling T fitting, parallel

类型	OD1	D1	D2	D3	L1	L2	L3	H1	g $\Delta$
21 04 18	4	G1/8	9,1	14,5	5	18,2	39	13	20,2
21 04 14	4	G1/4	9,1	16	6,5	21,7	39	13	23,9
21 06 18	6	G1/8	12	14,5	5	18	44	13	25,2
21 06 14	6	G1/4	12	16	6,5	21,5	44	13	29,1
21 08 18	8	G1/8	14	14,5	5	18	45	13	30,7
21 08 14	8	G1/4	14	16	6,5	21,5	45	13	34,1
21 08 38	8	G3/8	14	20	7	25,5	46	16	46,4
21 10 14	10	G1/4	16	18	6,5	22	52	16	44,4
21 10 38	10	G3/8	16	20	7	25,5	52	16	49,7
21 12 38	12	G3/8	19	22,5	7	26	57	20	75,3
21 12 12	12	G1/2	19	25	8,5	30,5	57	20	82,0

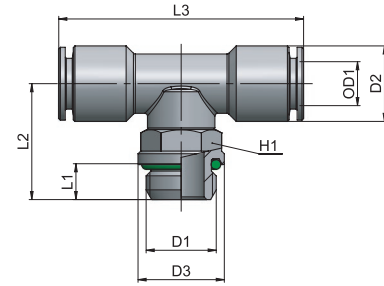

## AV 25

减径接头

Reducer

类型	OD1	D1	D2	L1	g $\Delta$
25 04 06	4	6	9	33,5	7,0
25 06 08	6	8	12	35	11,5
25 08 10	8	10	14	37	15,0
25 10 12	10	12	16	42	20,3

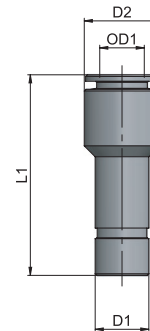

## AV 26

对接接头

Union

类型	OD1	OD2	D1	D2	L1	g $\Delta$
26 04 04	4	4	9	9	28	6,5
26 06 06	6	6	12	12	33,6	14,6
26 06 04	6	4	12	12	31	15,2
26 08 08	8	8	14	14	34	17,5
26 08 06	8	6	14	14	34	21,0
26 10 10	10	10	16	16	38,6	22,5
26 10 08	10	8	16	16	36,5	25,2
26 12 12	12	12	19	19	41	25,5

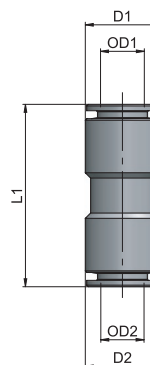

AP	55
AR	63
AV	221
CO	157
CX	255
EV	217
GU	119
GU Safety	135
GX	281
GX Safety	291
HP	317
MA	27
MB	41
MC	83
MF	235
MM	333
MO	93
MP	323
MT	339
MV	171
MX	241
MY	229
OX	261
PA	113
PE	79
PM	329
PN	67
PT	347
PU	131
PU Safety	149
PUX	287
PV	203
PVX	311
PX	249
QO	363
RA	101
RF	269
RT	355
RX	275
Tools	369
Tubings	375
VF	295
VT	359
VX	299

## AV 27

### 穿板对接接头

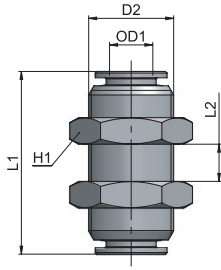

### Bulkhead union

类型	OD1	D2	L1	L2	H1	g $\Delta$
27 04 04	4	M12x1	28	11	16	24,0
27 06 06	6	M14x1	34	16	18	34,5
27 08 08	8	M16x1	34	16	20	40,0
27 10 10	10	M18x1	39	19	22	51,0
27 12 12	12	M20x1	41	20	24	59,5

## AV 28

### 直角对接接头

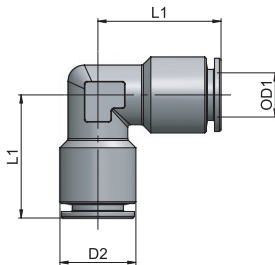

### Union elbow

类型	OD1	D2	L1	g $\Delta$
28 04 04	4	9	17,5	8,5
28 06 06	6	12	20,5	16,5
28 08 08	8	14	22,5	22,5
28 10 10	10	16	25	28,5
28 12 12	12	19	26,5	43,5

## AV 29

### 正T型三通对接接头

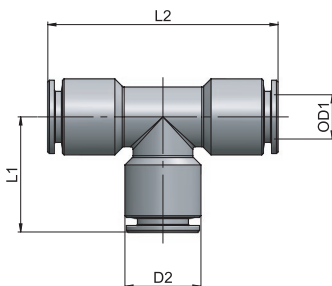

### Union T

类型	OD1	D2	L1	L2	g $\Delta$
29 04 04	4	9	17,5	35	11,0
29 06 06	6	12	20	40	22,0
29 08 08	8	14	21	42	28,0
29 10 10	10	16	24,5	49	37,5
29 12 12	12	19	26	52	53,0

AV 37

Y型接头

Y fitting

类型	OD1	OD2	D2	L1	L2	g $\Delta$
37 04 04	4	4	9	29,5	9,5	13,5
37 06 06	6	6	12	36,5	12,5	32,0
37 08 08	8	8	14	37,5	14,5	42,5
37 10 10	10	10	16	44,5	16,5	62,7
37 12 12	12	12	19	49	19,5	95,8

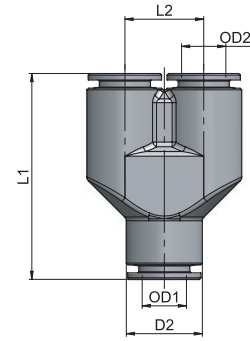

AV 39

接头连接杆

Extention piece

类型	D1	L1	g $\Delta$
39 00 04	4	35	2,7
39 00 06	6	40	5,1
39 00 08	8	42	8,0
39 00 10	10	50	11,8
39 00 12	12	53	15,3
39 00 14	14	54	18,8

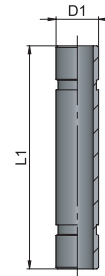

AV 40

堵头

Plug

类型	D1	L1	g $\Delta$
40 00 04	4	25	2,3
40 00 06	6	25	3,7
40 00 08	8	30	7,2
40 00 10	10	35	11,8
40 00 12	12	40	18,2

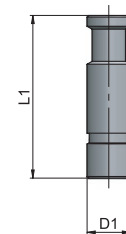

AP 55  
AR 63  
AV 221  
CO 157  
CX 255  
EV 217  
GU 119  
GU Safety 135  
GX 281  
GX Safety 291  
HP 317  
MA 27  
MB 41  
MC 83  
MF 235  
MM 333  
MO 93  
MP 323  
MT 339  
MV 171  
MX 241  
MY 229  
OX 261  
PA 113  
PE 79  
PM 329  
PN 67  
PT 347  
PU 131  
PU Safety 149  
PUX 287  
PV 203  
PVX 311  
PX 249  
QO 363  
RA 101  
RF 269  
RT 355  
RX 275  
Tools 369  
Tubings 375  
VF 295  
VT 359  
VX 299

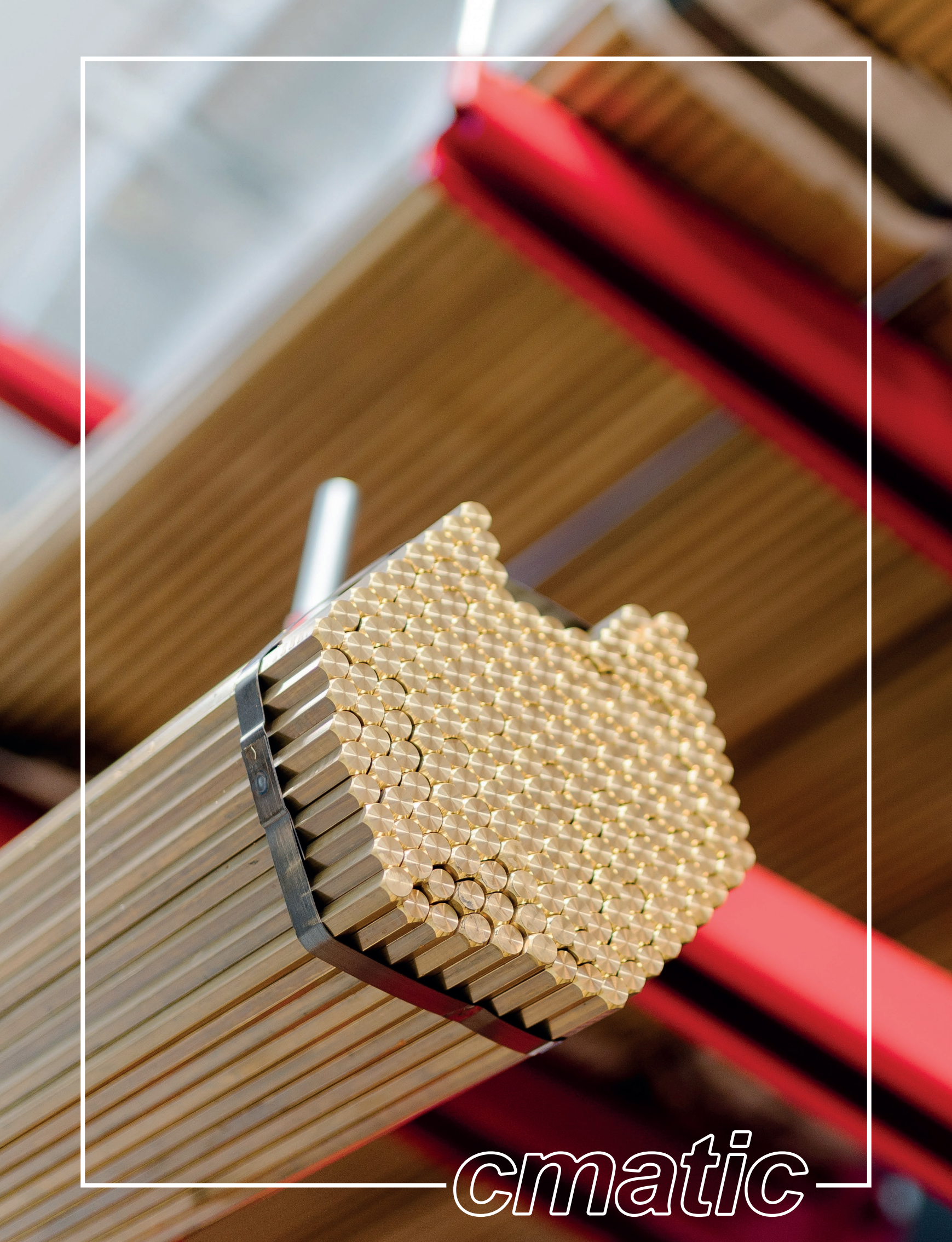

*cmatic*