

CX LINE



CN

EN

316L 不锈钢快拧接头

CX系列快拧式管接头采用AISI 316L不锈钢制造, 其创新之处在于完全省去了O型圈设计。该产品专为高温、强腐蚀性流体等恶劣工况研发, 在这些FPM材质O型圈无法适用的环境中表现出卓越的适应性。

316L Stainless Steel Push-on Fittings

CX is a "push-on" fitting made of AISI 316L, completely free of Orings since developed for heavy duty applications with high temperatures and aggressive fluids, environment where FPM Orings would not be suitable.

CX Line

1 本体
Body
316L (1.4404) 不锈钢
Stainless steel AISI 316L (1.4404)

2 螺母
Nut
316L (1.4404) 不锈钢
Stainless steel AISI 316L (1.4404)

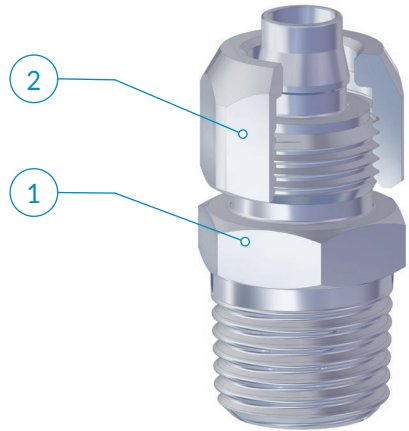

	G1/8	G1/4	G3/8	G1/2	R1/8	R1/4	R3/8	R1/2
6	●	●			●	●		
8	●	●	●		●	●		
10		●	●			●	●	
12			●	●		●	●	●

建议的连接管路:
PTFE管路

Recommended tubings:
PTFE tubings

可接受的管路公差:
+/- 0.07 mm, 最大直径 10 mm
+/- 0.1 mm, 最大直径 Ø 12 mm。

Acceptable Tolerances on the tubings:
+/- 0.07 mm up to Ø 10 mm
+/- 0.1 mm up to Ø 12 mm

应用领域:
气动、食品、化学、医疗制药行业。

Application fields:
Pneumatics, Food Industry, Chemical, Medical and Pharmaceutical Industry

- 1 垂直切割管路, 确认管路内外壁没有毛刺
- 2 将螺母套入管路
- 3 将管路套在锥面上, 用力推入至压紧程度
- 4 用手或者扳手拧紧螺母

- 1 Cut the tube at 90° making sure that no burr is left;
- 2 Push the nut onto the tube;
- 3 Push the tube and nut onto the fitting nozzle and make sure that the tube goes all the way up to the nozzle base;
- 4 Tighten the nut by hand or if necessary by a spanner.



! 完成连接后, 请确保管路上不承受外力; 此外, 请确保管路连接的最小弯曲半径符合本样册第376页之规定。为了避免管路意外松脱, 任何物体均不要接触释放环。作用在释放环上任何外力, 包括侧向力, 均可能导致管路意外松脱。螺纹拧紧时, 请参考第10页列出的建议扭矩。

! Once the tubing is connected to the fitting, make sure that the tubing is not subject to any tensile strength and that the min. recommended bending radius stated in the tubing section of this catalogue is complied with (see page 376). To tighten threads, please check out our tightening torque chart illustrated at page 10.

CX 10

螺母

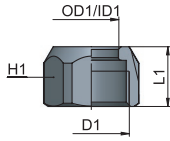

Nut

类型	OD1	ID1	D1	L1	H1	g Δ
10 06 10	6	4	M10x1	10	12	4,4
10 08 12	8	6	M12x1	10	14	5,5
10 10 14	10	8	M14x1	11	16	7,0
10 12 16	12	10	M16x1	12	19	-

CX 11

外锥螺纹直接头

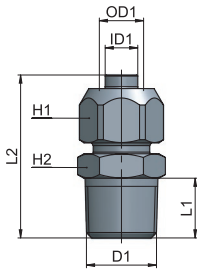

Taper straight, male

类型	OD1	ID1	D1	L1	L2	H1	H2	g Δ
11 06 18	6	4	R1/8	7,5	26	12	10	11,6
11 06 14	6	4	R1/4	11	29,5	12	14	17,5
11 08 18	8	6	R1/8	7,5	26,5	14	13	16,5
11 08 14	8	6	R1/4	11	30	14	14	20,3
11 10 14	10	8	R1/4	11	32,5	16	14	23,6
11 10 38	10	8	R3/8	11,5	33	16	17	29,9
11 12 14	12	10	R1/4	11	34	19	17	34,8
11 12 38	12	10	R3/8	11,5	34,5	19	17	34,6
11 12 12	12	10	R1/2	14	38	19	22	48,4

CX 11 XT

卡箍连接转快拧接头

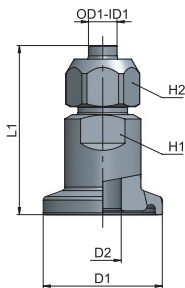

Clamp to push on fitting

类型	OD1	D1	D2	L1	H1	H2	g Δ
11 06 XT D25	6	25	7,75	35	12	12	37,6
11 06 XT D50,4	6	50,4	7,75	35	12	12	-
11 08 XT D25	8	25	7,75	35,5	13	14	49,9
11 08 XT D50,4	8	50,4	7,75	35,5	13	14	114,0
11 10 XT D25	10	25	7,75	37,5	16	16	55,9
11 10 XT D50,4	10	50,4	7,75	37,5	16	16	105,5



卡箍表面处理等级: SF1级
Surface finishing of the Clamp side: SF1 Class

CX 13

内螺纹直接头

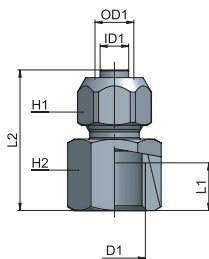

Female straight

类型	OD1	ID1	D1	L1	L2	H1	H2	g Δ
13 06 18	6	4	G1/8	7	25	12	13	14,6
13 06 14	6	4	G1/4	10	28,5	12	17	22,8
13 08 18	8	6	G1/8	7	25,5	14	13	17,7
13 08 14	8	6	G1/4	10	29,5	14	17	26,9
13 08 38	8	6	G3/8	11	31	14	21	37,4
13 10 14	10	8	G1/4	10	31,5	16	17	29,5
13 10 38	10	8	G3/8	11	33	16	17	40,8
13 12 38	12	10	G3/8	11	34,5	19	21	47,6
13 12 12	12	10	G1/2	11	35	19	24	50,5

CX 14

外锥螺纹弯管接头

Taper elbow fitting, male

类型	OD1	ID1	D1	L1	L2	L3	H1	H2	g Δ
14 06 18	6	4	R1/8	6,5	17	23	12	10	16,6
14 06 14	6	4	R1/4	10	21,5	23	12	10	20,5
14 08 18	8	6	R1/8	6,5	17	23,5	14	10	17,6
14 08 14	8	6	R1/4	10	21,5	23,5	14	10	21,1
14 10 14	10	8	R1/4	9,5	21,5	26	16	12	29,5
14 10 38	10	8	R3/8	11	24	26	16	12	35,3
14 12 38	12	10	R3/8	12,6	35,5	30,5	19	17	52,2
14 12 12	12	10	R1/2	13,5	30	33	19	19	52,2

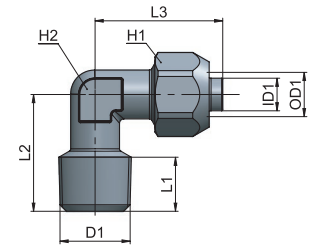

CX 15

可调向外锥螺纹弯管接头

Taper swivelling elbow fitting, male

类型	OD1	ID1	D1	L1	L2	L3	H1	H2	g Δ
15 06 18	6	4	R1/8	7,5	20	21	12	13	27,1
15 06 14	6	4	R1/4	11	24	21	12	14	26,5
15 08 18	8	6	R1/8	7,5	20	21	14	13	24,6
15 08 14	8	6	R1/4	11	24	21	14	14	28,6
15 10 14	10	8	R1/4	11	25,5	24	16	14	33,7
15 10 38	10	8	R3/8	11,5	26	24	16	17	37,9

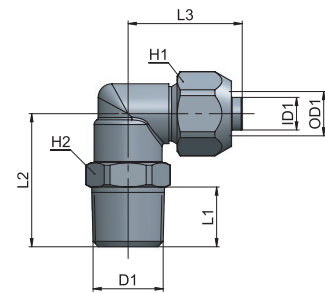

符合FDA的FPM密封 - FPM Seals, FDA compliant

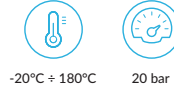

CX 20

锥螺纹正T型三通接头

Taper male T

类型	OD1	ID1	D1	L1	L2	L3	H1	H2	g Δ
20 06 18	6	4	R1/8	6,5	17	46	12	10	29,0
20 06 14	6	4	R1/4	9,5	21	46	12	10	31,6
20 08 18	8	6	R1/8	6,5	17	46	14	10	30,3
20 08 14	8	6	R1/4	10	21,5	46	14	10	33,7
20 10 14	10	8	R1/4	9,5	21,5	52	16	12	39,7
20 10 38	10	8	R3/8	11	24	52	16	12	53,0
20 12 38	12	10	R3/8	12,6	60	52	19	17	80,7
20 12 12	12	10	R1/2	13,9	60	52	19	17	88,2

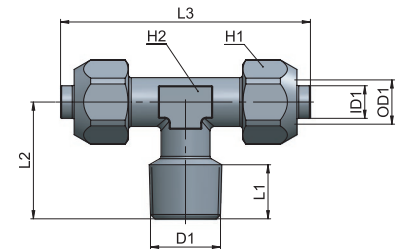

CX 23

锥螺纹直T型三通接头

Taper lateral T

类型	OD1	ID1	D1	L1	L2	L3	L4	H1	H2	g Δ
23 06 18	6	4	R1/8	9,9	17	23	40	12	10	28,3
23 06 14	6	4	R1/4	10	21,5	23	44,5	12	10	31,2
23 08 18	8	6	R1/8	6,5	17	23	40	14	10	30,4
23 08 14	8	6	R1/4	10	21,5	23	44,5	14	10	34,1
23 10 14	10	8	R1/4	9,5	21,5	26	47,5	16	12	39,5
23 10 38	10	8	R3/8	11	24	26	50	16	12	53,2
23 12 38	12	10	R3/8	12,6	25,5	30	55,5	19	17	79,6
23 12 12	12	10	R1/2	13,9	28	30	58	19	17	86,9

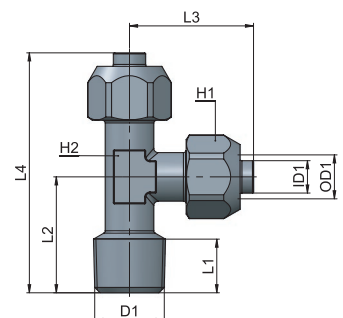

AP 55
AR 63
AV 221
CO 157
CX 255
EV 217
GU 119
GU Safety 135
GX 281
GX Safety 291
HP 317
MA 27
MB 41
MC 83
MF 235
MM 333
MO 93
MP 323
MT 339
MV 171
MX 241
MY 229
OX 261
PA 113
PE 79
PM 329
PN 67
PT 347
PU 131
PU Safety 149
PUX 287
PV 203
PVX 311
PX 249
QO 363
RA 101
RF 269
RT 355
RX 275
Tools 369
Tubings 375
VF 295
VT 359
VX 299

CX 26

对接接头

Union

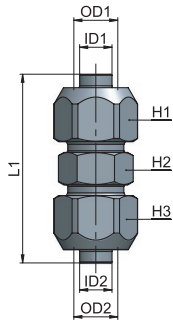

类型	OD1	ID1	OD2	ID2	L1	H1	H2	H3	g Δ
26 06 06	6	4	6	4	34	12	10	12	20,0
26 08 08	8	6	8	6	35	14	12	14	25,7
26 08 06	8	6	6	4	34,5	14	12	12	23,5
26 10 10	10	8	10	8	39	16	14	16	35,8
26 10 08	10	8	8	6	37	16	14	14	31,8
26 12 12	12	10	12	10	42	19	16	19	50,8
26 12 10	12	10	10	8	40,5	19	16	16	44,8

CX 28

直角对接接头

Union elbow

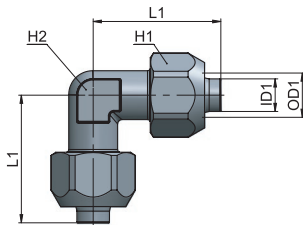

类型	OD1	ID1	L1	H1	H2	g Δ
28 06 06	6	4	23	12	10	24,9
28 08 08	8	6	23,5	14	10	26,9
28 10 10	10	8	26	16	12	33,3
28 12 12	12	10	30	19	17	67,6

CX 29

正T型三通对接接头

Union T

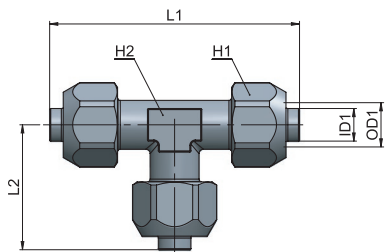

类型	OD1	ID1	L1	L2	H1	H2	g Δ
29 06 06	6	4	46	23	12	10	36,4
29 08 08	8	6	46	23	14	10	39,0
29 10 10	10	8	52	26	16	12	47,6
29 12 12	12	10	60	30	19	17	94,7