



GX LINE



CN

316L 不锈钢快换接头
不锈钢快换接头

EN

316L Stainless Steel Couplings
Stainless steel quick couplings.

GX 10

不锈钢多插座快换接头

Stainless steel multi socket quick coupling

- 1** 本体
Body

316L (1.4404) 不锈钢
Stainless steel AISI 316L (1.4404)
- 2** 控制滑套
Command sleeve
- 3** 阀芯
Valve
- 4** 弹簧
Springs

AISI 302 不锈钢
Stainless steel AISI 302
- 5** 滚珠
Balls

AISI 420 不锈钢
Stainless steel AISI 420
- 6** 密封圈
Seals

满足FDA规范的FPM
FPM compliant With FDA
- i** 插头体
Plugs

316L (1.4404) 不锈钢
Stainless steel AISI 316L (1.4404)



-20° ÷ 150°C



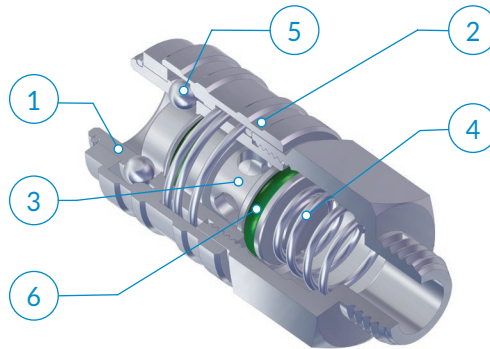

15 bar

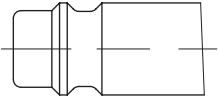
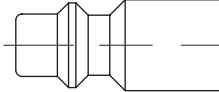
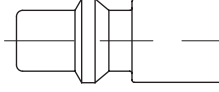
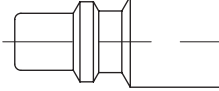
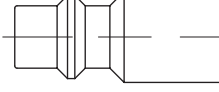

应用领域：
气动系统。

Application fields:
Pneumatic circuits

适用以下插头体外形 Suitable with following plugs profiles		流量 Flow rate
		NI/min (6 bar - Δp = 1bar)
	欧洲标准外形 European Profile	820
	ISO 6150 B标准外形 ISO 6150 B Profile	715
	瑞典标准外形 Standard Swedisch Profile	725
	意大利标准外形 Standard Italian Profile	670
	MIL C4109标准外形 MIL C4109 Profile	715
	ARO 210标准外形 ARO 210 Profile	705

比例尺 1:1 - Scale 1:1

GX 10-11

外螺纹接头体

Male coupling

类型	D1	D2	L1	L2	H1	g Δ
11 00 14	G1/4	23,5	8	51,5	21	87,8
11 00 38	G3/8	23,5	9	51,5	21	86,7

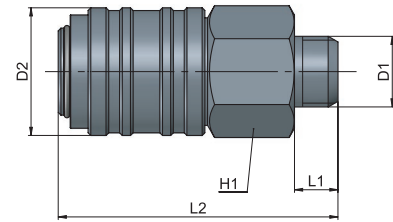

GX 10-12

内螺纹接头体

Female coupling

类型	D1	D2	L1	L2	H1	g Δ
12 00 14	G1/4	23,5	10	56,5	21	110,9
12 00 38	G3/8	23,5	10	58	21	106,3

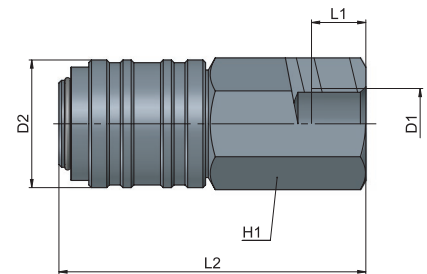

GX 10-20

外螺纹插头体, 欧洲标准外形

Male plug according to european profile

类型	D1	L1	H1	g Δ
20 00 14	G1/4	33	17	20,5
20 00 38	G3/8	33	21	30,4

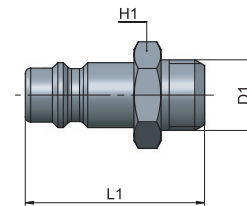

GX 10-21

内螺纹插头体, 欧洲标准外形

Female plug according to european profile

类型	D1	L1	H1	g Δ
21 00 14	G1/4	34,5	17	23,6
21 00 38	G3/8	35	21	31,7
21 00 12	G1/2	38	24	39,3

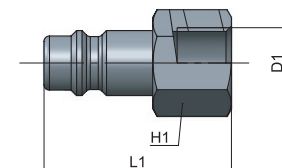

AP	55
AR	63
AV	221
CO	157
CX	255
EV	217
GU	119
GU Safety	135
GX	281
GX Safety	291
HP	317
MA	27
MB	41
MC	83
MF	235
MM	333
MO	93
MP	323
MT	339
MV	171
MX	241
MY	229
OX	261
PA	113
PE	79
PM	329
PN	67
PT	347
PU	131
PU Safety	149
PUX	287
PV	203
PVX	311
PX	249
QO	363
RA	101
RF	269
RT	355
RX	275
Tools	369
Tubings	375
VF	295
VT	359
VX	299

GX 30

ISO6150C-8 按钮型快换接头

Push-Button coupling according to ISO 6150 C-8

- 1** 本体
Body

316L (1.4404) 不锈钢
Stainless steel AISI 316L (1.4404)
- 2** 按钮和阀芯
Button and valve
- 3** 螺纹
Thread
- 4** 套筒
Cartridge
- 5** 弹簧
Springs

AISI 302 不锈钢
Stainless steel AISI 302
- 6** 密封圈
Seals

满足FDA规范的FPM
FPM compliant With FDA
- i** 插头体
Plugs

316L (1.4404) 不锈钢
Stainless steel AISI 316L (1.4404)

- 20° ÷ 180°C
- 25 bar
- 3 mm
- 345 NI/min
(6 bar - Δp = 1bar)
- SILICONE FREE
- RoHS
- REACH
- NSF
-

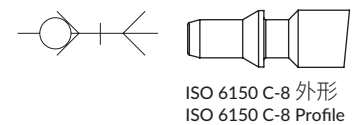
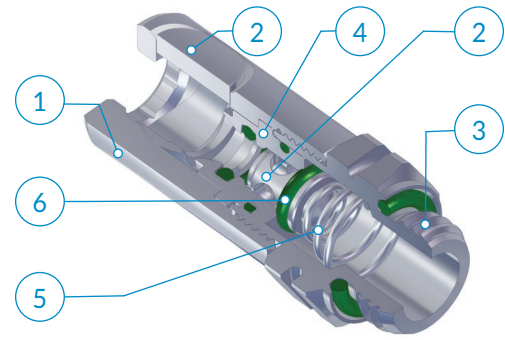

应用领域：
气动系统

Application fields:
Pneumatic circuits

GX 30-10

外螺纹接头体

Male coupling

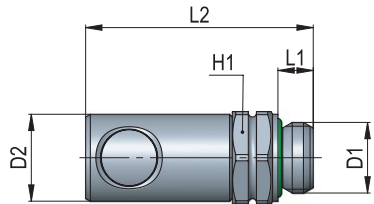

类型	D1	D2	L1	L2	H1	g ΔΔ
10 00 18	G1/8	16	5	41	17	-
10 00 14	G1/4	16	6,5	41,9	17	51,4



GX 30-20

外螺纹插头体

Male plug

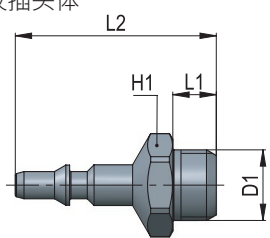

类型	D1	L1	L2	H1	g ΔΔ
20 00 18	G1/8	7	35	14	-
20 00 14	G1/4	8	37	17	18,2



GX 30-10 XT

ISO6150C-8 卡箍式接头体 DN3 外形

Clamp to quick coupling ISO 6150 C-8
DN3 profile

类型	D1	D2	L1	H1	g 
30-10 00 XT D25	25	16	46,4	14	57,6



卡箍表面处理等级: SF1级
Surface finishing of the Clamp side: SF1 Class

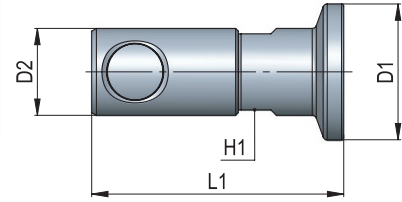

GX 30-20 XT

ISO6150C-8 卡箍式插头体 DN3 外形

Clamp to plug, ISO 6150 C-8 DN3

类型	D1	L1	g 
30-20 00 XT D25	25	28,4	20,0

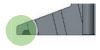

卡箍表面处理等级: SF1级
Surface finishing of the Clamp side: SF1 Class

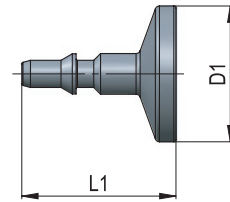

AP	55
AR	63
AV	221
CO	157
CX	255
EV	217
GU	119
GU Safety	135
GX	281
GX Safety	291
HP	317
MA	27
MB	41
MC	83
MF	235
MM	333
MO	93
MP	323
MT	339
MV	171
MX	241
MY	229
OX	261
PA	113
PE	79
PM	329
PN	67
PT	347
PU	131
PU Safety	149
PUX	287
PV	203
PVX	311
PX	249
QO	363
RA	101
RF	269
RT	355
RX	275
Tools	369
Tubings	375
VF	295
VT	359
VX	299

GX 31

符合ISO 6150C-10的按钮式快换接头

Push-Button coupling according to ISO 6150 C-10

- 1** 本体
Body

316L (1.4404) 不锈钢
Stainless steel AISI 316L (1.4404)
- 2** 按钮和阀芯
Button and valve
- 3** 螺纹
Thread
- 4** 套筒
Cartridge
- 5** 弹簧
Springs

AISI 302 不锈钢
Stainless steel AISI 302
- 6** 密封圈
Seals

满足FDA规范的FPM
FPM compliant With FDA
- i** 插头体
Plugs

316L (1.4404) 不锈钢
Stainless steel AISI 316L (1.4404)

-20° ÷ 180°C

25 bar

5,5 mm

933 NI/min (6 bar - Δp = 1bar)

600 NI/min (6 bar - Δp = 1bar)

SILICONE FREE

RoHS

REACH

NSF

ISO 6150 C-10 外形
ISO 6150 C-10 Profile

应用领域: 气动系统

Application fields: Pneumatic circuits

GX 31-10

外螺纹接头体

Male coupling

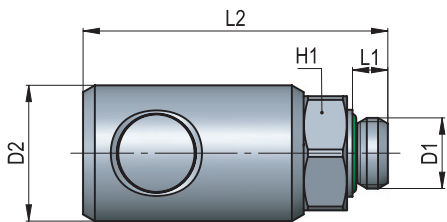

类型	D1	D2	L1	L2	H1	g ΔΔ
10 00 18	G1/8	25	5	55,1	21	-
10 00 14	G1/4	25	6,5	56,1	21	-
10 00 38	G3/8	25	7	56,6	21	-
10 00 12	G1/2	25	8,5	58,6	25	-



GX 31-20

外螺纹插头体

Male plug

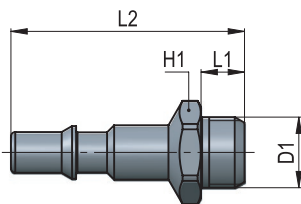

类型	D1	L1	L2	H1	g ΔΔ
20 00 18	G1/8	7	42	14	-
20 00 14	G1/4	8	43	17	-
20 00 38	G3/8	9	44	21	-



GX 31-30

带阀外螺纹插头体

Checked male plug

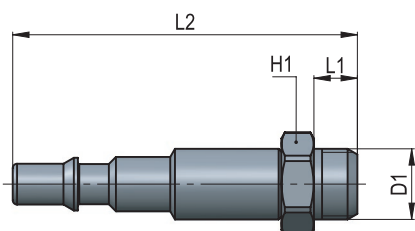

类型	D1	L1	L2	H1	g ΔΔ
30 00 18 CKD	G1/8	7	61,5	14	-
30 00 14 CKD	G1/4	8	63,5	17	-
30 00 38 CKD	G3/8	9	64,5	21	-

