

## HP LINE



CN

### 250 bar 润滑用自动接头

HP系列是新一代接头,旨在确保为“压力禁区”的场景,提供安全可靠的可插式产品方案。该接头专为润滑系统研发制造,凭借创新的卡爪系统,我们的HP快插式管接头最高可承受250bar的工作压力。

EN

### High Pressure Push-in Fittings, 250 bar

HP is a new generation fitting studied to guarantee tightness with pressure ranges, considered so far “out of reach” with the push-in version. The fitting has been created and developed to be used in the Lubrication systems. Thanks to the innovative gripping system of the collet, our HP push-in fitting can stand up to a maximum of 250 bar pressure.

# HP Line

- |  |  |  |  |   |
|--|--|--|--|---|
| <p><b>1</b> 本体<br/>Body</p> <p>黄铜镀镍 UNI EN 12164 CW614N - UNI EN 12165 CW617N<br/>Brass UNI EN 12164 CW614N - UNI EN 12165 CW617N, nickel plated</p> | <p><b>2</b> 螺纹体<br/>Threaded screws</p> <p>黄铜镀镍 UNI EN 12164 CW614N<br/>Brass UNI EN 12164 CW614N, nickel plated</p> | <p><b>3</b> 卡爪系统<br/>Gripping collet</p> <p>黄铜 UNI EN 12164 CW614N<br/>Brass UNI EN 12164 CW614N</p> | <p><b>4</b> 密封圈<br/>Seals</p> <p>NBR<br/>NBR</p> | <p><b>5</b> 卡簧<br/>Seeger</p> <p>钢 C75 镀锌<br/>C75 Steel zinc coated</p> |
|--|--|--|--|---|



-20° ± 80°C



250 bar

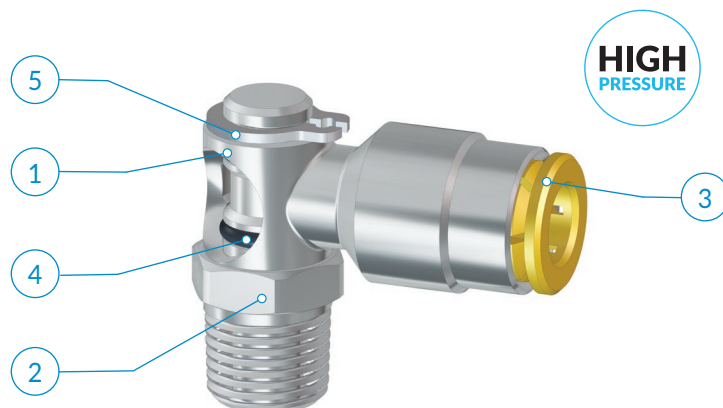

	M6x0,75*	M6x1*	M8x1*	M10x1*	R1/8**	R1/4**
4	●	●	●	●	●	●
6		●	●	●	●	●

\*UNI 7707  
\*\*ISO 7

### 建议的连接管路:

Pa66 (4x1,5 - 6x3), 高压管路, 带金属尾管。

### Recommended tubings:

PA66 (4x1,5 - 6x3), High pressure tubing with metal stem

### 可接受的管路公差:

+/- 0,07 mm, 最大直径 Ø 6 mm。

### Acceptable Tolerances on the tubings:

+/- 0,07 mm up to Ø 6 mm

### 应用领域:

润滑系统

### Application fields:

Lubrication installations



能到达的压力与所采用的管路以及环境温度有重要关系, 这两个因素可能会降低管路的爆破压力。



The max pressure rate achievable can vary depending on the tubing used and on the room temperature. These two factors may in fact lower the tube bursting pressure.



### 管路插入深度

### Tubing insertion depth

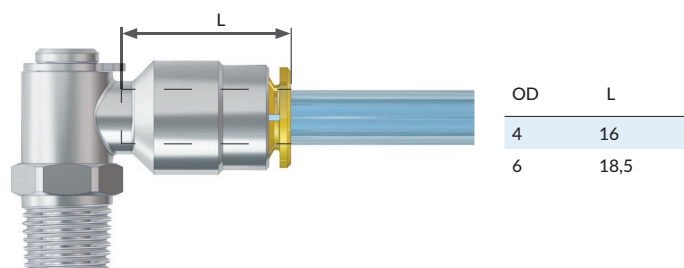

**1**

沿管路垂直切割 (使用TCUT切管刀),确认内外管壁没有毛刺,同时注意避免管路截面呈椭圆形。

**2**

将管路插入接头,到底为止。

拔出管路:

垂直按压释放环,同时拔出管路即可。

**1**

Cut the tube square (by means of a hose cutter i.e. our TCUT) making sure that no burrs are left and that the tube is not oval.

**2**

Insert the tube into the fitting until it bottoms.

**Tube release**

While pressing on the release ring, pull out the tube from the fitting.

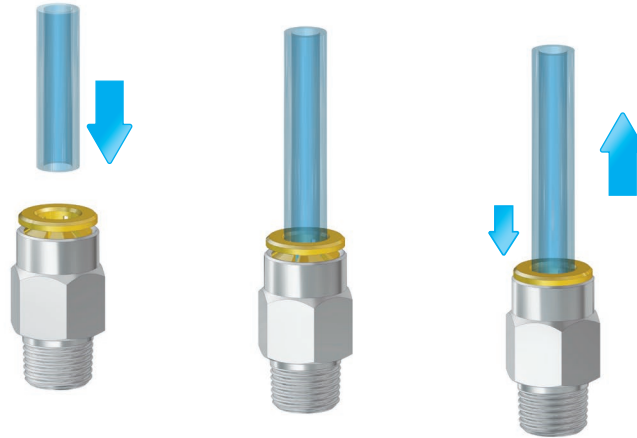

完成接头连接后,请确保管路不受到任何拉力,管路弯曲也需要符合本样本376页所声明的最小弯曲半径。为避免管路的意外脱落,不应在释放环上施加任何外力以及异常压力,释放环承受侧向的载荷也会引起管路脱落。

螺纹拧紧力矩,请参考本样本第10页

一旦接头已经与金属硬管进行过连接,拆装后,不建议再用同一个接头与塑料管进行连接安装。

如果将金属端管与接头连接,管端截面和尺寸必须与下列建议相符。如果将具有不同规格的管端与接头相连,可能会对接头造成无法修复的损坏,因此无法确保接头的功能。



Once the tubing is connected to the fitting, make sure that the tubing is not subject to any tensile strength and that the min. recommended bending radius stated in the tubing section of this catalogue is complied with (see page 376).

To prevent any accidental tube release, no components have to come in touch with the release ring and exercise any unwanted pressure on the same. Indeed however lateral, any load on the release ring may cause the tube disconnection.

To tighten threads, please check out our tightening torque chart illustrated at page 10.

Should the fitting be assembled with metal tubes, in case of disassembly, we do not recommend to reassemble the same fitting with plastic tubing.

If a metal stem is connected to the fitting, the stem has to be manufactured according to the profile and sizes as set forth below. Should the fitting be connected to a metal stem not complying to the technical features recommended, the fitting may get irreversibly damaged and its function would no longer be guaranteed.

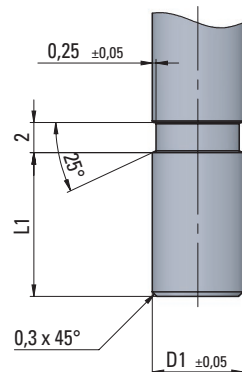

D1	L1
4	8
6	9,5

## HP 11

外锥螺纹直接头

Taper straight, male

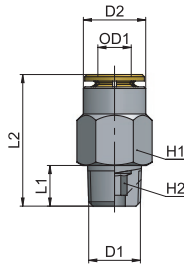

类型	OD1	D1	D2	L1	L2	H1	H2	g $\Delta$
11 04 18	4	R1/8	9,5	7,5	21	10	3	8,5
12 04 M6x0,75	4	M6x0,75	9,5	6	23	10	2,5	8,8
11 04 M6x1	4	M6x1	9,5	8	25	10	2,5	8,4
11 04 M8x1	4	M8x1	9,5	8	22,5	10	3	7,9
11 04 M10x1	4	M10x1	9,5	8	21	11	3	9,6
11 06 18	6	R1/8	11,5	7,5	24	12	4	11,5
11 06 14	6	R1/4	11,5	11	26	14	4	19,0
11 06 M6x1	6	M6x1	11,5	8	28	12	2,5	12,8
11 06 M8x1	6	M8x1	11,5	8	28	12	4	13,3
11 06 M10x1	6	M10x1	11,5	8	24,5	12	4	11,8

\*M6x0,75 圆柱形螺纹 - Parallel Thread

## HP 14

外锥螺纹弯管接头

Taper elbow fitting, male

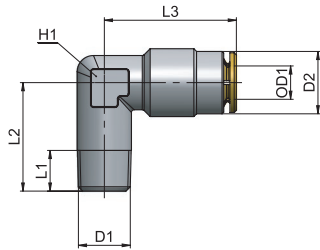

类型	OD1	D1	D2	L1	L2	L3	H1	g $\Delta$
14 04 18	4	R1/8	9,5	8	17	21,5	10	16,0
14 04 M6x1	4	M6x1	9,5	7	17	21,5	10	13,9
14 04 M8x1	4	M8x1	9,5	7	17	21,5	10	14,4
14 04 M10x1	4	M10x1	9,5	7	18	21,5	10	16,9
14 06 18	6	R1/8	11,5	7,5	20	24	11	21,0
14 06 M6x1	6	M6x1	11,5	7	20	24	11	19,8
14 06 M8x1	6	M8x1	11,5	7	20	24	11	19,8
14 06 M10x1	6	M10x1	11,5	7	21	24	11	22,7

## HP 18

可调向直外螺纹弯管接头

Parallel swivelling elbow, taper male

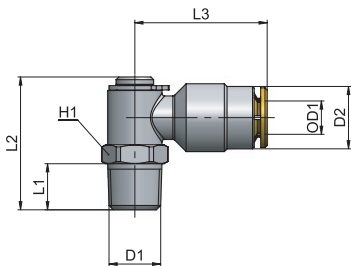

类型	OD1	D1	D2	L1	L2	L3	H1	g $\Delta$
18 04 18	4	R1/8	9,5	8,5	24,5	22	11	18,1
18 04 M6x0,75*	4	M6x0,75	9,5	6	22	22	11	16,8
18 04 M6x1	4	M6x1	9,5	8	24	22	11	16,9
18 04 M8x1	4	M8x1	9,5	8	24	22	11	17,4
18 04 M10x1	4	M10x1	9,5	8	25	22	11	18,9
18 06 18	6	R1/8	11,5	8,5	24,5	24	11	20,0
18 06 14	6	R1/4	11,5	11	28	24	14	25,5
18 06 M6x1	6	M6x1	11,5	8	24	24	11	18,6
18 06 M8x1	6	M8x1	11,5	8	24	24	11	19,4
18 06 M10x1	6	M10x1	11,5	8	25	24	11	20,7

\*M6x0,75 圆柱形螺纹 - Parallel Thread

## HP 90

软管接头

Hose connection, straight

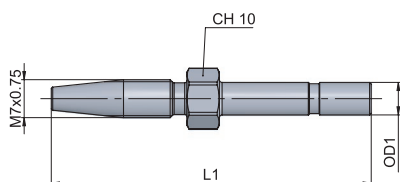

类型	OD1	L1	g $\Delta$
90 04 00	4	53	9,4
90 06 00	6	59	12,1

镀锌处理 11SMnPb37 - Body in Zinc plated steel 11SMnPb37

## HP 92

直角软管接头

90° hose connection

类型	OD1	L1	L2	g 
92 06 00	6	59	43	17,6

镀锌处理 11SMnPb37 - Body in Zinc plated steel 11SMnPb37

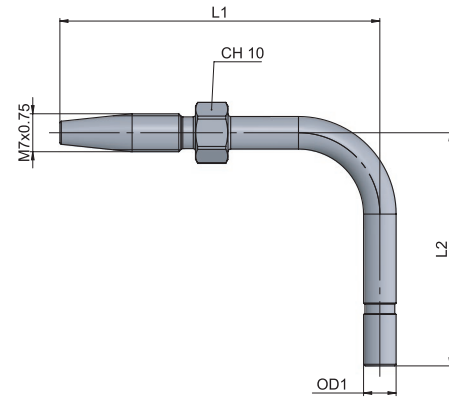

## HP 99

重复用衬套

Reusable ferrule

类型	OD1	ID1	g 
99 04 00	8+8,3	5/32	12,4

镀锌处理 11SMnPb37 - Body in Zinc plated steel 11SMnPb37

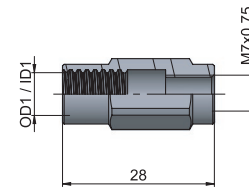

AP	55
AR	63
AV	221
CO	157
CX	255
EV	217
GU	119
GU Safety	135
GX	281
GX Safety	291
HP	317
MA	27
MB	41
MC	83
MF	235
MM	333
MO	93
MP	323
MT	339
MV	171
MX	241
MY	229
OX	261
PA	113
PE	79
PM	329
PN	67
PT	347
PU	131
PU Safety	149
PUX	287
PV	203
PVX	311
PX	249
QO	363
RA	101
RF	269
RT	355
RX	275
Tools	369
Tubings	375
VF	295
VT	359
VX	299

# HP 11-NR

- 1** 本体  
Body

黄铜UNI EN 12164 CW614N镀镍  
Brass UNI EN 12164 CW614N, nickel Plated
- 2** 卡爪  
Gripping collet

镀镍黄铜UNI EN 12164 CW614N  
Brass UNI EN 12164 CW614N
- 3** 弹簧  
Spring

AISI 302 不锈钢  
Stainless steel AISI 302
- 4** 滚珠  
Balls

AISI 420 不锈钢  
Stainless steel AISI 420



-20° ÷ 80°C



40 ÷ 150 bar



3 bar

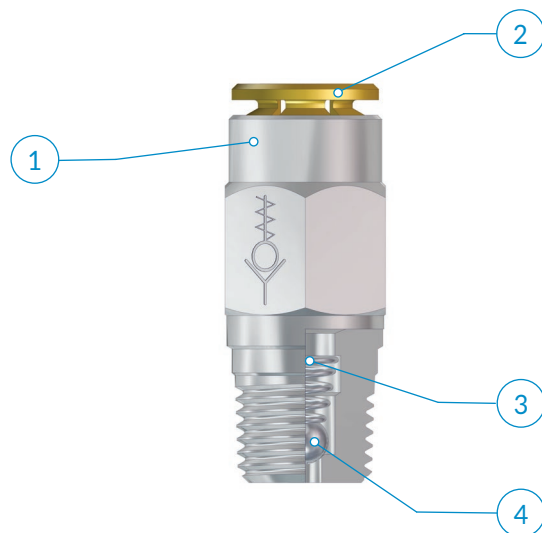

## HP 11-NR

150 bar 单向阀

Check valve for 150 bar

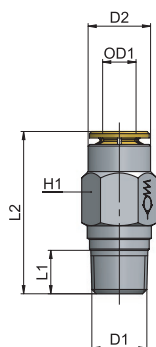

类型	OD1	D1	D2	L1	L2	H1	g $\Delta$
11 06 18 NR	6	R1/8	11,5	7,5	29,5	12	15,7
11 06 M10x1 NR	6	M10x1	11,5	8	29,5	12	15,9

### 建议的连接管路:

Pa66 (4x1.5 - 6x3), 高压管路, 带金属端管。

### 可接受的管路公差:

+/- 0.07 mm, 最大直径Ø 6 mm。

### 应用领域:

润滑系统

### Recommended tubings:

PA66 (4x1.5 - 6x3), High pressure tubing with metal stem

### Acceptable Tolerances on the tubings:

+/- 0,07 mm up to Ø 6 mm

### Application fields:

Lubrication installations

**!** 一旦接头已经与金属硬管进行过连接, 拆装后, 不建议再用同一个接头与塑料管进行连接安装。

**!** Should the fitting be assembled with metal tubes, in case of disassembly, we do not recommend to reassemble the same fitting with plastic tubing.