

MP LINE



CN

80 bar 润滑用快插接头

MP是一款专为中压润滑脂应用设计的快插式管接头，最高可承受80bar压力。凭借其技术特性，MP接头进一步完善了现有集中润滑系统应用的接头产品范围，并进一步彰显了Cmatic全线产品的核心优势：快速连接、卓越性能与可靠保障。

EN

Medium Pressure Push-in Fittings, 80 bar

MP is a push-in fitting conceived for Medium pressure grease applications up to max 80 bar. MP completes, with its technical features the existing products offer for central lubrication applications and highlights further the distinguishing marks of the whole Cmatic production: quick connections, performance and reliance guarantee.

MP Line



- 1** 本体
Body

黄铜镀镍 UNI EN 12164 CW614N - UNI EN 12165 CW617N
Brass UNI EN 12164 CW614N - UNI EN 12165 CW617N, nickel plated
- 2** 螺纹体
Threaded screws

黄铜镀镍 UNI EN 12164 CW614N
Brass UNI EN 12164 CW614N, nickel Plated
- 3** 卡爪系统
Gripping collet

黄铜 UNI EN 12164 CW614N
Brass UNI EN 12164 CW614N
- 4** 密封圈
Seals

NBR
NBR

 -20° ÷ 80°C
  80 bar

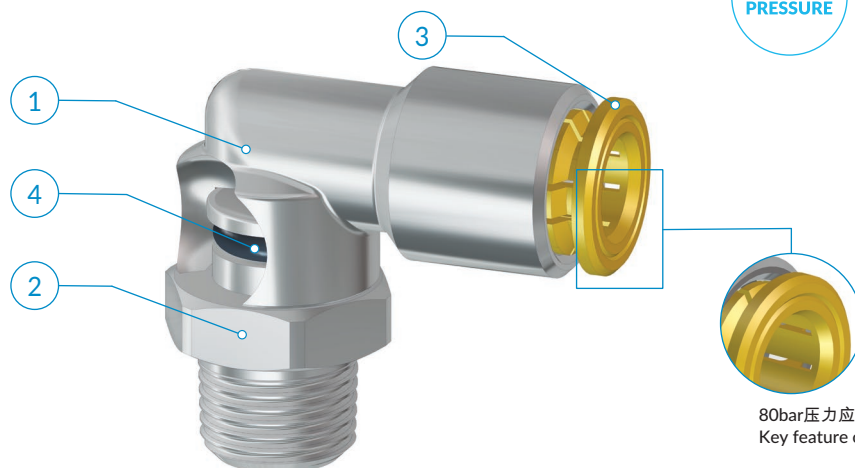

MEDIUM PRESSURE

80bar压力应用范围是其显著特点
Key feature of the 80-bar version

	M6x1	M8x1	M10x1	R1/8	R1/4
4	●	●	●	●	
6	●	●	●	●	
8			●	●	●

建议的连接管路:
PA66 (4x1,5 - 6x3), PA12 HR

Recommended tubings:
PA66 (4x1,5 - 6x3), PA12 HR

可接受的管路公差:
+/- 0.07 mm, 最大直径 Ø 8 mm。

Acceptable Tolerances on the tubings:
+/- 0,07 mm up to Ø 8 mm

应用领域:
润滑系统。

Application fields:
Lubrication installations

 可承受的最大压力根据使用管路类型和环境温度而有所差异, 这两个因素或许导致管路爆破压力的降低。

 The max pressure rate achievable can vary depending on the tubing used and on the room temperature. These two factors may in fact lower the tube bursting pressure.



管路插入深度

Tubing insertion depth

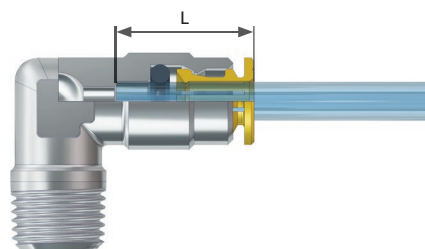

OD	L
4	14,5
6	17
8	17

1

沿管路垂直切割 (使用TCUT切管刀),确认内外管壁没有毛刺,同时注意避免管路截面呈椭圆形。

2

将管路插入接头,到底为止。

拔出管路:

垂直按压释放环,同时拔出管路即可。

1

Cut the tube square (by means of a hose cutter i.e. our TCUT) making sure that no burrs are left and that the tube is not oval.

2

Insert the tube into the fitting until it bottoms.

Tube release

While pressing on the release ring, pull out the tube from the fitting.

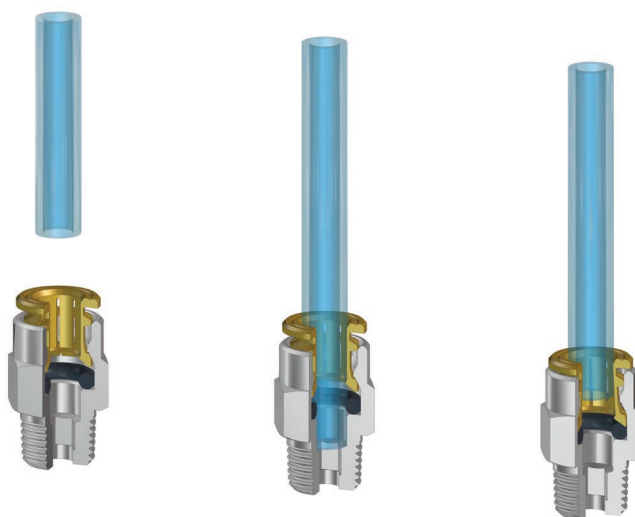

! 完成接头连接后,请确保管路不受到任何拉力,管路弯曲也需要符合本样本376页所声明的最小弯曲半径。为避免管路的意外脱落,不应在释放环上施加任何外力以及异常压力,释放环承受侧向的载荷也会引起管路脱落。
螺纹拧紧力矩,请参考本样本第10页

! Once the tubing is connected to the fitting, make sure that the tubing is not subject to any tensile strength and that the min. recommended bending radius stated in the tubing section of this catalogue is complied with (see page 376).

To prevent any accidental tube release, no components have to come in touch with the release ring and exercise any unwanted pressure on the same. Indeed however lateral, any load on the release ring may cause the tube disconnection.

To tighten threads, please check out our tightening torque chart illustrated at page 10.

! 如果将金属端管与接头连接,端管截面和尺寸必须与下列建议相符。如果将具有不同规格的端管与接头相连,可能会对接头造成无法修复的损坏,因此无法确保接头的正常功能。

! If a metal stem is connected to the fitting, the stem has to be manufactured according to the profile and sizes as set forth below. Should the fitting be connected to a metal stem not complying to the technical features recommended, the fitting may get irreversibly damaged and its function would no longer be guaranteed.

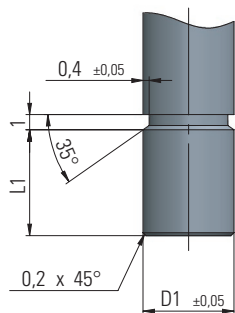

D1	L1
4	6
6	7
8	7

MP 11

外锥螺纹直接头

Taper straight, male

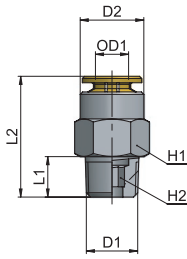

类型	OD1	D1	D2	L1	L2	H1	H2	g Δ
11 04 18	4	R1/8	9	7,5	18,5	10	3	7,3
11 04 M6x1	4	M6x1	9	8	23,2	10	2,5	7,6
11 04 M8x1	4	M8x1	9	8	20	10	3	6,7
11 04 M10x1	4	M10x1	9	8	20	11	3	9,3
11 06 18	6	R1/8	11,8	7,5	22	12	4	10,3
11 06 M6x1	6	M6x1	11,8	8	26	12	2,5	11,8
11 06 M8x1	6	M8x1	11,8	8	26	12	4	12,3
11 06 M10x1	6	M10x1	11,8	8	22,5	12	4	10,9
11 08 18	8	R1/8	13,8	7,5	25	14	5	15,4
11 08 14	8	R1/4	13,8	11	25	14	6	16,4
11 08 M10x1	8	M10x1	13,8	8	25,5	14	5	15,6

MP 14

外锥螺纹弯管接头

Taper elbow fitting, male

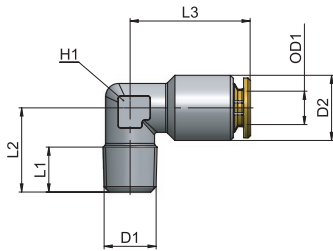

类型	OD1	D1	D2	L1	L2	L3	H1	g Δ
14 04 18	4	R1/8	9	8,3	15,5	20	10	12,6
14 04 M6x1	4	M6x1	9	9	17	20	10	13,3
14 04 M8x1	4	M8x1	9	10	17	20	10	13,4
14 04 M10x1	4	M10x1	9	9	18	20	10	14,3
14 06 18	6	R1/8	12	8,3	15,5	21,5	10	14,2
14 06 M6x1	6	M6x1	12	9	17	21,5	10	14,6
14 06 M8x1	6	M8x1	12	10	17	21,5	10	14,8
14 06 M10x1	6	M10x1	12	9	18	21,5	10	15,8
14 08 18	8	R1/8	14	10,5	19	23	12	21,1
14 08 14	8	R1/4	14	10,6	20	23	12	23,9
14 08 M10x1	8	M10x1	14	9	19	23	12	22,1

MP 15

可调向外锥螺纹弯管接头

Taper swivelling elbow fitting, male

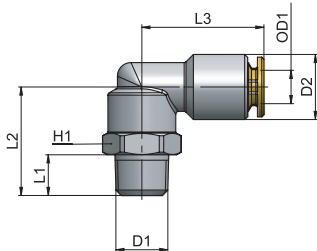

类型	OD1	D1	D2	L1	L2	L3	H1	g Δ
15 04 18	4	R1/8	9	7,5	20	20	13	21,9
15 04 M6x1	4	M6x1	9	8	20,5	20	13	19,9
15 04 M8x1	4	M8x1	9	8	20,5	20	13	20,7
15 04 M10x1	4	M10x1	9	8	21,5	20	13	23,4
15 06 18	6	R1/8	12	7,5	20	22	13	24,2
15 06 M6x1	6	M6x1	12	8	20,5	22	13	21,7
15 06 M8x1	6	M8x1	12	8	20,5	22	13	22,7
15 06 M10x1	6	M10x1	12	8	21,5	22	13	25,8
15 08 18	8	R1/8	14	7,5	20,5	22,5	13	28,3
15 08 14	8	R1/4	14	11	24	22,5	14	35,8
15 08 M10x1	8	M10x1	14	8	22	22,5	13	29,9

MP 26

对接接头

Union

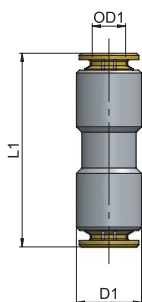

类型	OD1	D1	L1	g Δ
26 04 04	4	9	30	10,1
26 06 06	6	12	34,5	15,7
26 08 08	8	14	35	20,2

MP 28

直角对接接头

Union elbow

类型	OD1	D1	L1	g 
28 04 04	4	9	20	15,8
28 06 06	6	12	22,5	18,9
28 08 08	8	14	23	25,3

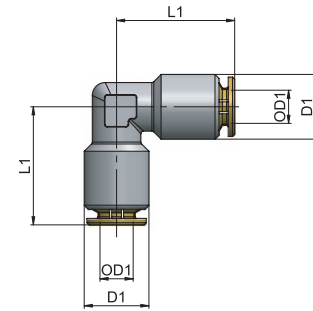

MP 29

正T型三通对接接头

Union T

类型	OD1	D1	L1	g 
29 04 04	4	9	19,5	21,3
29 06 06	6	12	20,5	24,8
29 08 08	8	14	21,5	31,7

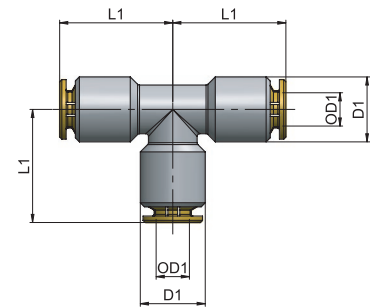

AP	55
AR	63
AV	221
CO	157
CX	255
EV	217
GU	119
GU Safety	135
GX	281
GX Safety	291
HP	317
MA	27
MB	41
MC	83
MF	235
MM	333
MO	93
MP	323
MT	339
MV	171
MX	241
MY	229
OX	261
PA	113
PE	79
PM	329
PN	67
PT	347
PU	131
PU Safety	149
PUX	287
PV	203
PVX	311
PX	249
QO	363
RA	101
RF	269
RT	355
RX	275
Tools	369
Tubings	375
VF	295
VT	359
VX	299



cmatic