

MX LINE



CN

316L不锈钢快插接头

MX系列快插式管接头完全采用AISI 316L (1.4404) 不锈钢制造，是强腐蚀性环境及高温应用场景的理想解决方案。

EN

316L Stainless Steel Push-in Fittings

The push-in fittings of the MX line are entirely made of AISI 316L (1.4404) and they are the perfect solution for highly aggressive environments and high temperature rated applications.

MX Line

- 1** 本体
Body

316L (1.4404) 不锈钢
Stainless steel AISI 316L (1.4404)
- 2** 释放环
Release ring
- 3** 卡爪
Gripping ring

AISI 301 不锈钢
Stainless steel AISI 301
- 4** 支撑环
Holding ring

316L (1.4404) 不锈钢
Stainless steel AISI 316L (1.4404)
- 5** 保护环
Protection ring

316L (1.4404) 不锈钢
Stainless steel AISI 316L (1.4404)
- 6** 密封圈
Seals

满足FDA规范的FPM
FPM, FDA compliant

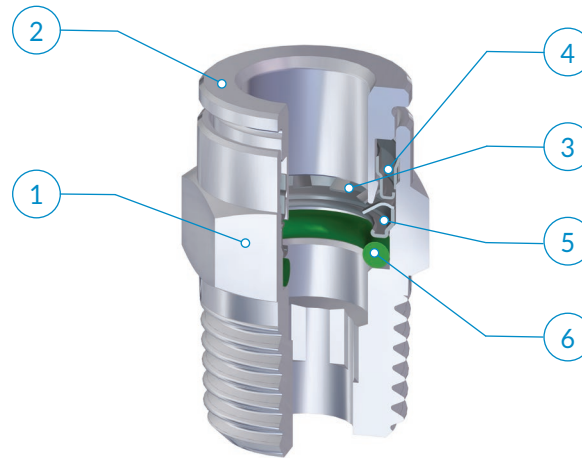

	M5x0,8	G1/8	G1/4	G3/8	G1/2	R1/8	R1/4	R3/8	R1/2
3	●								
4	●	●				●	●		
6	●	●	●			●	●		
8		●	●	●		●	●	●	
10			●	●	●		●	●	●
12			●	●	●		●	●	●

建议的连接管路:

PVDF管、PTFE管、不锈钢管 (关于金属管的使用, 参见安装说明)

Recommended tubings:

PVDF, PTFE and Stainless steel tubes (for metal hose assembly see the instructions above).

可接受的管路公差:

+/- 0.07 mm, 最大直径 10 mm
+/- 0.1 mm, 直径从10到12 mm。

Acceptable Tolerances on the tubings:

+/- 0.07 mm up to 10 mm.
+/- 0.1 mm from diam 10 up to 12 mm

应用领域:

气动、食品、化学、医疗制药行业。

Application fields:

Pneumatics, Food Industry, Chemical, Medical and Pharmaceutical Industry

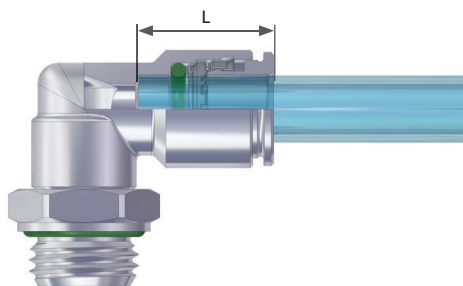

OD	L
4	13,2
6	16,1
8	16,2
10	18,3
12	19,5

安装说明

ASSEMBLY INSTRUCTIONS

1

沿管路垂直切割 (使用TCUT切管刀),确认内外管壁没有毛刺,同时注意避免管路截面呈椭圆形。使用金属管路连接时,需要通过专用设备 (TINC) 在管路上开槽。开槽尺寸需要考虑管路直径,以保证可靠的连接。

1

Cut the tube square (by means of a hose cutter i.e. our TCUT) making sure that no burrs are left and that the tube is not oval. In case of use with metal hoses, make a groove all around the tube diameter with a suitable tool (TINC).The groove must be made according to the tube diameter so that the fitting collect can better grip onto it.

2

将管路插入接头,到底为止。

2

Insert the tube into the fitting until it bottoms.

拔出管路:

垂直按压释放环,同时拔出管路即可。

Tube release

While pressing on the release ring, pull out the tube from the fitting

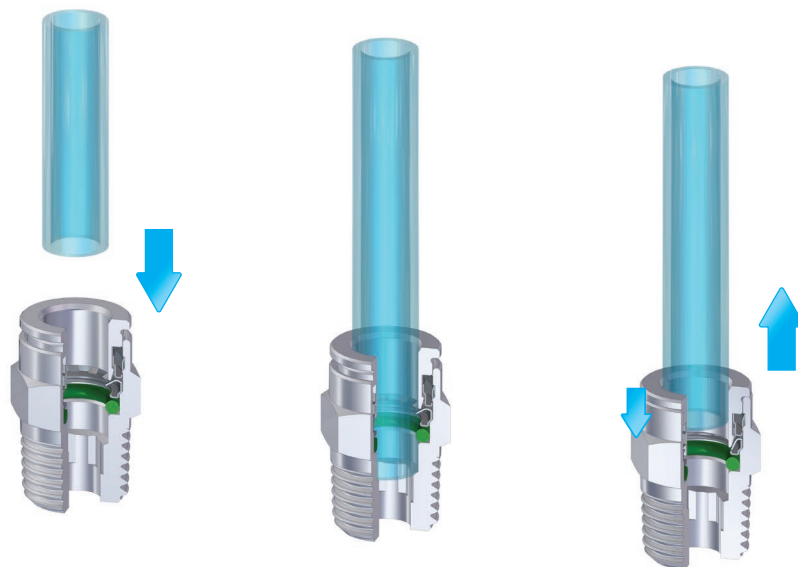

完成连接后,请确保管路上不承受外力;此外,请确保管路连接的最小弯曲半径符合本样册第376页之规定。

为了避免管路意外松脱,任何物体均不要接触释放环。作用在释放环上任何外力,包括侧向力,均可能导致管路意外松脱。螺纹拧紧时,请参考第10页列出的建议扭矩。



Once the tubing is connected to the fitting, make sure that the tubing is not subject to any tensile strength and that the min. recommended bending radius stated in the tubing section of this catalogue is complied with (see page 376).

To prevent any accidental tube release, no components have to come in touch with the release ring and exercise any unwanted pressure on the same. Indeed however lateral, any load on the release ring may cause the tube disconnection.

To tighten threads, please check out our tightening torque chart illustrated at page 10.

MX 11

外锥螺纹直接头

Taper straight, male

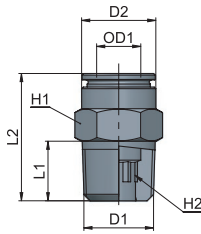

类型	OD1	D1	D2	L1	L2	H1	H2	g Δ
11 04 18	4	R1/8	9	7,5	16,5	10	3	6,3
11 04 14	4	R1/4	9	11	20,5	14	3	16,1
11 06 18	6	R1/8	11,7	7,5	21	12	4	9,5
11 06 14	6	R1/4	12	11	20,5	14	4	14,3
11 08 18	8	R1/8	13,7	7,5	25	14	6	13,5
11 08 14	8	R1/4	13,7	11	23,5	14	6	14,4
11 08 38	8	R3/8	13,9	11,5	22,5	17	6	23,7
11 10 14	10	R1/4	15,7	11	30,5	16	8	20,3
11 10 38	10	R3/8	16	11,5	24	17	8	21,5
11 10 12	10	R1/2	15,7	14	27	22	8	45,9
11 12 14	12	R1/4	18,7	11	32	19	8	29,1
11 12 38	12	R3/8	18,7	11,5	27,5	19	10	25,7
11 12 12	12	R1/2	19	14	27,5	22	10	42,1

MX 11 XT

快插卡箍接头

Clamp to push-in fitting

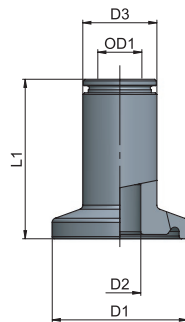

类型	OD1	D1	D2	D3	L1	g Δ
11 06 XT D25	6	25	4,55	12	29,5	29,5
11 06 XT D50,4	6	50,4	4,55	12	29,5	98,2
11 08 XT D25	8	25	7,75	13,7	29,5	34,3
11 08 XT D50,4	8	50,4	7,75	13,7	29,5	105,7
11 10 XT D25	10	25	7,75	16	30	56,8
11 10 XT D50,4	10	50,4	7,75	16	30	102,6

卡箍表面处理等级: SF1级
Surface finishing of the Clamp side: SF1 Class

MX 12

外直螺纹直接头

Parallel straight, male

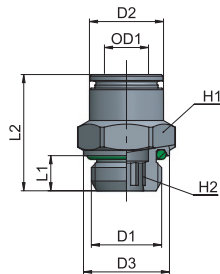

类型	OD1	D1	D2	D3	L1	L2	H1	H2	g Δ
12 03 M5	3	M5x0,8	6,5	9	4	16	8	-	3,0
12 04 M5	4	M5x0,8	9	8	4	19	9	-	4,9
12 04 18	4	G1/8	9	12,9	5	16,5	13	3	8,1
12 06 M5	6	M5x0,8	11,8	8	4	22,5	12	-	10,3
12 06 18	6	G1/8	11,7	12,9	5	19,5	13	4	9,2
12 06 14	6	G1/4	11,7	15,8	6,5	19,5	16	4	15,8
12 08 18	8	G1/8	13,7	12,9	5	23	14	6	12,8
12 08 14	8	G1/4	13,7	15,9	6,5	21,5	16	6	15,5
12 08 38	8	G3/8	13,7	20	7	21,5	17	6	24,4
12 10 14	10	G1/4	15,7	15,8	6,5	27,5	16	8	19,2
12 10 38	10	G3/8	16	20	7	25	17	8	24,4
12 10 12	10	G1/2	15,8	25	8,5	25,5	22	8	42,5
12 12 14	12	G1/4	18,8	16	6,5	28,5	19	8	13,0
12 12 38	12	G3/8	18,8	20	7	28	21	10	31,8
12 12 12	12	G1/2	18,8	25	8,5	26,5	22	10	41,8

MX 13

内螺纹直接头

Female straight

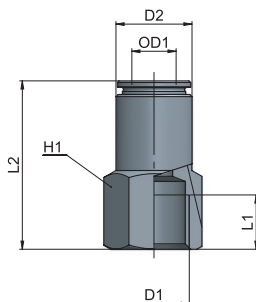

类型	OD1	D1	D2	L1	L2	H1	g Δ
13 04 18	4	G1/8	9	7	24,5	13	11,2
13 06 18	6	G1/8	12	7	26,5	13	15,4
13 06 14	6	G1/4	12	10	31	16	20,8
13 08 18	8	G1/8	13,8	7	26,5	14	18,2
13 08 14	8	G1/4	14	10	31	16	22,7
13 08 38	8	G3/8	14	11	32,5	21	33,2
13 10 14	10	G1/4	15,7	10	33	16	24,0
13 10 38	10	G3/8	16	11	34,5	21	16,6
13 10 12	10	G1/2	16	11	36	24	41,4
13 12 38	12	G3/8	19	11	35,5	21	77,5
13 12 12	12	G1/2	19	11	37	24	48,4

MX 14

外锥螺纹弯管接头

Taper elbow fitting, male

类型	OD1	D1	D2	L1	L2	L3	g Δ
14 04 18	4	R1/8	9	9,8	17	17,5	10,2
14 06 18	6	R1/8	12	9,8	17	20,5	14,0
14 06 14	6	R1/4	12	11,3	20,7	20,5	20,8
14 08 18	8	R1/8	14	9,5	18	22,5	19,6
14 08 14	8	R1/4	14	11,3	20,7	22,5	22,3
14 10 14	10	R1/4	16	12,1	21,5	24,5	39,5

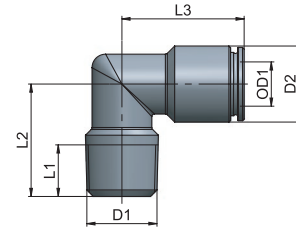

MX 15

可调向外锥螺纹弯管接头

Taper swivelling elbow fitting, male

类型	Ø Tubo	D1	D2	L1	L2	L3	H1	g Δ
15 04 18	4	R1/8	9	7,5	18	17,5	10	10,8
15 06 18	6	R1/8	12	7,5	20,5	21,5	13	21,2
15 06 14	6	R1/4	12	11	24,5	21,5	14	25,2
15 08 18	8	R1/8	14	7,5	20,5	22,5	13	22,2
15 08 14	8	R1/4	14	11	24,5	22,5	14	26,3
15 08 38	8	R3/8	14	11,5	25	22,5	17	31,3
15 10 14	10	R1/4	16	11	27	26	16	37,5
15 10 38	10	R3/8	16	11,5	27,5	26	17	41,1
15 10 12	10	R1/2	16	14	32	26	22	54,4
15 12 14	12	R1/4	19	11	30,5	28,5	21	63,9
15 12 38	12	R3/8	19	11,5	31	28,5	21	65,1
15 12 12	12	R1/2	19	14	34	28,5	22	71,5

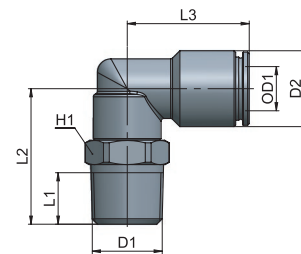

MX 15 XT

直角快插卡箍接头

Clamp to push-in 90° fitting

类型	OD1	D1	D2	D3	L1	L2	g Δ
15 06 XT D25	6	25	7,75	12	29,8	21,5	39,8
15 06 XT D50,4	6	50,4	7,75	12	29,8	21,5	114,3
15 08 XT D25	8	25	7,75	14	30,3	22,5	41,7
15 08 XT D50,4	8	50,4	7,75	14	30,3	22,5	115,9
15 10 XT D25	10	25	7,75	16	31,8	26	68,0
15 10 XT D50,4	10	50,4	7,75	16	31,8	26	122,0



卡箍表面处理等级: SF1级
Surface finishing of the Clamp side: SF1 Class

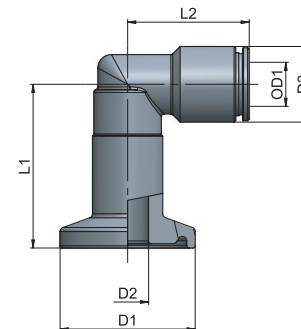

MX 16

可调向外直螺纹弯管接头

Parallel swivelling elbow fitting, male

类型	OD1	D1	D2	L1	L2	L3	H1	g Δ
16 04 M5	4	M5x0,8	9	4	14,5	17,5	9	8,7
16 04 18	4	G1/8	9	5	16,5	17,5	13	12,2
16 06 M5	6	M5x0,8	12	4	15,5	20,5	9	13,2
16 06 18	6	G1/8	12	5	18,5	21,5	13	20,3
16 06 14	6	G1/4	12	6,5	20,5	21,5	16	24,3
16 08 18	8	G1/8	14	5	18,5	22,5	13	21,9
16 08 14	8	G1/4	14	6,5	20,5	22,5	16	25,8
16 08 38	8	G3/8	14	7	22,5	22,5	21	35,1
16 10 14	10	G1/4	16	6,5	23	26	16	34,6
16 10 38	10	G3/8	16	7	24,5	26	21	41,0
16 10 12	10	G1/2	16	8,5	29	26	22	52,3
16 12 14	12	G1/4	19	6,5	26	28,5	21	62,0
16 12 38	12	G3/8	19	7	26,5	28,5	21	59,5
16 12 12	12	G1/2	19	8,5	31	28,5	22	69,2

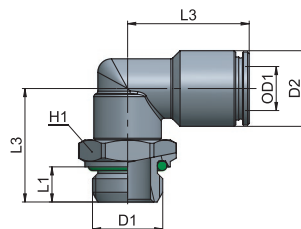

AP 55
AR 63
AV 221
CO 157
CX 255
EV 217
GU 119
GU Safety 135
GX 281
GX Safety 291
HP 317
MA 27
MB 41
MC 83
MF 235
MM 333
MO 93
MP 323
MT 339
MV 171
MX 241
MY 229
OX 261
PA 113
PE 79
PM 329
PN 67
PT 347
PU 131
PU Safety 149
PUX 287
PV 203
PVX 311
PX 249
QO 363
RA 101
RF 269
RT 355
RX 275
Tools 369
Tubings 375
VF 295
VT 359
VX 299

MX 20

可调向锥螺纹正T型三通接头

Swivelling T fitting, taper

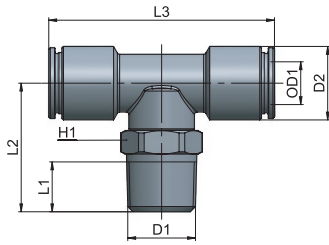

类型	OD1	D1	D2	L1	L2	L3	H1	g Δ
20 04 18	4	R1/8	9	7,5	21,5	35	10	16,1
20 06 18	6	R1/8	12	7,5	20,5	43	13	30,3
20 06 14	6	R1/4	12	11	24,5	43	14	33,9
20 08 18	8	R1/8	14	7,5	20,5	43	13	32,2
20 08 14	8	R1/4	14	11	24,5	43	14	35,4
20 10 14	10	R1/4	16	11	27,5	51	16	61,0
20 10 38	10	R3/8	16	11,5	28	51	17	64,1
20 12 38	12	R3/8	19	11,5	31	57	21	82,6
20 12 12	12	R1/2	19	14	34	57	22	88,7

MX 21

可调向直螺纹正T型三通接头

Swivelling T fitting, parallel

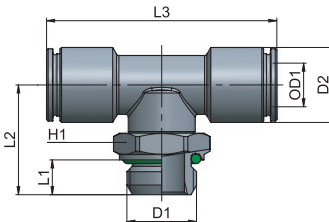

类型	OD1	D1	D2	L1	L2	L3	H1	g Δ
21 04 M5	4	M5x0,8	9	4	18	35	9	14,0
21 04 18	4	G1/8	9	5	20	35	13	17,6
21 06 18	6	G1/8	12	5	18,5	43	13	29,2
21 06 14	6	G1/4	12	6,5	20,5	43	16	33,3
21 08 18	8	G1/8	14	5	18,5	43	13	30,7
21 08 14	8	G1/4	14	6,5	20,5	43	16	34,8
21 10 14	10	G1/4	16	6,5	22,5	51	16	57,1
21 10 38	10	G3/8	16	7	24,5	51	21	63,9
21 12 38	12	G3/8	19	7	26,5	57	21	76,9
21 12 12	12	G1/2	19	8,5	31	57	22	85,7

MX 25

减径接头

Reducer

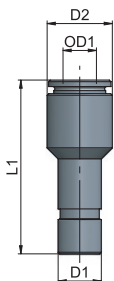

类型	OD1	D1	D2	L1	g Δ
25 04 06	4	6	9	30,5	6,5
25 06 08	6	8	12	32	11,9
25 06 10	6	10	12	35	15,1
25 08 10	8	10	14	35	14,8
25 08 12	8	12	14	38	21,5
25 10 12	10	12	16	41	20,5

MX 26

对接接头

Union

类型	OD1	OD2	D1	D2	L1	g 
26 04 04	4	4	9	9	28	7,8
26 06 06	6	6	12	12	33,6	15,7
26 06 04	6	4	12	12	31	15,5
26 08 08	8	8	14	14	34	19,5
26 08 06	8	6	14	14	34	23,8
26 10 10	10	10	16	16	38,6	24,9
26 10 08	10	8	16	14	37,1	23,3
26 12 12	12	12	19	19	41	40,0
26 12 10	12	10	19	16	40,3	34,2

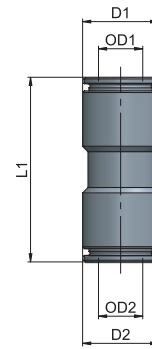

MX 27

穿板对接接头

Bulkhead union

类型	OD1	D2	L1	L2	H1	g 
27 04 04	4	M12x1	28	11,5	16	19,9
27 06 06	6	M14x1	34	15,5	17	31,4
27 08 08	8	M16x1	34	15,5	19	36,8
27 10 10	10	M18x1	39	18,5	21	48,4
27 12 12	12	M20x1	41	20,5	24	61,8

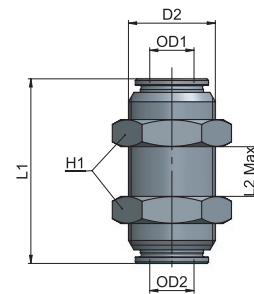

MX 28

直角对接接头

Union elbow

类型	OD1	D2	L1	g 
28 04 04	4	9	17,5	11,7
28 06 06	6	12	21	18,0
28 08 08	8	14	22,5	24,1
28 10 10	10	16	24,5	43,0
28 12 12	12	18	27	49,3

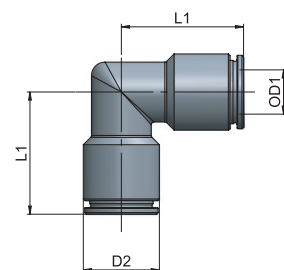

AP	55
AR	63
AV	221
CO	157
CX	255
EV	217
GU	119
GU Safety	135
GX	281
GX Safety	291
HP	317
MA	27
MB	41
MC	83
MF	235
MM	333
MO	93
MP	323
MT	339
MV	171
MX	241
MY	229
OX	261
PA	113
PE	79
PM	329
PN	67
PT	347
PU	131
PU Safety	149
PUX	287
PV	203
PVX	311
PX	249
QO	363
RA	101
RF	269
RT	355
RX	275
Tools	369
Tubings	375
VF	295
VT	359
VX	299

MX 29

正T型三通对接接头

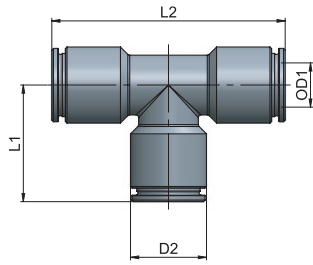

Union T

类型	OD1	D2	L1	L2	g Δ
29 04 04	4	9	17,5	35	14,6
29 06 06	6	12	21	42	29,9
29 08 08	8	14	21,5	43	30,6
29 10 10	10	16	24,5	49	56,1
29 12 12	12	18	27	54	65,9

MX 31

单层铰接螺栓

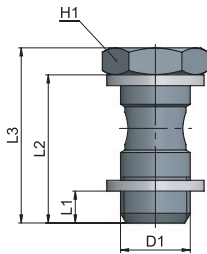

Simple screw

类型	D1	L1	L2	L3	H1	g Δ
31 00 18	G1/8	5,4	24,9	28,9	14	15,1
31 00 14	G1/4	6,4	27,4	32,4	17	26,1
31 00 38	G3/8	6,4	30	36	21	43,6
31 00 12	G1/2	7,5	35,5	41,5	26	76,5

PTFE 垫圈 - Standard PTFE gasket

MX 35

单通铰接接头本体

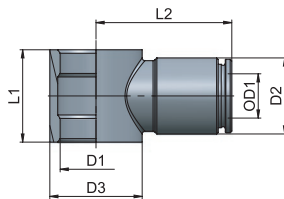

Single banjo ring

类型	OD1	D1	D2	D3	L1	L2	g Δ
35 04 18	4	10	9	14	15	20,5	13,1
35 06 18	6	10	12	14	15	22,5	16,1
35 06 14	6	13,2	12	17	17	24	18,7
35 08 18	8	10	14	14	15	23	16,6
35 08 14	8	13,2	14	17	17	25	20,4
35 10 14	10	13,2	16	17	17	27	23,1
35 10 38	10	17	16	22	20	29	35,5
35 12 38	12	17	16	22	20	31	40,8
35 12 12	12	21	19	26	24	33	52,2