

OX LINE



CN

EN

316L不锈钢卡套接头

OX系列管接头完全采用AISI 316L (1.4404) 不锈钢制造, 适用于不锈钢管道连接。管道安装简便且无需使用润滑剂, 从而确保产品符合食品级标准。本体, 卡套及螺母均按照ISO8434/DIN 2353标准规范制造。

316L Stainless Steel Compression Fittings

The OX fittings are completely made in AISI 316L (1.4404) and they are suitable for assembly with stainless steel pipes. The pipe connection is easy and needs no grease, allowing thereby to keep the food grade degree of the product. The olive seat, the olives and the nuts are all manufactured according to ISO8434/DIN 2353 norm.

OX Line

1 本体
Body
316L (1.4404) 不锈钢
Stainless steel AISI 316L (1.4404)

2 螺母
Nut
316L (1.4404) 不锈钢
Stainless steel AISI 316L (1.4404)

3 卡箍
Olive
316L (1.4404) 不锈钢
Stainless steel AISI 316L (1.4404)

-40° ÷ 250°C

80 bar

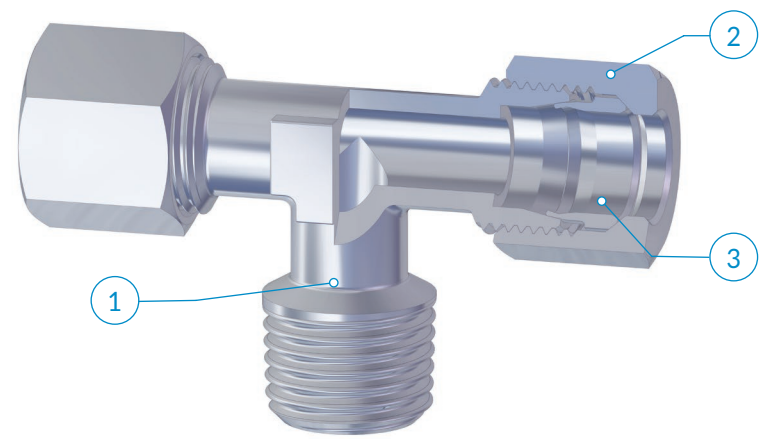

	G1/8	G1/4	G3/8	G1/2	R1/8	R1/4	R3/8	R1/2
4					•			
6	•				•	•		
8		•			•	•		
10		•	•			•	•	
12			•	•			•	•

建议的连接管路:
符合DIN EN 10216-5规范的无缝不锈钢管路

Recommended pipes:
Seamless Stainless steel pipes according to the DIN EN 10216-5 Norm

可接受的管路公差:
根据DIN EN 10216-5规范

Acceptable hoses tolerances:
According to DIN EN 10216-5

应用领域:
食品、制药和仪器仪表行业。

Application fields:
Food and Pharma industry and instrumentation

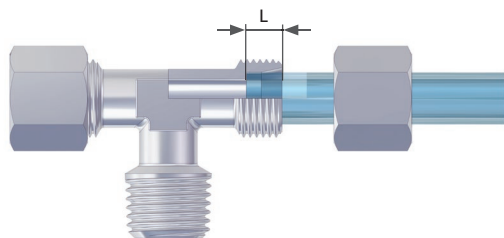

OD	L
4	4
6	5,5
8	5,5
10	7
12	7

管路准备和提示

PIPE PREPARATION AND WARNINGS

两个相邻接头间的距离L, 至少应为螺母长度的2.5-3倍。如果要连接弯管, 请确保弯管端长度H至少为2倍的螺母长度。L与H, 可参看下方图示。

The min. pipe length "L" between two fittings has to be at least 2.5-3 times the nut height. To connect a curved pipe, make sure the pipe curve be at least at a distance "H" equaling twice the nut height.

管路
拆装后再次装配时, 管端位置需要与之前一样。
切管时, 应使用专用工具, 以保证切口平直, 避免毛刺。

Pipe
If disassembled, the pipe endings have to be re-assembled in the same fitting shoulder as previously used.
To cut the tube, DO NOT use a pipe cutter but a saw that allows for a square cut and limits burrs.

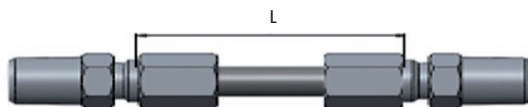
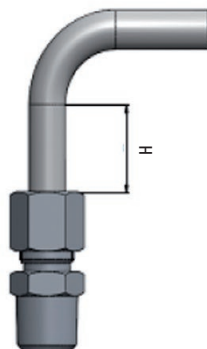

管径Ø	Ø 4	Ø 6	Ø 8	Ø 10	Ø 12
H min.	22	23	24	31	31
L min.	33	34	36	46	46

安装说明

1

垂直切割管路，截面最大允许偏差角度为0.5°

2

清除管路内外壁毛刺，注意不要损坏管端

3

将螺母和卡箍套在管子上，确保卡箍朝向管端

4

将管路插入接头体，直到底部。同时确保接头体，管路，卡箍，螺母同轴

5

用手完全拧紧螺母。

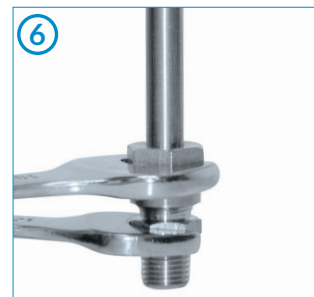
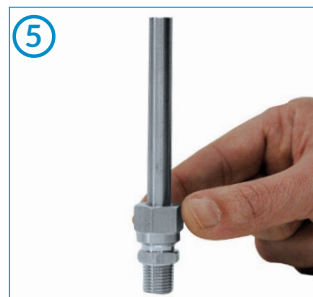
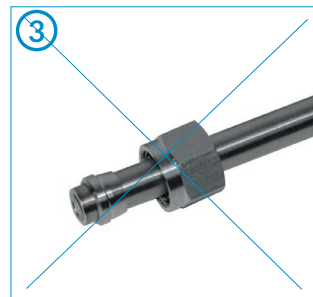
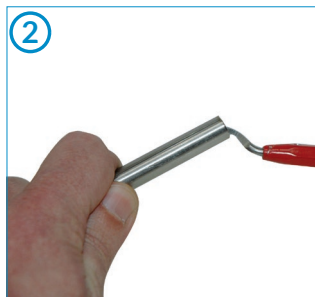
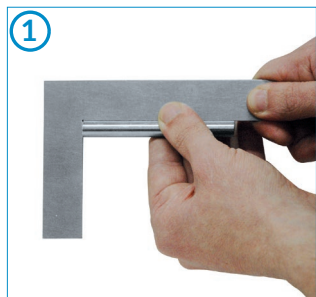

6

借助扳手，根据所使用接头尺寸，拧紧 $\frac{1}{4}$ - 1圈左右，将螺母最后拧紧，确定管路不会随螺母一同旋转。建议使用扭矩扳手，参见表中指示的拧紧扭矩。

7

再次确认

仅在检查时，拧松螺母并检查卡箍是否正确卡在管路上

8

最终安装

在第6点所示的拧紧基础上，将螺母再次拧紧 $\frac{1}{4}$ 圈。

6

By means of a wrench, tighten the nut by $\frac{1}{4}$ - 1 turn depending upon the fitting size. Avoid any pipe rotation during this phase. For this purpose, it is recommended to use a torque wrench and to refer to the torque force stated in the chart above.

7

DOUBLECHECK

Loosen the nut and make sure that the ferrule has left an even groove on the pipe.

8

FINAL ASSEMBLY

Tighten the nut by $\frac{1}{4}$ of a turn beyond the number of turns stated at point 6.

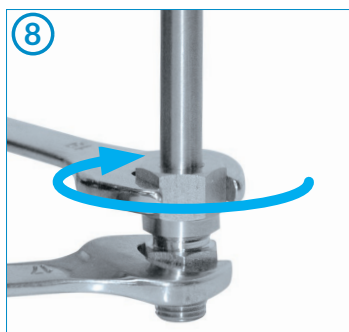
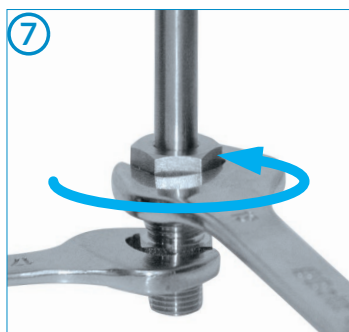

螺纹拧紧力矩 Tightening torques

管径Ø	Nm
Ø 4	10
Ø 6	20
Ø 8	25
Ø 10	30
Ø 12	65

OX 10

螺母

Nut

类型	OD1	D1	L1	H1	g Δ
10 00 04	4	M8x1	11	10	4,3
10 00 06	6	M10x1	11,5	12	5,6
10 00 08	8	M12x1	12	14	7,1
10 00 10	10	M16x1,5	15,5	19	18,4
10 00 12	12	M18x1,5	15,5	22	25,8

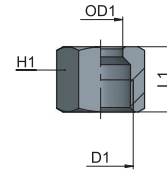

OX 11

外锥螺纹直接头

Taper straight, male

类型	OD1	D1	L1	L2	H1	H2	g Δ
11 04 18	4	R1/8	8	27	10	10	12,9
11 06 18	6	R1/8	8	27	11	12	14,7
11 06 14	6	R1/4	11	31	14	12	24,0
11 08 18	8	R1/8	8	29	12	14	17,5
11 08 14	8	R1/4	11	32	14	14	25,0
11 10 14	10	R1/4	11	35,5	17	19	42,4
11 10 38	10	R3/8	11,5	37	17	19	51,2
11 12 38	12	R3/8	11,5	37	19	22	59,3
11 12 12	12	R1/2	14	40,5	22	22	81,1

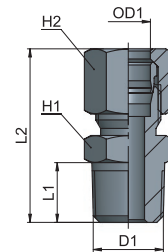

OX 11 XT

卡套卡箍接头

Clamp to compression fitting

类型	OD1	D1	D2	L1	H1	H2	g Δ
11 06 XT D25	6	25	4,55	35,5	12	12	-
11 06 XT D50,4	6	50,4	4,55	35,5	12	12	-
11 08 XT D25	8	25	7,75	36	12	14	-
11 08 XT D50,4	8	50,4	7,75	36	12	14	-
11 10 XT D25	10	25	7,75	40,5	16	19	-
11 10 XT D50,4	10	50,4	7,75	40,5	16	19	-

卡箍表面处理等级: SF1级
Surface finishing of the Clamp side: SF1 Class

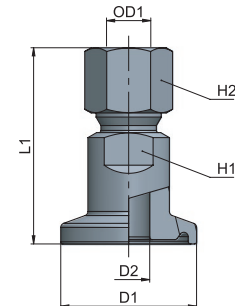

OX 13

内螺纹直接头

Female straight

类型	OD1	D1	L1	L2	H1	H2	g Δ
13 06 18	6	G1/8	8,5	28	14	12	20,5
13 08 14	8	G1/4	10,5	31	19	14	35,1
13 10 14	10	G1/4	10,5	34,5	19	19	51,6
13 10 38	10	G3/8	10,5	36,5	22	19	61,8
13 12 38	12	G3/8	10,5	36,5	22	22	70,2
13 12 12	12	G1/2	12,5	37,5	24	22	69,2

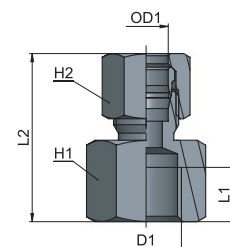

AP 55
AR 63
AV 221
CO 157
CX 255
EV 217
GU 119
GU Safety 135
GX 281
GX Safety 291
HP 317
MA 27
MB 41
MC 83
MF 235
MM 333
MO 93
MP 323
MT 339
MV 171
MX 241
MY 229
OX 261
PA 113
PE 79
PM 329
PN 67
PT 347
PU 131
PU Safety 149
PUX 287
PV 203
PVX 311
PX 249
QO 363
RA 101
RF 269
RT 355
RX 275
Tools 369
Tubings 375
VF 295
VT 359
VX 299

OX 14

外锥螺纹弯管接头

Taper elbow fitting, male

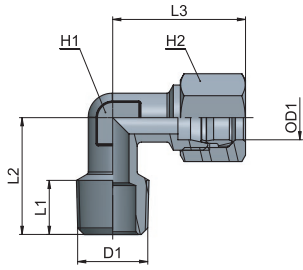

类型	OD1	D1	L1	L2	L3	H1	H2	g Δ
14 04 18	4	R1/8	6,5	17	23	10	10	16,7
14 06 18	6	R1/8	6,5	17	24	10	12	19,2
14 06 14	6	R1/4	10	21,5	24	10	12	21,9
14 08 14	8	R1/4	10	21,5	24,5	10	14	23,1
14 10 14	10	R1/4	12,5	24,5	30,5	12	19	46,8
14 10 38	10	R3/8	11,5	24,5	30,5	12	19	49,8
14 12 38	12	R3/8	12,5	25,5	33	17	22	72,5
14 12 12	12	R1/2	13,5	30	35	19	22	91,2

OX 20

锥螺纹正T型三通接头

Taper male T

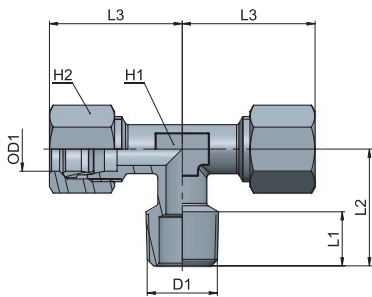

类型	OD1	D1	L1	L2	L3	H1	H2	g Δ
20 04 18	4	R1/8	6,5	17	23	10	10	25,3
20 06 18	6	R1/8	6,5	17	24	10	12	29,6
20 06 14	6	R1/4	10	21,5	24	10	12	32,7
20 08 14	8	R1/4	10	21,5	24,5	10	14	35,1
20 10 14	10	R1/4	12,5	24,5	30,5	12	19	72,6
20 10 38	10	R3/8	11,5	24,5	30,5	12	19	76,9
20 12 38	12	R3/8	12,5	25,5	33	17	22	117,1
20 12 12	12	R1/2	13,5	30	33	19	22	126,2

OX 22

卡箍

Olive

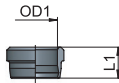

类型	OD1	L1	g Δ
22 00 04	4	5,5	0,3
22 00 06	6	6	0,8
22 00 08	8	5,7	1,0
22 00 10	10	8	2,2
22 00 12	12	8	2,5

OX 26

对接接头

Union

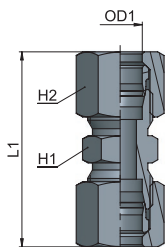

类型	OD1	L1	H1	H2	g Δ
26 04 04	4	34	9	10	14,9
26 06 06	6	34	11	12	20,4
26 08 08	8	36	12	14	26,5
26 10 10	10	45	17	19	66,4
26 12 12	12	45	19	22	85,8

Ox 28

直角对接接头

Union elbow

类型	OD1	L1	H1	H2	g 
28 04 04	4	23	10	10	21,5
28 06 06	6	24	10	12	25,3
28 08 08	8	24,5	10	14	28,3
28 10 10	10	30,5	12	19	66,0
28 12 12	12	33	17	22	99,2

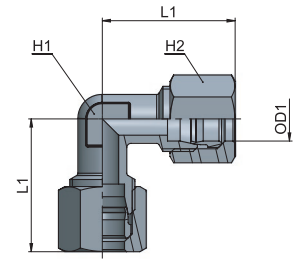

Ox 29

正T型三通对接接头

Union T

类型	OD1	L1	H1	H2	g 
29 04 04	4	23	10	10	30,2
29 06 06	6	24	10	12	36,2
29 08 08	8	24,5	10	14	40,9
29 10 10	10	30,5	12	19	94,1
29 12 12	12	33	17	22	143,0

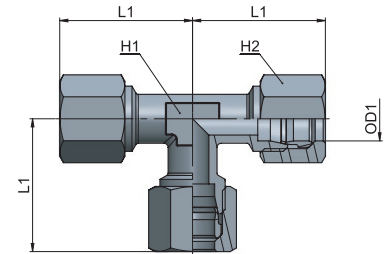

AP	55
AR	63
AV	221
CO	157
CX	255
EV	217
GU	119
GU Safety	135
GX	281
GX Safety	291
HP	317
MA	27
MB	41
MC	83
MF	235
MM	333
MO	93
MP	323
MT	339
MV	171
MX	241
MY	229
Ox	261
PA	113
PE	79
PM	329
PN	67
PT	347
PU	131
PU Safety	149
PUX	287
PV	203
PVX	311
PX	249
QO	363
RA	101
RF	269
RT	355
RX	275
Tools	369
Tubings	375
VF	295
VT	359
VX	299

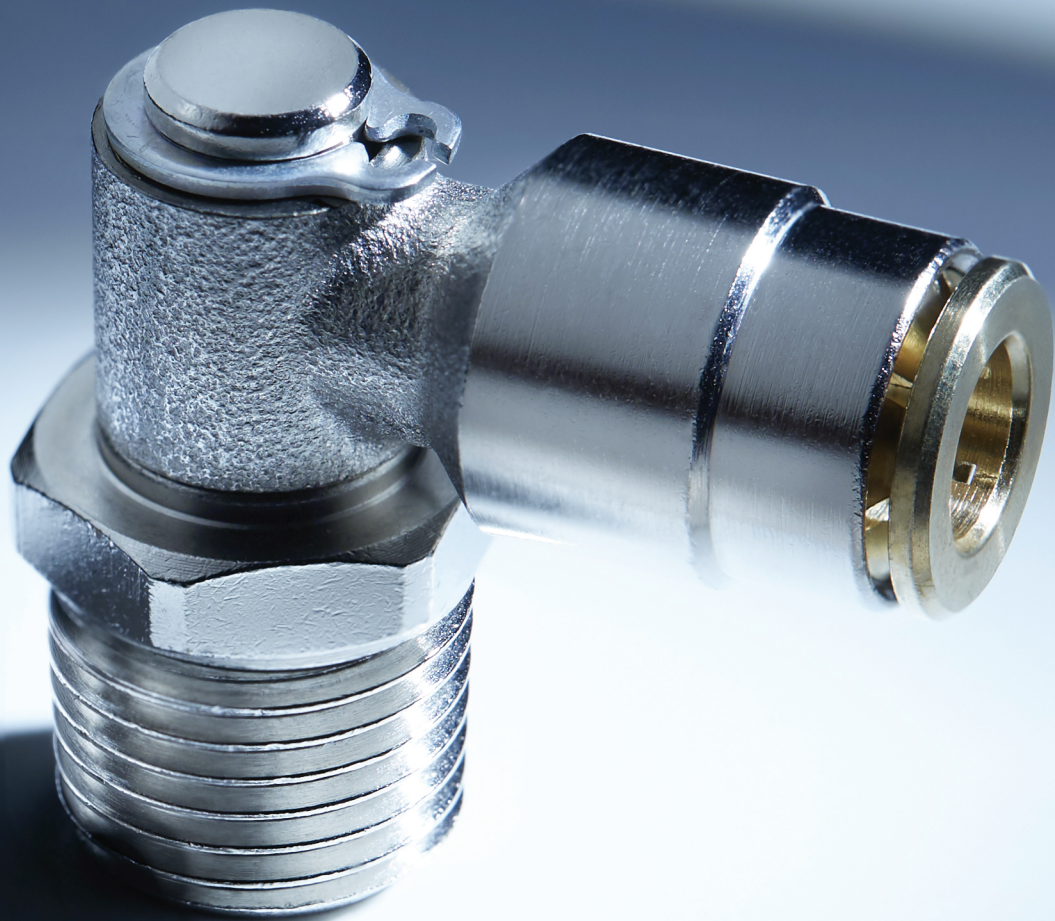

cmatic