

INCH

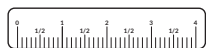

PA LINE



CN

EN

NPT黄铜镀镍标准接头

PA系列(亦称“附件系列”或“标准管接头系列”)包含多种组件,例如直通接头、异径接头、转换接头、堵头、软管接头、L型与T型及十字型接头等。凭借其丰富的品种选择,该系列管接头可完美补充各种连接件产品范围。所有零件均采用英制尺寸及NPT螺纹规格,并经过电解镀镍工艺处理。

Brass Nickel-Plated Standard Fittings, NPT

The PA line, also known as the “Accessories line” or the “Standard fittings line” consists of a wide variety of components, such as Nipples, Reduction pieces, Connections, Plugs, Hose connections, L-T and Cross fittings. Due to the multiple auxiliary functions of this line, the PA fittings are the right complement of different ranges. All components are in inch sizes and NPT threads and are electrolytic nickel plated.

PA Line

1 本体 Body

黄铜镀镍 UNI EN 12164 CW614N - UNI EN 12165 CW617N
Brass UNI EN 12164 CW614N - UNI EN 12165 CW617N, nickel Plated



-40° ÷ 150°C



60 bar

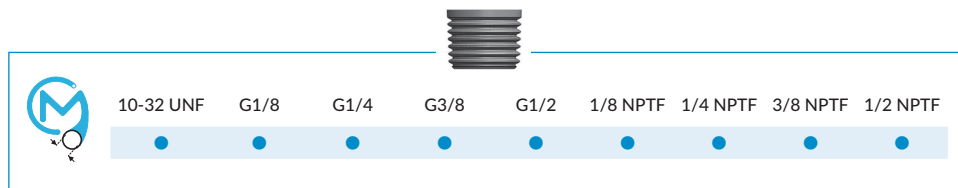
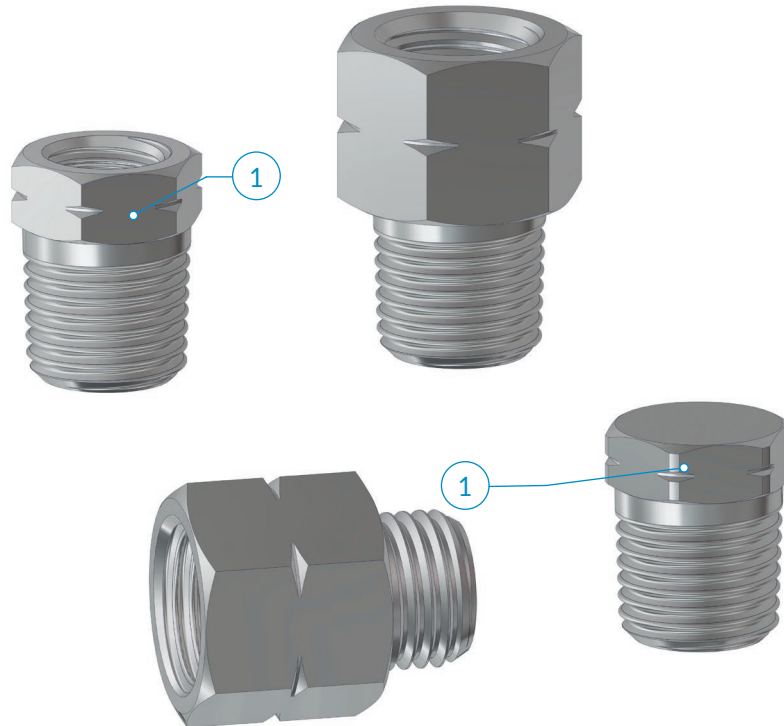

应用领域:
气动、液压和油压系统。

Application fields:
Pneumatic, hydraulic and oleodynamic circuits

PA 11

锥螺纹转接头

Nipple, taper

类型	D1	D2	L1	L2	L3	H1	g 
11 1/8 1/8	1/8 NPTF	1/8 NPTF	8,5	8,5	21	12	9,3
11 1/4 1/4	1/4 NPTF	1/4 NPTF	13	13	31	14	19,4
11 3/8 3/8	3/8 NPTF	3/8 NPTF	13	13	32	18	34,2
11 1/2 1/2	1/2 NPTF	1/2 NPTF	17	17	41	22	59,7

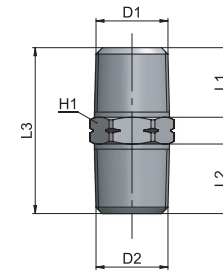

PA 13

内螺纹转接头

Joint Piece

类型	D1	L1	H1	g 
13 1/8 1/8	1/8 NPTF	18	14	13,4
13 1/4 1/4	1/4 NPTF	23	18	27,7
13 3/8 3/8	3/8 NPTF	25	22	41,1
13 1/2 1/2	1/2 NPTF	32	26	66,3

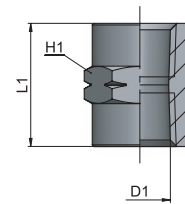

PA 14

内外螺纹减径接头

Taper female-male reducing connector

类型	D1	D2	L1	L2	H1	g 
14 1/8 10-32	1/8 NPTF	10-32 UNF	8,5	12,5	12	-
14 1/4 1/8	1/4 NPTF	1/8 NPTF	13	19	14	12,3
14 3/8 1/8	3/8 NPTF	1/8 NPTF	13	19	18	26,2
14 3/8 1/4	3/8 NPTF	1/4 NPTF	13	19	18	18,3
14 1/2 1/4	1/2 NPTF	1/4 NPTF	17	24	22	47,0
14 1/2 3/8	1/2 NPTF	3/8 NPTF	17	24	22	32,9

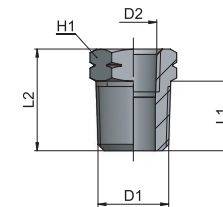

PA 16

内外螺纹转接头

Adaptor male-female, taper

类型	D1	D2	L1	L2	H1	g 
16 1/0-32 M5	10-32 UNF	M5x0,8	5	12	8	12,0
16 1/8 1/8	1/8 NPTF	G1/8 BSP	8,5	19	14	12,0
16 1/4 1/4	1/4 NPTF	G1/4 BSP	13	27	18	26,1
16 3/8 3/8	3/8 NPTF	G3/8 BSP	13	27	22	38,5
16 1/2 1/2	1/2 NPTF	G1/2 BSP	17	34	27	65,5

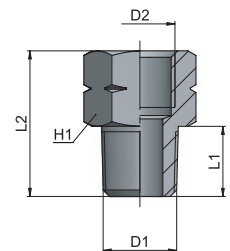

AP 55
AR 63
AV 221
CO 157
CX 255
EV 217
GU 119
GU Safety 135
GX 281
GX Safety 291
HP 317
MA 27
MB 41
MC 83
MF 235
MM 333
MO 93
MP 323
MT 339
MV 171
MX 241
MY 229
OX 261
PA 113
PE 79
PM 329
PN 67
PT 347
PU 131
PU Safety 149
PUX 287
PV 203
PVX 311
PX 249
QO 363
RA 101
RF 269
RT 355
RX 275
Tools 369
Tubings 375
VF 295
VT 359
VX 299

PA 17

内外螺纹转接头

Adaptor male-female, parallel

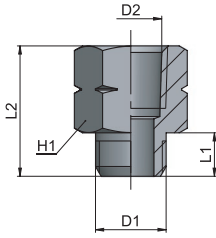

类型	D1	D2	L1	L2	H1	g Δ
17 1/8 1/8	G1/8 BSP	1/8 NPTF	6	18	14	12,5
17 1/4 1/4	G1/4 BSP	1/4 NPTF	8	24	18	27,0
17 3/8 3/8	G3/8 BSP	3/8 NPTF	9	25	22	49,5
17 1/2 1/2	G1/2 BSP	1/2 NPTF	10	30	24	50,0

PA 19

外螺纹堵头

Male plug

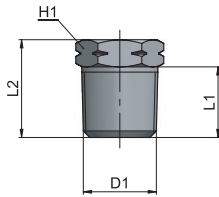

类型	D1	L1	L2	H1	g Δ
19 00 1/8	1/8 NPTF	8,5	12,5	12	6,5
19 00 1/4	1/4 NPTF	13	18	14	14,5
19 00 3/8	3/8 NPTF	13	19	18	24,5
19 00 1/2	1/2 NPTF	17	24	22	41,5

PA 21

内螺纹直角转接头

Female elbow

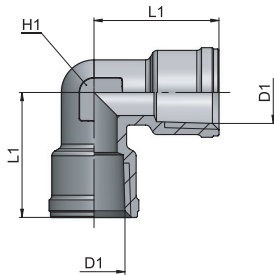

类型	D1	L1	H1	g Δ
21 1/8 1/8	1/8 NPTF	19	10	15,2
21 1/4 1/4	1/4 NPTF	23	12	38,5
21 3/8 3/8	3/8 NPTF	26	15	46,3
21 1/2 1/2	1/2 NPTF	34	19	87,1

PA 22

内外螺纹直角转接头

Male-Female elbow

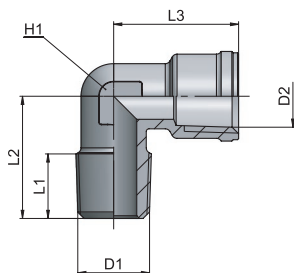

类型	D1	D2	L1	L2	L3	H1	g Δ
22 1/8 1/8	1/8 NPTF	1/8 NPTF	8,5	17,5	19	10	13,2
22 1/4 1/4	1/4 NPTF	1/4 NPTF	12	22,5	23	12	35,0
22 3/8 3/8	3/8 NPTF	3/8 NPTF	12	25,5	26	15	42,1
22 1/2 1/2	1/2 NPTF	1/2 NPTF	16	31	34	19	78,9

类型	D1	L1	H1	g 
23 1/8 1/8	1/8 NPTF	19	10	21,5
23 1/4 1/4	1/4 NPTF	23	12	38,4
23 3/8 3/8	3/8 NPTF	31	17	65,5
23 1/2 1/2	1/2 NPTF	33,5	21	143,0

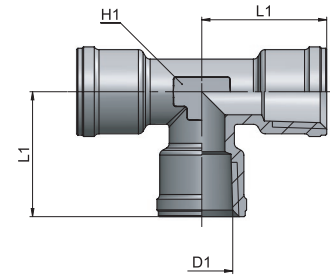

AP	55
AR	63
AV	221
CO	157
CX	255
EV	217
GU	119
GU Safety	135
GX	281
GX Safety	291
HP	317
MA	27
MB	41
MC	83
MF	235
MM	333
MO	93
MP	323
MT	339
MV	171
MX	241
MY	229
OX	261
PA	113
PE	79
PM	329
PN	67
PT	347
PU	131
PU Safety	149
PUX	287
PV	203
PVX	311
PX	249
QO	363
RA	101
RF	269
RT	355
RX	275
Tools	369
Tubings	375
VF	295
VT	359
VX	299

类型

Profiles



页码 ref.

GU20	Mini	2,5		BSP	120
GU21	Midi	5,5		BSP	122
GU26	European	7,4		BSP	125
GU10	Multi	5,5 ÷ 7,4		BSP	128
PU10	Multi	5,5 ÷ 7,4		NPT	132
GX10 不锈钢	Multi	5,5 ÷ 7,4		BSP	282
PUX10 不锈钢	Multi	5,5 ÷ 7,4		NPT	288