

## PE LINE



CN

### “通用” 螺纹Easythread快插接头

名为“easyThread”的螺纹设计并按Cmatic标准制造的快插式管接头。该螺纹特性使其能够适配不同螺纹标准（NPT、BSP-P、BSPT），从而显著提升操作灵活性并降低库存成本。

EN

### Easythread Push-in Fittings, "Uni" thread

Push-in fittings featured by the so called “easyThread” and made according to Cmatic Standards. This thread feature allows for connections with different threads standards (NPT, BSPP, BSPT) and leads to greater operational flexibility and inventory cost reduction.

# PE Line

1 本体 Body	2 释放环 Release ring	3 支撑环 Holding ring	4 卡爪 Gripping ring	5 保护环 Protection ring	6 密封圈 Seals
黄铜镀镍 UNI EN 12164 CW614N - UNI EN 12165 CW617N Brass UNI EN 12164 CW614N - UNI EN 12165 CW617N, nickel Plated		缩醛树脂 Acetal resin	(POM) (POM)	AISI 301 不锈钢 Stainless steel AISI 301	缩醛树脂 Acetal resin
				(POM) (POM)	NBR NBR



-20° ÷ 80°C



20 bar



-99 KPa

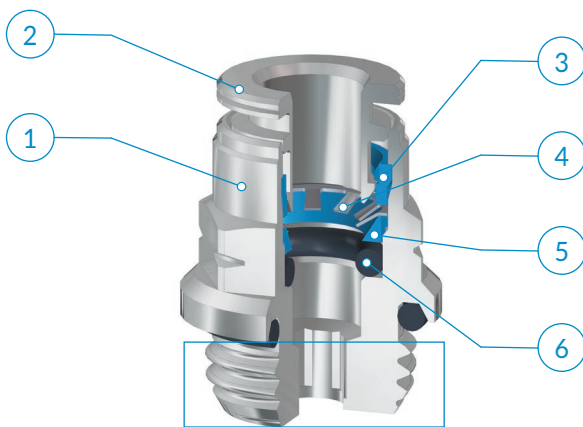

	Easy 1/8	Easy 1/4	Easy 3/8	Easy 1/2
1/4	●	●		
3/8		●	●	
1/2			●	●
6	●	●		
8		●		
10		●	●	
12			●	●

## EasyThread

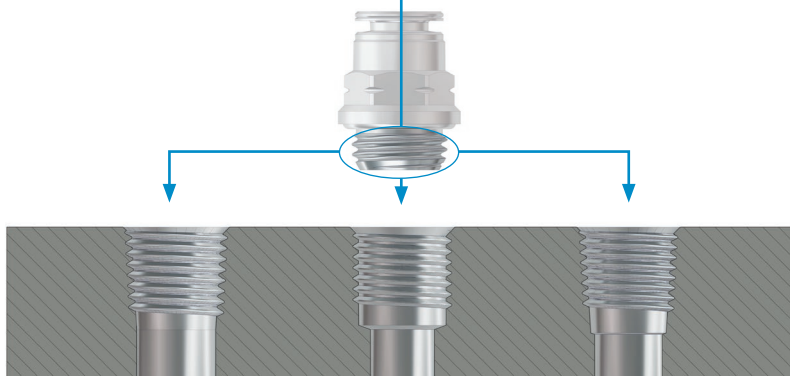

NPTF

BSPP (G)

BSPT (R)

### 建议的连接管路:

PA11、PA12、PA6、PE聚乙烯、PU聚氨酯 (98 Shore A)。

### 可接受的管路公差:

+/- 0.07 mm, 最大直径 Ø 3/8" - 10 mm  
+/- 0.1 mm Ø 1/2" - 12 mm。

### 应用领域:

气动系统。

### Recommended tubings:

PA11, PA12, PA6, Polyethylene PE, Polyurethane PU (98 Shore A).

### Acceptable Tolerances on the tubings:

+/- 0.07 mm up to Ø 3/8" - 10 mm  
+/- 0.1 mm Ø 1/2" - 12 mm.

### Application fields:

Pneumatic circuits.

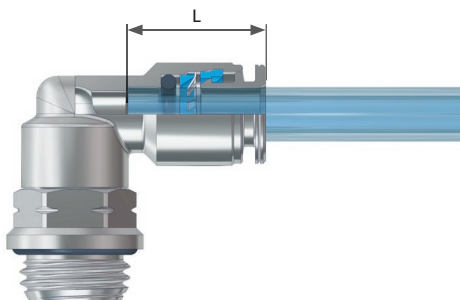

OD	L
1/4	16,1
3/8	18,3
1/2	19,5
6	16,1
8	16,2
10	18,3
12	19,5

安装说明

ASSEMBLY INSTRUCTIONS

1

沿管路垂直切割 (使用TCUT切管刀),确认内外管壁没有毛刺,同时注意避免管路截面呈椭圆形。使用金属管路连接时,需要通过专用设备 (TINC) 在管路上开槽。开槽尺寸需要考虑管路直径,以保证可靠的连接。

1

Cut the tube square (by means of a hose cutter i.e. our TCUT) making sure that no burrs are left and that the tube is not oval. In case of use with metal hoses, make a groove all around the tube diameter with a suitable tool (TINC).The groove must be made according to the tube diameter so that the fitting collect can better grip onto it.

2

将管路插入接头,到底为止。

2

Insert the tube into the fitting until it bottoms.

拔出管路:

垂直按压释放环,同时拔出管路即可。

Tube release

While pressing on the release ring, pull out the tube from the fitting

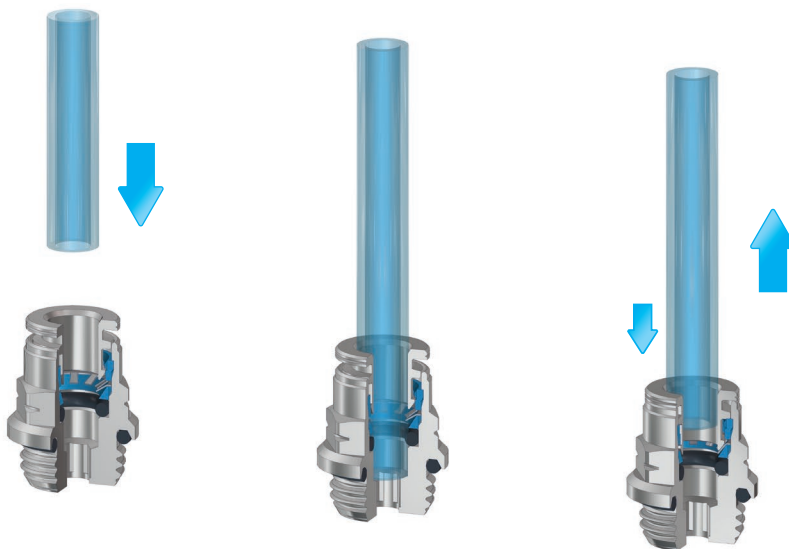

完成连接后,请确保管路上不承受外力;此外,请确保管路连接的最小弯曲半径符合本样册第376页之规定。

为了避免管路意外松脱,任何物体均不要接触释放环。作用在释放环上任何外力,包括侧向力,均可能导致管路意外松脱。螺纹拧紧时,请参考第10页列出的建议扭矩。



Once the tubing is connected to the fitting, make sure that the tubing is not subject to any tensile strength and that the min. recommended bending radius stated in the tubing section of this catalogue is complied with (see page 376).

To prevent any accidental tube release, no components have to come in touch with the release ring and exercise any unwanted pressure on the same. Indeed however lateral, any load on the release ring may cause the tube disconnection.

To tighten threads, please check out our tightening torque chart illustrated at page 10.

## PE 12

EasyThread外螺纹直管接头

"EasyThread" straight, male

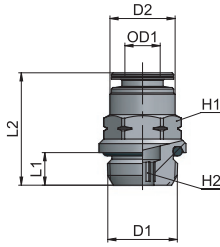

类型	OD1	D1	D2	L1	L2	H1	H2	g $\Delta$
12 1/4 1/8	1/4	Easy 1/8	12	4,5	20,5	1/2	5/32	9,4
12 1/4 1/4	1/4	Easy 1/4	12	6	20,5	1/2	5/32	12,8
12 3/8 1/4	3/8	Easy 1/4	15,7	6	26,5	5/8	1/4	19,7
12 3/8 3/8	3/8	Easy 3/8	15,7	6	25	5/8	1/4	24,1
12 1/2 3/8	1/2	Easy 3/8	20	6	28	13/16	13/32	32,2
12 1/2 1/2	1/2	Easy 1/2	20	8,5	26,5	13/16	13/32	35,6
12 06 1/8	6	Easy 1/8	11,7	4,5	19,5	12	4	9,3
12 06 1/4	6	Easy 1/4	11,7	6	19,5	12	4	12,1
12 08 1/4	8	Easy 1/4	13,7	6	21,5	14	6	14,0
12 10 1/4	10	Easy 1/4	15,8	6	27	15	8	16,1
12 10 3/8	10	Easy 3/8	15,8	6	24	16	8	20,3
12 12 3/8	12	Easy 3/8	18,8	6	27,5	19	10	27,9
12 12 1/2	12	Easy 1/2	18,8	8,5	26,5	19	10	35,2

## PE 16

"EasyThread"可调向外螺纹弯管接头

"EasyThread" swivelling elbow fitting, male

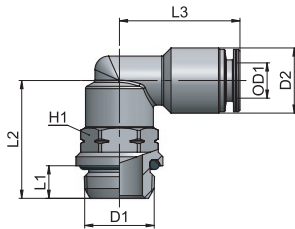

类型	OD1	D1	D2	L1	L2	L3	H1	g $\Delta$
16 1/4 1/8	1/4	Easy 1/8	12	4,5	18,2	22	1/2	18,1
16 1/4 1/4	1/4	Easy 1/4	12	6	21,7	22	1/2	20,9
16 3/8 1/4	3/8	Easy 1/4	16	6	22	26	5/8	33,4
16 3/8 3/8	3/8	Easy 3/8	16	6	25	26	5/8	38,4
16 1/2 3/8	1/2	Easy 3/8	20	6	25,5	28,5	13/16	57,8
16 1/2 1/2	1/2	Easy 1/2	20	8,5	32,5	28,5	13/16	69,5
16 06 1/8	6	Easy 1/8	12	4,5	18,2	22	1/2	18,3
16 06 1/4	6	Easy 1/4	12	6	21,7	22	1/2	21,6
16 08 1/4	8	Easy 1/4	14	6	21,5	22,5	1/2	24,8
16 10 1/4	10	Easy 1/4	16	6	22	26	5/8	31,7
16 10 3/8	10	Easy 3/8	16	6	25	26	5/8	36,7
16 12 3/8	12	Easy 3/8	19	6	25,5	28,5	13/16	56,0
16 12 1/2	12	Easy 1/2	19	8,5	32,5	28,5	13/16	69,0

## PE 21

"EasyThread"可调向外螺纹正T管接头

"EasyThread" swivelling T fitting

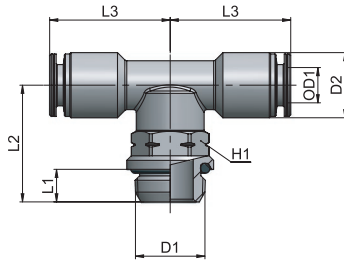

类型	OD1	D1	D2	L1	L2	L3	H1	g $\Delta$
21 1/4 1/8	1/4	Easy 1/8	12	4,5	18	22	1/2	24,3
21 1/4 1/4	1/4	Easy 1/4	12	6	21,5	22	1/2	27,2
21 3/8 1/4	3/8	Easy 1/4	16	6	22	26	5/8	46,0
21 3/8 3/8	3/8	Easy 3/8	16	6	25	26	5/8	50,6
21 1/2 3/8	1/2	Easy 3/8	20	6	25,5	28,5	13/16	75,0
21 1/2 1/2	1/2	Easy 1/2	20	8,5	32,5	28,5	13/16	86,9
21 06 1/8	6	Easy 1/8	12	4,5	18	22	1/2	24,9
21 06 1/4	6	Easy 1/4	12	6	21,5	22	1/2	27,8
21 08 1/4	8	Easy 1/4	14	6	21,5	22,5	1/2	33,4
21 10 1/4	10	Easy 1/4	16	6	22	26	5/8	43,3
21 10 3/8	10	Easy 3/8	16	6	25	26	5/8	48,6
21 12 3/8	12	Easy 3/8	19	6	25,5	28,5	13/16	74,0
21 12 1/2	12	Easy 1/2	19	8,5	32,5	28,5	13/16	86,7

## PE 24

"EasyThread"外螺纹直T型三通接头

"EasyThread" lateral run T fitting

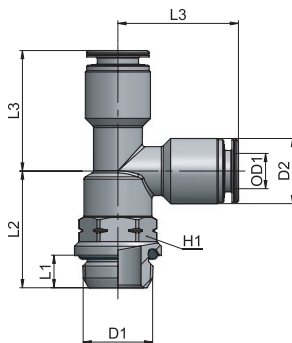

类型	OD1	D1	D2	L1	L2	L3	H1	g $\Delta$
24 1/4 1/8	1/4	Easy 1/8	12	4,5	18,2	22	1/2	25,0
24 1/4 1/4	1/4	Easy 1/4	12	6	21,7	22	1/2	27,8
24 3/8 1/4	3/8	Easy 1/4	16	6	22	26	5/8	45,2
24 3/8 3/8	3/8	Easy 3/8	16	6	25	26	5/8	50,8
24 1/2 3/8	1/2	Easy 3/8	20	6	25,5	28,5	13/16	73,2
24 1/2 1/2	1/2	Easy 1/2	20	8,5	32,5	28,5	13/16	85,0
24 06 1/8	6	Easy 1/8	12	4,5	18	22	1/2	26,1
24 06 1/4	6	Easy 1/4	12	6	21,5	22	1/2	29,2
24 08 1/4	8	Easy 1/4	14	6	21,5	22,5	1/2	33,1
24 10 1/4	10	Easy 1/4	16	6	22	26	5/8	43,5
24 10 3/8	10	Easy 3/8	16	6	25	26	5/8	48,5
24 12 3/8	12	Easy 3/8	19	6	25,5	28,5	13/16	63,1
24 12 1/2	12	Easy 1/2	19	8,5	32,5	28,5	13/16	76,0