

INCH

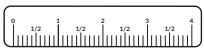

**PU LINE**



CN

**NPT快换接头**

NPT螺纹电解镀镍黄铜快换接头

EN

**NPT Couplings**

Electrolytic Nickel-plated brass quick couplings available with NPT threads.

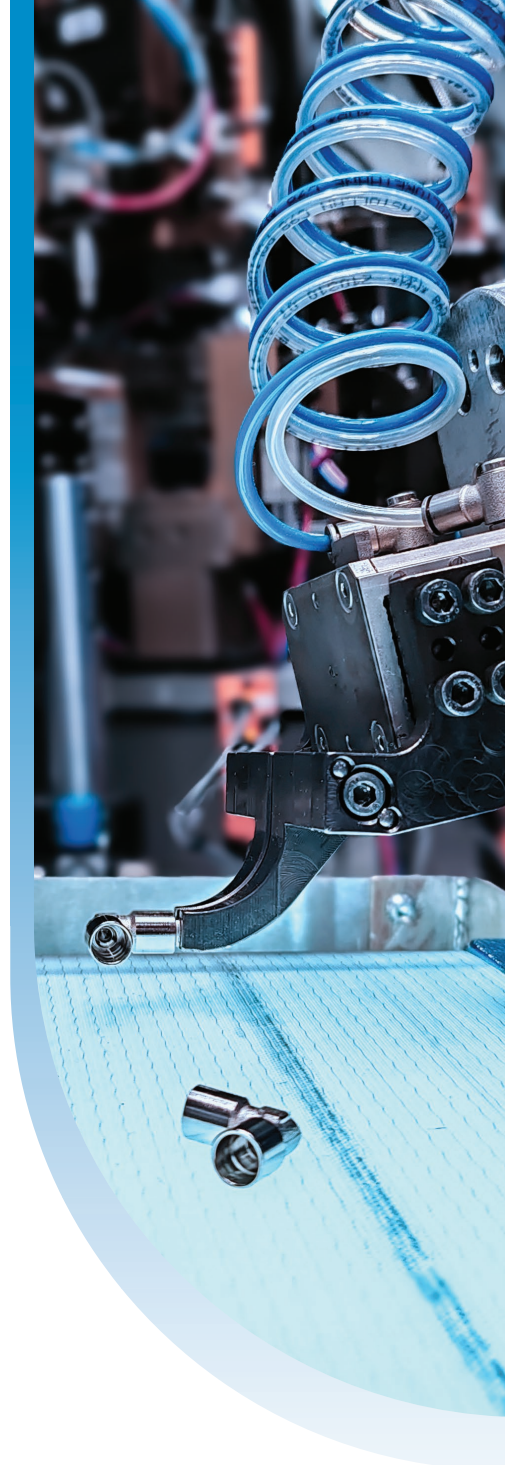

# PU 10

多插座快换接头

Multi socket quick coupling

1 本体  
Body

黄铜镀镍 UNI EN 12164 CW614N  
Brass UNI EN 12164 CW614N, nickel plated

2 滚珠  
Balls

AISI 420 不锈钢  
Stainless steel AISI 420

3 密封圈  
Seals

NBR  
NBR

4 弹簧  
Springs

AISI 302 不锈钢  
Stainless steel AISI 302



-20° ÷ 80°C





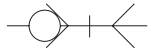
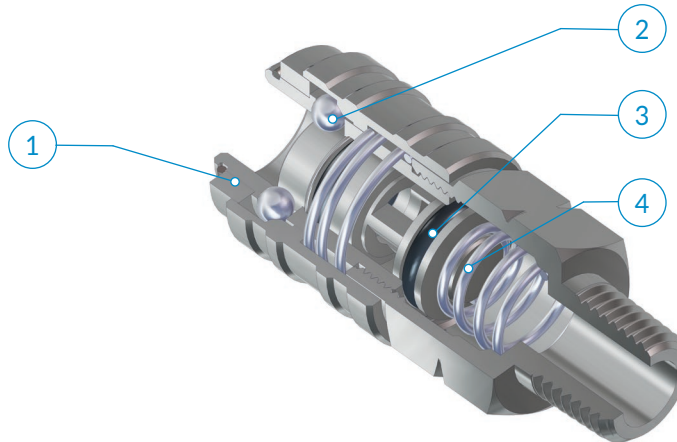

15 bar

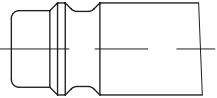
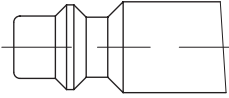
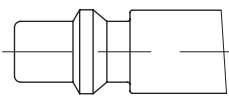

应用领域：  
气动系统。

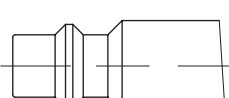
Application fields:  
Pneumatic circuits

适用以下插头体外形 Suitable with following plugs profiles		流量 Flow rate
		NI/min (6 bar - Δp = 1bar)
	欧洲标准外形 European Profile	820
	ISO 6150 B标准外形 ISO 6150 B Profile	715
	瑞典标准外形 Standard Swedisch Profile	725
	意大利标准外形 Standard Italian Profile	670
	MIL C4109标准外形 MIL C4109 Profile	715
	ARO 210标准外形 ARO 210 Profile	705

比例尺 1:1 - Scale 1:1

PU 10-11

外螺纹接头体

Male coupling

类型	D1	D2	L1	L2	H1	g $\Delta$
11 00 1/4	1/4 NPTF	23,5	13	56,5	20	90,9
11 00 3/8	3/8 NPTF	23,5	13	56,5	20	99,3
11 00 1/2	1/2 NPTF	23,5	17	59,5	24	129,2

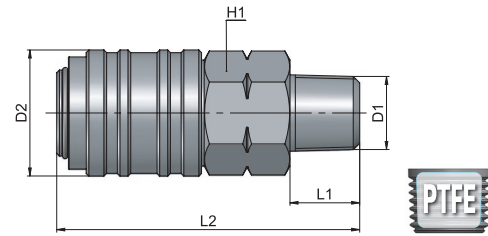

PU 10-12

内螺纹接头体

Female coupling

类型	D1	D2	L1	L2	H1	g $\Delta$
12 00 1/4	1/4 NPTF	23,5	12,5	58,5	20	113
12 00 3/8	3/8 NPTF	23,5	12,5	58,5	20	104
12 00 1/2	1/2 NPTF	23,5	13,5	62	24	140,5

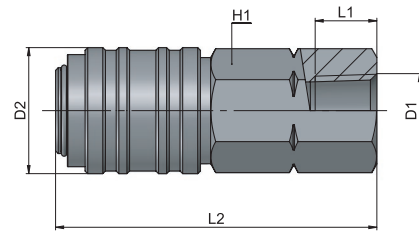

AP	55
AR	63
AV	221
CO	157
CX	255
EV	217
GU	119
GU Safety	135
GX	281
GX Safety	291
HP	317
MA	27
MB	41
MC	83
MF	235
MM	333
MO	93
MP	323
MT	339
MV	171
MX	241
MY	229
OX	261
PA	113
PE	79
PM	329
PN	67
PT	347
PU	131
PU Safety	149
PUX	287
PV	203
PVX	311
PX	249
QO	363
RA	101
RF	269
RT	355
RX	275
Tools	369
Tubings	375
VF	295
VT	359
VX	299

类型

Profiles



页码 ref.

类型	Profiles				页码 ref.
<b>GU41</b>	ISO 6150 C-10	5,5		BSP	136
<b>GU42</b>	ISO 6150 B-12 US MIL4109	5,5		BSP	138
<b>PU42</b>	ISO 6150 B-12 US MIL4109	5,5		NPT	150
<b>GU43</b>	ISO 6150 C-14	8		BSP	140
<b>GU44</b>	ISO 6150 B-15	8		BSP	142
<b>PU44</b>	ISO 6150 B-15	8		NPT	152
<b>GU45</b>	ARO 210	5,5		BSP	144
<b>PU45</b>	ARO 210	5,5		NPT	154
<b>GU46</b>	European Profile	7,4		BSP	146
<b>GX46</b> 不锈钢	European Profile	7,4		BSP	292