

cmatic[®]
PNEUMATIC FITTINGS

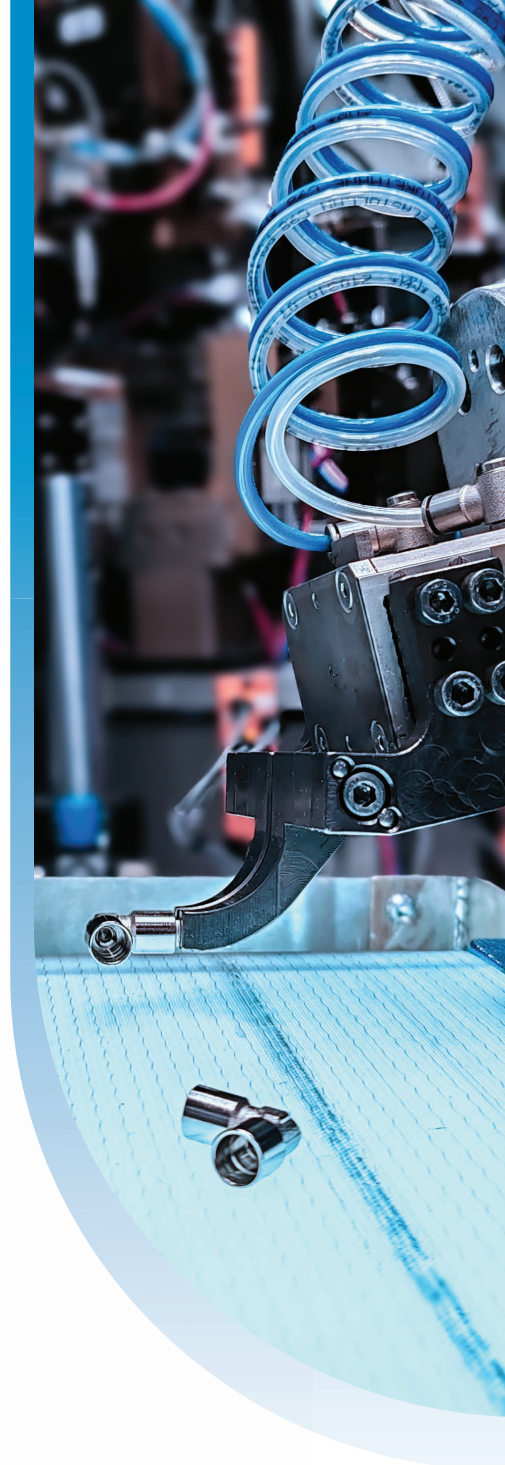

INCH

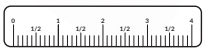

PU Safety



CN

NPT安全型快换接头

符合ISO4414的NPT螺纹安全型快换接头

EN

Safety Couplings, NPT

Safety quick couplings compliant with ISO 4414-C available with NPT threads.

PU 42

安全型按钮式快换接头，ISO 6150 B-12外形

Push-button safety coupling according to ISO 6150 B-12

1 本体 Body	2 按钮、阀芯和排气环 Button, valve and venting ring	3 螺纹 Thread	4 弹簧 Springs	5 滚珠 Balls	6 密封圈 Seals	i 插头体 Plugs
阳极氧化铝 Al2011 Anodized aluminium Al2011	硬化镀锌钢 11SMnPb37 Hardened, zinc plated steel 11SMnPb37	黄铜镀镍 UNI EN 12164 CW614N Brass UNI EN 12164 CW614N nickel plated	AISI 302 不锈钢 Stainless steel AISI 302	AISI 420 不锈钢 Stainless steel AISI 420	NBR NBR	硬化镀锌钢 11SMnPb37 Hardened, zinc plated steel 11SMnPb37



-20° ± 80°C



16 bar



5,5 mm



780 NI/min
(6 bar - Δp = 1bar)

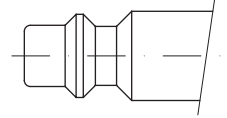
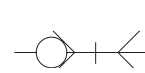

INDUSTRIAL Profile
MIL C4109 Profile
ISO 6150 B-12 Profile

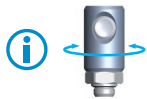
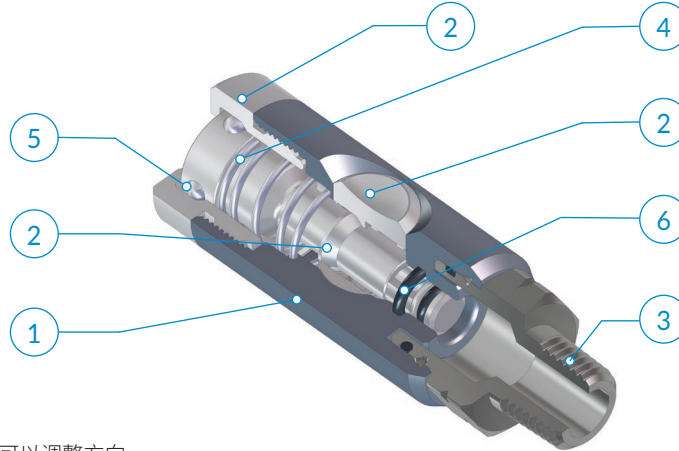

快换接头在安装后依然可以调整方向。
The Coupling will remain swivelling after installation

应用领域：
气动系统

Application fields:
Pneumatic circuits

i 连接 - 断开

将插头体插入接头体

断开连接，需依照以下指导步骤：
插头体已经插入接头体

1

按压按钮，排出下游回路中的空气，此时，插头体依旧锁定接头体

2

再次按压按钮，完成插头体的分离。

CONNECTION - RELEASE

Insert the plug into the Coupling.

To disconnect the plug follow instructions below:
Plug inserted in Coupling.

1

Press the button once to vent the downstream air from the circuit; at this time the plug is still captive in the Coupling.

2

Press the button one more time to release the plug.

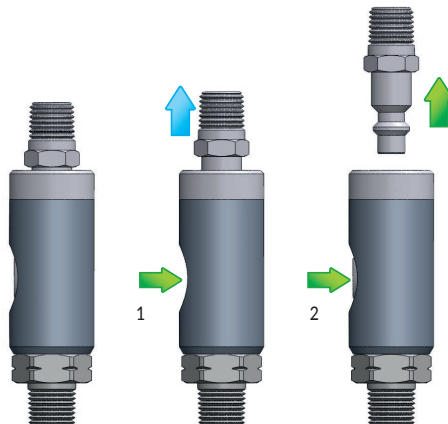

PU 42-11

外螺纹接头体

Male coupling

类型	D1	D2	L1	L2	H1	g 
11 00 14	1/4 NPTF	25	13	75,5	21	110,1
11 00 38	3/8 NPTF	25	13	74,5	21	120,3
11 00 12	1/2 NPTF	25	17	78,5	22	141,6

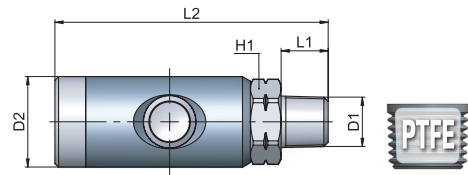

PU 42-12

内螺纹接头体

Female coupling

类型	D1	D2	L1	L2	H1	g 
12 00 14	1/4 NPTF	25	12	76,5	21	127,6
12 00 38	3/8 NPTF	25	12,5	77	21	118,0
12 00 12	1/2 NPTF	25	13,5	79	24	140,0

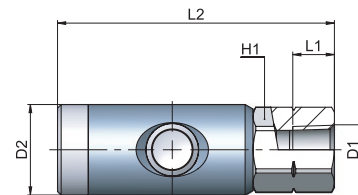

PU 42-20

外螺纹插头体

Male plug

类型	D1	L1	H1	g 
20 00 14	1/4 NPTF	42	14	22,6
20 00 38	3/8 NPTF	42	18	28,9
20 00 12	1/2 NPTF	47	22	43,1

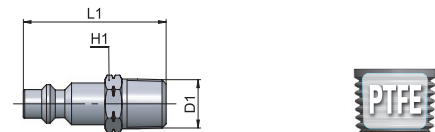

PU 42-21

内螺纹插头体

Female plug

类型	D1	L1	H1	g 
21 00 14	1/4 NPTF	40	17	28,1
21 00 38	3/8 NPTF	40	20	31,6
21 00 12	1/2 NPTF	44	24	50,0

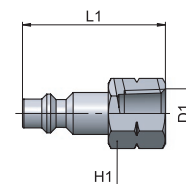

- AP 55
- AR 63
- AV 221
- CO 157
- CX 255
- EV 217
- GU 119
- GU Safety 135
- GX 281
- GX Safety 291
- HP 317
- MA 27
- MB 41
- MC 83
- MF 235
- MM 333
- MO 93
- MP 323
- MT 339
- MV 171
- MX 241
- MY 229
- OX 261
- PA 113
- PE 79
- PM 329
- PN 67
- PT 347
- PU 131
- PU Safety 149
- PUX 287
- PV 203
- PVX 311
- PX 249
- QO 363
- RA 101
- RF 269
- RT 355
- RX 275
- Tools 369
- Tubings 375
- VF 295
- VT 359
- VX 299

PU 44

安全型按钮式快换接头符合ISO6150 B-15

Push-Button safety coupling according to ISO 6150 B-15

- | | | | | | | |
|---|---|--|---|---|--|--|
| <p>1 本体
Body</p> <p>阳极氧化铝 Al2011
Anodized aluminium Al2011</p> | <p>2 按钮、阀芯和排气环
Button, valve and venting ring</p> <p>硬化镀锌钢 11SMnPb37
Hardened, zinc plated steel 11SMnPb37</p> | <p>3 螺纹
Thread</p> <p>黄铜镀镍 UNI EN 12164 CW614N
Brass UNI EN 12164 CW614N, nickel plated</p> | <p>4 弹簧
Springs</p> <p>AISI 302 不锈钢
Stainless steel AISI 302</p> | <p>5 滚珠
Balls</p> <p>AISI 420 不锈钢
Stainless steel AISI 420</p> | <p>6 密封圈
Seals</p> <p>NBR
NBR</p> | <p>i 插头体
Plugs</p> <p>硬化镀锌钢 11SMnPb37
Hardened, zinc plated steel 11SMnPb37</p> |
|---|---|--|---|---|--|--|



-20° ÷ 80°C



12 bar



8 mm



1650 NI/min
(6 bar - Δp = 1bar)

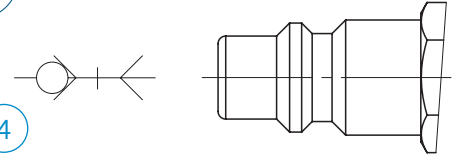

ISO 6150 B-15外形
ISO 6150 B-15 Profile

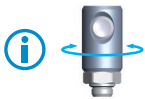
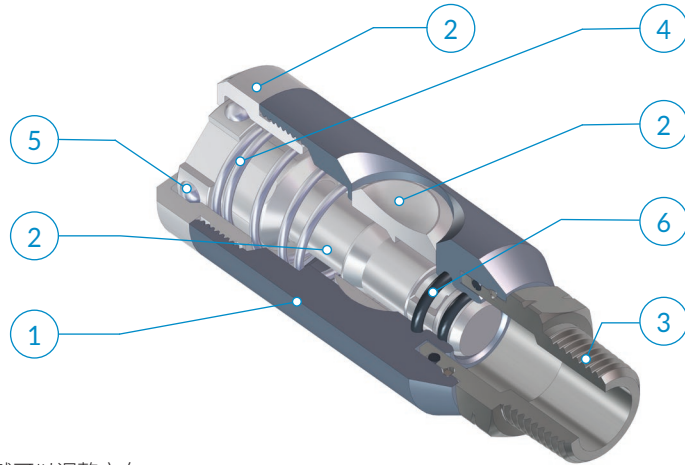

快换接头在安装后依然可以调整方向。
The Coupling will remain swivelling after installation

应用领域：
气动系统

Application fields:
Pneumatic circuits

i 连接 - 断开

将插头体插入接头体

断开连接，需依照以下指导步骤：
插头体已经插入接头体

1

按压按钮，排出下游回路中的空气，此时，插头体依旧锁定接头体

2

再次按压按钮，完成插头体的分离。

CONNECTION - RELEASE

Insert the plug into the Coupling.

To disconnect the plug follow instructions below:
Plug inserted in Coupling.

1

Press the button once to vent the downstream air from the circuit; at this time the plug is still captive in the Coupling.

2

Press the button one more time to release the plug.

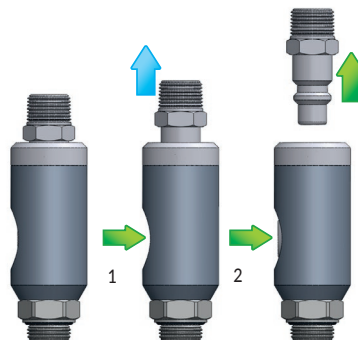

PU 44-11

外螺纹接头体

Male coupling

类型	D1	D2	L1	L2	H1	g 
11 00 38	3/8 NPTF	29	13	80,2	21	153,0
11 00 12	1/2 NPTF	29	17	84,2	22	-

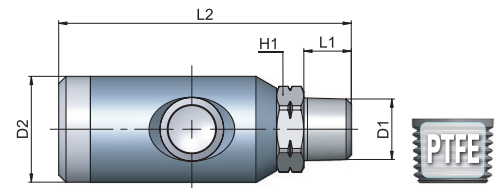

PU 44-12

内螺纹接头体

Female coupling

类型	D1	D2	L1	L2	H1	g 
12 00 38	3/8 NPTF	29	12,5	82,7	21	168,5
12 00 12	1/2 NPTF	29	13,5	84,7	24	-

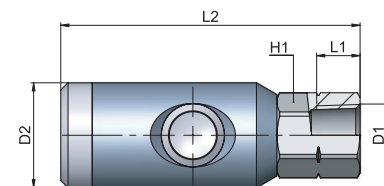

PU 44-20

外螺纹插头体

Male plug

类型	D1	L1	H1	g 
20 00 38	3/8 NPTF	44,5	18	35,2
20 00 12	1/2 NPTF	49,5	22	50,6

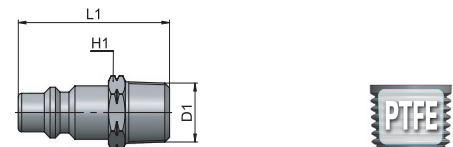

PU 44-21

内螺纹插头体

Female plug

类型	D1	L1	H1	g 
21 00 38	3/8 NPTF	42,5	20	37,5
21 00 12	1/2 NPTF	46,5	22	55,3

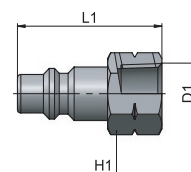

AP	55
AR	63
AV	221
CO	157
CX	255
EV	217
GU	119
GU Safety	135
GX	281
GX Safety	291
HP	317
MA	27
MB	41
MC	83
MF	235
MM	333
MO	93
MP	323
MT	339
MV	171
MX	241
MY	229
OX	261
PA	113
PE	79
PM	329
PN	67
PT	347
PU	131
PU Safety	149
PUX	287
PV	203
PVX	311
PX	249
QO	363
RA	101
RF	269
RT	355
RX	275
Tools	369
Tubings	375
VF	295
VT	359
VX	299

PU 45

安全型按钮式快换接头符合 ARO210

Push-button safety coupling according to ARO 210

- | | | | | | | |
|---|---|---|---|---|--|--|
| <p>1 本体
Body</p> <p>阳极氧化铝 Al2011
Anodized aluminium Al2011</p> | <p>2 按钮、阀芯和排气环
Button, valve and venting ring</p> <p>硬化镀锌钢 11SMnPb37
Hardened, zinc plated steel 11SMnPb37</p> | <p>3 螺纹
Thread</p> <p>黄铜镀镍 UNI EN 12164 CW614N
Brass UNI EN 12164 CW614N nickel plated</p> | <p>4 弹簧
Springs</p> <p>AISI 302 不锈钢
Stainless steel AISI 302</p> | <p>5 滚珠
Balls</p> <p>AISI 420 不锈钢
Stainless steel AISI 420</p> | <p>6 密封圈
Seals</p> <p>NBR
NBR</p> | <p>i 插头体
Plugs</p> <p>硬化镀锌钢 11SMnPb37
Nickel plated steel 11SMnPb37</p> |
|---|---|---|---|---|--|--|



-20° ÷ 80°C



12 bar



5,5 mm



1080 NI/min
(6 bar - Δp = 1bar)

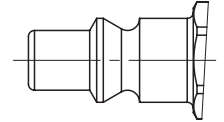

ARO 210外形
ARO 210 Profile

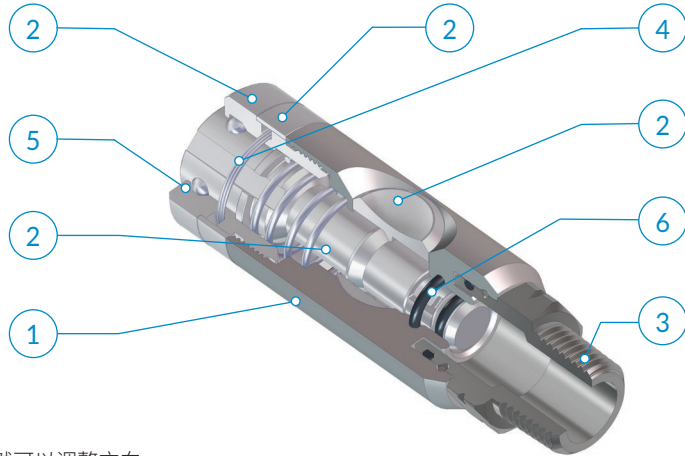

快换接头在安装后依然可以调整方向。
The Coupling will remain swivelling after installation

应用领域：
气动系统

Application fields:
Pneumatic circuits

i 连接 - 断开

CONNECTION - RELEASE

将插头体插入接头体

Insert the plug into the Coupling.

断开连接，需依照以下指导步骤：
插头体已经插入接头体

To disconnect the plug follow instructions below:
Plug inserted in Coupling.

1

按压按钮，排出下游回路中的空气，此时，插头体依旧锁定接头体

1

Press the button once to vent the downstream air from the circuit; at this time the plug is still captive in the Coupling.

2

再次按压按钮，完成插头体的分离。

2

Press the button one more time to release the plug.

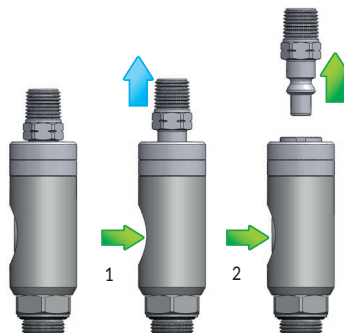

PU 45-11

外螺纹接头体

Male coupling

类型	D1	D2	L1	L2	H1	g Δ
11 00 14	1/4 NPTF	26	13	80,8	21	145,9
11 00 38	3/8 NPTF	26	13	79,8	21	146,4
11 00 12	1/2 NPTF	26	17	83,8	22	167,4

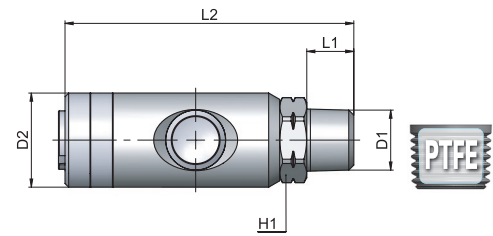

PU 45-12

内螺纹接头体

Female coupling

类型	D1	D2	L1	L2	H1	g Δ
12 00 14	1/4 NPTF	26	9	81,8	21	169,1
12 00 38	3/8 NPTF	26	10	82,3	21	160,9
12 00 12	1/2 NPTF	26	11	84,3	24	173,0

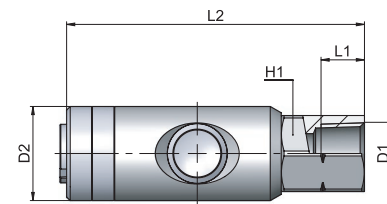

PU 45-20

外螺纹插头体

Male plug

类型	D1	L1	H1	g Δ
20 00 14	1/4 NPTF	40,8	14	20,0
20 00 38	3/8 NPTF	40,8	18	26,7
20 00 12	1/2 NPTF	45,8	22	42,2

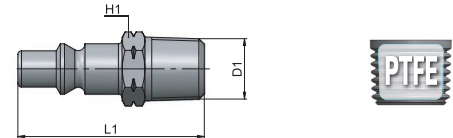

PU 45-21

内螺纹插头体

Female plug

类型	D1	L1	H1	g Δ
21 00 14	1/4 NPTF	38,8	17	26,2
21 00 38	3/8 NPTF	38,8	20	29,4
21 00 12	1/2 NPTF	42,8	24	46,0

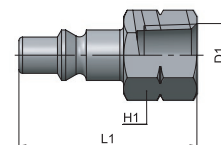

AP	55
AR	63
AV	221
CO	157
CX	255
EV	217
GU	119
GU Safety	135
GX	281
GX Safety	291
HP	317
MA	27
MB	41
MC	83
MF	235
MM	333
MO	93
MP	323
MT	339
MV	171
MX	241
MY	229
OX	261
PA	113
PE	79
PM	329
PN	67
PT	347
PU	131
PU Safety	149
PUX	287
PV	203
PVX	311
PX	249
QO	363
RA	101
RF	269
RT	355
RX	275
Tools	369
Tubings	375
VF	295
VT	359
VX	299



CE



cmatic