

**cmatic**<sup>®</sup>  
PNEUMATIC FITTINGS

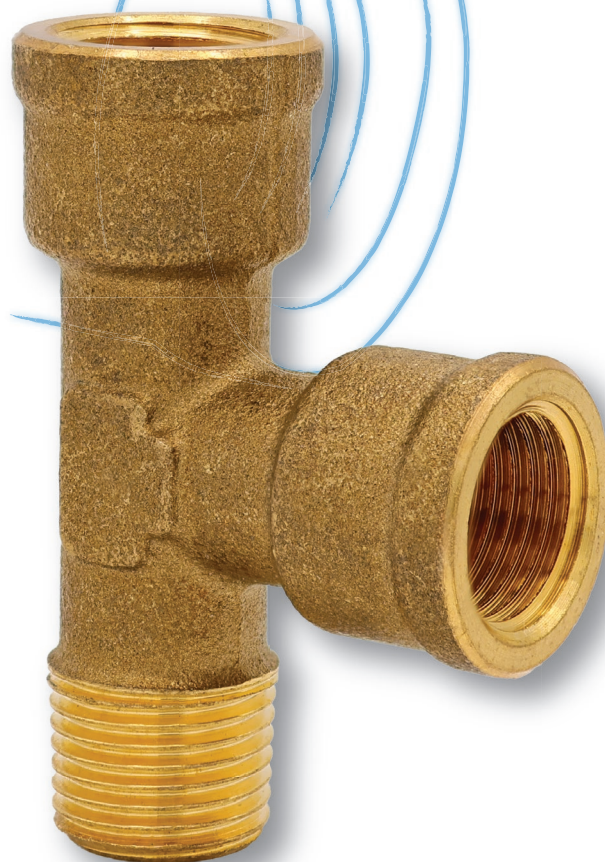

**RF LINE**



CN

EN

### 食品和饮料应用领域标准接头

RF系列管接头配件采用低铅黄铜制造(铅含量<0.1%),通过NSF/ANSI 169认证,可安全接触水、茶及咖啡等饮品,这使其成为咖啡设备与自动售卖机行业的理想解决方案。该系列产品同时符合NSF/ANSI 372标准对与饮用水接触黄铜材料的最大含铅量要求(铅含量<0.1%),满足美国《安全饮用水法案》规定,并全面符合ROHS III指令环保标准。

### Standard Fittings for Food and Beverage Applications

The RF fittings are accessories made of low lead brass (Pb <0.1%) and they are NSF/ANSI169 certified for contact with water, tea and coffee. This makes the RF line The Right Solution for the coffee and vending machines industry. The RF fitting also boasts the NSF/ANSI 372 brass compliance with the maximum lead content standards (Pb<0.1%) allowed for contact with drinking water (U.S. Safe Drinking Water Act). RF fittings are meeting the ROHS III Directive.

# RF Line

1 本体  
Body

黄铜 EN 12164 CW510L 符合 NSF/ANSI 372  
Brass EN12164 CW510L compliant NSF/ANSI 372



-40° ÷ 150°C



60 bar

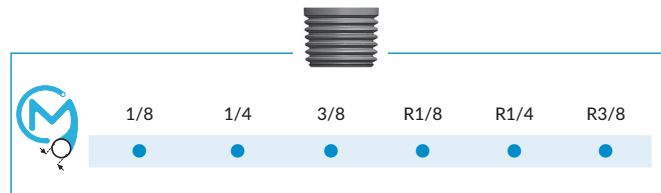
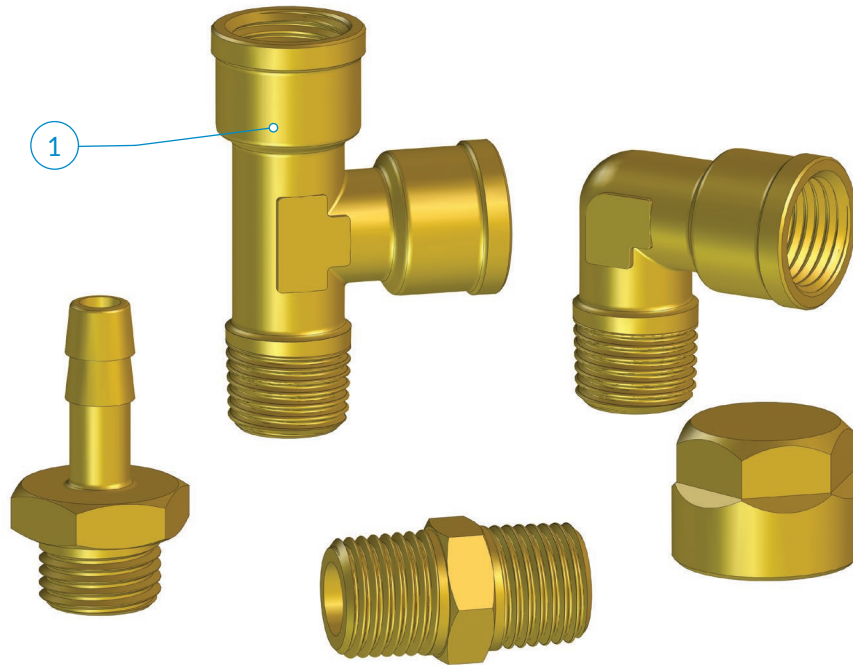

应用领域：  
食品和饮料领域应用。

Application fields:  
Food and Beverage Applications

RF 12

锥螺纹转接头

Nipple, taper

类型	D1	D2	L1	L2	L3	H1	g $\Delta$
12 18 18	R1/8	R1/8	7,5	7,5	19,5	12	8,2
12 18 14	R1/8	R1/4	7,5	11	23,5	14	14,1
12 14 14	R1/4	R1/4	11	11	27	14	17,3
12 14 38	R1/4	R3/8	11	11,5	27,5	17	21,1
12 38 38	R3/8	R3/8	11,5	11,5	28	17	23,3

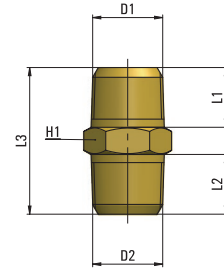

RF 13

内螺纹转接头

Joint piece

类型	D1	L1	H1	g $\Delta$
13 00 18	G1/8	15	14	10,4
13 00 14	G1/4	22	17	18,8
13 00 38	G3/8	23	20	21,4

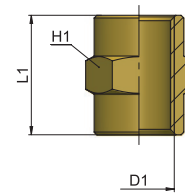

RF 14

内外螺纹减径接头

Taper female-male reducing connector

类型	D1	D2	L1	L2	H1	g $\Delta$
14 18 14	G1/8	R1/4	11	16	14	10,5
14 18 38	G1/8	R3/8	11,5	16,5	17	20,0
14 14 38	G1/4	R3/8	11,5	16,5	17	12,8

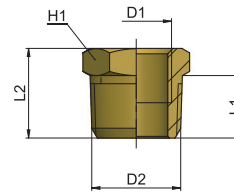

RF 16

内外螺纹转接头

Adaptor male-female, taper

类型	D1	D2	L1	L2	H1	g $\Delta$
16 18 18	R1/8	G1/8	7,5	17,5	12	10,7
16 18 14	R1/8	G1/4	7,5	21	17	16,9
16 14 14	R1/4	G1/4	11	24,5	17	20,4
16 14 38	R1/4	G3/8	11	25,5	20	23,9
16 38 38	R3/8	G3/8	11,5	26	20	28,2

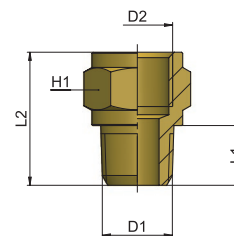

AP 55  
AR 63  
AV 221  
CO 157  
CX 255  
EV 217  
GU 119  
GU Safety 135  
GX 281  
GX Safety 291  
HP 317  
MA 27  
MB 41  
MC 83  
MF 235  
MM 333  
MO 93  
MP 323  
MT 339  
MV 171  
MX 241  
MY 229  
OX 261  
PA 113  
PE 79  
PM 329  
PN 67  
PT 347  
PU 131  
PU Safety 149  
PUX 287  
PV 203  
PVX 311  
PX 249  
QO 363  
RA 101  
RF 269  
RT 355  
RX 275  
Tools 369  
Tubings 375  
VF 295  
VT 359  
VX 299

## RF 19

直螺纹堵头

Parallel plug

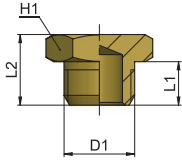

类型	D1	L1	L2	H1	g
19 00 18	G1/8	6	10	14	7,3
19 00 14	G1/4	8	13	17	13,3
19 00 38	G3/8	9	14	20	19,8

## RF 20

内螺纹堵头

Female plug

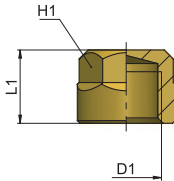

类型	D1	L1	H1	g
20 00 18	G1/8	10	14	6,5
20 00 14	G1/4	13,5	15	19,8
20 00 38	G3/8	14	19	17,6

## RF 21

内螺纹直角转接头

Female elbow

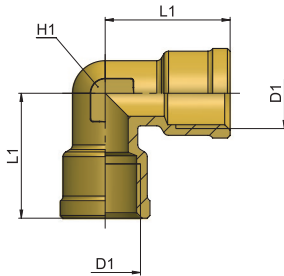

类型	D1	L1	H1	g
21 18 18	G1/8	18,5	10	14,7
21 14 14	G1/4	22,5	12	24,9
21 38 38	G3/8	25,5	15	42,3

## RF 22

内外螺纹直角转接头

Male-female elbow

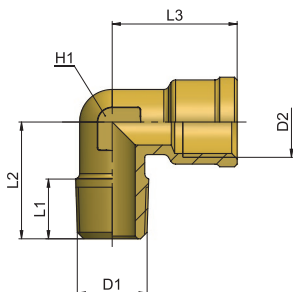

类型	D1	D2	L1	L2	L3	H1	g
22 18 18	R1/8	G1/8	8,2	17	18,5	10	12,3
22 14 14	R1/4	G1/4	11	21,5	22,5	12	22,6
22 38 38	R3/8	G3/8	12	24,5	25,5	15	39,4

RF 23

内螺正T型转接头

Female T

类型	D1	L1	H1	g 
23 18 18	G1/8	18,5	10	21,0
23 14 14	G1/4	22,5	12	35,5
23 38 38	G3/8	25,5	15	59,8

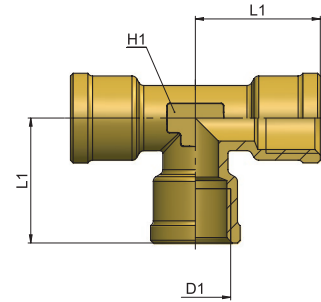

RF 24

内外螺纹正T型转接头

Female-male-female T

类型	D1	D2	L1	L2	L3	H1	g 
24 18 18	R1/8	G1/8	8,2	17	18,5	10	18,9
24 14 14	R1/4	G1/4	11	21,5	22,5	12	33,1
24 38 38	R3/8	G3/8	12	24,5	25,5	15	57,2

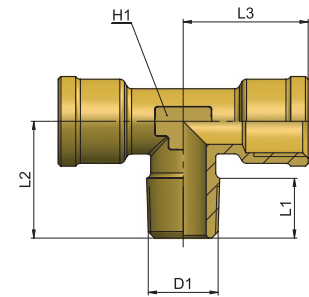

RF 25

内外螺纹直T型转接头

Male-female- female T

类型	D1	D2	L1	L2	L3	L4	H1	g 
25 18 18	G1/8	R1/8	8,2	17	18,5	35,5	10	18,8
25 14 14	G1/4	R1/4	11	21,5	22,5	44	12	32,9
25 38 38	G3/8	R3/8	12	24,5	25,5	50	15	57,3

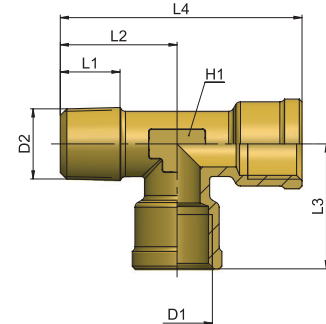

RF 30

宝塔接头

Hose connector

类型	OD1	D1	D2	L1	L2	L3	H1	g 
30 6,5 18	6	6,5	G1/8	6	20	30	14	9,7
30 6,5 14	6	6,5	G1/4	8	20	33	17	15,8

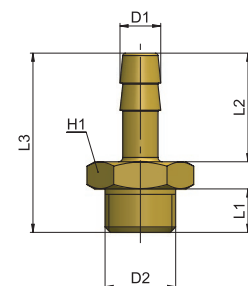

AP 55  
AR 63  
AV 221  
CO 157  
CX 255  
EV 217  
GU 119  
GU Safety 135  
GX 281  
GX Safety 291  
HP 317  
MA 27  
MB 41  
MC 83  
MF 235  
MM 333  
MO 93  
MP 323  
MT 339  
MV 171  
MX 241  
MY 229  
OX 261  
PA 113  
PE 79  
PM 329  
PN 67  
PT 347  
PU 131  
PU Safety 149  
PUX 287  
PV 203  
PVX 311  
PX 249  
QO 363  
RA 101  
RF 269  
RT 355  
RX 275  
Tools 369  
Tubings 375  
VF 295  
VT 359  
VX 299

## RF 35

外螺纹弯头

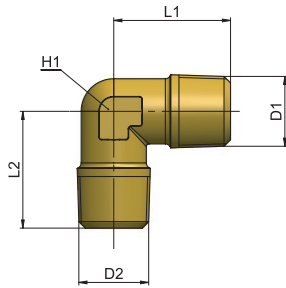

Male-male elbow

类型	D1	D2	L1	L2	H1	g $\Delta$
35 18 18	R1/8	R1/8	17	17	10	10,3
35 18 14	R1/8	R1/4	19	21,5	12	19,6
35 14 14	R1/4	R1/4	21,5	21,5	12	20,6
35 14 38	R1/4	R3/8	23	24,5	15	34,0
35 38 38	R3/8	R3/8	24,5	24,5	15	36,0

## RF 36

外螺纹正T型转接头

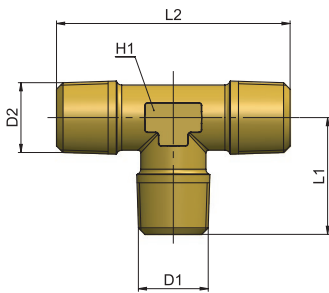

Male T

类型	D1	D2	L1	L2	H1	g $\Delta$
36 18 18	R1/8	R1/8	17	34	10	14,4
36 14 14	R1/4	R1/4	21,5	43	12	28,5
36 38 38	R3/8	R3/8	24,5	49	15	50,2

## RF 45

内外螺纹正T型转接头

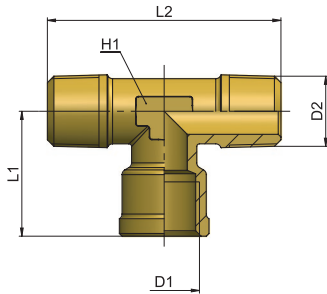

Male-female-male T

类型	D1	D2	L1	L2	H1	g $\Delta$
45 18 18	G1/8	R1/8	18,5	34	10	16,7
45 14 14	G1/4	R1/4	22,5	43	12	30,8
45 38 38	G3/8	R3/8	25,5	49	15	53,3

## RF 47

内外螺纹直T型转接头

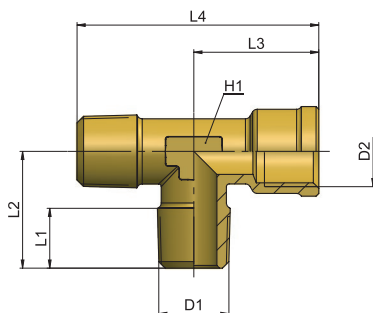

Male-male-female T

类型	D1	D2	L1	L2	L3	L4	H1	g $\Delta$
47 18 18	R1/8	G1/8	8,2	17	18,5	35,5	10	16,6
47 14 14	R1/4	G1/4	11	21,5	22,5	44	12	30,5
47 38 38	R3/8	G3/8	12	24,5	25,5	50	15	53,4