

VX LINE



IT

316L 不锈钢功能接头

VX 系列功能接头是对 SS316L 全系列产品的补充

EN

316L Stainless Steel Function Fittings

The VX function fittings line complements all our SS316L product offer.

流量调节阀可用于控制气动回路中的流量。根据采用的调节阀类型, 可实现双向流量调节 (双向流量控制阀) 或单向调节 (单向流量控制阀)。单向流量控制阀尤其适用于调节气缸的运行速度。

They can adjust the flow in a pneumatic circuit. Depending on the flow control used, the setting can be made both ways (Bidirectional Flow Control), or just one way (Unidirectional Flow Control). The Unidirectional Flow Control is particularly used to adjust the speed of pneumatic cylinders.

i 流量调节范围

Possible Flow Adjustments

.../O = 排气节流
Meter out flow control

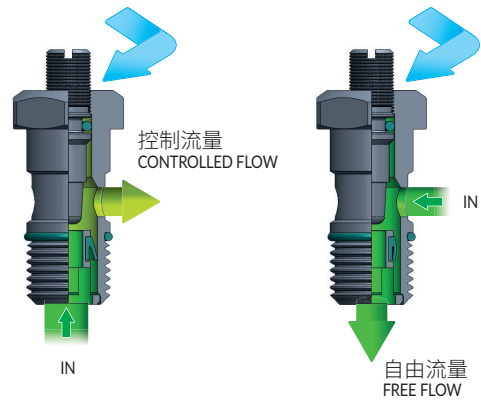

.../I = 进气节流
Meter in flow control

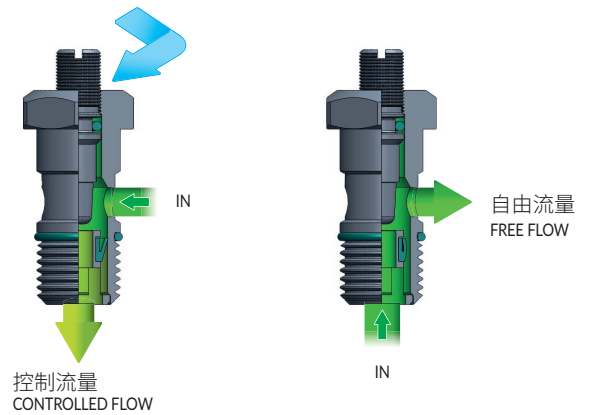

.../B = 双向流量调节
Bidirectional flow control

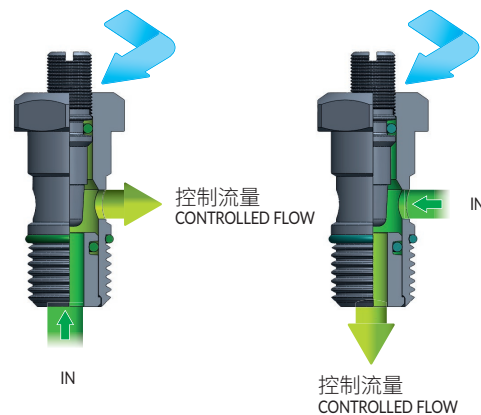

VX 15

VX
LINE

节流阀

Flow control

- 1 本体
Body
- 2 阀针
Needle
- 3 插装阀芯
Cartridge

316L (1.4404) 不锈钢
Stainless steel AISI 316L (1.4404)

- 4 密封圈
Seals

满足FDA规范的FPM
FPM, FDA compliant

- 5 垫圈
Gasket

PTFE
PTFE



-20° ÷ 150°C



10 bar

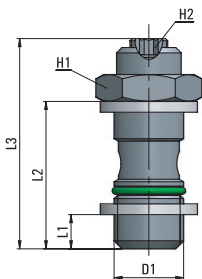
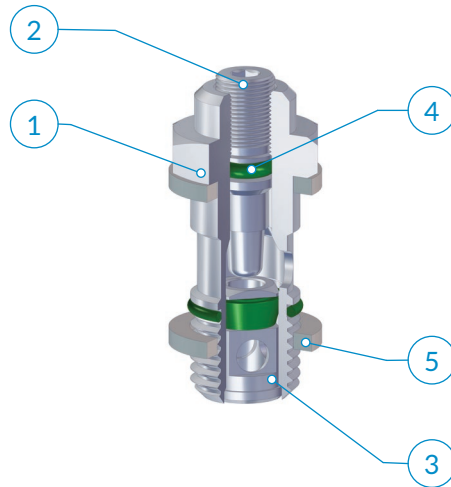

类型	D1	L1	L2	L3 max	H1	H2	g Δ
15 00 18	G1/8	5,1	22,1	32,9	14	2,5	18,3
15 00 14	G1/4	6,4	27,4	41,8	17	3	34,5

可用版本:
Available as:

.../O



.../I



.../B



建议的连接管路:
取决于与节流阀相连的接头类型。

Recommended tubings:
According to the fitting connected to the flow control.

应用领域:
空气经过过滤和润滑处理的气动系统。

Application field:
Pneumatic installations fed with filtered, lubricated air.

- AP 55
- AR 63
- AV 221
- CO 157
- CX 255
- EV 217
- GU 119
- GU Safety 135
- GX 281
- GX Safety 291
- HP 317
- MA 27
- MB 41
- MC 83
- MF 235
- MM 333
- MO 93
- MP 323
- MT 339
- MV 171
- MX 241
- MY 229
- OX 261
- PA 113
- PE 79
- PM 329
- PN 67
- PT 347
- PU 131
- PU Safety 149
- PUX 287
- PV 203
- PVX 311
- PX 249
- QO 363
- RA 101
- RF 269
- RT 355
- RX 275
- Tools 369
- Tubings 375
- VF 295
- VT 359
- VX 299

VX 18

可调节流阀

Flow Control with swivelling push-in fitting

- 1 本体
Body
- 2 阀针
Needle
- 3 插装阀芯
Cartridge

316L (1.4404) 不锈钢
Stainless steel AISI 316L (1.4404)

- 4 密封圈
Seals

满足FDA规范的FPM
FPM, FDA compliant

- 5 MX快插接头
MX line push-in fittings



-20° ÷ 150°C



10 bar

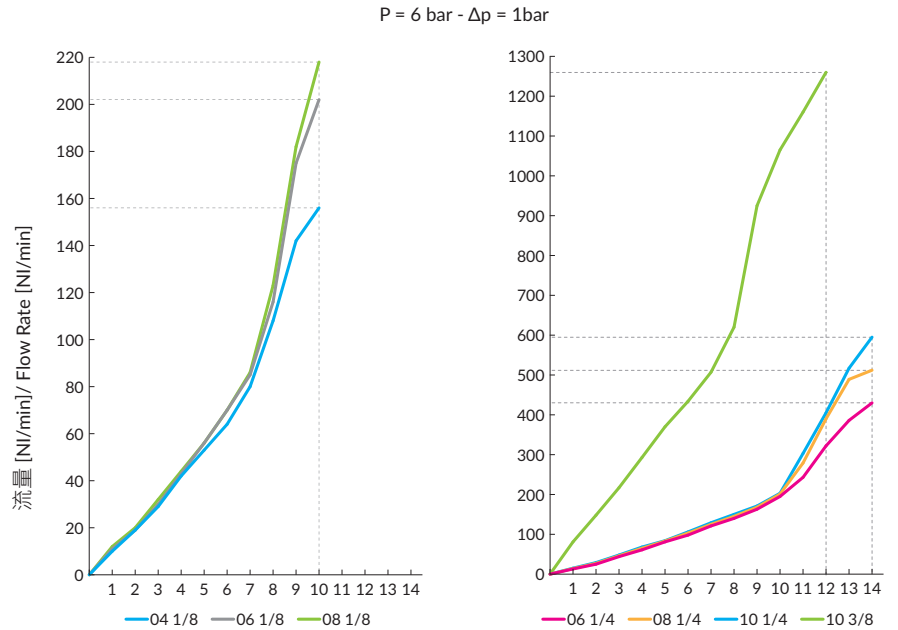
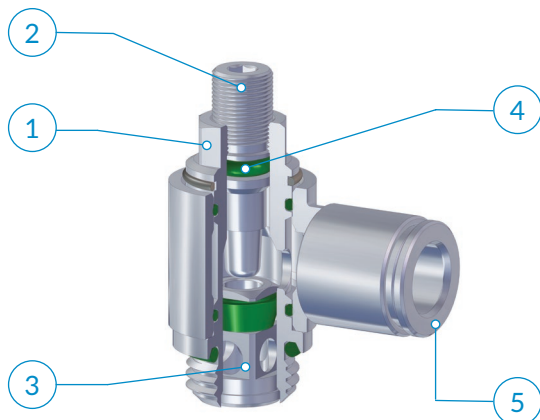

调节针圈数 / N° of needle turns



流量控制装置安装完成后, 铰接接头本体部分仍可自由转动。
The banjo ring swivels also after flow control installation.

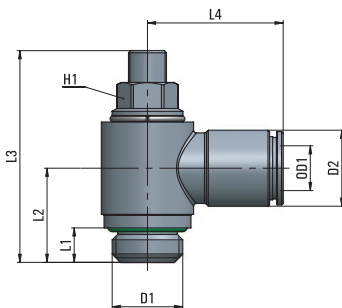

类型	OD1	D1	D2	L1	L2	L3 max	L4	H1	g Δ
18 04 18	4	G1/8	9	5,1	15	32,9	20,5	9	26,0
18 06 18	6	G1/8	12	5,1	15	32,9	22,5	9	28,8
18 06 14	6	G1/4	12	6,4	17,4	39	24	10	43,1
18 08 18	8	G1/8	14	5,1	15	32,9	23	9	29,5
18 08 14	8	G1/4	14	6,4	17,4	39	25	10	45,4
18 10 14	10	G1/4	16	6,4	17,4	39	27	10	47,0
18 10 38	10	G3/8	16	7	20	50	26	14	85,2

可用版本:
Available as:

.../O



.../I



.../B



建议的连接管路:
PVDF管, PTFE管。

Recommended tubings:
PVDF and PTFE tubings.

应用领域:
空气经过过滤和润滑处理的气动系统。

Application field:
Pneumatic installations fed with filtered, lubricated air.

线型节流阀

In-line flow control

- 1 本体
Body
- 2 针阀
Needle valve
- 3 旋钮
Handwheel
- 4 阀针
Needle
- 5 螺母
Nut
- 6 密封圈
Seals

316L (1.4404) 不锈钢
Stainless steel AISI 316L (1.4404)

满足FDA规范的FPM
FPM compliant with FDA



-20° ÷ 150°C



10 bar

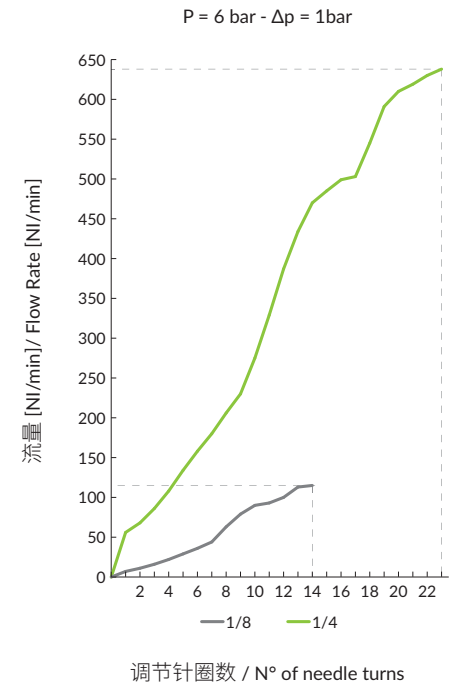
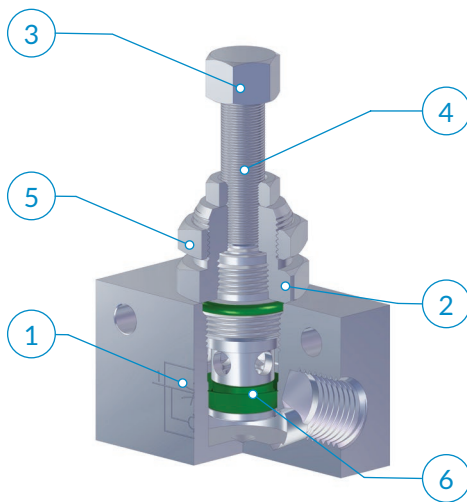

类型	D1	D2	D3	L1	L2 max	L3	L4	L5	L6	H1	g ΔΔ
21 00 18	G1/8	4,5	M12x0,75	20	51,6	34	24	7,5	15	14	72,5
21 00 14	G1/4	5,4	M18x1	30	74,6	50	35	12	25	21	281,4

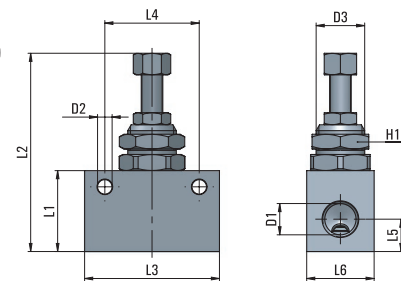

可用版本:
Available as:

.../U =



.../B



建议的连接管路:
取决于与节流阀相连的接头类型。

Recommended tubings:
According to the fitting connected to the flow control.

应用领域:
空气经过过滤和润滑处理的气动系统。

Application field:
Pneumatic installations fed with filtered, lubricated air.

- AP 55
- AR 63
- AV 221
- CO 157
- CX 255
- EV 217
- GU 119
- GU Safety 135
- GX 281
- GX Safety 291
- HP 317
- MA 27
- MB 41
- MC 83
- MF 235
- MM 333
- MO 93
- MP 323
- MT 339
- MV 171
- MX 241
- MY 229
- OX 261
- PA 113
- PE 79
- PM 329
- PN 67
- PT 347
- PU 131
- PU Safety 149
- PUX 287
- PV 203
- PVX 311
- PX 249
- QO 363
- RA 101
- RF 269
- RT 355
- RX 275
- Tools 369
- Tubings 375
- VF 295
- VT 359
- VX 299

VX 22

不锈钢快排阀

Stainless steel quick exhaust valve

1 本体
Body
316L (1.4404) 不锈钢
Stainless steel AISI 316L (1.4404)

2 消声器
Muffler
AISI 316 不锈钢
Stainless steel AISI 316

3 挡圈
Seeger
AISI 302 不锈钢
Stainless steel AISI 302

4 密封圈
Seals
FPM
FPM



-20° ÷ 150°C



2:10 bar

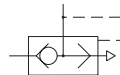
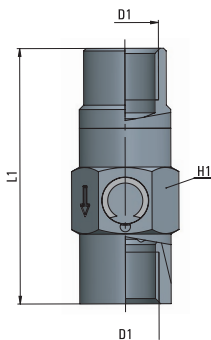
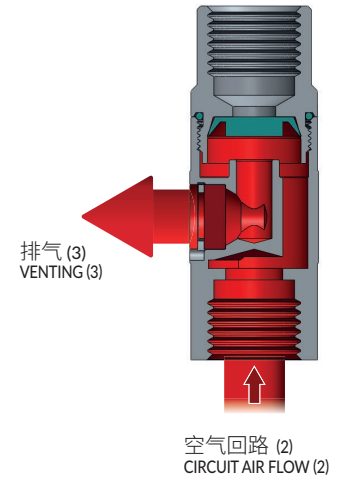
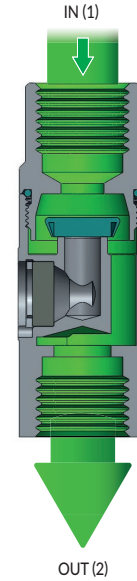
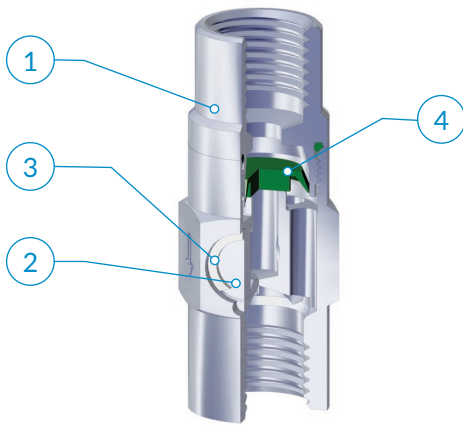

6 bar时流量
Flow rate at 6 bar

	IN OUT 1→2	OUT VENT 2→3
1/4	1050 NI/min	660 NI/min
3/8	3000 NI/min	1900 NI/min
1/2	3420 NI/min	2280 NI/min

类型	D1	L1	H1	g
22 00 14	G1/4	49,5	18	51,5
22 00 38	G3/8	60,5	27	133,1
22 00 12	G1/2	68,5	35	257,0

i 断开供应时阀门能够迅速排出回路中空气;如果用于气缸,则可提高速度。

建议的连接管路:
取决于与节流阀相连的接头类型。

应用领域:
空气经过过滤和润滑处理的气动系统。

i This valve can easily vent the circuit in case of an air supply failure. If assembled on the cylinder port, it increases the cylinder speed.

Recommended tubings:
According to the fitting connected to the flow control.

Application field:
Pneumatic installations fed with filtered, lubricated air.

单向阀

Check valve

- 1 本体
Body
- 2 阀芯
Valve

316L (1.4404) 不锈钢
Stainless steel AISI 316L (1.4404)

- 3 密封圈
Seals

满足FDA规范的FPM
FPM compliant with FDA

- 4 弹簧
Spring

AISI 302 不锈钢
Stainless steel AISI 302



-20° ÷ 150°C



2÷10 bar



0,2 bar

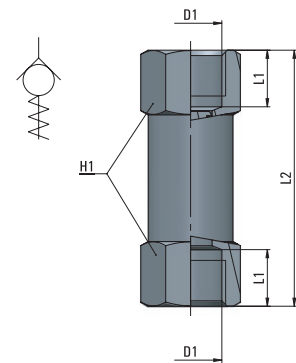
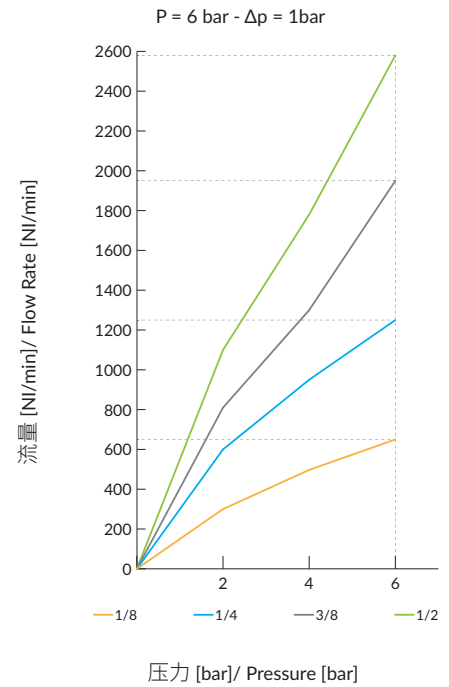
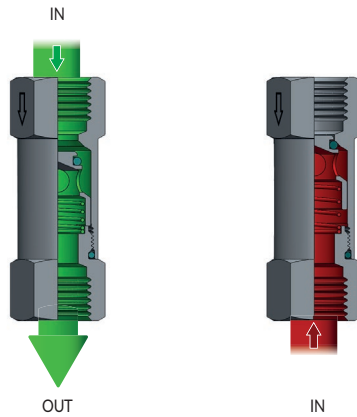
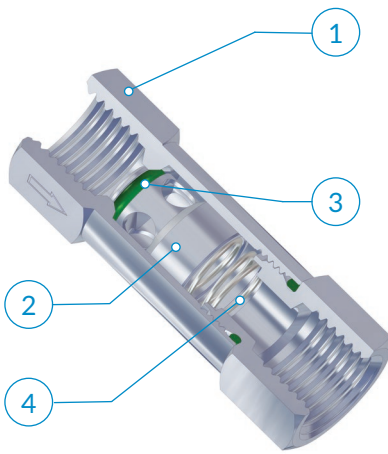

类型	D1	L1	L2	H1	g
23 00 18	G1/8	8	39,7	13	26,0
23 00 14	G1/4	8,5	47,5	16	38,1
23 00 38	G3/8	10,5	51	21	76,1
23 00 12	G1/2	12,5	62	24	111,4



i 流体仅允许单向通过 (沿着阀体上箭头方向), 反向截止。

i The flow is allowed only in one way (the arrow direction engraved on the body) and stopped in the reverse way.

建议的连接管路:
取决于与节流阀相连的接头类型。

Recommended tubings:
According to the fitting connected to the flow control.

应用领域:
空气经过过滤和润滑处理的气动系统。

Application field:
Pneumatic installations fed with filtered, lubricated air.

- AP 55
- AR 63
- AV 221
- CO 157
- CX 255
- EV 217
- GU 119
- GU Safety 135
- GX 281
- GX Safety 291
- HP 317
- MA 27
- MB 41
- MC 83
- MF 235
- MM 333
- MO 93
- MP 323
- MT 339
- MV 171
- MX 241
- MY 229
- OX 261
- PA 113
- PE 79
- PM 329
- PN 67
- PT 347
- PU 131
- PU Safety 149
- PUX 287
- PV 203
- PVX 311
- PX 249
- QO 363
- RA 101
- RF 269
- RT 355
- RX 275
- Tools 369
- Tubings 375
- VF 295
- VT 359
- VX 299

VX 24-25

手动两通球阀

2 way manual valve

- 1 本体
Body
- 2 手柄
Handle

316L (1.4404) 不锈钢
Stainless steel AISI 316L (1.4404)

- 3 垫圈
Gasket

PTFE
PTFE

- 4 密封圈
Seals

满足FDA规范的FPM
FPM compliant with FDA



-20° ÷ 150°C



10 bar



1/8	6 mm
1/4	6 mm
3/8	8 mm
1/2	10 mm

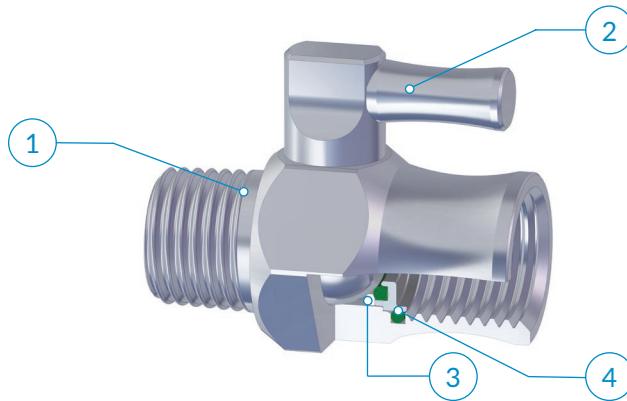

VX 24

双通手动阀，内螺纹-内螺纹

2 way manual valve, female

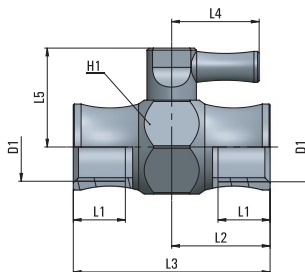

类型	D1	L1	L2	L3	L4	L5	H1	g Δ
24 00 18	G1/8	8	19	37,8	17	19	18	54,0
24 00 14	G1/4	9	19	37,8	17	19	18	43,4
24 00 38	G3/8	10	24,5	39	24,5	26	22	67,0
24 00 12	G1/2	11	28,5	45,5	24,5	28	26	132,5

VX 25

双通手动阀，外螺纹-内螺纹

2 way manual valve, male-female

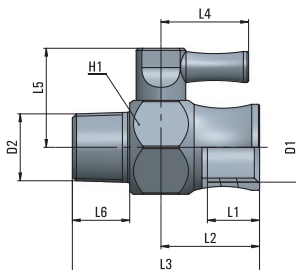

类型	D1	D2	L1	L2	L3	L4	L5	L6	H1	g Δ
25 00 18	G1/8	R1/8	8	19	32,8	17	19	7,5	18	46,4
25 00 14	G1/4	R1/4	9	19	35,9	17	19	11	18	41,5
25 00 38	G3/8	R3/8	10	24,5	37,3	24,5	26	11,5	22	85,7
25 00 12	G1/2	R1/2	11	28,5	43,1	24,5	28	14	26	90,1

VX 33-T

VX
LINE

单向阀

Check valve

- 1 本体
Body
- 2 阀芯
Valve

316L (1.4404) 不锈钢
Stainless steel AISI 316L (1.4404)

- 3 密封圈
Seals

满足FDA规范的FPM
FPM compliant with FDA

- 4 弹簧
Spring

AISI 302 不锈钢
Stainless steel AISI 302

- 5 MX快插接头
MX line push-in fittings



-20° ± 150°C



2 ± 10 bar



0,2 bar

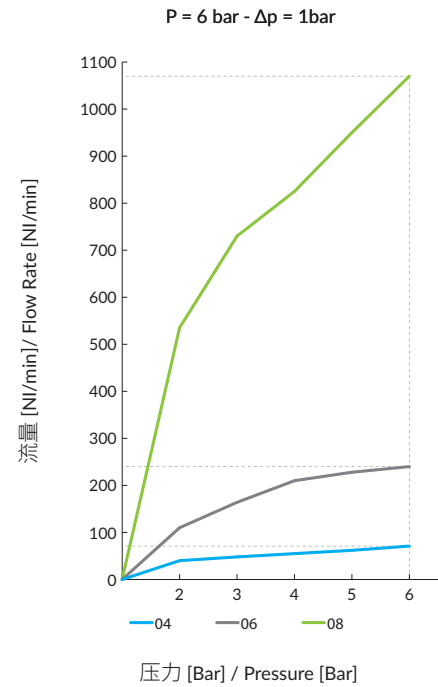
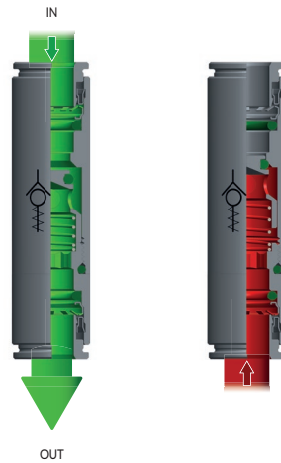

类型	OD1	D2	L1	g
33 04 04 T	4	9	43	-
33 06 06 T	6	12	52	-
33 08 08 T	8	14	53	-

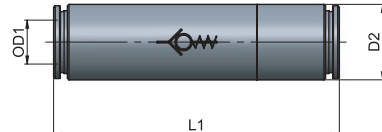

i 流体仅允许单向通过 (沿着阀体上箭头方向), 反向截止。

i The flow is allowed only in one way (the arrow direction engraved on the body) and stopped in the reverse way.

建议的连接管路:
取决于与节流阀相连的接头类型。

Recommended tubings:
According to the fitting connected to the flow control.

应用领域:
空气经过过滤和润滑处理的气动系统。

Application field:
Pneumatic installations fed with filtered, lubricated air.

- AP 55
- AR 63
- AV 221
- CO 157
- CX 255
- EV 217
- GU 119
- GU Safety 135
- GX 281
- GX Safety 291
- HP 317
- MA 27
- MB 41
- MC 83
- MF 235
- MM 333
- MO 93
- MP 323
- MT 339
- MV 171
- MX 241
- MY 229
- OX 261
- PA 113
- PE 79
- PM 329
- PN 67
- PT 347
- PU 131
- PU Safety 149
- PUX 287
- PV 203
- PVX 311
- PX 249
- QO 363
- RA 101
- RF 269
- RT 355
- RX 275
- Tools 369
- Tubings 375
- VF 295
- VT 359
- VX 299

VX 45

先导式单向阀

Pilot operated check valve

- | | | | | |
|---|--|--|---|--|
| <p>1 本体
Body</p> <p>316L (1.4404) 不锈钢
Stainless steel AISI 316L (1.4404)</p> | <p>2 活塞
Piston</p> <p>AISI 304 不锈钢
Stainless steel AISI 304</p> | <p>3 弹簧
Spring</p> <p>AISI 302 不锈钢
Stainless steel AISI 302</p> | <p>4 密封圈
Seals</p> <p>满足FDA规范的FPM
FPM compliant with FDA</p> | <p>5 垫圈
Gasket</p> <p>PTFE
PTFE</p> |
|---|--|--|---|--|



-20° ÷ 150°C



10 bar

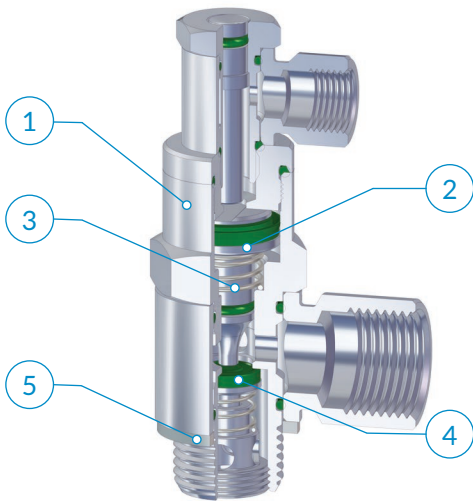

先导压力 - Pilot pressure P [bar]

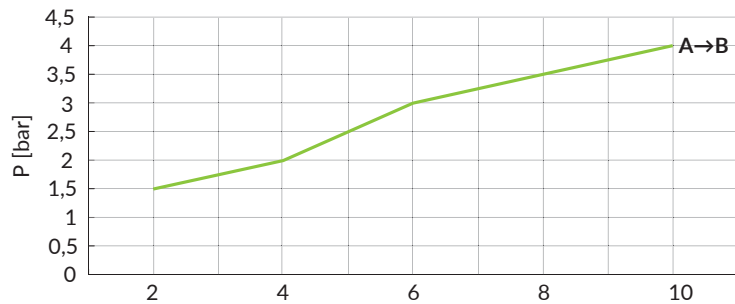

供应压强 - Inlet pressure [bar]

流量 - Flow capacity [Nl/min] 6 bar - Δp1

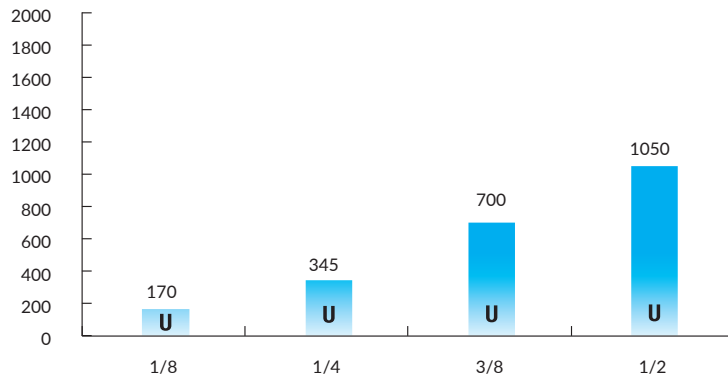

i 先导式单向阀 如果成对安装在缸上,当控制压力突然下降时,则能确保气缸活塞快速停止。通过解锁装置,可以手动重置活塞行程,这在调整阶段或供气出现不足时特别有用。

i Should a sudden pressure failure happen, if the stop valves are assembled in pairs on the cylinder, the stop valves make sure, that the cylinder piston rapidly stops. By operating the override device, it is possible to reset manually the piston stroke, which is particularly important during a set-up phase or in case of air shortage.

建议的连接管路:
取决于与阀相连的接头类型。

Recommended tubings:
According to the fitting connected to the flow control.

应用领域:
空气经过过滤和润滑处理的气动系统。

Application field:
Pneumatic installations fed with filtered, lubricated air.

/U = 单向阀 - One Way

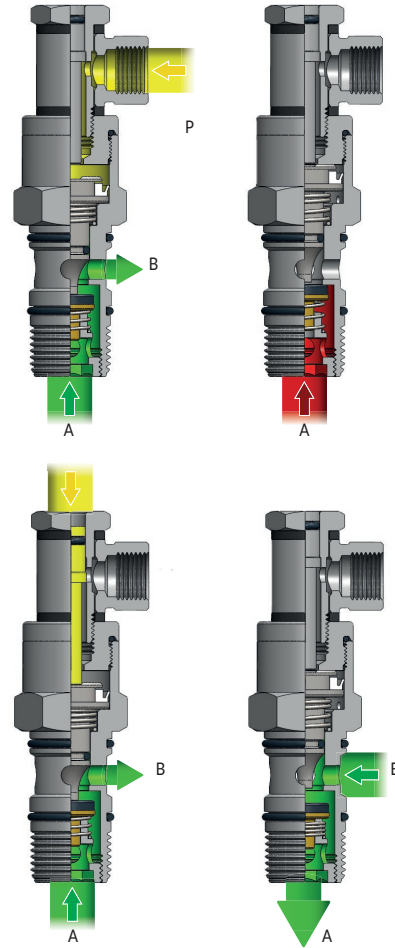
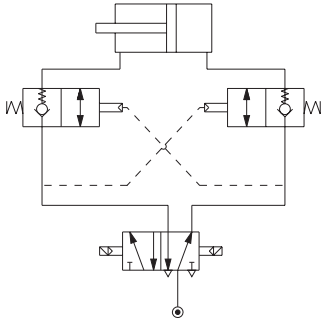

类型	D1	D2	D3	L1	L2	L3	L4	H1	H2	g	△
45 18 18 RX /U + K	G1/8	G1/8	M5x0,8	6	15,5	42	20,5	13	8	55,1	
45 14 14 RX /U + K	G1/4	G1/4	M5x0,8	8	18,5	46,5	20,5	17	8	85,2	
45 38 38 RX /U + K	G3/8	G3/8	G1/8	9	21	53,5	19	21	14	142,2	
45 12 12 RX /U + K	G1/2	G1/2	G1/8	10,5	24,5	61,5	19	25	14	222,6	

可用版本:
Available as:

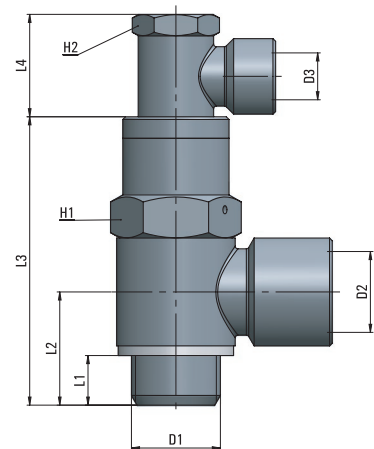
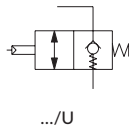

- AP 55
- AR 63
- AV 221
- CO 157
- CX 255
- EV 217
- GU 119
- GU Safety 135
- GX 281
- GX Safety 291
- HP 317
- MA 27
- MB 41
- MC 83
- MF 235
- MM 333
- MO 93
- MP 323
- MT 339
- MV 171
- MX 241
- MY 229
- OX 261
- PA 113
- PE 79
- PM 329
- PN 67
- PT 347
- PU 131
- PU Safety 149
- PUX 287
- PV 203
- PVX 311
- PX 249
- QO 363
- RA 101
- RF 269
- RT 355
- RX 275
- Tools 369
- Tubings 375
- VF 295
- VT 359
- VX 299

VX 11

消声器

Air mufflers

	本体 Body	消声器 Muffler		
VX11	AISI 304不锈钢 Stainless steel AISI 304	AISI 304不锈钢 Stainless steel AISI 304	0 ÷ 12 bar	-20°C ÷ 150°C

VX 11

不锈钢消音器

Air muffler with stainless steel wire

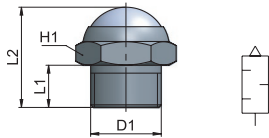

类型	D1	L1	L2	H1	g 
11 00 18	G1/8	6	15	13	5,5
11 00 14	G1/4	8	18	16	10,0
11 00 38	G3/8	8	19	19	14,6
11 00 12	G1/2	9	22	24	21,5