

MA LINE



Push-in Fittings

The push-in fittings of the MA line are completely made of brass and they are suitable for quick connections in different industrial applications; they are robust, compact and guarantee high performances in time.

All MA fittings are electrolytic nickel-plated.

MA Line

All size are in millimeters 

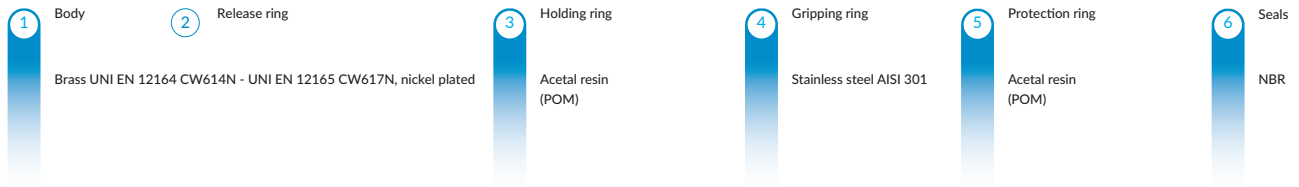

-4° ÷ 176°F



Max 290 PSI



-29" Hg

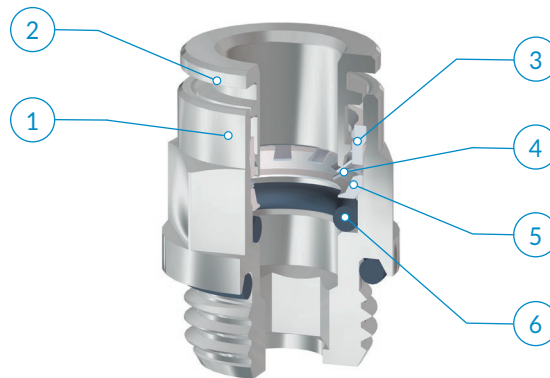

for "R" threads

	M3x0,5	M5x0,8	M6x1	M7x1	M12x1,25	M12x1,5	G1/8	G1/4	G3/8	G1/2	G3/4	R1/8	R1/4	R3/8	R1/2	
3	•	•														
4		•	•	•			•	•					•	•		
6		•	•	•	•	•	•	•	•	•		•	•	•	•	
8							•	•	•	•		•	•	•	•	•
10							•	•	•	•		•	•	•	•	•
12								•	•	•			•	•	•	•
14									•	•				•	•	•
16										•	•					•

Recommended tubings:
PA11, PA12, PA6, Polyethylene PE,
Polyurethane PU (98 Shore A)

Acceptable Tolerances on the tubings:
+/- 0,07 mm up to Ø 10 mm
+/- 0,1 mm from Ø 12 up to Ø 16 mm

Application fields:
Pneumatic circuits

 Tubing insertion depth

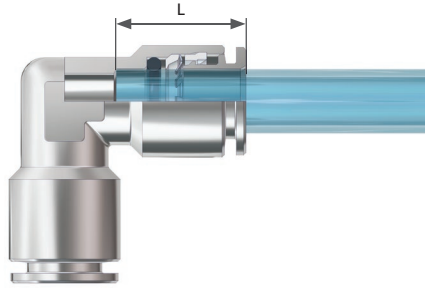

OD	L
3	9,8
4	13,2
6	16,1
8	16,2
10	18,3
12	19,5
14	22,5
16	22,5

 ASSEMBLY INSTRUCTIONS

1

Cut the tube square (by means of a hose cutter i.e. our TCUT) making sure that no burrs are left and that the tube is not oval.

In case of use with metal hoses, make a groove all around the tube diameter with a suitable tool (TINC). The groove must be made according to the tube diameter so that the fitting collect can better grip onto it.

2

Insert the tube into the fitting until it bottoms.

Tube release

While pressing on the release ring, pull out the tube from the fitting.

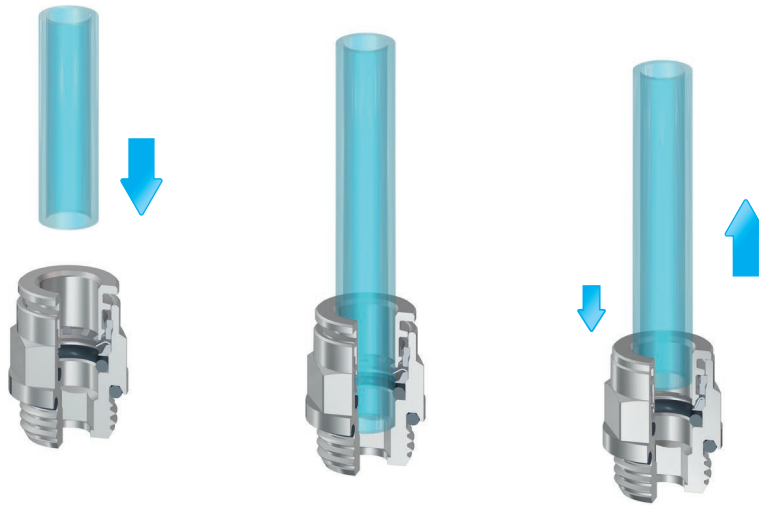

Once the tubing is connected to the fitting, make sure that the tubing is not subject to any tensile strength and that the min. Recommended bending radius stated in the tubing section of this catalogue is complied with (see page 136).

To prevent any accidental tube release, no components have to come in touch with the release ring and exercise any unwanted pressure on the same. Indeed however lateral, any load on the release ring may cause the tube disconnection.

To tighten threads, please check out our tightening torque chart illustrated at page 6.

MA 11

Taper straight, male

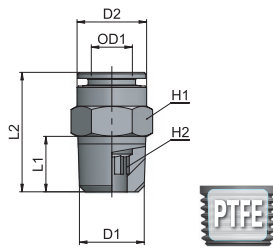

Type	OD1	D1	D2	L1	L2	H1	H2	g Δ
11 04 18	4	R1/8	9	7,5	16	10	3	6,0
11 04 14	4	R1/4	9	11	20,5	14	3	16,1
11 06 18	6	R1/8	11,9	7,5	21	12	4	9,3
11 06 14	6	R1/4	11,9	11	20,5	14	4	14,1
11 06 38	6	R3/8	11,9	11,5	21	17	4	25,5
11 08 18	8	R1/8	13,9	7,5	25	14	6	13,6
11 08 14	8	R1/4	13,9	11	23,5	14	6	14,3
11 08 38	8	R3/8	13,9	11,5	22,5	17	6	24,0
11 08 12	8	R1/2	13,9	14	25	22	6	50,3
11 10 18	10	R1/8	15,9	7,5	28	16	6	19,2
11 10 14	10	R1/4	15,9	11	30,5	16	8	20,2
11 10 38	10	R3/8	15,9	11,5	24	17	8	20,0
11 10 12	10	R1/2	15,9	14	27	22	8	47,5
11 12 14	12	R1/4	18,9	11	32	19	8	28,5
11 12 38	12	R3/8	18,9	11,5	27,5	19	10	24,8
11 12 12	12	R1/2	18,9	14	27,5	22	10	42,3
11 14 38	14	R3/8	21,9	11,5	35,5	22	10	40,1
11 14 12	14	R1/2	21,9	14	32,5	22	12	39,5

MA 12

Parallel straight, male

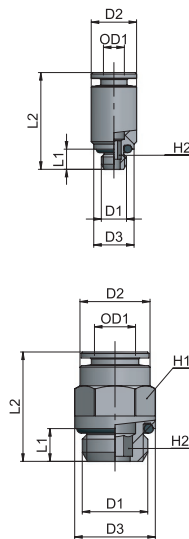

Type	OD1	D1	D2	D3	L1	L2	H1	H2	g Δ
12 03 M3	3	M3x0,5	6,5	5,6	3	15,5	-	1,5	1,4
12 03 M5	3	M5x0,8	6,5	7	4	15,8	-	2	2,1
12 04 M5	4	M5x0,8	9	8	4	19	-	2,5	4,4
12 04 M6	4	M6x1	9	9	4,5	19,5	-	3	4,3
12 04 M7	4	M7x1	9	9	5	20	-	3	5,0
12 06 M5	6	M5x0,8	12	8	4	22,2	-	2,5	8,6
12 06 M6	6	M6x1	12	9	4,5	22,8	-	3	8,9
12 06 M7	6	M7x1	12	9,1	5	23	-	3	9,4

Type	OD1	D1	D2	D3	L1	L2	H1	H2	g Δ
12 04 18	4	G1/8	9	13	5	16,5	9	3	6,3
12 04 14	4	G1/4	9	16	6,5	18,5	9	3	12,0
12 06 M12x1,25	6	M12x1,25	11,9	15	6,5	21	12	4	11,5
12 06 M12x1,5	6	M12x1,5	11,9	15	6,5	21	12	4	11,5
12 06 18	6	G1/8	11,9	13,5	5	19,5	12	4	9,2
12 06 14	6	G1/4	11,9	16	6,5	19,5	12	4	12,3
12 06 38	6	G3/8	11,9	20	7	20,5	12	4	20,6
12 06 12	6	G1/2	11,9	25	8,5	22,5	12	4	35,0
12 08 18	8	G1/8	13,9	14,5	5	23,5	13	6	11,5
12 08 14	8	G1/4	13,9	16	6,5	21,5	14	6	13,8
12 08 38	8	G3/8	13,9	20	7	21	14	6	20,1
12 08 12	8	G1/2	13,9	25	8,5	23	14	6	34,3
12 10 18	10	G1/8	15,9	13	5	26,5	15	8	16,8
12 10 14	10	G1/4	15,9	16,5	6,5	27,5	15	8	16,8
12 10 38	10	G3/8	15,9	20	7	25	16	8	22,0
12 10 12	10	G1/2	15,9	25	8,5	25,5	16	8	34,5
12 12 14	12	G1/4	18,9	21	6,5	28,5	19	8	25,8
12 12 38	12	G3/8	18,9	21	7	28,5	19	10	29,0
12 12 12	12	G1/2	18,9	25	8,5	26,5	19	10	36,1
12 14 38	14	G3/8	21,9	25	7	32	22	10	37,0
12 14 12	14	G1/2	21,9	25	8,5	32	22	12	42,4
12 16 12	16	G1/2	23,7	28	8,5	34,5	25	13	51,1
12 16 34	16	G3/4	23,7	32	9,5	32	24	13	68,2

MA 13

Female straight

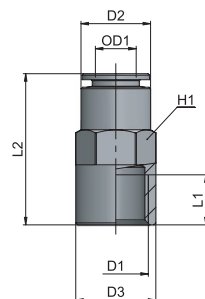

Type	OD1	D1	D2	D3	L1	L2	H1	g Δ
13 04 18	4	G1/8	9	13	7	23,5	9	10,0
13 06 18	6	G1/8	11,9	14	7	26	12	15,0
13 06 14	6	G1/4	11,9	16	10	30	12	18,5
13 08 18	8	G1/8	13,7	16,2	7	26	14	17,5
13 08 14	8	G1/4	13,9	16	10	30	14	20,2
13 08 38	8	G3/8	13,9	20	11	31	14	25,9
13 10 14	10	G1/4	15,9	18,5	10	32	16	24,4
13 10 38	10	G3/8	15,9	20	11	33,5	16	30,3
13 10 12	10	G1/2	15,9	25	11	36,5	16	45,0
13 12 38	12	G3/8	19	23,1	11	34	20	38,3
13 12 12	12	G1/2	18,8	25	11	37	19	50,9



MA 14

Taper elbow fitting, male

Type	OD1	D1	D2	L1	L2	L3	H1	g
14 04 18	4	R1/8	9	7,8	15	17,5	8	8,1
14 04 14	4	R1/4	9,1	10	19	17,5	10	13,9
14 06 18	6	R1/8	12	8,2	15,5	20,5	10	13,2
14 06 14	6	R1/4	12	10	19	20,5	10	16,7
14 08 18	8	R1/8	14	7,5	19	22,5	12	19,6
14 08 14	8	R1/4	14	10,5	20	22,5	12	22,6
14 10 14	10	R1/4	16	9,5	22	25	14	27,4
14 10 38	10	R3/8	16	10,8	22,5	25	14	31,5

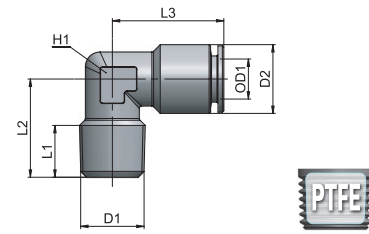

MA 15

Taper swivelling elbow fitting, male

Type	OD1	D1	D2	D3	L1	L2	L3	H1	g
15 04 18	4	R1/8	9,1	11,2	7,5	17,85	19,5	10	10,8
15 04 14	4	R1/4	9,1	15,5	11	24,2	19,5	14	20,9
15 06 18	6	R1/8	12	14,5	7,5	20,2	22	13	20,0
15 06 14	6	R1/4	12	15,5	11	24,2	22	14	24,0
15 06 38	6	R3/8	12	20	11,5	25,2	22	18	31,0
15 08 18	8	R1/8	14	14,5	7,5	20	22,5	13	23,0
15 08 14	8	R1/4	14	15,5	11	24	22,5	14	26,4
15 08 38	8	R3/8	14	20	11,5	27	23	18	39,2
15 08 12	8	R1/2	14	24,5	14	31	23	22	54,4
15 10 18	10	R1/8	16	20	7,5	26,5	23	16	33,2
15 10 14	10	R1/4	16	20	11	26,5	26	18	37,5
15 10 38	10	R3/8	16	20	11,5	27	26	18	41,0
15 10 12	10	R1/2	16	24,5	14	31	26	22	55,7
15 12 14	12	R1/4	19	22,5	11	30	28,5	20	62,3
15 12 38	12	R3/8	19	22,5	11,5	30,5	28,5	20	62,8
15 12 12	12	R1/2	19	24,5	14	33,5	28,5	22	71,5
15 14 38	14	R3/8	22	22,5	11,5	30,5	32	20	66,2
15 14 12	14	R1/2	22	24,5	14	33,5	32	22	74,6

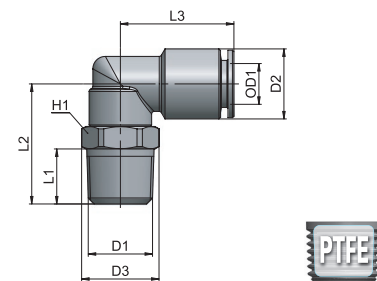

MA 16

Parallel swivelling elbow fitting, male

Type	OD1	D1	D2	D3	L1	L2	L3	H1	g
16 03 M3	3	M3x0,5	7	7,9	3	13,2	14	7	5,5
16 03 M5	3	M5x0,8	7	7,9	4	13,7	14	7	7,1
16 04 M5	4	M5x0,8	9,1	10	4	14	17,5	9	8,8
16 04 M6	4	M6x1	9,1	10	4,5	14,5	17,5	9	8,7
16 04 18	4	G1/8	9,1	14,5	5	18,2	19,5	13	15,7
16 04 14	4	G1/4	9,1	16	6,5	21,7	19,5	13	19,0
16 06 M5	6	M5x0,8	12	10	4	14	20,5	9	12,3
16 06 M6	6	M6x1	12	10	4,5	14,5	20,5	9	12,0
16 06 M12x1,25	6	M12x1,25	12	15	6,5	21,7	22	13	22,0
16 06 M12x1,5	6	M12x1,5	12	15	6,5	21,7	22	13	21,5
16 06 18	6	G1/8	12	14,5	5	18,2	22	13	18,5
16 06 14	6	G1/4	12	16	6,5	21,7	22	13	22,0
16 06 38	6	G3/8	12	20	7	22,2	22	13	27,7
16 06 12	6	G1/2	12	25	8,5	24,2	22	13	37,2
16 08 18	8	G1/8	14	14,5	5	18	22,5	13	22,0
16 08 14	8	G1/4	14	16	6,5	21,5	22,5	13	25,5
16 08 38	8	G3/8	14	20	7	25,5	23	16	36,0
16 08 12	8	G1/2	14	25	8,5	27,5	23	16	41,0
16 10 18	10	G1/8	16	18	5	20,5	26	16	30,8
16 10 14	10	G1/4	16	18	6,5	22	26	16	32,5
16 10 38	10	G3/8	16	20	7	25,5	26	16	39,5
16 10 12	10	G1/2	16	25	8,5	27,5	26	16	43,2
16 12 14	12	G1/4	19	22,5	6,5	25,5	28,5	20	58,5
16 12 38	12	G3/8	19	22,5	7	26	28,5	20	56,0
16 12 12	12	G1/2	19	25	8,5	30,5	28,5	20	65,1
16 14 38	14	G3/8	22	22,5	7	26	32	20	59,0
16 14 12	14	G1/2	22	25	8,5	30,5	32	20	68,5
16 16 12	16	G1/2	24	27	8,5	33	36,5	25	105,2
16 16 34	16	G3/4	24	32	9,5	35	36,5	25	113,8

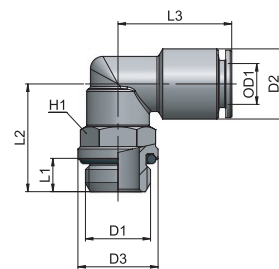

CO 67

MA 31

MM 115

PA 49

PE 45

PM 111

PN 19

PT 121

PU 55

PU Safety 59

PUX 101

PV 81

PVX 105

PX 95

Tool 129

Tubings 135

MA 16-45

Parallel Swivelling Elbow Fitting, male 45°

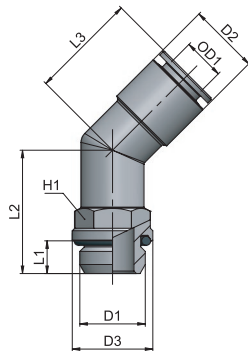

Type	OD1	D1	D2	D3	L1	L2	L3	H1	g 
16 06 18 45°	6	G1/8	12	12,8	5	21	21	13	24,1
16 06 14 45°	6	G1/4	12	16	6,5	24,5	21	13	27,9
16 08 18 45°	8	G1/8	14	12,8	5	21	21	13	24,6
16 08 14 45°	8	G1/4	14	16	6,5	24,5	21	13	28,3
16 10 14 45°	10	G1/4	16	16	6,5	23	25	13	40,5
16 10 38 45°	10	G3/8	16	20	7	26,5	25	16	45,3
16 12 38 45°	12	G3/8	20	20	7	26	25	16	68,2
16 12 12 45°	12	G1/2	20	25	8,5	30,5	25	20	76,3

MA 17

Swivelling elbow fitting, female

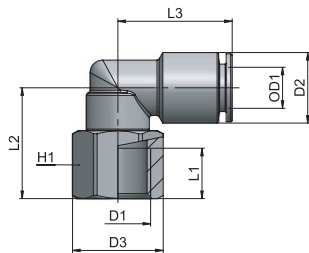

Type	OD1	D1	D2	D3	L1	L2	L3	H1	g 
17 04 18	4	G1/8	9,1	14,5	6,5	17,9	19,5	13	17,3
17 06 18	6	G1/8	12	14,5	6,5	17,9	22	13	19,7
17 06 14	6	G1/4	12	18	10	22,2	22	16	25,4
17 08 18	8	G1/8	14	14,5	6,5	17,7	22,5	13	23,1
17 08 14	8	G1/4	14	18	10	22	22,5	16	29,1
17 10 14	10	G1/4	16	18	10	23	26	16	35,6
17 10 38	10	G3/8	16	22,5	10,5	25	26	20	43,5

MA 18

Swivelling fitting with banjo ring

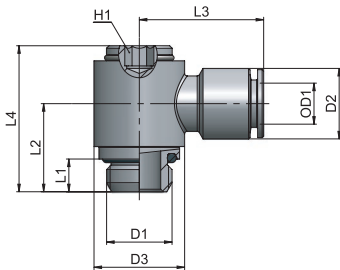

Type	OD1	D1	D2	D3	L1	L2	L3	L4	H1	g 
18 03 M3	3	M3x0,5	6,8	7	3	8,5	14	14	2	4,6
18 03 M5	3	M5x0,8	6,8	7	4	9,5	14	15	2	8,1
18 04 M5	4	M5x0,8	9	10	4	11	18,5	19,1	3	10,1
18 04 18	4	G1/8	9,1	14	5	15	20,5	25,5	4	22,2
18 06 M5	6	M5x0,8	12	10	4	11	21,5	19,1	3	13,3
18 06 18	6	G1/8	12	14	5	15	22,5	25,5	4	24,4
18 06 14	6	G1/4	12	18	6,5	17,5	24	29	5	39,3
18 08 18	8	G1/8	14	14	5	15	23,5	25,5	4	25,7
18 08 14	8	G1/4	14	18	6,5	17,5	24,5	29	5	39,1
18 10 14	10	G1/4	16	18	6,5	17,5	27	29	5	43,6
18 10 38	10	G3/8	16	22	7	19,5	29	32,5	6	62,2
18 12 38	12	G3/8	19	22	7	19,5	29,5	32,5	6	69,0
18 12 12	12	G1/2	19	26	8,5	24	31,5	39,6	8	114,8

MA 19

Swivelling extended elbow fitting, male, parallel

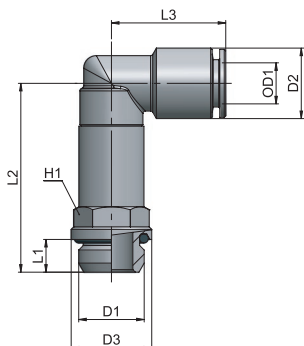

Type	OD1	D1	D2	D3	L1	L2	L3	H1	g 
19 04 18	4	G1/8	9,1	14,5	5	29,2	19,5	13	25,6
19 06 18	6	G1/8	12	14,5	5	32,2	22	13	30,5
19 06 14	6	G1/4	12	16	6,5	35,7	22	13	30,9
19 08 18	8	G1/8	14	14,5	5	34	22,5	13	35,7
19 08 14	8	G1/4	14	16	6,5	37,5	22,5	13	36,0

MA 20

Swivelling T fitting, taper

Type	OD1	D1	D2	D3	L1	L2	L3	H1	g Δ
20 04 18	4	R1/8	9,1	14,5	7,5	20,2	39	13	21,5
20 04 14	4	R1/4	9,1	15,5	11	24,2	39	14	25,6
20 06 18	6	R1/8	12	14,5	7,5	20	44	13	26,3
20 06 14	6	R1/4	12	15,5	11	24	44	14	30,4
20 08 18	8	R1/8	14	14,5	7,5	20	45	13	31,3
20 08 14	8	R1/4	14	15,5	11	24	45	14	35,5
20 08 38	8	R3/8	14	20	11,5	27	46	18	49,1
20 10 14	10	R1/4	16	20	11	26,5	52	18	50,0
20 10 38	10	R3/8	16	20	11,5	27	52	18	51,6
20 12 38	12	R3/8	19	22,5	11,5	30,5	57	20	80,0
20 12 12	12	R1/2	19	24,5	14	33,5	57	22	83,5

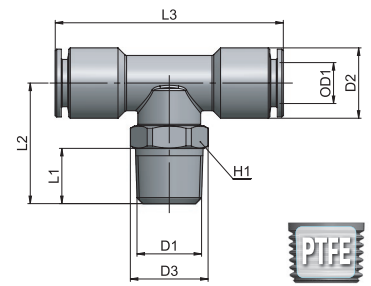

MA 21

Swivelling T fitting, parallel

Type	OD1	D1	D2	D3	L1	L2	L3	H1	g Δ
21 04 18	4	G1/8	9,1	14,5	5	18,2	39	13	20,2
21 04 14	4	G1/4	9,1	16	6,5	21,7	39	13	23,9
21 06 18	6	G1/8	12	14,5	5	18	44	13	25,2
21 06 14	6	G1/4	12	16	6,5	21,5	44	13	29,1
21 08 18	8	G1/8	14	14,5	5	18	45	13	30,7
21 08 14	8	G1/4	14	16	6,5	21,5	45	13	34,1
21 08 38	8	G3/8	14	20	7	25,5	46	16	46,4
21 10 14	10	G1/4	16	18	6,5	22	52	16	44,4
21 10 38	10	G3/8	16	20	7	25,5	52	16	48,7
21 12 38	12	G3/8	19	22,5	7	26	57	20	75,3
21 12 12	12	G1/2	19	25	8,5	30,5	57	20	82,0

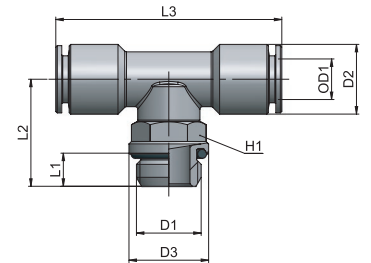

MA 22

Swivelling fitting with double banjo ring

Type	OD1	D1	D2	D3	L1	L2	L3	L4	H1	g Δ
22 04 M5	4	M5x0,8	9	10	4	11	38	19,1	3	13,8
22 04 18	4	G1/8	9	14	5	15	41	25,5	4	27,4
22 06 M5	6	M5x0,8	12	10	4	11	43	19,1	3	19,9
22 06 18	6	G1/8	12	14	5	15	45	25,5	4	32,1
22 06 14	6	G1/4	12	18	6,5	17,5	48	29	5	45,8
22 08 18	8	G1/8	14	14	5	15	47	25,5	4	34,1
22 08 14	8	G1/4	14	18	6,5	17,5	49	29	5	46,5
22 10 14	10	G1/4	16	18	6,5	17,5	54	29	5	55,2
22 10 38	10	G3/8	16	22	7	19,5	58	32,5	6	72,4
22 12 38	12	G3/8	19	22	7	19,5	59	32,5	6	79,0
22 12 12	12	G1/2	19	27	8,5	24	63	39,6	8	124,7

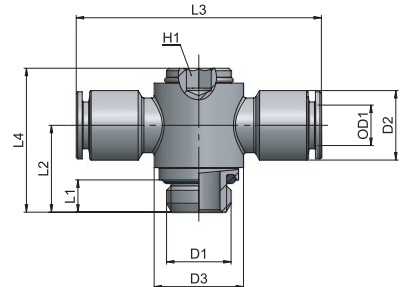

MA 23

Lateral run T fitting, taper

Type	OD1	D1	D2	D3	L1	L2	L3	L4	H1	g Δ
23 04 18	4	R1/8	9,1	14,5	7,5	20,2	19,5	39,7	13	22,0
23 04 14	4	R1/4	9,1	15,5	11	24,2	19,5	43,7	14	25,5
23 06 18	6	R1/8	12	14,5	7,5	20,2	22	42,2	13	27,5
23 06 14	6	R1/4	12	15,5	11	24,2	22	46,2	14	31,0
23 08 18	8	R1/8	14	14,5	7,5	20	22,5	42,5	13	31,0
23 08 14	8	R1/4	14	15,5	11	24	22,5	46,5	14	35,0
23 10 14	10	R1/4	16	20	11	26,5	26	52,5	18	50,0
23 10 38	10	R3/8	16	20	11,5	27	26	53	18	51,0
23 12 38	12	R3/8	19	22,5	11,5	30,5	28,5	59	20	75,0
23 12 12	12	R1/2	19	24,5	14	33,5	28,5	62	22	83,5

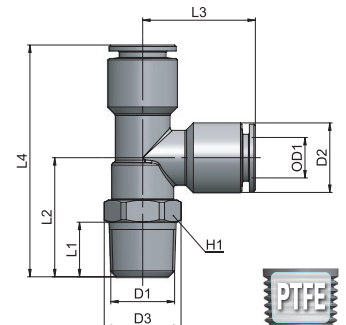

CO 67
MA 31
MM 115
PA 49
PE 45
PM 111
PN 19
PT 121
PU 55
PU Safety 59
PUX 101
PV 81
PVX 105
PX 95
Tool 129
Tubings 135

MA 24

Lateral run T fitting, parallel

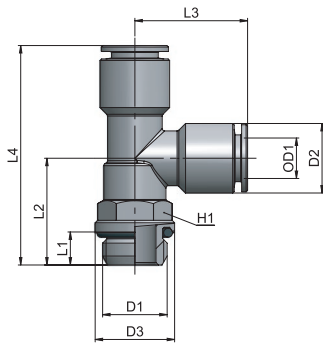

Type	OD1	D1	D2	D3	L1	L2	L3	L4	H1	g 
24 04 18	4	G1/8	9,1	14,5	5	18,2	19,5	37,7	13	20,5
24 04 14	4	G1/4	9,1	16	6,5	21,7	19,5	41,2	13	24,0
24 06 18	6	G1/8	12	14,5	5	18,2	22	40,2	13	26,0
24 06 14	6	G1/4	12	16	6,5	21,7	22	43,7	13	29,5
24 08 18	8	G1/8	14	14,5	5	18	22,5	40,5	13	30,0
24 08 14	8	G1/4	14	16	6,5	21,5	22,5	44	13	33,5
24 10 14	10	G1/4	16	18	6,5	22	26	48	16	44,0
24 10 38	10	G3/8	16	20	7	25,5	26	51,5	16	49,0
24 12 38	12	G3/8	19	22,5	7	26	28,5	54,5	20	73,0
24 12 12	12	G1/2	19	25	8,5	30,5	28,5	59	20	77,0

MA 25

Reducer

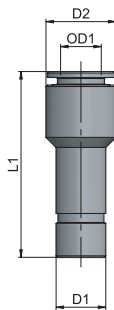

Type	OD1	D1	D2	L1	g 
25 03 04	3	4	6,5	27,5	2,5
25 04 06	4	6	9	33,5	7,0
25 04 08	4	8	9	33,5	10,0
25 04 10	4	10	10	31,5	15,0
25 04 12	4	12	12	32,5	24,5
25 06 04	6	4	12	35,5	10,0
25 06 08	6	8	12	35	11,5
25 06 10	6	10	12	36,5	16,5
25 06 12	6	12	12	35,5	22,2
25 06 14	6	14	14	37,5	25,0
25 08 06	8	6	14	39,5	13,5
25 08 10	8	10	14	37	15,0
25 08 12	8	12	14	39	23,0
25 08 14	8	14	14	38,5	31,5
25 10 12	10	12	16	42	20,0
25 10 14	10	14	16	42	29,5
25 12 14	12	14	19	43	24,0
25 14 16	14	16	22	49,5	45,0

MA 26

Union

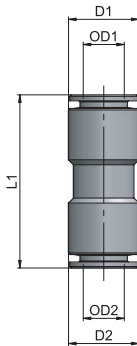

Type	OD1	OD2	D1	D2	L1	g 
26 03 03	3	3	6,5	6,5	22,5	2,7
26 04 04	4	4	9	9	28	6,8
26 06 06	6	6	12	12	33,6	14,2
26 06 04	6	4	12	12	31	14,7
26 08 08	8	8	14	14	34	17,6
26 08 06	8	6	14	14	34	21,0
26 10 10	10	10	16	16	38,6	22,5
26 10 08	10	8	16	16	36,5	25,2
26 12 12	12	12	19	19	41	37,0
26 12 08	12	8	19	14	39	31,4
26 12 10	12	10	19	16	40,5	33,9
26 14 14	14	14	22	22	47	47,2
26 14 12	14	12	22	19	44,5	44,0
26 16 16	16	16	24	24	47	63,2
26 16 12	16	12	24	19	44,5	52,0
26 16 14	16	14	24	22	47	60,0

MA 27

Bulkhead union

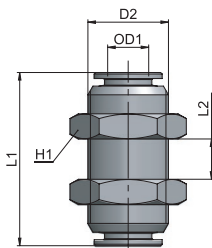

Type	OD1	D2	L1	L2	H1	g 
27 03 03	3	M8x0,75	21	8	12	14,5
27 04 04	4	M12x1	28	11	16	23,5
27 06 06	6	M14x1	34	16	18	33,0
27 08 08	8	M16x1	34	16	20	39,5
27 10 10	10	M18x1	39	19	22	51,5
27 12 12	12	M20x1	41	20	24	60,0



MA 27-F

Bulkhead union, female

Type	OD1	D1	D2	L1	L2	L3	H1	H2	g Δ
27 06 18 F	6	G1/8	M14x1	7	26,5	9	18	18	33,6
27 06 14 F	6	G1/4	M14x1	10	30,5	9	18	18	35,2
27 08 18 F	8	G1/8	M16x1	7	26,5	9	20	20	41,5
27 08 14 F	8	G1/4	M16x1	10	30,5	9	20	20	45,3
27 10 38 F	10	G3/8	M18x1	11	33	10	22	22	51,8

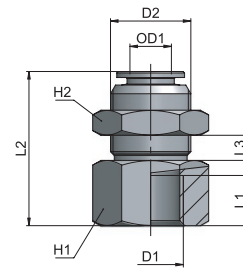

MA 28

Union elbow

Type	OD1	D2	L1	g Δ
28 03 03	3	7	12,8	4,5
28 04 04	4	9	17,5	9,0
28 06 06	6	12	20,5	16,5
28 08 08	8	14	22,5	22,0
28 10 10	10	16	25	29,5
28 12 12	12	19	26,5	48,5
28 14 14	14	22	31,5	58,0
28 16 16	16	24	36,5	90,6

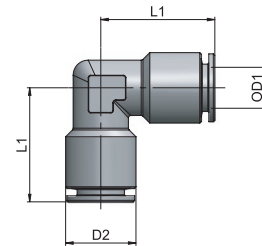

MA 29

Union T

Type	OD1	OD2	D1	D2	L1	L2	g Δ
29 03 03	3	3	7	7	12,8	25,6	5,6
29 04 04	4	4	9	9	17,5	35	12,5
29 06 06	6	6	12	12	20	40	22,3
29 06 04	6	4	12	9	18	40	19,9
29 08 08	8	8	14	14	21	42	28,0
29 08 06	8	6	14	12	20,5	42	27,5
29 10 10	10	10	16	16	24,5	49	39,2
29 10 08	10	8	16	14	23	49	38,4
29 12 12	12	12	19	19	26	52	61,3
29 12 10	12	10	19	16	26	52	60,3
29 14 14	14	14	22	22	30,5	61	77,1
29 16 16	16	16	24	24	34,5	69	124,0

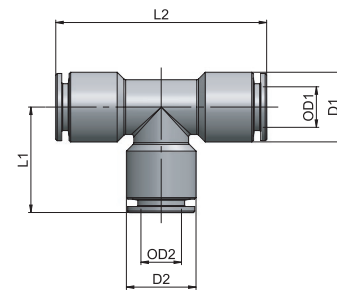

MA 31

Simple screw

Type	D1	L1	L2	L3	H1	g Δ
31 00 M5	M5x0,8	4,1	14,3	18,5	8	2,5
31 00 18	G1/8	4,4	21,2	27	14	13,4
31 00 14	G1/4	5,9	24,7	31,5	17	27,8
31 00 38	G3/8	6,4	28,2	36	20	43,0
31 00 12	G1/2	7,5	33,5	41,5	26	81,1

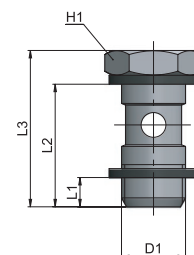

CO 67

MA 31

MM 115

PA 49

PE 45

PM 111

PN 19

PT 121

PU 55

PU Safety 59

PUX 101

PV 81

PVX 105

PX 95

Tool 129

Tubings 135

MA 32

Double screw

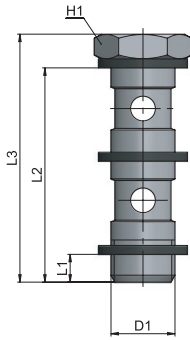

Type	D1	L1	L2	L3	H1	g 
32 00 18	G1/8	4,1	37,7	43,5	14	19,5
32 00 14	G1/4	5,6	43,2	50	17	38,5
32 00 38	G3/8	6,1	49,7	57,5	20	63,5
32 00 12	G1/2	7	59	67	26	117,0

MA 33

Screw, male female

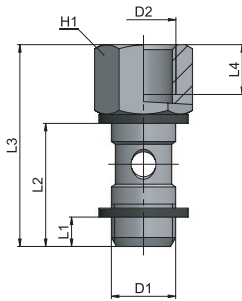

Type	D1	D2	L1	L2	L3	L4	H1	g 
33 00 18	G1/8	G1/8	4,4	21,2	35	6,2	14	19,5
33 00 14	G1/4	G1/4	5,9	24,7	40,5	10	17	32,5
33 00 38	G3/8	G3/8	6,4	28,2	45	10	20	47,0

MA 34

Double screw, male female

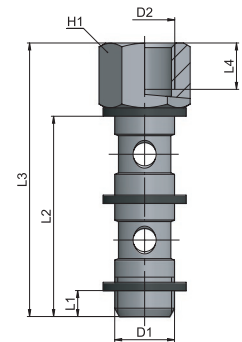

Type	D1	D2	L1	L2	L3	L4	H1	g 
34 00 18	G1/8	G1/8	4,1	37,7	51,5	6,2	14	26,0
34 00 14	G1/4	G1/4	5,6	43,2	59	10	17	44,0
34 00 38	G3/8	G3/8	6,1	49,7	66,5	10	20	66,0

MA 35

Single banjo ring

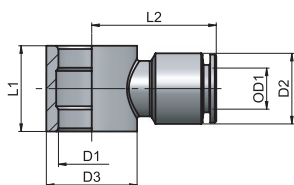

Type	OD1	D1	D2	D3	L1	L2	g 
35 04 M5	4	M5	9,1	10	9	18,5	7,7
35 04 M5 /R	4	7	9,1	10	10	18,5	6,6
35 04 18	4	10	9,1	14	15	20,5	13,5
35 06 M5	6	M5	12	10	9	21,5	10,9
35 06 M5 /R	6	7	12	10	10	21,5	10,1
35 06 18	6	10	12	14	15	22,5	15,5
35 06 14	6	13,2	12	18	17	24	21,6
35 08 18	8	10	14	14	15	23,5	16,7
35 08 14	8	13,2	14	18	17	24,5	22,8
35 08 38	8	17	14	22	20	26,5	32,7
35 10 14	10	13,2	16	18	17	27	27,2
35 10 38	10	17	16	22	20	29	34,5
35 12 38	12	17	19	22	20	29,5	38,8
35 12 12	12	21	19	26	24	31,5	56,9

/R = For flow controls only

MA 36

Double banjo ring

Type	OD1	D1	D2	D3	L1	L2	g Δ
36 04 M5	4	M5	9	10	9	37	10,9
36 04 18	4	10	9	14	15	41	18,0
36 06 18	6	10	12	14	15	45	23,0
36 06 14	6	13,2	12	18	17	48	28,7
36 08 18	8	10	14	14	15	47	25,3
36 08 14	8	13,2	14	18	17	49	29,7
36 08 38	8	17	14	22	20	53	42,5
36 10 14	10	13,2	16	18	17	54	37,9
36 10 38	10	17	16	22	20	58	44,5
36 12 38	12	17	19	22	20	59	51,3
36 12 12	12	21	19	27	24	63	67,2

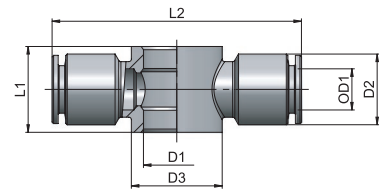

MA 37

Y fitting

Type	OD1	OD2	D2	L1	L2	g Δ
37 03 03	3	3	6,8	25	7,5	7,9
37 04 04	4	4	9	29,5	9,5	14,3
37 06 06	6	6	12	36,5	12,5	33,3
37 06 04	6	4	12	34,1	11	36,1
37 08 08	8	8	14	37,5	14,5	44,1
37 08 06	8	6	14	37,5	14,5	51,1
37 10 10	10	10	16	44,5	16,5	62,7
37 10 08	10	8	16	44	16,5	74,9
37 12 12	12	12	19	49	19,5	95,8

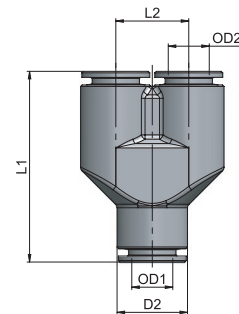

MA 38

Stem adaptor

Type	D1	D2	L1	L2	H1	g Δ
38 04 M5	M5x0,8	4	4	26	9	3,2
38 04 18	G1/8	4	5	28	13	7,3
38 04 14	G1/4	4	6,5	29,5	16	12,4
38 06 M5	M5x0,8	6	4	28	9	5,9
38 06 18	G1/8	6	5	30	13	8,5
38 06 14	G1/4	6	6,5	32,5	16	13,7
38 08 18	G1/8	8	5	31	13	9,4
38 08 14	G1/4	8	6,5	33,5	16	14,5
38 10 14	G1/4	10	6,5	34,5	16	15,5
38 10 38	G3/8	10	7	35	20	22,0
38 12 38	G3/8	12	7	38	20	23,6
38 12 12	G1/2	12	8,5	39,5	25	38,0

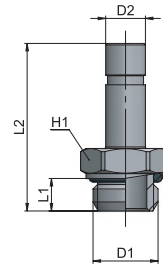

MA 39

Extention piece

Type	D1	L1	g Δ
39 00 04	4	35	2,7
39 00 06	6	40	5,1
39 00 08	8	42	8,0
39 00 10	10	50	11,8
39 00 12	12	53	15,3
39 00 14	14	54	18,8

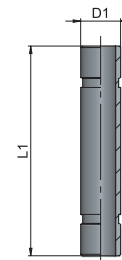

CO	67
MA	31
MM	115
PA	49
PE	45
PM	111
PN	19
PT	121
PU	55
PU Safety	59
PUX	101
PV	81
PVX	105
PX	95
Tool	129
Tubings	135

MA 40

Plug

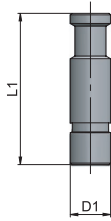

Type	D1	L1	g Δ
40 00 03	3	20	1,0
40 00 04	4	25	2,3
40 00 06	6	25	3,7
40 00 08	8	30	7,2
40 00 10	10	35	11,8
40 00 12	12	40	18,2
40 00 14	14	40	26,2
40 00 16	16	40	32,5

MA 41

Swivelling fitting with two banjo rings

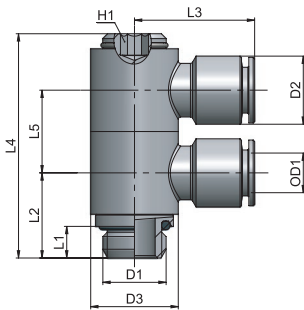

Type	OD1	D1	D2	D3	L1	L2	L3	L4	L5	H1	g Δ
41 04 M5	4	M5x0,8	9	10	4	11	18,5	29,2	10	3	18,5
41 04 18	4	G1/8	9,1	14	5	15	20,5	40,4	15	4	40,0
41 06 18	6	G1/8	12	14	5	15	22,5	40,4	15	4	46,0
41 06 14	6	G1/4	12	18	6,5	17,5	24	46,1	17	5	69,5
41 08 18	8	G1/8	14	14	5	15	23,5	40,4	15	4	50,0
41 08 14	8	G1/4	14	18	6,5	17,5	24,5	46,1	17	5	69,5

MA 42

Swivelling fitting with two double banjo rings

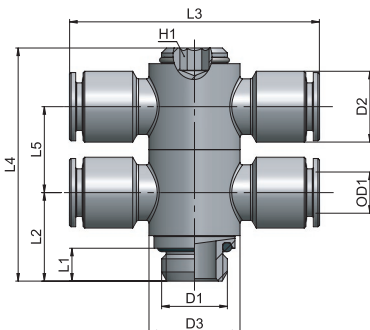

Type	OD1	D1	D2	D3	L1	L2	L3	L4	L5	H1	g Δ
42 04 M5	4	M5x0,8	9	10	4	11	38	29,2	10	3	25,0
42 04 18	4	G1/8	9	14	5	15	41	40,4	15	4	50,0
42 06 18	6	G1/8	12	14	5	15	45	40,4	15	4	59,0
42 06 14	6	G1/4	12	18	6,5	17,5	48	46,1	17	5	82,0
42 08 18	8	G1/8	14	14	5	15	47	40,4	15	4	61,0
42 08 14	8	G1/4	14	18	6,5	17,5	49	46,1	17	5	83,5

MA 43

Plug-in elbow

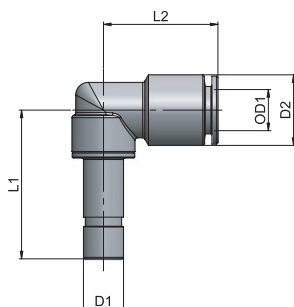

Type	OD1	D1	D2	L1	L2	g Δ
43 04 04	4	4	9,1	25,7	19,5	14,0
43 04 06	4	6	9,1	29,7	19,5	15,0
43 06 04	6	4	12	25,7	22	17,0
43 06 06	6	6	12	29,7	22	17,0
43 06 08	6	8	12	29,7	22	17,5
43 08 06	8	6	14	29,5	22,5	20,5
43 08 08	8	8	14	29,5	22,5	20,5
43 10 10	10	10	16	33,5	26	30,0

MA 44

Plug-in T

Type	OD1	D1	D2	L1	L2	g 
44 04 04	4	4	9,1	25,7	39	18,5
44 04 06	4	6	9,1	29,7	39	19,5
44 06 06	6	6	12	29,5	44	24,5
44 06 08	6	8	12	29,5	44	24,5
44 08 08	8	8	14	29,5	45	29,0
44 08 10	8	10	14	33,5	46	38,5
44 10 10	10	10	16	33,5	52	41,0

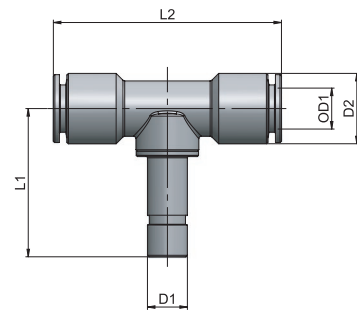

MA 45

Plug-in run T

Type	OD1	D1	D2	L1	L2	L3	g 
45 04 04	4	4	9,1	25,7	19,5	45,2	18,5
45 04 06	4	6	9,1	29,7	19,5	49,2	20,0
45 06 06	6	6	12	29,7	22	51,7	25,0
45 06 08	6	8	12	29,7	22	51,7	25,5
45 08 08	8	8	14	29,5	22,5	52	30,0
45 10 10	10	10	16	33,5	26	59,5	41,0

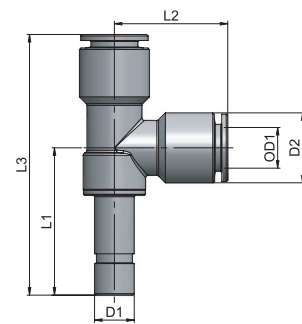

MA 46

Swivelling cross fitting

Type	OD1	OD2	D1	D2	L1	L2	L3	g 
46 04 04	4	4	9,1	9,1	18,4	39	39	31,0
46 04 06	4	6	9,1	12	18,4	39	44	36,0
46 06 06	6	6	12	12	18	44	44	41,0
46 06 08	6	8	12	14	18	44	45	46,5
46 08 08	8	8	14	14	18	45	45	50,0

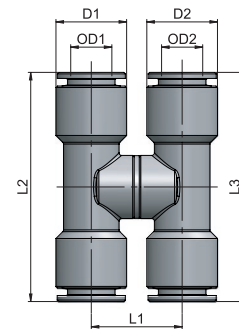

MA 47

Swivelling Y fitting

Type	OD1	OD2	D1	D2	L1	L2	L3	g 
47 04 04	4	4	9,1	9,1	18,4	39	19,5	27,0
47 04 06	4	6	9,1	12	18,4	39	22	29,5
47 06 06	6	6	12	12	18,2	44	22	34,5
47 06 08	6	8	12	14	18	44	22,5	37,5
47 08 08	8	8	14	14	18	45	22,5	42,0

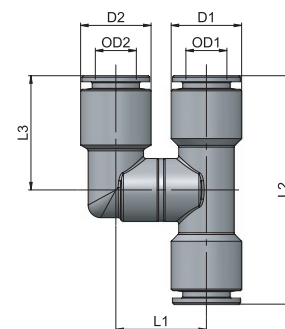

CO 67

MA 31

MM 115

PA 49

PE 45

PM 111

PN 19

PT 121

PU 55

PU Safety 59

PUX 101

PV 81

PVX 105

PX 95

Tool 129

Tubings 135

MA 10

Press-in cartridge

The new construction features of the cartridge MA10 allow for one single cartridge version to be assembled in plastic, aluminium as well as brass bodies.

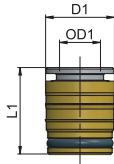

Type	OD1	D1	L1	g Δ
10 04 00	4	9,3	14,5	3,6
10 06 00	6	11,5	16,5	5,7
10 08 00	8	13,7	17	7,9
10 10 00	10	15,8	19	10,3

Cartridge seat drilling plan

1 Drill the cartridge seat, following the instructions given.

2 Manually press the cartridge into the seat and by means of the Assembly tool push it all the way down until it bottoms; this will guarantee the proper cartridge assembly.

"Drilling and Assembly Tool" available upon request.

Type	D1	D2	D3	D4	L1	L2
4	9,5	9,2	3	8,6	12	3,2
6	11,7	11,4	5	10,8	14	4
8	13,9	13,6	7	13	14,5	4
10	16	15,7	9	15,1	16	4

