

PM LINE



Medium Pressure Push-in Fittings, 1,160 PSI Inch/NPTF

The push-in fittings of the PM line are available in inch sizes and NPTF threads. They are conceived for high pressure rated in central grease applications up to 1,160 PSI.

PM Line

1

Body

Brass UNI EN 12164 CW614N - UNI EN 12165 CW617N, nickel plated

2

Gripping collet

Brass UNI EN 12164 CW614N, nickel plated

3

Seals

NBR



-4° ÷ 176°F



Max 1,160 PSI

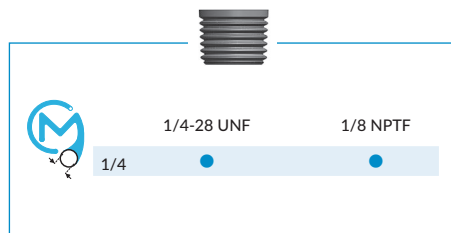
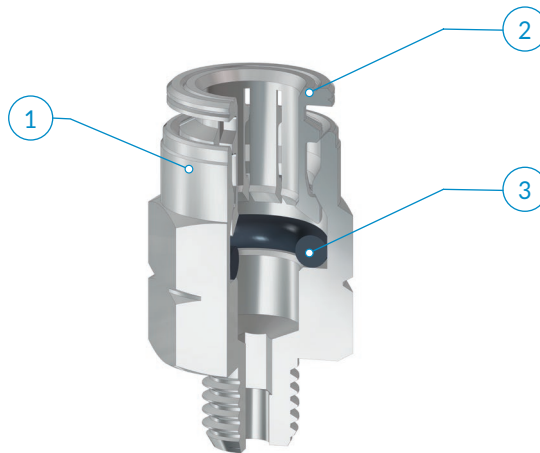

Recommended tubings:
PA66, PA12 HR

Acceptable Tolerances on the tubings:
+/- .003 up to Ø 1/4

Application fields:
Lubrication installations



The max pressure rate achievable can vary depending on the tubing used and on the room temperature. These two factors may in fact lower the tube bursting pressure.

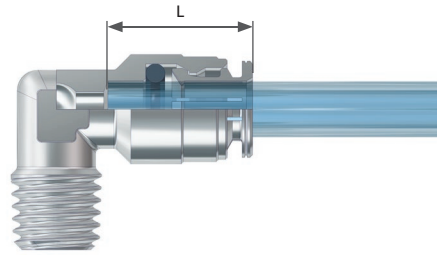

OD	L
1/4	.669

i ASSEMBLY INSTRUCTIONS

- 1** Cut the tube square (by means of a hose cutter i.e. our TCUT) making sure that no burrs are left and that the tube is not oval.
- 2** Insert the tube into the fitting until it bottoms.

Tube release
While pressing on the release ring, pull out the tube from the fitting.

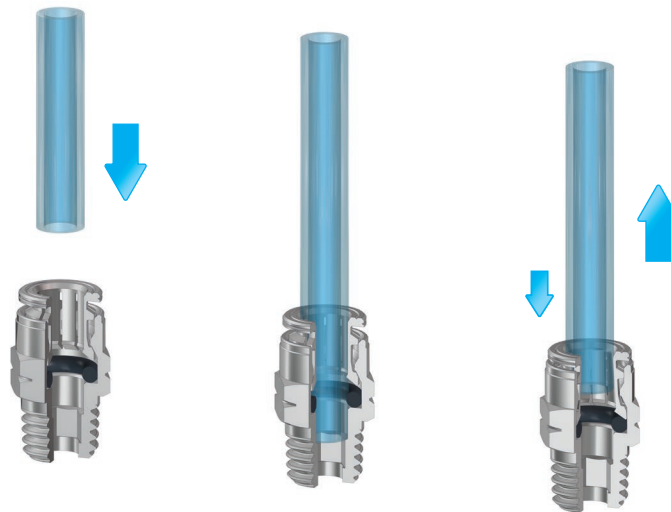

Once the tubing is connected to the fitting, make sure that the tubing is not subject to any tensile strength and that the min. recommended bending radius stated in the tubing section of this catalogue is complied with (see page 136).

To prevent any accidental tube release, no components have to come in touch with the release ring and exercise any unwanted pressure on the same. Indeed however lateral, any load on the release ring may cause the tube disconnection.

To tighten threads, please check out our tightening torque chart illustrated at page 6.

If a metal stem is connected to the fitting, the stem has to be manufactured according to the profile and sizes as set forth below. Should the fitting be connected to a metal stem not complying to the technical features recommended, the fitting may get irreversibly damaged and its function would no longer be guaranteed.

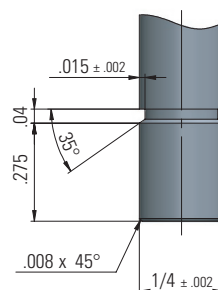

PM 11

Taper straight, male

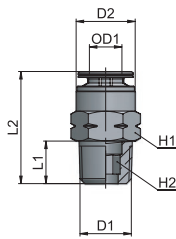

Type	OD1	D1	D2	L1	L2	H1	H2	oz
11 1/4 1/8	1/4	1/8 NPTF	.465	.335	.866	12	5	.330
11 1/4 1/4-28	1/4	1/4-28 UNF	.465	.236	.945	12	2,5	.385

PM 14

Taper elbow fitting, male

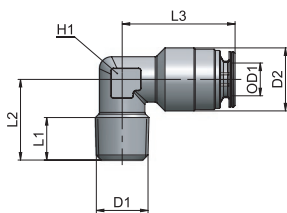

Type	OD1	D1	D2	L1	L2	L3	H1	oz
14 1/4 1/8	1/4	1/8 NPTF	.492	.331	.630	.866	10	.532
14 1/4 1/4-28	1/4	1/4-28 UNF	.492	.276	.591	.591	10	.527

PM 15

Taper swivelling elbow fitting, male

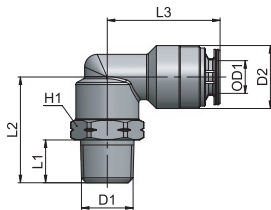

Type	OD1	D1	D2	L1	L2	L3	H1	oz
15 1/4 1/8	1/4	1/8 NPTF	.492	.335	.827	.866	13	.860
15 1/4 1/4-28	1/4	1/4-28 UNF	.492	.236	.728	.866	13	.754

PM 26

Union

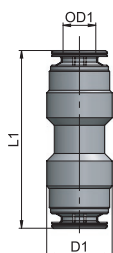

Type	OD1	D1	L1	oz
26 1/4 1/4	1/4	.512	1.358	.596