

## PU Safety



Safety Couplings, NPTF

Safety quick couplings compliant with ISO 4414-C available with NPTF threads.

# PU 42

Push-button safety coupling according to ISO 6150 B-12

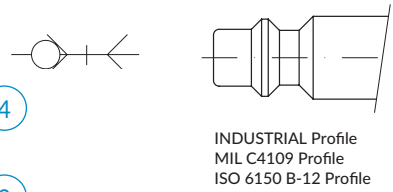
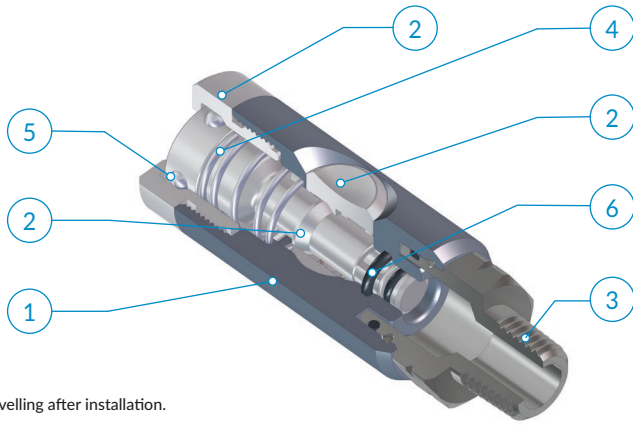
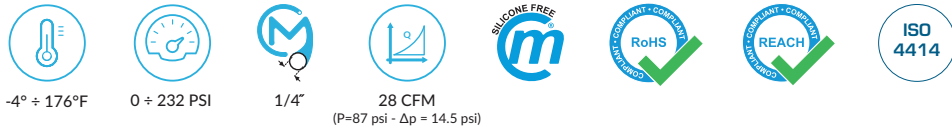
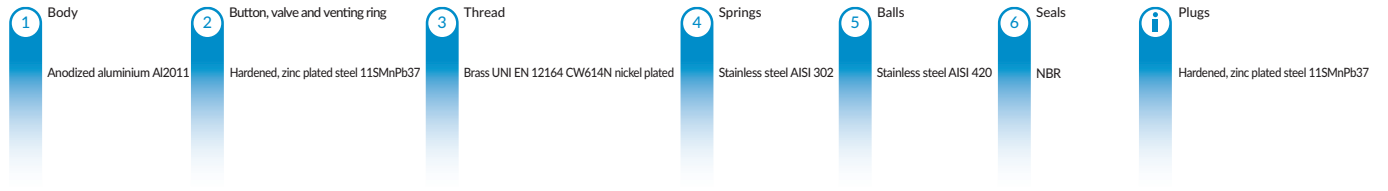

The Coupling will remain swivelling after installation.

**Application fields:**  
Pneumatic circuits

## CONNECTION - RELEASE

Insert the plug into the Coupling.

**1**  
To disconnect the plug follow instructions below:  
Plug inserted in Coupling.

**2**  
Press the button once to vent the downstream air from the circuit; at this time the plug is still captive in the Coupling.

Press the button one more time to release the plug.

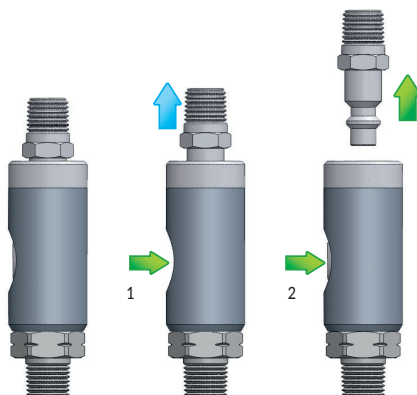

PU 42-11

Male coupling

Type	D1	D2	L1	L2	H1	oz $\Delta$
11 00 14	1/4 NPTF	.984	.512	2.972	.827	3.884
11 00 38	3/8 NPTF	.984	.512	2.933	.827	4.245
11 00 12	1/2 NPTF	.984	.669	3.091	.866	4.995

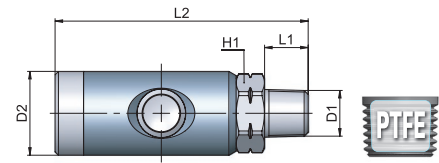

CO 67

MA 31

MM 115

PA 49

PE 45

PM 111

PN 19

PT 121

PU 55

PU Safety 59

PUX 101

PV 81

PVX 105

PX 95

Tool 129

Tubings 135

PU 42-12

Female coupling

Type	D1	D2	L1	L2	H1	oz $\Delta$
12 00 14	1/4 NPTF	.984	.472	3.012	.827	4.501
12 00 38	3/8 NPTF	.984	.492	3.031	.827	4.163
12 00 12	1/2 NPTF	.984	.531	3.110	.945	4.939

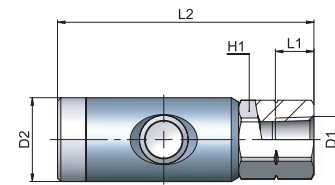

PU 42-20

Male plug

Type	D1	L1	H1	oz $\Delta$
20 00 14	1/4 NPTF	1.654	.551	.798
20 00 38	3/8 NPTF	1.654	.709	1.020
20 00 12	1/2 NPTF	1.850	.866	1.521

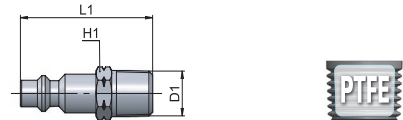

PU 42-21

Female plug

Type	D1	L1	H1	oz $\Delta$
21 00 14	1/4 NPTF	1.575	.669	.992
21 00 38	3/8 NPTF	1.575	.787	1.115
21 00 12	1/2 NPTF	1.732	.945	1.764

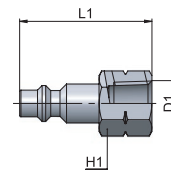

# PU 44

Push-Button safety coupling according to ISO 6150 B-15

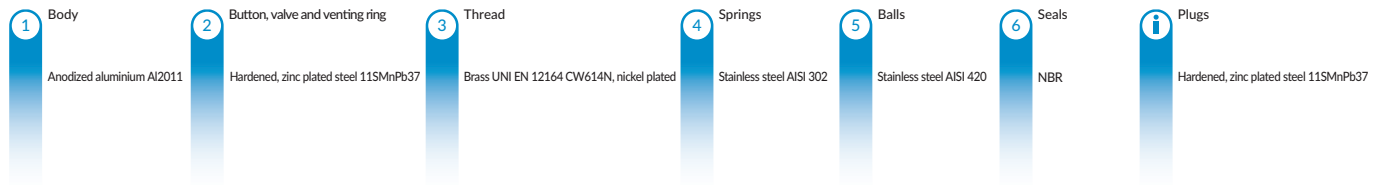

-4° ± 176°F



0 ± 174 PSI



3/8"



58 CFM  
(P=87 psi - Δp = 14.5 psi)

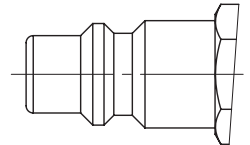
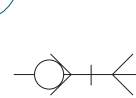

3/8 INDUSTRIAL Profile ISO 6150 B-15

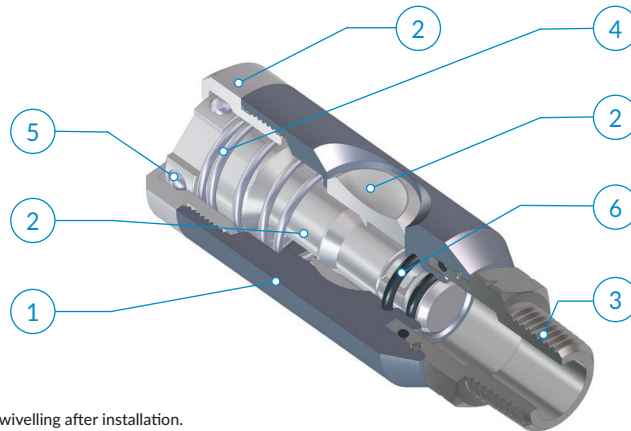

The Coupling will remain swivelling after installation.

**Application fields:**  
Pneumatic circuits

## **i** CONNECTION - RELEASE

Insert the plug into the Coupling.

**1**  
To disconnect the plug follow instructions below:  
Plug inserted in Coupling.

**2**  
Press the button once to vent the downstream air from the circuit; at this time the plug is still captive in the Coupling.

Press the button one more time to release the plug.

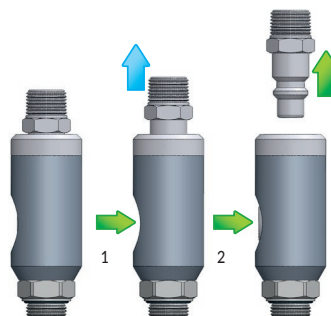

PU 44-11

Male coupling

Type	D1	D2	L1	L2	H1	oz $\Delta$
11 00 38	3/8 NPTF	1.142	.512	3.157	.827	5.397
11 00 12	1/2 NPTF	1.142	.669	3.315	.866	-

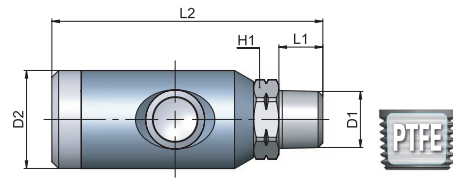

CO 67  
 MA 31  
 MM 115  
 PA 49  
 PE 45  
 PM 111  
 PN 19  
 PT 121  
 PU 55  
 PU Safety 59  
 PUX 101  
 PV 81  
 PVX 105  
 PX 95  
 Tool 129  
 Tubings 135

PU 44-12

Female coupling

Type	D1	D2	L1	L2	H1	oz $\Delta$
12 00 38	3/8 NPTF	1.142	.492	3.256	.827	5.944
12 00 12	1/2 NPTF	1.142	.531	3.335	.945	-

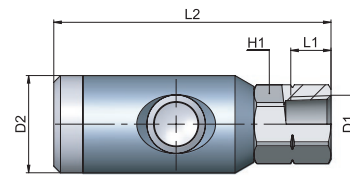

PU 44-20

Male plug

Type	D1	L1	H1	oz $\Delta$
20 00 38	3/8 NPTF	1.752	.709	1.242
20 00 12	1/2 NPTF	1.949	.866	1.785

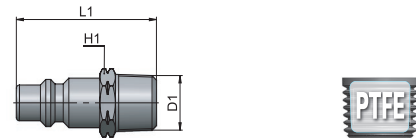

PU 44-21

Female plug

Type	D1	L1	H1	oz $\Delta$
21 00 38	3/8 NPTF	1.673	.787	1.322
21 00 12	1/2 NPTF	1.831	.866	1.950

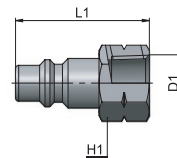

# PU 45

Push-button safety coupling according to ARO 210

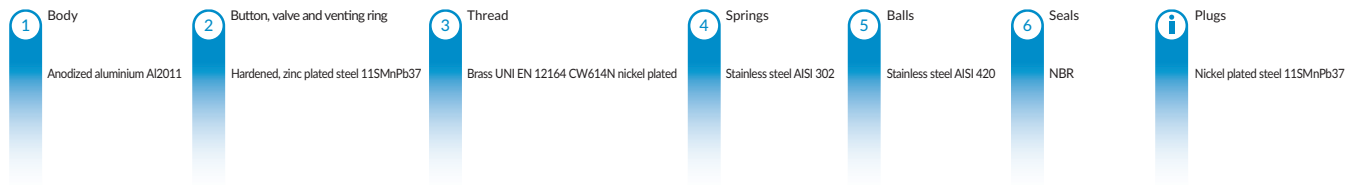

-4° ± 176°F



0 ± 174 PSI



1/4"



38 CFM  
(P=87 psi - Δp = 14.5 psi)

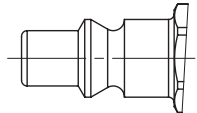
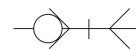

ARO 210 Profile

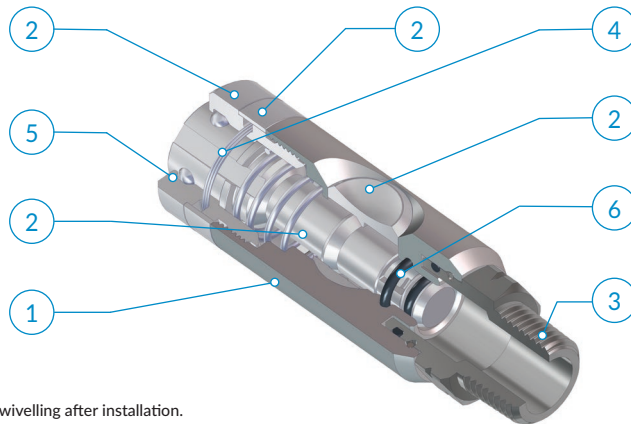

The Coupling will remain swivelling after installation.

**Application fields:**  
Pneumatic circuits

## **i** CONNECTION - RELEASE

Insert the plug into the Coupling.

**1**  
To disconnect the plug follow instructions below:  
Plug inserted in Coupling.

**2**  
Press the button once to vent the downstream air from the circuit; at this time the plug is still captive in the Coupling.

Press the button one more time to release the plug.

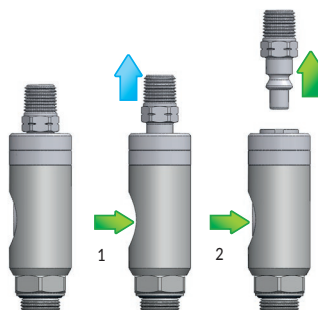

PU 45-11

Male coupling

Type	D1	D2	L1	L2	H1	oz $\Delta$
11 00 14	1/4 NPTF	1.024	.512	3.181	.827	5.148
11 00 38	3/8 NPTF	1.024	.512	3.142	.827	5.164
11 00 12	1/2 NPTF	1.024	.669	3.299	.866	5.904

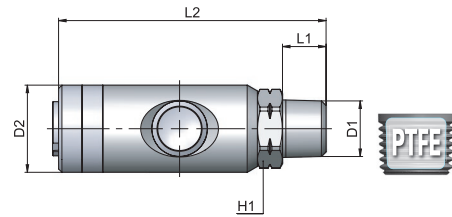

CO 67  
MA 31  
MM 115  
PA 49  
PE 45  
PM 111  
PN 19  
PT 121  
PU 55  
PU Safety 59  
PUX 101  
PV 81  
PVX 105  
PX 95  
Tool 129  
Tubings 135

PU 45-12

Female coupling

Type	D1	D2	L1	L2	H1	oz $\Delta$
12 00 14	1/4 NPTF	1.024	.354	3.220	.827	5.967
12 00 38	3/8 NPTF	1.024	.394	3.240	.827	5.675
12 00 12	1/2 NPTF	1.024	.433	3.319	.945	6.104

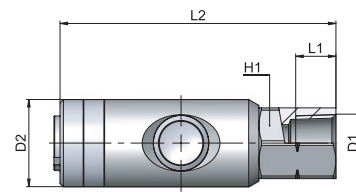

PU 45-20

Male plug

Type	D1	L1	H1	oz $\Delta$
20 00 14	1/4 NPTF	1.606	.551	.707
20 00 38	3/8 NPTF	1.606	.709	.942
20 00 12	1/2 NPTF	1.803	.866	1.488

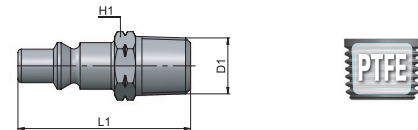

PU 45-21

Female plug

Type	D1	L1	H1	oz $\Delta$
21 00 14	1/4 NPTF	1.528	.669	.925
21 00 38	3/8 NPTF	1.528	.787	1.036
21 00 12	1/2 NPTF	1.685	.945	1.624

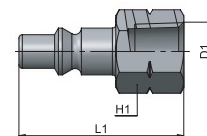



*cmatic*