

**GROUND FLOOR**

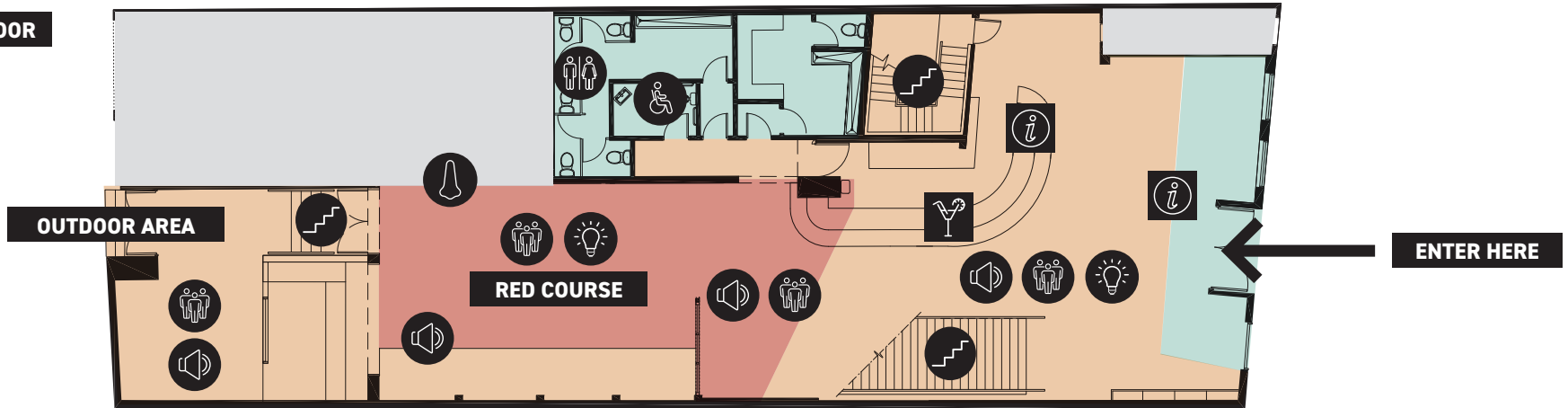

**LEVEL 1**

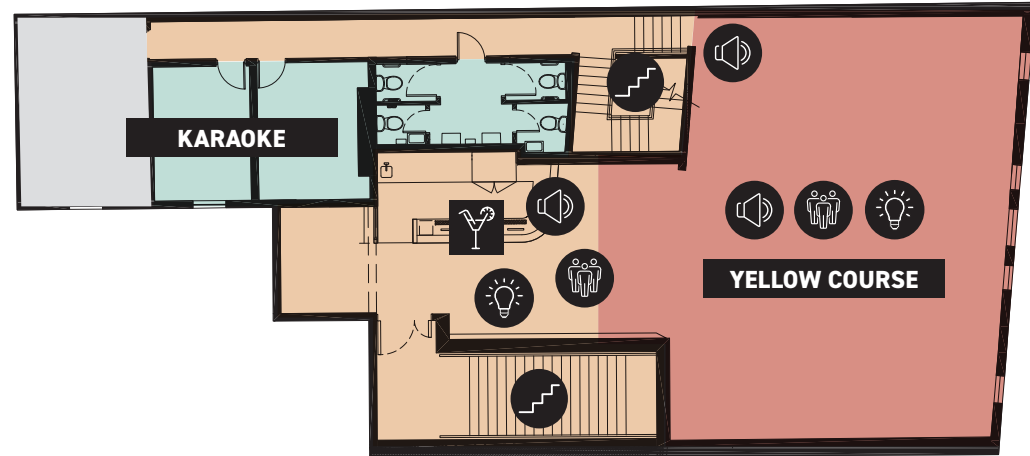

**NOTES:**

- THIS VENUE IS ACCESSED VIA KING ST AND HAS LIFT ACCESS TO BOTH MAIN FLOORS (SPEAK TO RECEPTION FOR ACCESS)
- BOTH COURSES HAVE VARIOUS STEPS, LEDGES AND NARROW PASSAGeways MAKING IT CHALLENGING TO NAVIGATE WITH MOBILITY AIDES
- THE MEZZANINE LEVEL (KARAOKE) & OUTDOOR AREA ARE ONLY ACCESSIBLE VIA STAIRS
- THE RED COURSE IS SLIGHTLY LESS OVERWHELMING WITH LESS FLASHING LIGHTS AND MORE NATURAL DAYLIGHT EXPOSURE

**KEY:**

NOISE	FLASHING LIGHTS	GENERAL TOILET	HIGH SENSORY
QUIET SPACE	RAMP	SINGLE STALL ACCESSIBLE TOILETS (GENDER NEUTRAL)	MEDIUM SENSORY
SMELL	STEPS	LIFT	LOW SENSORY
LIGHT	CROWDED	BAR	STAFF ONLY
		RECEPTION	