BuzziShield Desk

Product Specification Sheet

This document contains technical information about the BuzziShield Desk



www.buzzi.space







Create private workstations

BuzziShield Desk is a voluminous desk partition that instantly creates private and snug workstations all while absorbing noise and adding visual privacy so focus work can be done. The lightweight and flexible acoustic solution features a thick upholstered body (7 cm/2.8") that's sturdy enough to sit on top of a desk by placing it on its metal feet or secure the acoustic solution to the edge of a desk with its unobtrusive fixes. Combine more than one BuzziShield Desk to define multiple workstations, or use them individually.

BuzziShield Desk arrives in two different heights (40 cm/15.7" and 60 cm/23.6"); three different lengths; and can be dressed in a variety of fabrics and colors to match your existing workspace. You can also pin notes, pictures, or whatever you like into BuzziShield Desk to truly make it your own.

Design by BuzziSpace Studio

General

-  BuzziShield Desk
 - Upholstered acoustic foam element
-  Fix | Foot: powder coated metal in black (RAL 9005)
Fabrics: Fabric, Trevira CS|CS+, Revive 1, Velvet, Clara 2, Remix 3, Hero 2, Tonus 4, Memory 2
-  Dry use
 - Desk mounted
-  Flat packed
Preassembled

Acoustics



Content

Configurations	3
Fix overview	4
Fabrics	5
Dimensions	8
Acoustics	11

Configurations

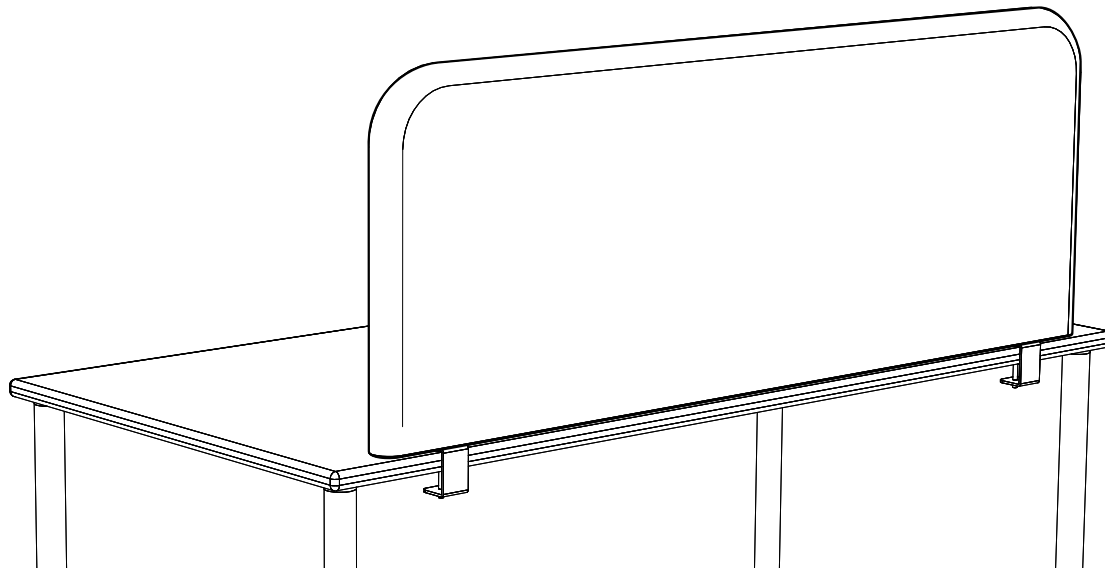

🔑 BuzziShield Desk

Upholstered acoustic foam element

🌲 Fix | Foot: powder coated metal in black (RAL 9005)

Fabrics: Fabric, Trevira CS|CS+, Revive 1, Velvet, Clara 2, Remix 3, Hero 2, Tonus 4, Memory 2

✂ Height: 40 cm, 60 cm | 15.75", 23.62"

Width: 60 cm, 100 cm, 140 cm | 23.62", 39.37", 55.12"

Panel

Height: 40 cm Width: 60 cm: 1,5 kg
 Height: 40 cm Width: 100 cm: 2,5 kg
 Height: 40 cm Width: 140 cm: 3,5 kg

Height: 15.75" Width: 23.62": 3.31 lbs
 Height: 15.75" Width: 39.37": 5.51 lbs
 Height: 15.75" Width: 55.12": 7.72 lbs



Height: 60 cm Width: 60 cm: 1,9 kg
 Height: 60 cm Width: 100 cm: 3,2 kg
 Height: 60 cm Width: 140 cm: 4,6 kg

Height: 23.62" Width: 23.62": 4.19 lbs
 Height: 23.62" Width: 39.37": 7.05 lbs
 Height: 23.62" Width: 55.12": 10.14 lbs

Fix

Foot 0,5 kg
 L 0,6 kg
 L-Plus 0,6 kg
 XL 0,7 kg

Foot 1.10 lbs
 L 1.32 lbs
 L-Plus 1.32 lbs
 XL 1.54 lbs

Fix Overview

BuzziShield Desk Fix is available in powder coated metal black (RAL 9005).
Use 2pcs/BuzziShield Desk

Foot

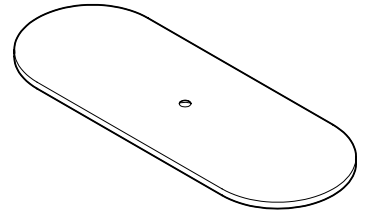
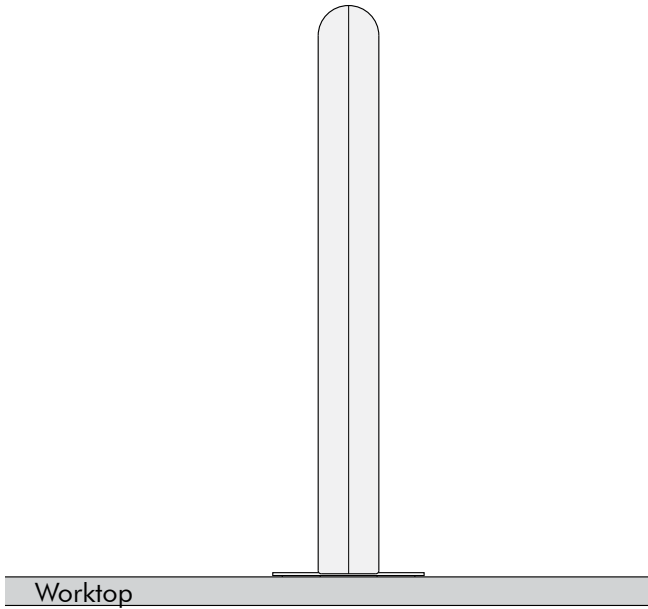

L | L-Plus | XL

L

Worktop: 12 > 27mm
0.47" > 1.06"

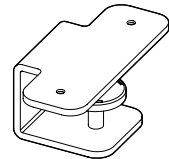

L-Plus

Worktop: 18 > 43mm
0.71" > 1.69"

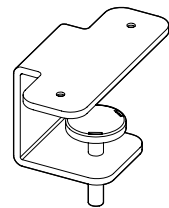

XL

Worktop: 28 > 57mm
1.10" > 2.24"

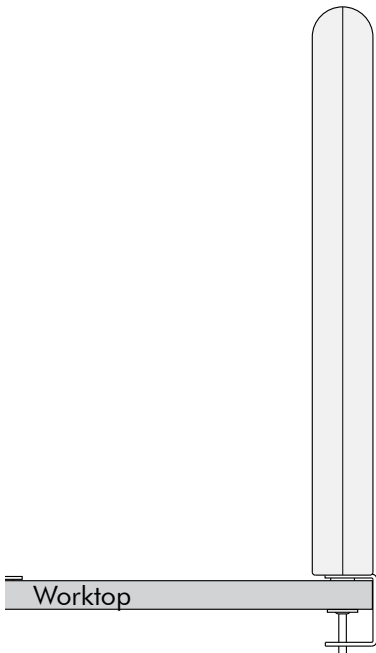
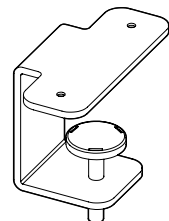

Fabrics

Fabric (45 colors)

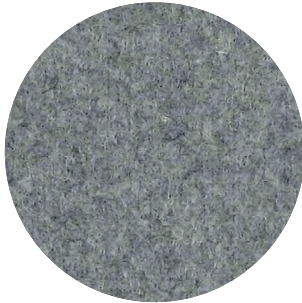

Category A

Composition 70% Recycled Wool, 25% Recycled Polyacryl,
5% Recycled Other Fabrics

Weight 405 g/m² | 11.94 oz/yd²

Abrasion resistance 40.000 Martindale, 50,000 Wyzenbeek

Flammability EU: EN 1021.1/2006 | BS EN 1021.1/2006 (cigarette).
EN 1021.2/2006 | BS EN 1021.2/2006 (match)
USA: CAL TB 117 | ASTM E84 CLASS A

Fastness to light EU: 4 | USA 4

Fastness to rubbing EU: Wet 3-4 | Dry 4-5

Fastness to crocking USA: Wet 5 | Dry 5



Trevira CS+ | CS (47 colors)

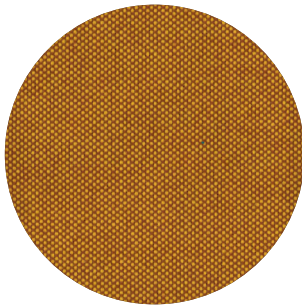

Category A

Weight 420 g/m² | 12.39 oz/yd²

Composition 100% Polyester, Trevira CS

Abrasion resistance 100.000 Martindale, 90,000 Wyzenbeek

Flammability BS 5852 part II: CRIB 5 | BS 7176 Medium Hazard
USA: CAL TB 117 | M1 | B1 | EN 1021/1-2 | C1 |
IMO Res. A652 (16)

Fastness to light EU: 6 | USA 5

Fastness to rubbing EU: Wet 4-5 | Dry 4-5

Fastness to crocking USA: Wet 5 | Dry 5



Revive 1 (25 colors)

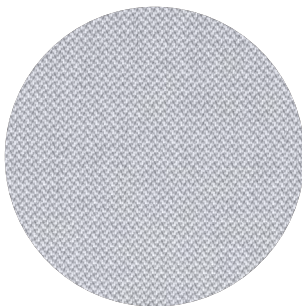

Category A

Composition 100% recycled polyester FR

Weight 430 g/lin.m

Abrasion resistance 60.000 Martindale rubs, EN ISO 12947

Flammability EN 1021-1/2 | DIN 4102 B1 | Önorm B1/Q1
UNI 9175 11M | US Cal. Tech. Bull. 117
IMO A.652 (16)

Fastness to light Note 5-7, ISO 105-B02

Fastness to rubbing (ISO) dry 5, wet 4-5

Pilling Note 4-5, EN ISO 12945



kvadrat

Velvet (12 colors)

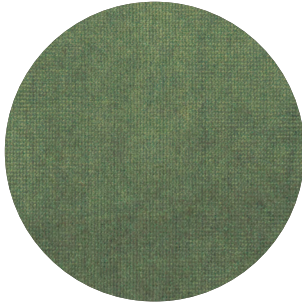

Category B
Composition 100% PES
Weight 375 g/m² | 11.06 oz/yd²
Abrasion resistance > 100.000 Martindale
Fastness to light EU: 4-5
Fastness to rubbing EU: Wet 4 | Dry 4-5
Pilling EU: 4-5

Clara 2 (24 colors)

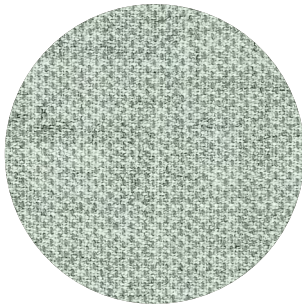

Category B
Composition 92% new wool, 8% nylon
Weight 400 g/lin.m
Abrasion resistance 80.000 Martindale rubs, EN ISO 12947
Flammability EN 1021-1/2 | BS 5852, ignition source 2-3 | DIN 4102 B2
NF D 60 013 | UNI 9175 11M | US Cal. Tech. Bull. 117, Sec. E
NFPA 260 | IMO A.652(16)
Fastness to light Note 5-7, ISO 105-B02
Fastness to rubbing (ISO) dry 4-5, wet 4
Pilling Note 4, EN ISO 12945



kvadrat

Remix 3 (73 colors)



Category B
Composition 90% new wool, 10% nylon
Weight 415 g/lin.m
Abrasion resistance 100.000 Martindale rubs, EN ISO 12947
Flammability EN 1021-1/2 | BS 5852 part 1
Önorm B1/Q1 | NF D 60 013 | UNI 9175, 11M
AS/NZS 1530.3 | Cal. Tech. Bull. 117-2013
NFPA 260 | IMO FTP Code 2010:Part 8
Fastness to light Note 5-7, ISO 105-B02
Fastness to rubbing (ISO) dry 4-5, wet 4
Pilling Note 4, EN ISO 12945



kvadrat

Hero 2 (33 colors)

kvadrat

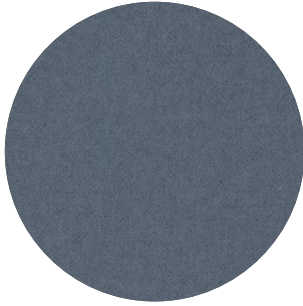

Category C

Composition 97% new wool, 3% nylon

Weight 580 g/lin.m

Abrasion resistance 45.000 Martindale rubs, EN ISO 12947

Flammability EN 1021-1/2 | DIN 4102 B2 | NF D 60 013

UNI 9175 1IM | US Cal. Bull. 117-2013 | NFPA 260

IMO A.652 (16)

Fastness to light Note 5-6, ISO 105-B02

Fastness to rubbing (ISO) dry 4-5, wet 4-5

Pilling Note 3-4, EN ISO 12945



Tonus 4 (47 colors)

kvadrat



Category D

Composition 90% new wool, 10% Helanca

Weight 665 g/lin.m

Abrasion resistance 100.000 Martindale rubs, EN ISO 12947

Flammability EN 1021-1/2 | BS 5852 part 1 | DIN 4102 B2

Önorm B1/Q1 | NF D 60 013 | UNI 9175 1IM

US Cal. Bull. 117-2013 | NFPA 260 | IMO A.652 (16)

Fastness to light Note 5-7, ISO 105-B02

Fastness to rubbing (ISO) dry 3-5, wet 3-5

Pilling Note 3, EN ISO 12945



Memory 2 (20 colors)

kvadrat

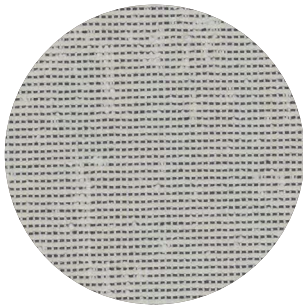

Category E

Composition 100% Trevira CS

Weight 700 g/lin.m

Abrasion resistance

35.000 rubs acc. to the Martindale method, EN ISO 12947

Flammability EN 1021-1/2 | DIN 4102 B1 | Önorm B1/Q1

NF D 60 013 | NF P 92 507 M1 | UNI 9175 1IM

UNI 9177 classe 1 | US Cal. Tech. Bull. 117

IMO A.652 (16)

Fastness to light Note 5-8, ISO 105-B02

Fastness to rubbing (ISO) dry 4-5, wet 4-5

Pilling Note 4, EN ISO 12945



Dimensions

Panel

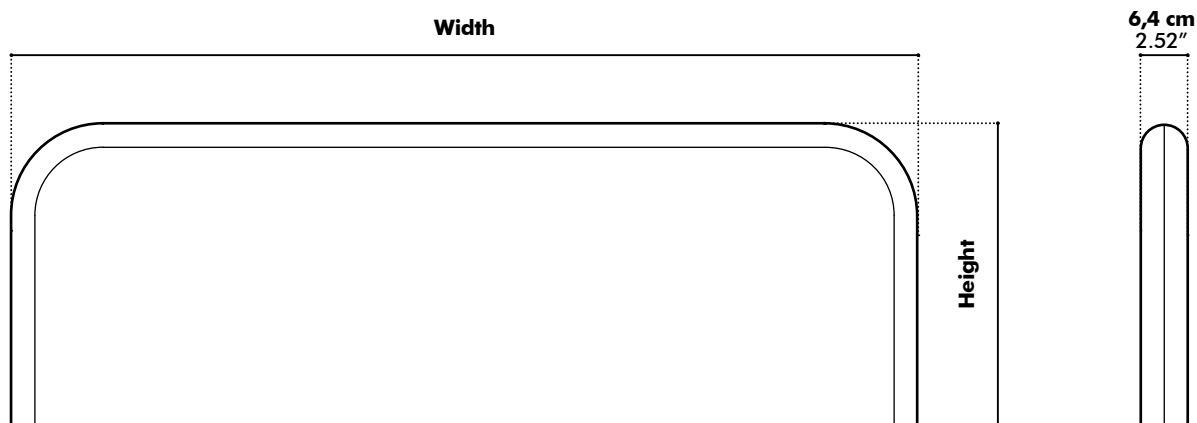
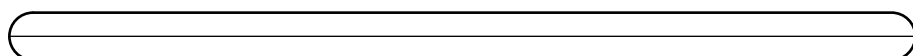

Height 40 cm, 60 cm | 15.75", 23.62"

Width 60 cm, 100 cm, 140 cm | 23.62", 39.37", 55.12"

Fix Foot

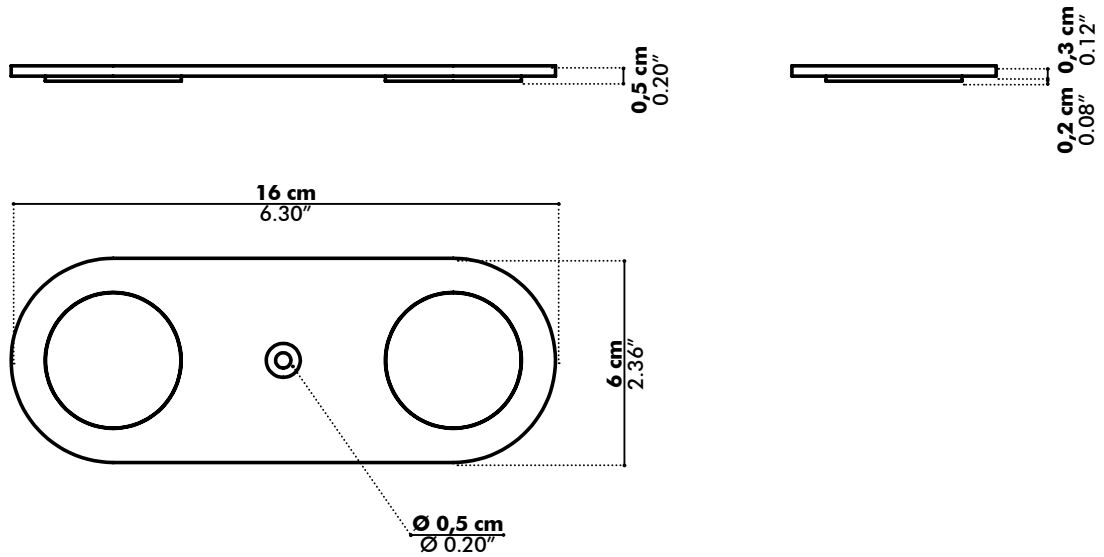

Fix L Worktop: 12 > 27mm | 0.47" > 1.06"

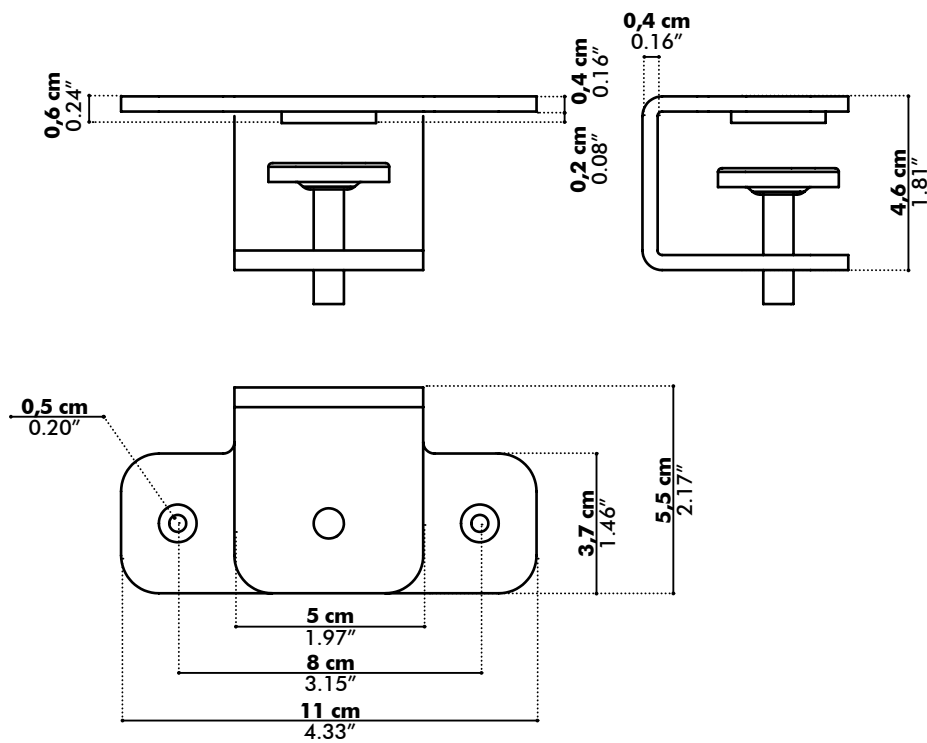

Fix L-Plus Worktop: 18 > 43mm | 0.71" > 1.69"

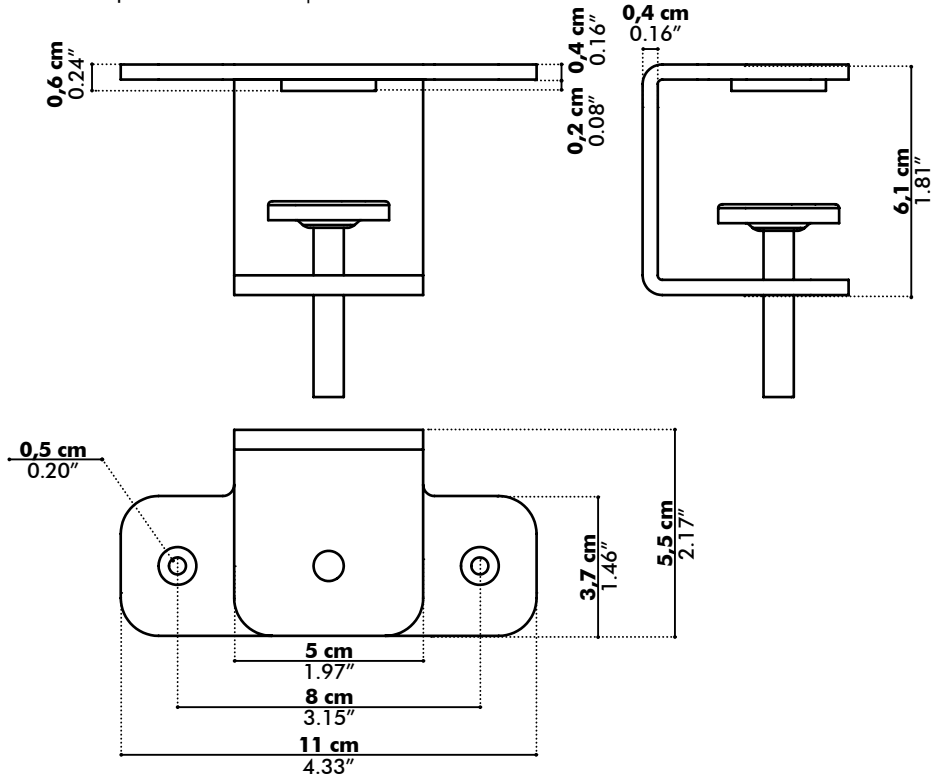

Fix XL Worktop: 28 > 57mm | 1.10" > 2.24"

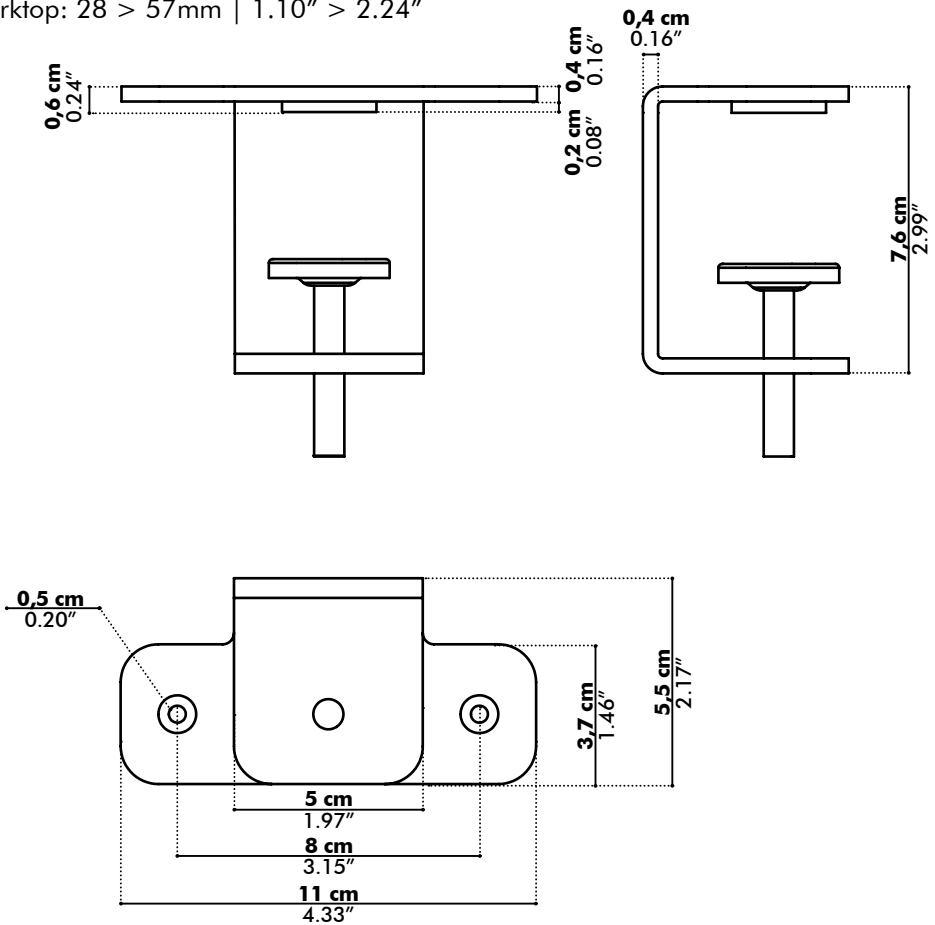

Acoustics

BuzziShield Desk Height 40 cm | 15.75"

Equivalent sound absorption area in m² per object

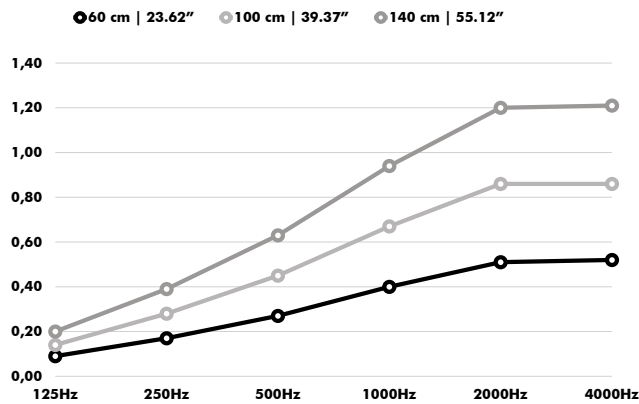

Hz	Width 60 cm 23.62" Aeq/m ²	Width 100 cm 39.37" Aeq/m ²	Width 140 cm 55.12" Aeq/m ²
125	0.09	0.14	0.20
250	0.17	0.28	0.39
500	0.27	0.45	0.63
1000	0.40	0.67	0.94
2000	0.51	0.86	1.20
4000	0.52	0.86	1.21

BuzziShield Desk Height 60 cm | 23.62"

Equivalent sound absorption area in m² per object

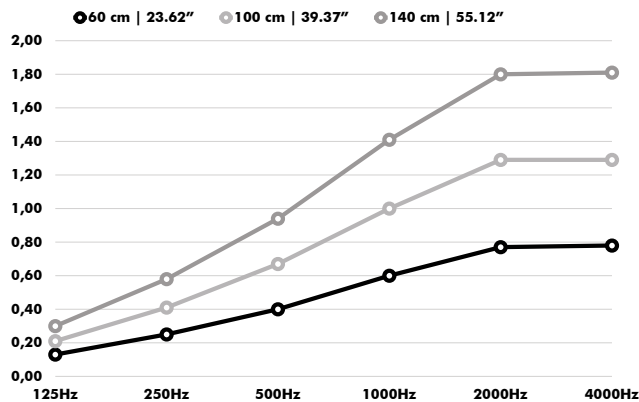

Hz	Width 60 cm 23.62" Aeq/m ²	Width 100 cm 39.37" Aeq/m ²	Width 140 cm 55.12" Aeq/m ²
125	0.13	0.21	0.30
250	0.25	0.41	0.58
500	0.40	0.67	0.94
1000	0.60	1.00	1.41
2000	0.77	1.29	1.80
4000	0.78	1.29	1.81