

**BuzziJet Square Ceiling Suspended S|M**  
**Ceiling Mounted S|M**

INSTALLATION MANUAL  
220-240V

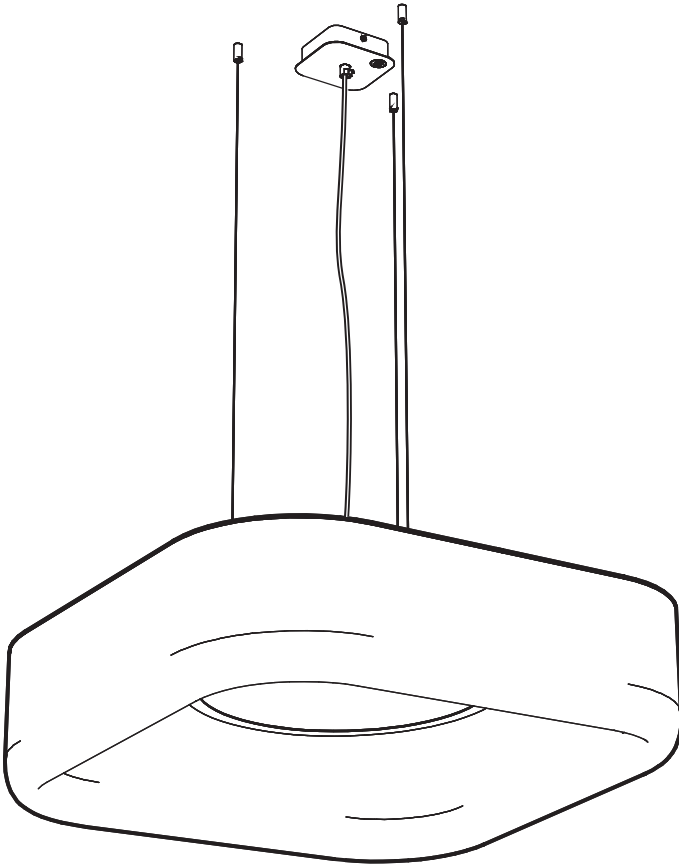

## Technical info

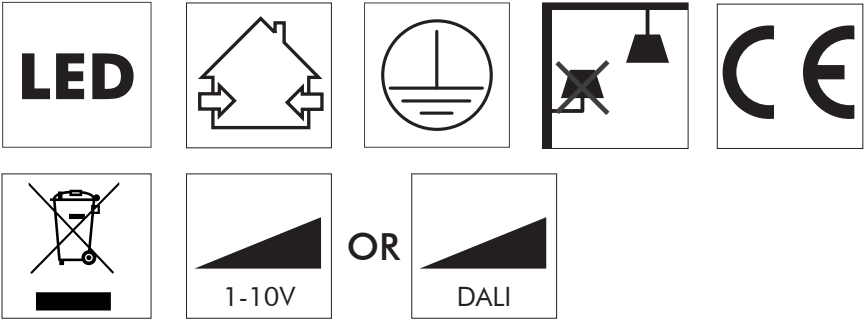

## Environmental Protection

Waste electrical products should not be disposed of with household waste. Please recycle where facilities exist. Check with your Local Authority or retailer for recycling advice.

**⚠** The light source of this luminaire is not replaceable; when the light source reaches its end of life the whole luminaire shall be replaced.

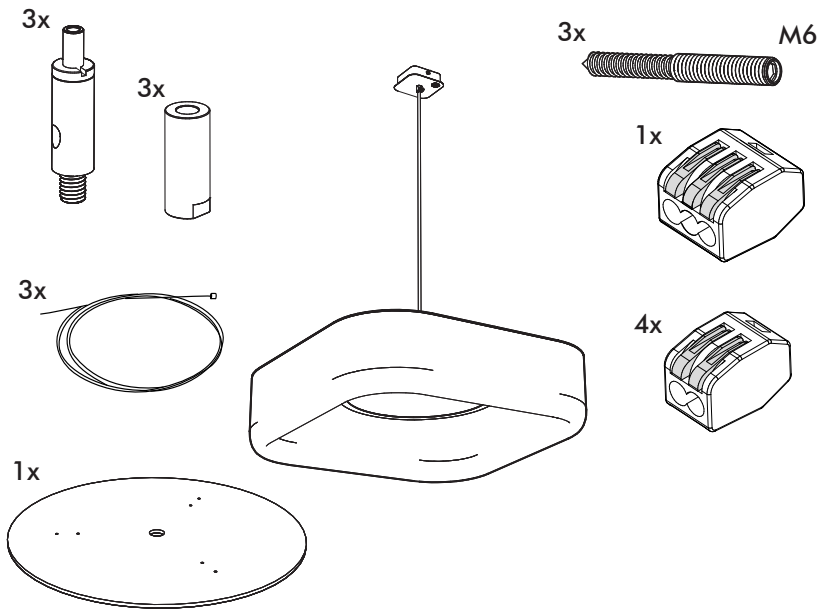

**Excluded**

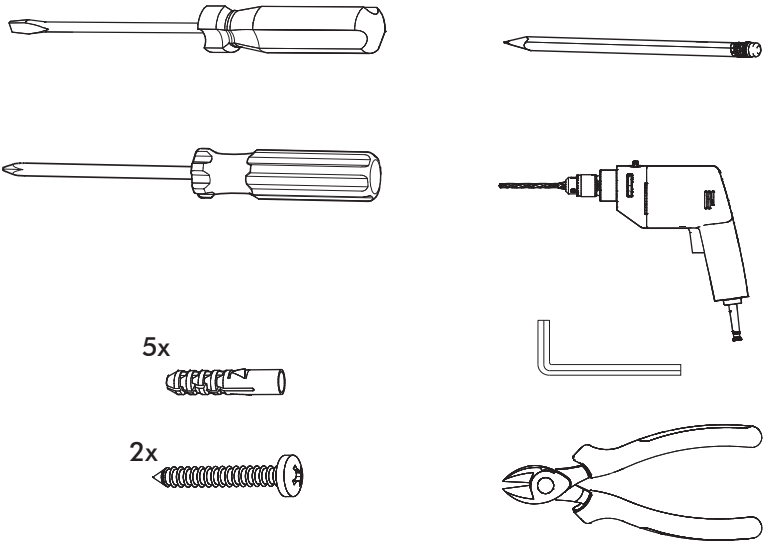

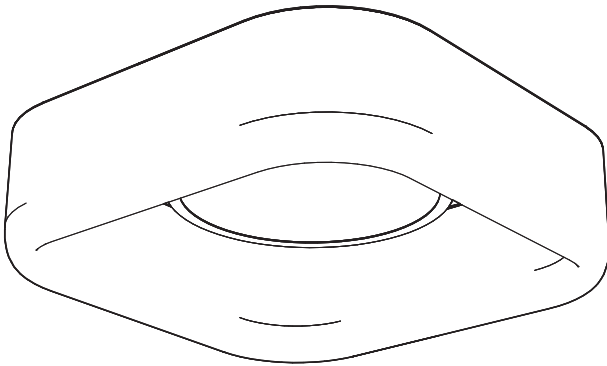

1x

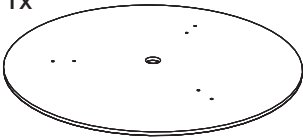

3x



**Excluded**

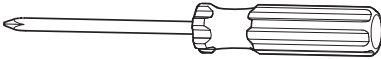

3x



3x

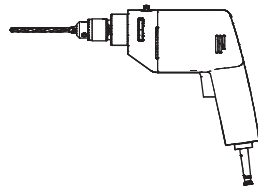

# BuzziJet Square Ceiling Suspended Straight

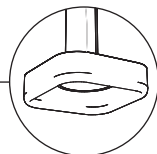

2 PERS. 

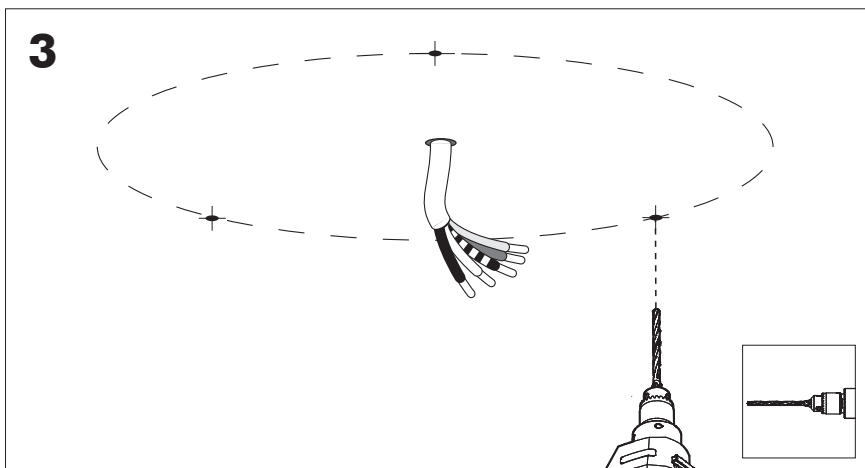
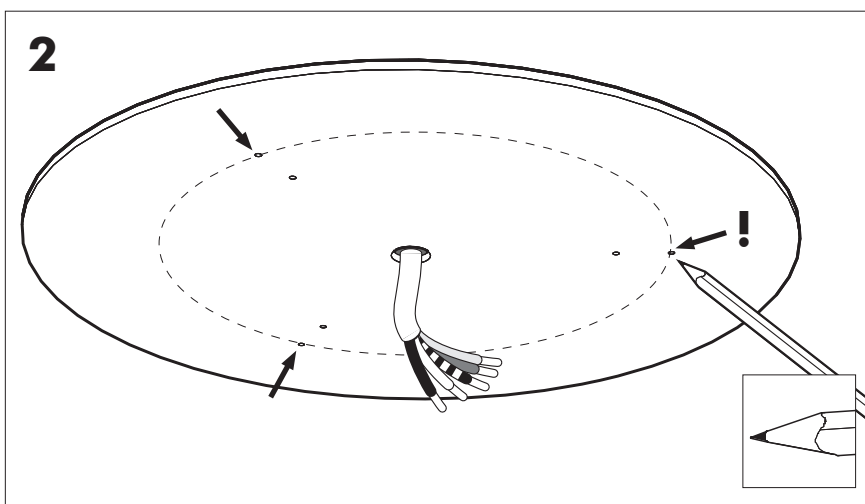
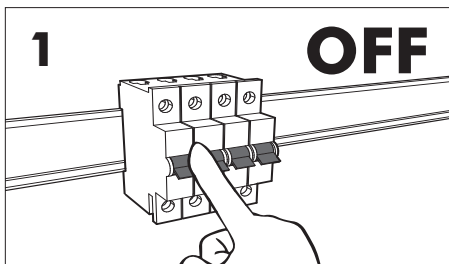

**4**

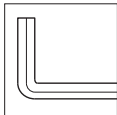

**5**

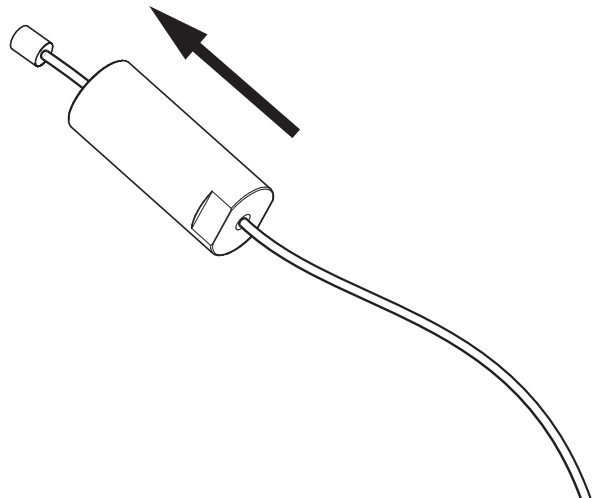
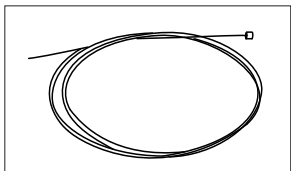

**6**

6

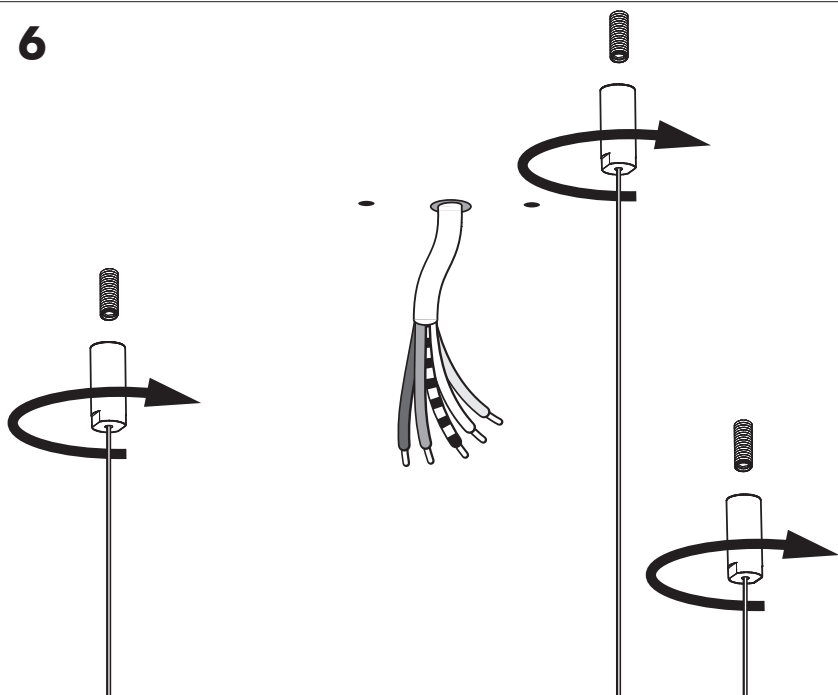

7

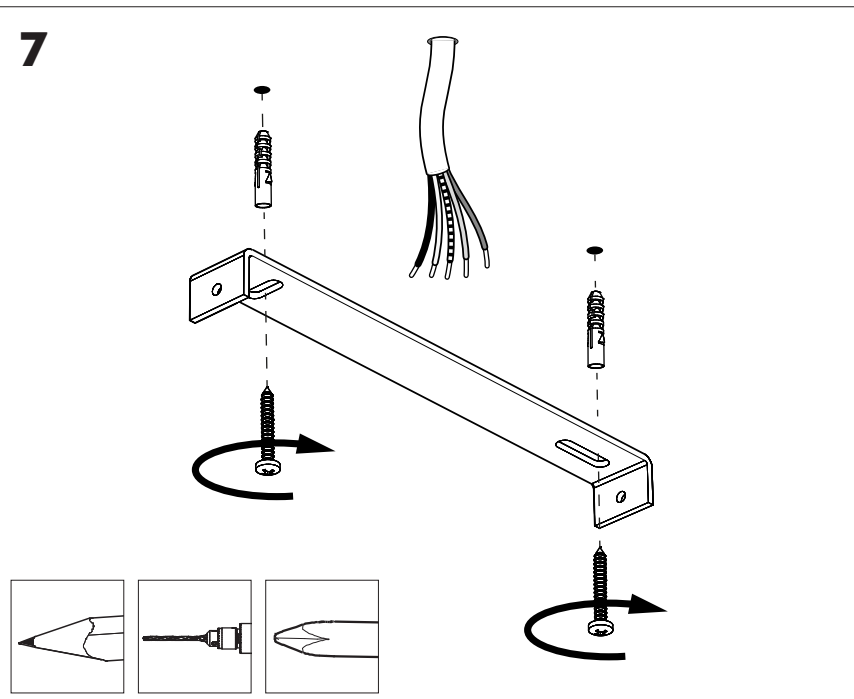

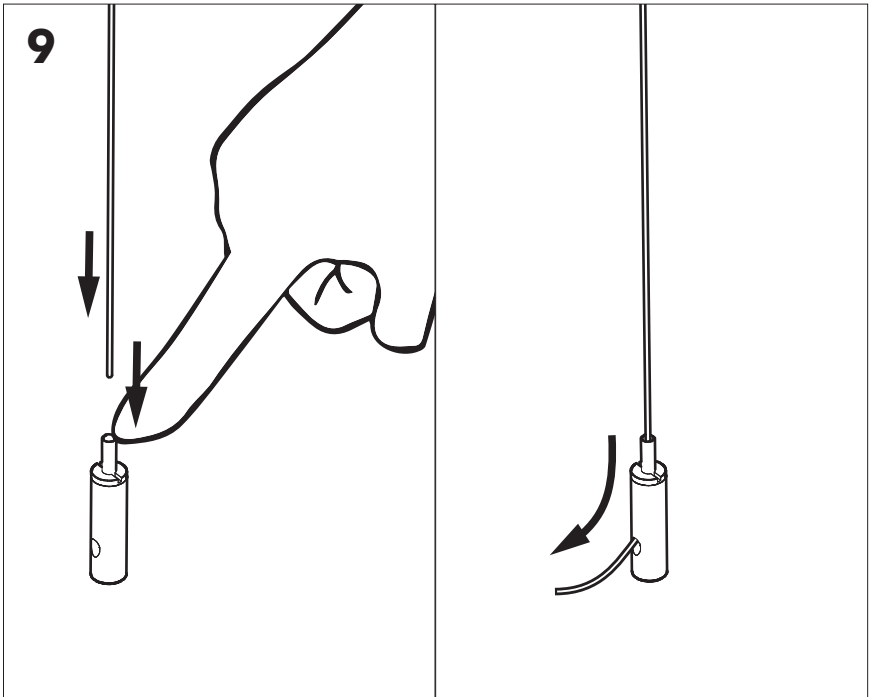
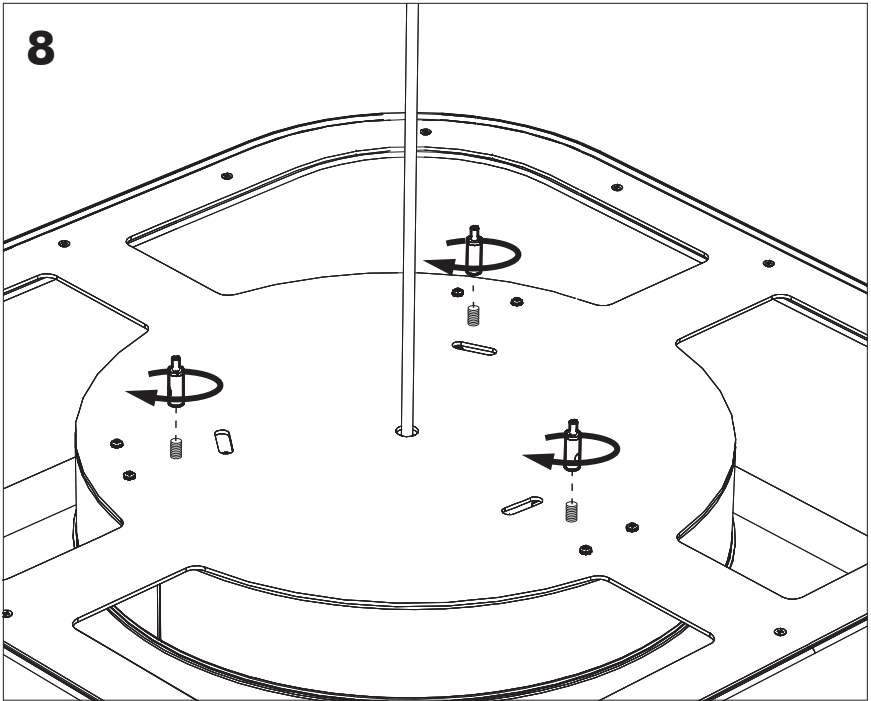



# 10a

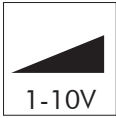

1-10V



DALI



DMX



DST

Connection including dimmable function



1-10V

Dim+

Dim-

Blue	Neutral
Brown	Line
Green/Yellow	Ground
White	DIM -
Black	DIM +

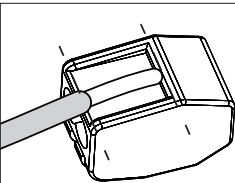

Strip conductor  
to  $\pm 10 \text{ mm}$  |  $\pm 0.4''$

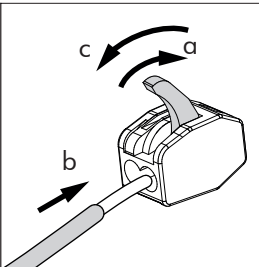

# 10b Connection excluding dimmable function

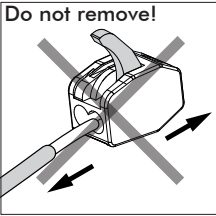
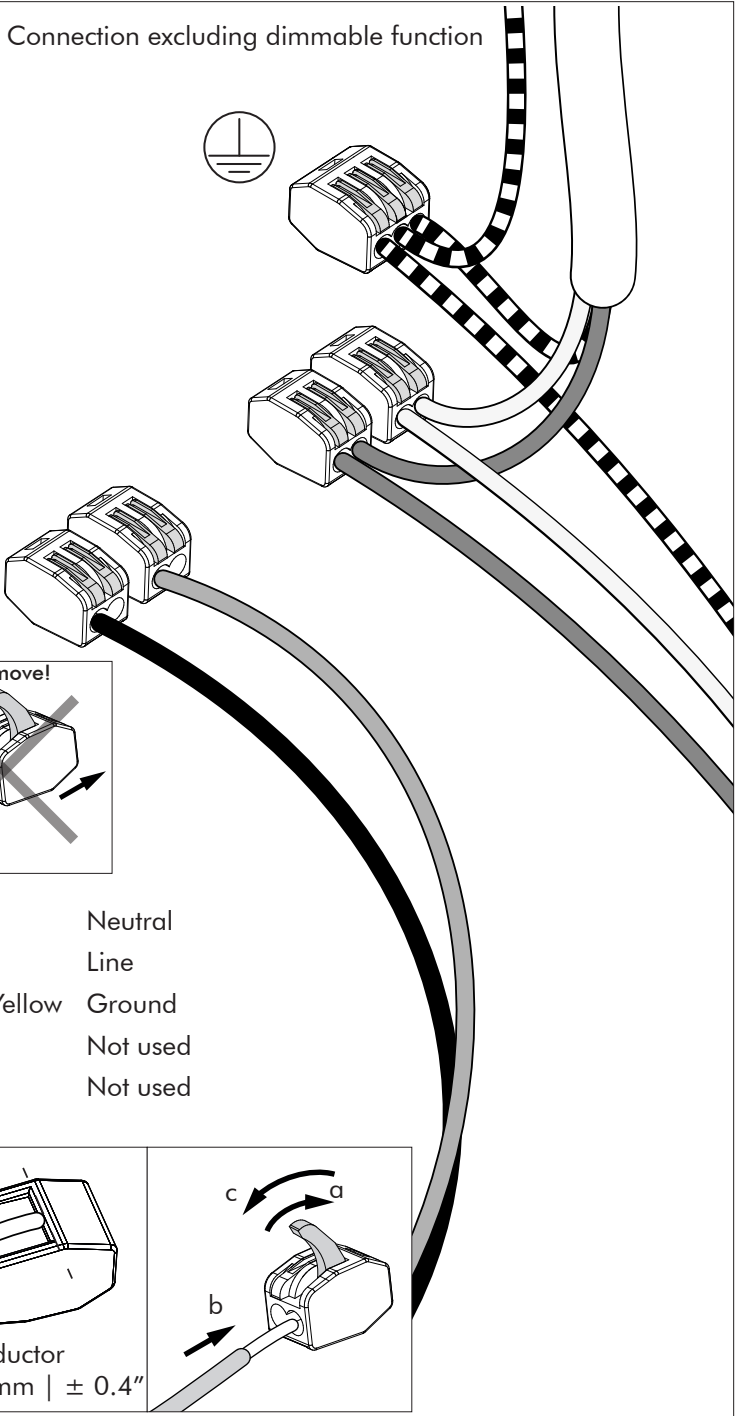

Blue	Neutral
Brown	Line
Green/Yellow	Ground
White	Not used
Black	Not used

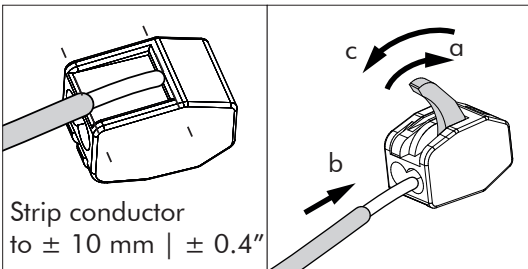

11

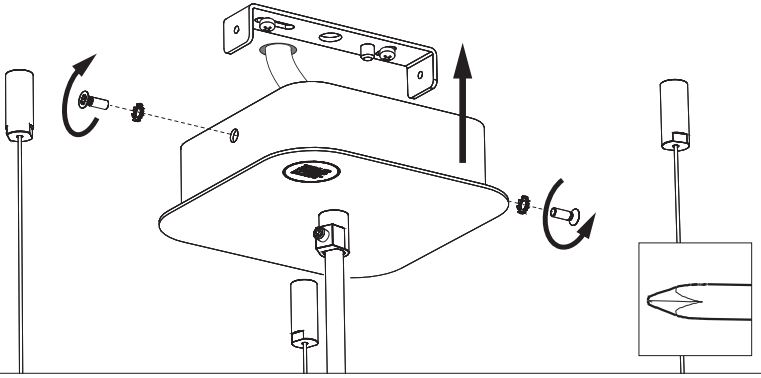

!

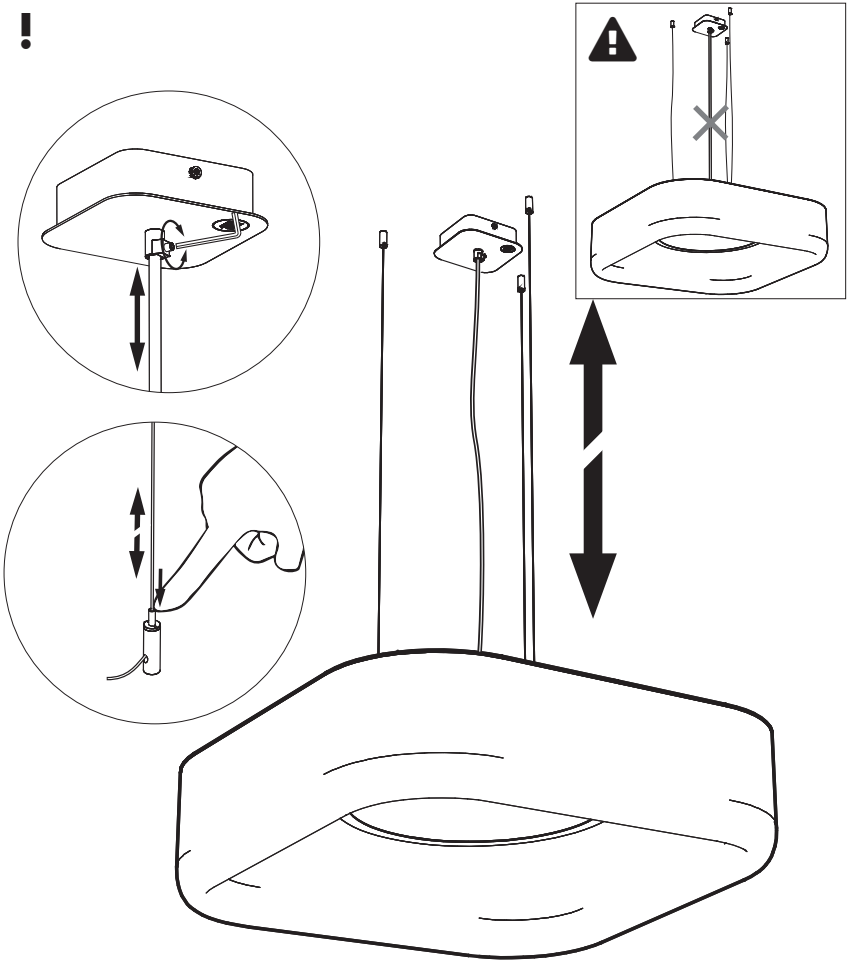

# BuzziJet Square Ceiling Mounted

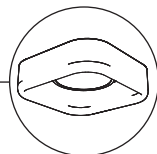

1 PERS. 

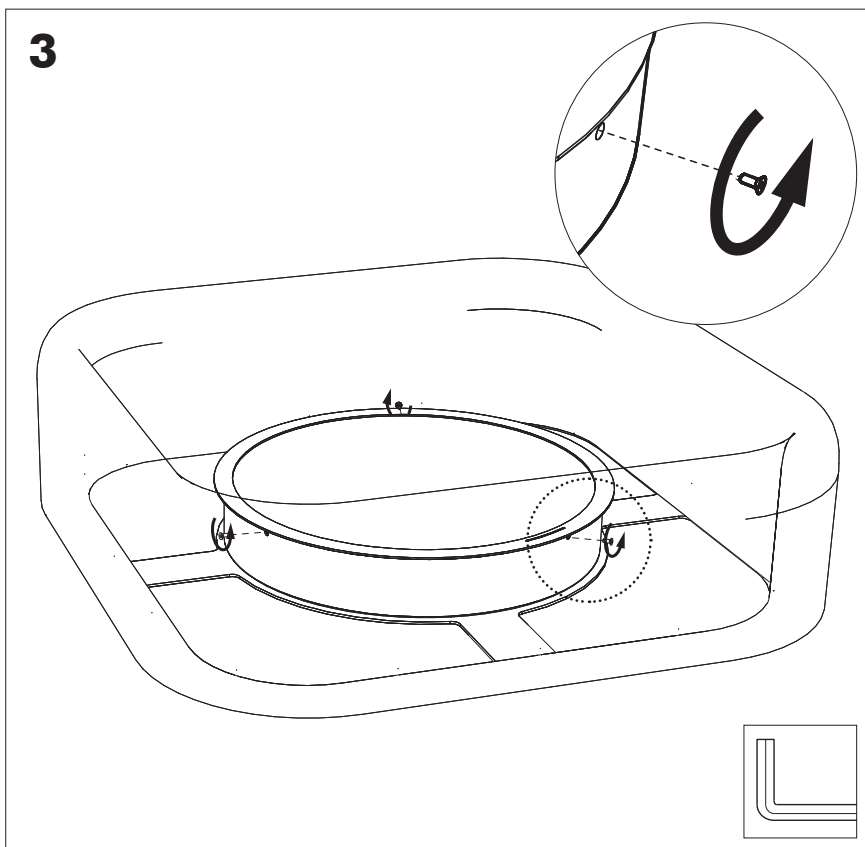
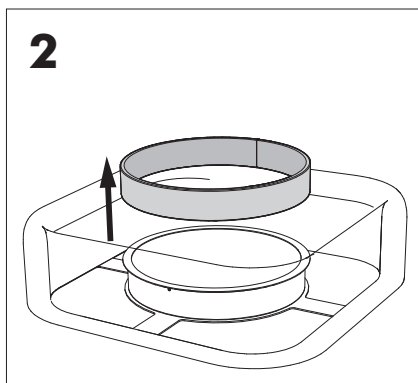
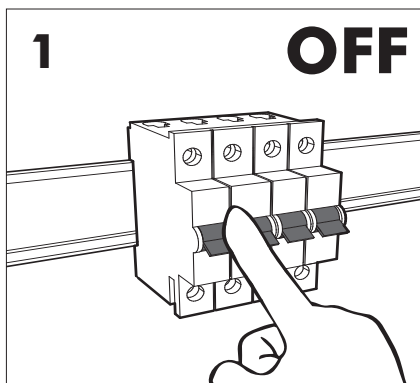

4

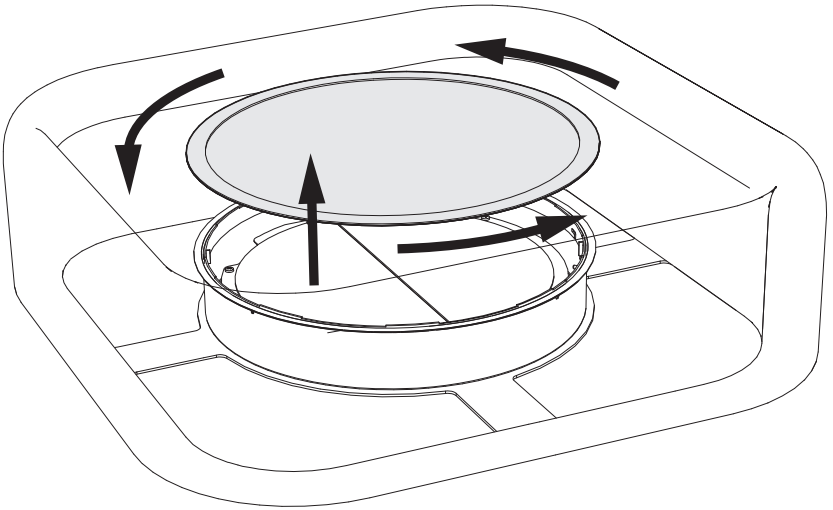

5

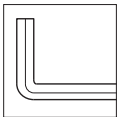
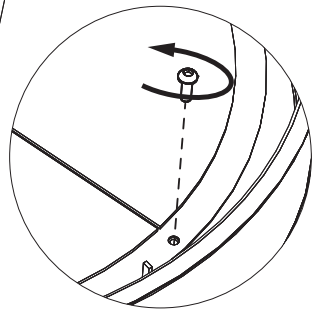
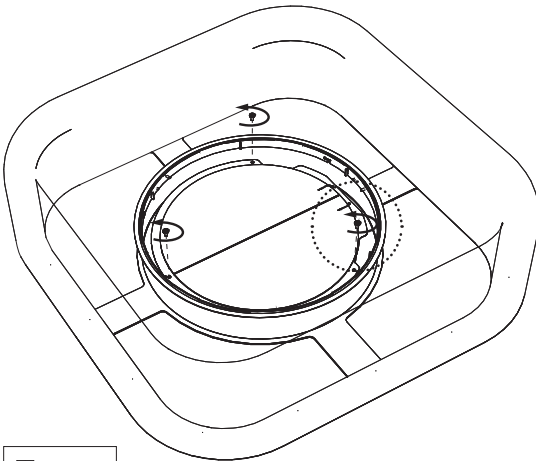

6

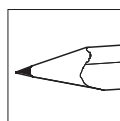
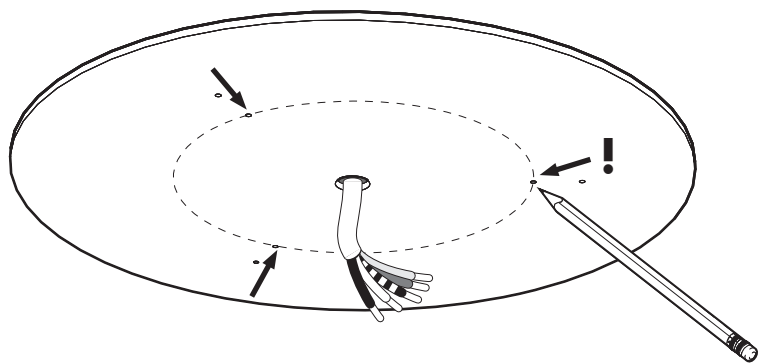

7

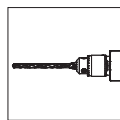
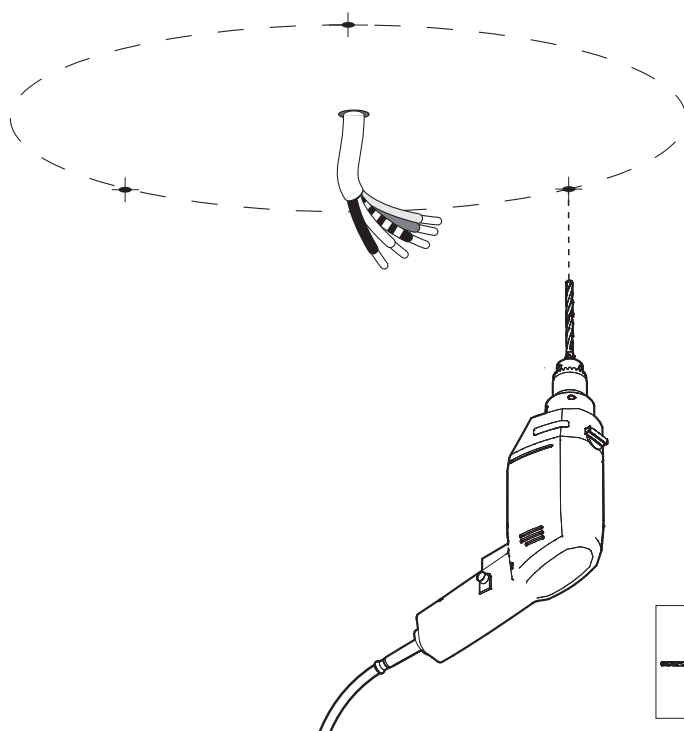

# 8a

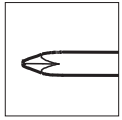
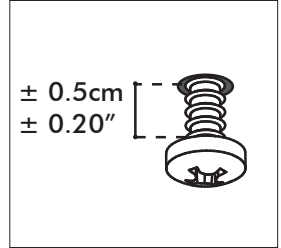
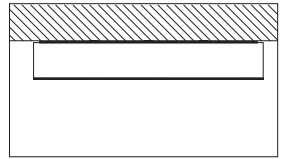
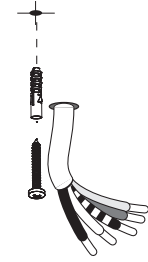

# 8b

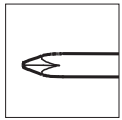
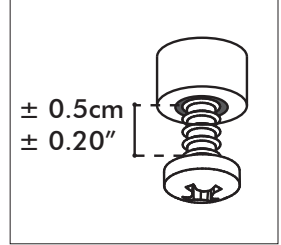
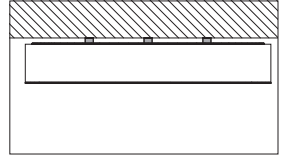
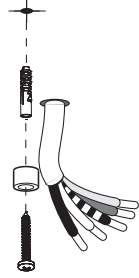

9a

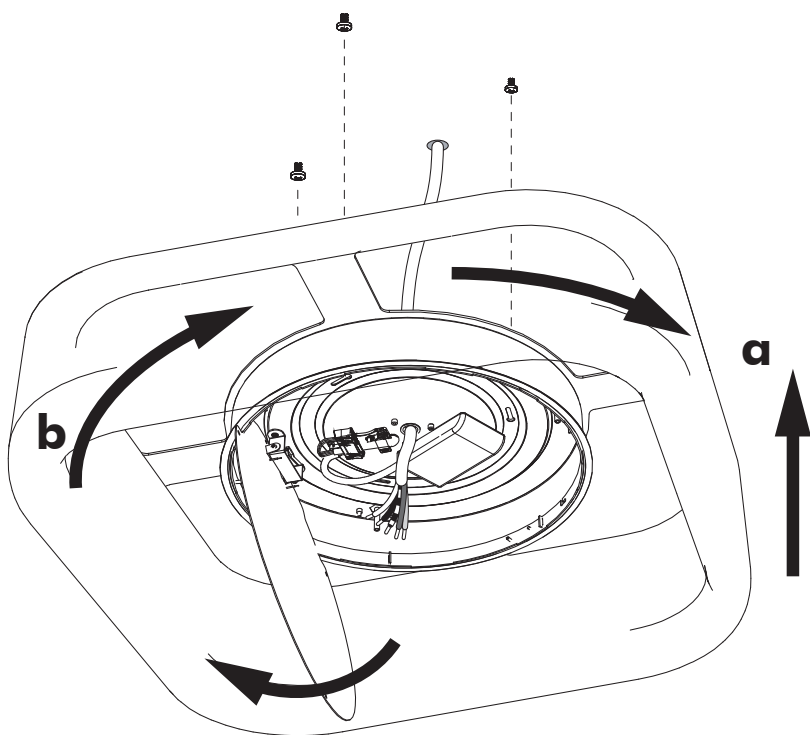
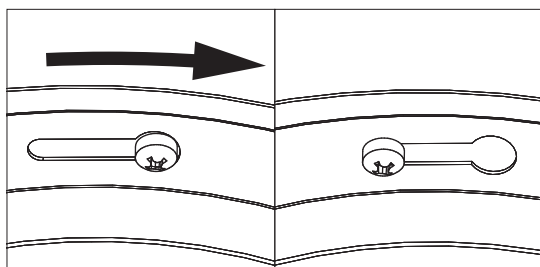



**9b**

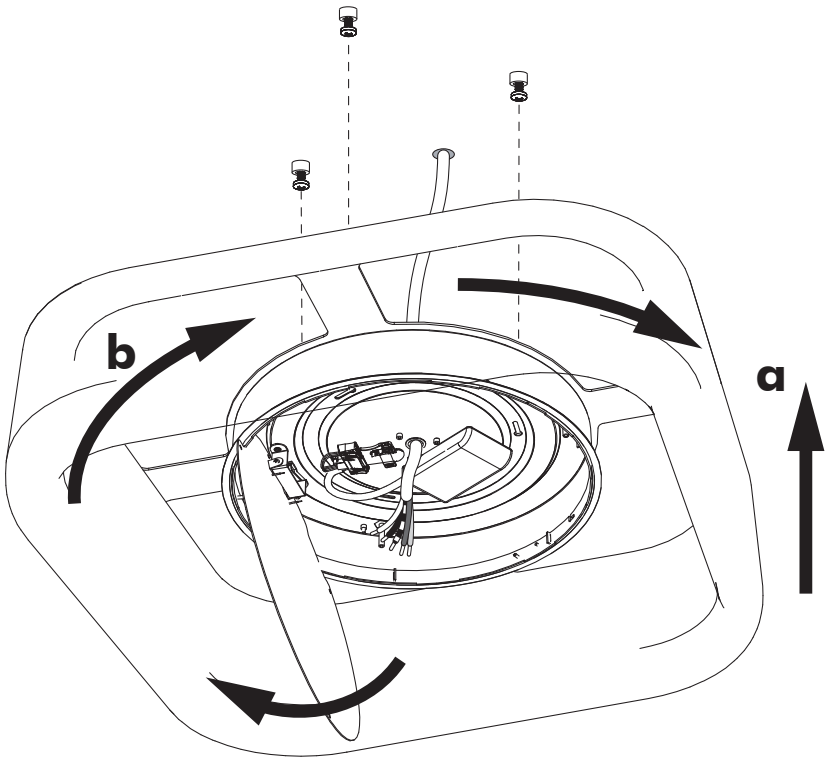
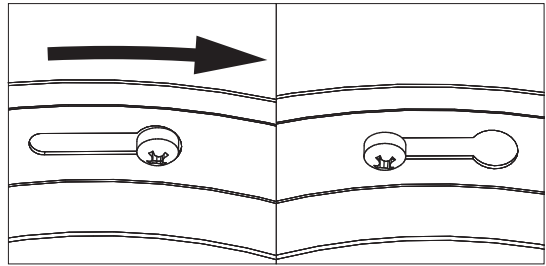

10

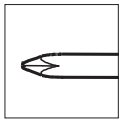
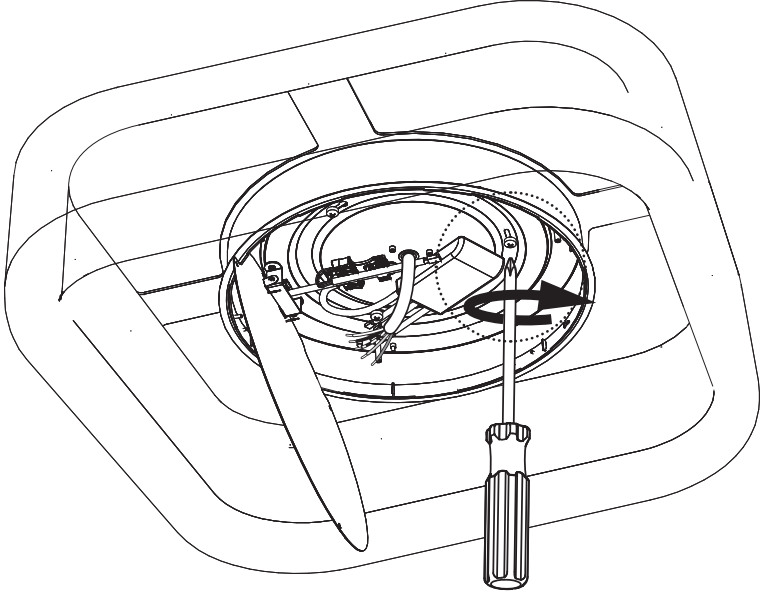

# 11a



Connection including dimmable function

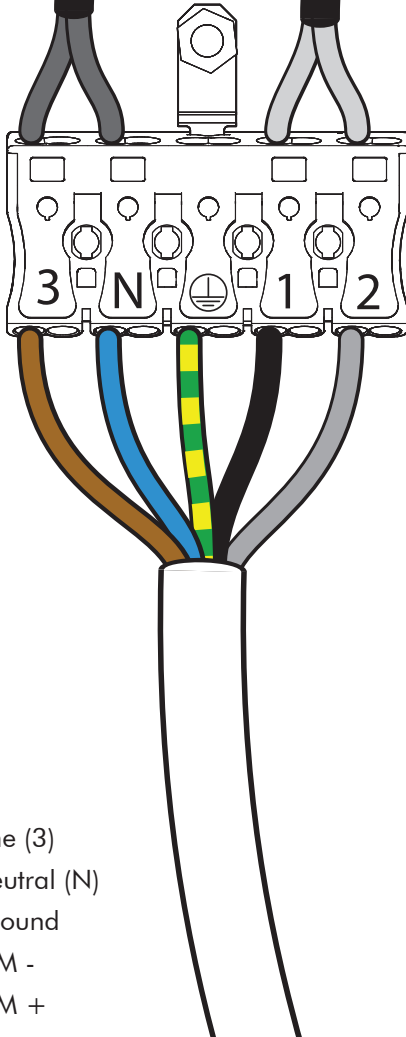

- |       |             |
|-------|-------------|
| Brown | Line (3)    |
| Blue  | Neutral (N) |
| Green | Ground      |
| Black | DIM -       |
| Grey  | DIM +       |

# 11b Connection excluding dimmable function

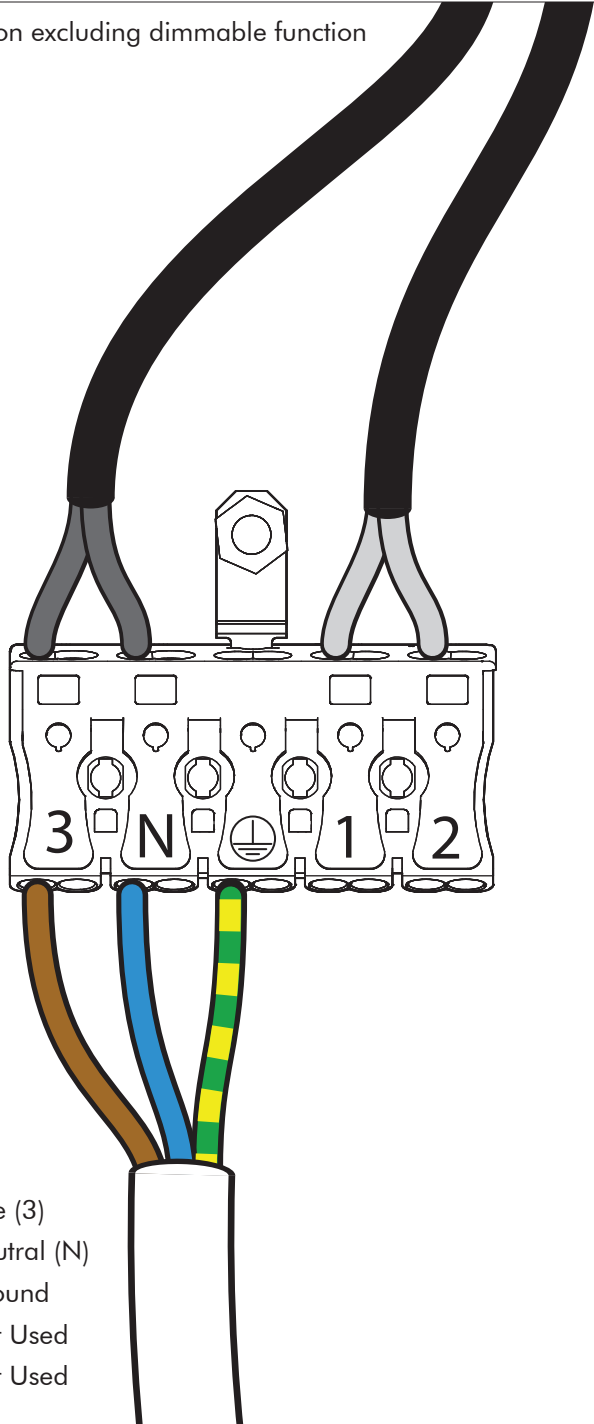

- |       |             |
|-------|-------------|
| Brown | Line (3)    |
| Blue  | Neutral (N) |
| Green | Ground      |
| 1     | Not Used    |
| 2     | Not Used    |

**12**

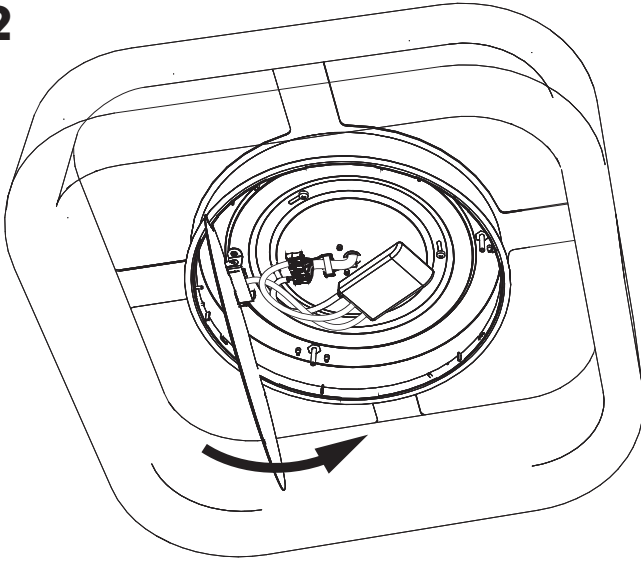

**DO NOT  
TOUCH LED**

**! Make sure wires are not pinched in-between during this step !  
! Assurez-vous que les fils ne sont pas pincés pendant cette étape !**

**13**

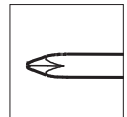
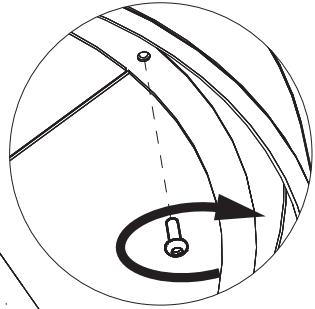
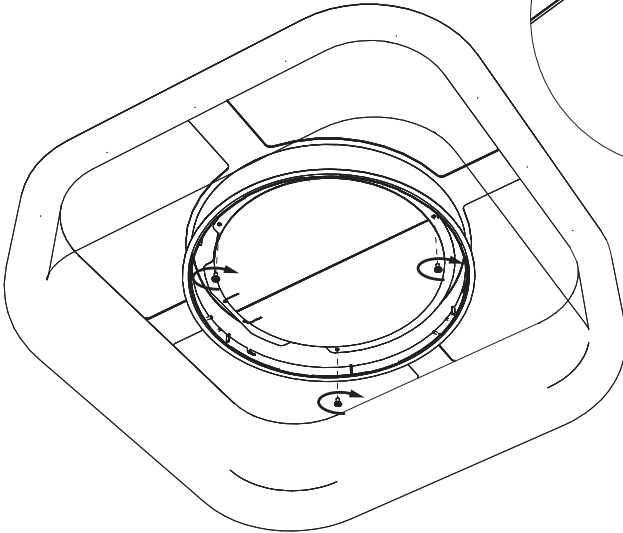

**14**

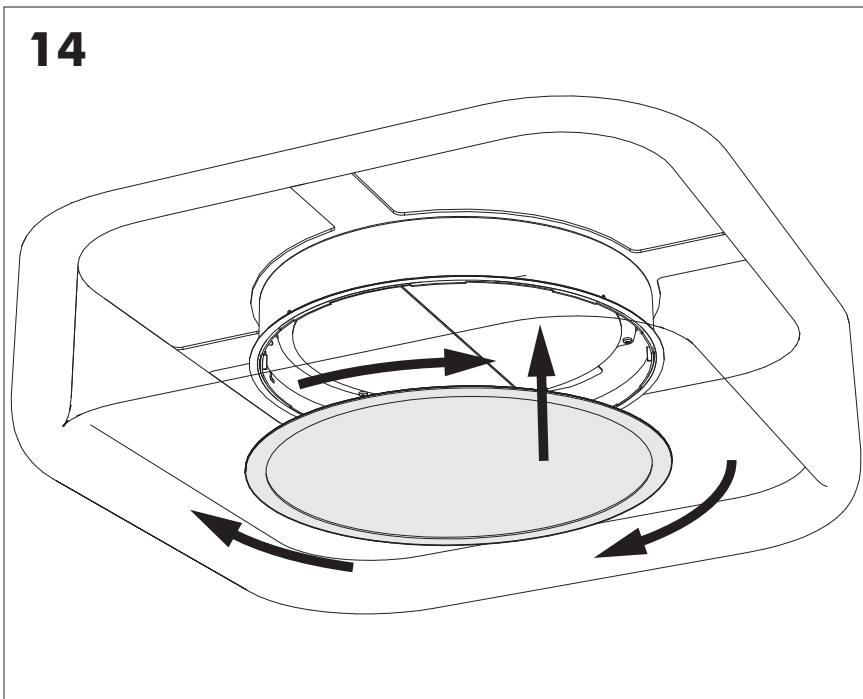

**15**

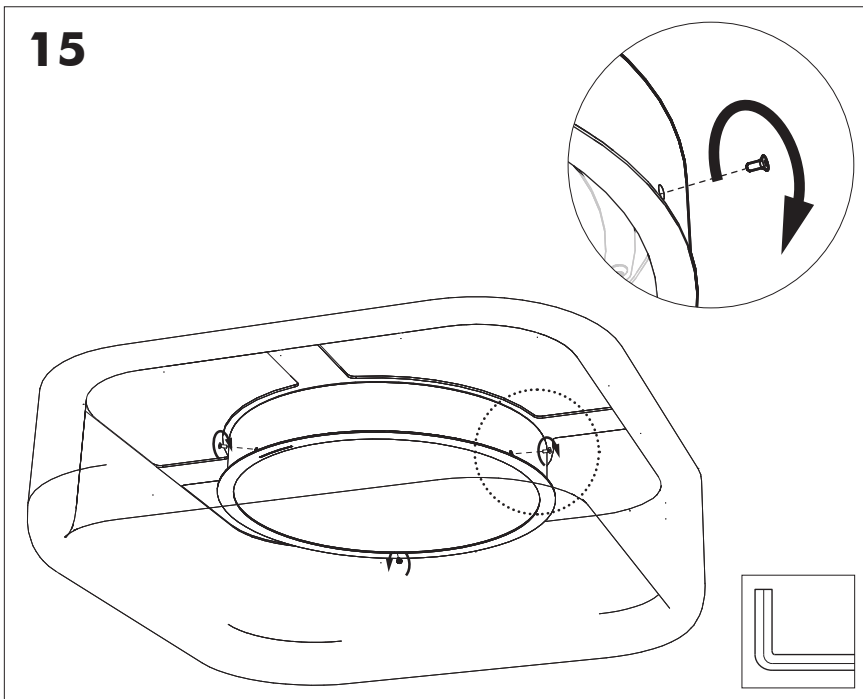

16

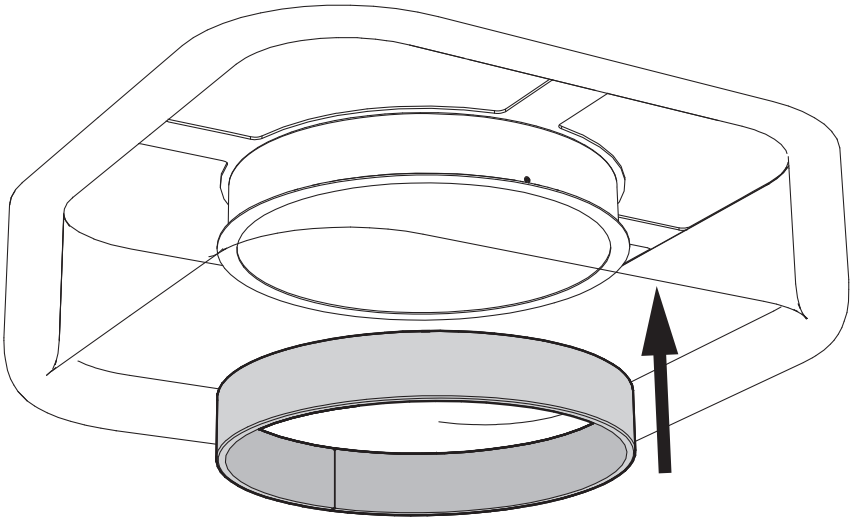

BuzziSpace Group NV  
Italiëlei 8, 2000 Antwerp  
Belgium

☎ +32 (0)3 846 10 00

✉ [info@buzzi.space](mailto:info@buzzi.space)

🌐 [www.buzzi.space](http://www.buzzi.space)

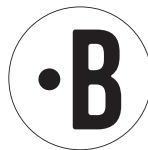

A-0000007882/01  
Last update: 30/11/2023