

# BuzziTube

## INSTALLATION MANUAL

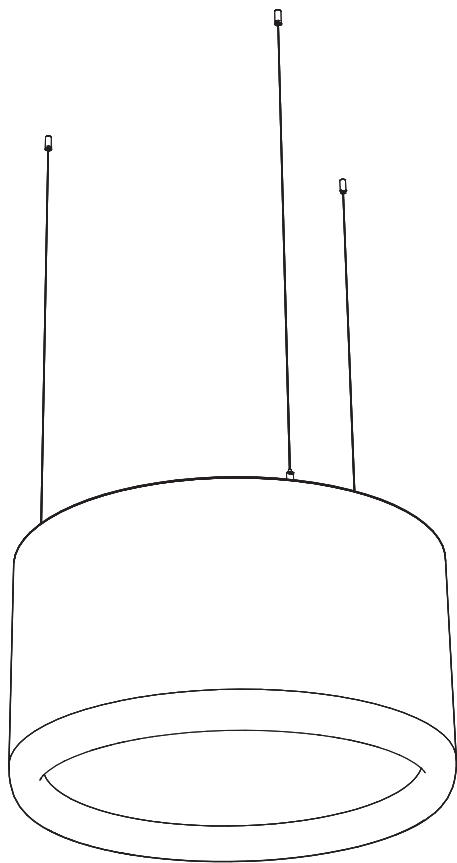

**⚠** The installer is responsible for selecting the right plug, for a secure mounting of the product.  
Taking into account the weight of the product and the material of the mounting surface.

## Excluded

---

Straight 3x  
Split 1x

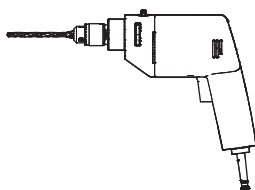
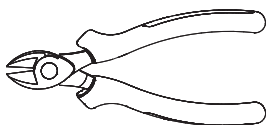

## Included BuzziTube Straight

p.4

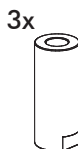
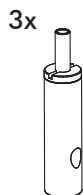
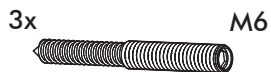
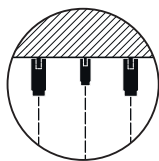
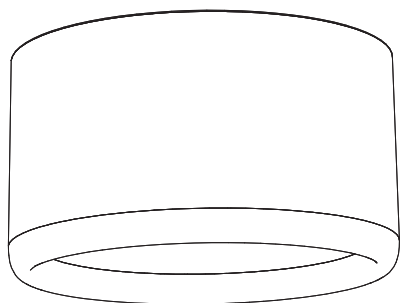

## Included BuzziTube Split (Only For S|M)

p.9

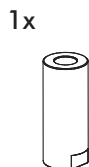
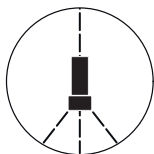
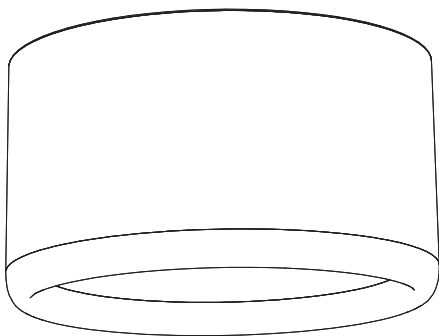
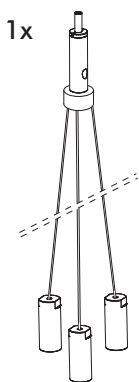

# BuzziTube Straight

2 PERS. 

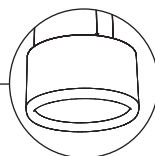

1

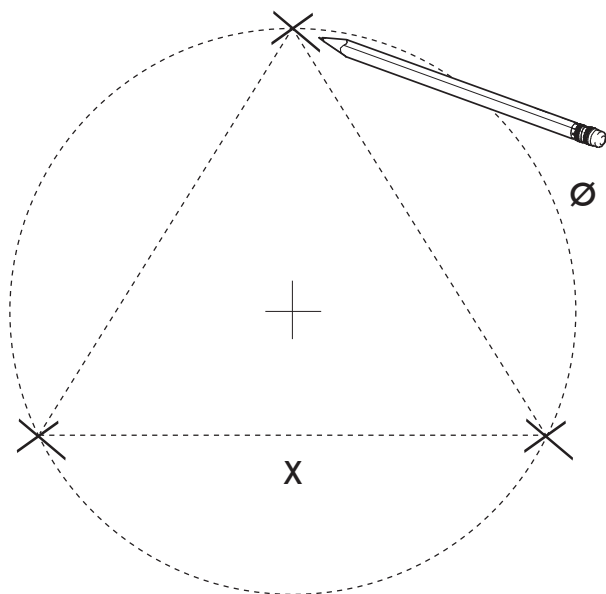

S   M:	X: 64 cm	Ø: 73,5 cm
	X: 25.20"	Ø: 28.94"
L   XL :	X: 98 cm	Ø: 113,5 cm
	X: 38.58"	Ø: 44.69"
XXL:	X: 124 cm	Ø: 143,5 cm
	X: 48.82"	Ø: 56.50"

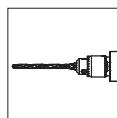
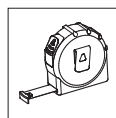
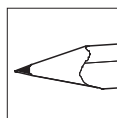

**2**

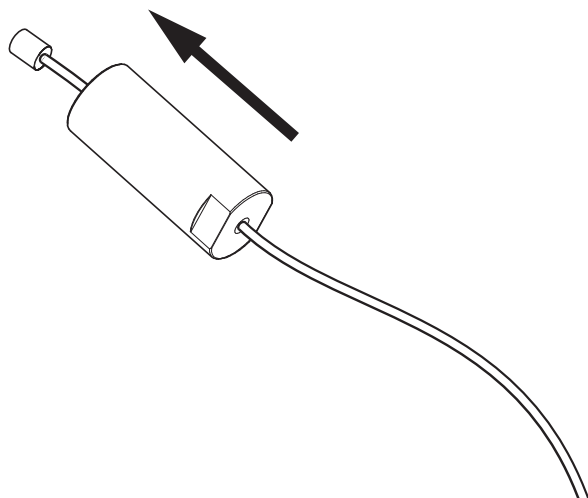
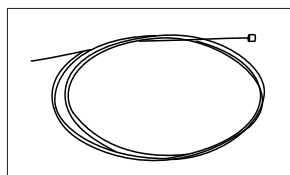

**3**

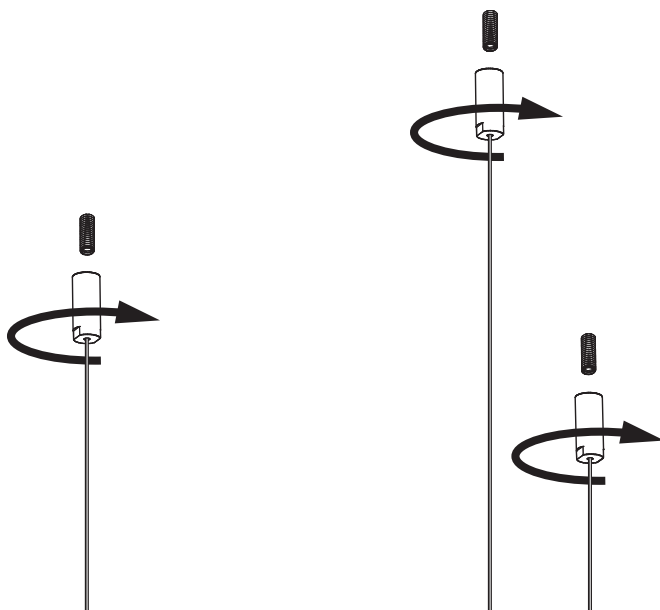

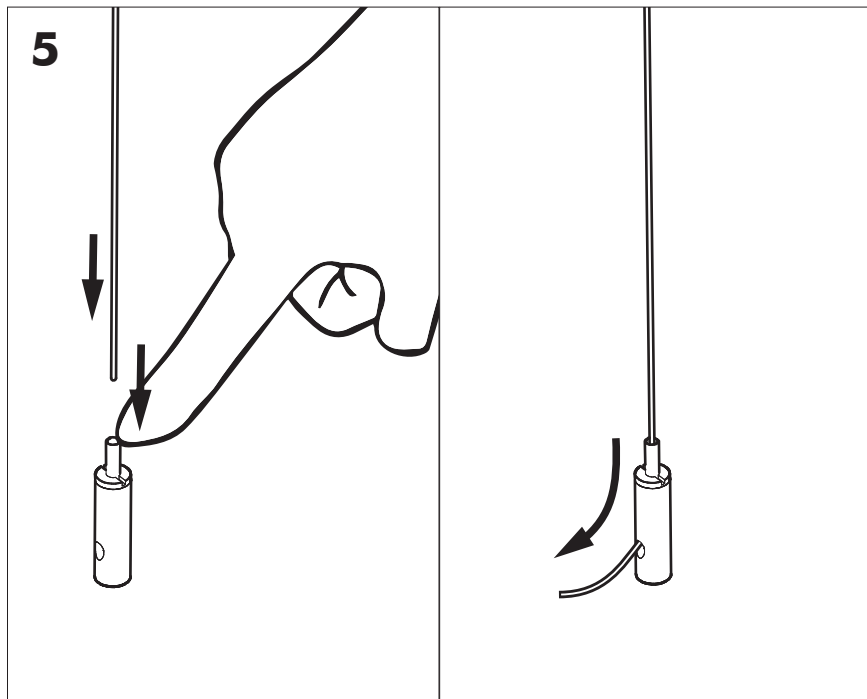
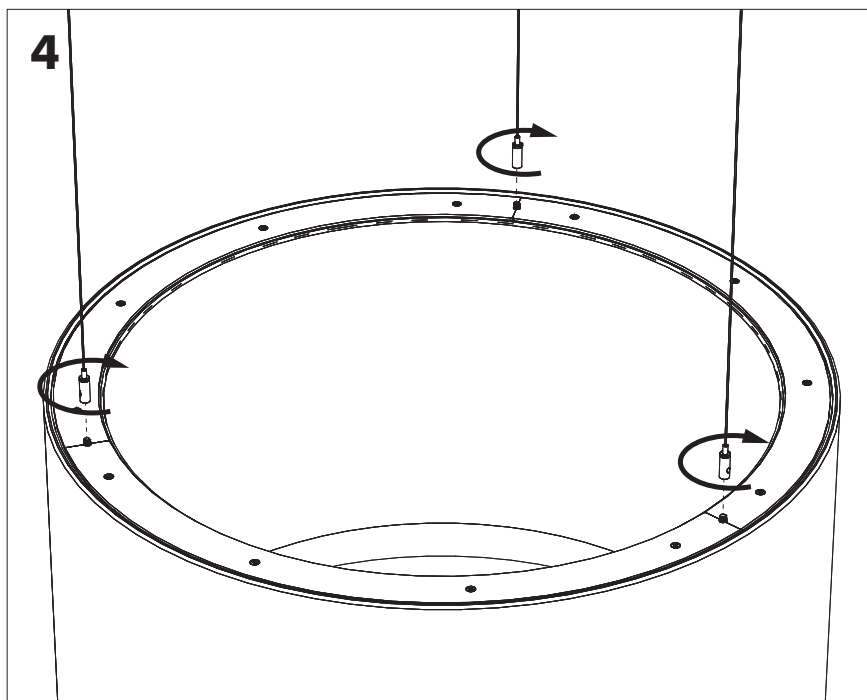

!

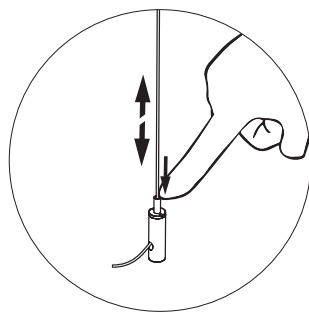
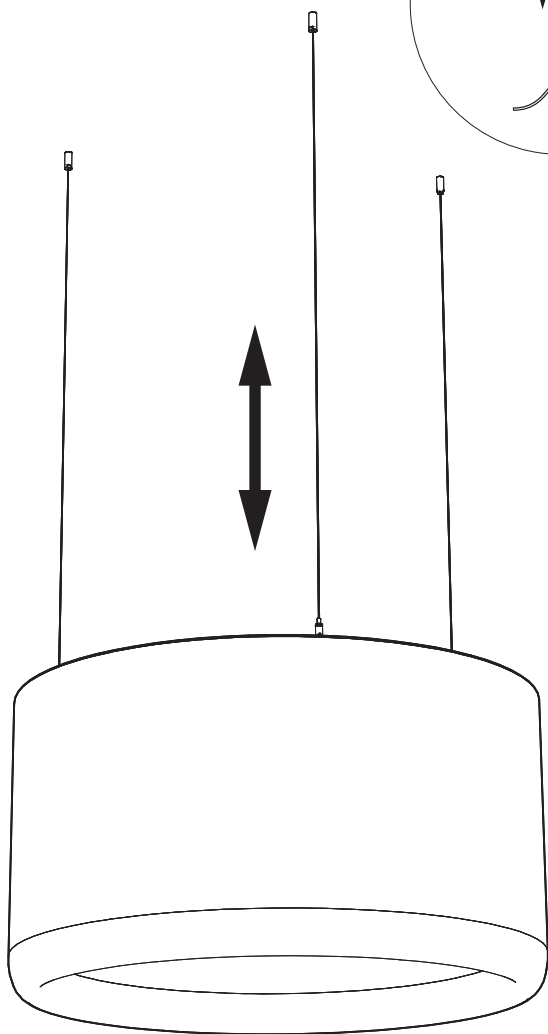

# BuzziTube Split

2 PERS. 

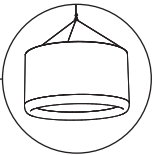

1

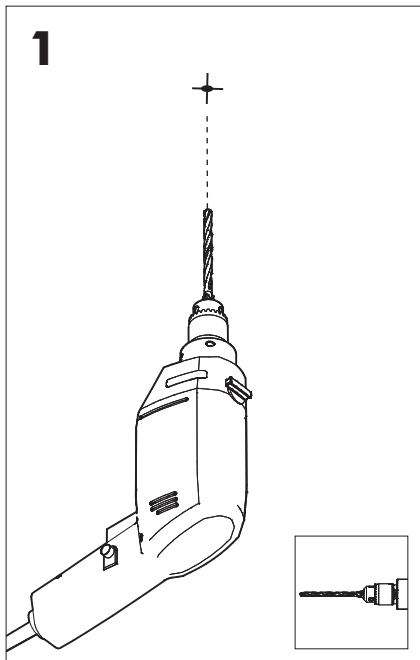

2

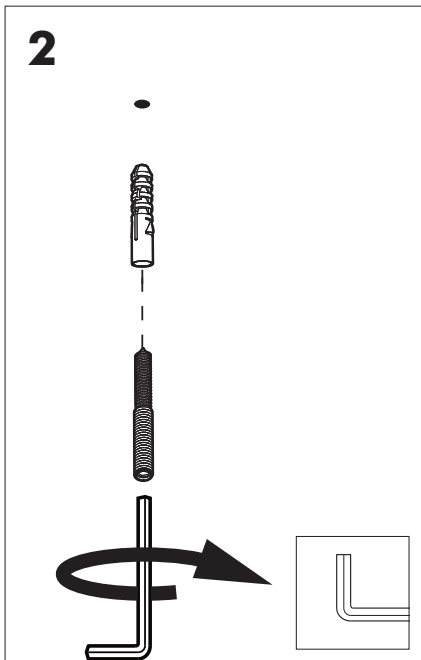

3

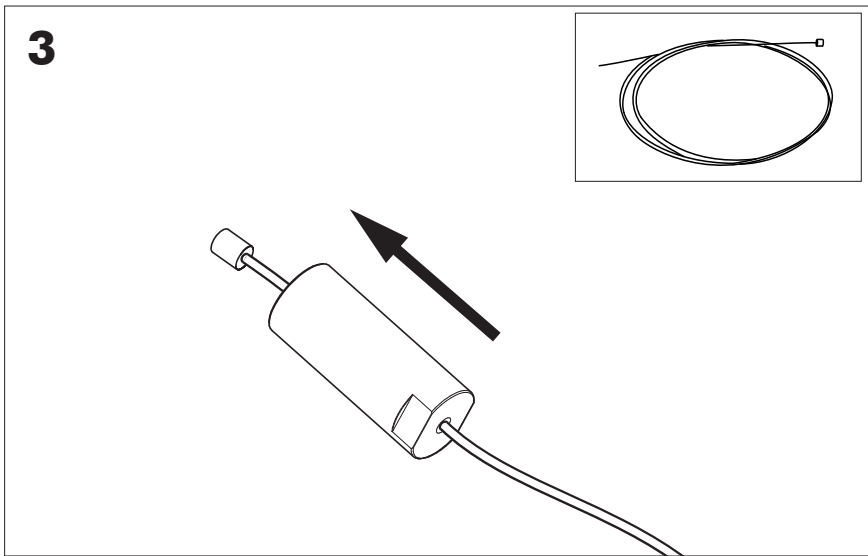



**4**

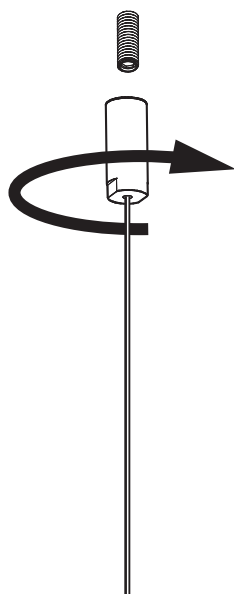

**5**

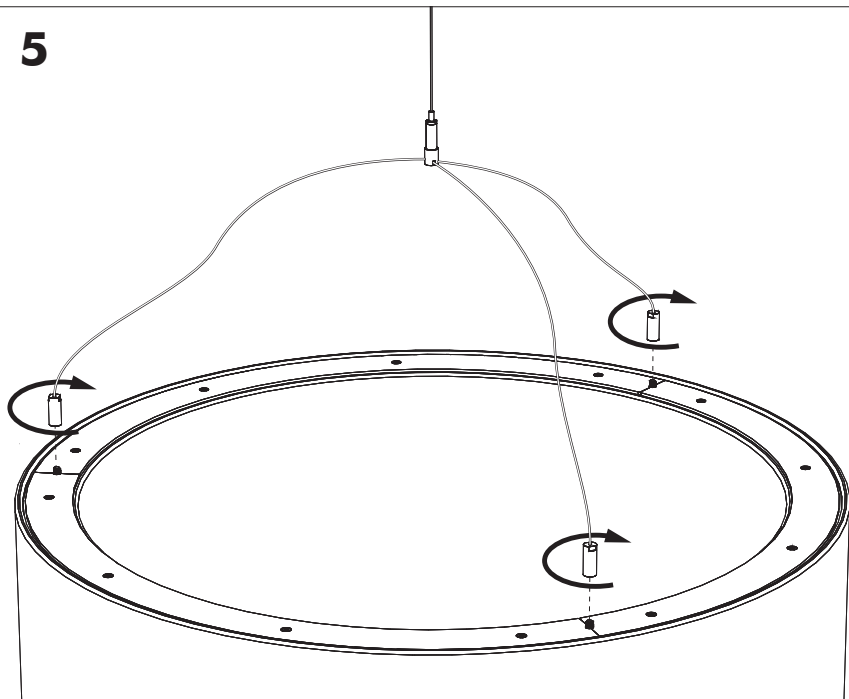

6

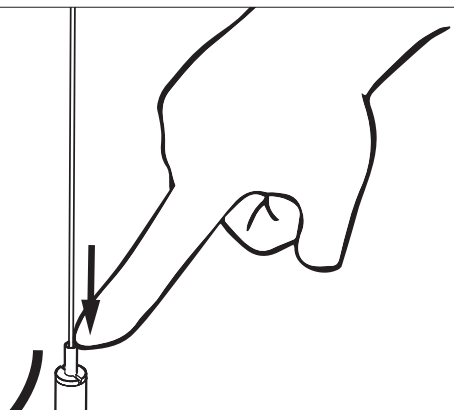

!

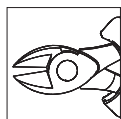
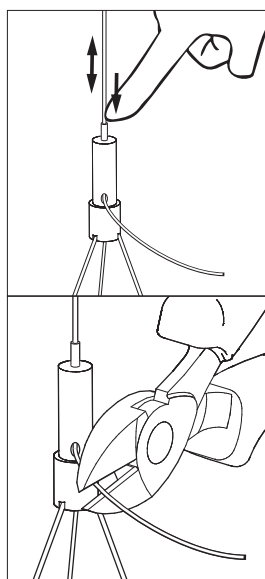
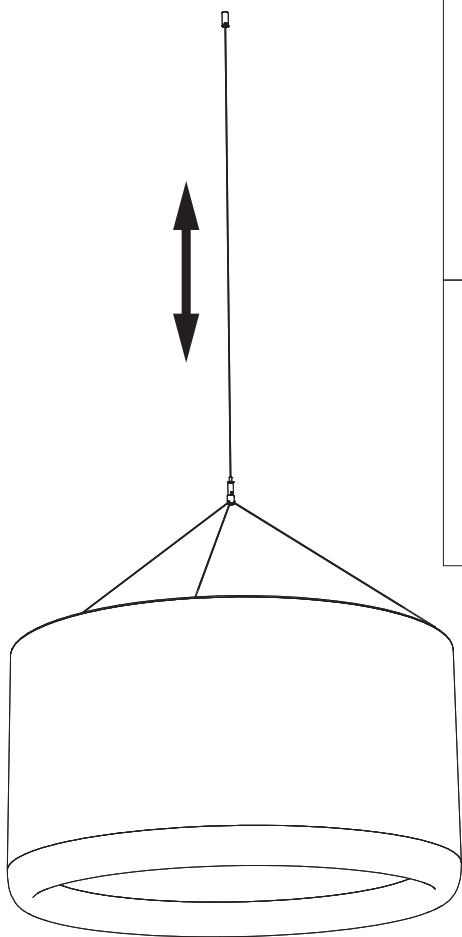



BuzziSpace  
Groeningenlei 141  
2550 Antwerp, Kontich  
Belgium  
☎ +32 (0)3 846 10 00  
✉ info@buzzi.space  
🌐 www.buzzi.space

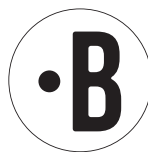

A-0000007348/02  
Last update: 29/11/2022