

# BuzziRing

## INSTALLATION MANUAL

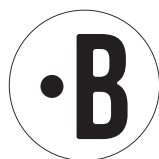
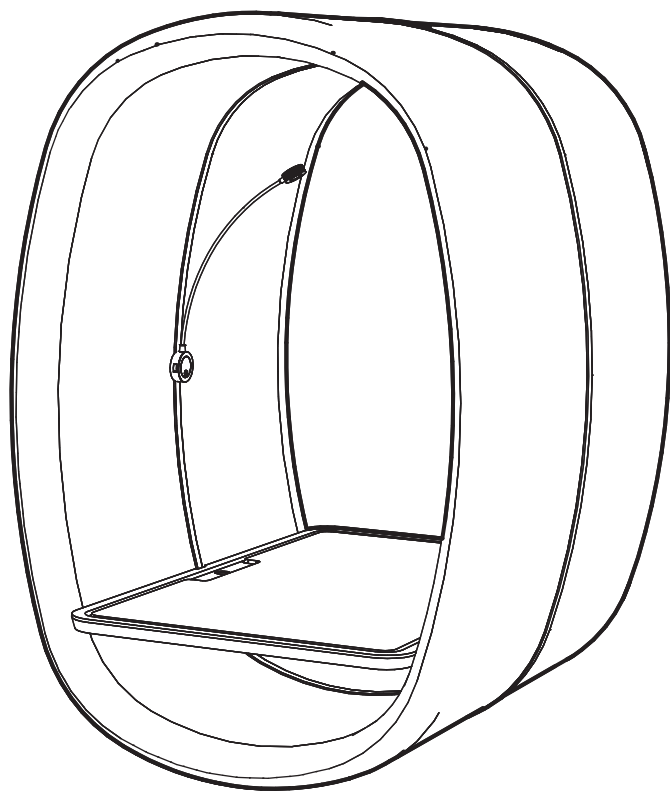

**Please note:** Due to safety reasons the BuzziRing should only be mounted by a professional.

The max load on the BuzziRing strongly depends on the mounting structure and the mounting materials used.

The BuzziRing is recommended for mounting on walls made of concrete or brick.

Hollow walls have to be reinforced on the backside of the wall. Do use suitable mounting.

## BuzziRing

---

2 PERS. 

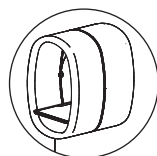

## Excluded

---



4x

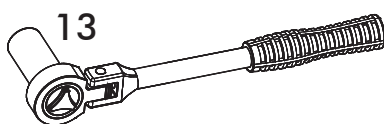
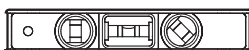
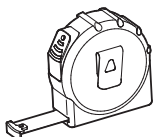
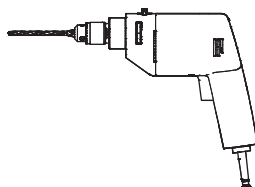

## Included

---

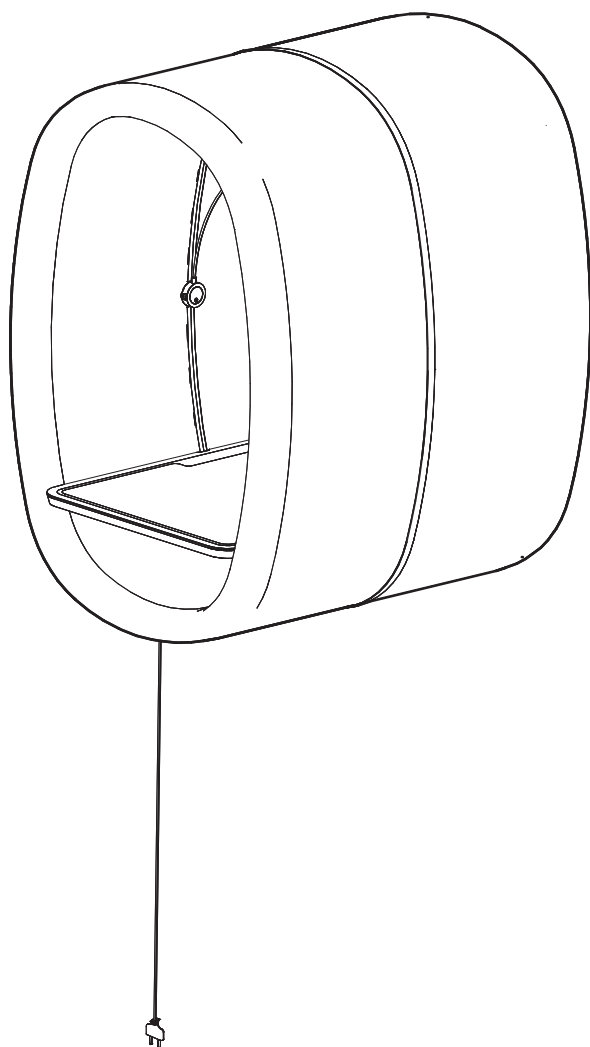

1

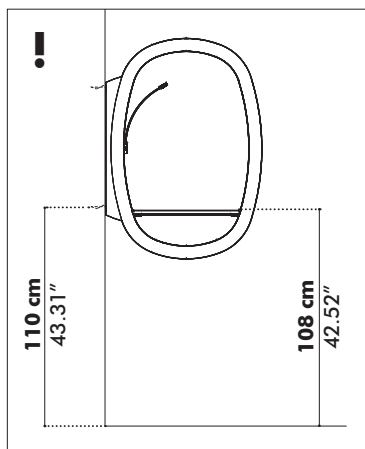
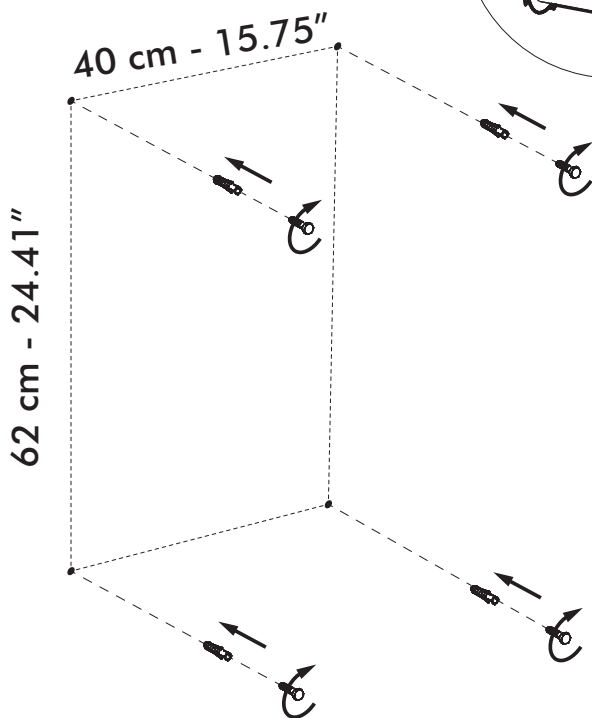

**2** 2 PERS. 

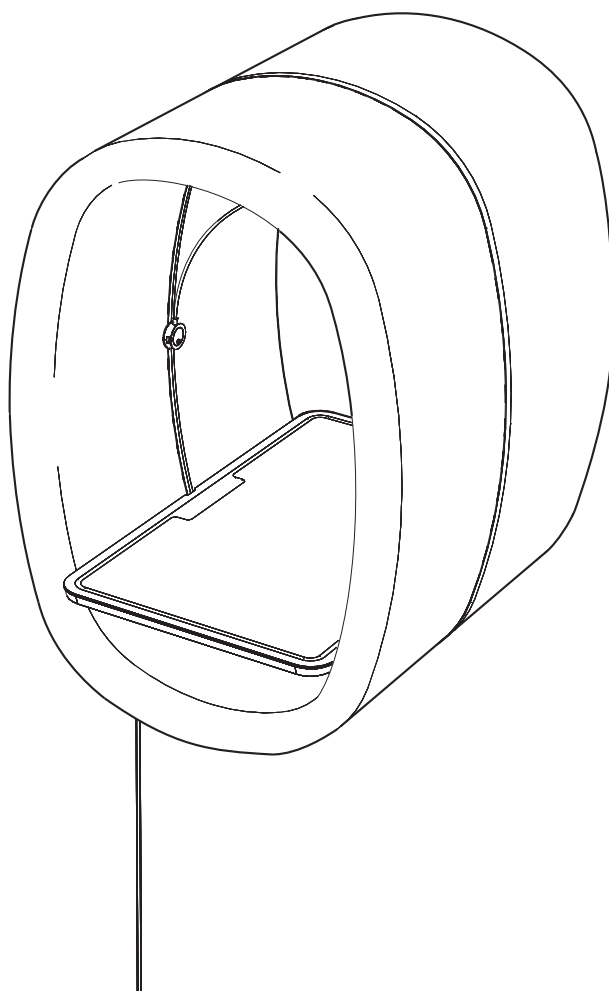
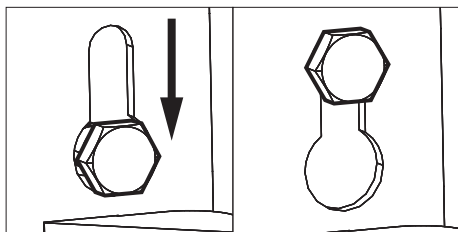

**3**

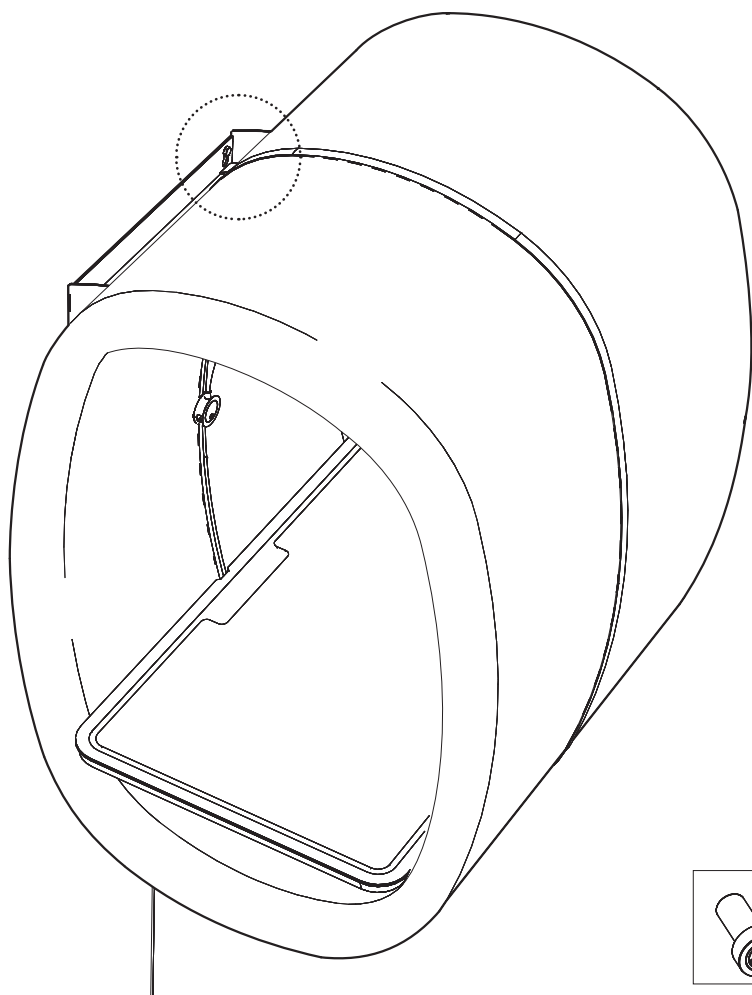
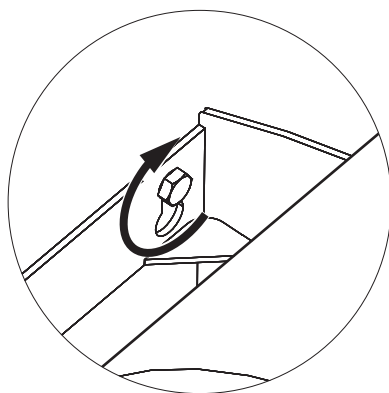

13

**4**

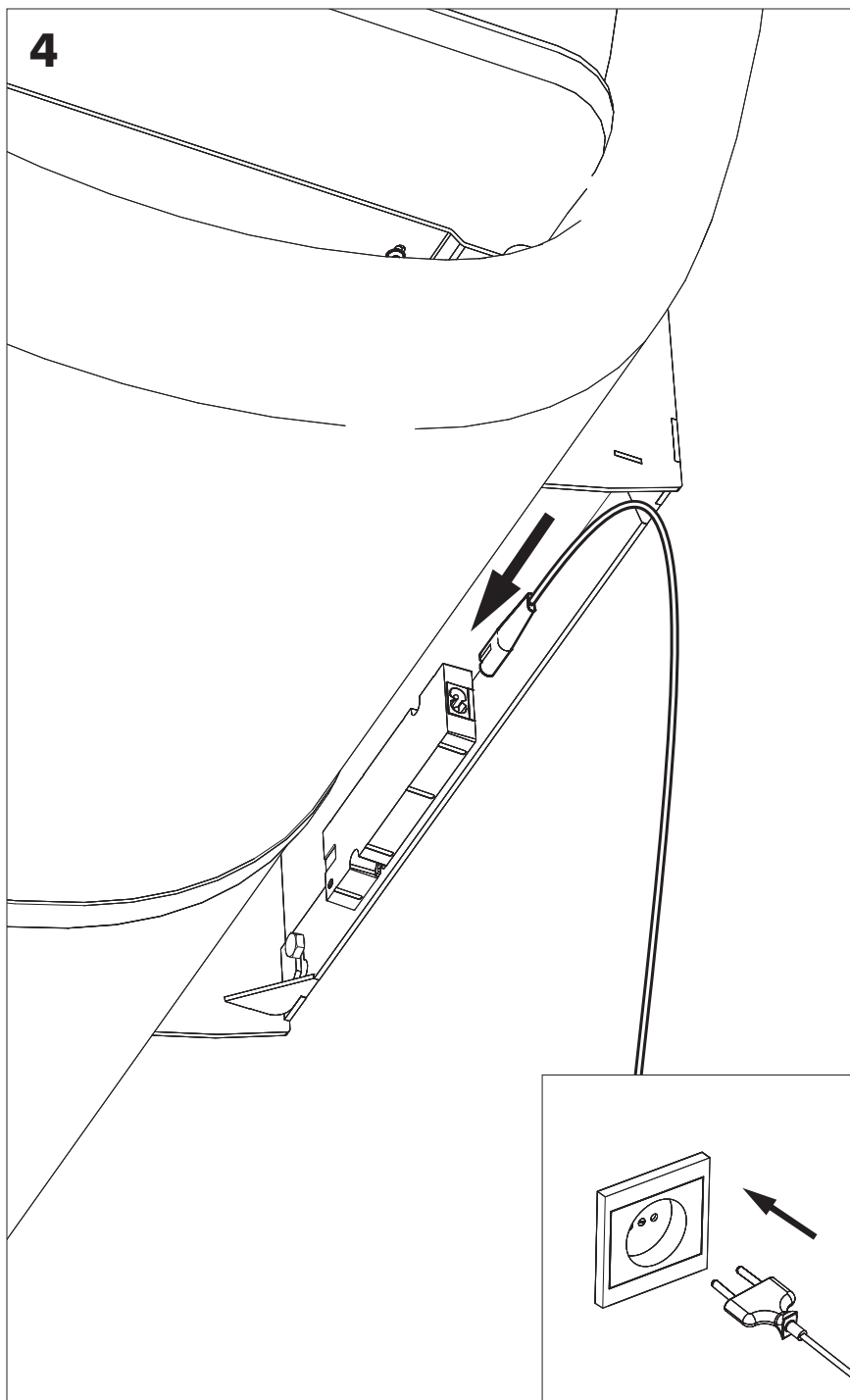

BuzziSpace Group NV  
Italiëlei 8, 2000 Antwerp  
Belgium

☎ +32 (0)3 846 10 00

✉ [info@buzzi.space](mailto:info@buzzi.space)

🌐 [www.buzzi.space](http://www.buzzi.space)



Doc nr.: A-0000007056/03

Last update: 04/12/2023