

# BuzziShade Square Beam

INSTALLATION MANUAL

220-240V

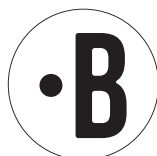
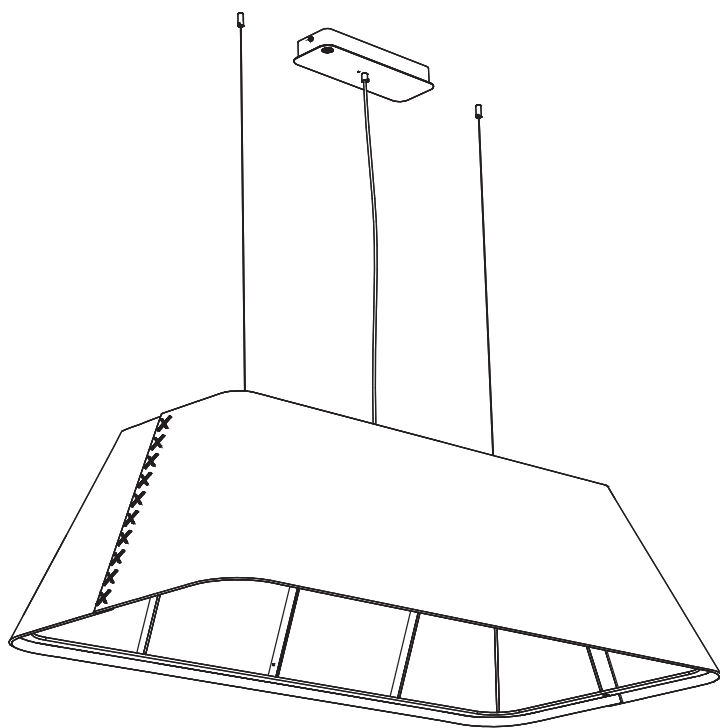

## Technical info

---

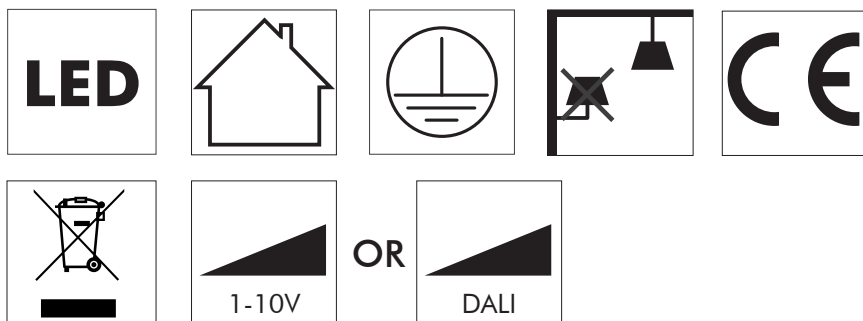

Power factor > 0.8;

Input current: Max 0.35Amp

## Environmental Protection

Waste electrical products should not be disposed of with household waste. Please recycle where facilities exist. Check with your Local Authority or retailer for recycling advice.

**⚠** The light source of this luminaire is not replaceable; when the light source reaches its end of life the whole luminaire shall be replaced.

**⚠** The BuzziSol is approved to be combined with BuzziShade, BuzziPleat.

**⚠** The control terminals of LED driver need to use SELV control signal.

**⚠** If the external flexible cable or cord of this luminaire is damaged, it shall be exclusively replaced by the manufacturer or his service agent or a similar qualified person in order to avoid a hazard."

## Excluded

---

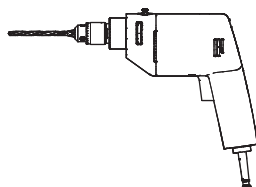
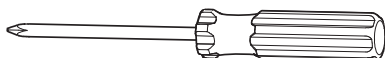

**Included BuzziShade Square Beam Globe | Spot**

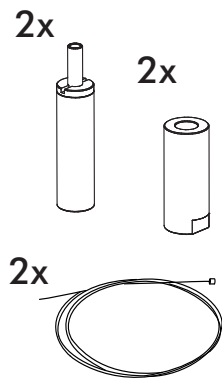
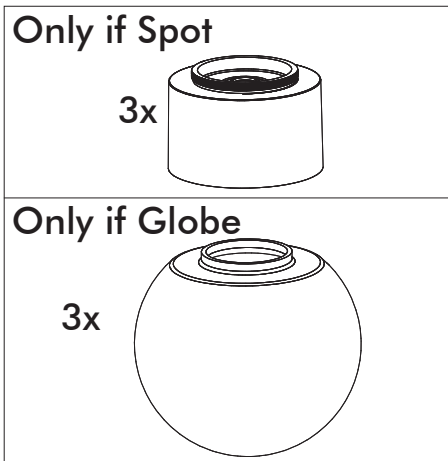
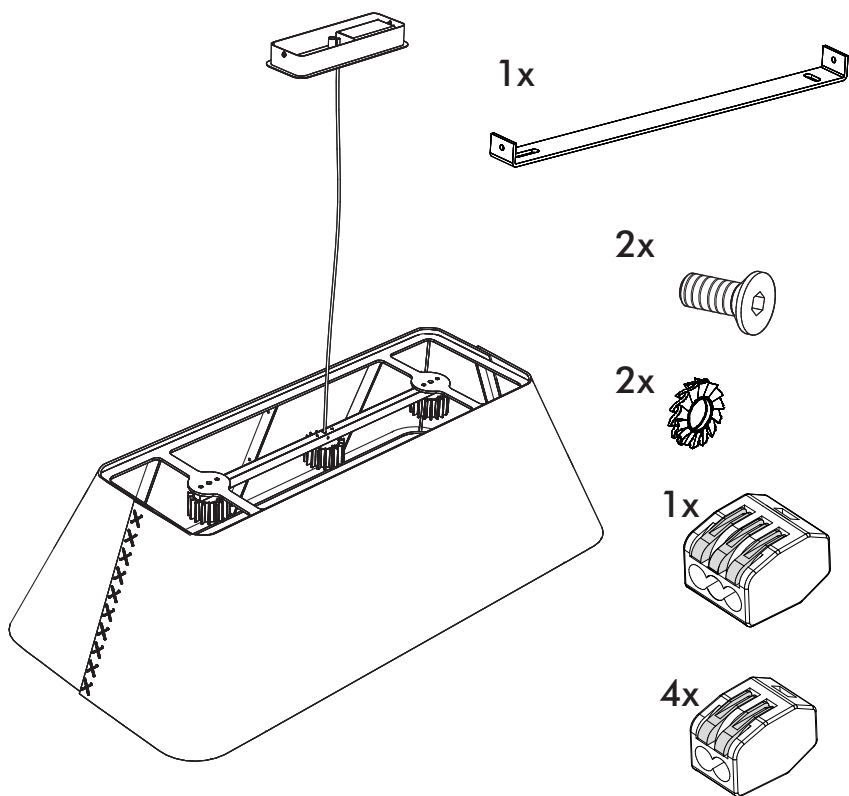

## **Configuration Type A**

---

**P.5**

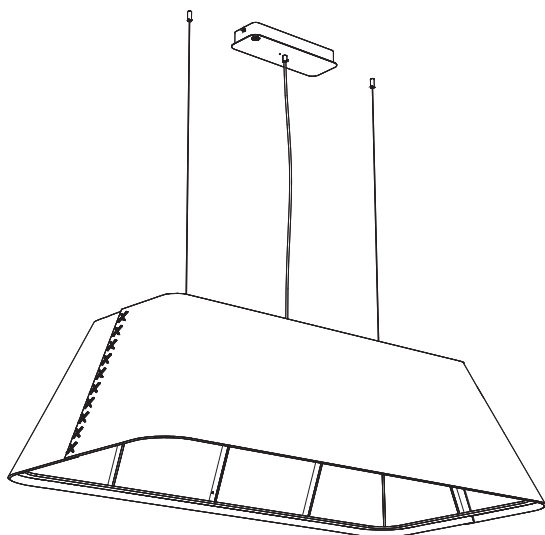

## **Configuration Type B**

---

**P.14**

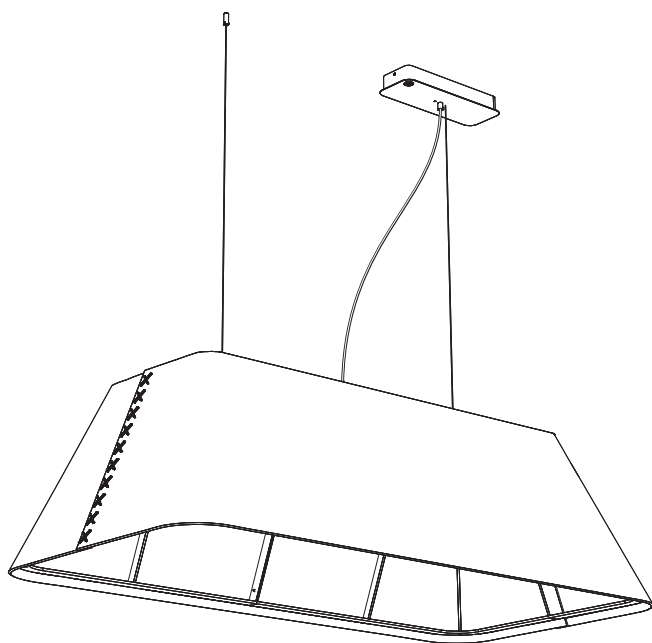

# BuzziShade Square Beam Type A

2 PERS. 

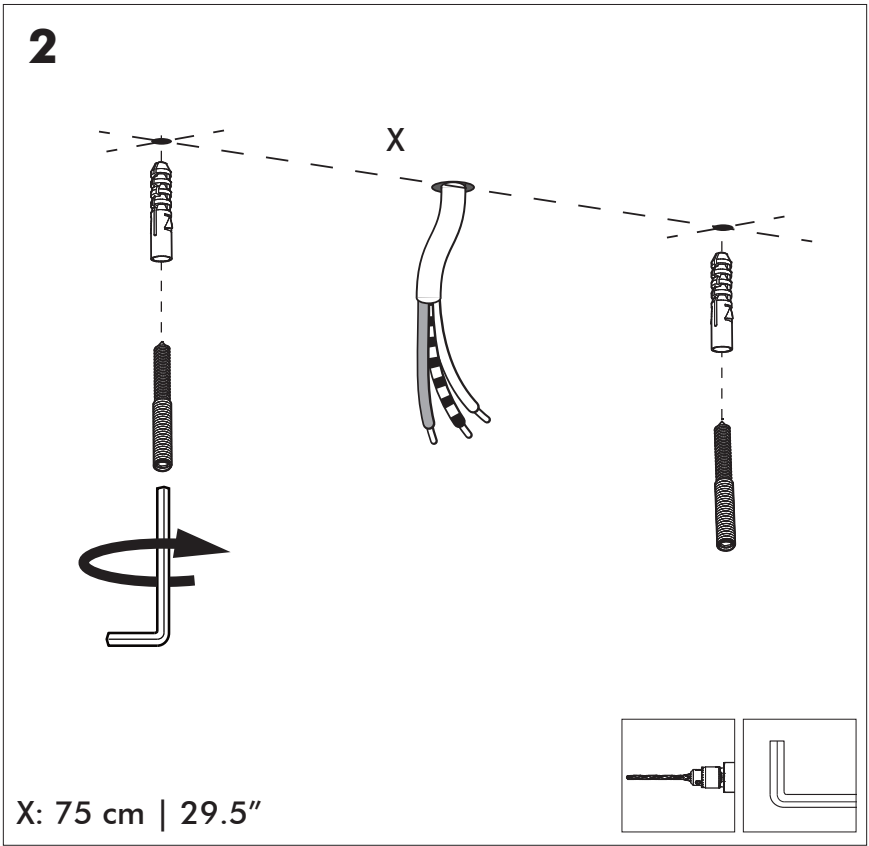
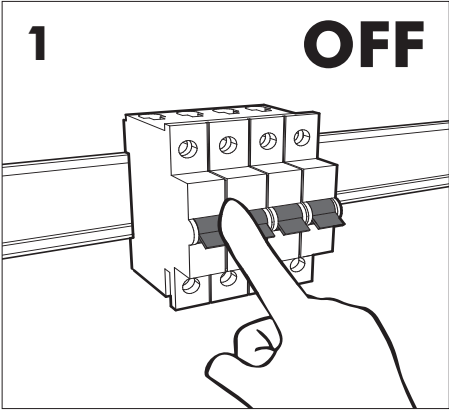

**3**

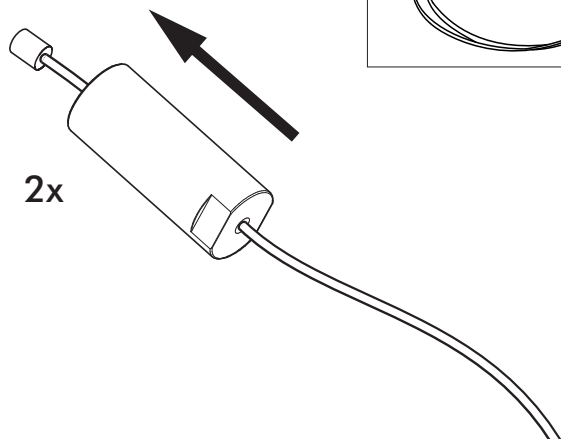

**4**

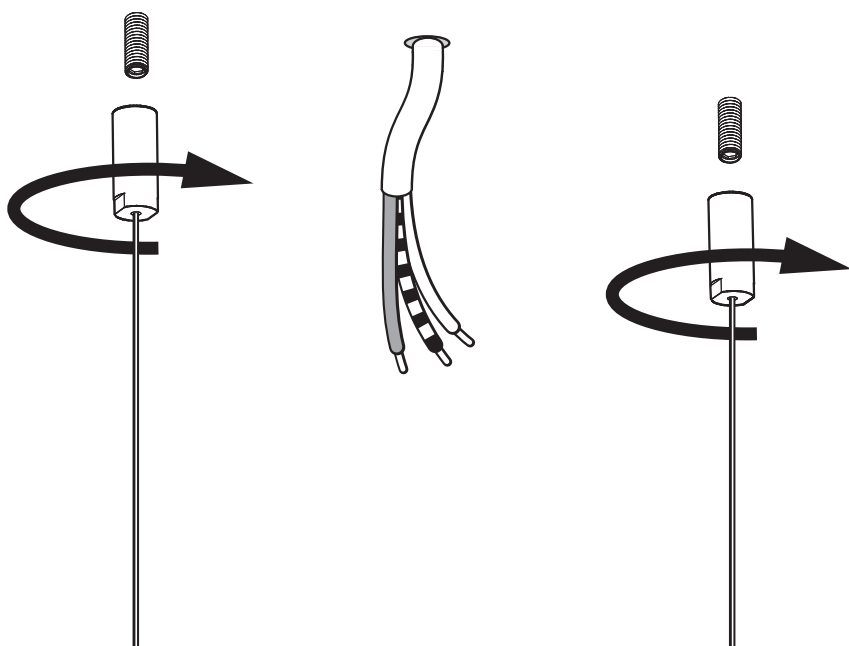

5

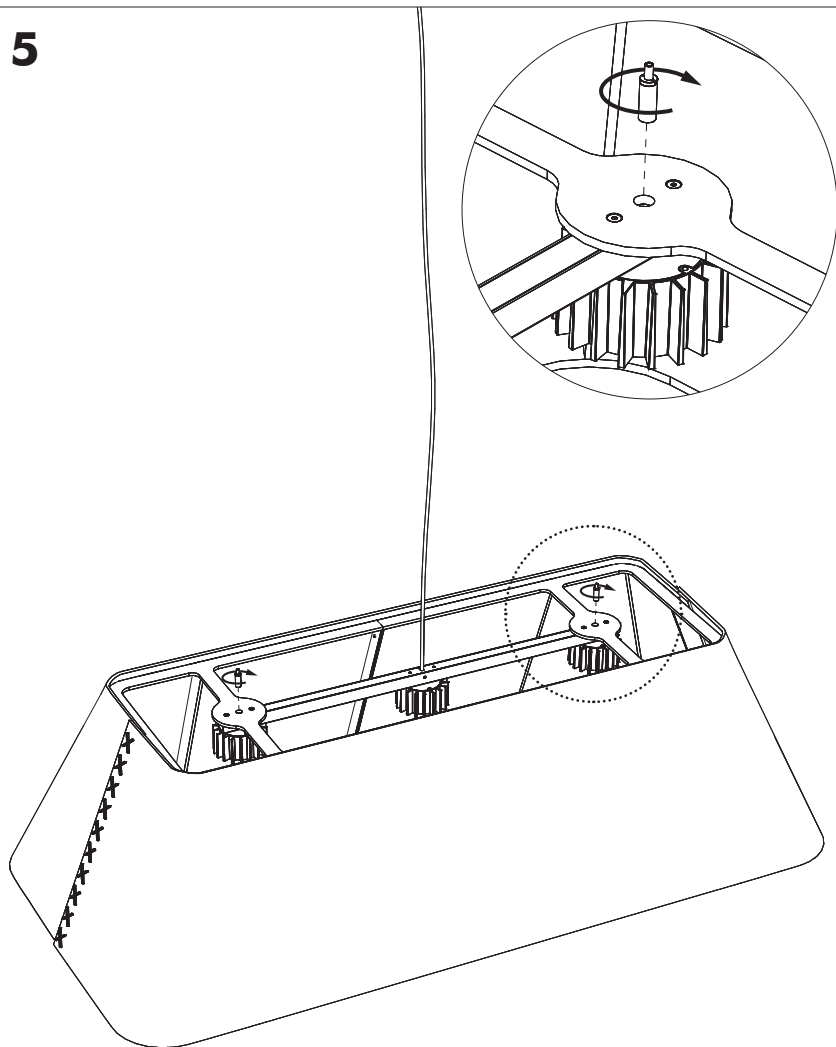

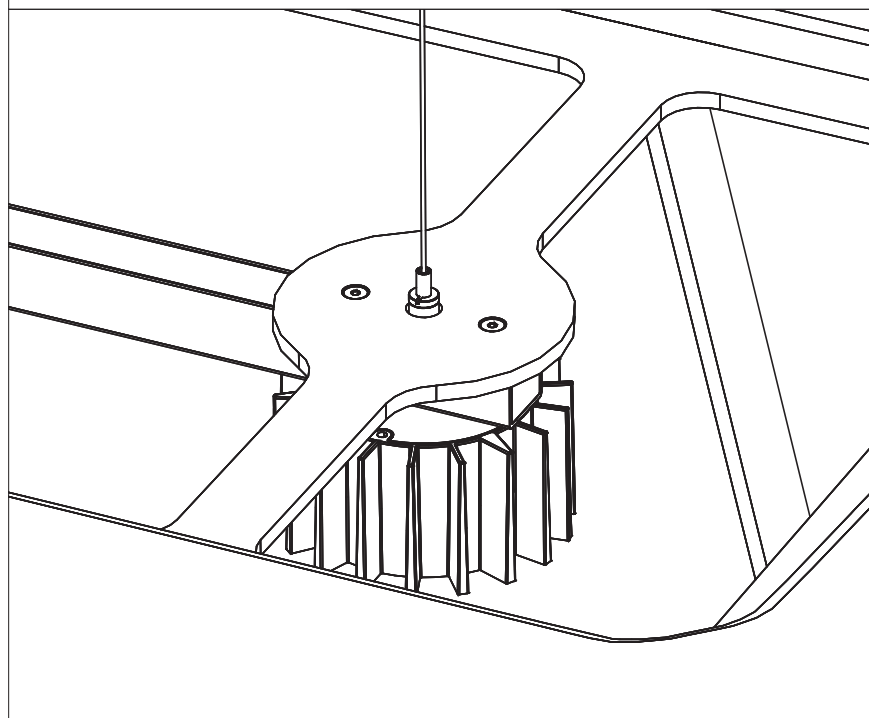
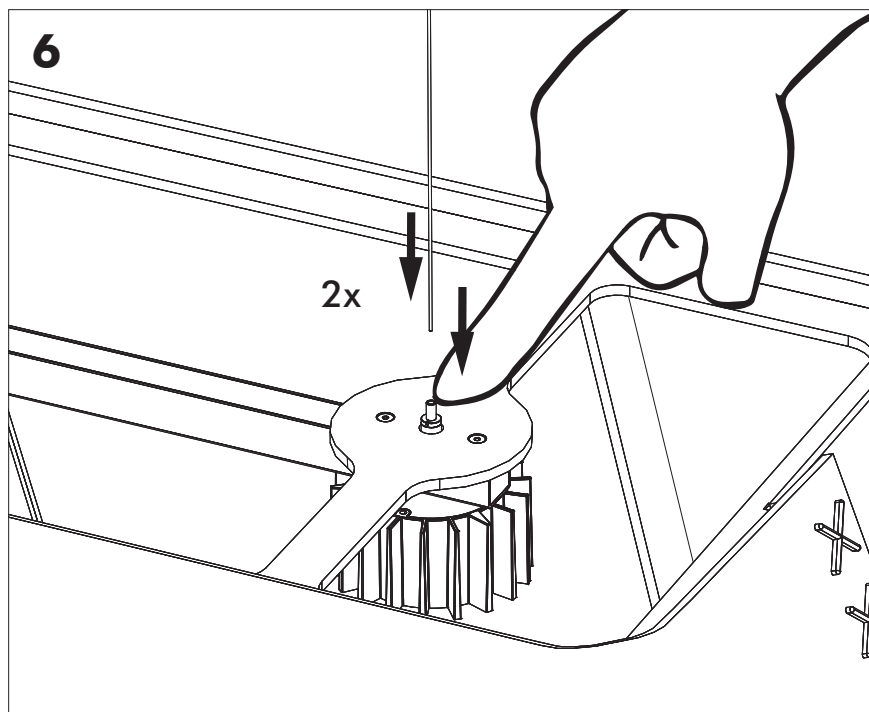



# 7a

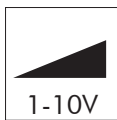

Connection including dimmable function

Dim+  
Dim-

Blue	Neutral
Brown	Line
Red	DIM +
Black	DIM -

Strip conductor  
to  $\pm 10 \text{ mm}$  |  $\pm 0.4''$

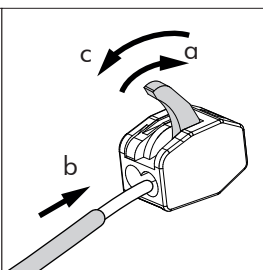

**7b**

Connection excluding dimmable function

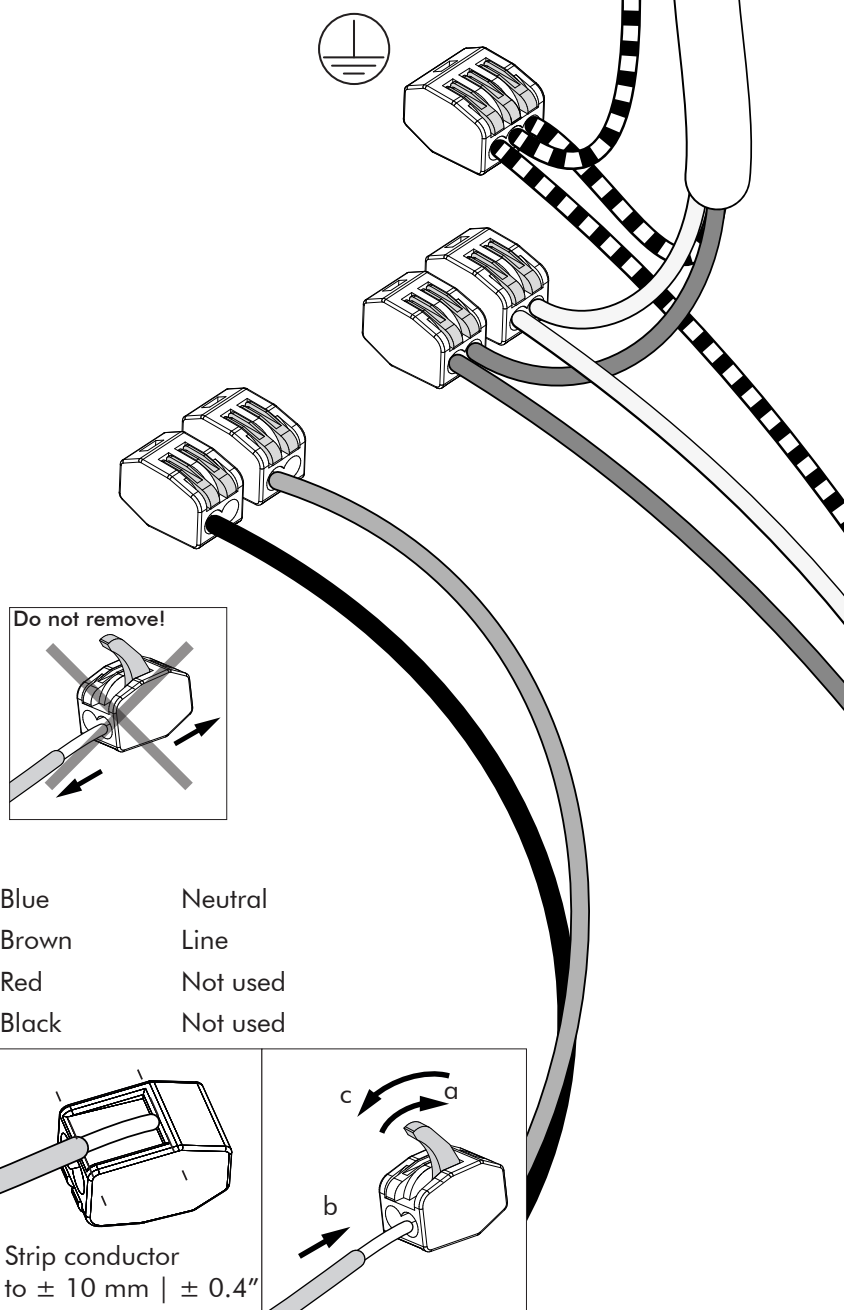

8

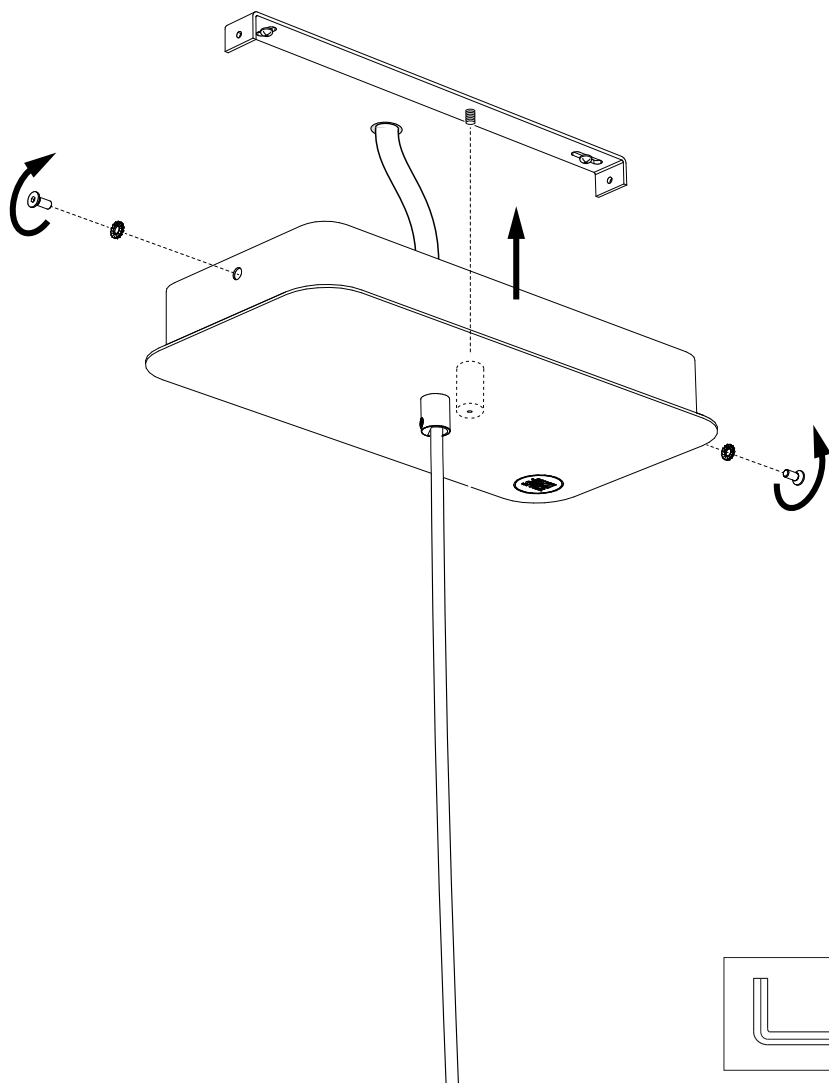

## 9 BuzziShade Square Globe

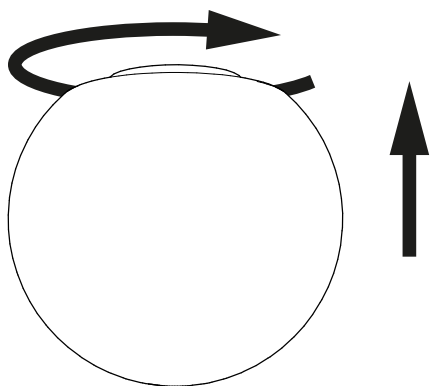
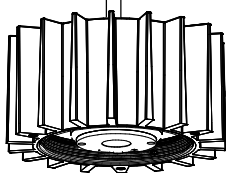

## 9 BuzziShade Square Spot

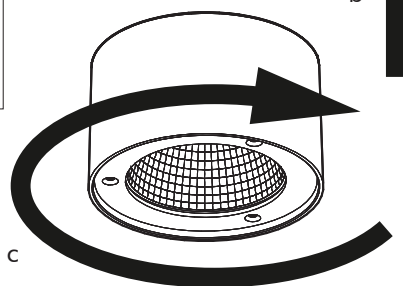
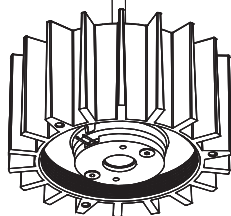
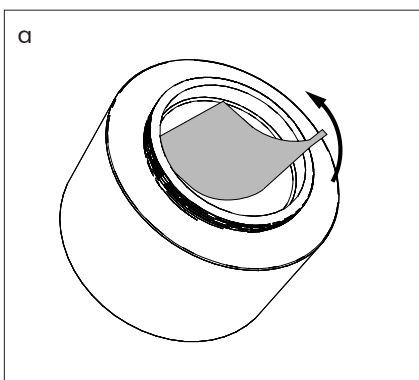

!

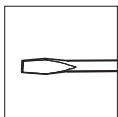
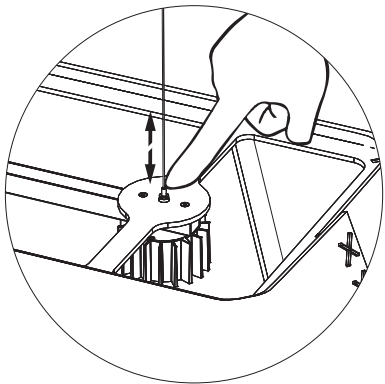
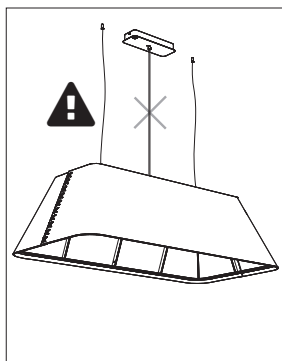
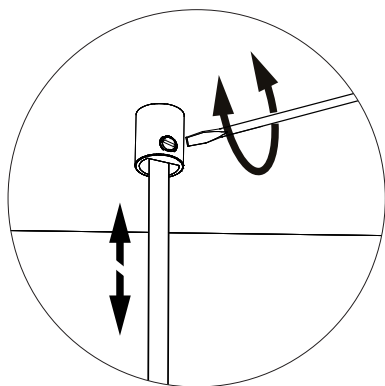
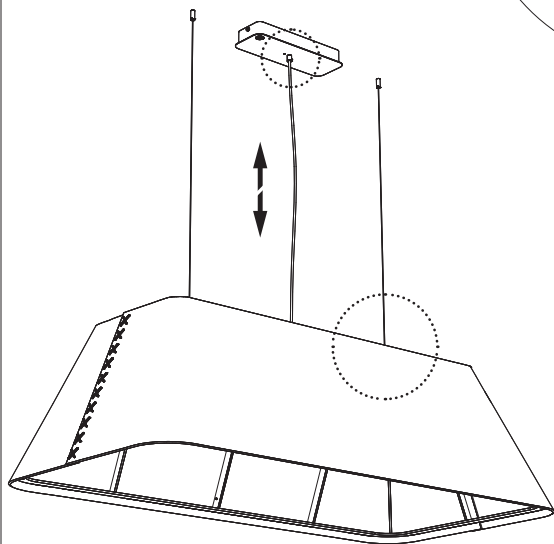

# BuzziShade Square Beam Type B

2 PERS. 

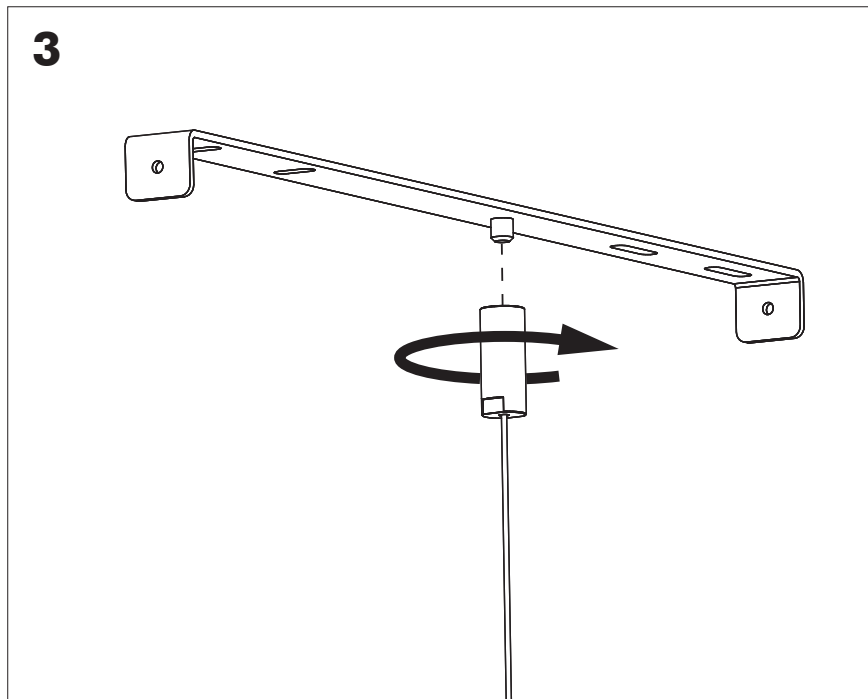
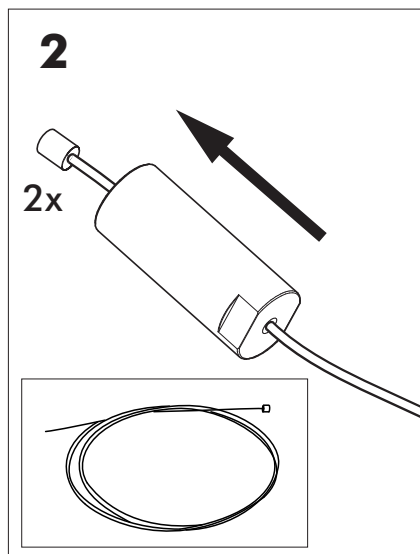
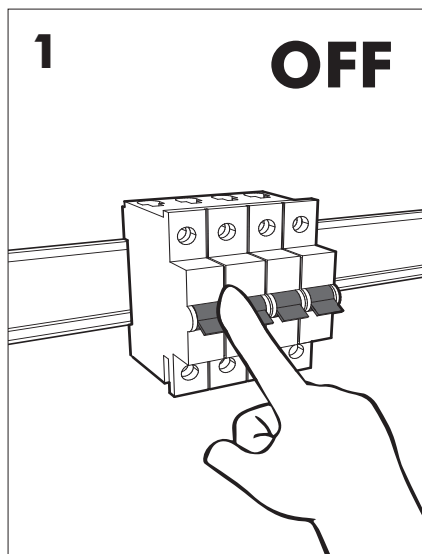

**4**

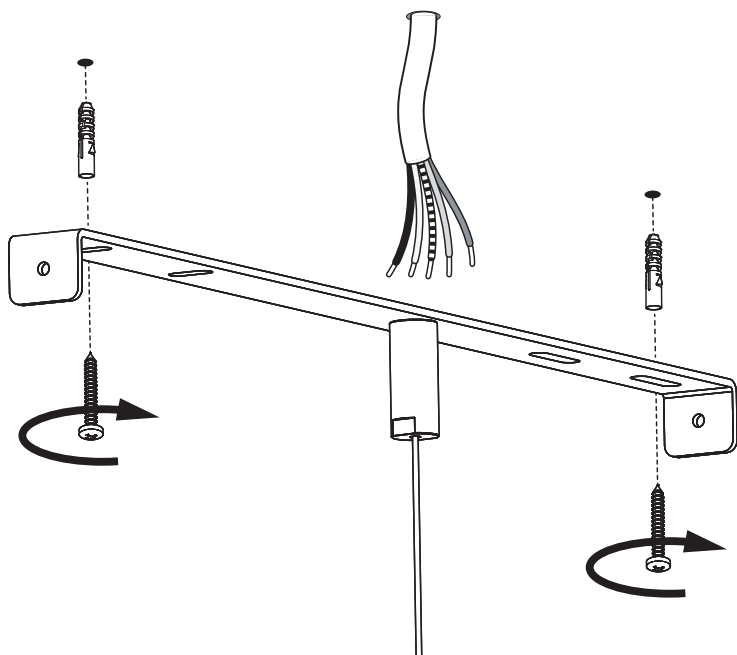

**5**

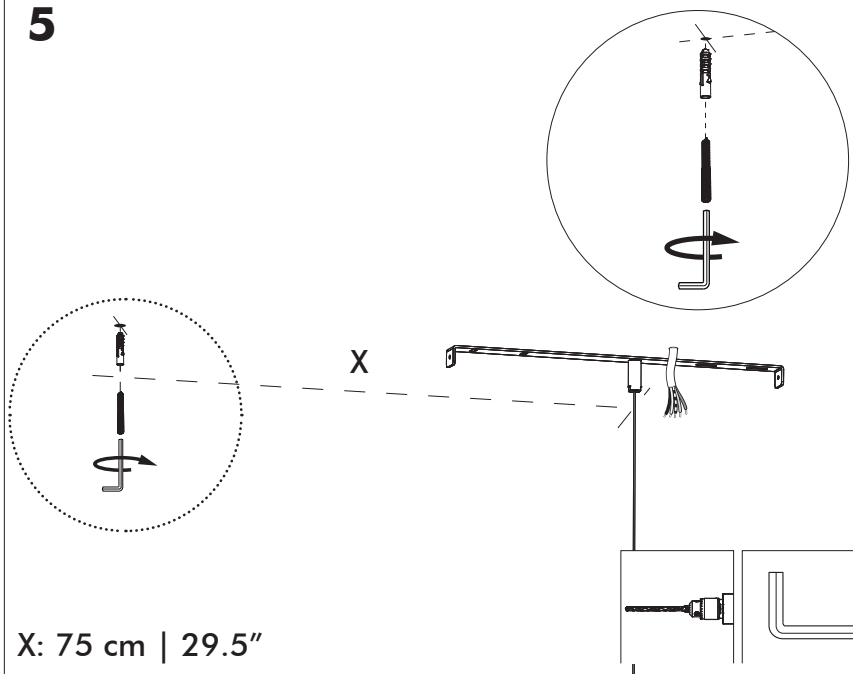

6

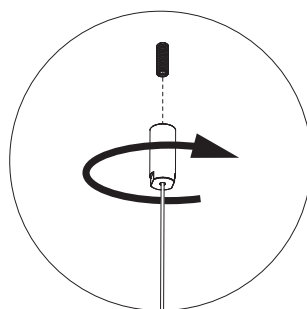
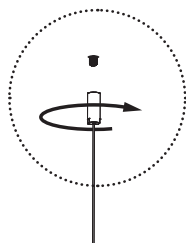

7

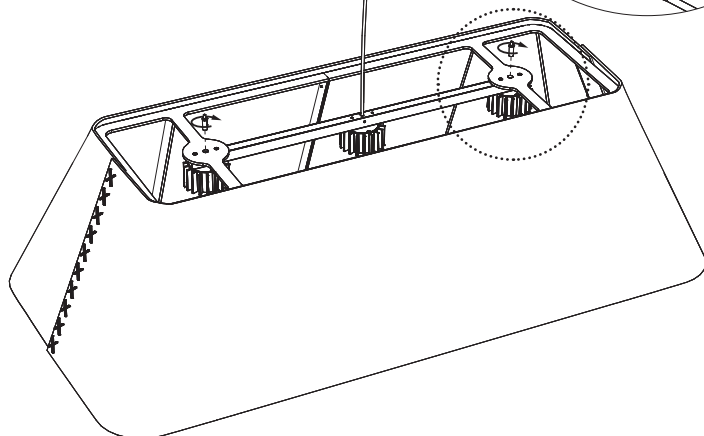
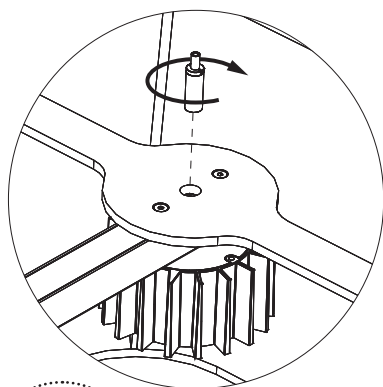



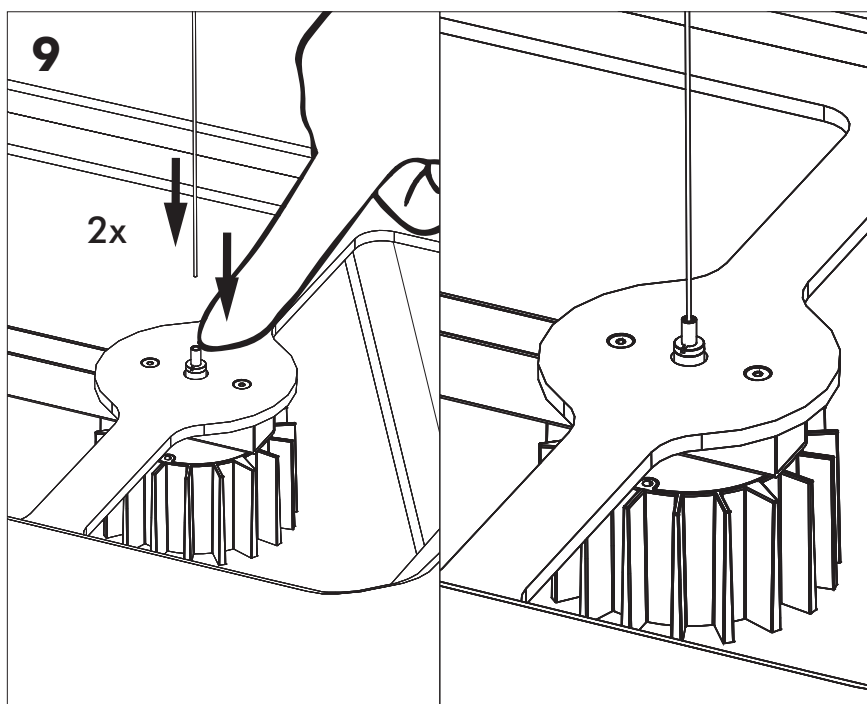
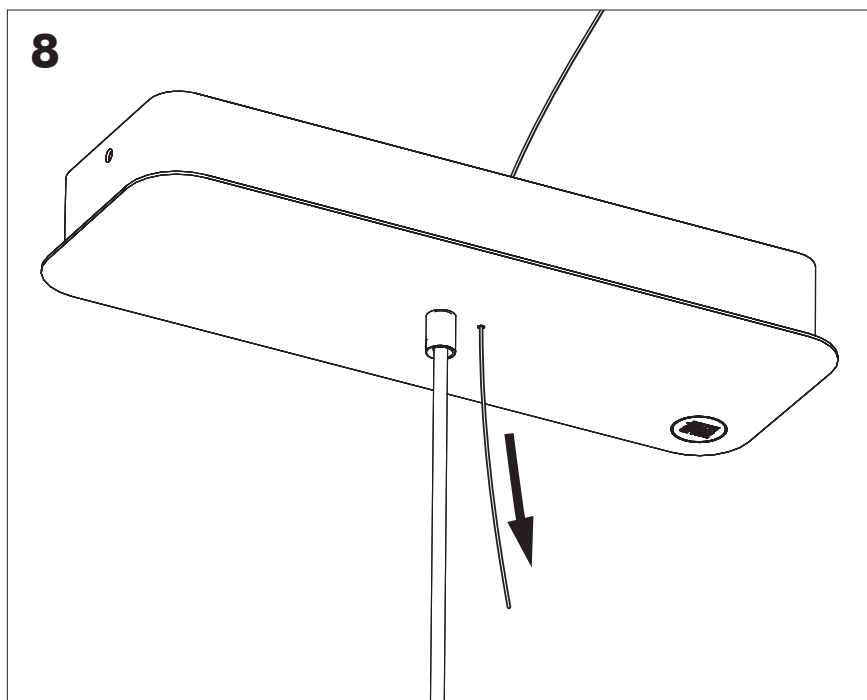

10a



Connection including dimmable function

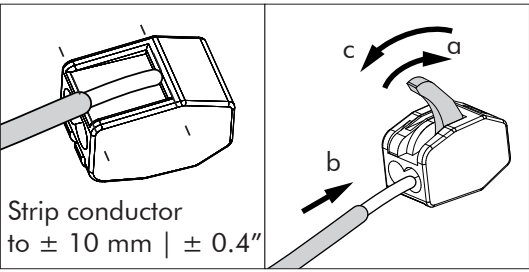
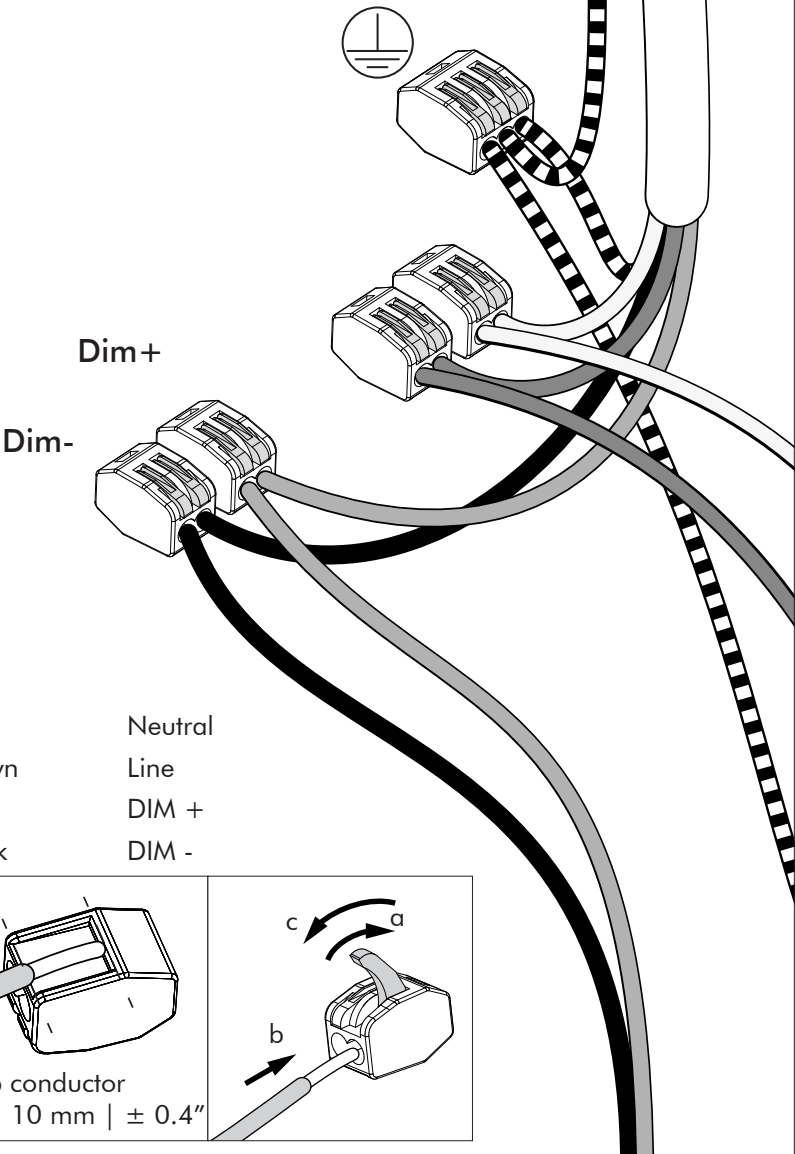

## 10b Connection excluding dimmable function

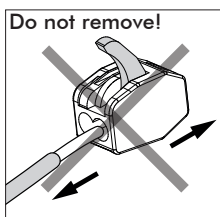

Blue	Neutral
Brown	Line
Red	Not used
Black	Not used

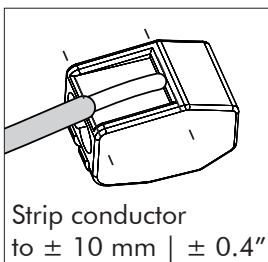

Strip conductor  
to  $\pm 10 \text{ mm}$  |  $\pm 0.4''$

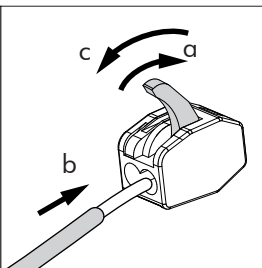

11

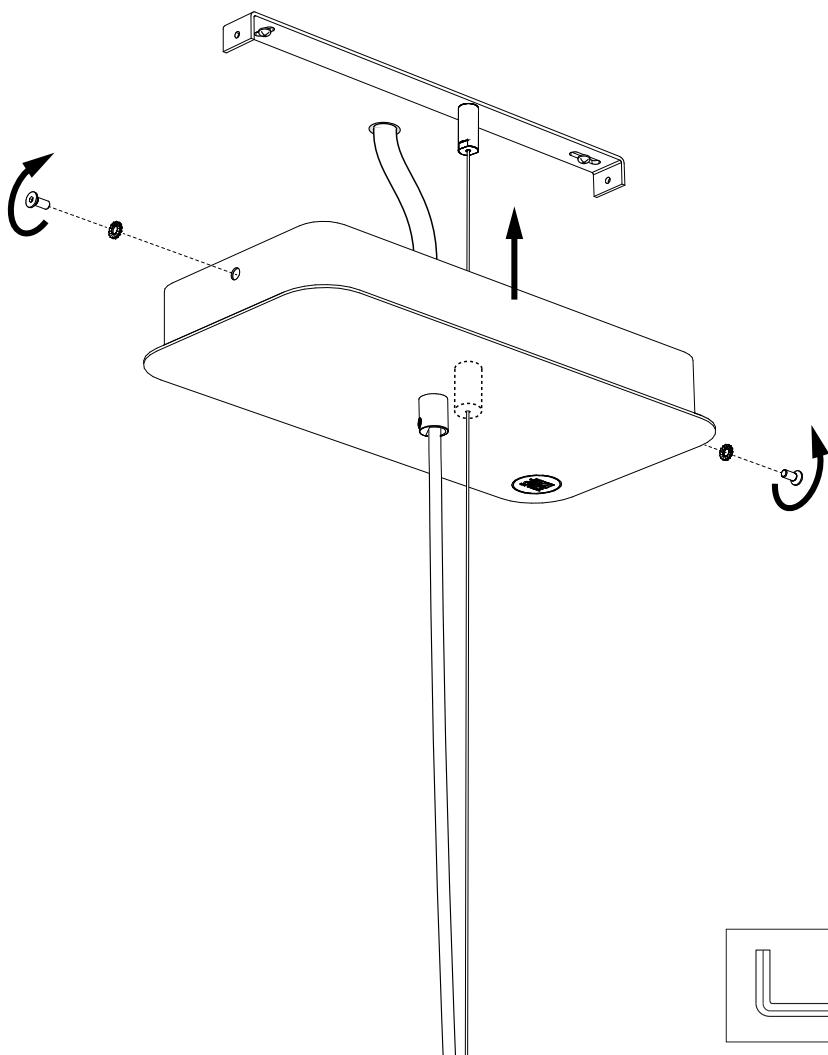

# 12 BuzziShade Square Beam Globe

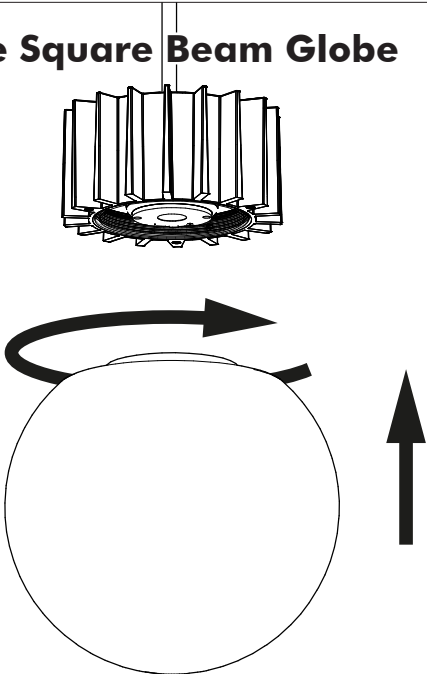

# 12 BuzziShade Square Beam Spot

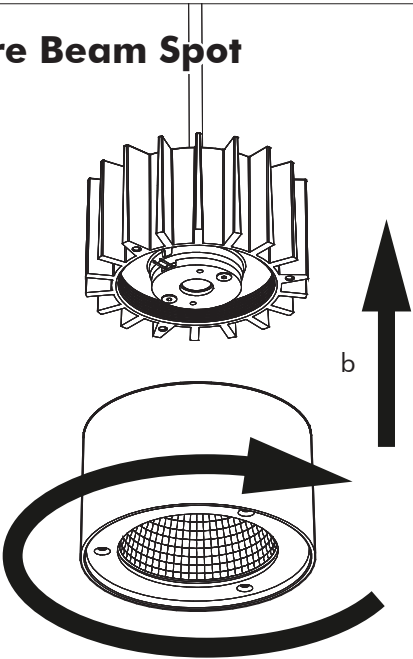
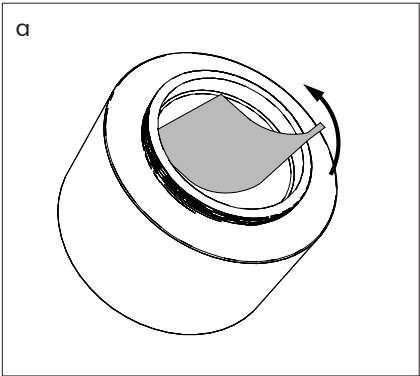

!

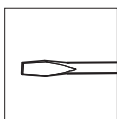
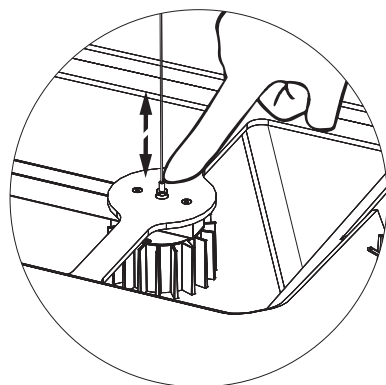
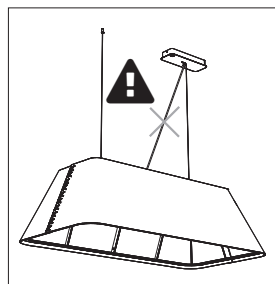
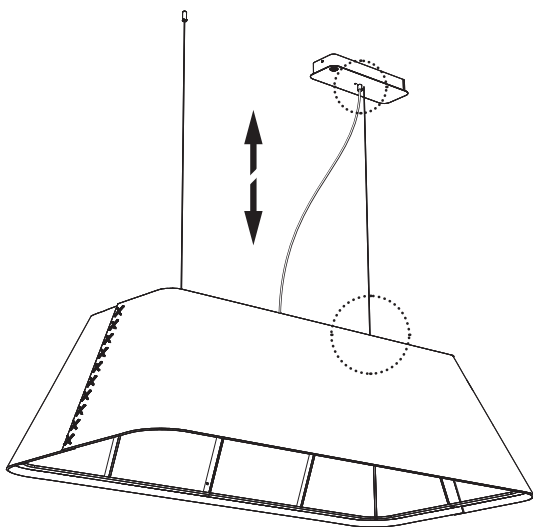
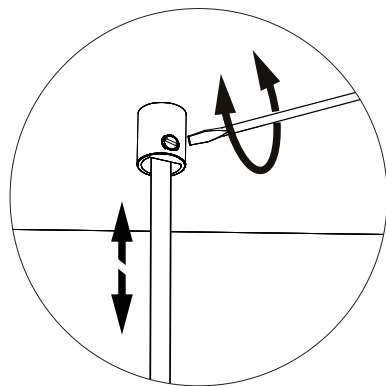



BuzziSpace Group NV  
Italiëlei 8, 2000 Antwerp  
Belgium

☎ +32 (0)3 846 10 00

✉ [info@buzzi.space](mailto:info@buzzi.space)

🌐 [www.buzzi.space](http://www.buzzi.space)



A-0000007365/02  
Last update: 03/09/2024