

# **YAKTA**

## **MULCH KIT INSTALLATION INSTRUCTIONS**

**FOR 48", 54", 61", & 72" MOWER DECKS**



1-866-925-8201  
clientcare@yakta.com  
yakta.com  
FEB 2025

# CONTENTS

PARTS LIST & DIAGRAM .....	3
TORQUE SPECIFICATIONS .....	4
INSTALLATION INSTRUCTIONS .....	5
REMOVAL INSTRUCTIONS .....	6
IMPROVE CUT QUALITY WITH YOUR MULCH KIT .....	7

# PARTS LIST & DIAGRAM

LOOSE PARTS		
Item #	Description	QTY
1	Bolt-on Mulch Baffle 1	1
2	Bolt-on Mulch Baffle 2	1
3	Bolt-on Mulch Baffle 3	1
4	Shredding Blade	3
5	5/16" Flange Head Bolt	1
6	5/16" Nut	1
7	3/8" Flange Head Bolt	6
8	3/8" Nut	6

BLADE SIZE	
Deck Size	Blade Size
48"	17"
54"	18.5"
61"	21"
72"	25"

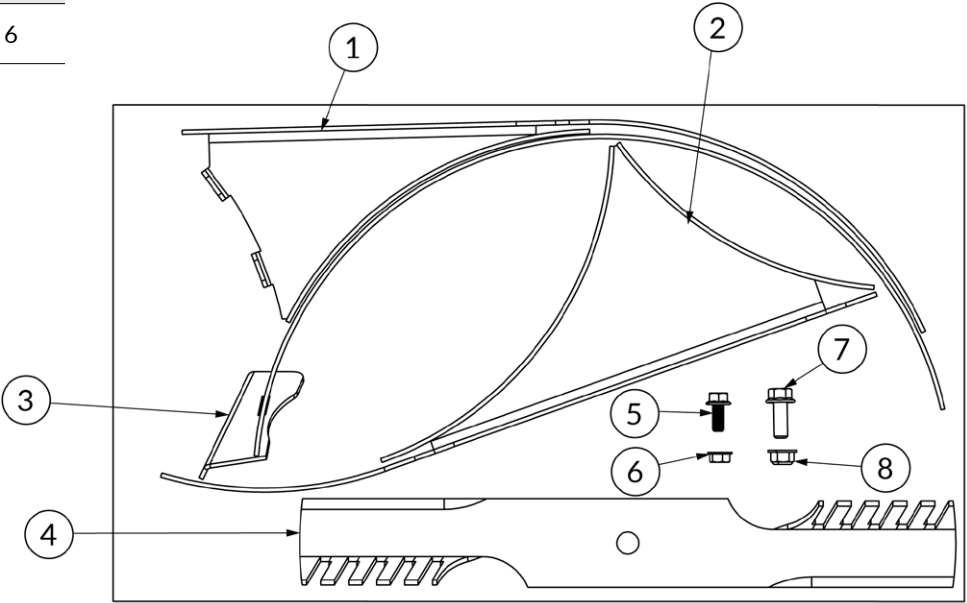

# TORQUE SPECIFICATIONS

Size	Thread Pitch	Grade 5	Grade 8
#3	32	23 in-lb	28 in-lb
#8	32	41 in-lb	52 in-lb
#10	24	60 in-lb	75 in-lb
#12	24	94 in-lb	117 in-lb
1/4	20	7 ft-lb	11 ft-lb
5/16	18	15 ft-lb	21 ft-lb
3/8	16	27 ft-lb	37 ft-lb
7/16	14	43 ft-lb	57 ft-lb
1/2	13	61 ft-lb	88 ft-lb
9/16	12	87 ft-lb	125 ft-lb
5/8	11	121 ft-lb	175 ft-lb
3/4	10	215 ft-lb	311 ft-lb
7/8	9	349 ft-lb	492 ft-lb

# INSTALLATION INSTRUCTIONS

## INSTRUCTIONS

### TOOLS REQUIRED:

- 1/2" Wrench (x2)
- 9/16" Wrench (x2)
- 15/16" Wrench
- Blue Thread Locker
- 1-1/8" Wrench

### STEPS:

1. Make sure your mower is turned off and safe to work on.



### CAUTION

Before working on your mower:

- Park on a level surface.
- Ensure the PTO is disengaged and the park brake is engaged.
- Turn off the mower and remove the key.
- Turn off the battery disconnect, if your mower has one.

2. Jack up or lift the mower deck.



### CAUTION

If you are using jacks to lift the machine, ensure you are using jack stands or blocks

3. Take off the existing mower blades.
  - a. Carefully hold the blades under the deck to prevent movement.
  - b. Use a 15/16" wrench to remove the 5/8" bolt at the bottom of each spindle. Use a 1-1/8" wrench to hold the spindle shaft above the blade to keep it from rotating. Alternatively, use a block to wedge the blade.
  - c. Take the blade off the spindle.

4. Remove the adjustable baffles, if your mower has them.
  - Use a 9/16" wrench to remove the 3/8" bolts.

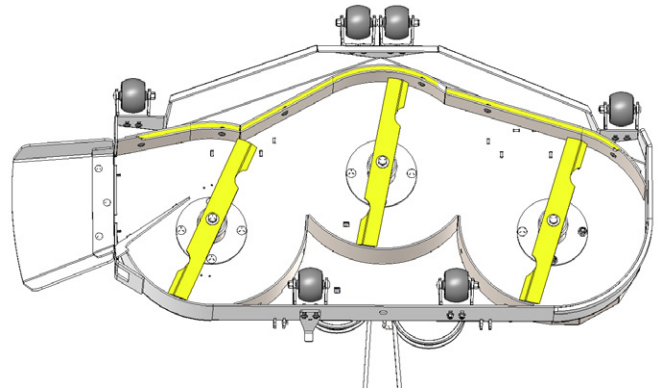

5. Attach Bolt-On Mulch Baffles 1 & 2
  - a. Starting with Baffle 1, secure the baffle to the existing ones with four 3/8" bolts and nuts. Tighten with both 9/16" wrenches.
  - b. Repeat step a for Baffle 2.

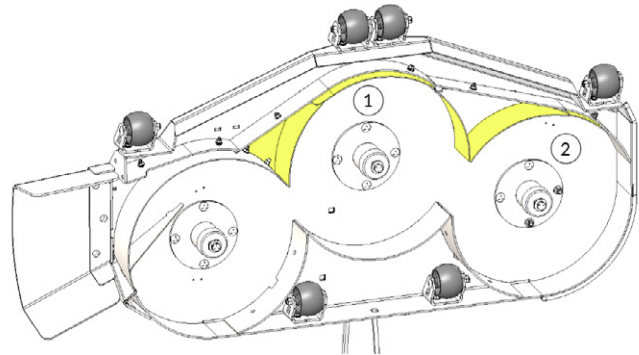

# INSTALLATION INSTRUCTIONS

## 6. Attach Bolt-On Baffle 3

- Insert baffle 3 into baffle 1, making sure that baffle 3 is positioned closest to the front of the mower deck. Secure with two 3/8" bolts using both 9/16" wrenches.
- On the chute side of the deck, secure baffle 3 with the 5/16" bolt and 5/16" nut with both 1/2" wrenches.

Note: Some deck models might have a rivnut installed near the chute opening. Remove the rivnut with a drill bit.

- For 5/16" rivnut, use 1/2" drill bit.
- For 1/4" rivnut, use 3/8" drill bit.

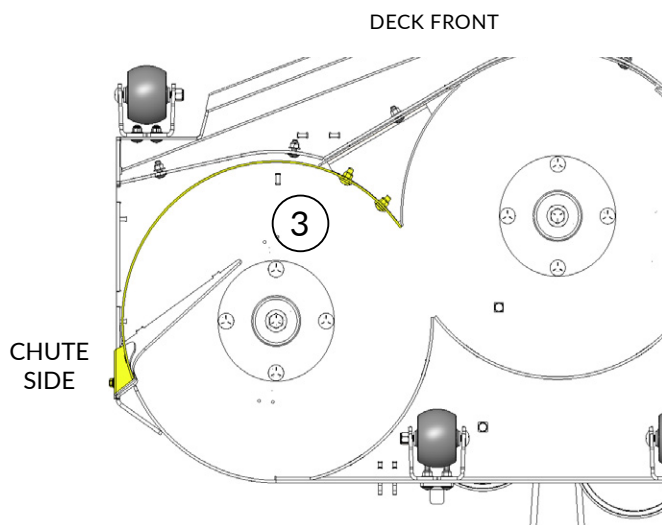

## 7. Attach the Shredding Blades.

- Put the blade on the spindle. The curved part should face upwards, toward the mower deck.
- Use a 15/16" wrench to attach the 5/8" bolt at the bottom of the spindle. Use a 1-1/8" wrench to hold the spindle shaft above the blade to keep it from rotating. Alternatively, use a block to wedge the blade. Carefully hold the blade under the deck to prevent movement.
- Before using the mower, ALWAYS spin the blades by hand after you install them to make sure they move freely and don't touch each other or the mower deck.

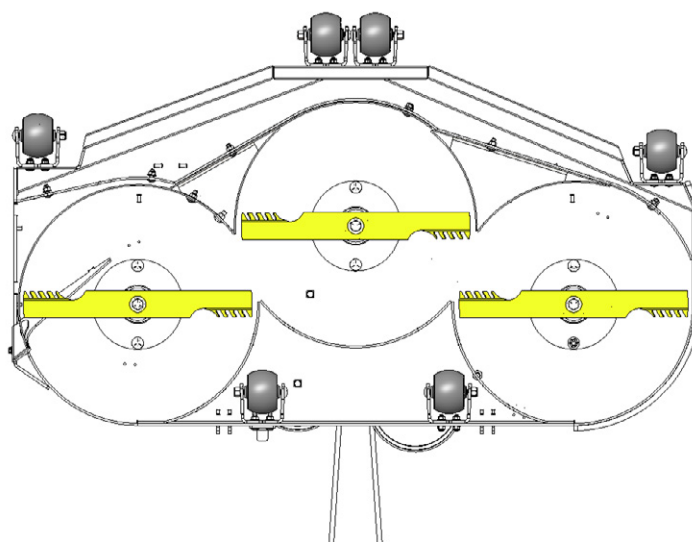

# REMOVAL INSTRUCTIONS

## STEPS:

- To remove the blades and bolt-on mulch baffles, follow the install steps above in reverse order.

# HOW TO IMPROVE CUT QUALITY WITH YOUR MULCH KIT

- **RAISE THE CUT HEIGHT:** Cut only a third of the grass blade at a time, unless the grass is sparse or it's late fall. For tall grass, mow once before installing mulch kit and once with mulch kit for a cleaner cut.
- **SLOWER CUTTING SPEED:** Reduce the speed you are mowing at in tougher conditions.
- **MINIMIZE CLUMPING:** Clean the underside of the mower after each use.
- **KEEP BLADES SHARP:** Check the sharpness and look for any damage to your blades after each use to ensure a clean cut and avoid grass tearing, which can lead to disease. Sharpen or replace blades if necessary.
- **MAINTAIN PROPER BELT TENSION:** Check tensioner arm to add tension. Change belt if needed.
- **CHECK YOUR TIRE PRESSURE:** Ensure tires have the right pressure and are evenly filled.
- **GIVE YOUR ENGINE FULL POWER:** Mow with the throttle dial turned up fully.
- **ENSURE GOOD AIR CIRCULATION:** Maintain air flow by ensuring at least one side of the mower deck isn't surrounded by grass. Raise the deck when cutting if needed.

# CONTACT YAKTA

**1-866-925-8201**

**clientcare@yakta.com**

**yakta.com**

