



SUN
& SOUL

4600™ Pergola Model



SSPTP4600260423

Sun & Soul – for the important things in life

SUNANDSOULSPAS.CO.NZ
SUNANDSOULSPAS.COM.AU

SUN & SOUL™ 4600™ Pergola Model

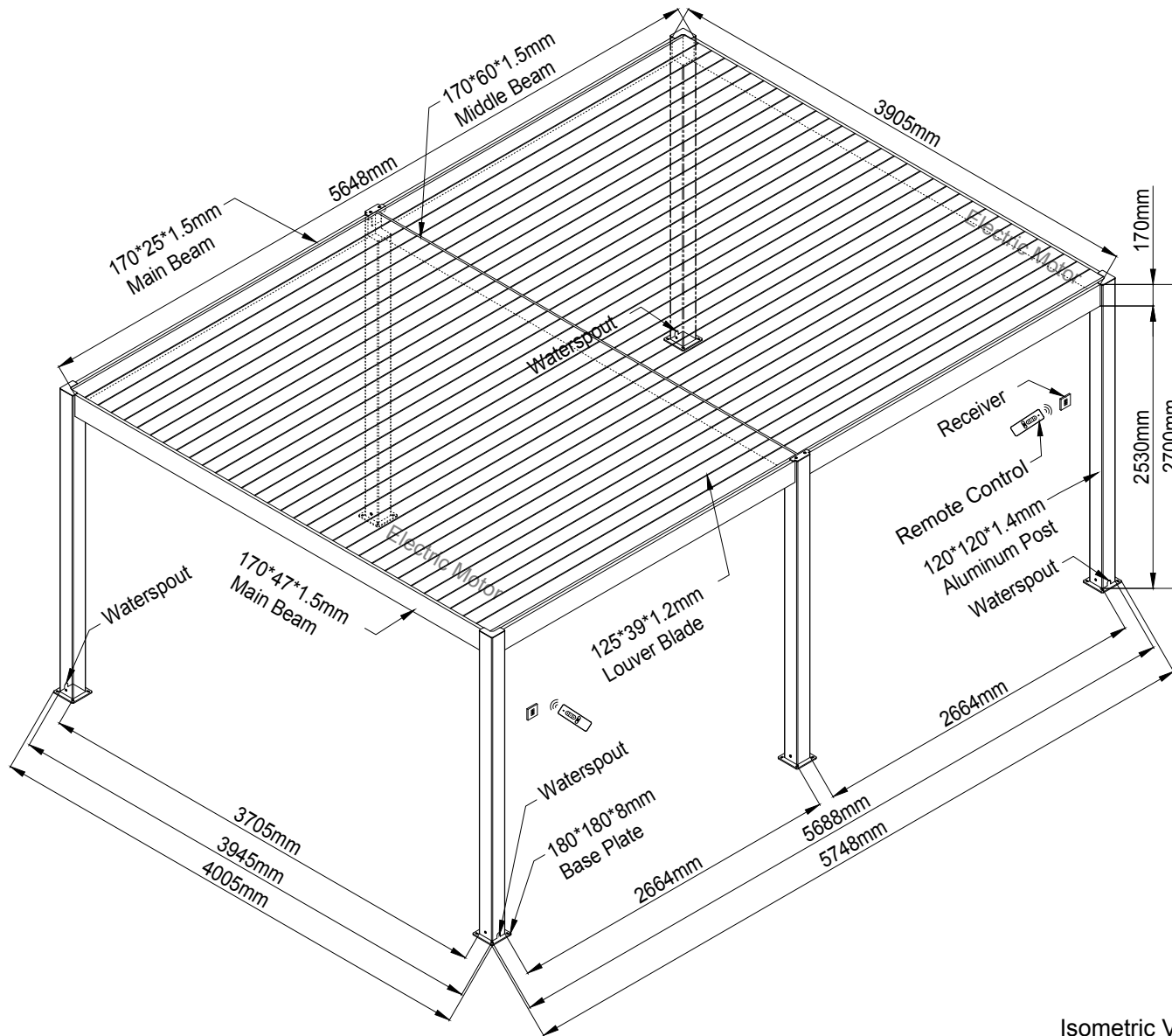

Isometric View

Title: 4600

Louvre Operation: Motor x 2

Control Method: Remote and Post Mount

Colour: Traffic White RAL 9016
Anthracite Grey RAL 7016

Lighting: LED Strip

Power Requirements: 10 Amp circuit

Material: Powder Coated Aluminium

Recommended Foundation: Concrete *
* Check with your local council

This pergola is intended as a semi-permanent structure - Please contact your local council for semi-permanent structure approval requirements.

SUN & SOUL™ 4600™ Pergola Model

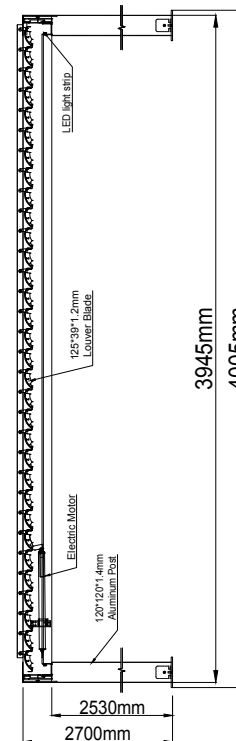
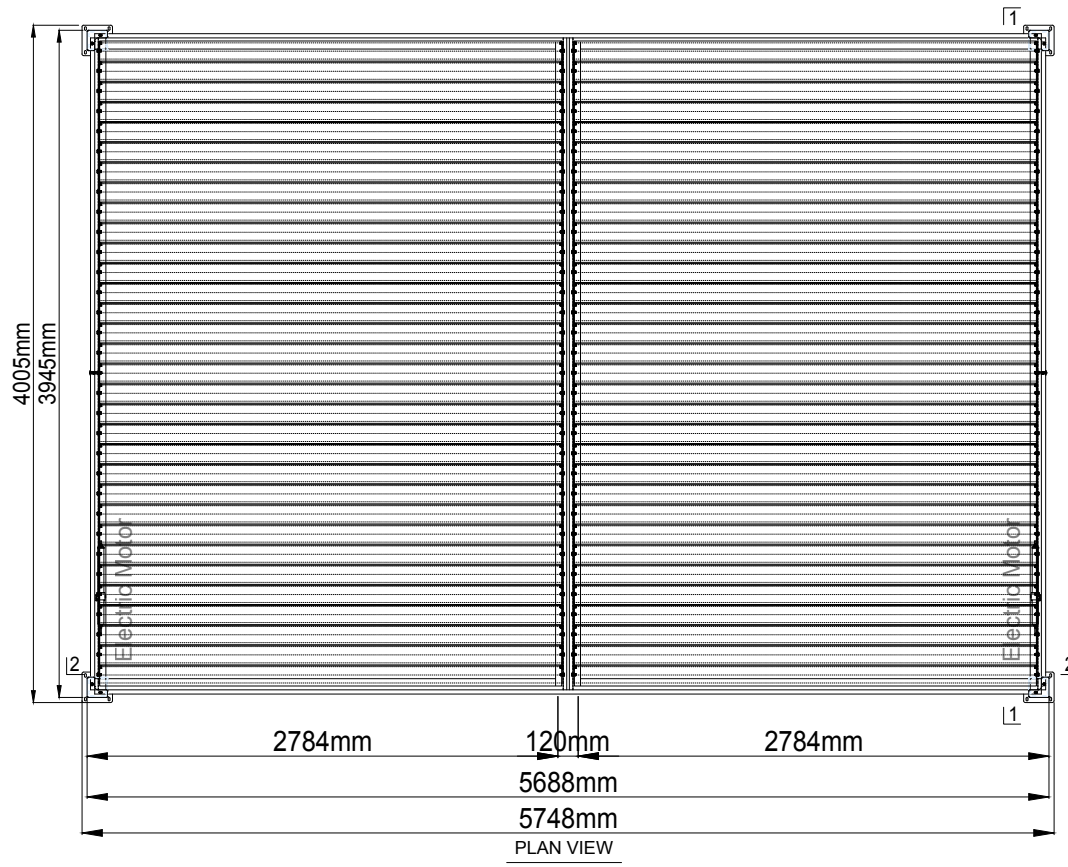

Elevation View 1-1

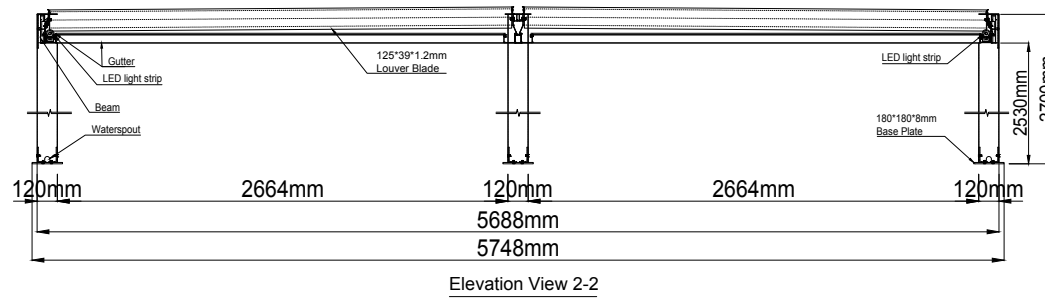

Title: 4600
Louvre Operation: Motor x 2
Control Method: Remote and Post Mount
Colour: Traffic White RAL 9016 Anthracite Grey RAL 7016
Lighting: LED Strip
Power Requirements: 10 Amp circuit
Material: Powder Coated Aluminium
Recommended Foundation: Concrete *
* Check with your local council

This pergola is intended as a semi-permanent structure - Please contact your local council for semi-permanent structure approval requirements.

SUN & SOUL™ 4600™ Pergola Model

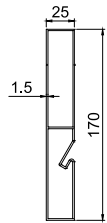

Beam1

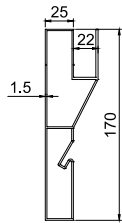

Beam2

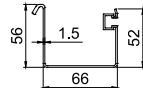

Gutter

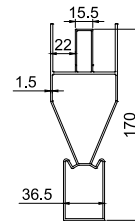

Middle Beam

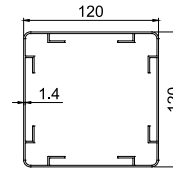

Post

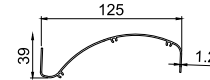

Louver Blade



Control Rod

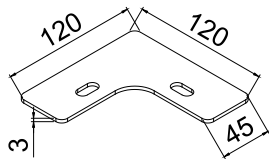

Post Top Cover

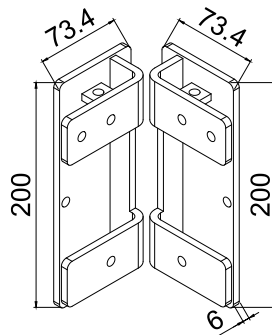

Post + Beam Connector

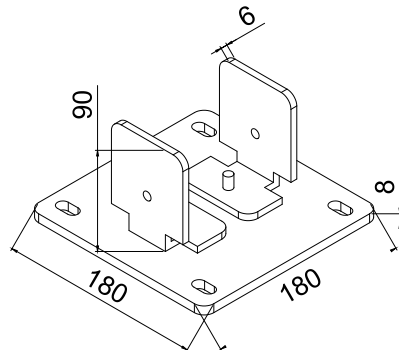

Base Plate

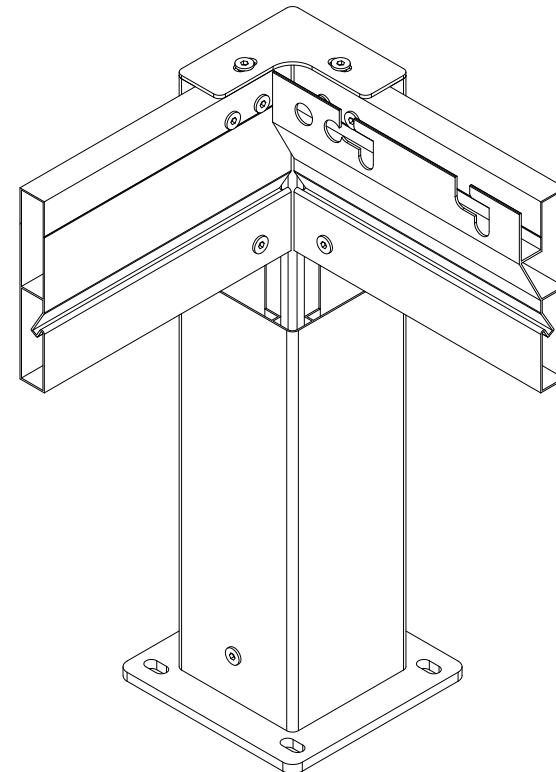

SUN & SOUL™ 4600™ Pergola Model

Standard Dimension (meters)			Packing Box Size (mm)			Total Package/ Set	Carton No.	N.W (kgs)	G.W (kgs)	Volume CBM	Description
Width	Length	Height	Width	Lenght	Height						
4	6	2.7	200	4010	200	8	1/8	48	52	0.16	Beam/Gutter/Control Rod/Motor
			205	3895	200		2/8	38	42	0.16	Beam
			356	2843	450		3/8	39	44	0.46	Louver Blades (Contains Driving Blade)
			356	2843	450		4/8	39	44	0.46	Louver Blades
			356	2843	450		5/8	39	44	0.46	Louver Blades
			356	2843	450		6/8	52	56	0.46	Louver Blades
			270	2970	265		7/8	43	47	0.21	Post/Accessories
			270	2735	145		8/8	19	23	0.11	Post
Optional Pergola Privacy Blinds Packaging											
	3	2.7	2825	170	220	1	21	25	21	25	
	4	2.7	3810	170	220	1	26	31	26	31	

The included anchors are for the standard concrete foundation design detailed in this document and certified by independent Engineers. Any other foundation type, including a wood deck, will require you to seek advice from an Engineer, which will stipulate the fasteners that are required.

SUN & SOUL™ 4600™ Pergola Model

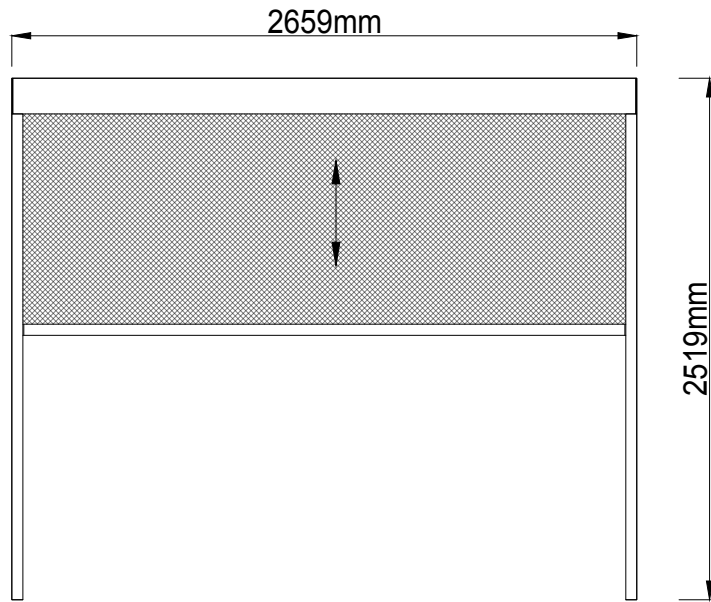

Side screen facade view

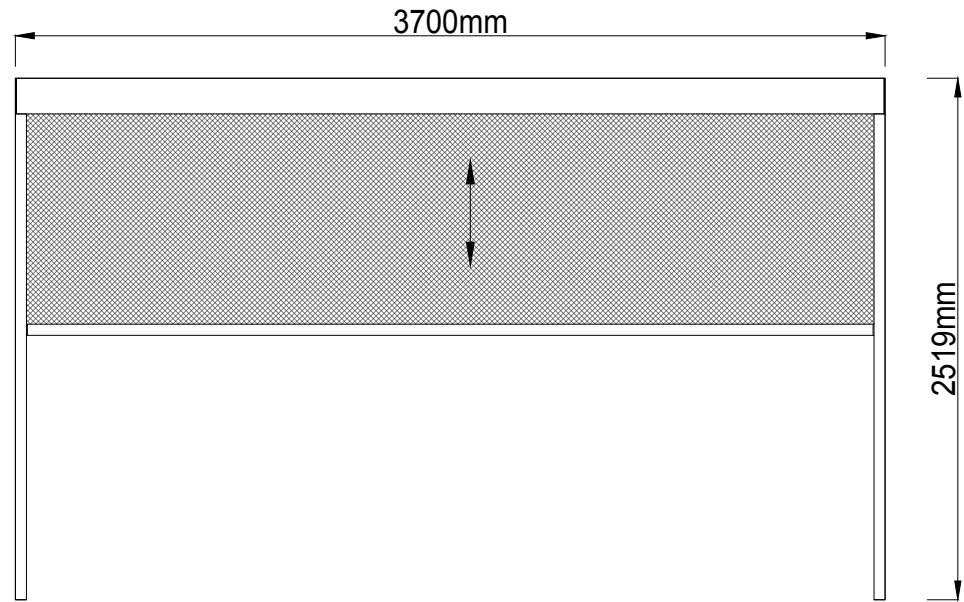

Side screen facade view

SUN & SOUL™ 4600™ Pergola Model

This pergola is intended as a semi-permanent structure - Please contact your local council for semi-permanent structure approval requirements.

NOTICE

Equipotential Bonding Compliance Obligation

This product is subject to Equipotential Bonding compliance in accordance with the Australian and New Zealand Standards (AS/NZS 3000: 2018 Electrical Installations) otherwise known as the Wiring Rules. If this product is installed within arms reach of a body of water including spa, swim spa or pool, then Equipotential Bonding **MUST** be performed by a licensed electrical person prior to the product being used. This is a mandatory requirement. As the purchaser of this product, you are responsible for ensuring compliance with this requirement at your own expense.

SUN & SOUL™ 4600™ Pergola Model

Drainage around your pergola

In most cases, you will need to install drainage around your pergola or gazebo if the roof is fully closed or can be closed. We always recommend checking local council regulations before you purchase or install a pergola.

- Your council may require you to install drainage around a pergola with fully closing louvres to catch the rainwater that flows across the louvres and down through the posts.
- Your council may also require water to be redirected to the household stormwater system, such as the downpipe system from your house.

Depending on your local regulations, you may not be allowed to let the water come out of the water spouts at the bottom of the pergola posts and onto the ground without drainage to catch and redirect it to the household stormwater system.

If you are installing your spa on an existing or new pad, you should consult with a building certifier before any installation to determine the requirements.

SUN & SOUL™ 4600™ Pergola Model

Frequently Asked Questions

This section is designed to provide a simplified overview of current regulations in reference to SUN & SOUL™ Pergolas. It is not state specific and therefore is not a complete guide.

We advise you to seek independent advice for your individual site requirements.

Do I need council consent to install a pergola?

This depends on the state you live in and the value of your complete project. Please contact your local council for the complete details.

Can I install my pergola onto a deck?

Yes, however, the engineering that has been done is based on a concrete footing. If you wish to put the pergola on a deck, you must have the foundation certified by an engineer.

Do I need engineering for my pergola?

We can provide engineering documents based on standard concrete foundations. Any variation from the standard foundation will require re-engineered certification.

Do I need an Electrician for the installation of my pergola?

Yes, a licenced electrician is require to hardwire the electrical supply to the motorised pergola. The cable can be hidden by running it through the posts for a tidy finish.

How Many motors are on the SUN & SOUL™ pergolas?

3300 = 1
3400 = 2
4600 = 2

How far do the louvres open?

Roughly 90°

How long does it take to install a pergola?

Each installation will vary based on many factors including, location, foundations, workers availability and experience etc. As a guide, a pergola can take 4-6 hours with 3 people.

Do SUN & SOUL™ Pergolas have a wind rating/classification?

Yes, you can find that on the following pages.

What grade of aluminium is used in the SUN & SOUL™ Pergolas?

6063-T5. (Detailed information available in the following pages)

Are the pergolas available in a lower height model?

Unfortunately, we cannot provide custom sizes.

Am I able to attach the pergola to an existing structure, such as a house?

We recommend that you discuss this option with your builder/ engineer.

Can we have changing colours in the LED Lighting?

Unfortunately, we are unable to offer this at this stage.

Do the Louvres automatically close when it rains?

The louvres do not automatically close when it rains.

*Information is subject to change without notice. Contact your dealer for the most up to date information.

SUN & SOUL™ Pergolas Limited Warranty

Vortex Leisure Pty Ltd distributes the SUN & SOUL™ Pergolas within Australia.

5 year structural warranty

Vortex Leisure Pty Ltd warrants the structural integrity of the pergola frame against defects in workmanship and materials for 5 years subject to the limitations, conditions and exclusions expressed in this warranty.

1 year lighting warranty

Vortex Leisure Pty Ltd warrants against any defects in the LED lighting supplied by Vortex Leisure Pty Ltd for a period of 1 year from date of manufacture. This warranty does not cover damage to the lights caused by incorrect use.

1 year motor warranty

Vortex Leisure Pty Ltd warrants the motor against defects in materials and workmanship for a period of 1 year from date of manufacture. This warranty does not cover damage to the motor caused by incorrect use.

1 year electronic components warranty

Vortex Leisure Pty Ltd warrants electronic control systems against defects in materials and workmanship for a period of 1 year from date of manufacture.

1 year pergola blinds warranty

Vortex Leisure Pty Ltd warrants the pergola blinds against defects in materials and workmanship for a period of 1 year from date of manufacture. The blinds must remain retracted when not in use. High winds can damage the blinds and this damage will not be covered under warranty. Fading and weathering of the surface will occur naturally over time, and are not considered defects and will not be covered under warranty.

1 year louvre roof warranty

Vortex Leisure Pty Ltd warrants the louvre roof and its components against defects in materials and workmanship for a period of 1 year from date of manufacture. Fading and weathering of the surface may occur naturally over time, and are not considered defects.

1 year powder coat warranty

Vortex Leisure Pty Ltd warrants the powder coat for a period of 1 year from the date of delivery. Fading and peeling may naturally occur over time and will not be covered under warranty. Damage caused to the powder coat due to improper use will not be covered under warranty. Disposal of any component replaced under warranty will be the owners responsibility.

Warranty coverage

Warranty coverage begins at the delivery date. Vortex Leisure Pty Ltd only extends this warranty to the original purchaser and only if the pergola has been purchased through an authorised Vortex Leisure Pty Ltd reseller. Written notice of the defect and proof of purchase must be provided to Vortex Leisure Pty Ltd or it's nominated representative within 14 days of the defect occurring. If the pergola is required to be returned to Vortex Leisure Pty Ltd for rectification all freight costs shall be pre-paid by the customer. Repair or replacement of any defective product is at the sole discretion of Vortex Leisure Pty Ltd. To action warranty service contact the authorised Vortex Leisure Pty Ltd reseller your purchased from. If you are unable to obtain satisfactory service from your reseller written notification must be provided to Vortex Leisure Pty Ltd within 14 days of the defect occurring. Vortex Leisure Pty Ltd will pay the travel costs of the service agent for the first 50km from their base. Any further travel charges shall be the responsibility of the pergola owner.

Electrical connection

Any required electrical work must be carried out by a licensed electrician. Vortex Leisure Pty Ltd reserve the right to ask for proof that the pergola has been installed by a qualified electrician.

Warranty exclusions

1. Damage resulting from improper maintenance.
2. Damage caused to the pergola by improper use and natural fading from sunlight.
3. Acts of God.
4. Damage caused by not installing the pergola correctly.
5. Damage caused by incorrect electrical installation, brownouts, voltage spikes or operating pergola out of +/- 10% of voltage range.
6. Commercial use reduces all warranties to maximum 6 months.
7. Damage caused by relocation of the pergola from its original installed location.
8. Damage caused by third party carriers.
9. Drain or gutter leakage.
10. Damage to frame caused by unrepaired drain leakage.
11. Remote batteries are excluded from the warranty.

Limitations

This warranty is the only warranty offered by Vortex Leisure Pty Ltd and excludes any other implied or oral undertakings. Except as described above, this warranty does not cover defects or damage due to normal wear and tear, improper installation, alteration without Vortex Leisure Pty Ltd prior written consent, accident, acts of God, misuse, abuse, commercial or industrial use, use of an accessory not approved by Vortex Leisure Pty Ltd, failure to follow SUN & SOUL™ Pergolas or Owner's Manual, or repairs made or attempted by anyone other than an authorised representative of Vortex Leisure Pty Ltd. Vortex Leisure Pty Ltd or its agents will not be liable for any incidental or consequential loss or injury. Vortex Leisure Pty Ltd will not be liable for costs associated with but not limited to building alterations, removal costs, delivery costs or labour costs associated with the replacement or repair of pergola and parts.



SUN
& SOUL