

**LEGEND**

- STAGE BOUNDARY
- FINISHED SURFACE MAJOR CONTOURS (1.0m)  620.0
- FINISHED SURFACE MINOR CONTOURS (0.5m)
- FILL  3m<sup>2</sup>
- FILL DEPTH (to nearest 100mm) x 0.5
- DRIVEWAY LOCATION
- INDICATIVE MULTI UNIT DRIVEWAY LOCATION
- 3.5m COMBINED EASEMENT (Sewer and Stormwater)
- RETAINING WALL

**NOTES**

THIS PLAN ONLY INDICATES AREA OF FILL OF WHICH THE DEVELOPER AND THEIR AGENTS ARE AWARE. IT HAS NOT BEEN CHECKED BY THE DEVELOPER, AND THE DEVELOPER DOES NOT GUARANTEE ITS ACCURACY. IN NO WAY SHOULD THIS PLAN BE READ AS A CONCLUSIVE STATEMENT OF THE FULL EXTENT OF THE FILL THAT MAY BE FOUND ON THE WHOLE LAND DEPICTED. LESSEES AND PURCHASERS SHOULD MAKE THEIR OWN INQUIRIES IN REGARD TO THE EXACT DRAINAGE, GEOTECHNICAL AND FILL CONDITIONS AFFECTING THEIR BLOCKS.

**CT**

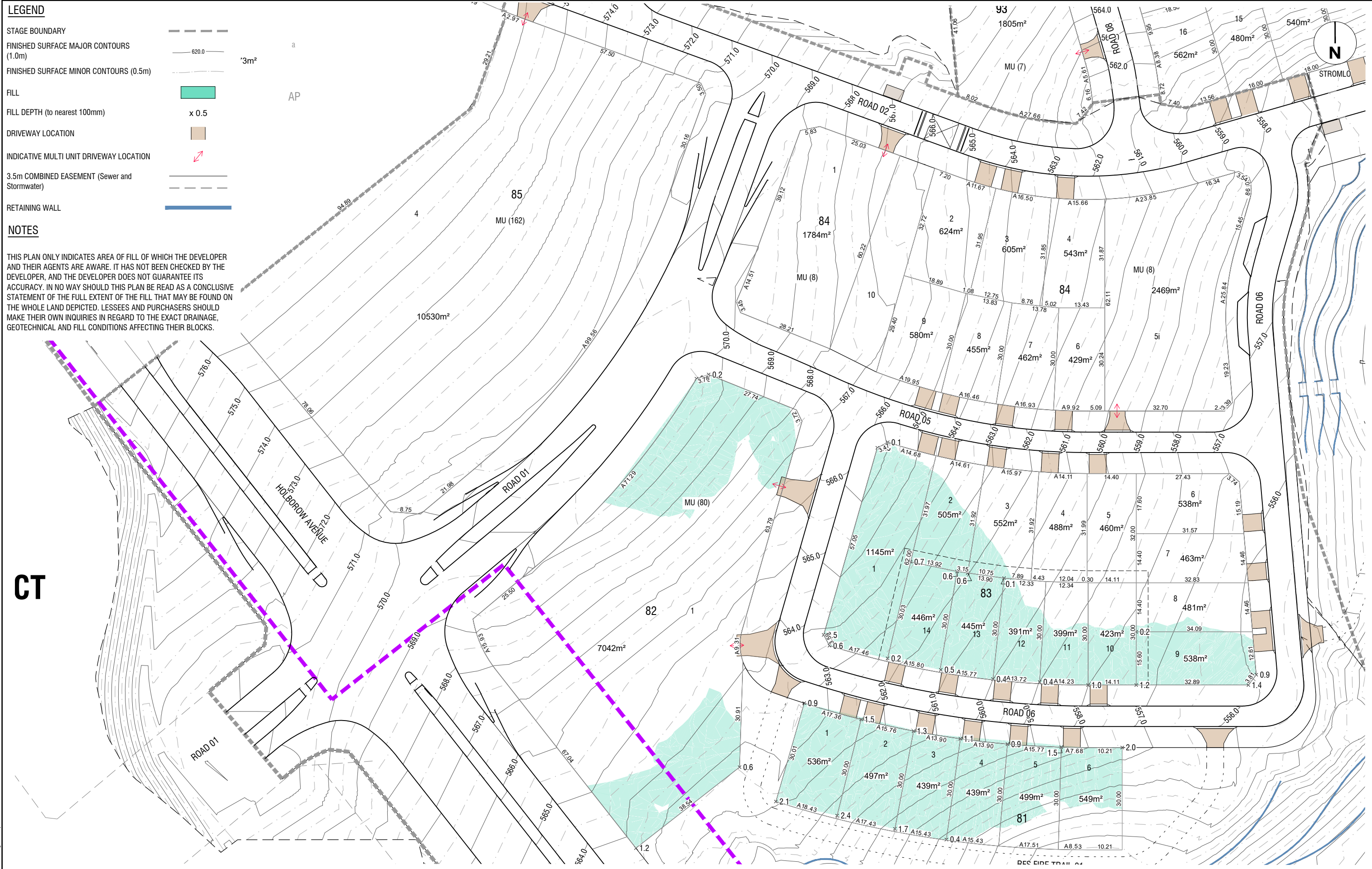

F	FILL ON BLOCKS UPDATED	C.J.C	18-05-23
E	BAL RATINGS UPDATED	C.J.C	28-04-22
D	BLOCK NUMBERS ADJUSTED	C.J.C	20-04-22
C	BLOCK NUMBERS ADJUSTED	C.J.C	20-04-22
B	FILL ON BLOCKS UPDATED. VIEWPORT MOVED TO REFLECT NEW STAGING	BC	20-09-21
A	ISSUED TO CLIENT	BC	03-05-21
Rev	Amendments	Approved	Date

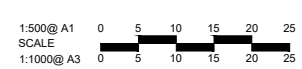

© Spiire Australia Pty Ltd All Rights Reserved  
 This document is produced by Spiire Australia Pty Ltd solely for the benefit of and use by the client in accordance with the terms of the retainer. Spiire Australia Pty Ltd does not and shall not assume any responsibility or liability whatsoever to any third party arising out of any use or reliance by third party on the contents of this document.

Suite 3, Level 1, 243 Northbourne Ave Lyneham 2602  
 Australian Capital Territory Australia T 61 2 6102 1000  
 spiire.com.au ABN 55 050 029 635

Designed  
**R. MURDOCK**  
 Authorised  
**B. CARGILL**

Checked  
**B. CARGILL**  
 Date  
 20-04-21

**DENMAN PROSPECT 2**  
**STAGES 1 2A & 2B**  
**FILL ON BLOCK PLAN**  
**STAGE 1 - SECTION AP**  
 ACT  
 CED

Drg No  
**308664CS030**

Rev  
**F**

file name: 308664CS030.dwg; input name: CS030; plotted by: Jima Zhang; plot date: 19/05/2023 4:18 PM; Sheet of: 2; plot date: 19/05/2023 4:18 PM; Sheet of: 2

**LEGEND**

- STAGE BOUNDARY
- FINISHED SURFACE MAJOR CONTOURS (1.0m)
- FINISHED SURFACE MINOR CONTOURS (0.5m)
- FILL
- FILL DEPTH (to nearest 100mm)
- DRIVEWAY LOCATION
- INDICATIVE MULTI UNIT DRIVEWAY LOCATION
- 3.5m COMBINED EASEMENT (Sewer and Stormwater)
- RETAINING WALL

**NOTES**

THIS PLAN ONLY INDICATES AREA OF FILL OF WHICH THE DEVELOPER AND THEIR AGENTS ARE AWARE. IT HAS NOT BEEN CHECKED BY THE DEVELOPER, AND THE DEVELOPER DOES NOT GUARANTEE ITS ACCURACY. IN NO WAY SHOULD THIS PLAN BE READ AS A CONCLUSIVE STATEMENT OF THE FULL EXTENT OF THE FILL THAT MAY BE FOUND ON THE WHOLE LAND DEPICTED. LESSEES AND PURCHASERS SHOULD MAKE THEIR OWN INQUIRIES IN REGARD TO THE EXACT DRAINAGE, GEOTECHNICAL AND FILL CONDITIONS AFFECTING THEIR BLOCKS.

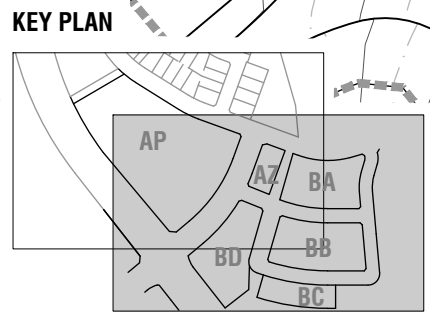
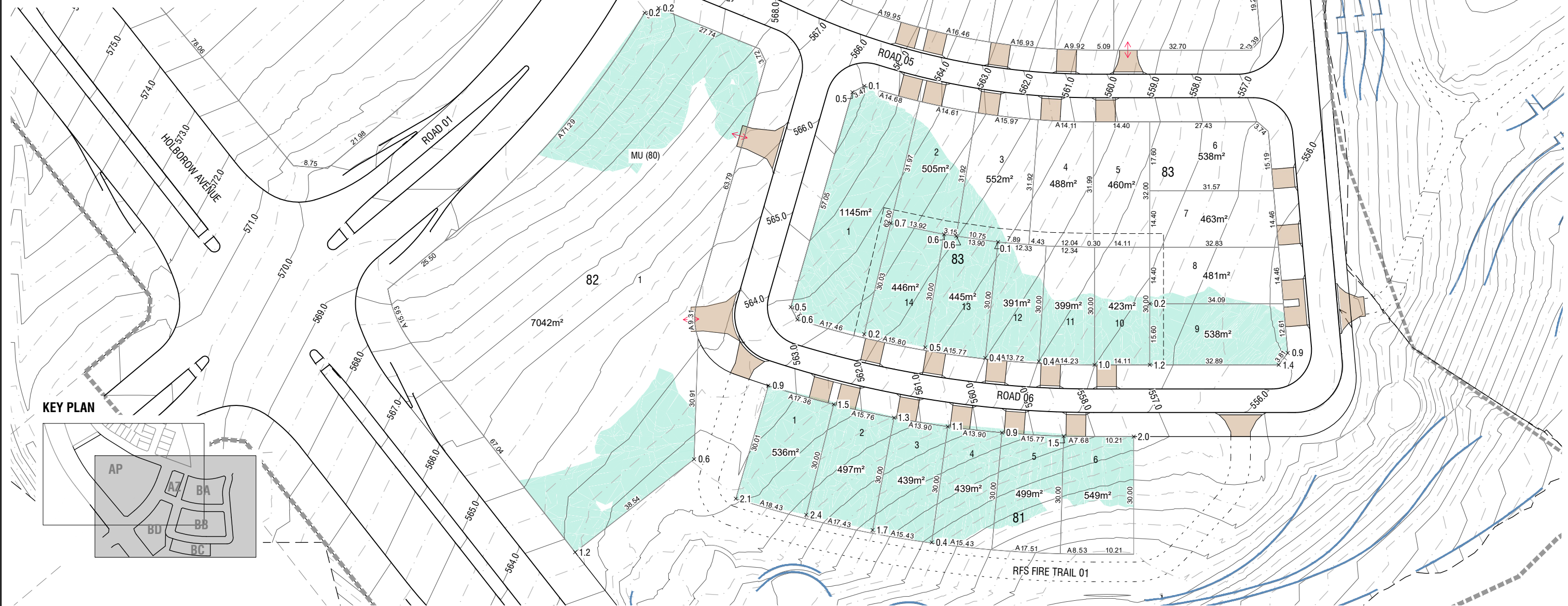

file name: 308664CS031.dwg; input name: CS031; plotted by: Rachel Murdoch; file location: G:\308664CS031\ACAD\Sales Plans\Stage 1 & 2; plot date: 22/08/2023 10:02 AM; Sheet of Sheets

Rev	Description	Approved	Date
B	FILL ON BLOCKS UPDATED	C.J.C	18-05-23
A	ISSUED TO CLIENT	BC	03-05-21

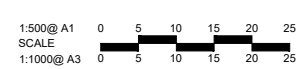

© Spiire Australia Pty Ltd All Rights Reserved  
This document is produced by Spiire Australia Pty Ltd solely for the benefit of and use by the client in accordance with the terms of the retainer. Spiire Australia Pty Ltd does not and shall not assume any responsibility or liability whatsoever to any third party arising out of any use or reliance by third party on the contents of this document.

Suite 3, Level 1, 243 Northbourne Ave Lyneham 2602  
Australian Capital Territory Australia T 61 2 6102 1000  
spiire.com.au ABN 55 050 029 635

Designed  
**R. MURDOCK**

Checked  
**B. CARGILL**

Authorised  
**B. CARGILL**

Date  
20-04-21

**DENMAN PROSPECT 2**  
**STAGES 1 2A & 2B**  
**FILL ON BLOCK PLAN**  
**STAGE 1 - SECTION BD, AZ, BA, BB, BC**  
**ACT**  
**CED**

Drg No  
**308664CS031**

Rev  
**B**

**LEGEND**

- STAGE BOUNDARY
- FINISHED SURFACE MAJOR CONTOURS (1.0m)
- FINISHED SURFACE MINOR CONTOURS (0.5m)
- FILL
- FILL DEPTH (to nearest 100mm)
- DRIVEWAY LOCATION
- INDICATIVE MULTI UNIT DRIVEWAY LOCATION
- 3.5m COMBINED EASEMENT (Sewer and Stormwater)
- RETAINING WALL

**NOTES**

THIS PLAN ONLY INDICATES AREA OF FILL OF WHICH THE DEVELOPER AND THEIR AGENTS ARE AWARE. IT HAS NOT BEEN CHECKED BY THE DEVELOPER, AND THE DEVELOPER DOES NOT GUARANTEE ITS ACCURACY. IN NO WAY SHOULD THIS PLAN BE READ AS A CONCLUSIVE STATEMENT OF THE FULL EXTENT OF THE FILL THAT MAY BE FOUND ON THE WHOLE LAND DEPICTED. LESSEES AND PURCHASERS SHOULD MAKE THEIR OWN INQUIRIES IN REGARD TO THE EXACT DRAINAGE, GEOTECHNICAL AND FILL CONDITIONS AFFECTING THEIR BLOCKS.



**KEY PLAN**

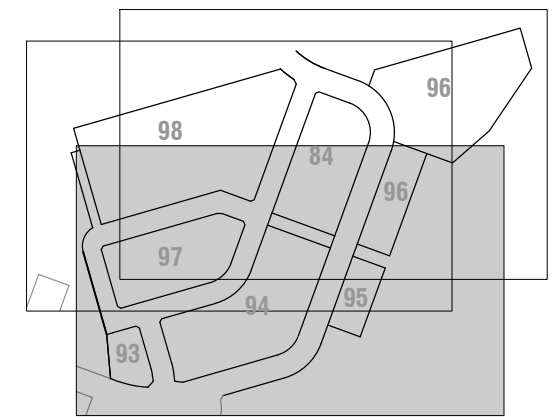

file name: 308664CS040.dwg; input name: CS040; plotted by: Jing Zhang; plot date: 19/05/2023 4:18 PM; Sheet: 1 of 2; plot date: 19/05/2023 4:18 PM; Sheet: 1 of 2

Rev	Amendments	Approved	Date
C	FILL ON BLOCKS UPDATED	C.J.C	18-05-23
B	FILL ON BLOCKS UPDATED	BC	20-09-21
A	ISSUED TO CLIENT	BC	10-05-21

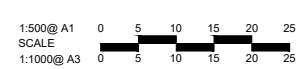

© Spiire Australia Pty Ltd All Rights Reserved  
 This document is produced by Spiire Australia Pty Ltd solely for the benefit of and use by the client in accordance with the terms of the retainer. Spiire Australia Pty Ltd does not and shall not assume any responsibility or liability whatsoever to any third party arising out of any use or reliance by third party on the contents of this document.



Suite 3, Level 1, 243 Northbourne Ave Lyneham 2602  
 Australian Capital Territory Australia T 61 2 6102 1000  
 spiire.com.au ABN 55 050 029 635



Designed  
**R. MURDOCK**  
 Authorised  
**B. CARGILL**



Checked  
**B. CARGILL**  
 Date  
 10-05-2021

**DENMAN PROSPECT 2**  
**STAGES 1 2A & 2B**  
 FILL ON BLOCK PLAN  
 STAGE 2 - SECTION AS, AU, AT  
 ACT  
 CED

Drg No  
**308664CS040**  
 Rev  
**C**

**LEGEND**

- STAGE BOUNDARY
- FINISHED SURFACE MAJOR CONTOURS (1.0m)
- FINISHED SURFACE MINOR CONTOURS (0.5m)
- FILL
- FILL DEPTH (to nearest 100mm)
- DRIVEWAY LOCATION
- INDICATIVE MULTI UNIT DRIVEWAY LOCATION
- 3.5m COMBINED EASEMENT (Sewer and Stormwater)
- RETAINING WALL

**NOTES**

THIS PLAN ONLY INDICATES AREA OF FILL OF WHICH THE DEVELOPER AND THEIR AGENTS ARE AWARE. IT HAS NOT BEEN CHECKED BY THE DEVELOPER, AND THE DEVELOPER DOES NOT GUARANTEE ITS ACCURACY. IN NO WAY SHOULD THIS PLAN BE READ AS A CONCLUSIVE STATEMENT OF THE FULL EXTENT OF THE FILL THAT MAY BE FOUND ON THE WHOLE LAND DEPICTED. LESSEES AND PURCHASERS SHOULD MAKE THEIR OWN INQUIRIES IN REGARD TO THE EXACT DRAINAGE, GEOTECHNICAL AND FILL CONDITIONS AFFECTING THEIR BLOCKS.



**KEY PLAN**

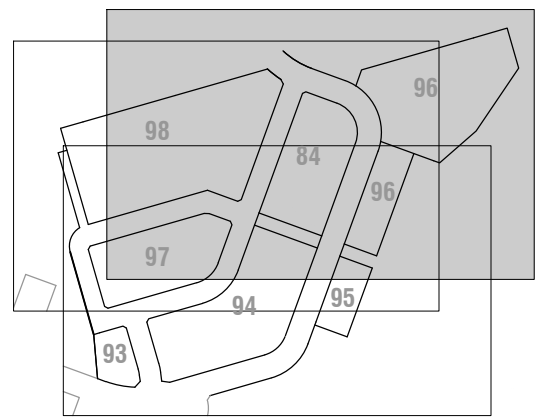

file name: 308664CS041.dwg; input name: CS041; plotted by: Jing Zhang; plot date: 19/05/2023 4:18 PM; Sheet: 1 of 2; plot location: C:\308664CS041\308664CS041.dwg

Rev	Amendments	Approved	Date
C	FILL ON BLOCKS UPDATED	C.J.C	18-05-23
B	FILL ON BLOCKS UPDATED	BC	20-09-21
A	ISSUED TO CLIENT	BC	10-05-21

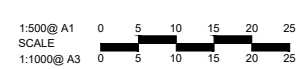

© Spiire Australia Pty Ltd All Rights Reserved  
This document is produced by Spiire Australia Pty Ltd solely for the benefit of and use by the client in accordance with the terms of the retainer. Spiire Australia Pty Ltd does not and shall not assume any responsibility or liability whatsoever to any third party arising out of any use or reliance by third party on the contents of this document.



Suite 3, Level 1, 243 Northbourne Ave Lyneham 2602  
Australian Capital Territory Australia T 61 2 6102 1000  
spiire.com.au ABN 55 050 029 635



Designed  
**R. MURDOCK**  
Authorised  
**B. CARGILL**



Checked  
**B. CARGILL**  
Date  
10-05-2021

**DENMAN PROSPECT 2**  
**STAGES 1 2A & 2B**  
**FILL ON BLOCK PLAN**  
**STAGE 2 - SECTION AS, AU, AT**  
ACT  
CED

Drg No  
**308664CS041**  
Rev  
**B**

**LEGEND**

- STAGE BOUNDARY
- FINISHED SURFACE MAJOR CONTOURS (1.0m)
- FINISHED SURFACE MINOR CONTOURS (0.5m)
- FILL
- FILL DEPTH (to nearest 100mm) x 0.5
- DRIVEWAY LOCATION
- INDICATIVE MULTI UNIT DRIVEWAY LOCATION
- 3.5m COMBINED EASEMENT (Sewer and Stormwater)
- RETAINING WALL

**NOTES**

THIS PLAN ONLY INDICATES AREA OF FILL OF WHICH THE DEVELOPER AND THEIR AGENTS ARE AWARE. IT HAS NOT BEEN CHECKED BY THE DEVELOPER, AND THE DEVELOPER DOES NOT GUARANTEE ITS ACCURACY. IN NO WAY SHOULD THIS PLAN BE READ AS A CONCLUSIVE STATEMENT OF THE FULL EXTENT OF THE FILL THAT MAY BE FOUND ON THE WHOLE LAND DEPICTED. LESSEES AND PURCHASERS SHOULD MAKE THEIR OWN INQUIRIES IN REGARD TO THE EXACT DRAINAGE, GEOTECHNICAL AND FILL CONDITIONS AFFECTING THEIR BLOCKS.

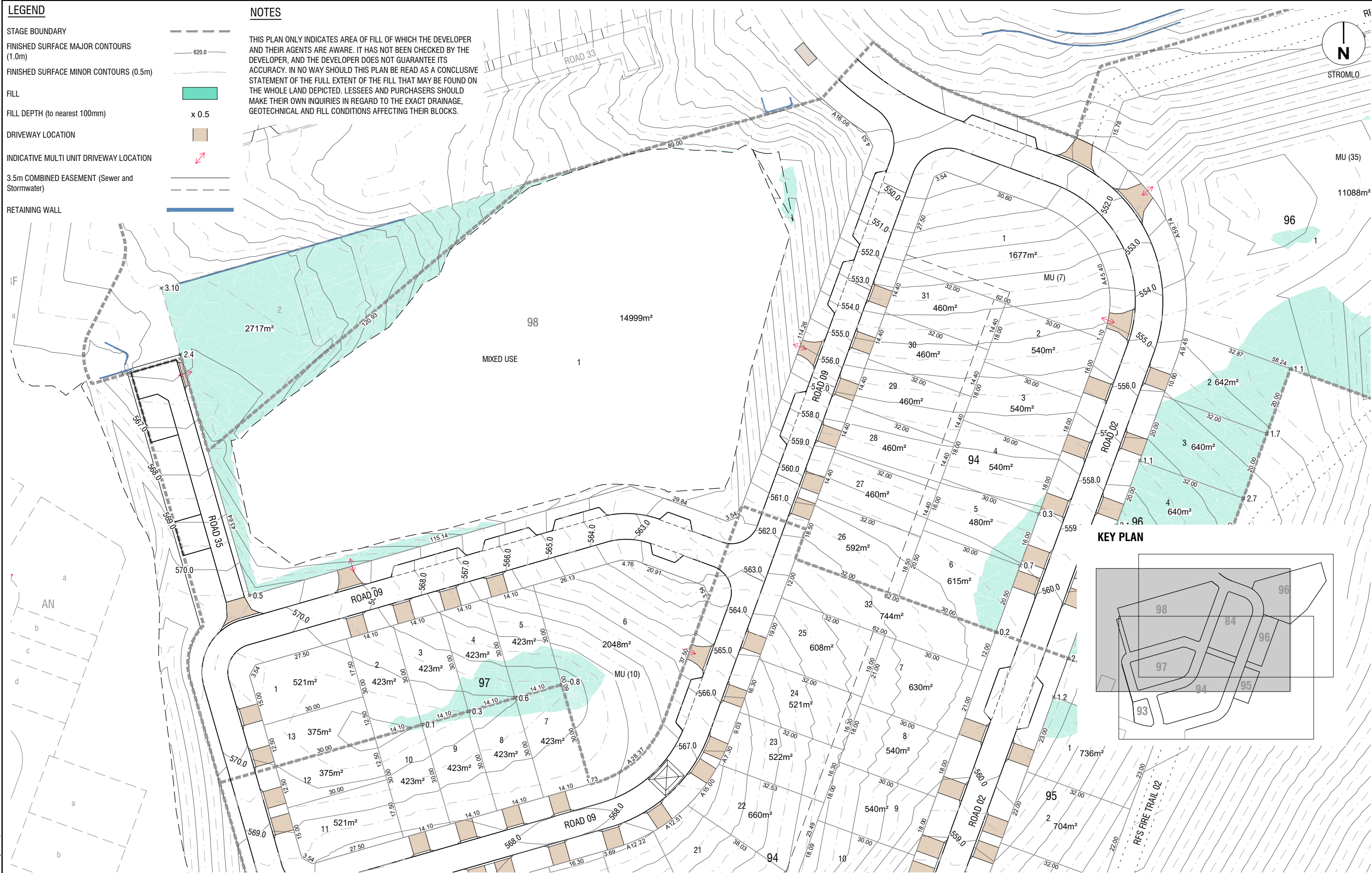

**KEY PLAN**

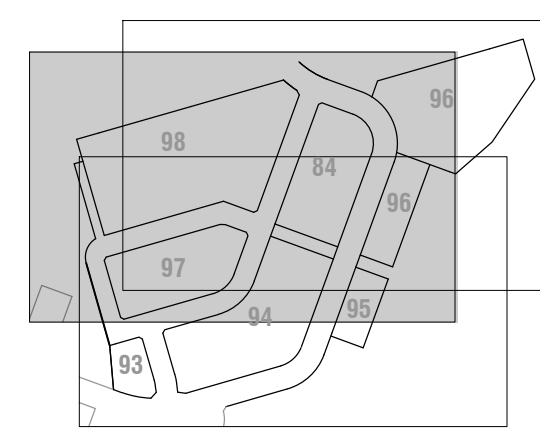

file name: 308664CS042.dwg; input name: CS042; plotted by: Jina Zhang; plot date: 19/05/2023 4:18 PM; Sheet of Sheets

G	FILL ON BLOCKS UPDATED	C.J.C	18-05-23
F	BAL RATINGS UPDATED	C.J.C	28-04-22
E	BLOCK NUMBERS ADJUSTED	C.J.C	20-04-22
D	BLOCK NUMBERS ADJUSTED	C.J.C	20-04-22
C	FILL ON BLOCKS UPDATED	BC	20-09-21
B	AMENDED IN ACCORDANCE WITH CLIENT COMMENTS	BC	27-07-21
A	ISSUED TO CLIENT	BC	10-05-21
Rev	Amendments	Approved	Date

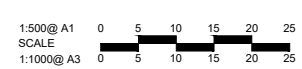

© Spiire Australia Pty Ltd All Rights Reserved  
 This document is produced by Spiire Australia Pty Ltd solely for the benefit of and use by the client in accordance with the terms of the retainer. Spiire Australia Pty Ltd does not and shall not assume any responsibility or liability whatsoever to any third party arising out of any use or reliance by third party on the contents of this document.



Suite 3, Level 1, 243 Northbourne Ave Lyneham 2602  
 Australian Capital Territory Australia T 61 2 6102 1000  
 spiire.com.au ABN 55 050 029 635



Designed  
**R. MURDOCK**  
 Authorised  
**B. CARGILL**



Checked  
**B. CARGILL**  
 Date  
 10-05-21

**DENMAN PROSPECT 2**  
**STAGES 1 2A & 2B**  
**FILL ON BLOCK PLAN**  
**STAGE 2 - SECTION AR**  
 ACT  
 CED

Drg No  
**308664CS042**  
 Rev  
**G**