



The delivered product may differ from the product shown in the image.

- Stainless steel load chain.
- Suspension hook rotated 90°.
- Flexible chain container.
- Other operating voltages.
- Limit switches for highest and lowest hook positions (in combination with low voltage control).
- Radio remote control.
- Control for synchronized operation of several hoists.
- Manual and electric trolleys.
- Festooned cable system or conductor rail system.

CPEF Electric chain hoist with V or with integrated trolley

Capacity 1600 - 7500 kg

The CPEF series is a range of high quality products for professional applications. They are highly efficient and engineered for a long working life. The hoists are composed of three main component parts which makes service easy and inexpensive.

Features

- Classification 1 Am/M4, except CPEF 20-8, CPEF 30-5 und CPEF 40-4 with classification 1 Bm/M3.
 - 42 V low voltage control.
 - 2 year warranty (excluding wear parts) as well as a lifetime lubricated gear box.
 - Motor fitted with a bimetallic thermal protection
 - Duty cycle 40 % at one operating speed.
 - The heavy duty squirrel cage motor has an adjustable spring pressure brake that holds the load secure even in the event of a power failure.
 - Standard operating voltage: Euro-voltage 400 V, 3-phase, 50 Hz.
 - Motor protected to IP 54, insulation class F.
 - Encapsulated pendant control protected to IP 65, against ingress of dust and water jets.
 - The 5-pocket load chain sheave, manufactured from wear resistant case hardening steel, is matched perfectly to the load chain to guarantee smooth and precise chain motion.
 - The standard, oil bath lubricated planetary gearbox is particularly smooth running.
 - Forged suspension and load hooks are made from non-aging, high tensile steel and fitted with robust safety latches.
 - The standard case hardened and zinc-plated link chain is matched perfectly to the load chain to guarantee smooth and precise chain motion.
- All requirements of national and international standards and regulations are fulfilled.

Options

CPEF 100-2
Electric chain hoist
with suspension hook or with
integrated trolley

Capacity 10000 kg

The model CPEF 100-2 consists of two CPEF 50-2 units. They are connected by a framework. Hook suspension, geared or electric trolleys are available. Integrated limit switches for highest and lowest hook positions are standard. 42V low voltage control as standard.

Options

- Stainless steel load chain.
- Flexible chain container.
- Other operating voltages.
- Motor with stainless steel brake.
- Radio remote control.
- Festooned cable system or conductor rail system.

INFO

The units are certified by the employer's liability insurance association (Berufsgenossenschaft) and fulfil the requirements of the machinery directive 2006/42/EG.

Festooned cable systems please see pages 146-147.



The delivered product may differ from the product shown in the image.

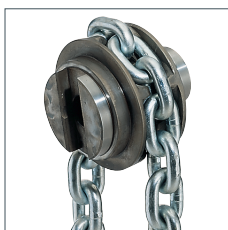

5-pocket load chain sheave machined for smooth, precise chain motion.



Universal connection to suspension hook, trolley or steel structures.



Double fall bottom block for capacities between 3200 up to 5000 kg.

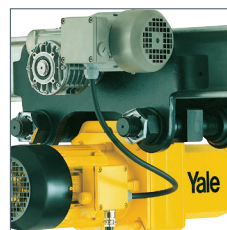

Hoist connected directly to trolley with electric drive. Manual pull and geared trolleys also available.



Option: Flexible chain container made from wear resistant textile fabric.

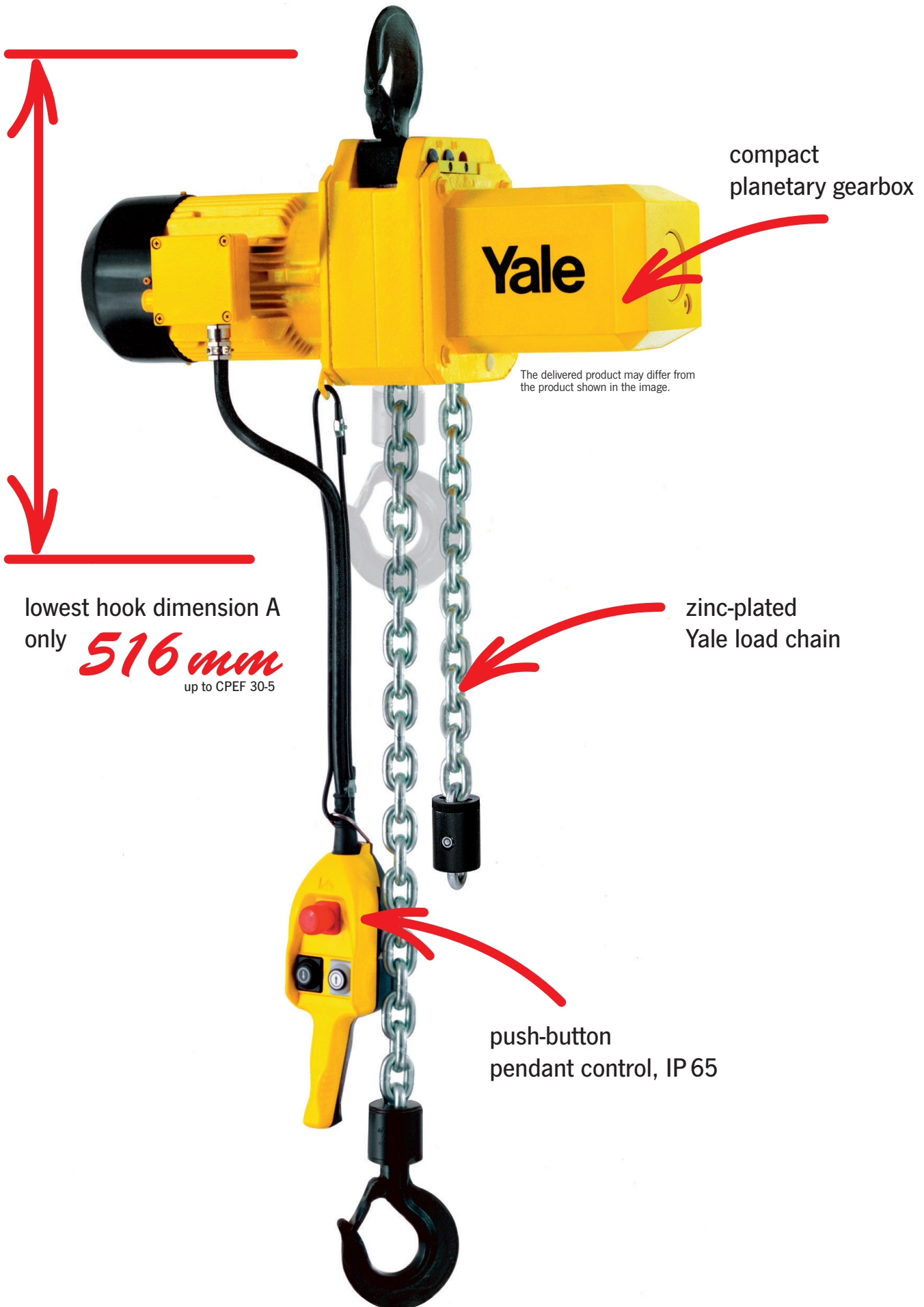

Technical data CPEF - 400V, 3 phase, 50 Hz

Model	Art.-No. CPEF with hook suspension	Capacity in kg/ Number of chain falls	Chain dimensions d x p mm	Classification FEM/ISO	Lifting speed		Hoist motor kW	Motor rating ED %
					main lift m/min	fine lift m/min		
CPEF 16-8	N06000246	1600/1	11 x 31	1Am/M4	8	2	2.3/0.58	40/20
CPEF 20-8	N06000248	2000/1	11 x 31	1Bm/M3	8	2	2.8/0.7	25/15
CPEF 25-5	N06000250	2500/1	11 x 31	1Am/M4	5	1.25	2.3/0.58	40/20
CPEF 30-5	N06000252	3000/1	11 x 31	1Bm/M3	5	1.25	2.8/0.7	25/15
CPEF 32-4	N06000254	3200/2	11 x 31	1Am/M4	4	1	2.3/0.58	40/20
CPEF 40-4	N06000256	4000/2	11 x 31	1Bm/M3	4	1	2.8/0.7	25/15
CPEF 50-2	N06000258	5000/2	11 x 31	1Am/M4	2.5	0.6	2.3/0.58	40/20
CPEF 75-1,6	N06000278	7500/3	11 x 31	1Am/M4	1.6	0.4	2.8/0.58	40/20
CPEF 100-2	N06041607	10000/4	11 x 31	1Am/M4	2.5	0.6	2 x 2.3/0.58	40/20

Model	Weight at standard lift (3 m) ¹		
	suspension hook kg	manual geared trolley kg	electric trolley kg
CPEF 16-8	93	159	171
CPEF 20-8	93	159	171
CPEF 25-5	93	159	171
CPEF 30-5	93	159	171
CPEF 32-4	112	178	189
CPEF 40-4	112	178	189
CPEF 50-2	112	178	189
CPEF 75-1,6	226	326	348
CPEF 100-2	287	390	413

¹Other lifting heights on request.

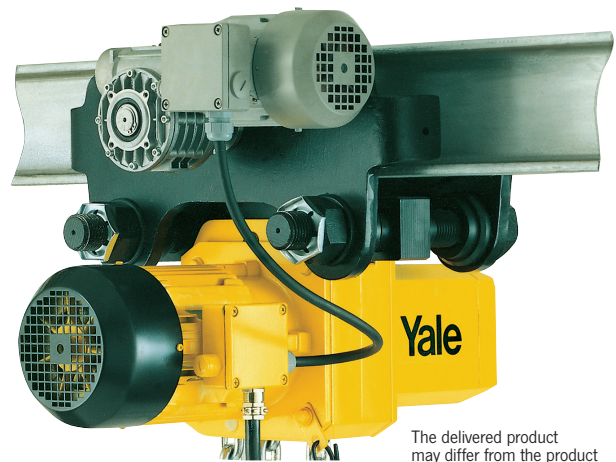

The delivered product may differ from the product shown in the image.

Technical data trolleys

Capacity kg	Size	Beam flange width b mm	Beam flange thickness t max. mm	Curve radius min. m	Electric trolley travel speed m/min at 50 Hz	Electric trolley motor kW at 50 Hz
1600 - 5000	A	98 - 180	27	2.0	11/2.8	0.3/0.09
1600 - 5000	B	180 - 300	27	1.8	11/2.8	0.3/0.09
7500 - 10000	B	125 - 310	40	1.8	5/1.25	0.55/0.12

INFO

Festooned cable systems please see pages 146-147.

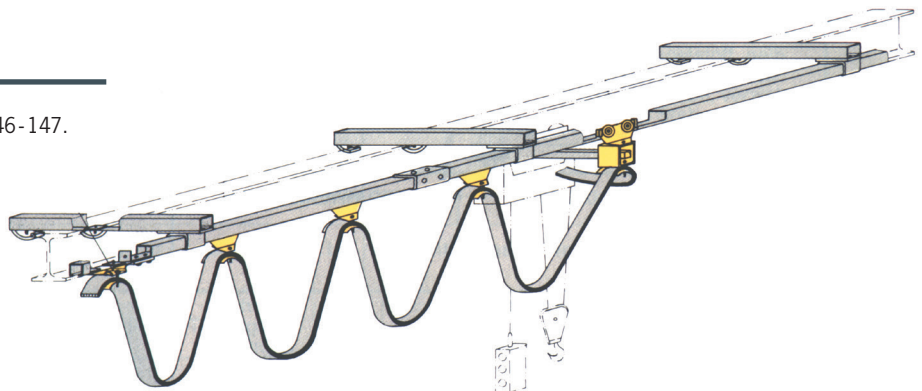

Dimensions CPE¹/CPEF

Model	CPE ¹ /CPEF 16-8	CPE ¹ /CPEF 20-8	CPE ¹ /CPEF 25-5	CPE ¹ /CPEF 30-5	CPE ¹ /CPEF 32-4	CPE ¹ /CPEF 40-4	CPE ¹ /CPEF 50-2	CPE ¹ /CPEF 75-1,6	CPE ¹ /CPEF 100-2
A, mm	516	516	516	516	681	681	681	950	1068
A1, mm	286	286	286	286	428	428	428	479	651
A2 (13m), mm	430	430	430	430	430	430	430	-	-
A2 (21m), mm	530	530	530	530	530	530	530	530	555
B, mm	35	35	35	35	45	45	45	60	60
C, mm	37	37	37	37	46	46	46	52	52
D, mm	24	24	24	24	30	30	30	40/45	40/45
E, mm	45/50	45/50	45/50	45/50	45/50	45/50	45/50	-	-
F1, mm	160	160	160	160	160	160	160	160	160
F2, mm	184/195	184/195	184/195	184/195	184/195	184/195	184/195	184/195	184/195
G, mm	220	220	220	220	220	220	220	220	-
G1, mm	180	180	180	180	140	140	140	293/298	340/345
G2 (13m), mm	257	257	257	257	218	218	218	-	-
G2 (21m), mm	277	277	277	277	238	238	238	345	408
H1, mm	110	110	110	110	110	110	110	110	135
H2, mm	135	135	135	135	135	135	135	307	256
K1, mm	100	100	100	100	100	100	100	92	92
K2, mm	51	51	51	51	51	51	51	62	62
M, mm	50	50	50	50	10	10	10	138	-
N, mm	105/110	105/110	105/110	105/110	145/150	145/150	145/150	136	390
Q1, mm	280	280	280	280	280	280	280	280	280
Q2, mm	382/438	382/438	382/438	382/438	382/438	382/438	382/438	382/438	382/438

¹ The model CPE (single speed hoist) is available on request. Please consider the deviating motor dimensions in the above table.

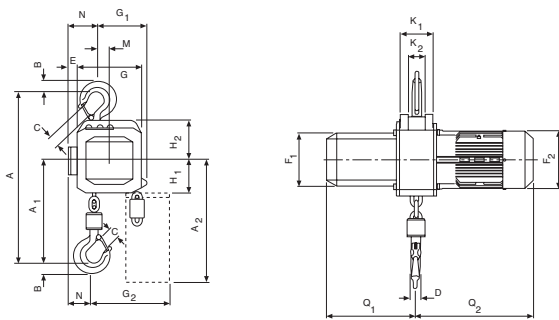

CPE¹/CPEF with suspension hook, 1600 - 3000 kg, single fall

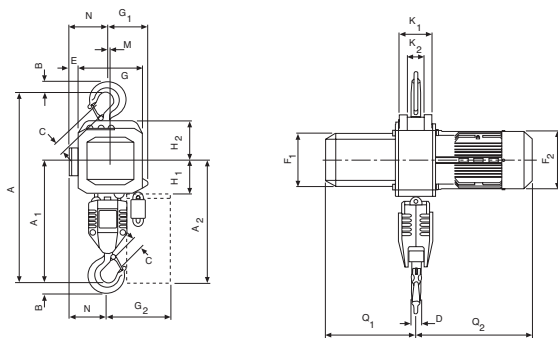

CPE¹/CPEF with suspension hook, 3200 - 5000 kg, double fall

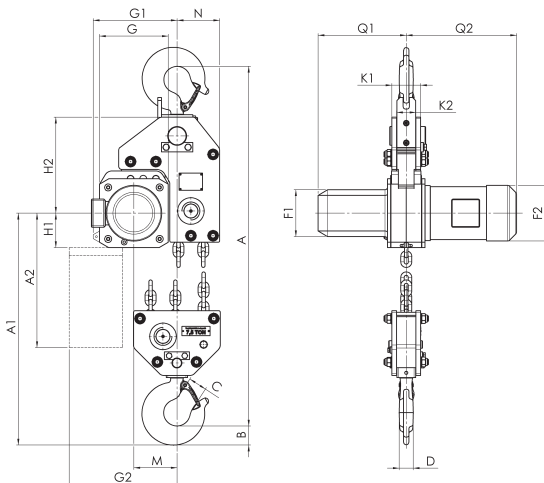

CPE¹/CPEF 75-1,6 with suspension hook, 7500 kg

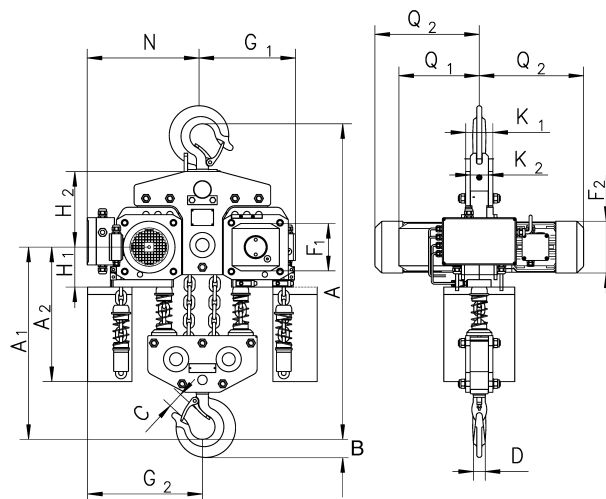

CPE¹/CPEF 100-2 with suspension hook, 10000 kg

Dimensions CPEF

Model	CPEF 16-8	CPEF 20-8	CPEF 25-5	CPEF 30-5	CPEF 32-4	CPEF 40-4	CPEF 50-2	CPEF 75-1,6	CPEF 100-2
A3, mm	121	121	121	121	121	121	121	-	110
A4, mm	465	465	465	465	615	615	615	855	965
A5, mm	298	298	298	298	298	298	298	477	450
A6, mm	178	178	178	178	178	178	178	-	170
b, mm	A = 98 - 180/ B = 180 - 300	A = 98 - 180/ B = 180 - 300	A = 98 - 180/ B = 180 - 300	A = 98 - 180/ B = 180 - 300	A = 98 - 180/ B = 180 - 300	A = 98 - 180/ B = 180 - 300	A = 98 - 180/ B = 180 - 300	125 - 310	125 - 310
F, mm	150	150	150	150	150	150	150	113	113
I, mm	142.5	142.5	142.5	142.5	142.5	142.5	142.5	170	170
L1, mm	209	209	209	209	209	209	209	200	200
L2, mm	262.5	262.5	262.5	262.5	262.5	262.5	262.5	215	215
L3 (VTE), mm	292	292	292	292	292	292	292	-	335
L3 (VTEF), mm	296	296	296	296	296	296	296	-	335
L4, mm	213	213	213	213	253	253	253	215	390
L5, mm	312	312	312	312	272	272	272	215	215
L6 (VTE), mm	342	342	342	342	342	342	342	-	-
L6 (VTEF), mm	346	346	346	346	306	306	306	-	-
O, mm	125	125	125	125	125	125	125	150	150
P (VTE), mm	197	197	197	197	197	197	197	-	273
P (VTEF), mm	205	205	205	205	205	205	205	-	280
P1, mm	229	229	229	229	229	229	229	-	110
S, mm	b + 70	b + 70	b + 70	b + 70	b + 70	b + 70	b + 70	b + 98	b + 98
T, mm	94	94	94	94	94	94	94	-	94
tmax., mm	27	27	27	27	27	27	27	40	40

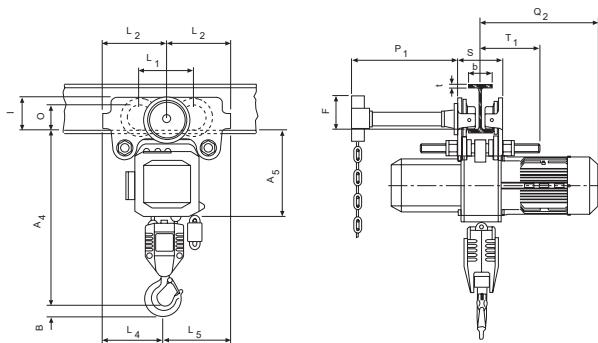

CPE1/CPEF with integrated manual geared trolley

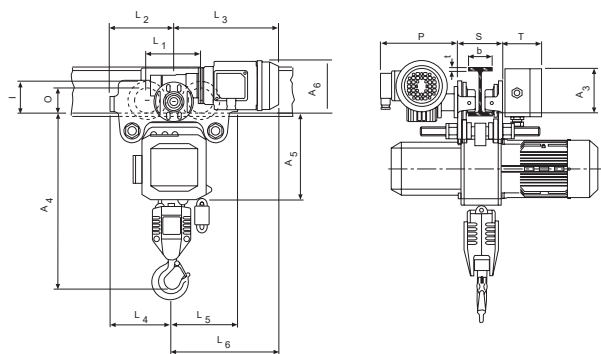

CPE1/CPEF with integrated electric trolley

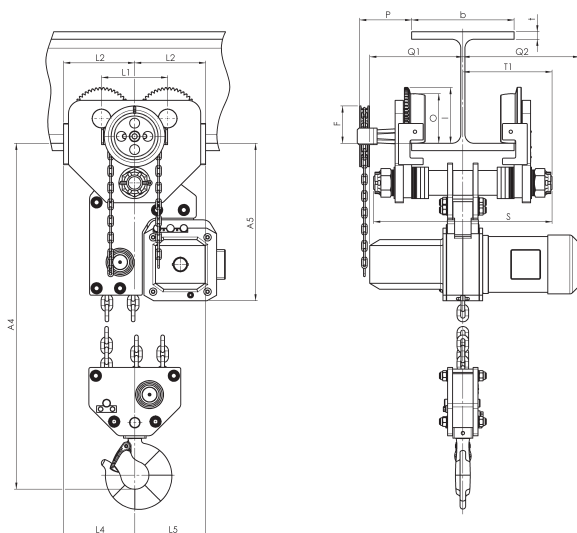

CPE1/CPEF with integrated geared or electric trolley, 7500 kg

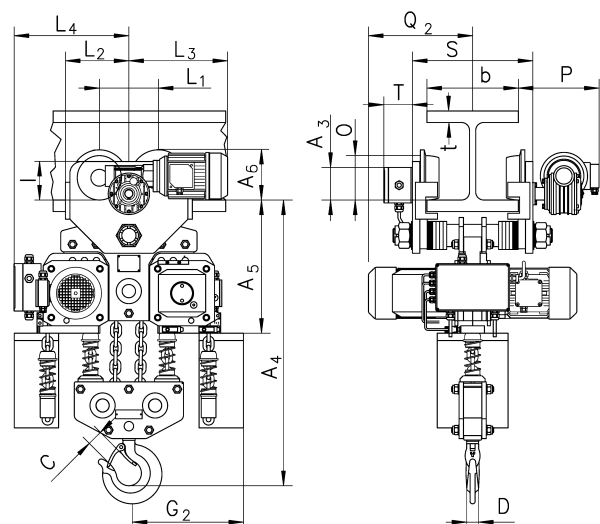

CPE1/CPEF with integrated electric trolley, 10000 kg